



midocean MO9379 Drones and Game Sets User Manual

[Home](#) » [midocean](#) » midocean MO9379 Drones and Game Sets User Manual 

midocean MO9379 Drones and Game Sets User Manual



Please read this manual carefully before flying. Retain this manual for future reference. As inconsistent with the specification in pictures, please prevail in kind.

Contents

- 1 **IMPORTANT NOTICE**
- 2 **Package Contents**
- 3 **NAME OF CONTROLLER**
- 4 **CHARGE BATTERY OF QUADCOPTER**
- 5 **CAUTIONS WHEN CHARGING**
- 6 **READY TO FLY**
- 7 **Headless Mode instructions**
 - 7.1 3D Eversion
- 8 **Wind Blade Installation**
- 9 **WIFI app download**
- 10 **Support**
- 11 **Documents / Resources**
 - 11.1 References
- 12 **Related Posts**

IMPORTANT NOTICE

1. Quadcopter is not a toy. There are still some risks that exist.
Please be sure to correctly use strictly in accordance with the safety notes and instructions. Any modification or improper use of the product may cause unexpected danger or accident.
Please do not overlook.
2. This product is not suitable for users under 12 years old. Please ensure the product is operated in a safe environment.
Manufacturer and dealer assume no liability for accidental damages by abnormal wear of parts, improper assembly, or operation in an unsafe manner.
3. This RC drone requires highflying skills. Any damages caused by wrong operations of disassemble and usage, cannot be replaced, returned, and exchanged under the warranty. If issues with usage, operation and maintenance occur, our company or distributors will provide you with technical guidance and spare parts supply.
4. This RC drone is dangerous for beginners to fly. It should be flown away from people, especially for beginner pilots. Improper assembly, damaged parts, wrong operations may cause unforeseen accidents such as injuries resulting from the loss of control during flight. The pilots must pay attention to the flying safety and be aware of his/her flying ability.
5. This RC drone can fly indoor and outdoor. Do not fly it in unsafe places, such as near heat sources, high-voltage power cables, and forbidden areas for flying drones
6. Adult supervision is required. Skill is required to control the flight and avoid collisions with the user, objects or third parties. Adult supervisors should teach children how to safely fly and control the toy.
7. Do not touch the rotating rotor, avoid loose clothing or hair that could be caught in the rotor, do not fly near the face.
8. Do not cover ventilation openings.

The Company has the right of final interpretation of this instruction manual statement.

Package Contents

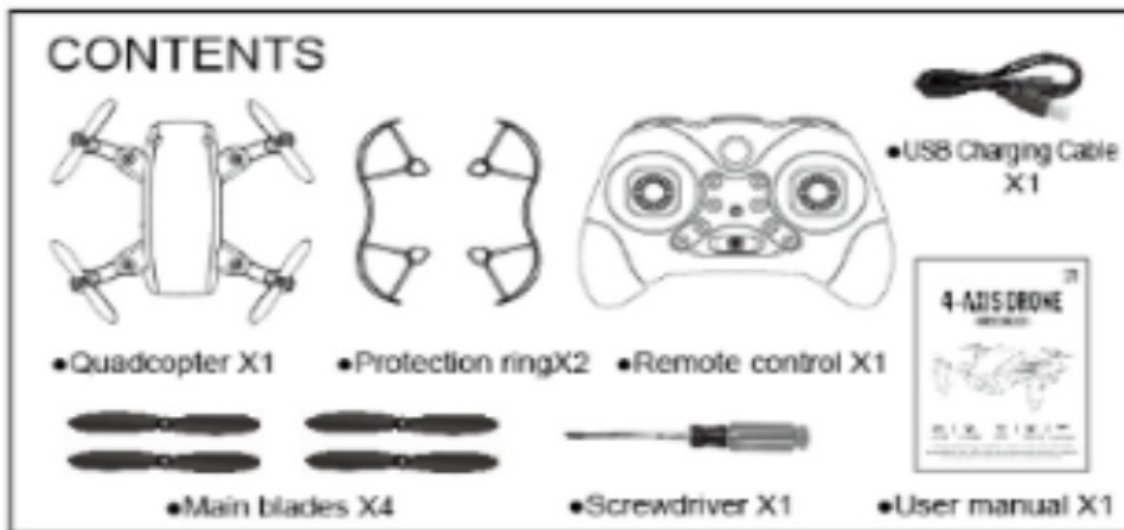

NAME OF CONTROLLER

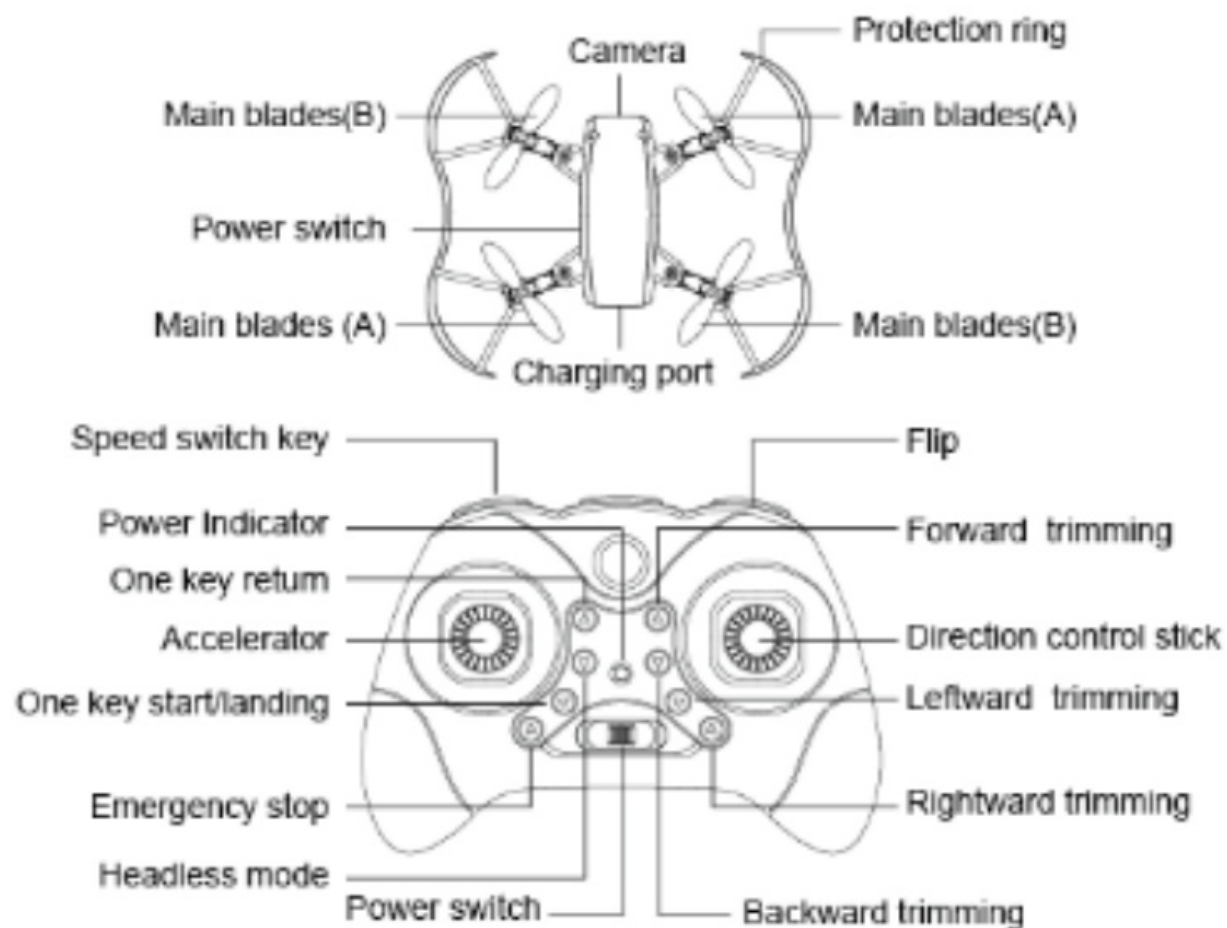

CHARGE BATTERY OF QUADCOPTER

1. Push the on/off switch of quadcopter to OFF position. Connect the charging port to a power supply device that has the USB interface with the USB cable.

Charging light on, that is in the state of charge.

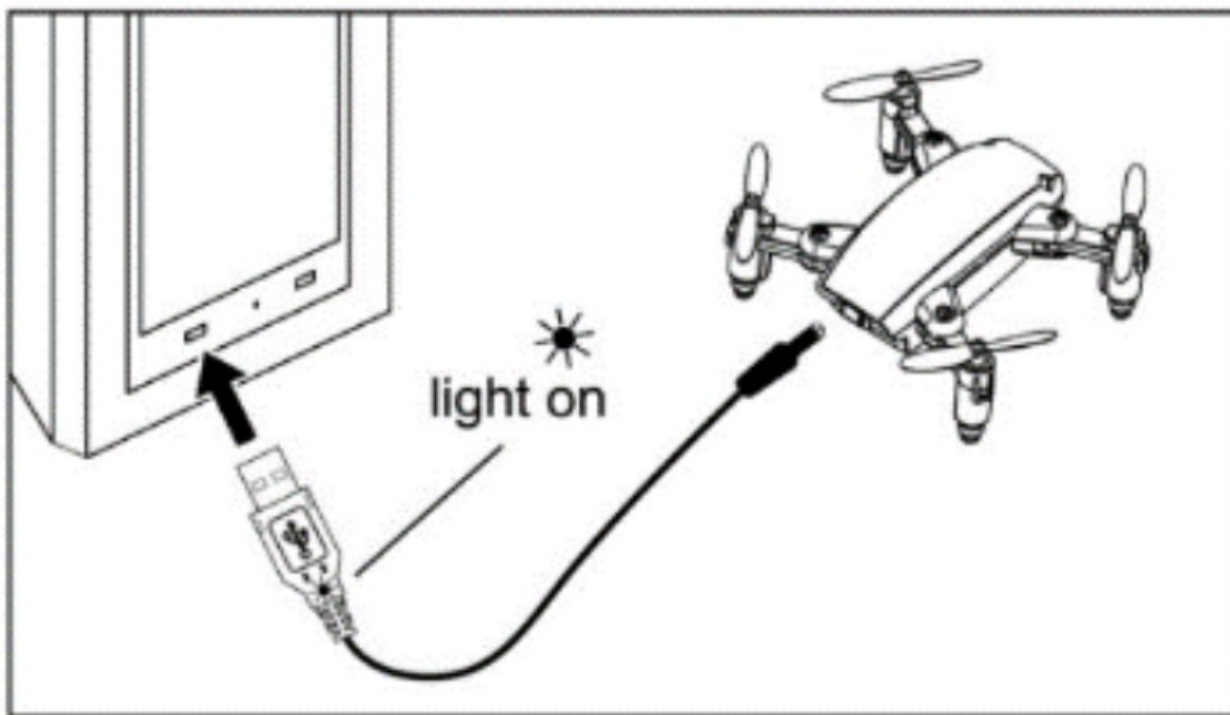

2. After charging for about 60 minutes, charging light goes off when full.

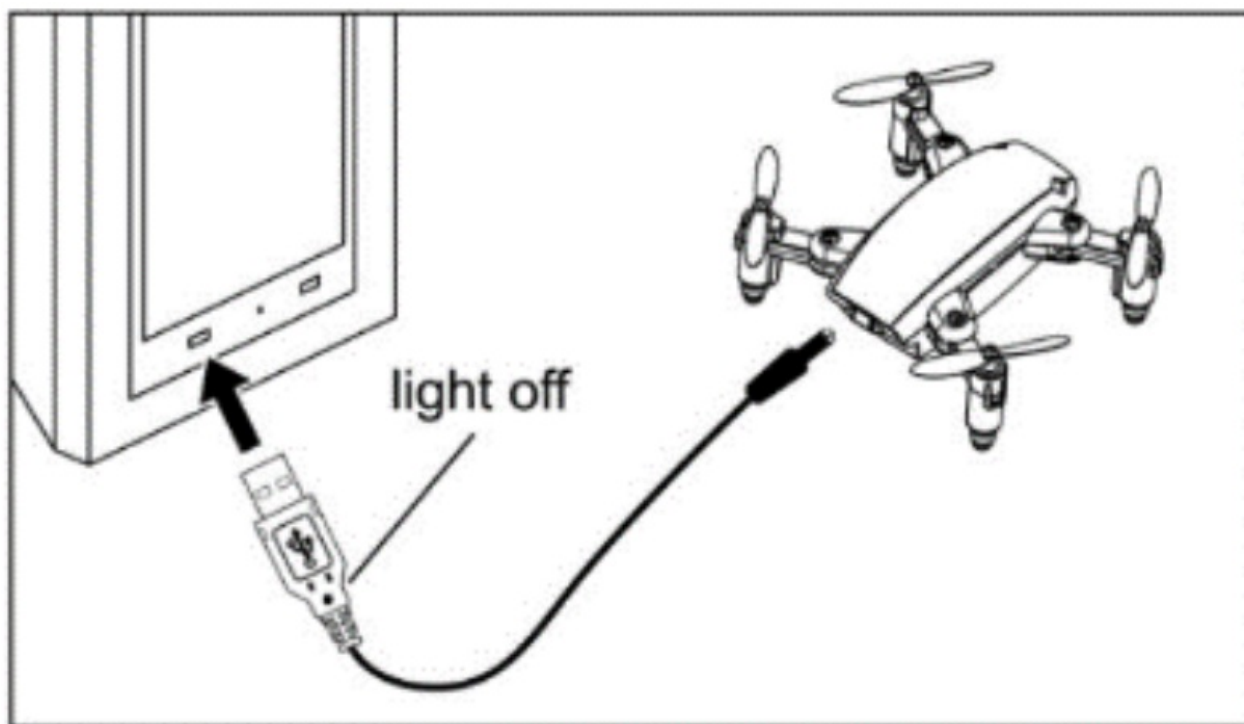

CAUTIONS WHEN CHARGING

1. When charging, please put this product on a dried or ventilated area and keep it far away from heat source or explosive product.
2. When charging should be supervised by an adult so as not to cause an accident.
3. After flying, please do not charge the Quadcopter if the surface temperature is still not cool. Otherwise it may cause a swollen battery or even a fire hazard.
4. Please make sure that you use the original USB charging cable provided. When the battery has been used for a long time, or appears to be swollen, please replace them.
5. A battery when not in use for a long time will lose its charge automatically. Charging or discharging too often

may reduce the life of the battery.

READY TO FLY

1. Unfold the quadcopter and place it on a horizontal position, then open up the power switch on the quadcopter. When the indicator lights flash, it means that the quadcopter goes into the flight standby mode.

Note: The antenna of the transmitter must be aligned the tail of the quadcopter.

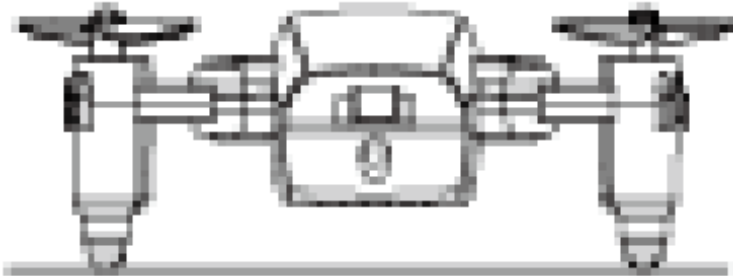

2. Open up the power switch of the transmitter. Push the left lever (accelerator) to the highest point and then reset to the lowest point. When the light in the quadcopter change to continuous lighting, it means that binding successfully.



3. Push the left and right lever at the same time to bottom left in 45 degree. The quadcopter's light stops flash and always light up, it means that compass adjustment successfully.



4. Push the left and right lever at the same time to bottom right in 45 degree. The quadcopter's light stops flash and always light up. At the same time, the transmitter buzzer beep once, it means that horizontal adjustment successfully.



Headless Mode instructions

Headless mode operation:

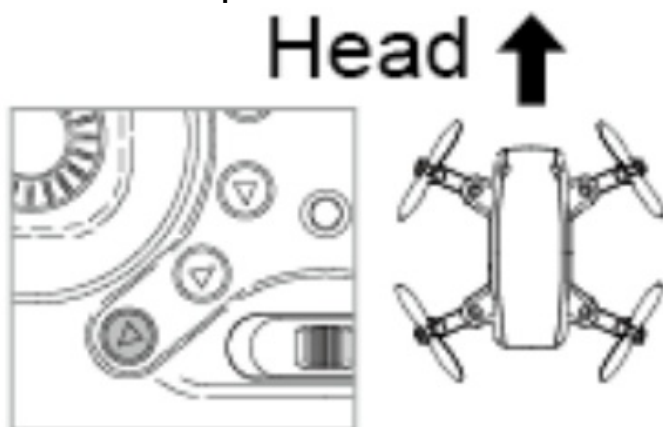

A key return

When the quadcopter fly far away, one key return button can recall the quadcopter. After binding the quadcopter, the antenna of the transmitter must be aligned the tail of the quadcopter when it take off. Press the one key return button to go into return mode with the light flash. Press the button again to exit return mode. During the returning, the forward and backward movement of right lever can interrupt this function.

High and low speed switching

During the flight of the quadcopter, the flight speed can be switched by pressing this button while it forward, backward, turn left and turn right. The quadcopter speed defaults to a low speed. Press this button once to switch to medium speed. At the same time, the transmitter buzzer beeps twice. Press the button again to switch to high speed. At the same time, the transmitter buzzer beeps three times. One more pressing turn back to low speed and beep once.

3D Eversion

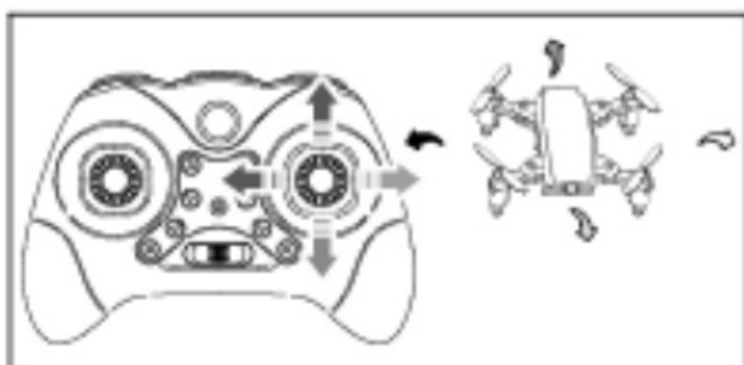

3D Eversion instructions When you are familiar with basic operation, you can do some awesome & exciting tricks an stunts! First of all, fly the aircraft to a height of more than 3 meters, press the 3D Eversion switch on the rear right side of the transmitter, then push the right rudder (in any direction) to make 360-degree flip.

Wind Blade Installation

- Install the fan blades on the motor shaft. (Ignore if installed)
- The arm logo must be the same as the wind blade logo. A blade should be aligned with A motor and B blade should be aligned with B motor.



WIFI app download

See the software for instructions:

Android (non-China)



IOS System :



Support

(2014/53/EU art. 10-8)

- Frequency Range; 2430-2469 MHz
- Maximum radio-frequency power; 100mW (EIRP)

(2014/53/EU art. 10-9 Simplified Declaration of Conformity)

Hereby, MOB, declares that item MO9379 complies with the essential requirements and other relevant conditions of directive 2014/53/EU. The full text of the EU declaration of conformity is available at the following internet address: www.momanual.com

MOB, PO BOX 644, 6710 BP (NL).



Warning: Not suitable for children under three years. Small parts.



PO: 41-XXXXXX

Made in China

Documents / Resources

	<p>midocean MO9379 Drones and Game Sets [pdf] User Manual MO9379 Drones and Game Sets, MO9379, Drones and Game Sets, Game Sets</p>
--	--

References

- [Export](#)