



MIDLAND 15-M Intercom Mesh Headset User Guide

[Home](#) » [MIDLAND](#) » MIDLAND 15-M Intercom Mesh Headset User Guide 

Contents

- 1 MIDLAND 15-M Intercom Mesh Headset
- 2 KNOW YOUR DEVICE
- 3 OPERATING THE TEAMS M-15
- 4 GETTING STARTED
- 5 INTERCOM SET-UP
 - 5.1 MOBILE PHONE FUNCTIONS
 - 5.2 BLUETOOTH & LEISURE FUNCTIONS
 - 5.3 INTERCOM MODE
- 6 KEY BENEFITS
- 7 Documents / Resources
 - 7.1 References
- 8 Related Posts



MIDLAND 15-M Intercom Mesh Headset



KNOW YOUR DEVICE

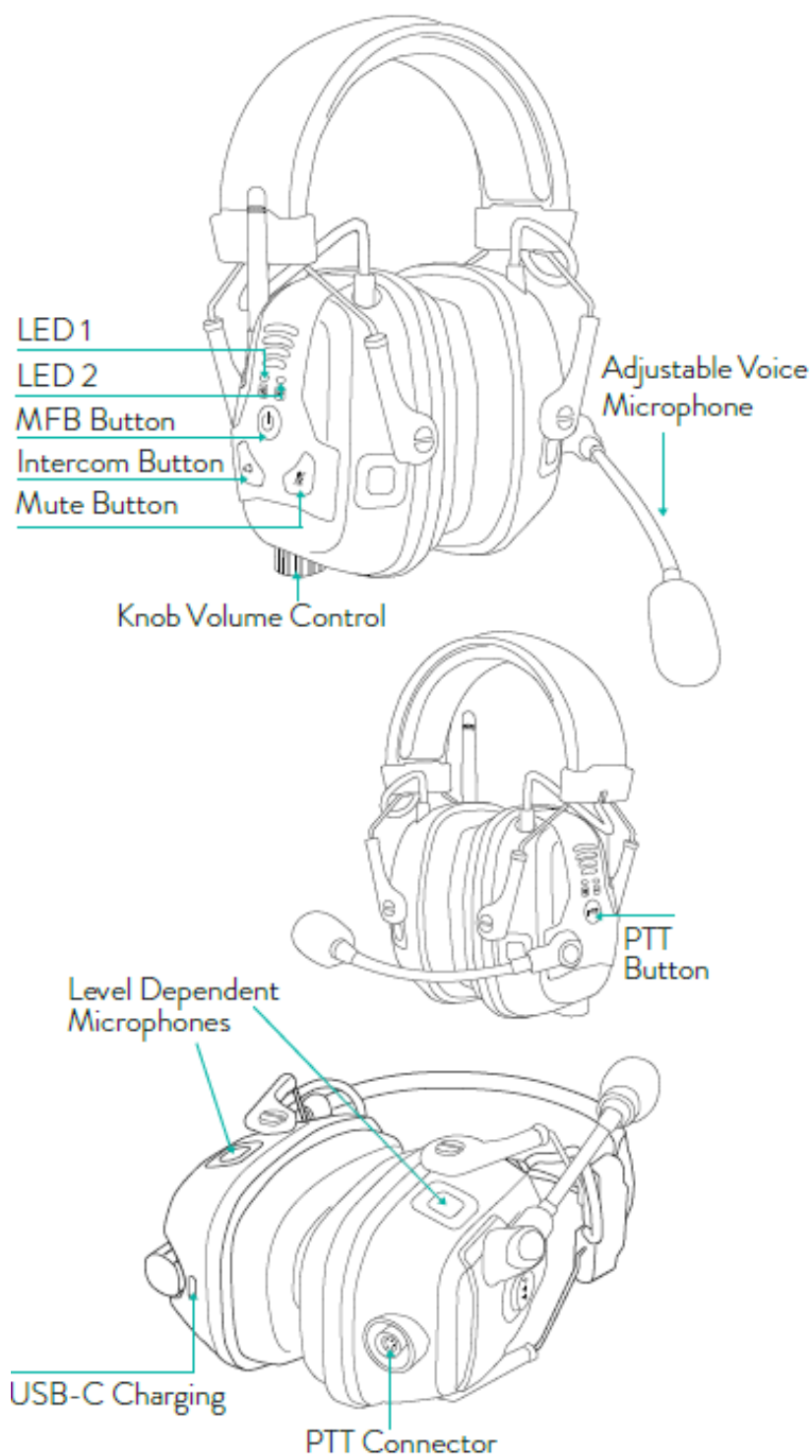

OPERATING THE TEAMS M-15

Charging the device via standard USB A to USB-C cable:

 Charging

 Charging complete

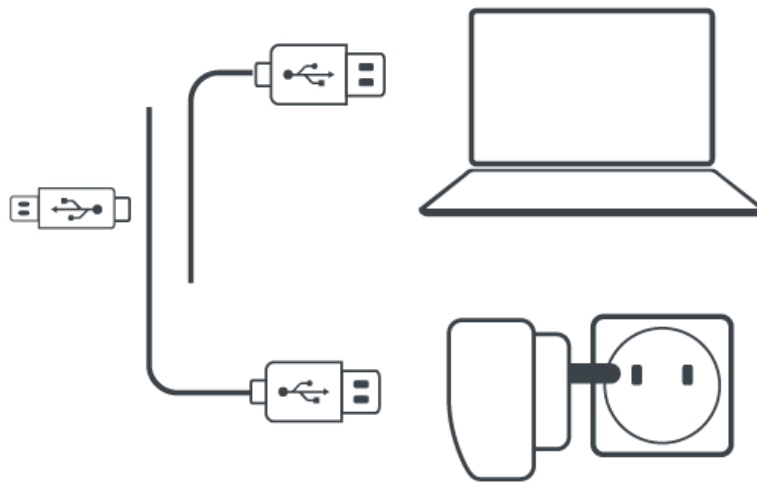

Fully charge the headset before first-time use.

Teams M-15 is designed to be operated via:

- Natural voice commands using the “Hey Midland” as an activation word
- Buttons
- Mobile app – optional

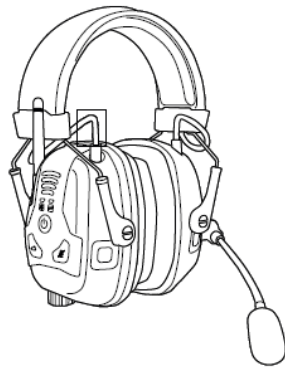

or

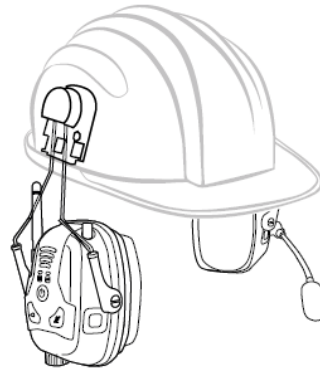

1

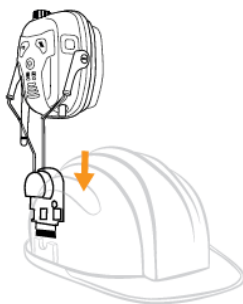

2

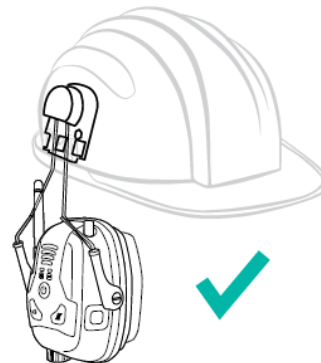

GETTING STARTED



On/ Off

Press
2
Sec.



Volume Up



Volume Down

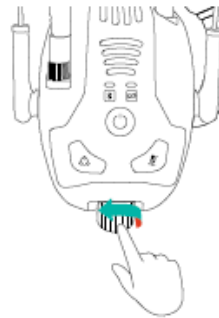
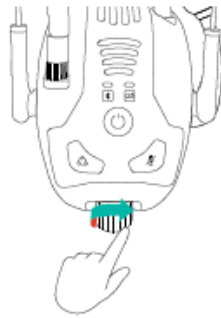

Mute



PTT Push To Talk

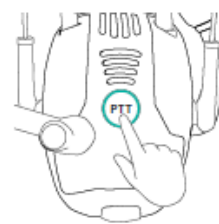

Press and Hold

Press until release

VOICE COMMANDS – Always on!

- Hey Midland, radio on
- Hey Midland, radio off
- Hey Midland, next station
- Hey Midland, previous station
- Hey Midland, music on
- Hey Midland, music off
- Hey Midland, next track
- Hey Midland, previous track
- Hey Midland, volume up
- Hey Midland, volume down
- Hey Midland, mute audio
- Hey Midland, unmute audio
- Hey Midland, speed dial
- Hey Midland, redial number

Answer

Ignore

- Hey Siri
- Ok Google
- Hey Midland, battery status
- Hey Midland, command list
- Hey Midland, emergency
- Hey Midland, private chat on
- Hey Midland, private chat off
- Hey Midland, what is my channel?

INTERCOM SET-UP

Create / Join a new Intercom Group

Admin + all group members / new member

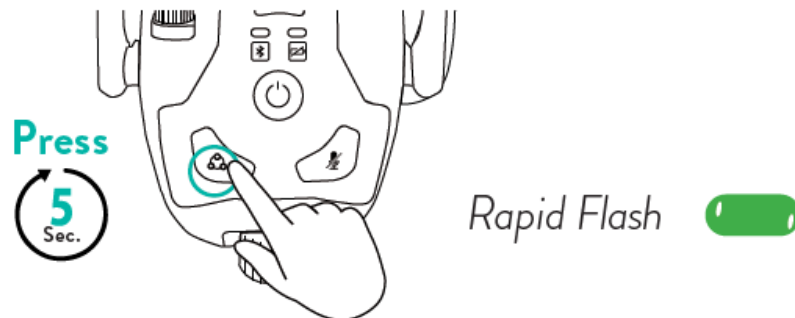

ONLY THE ADMIN (Group Creator)

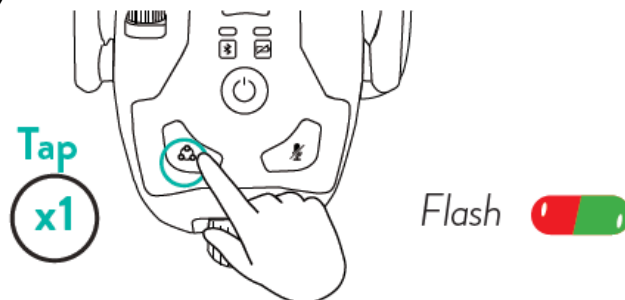

Grouped successfully

Flash 

STOP GROUPING PROCESS

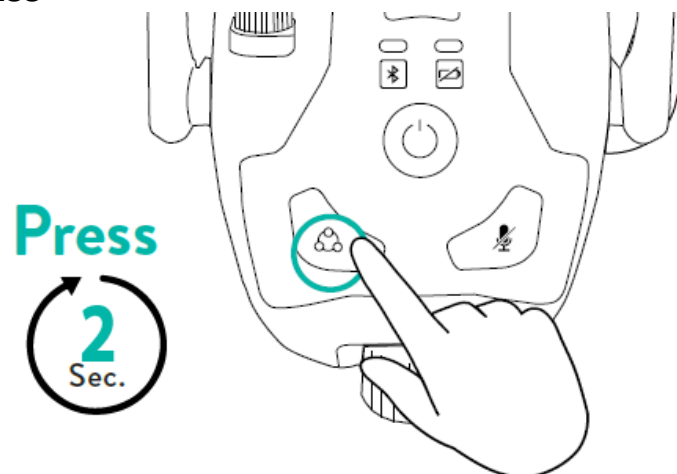

CANCEL GROUPING

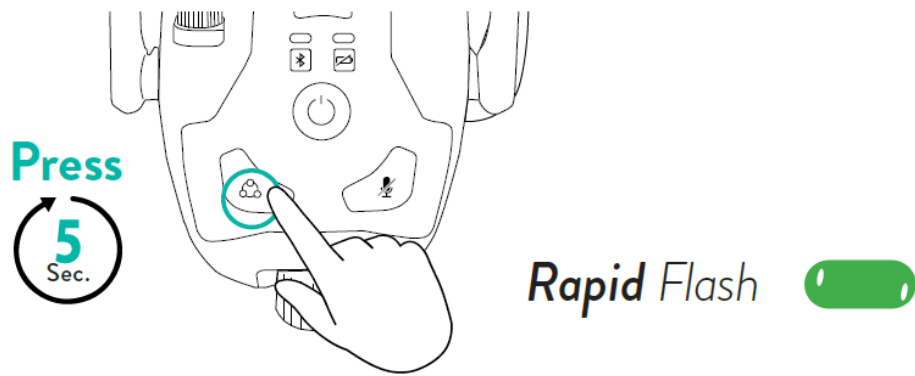

MOBILE PHONE PAIRING

1. Initiate/Cancel Bluetooth Pairing (Mobile Phone)

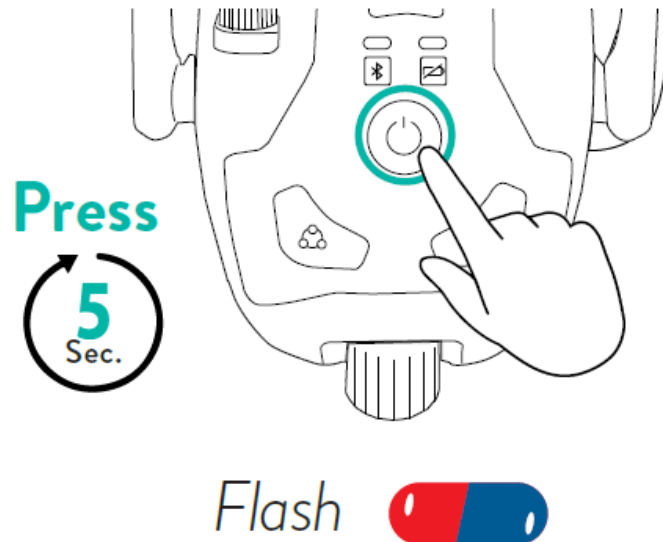

2. Pair Phone



Search for Bluetooth devices in your mobile phone, accept device.

MOBILE PHONE FUNCTIONS

Answer/ End a Call



Answer/ End a Call

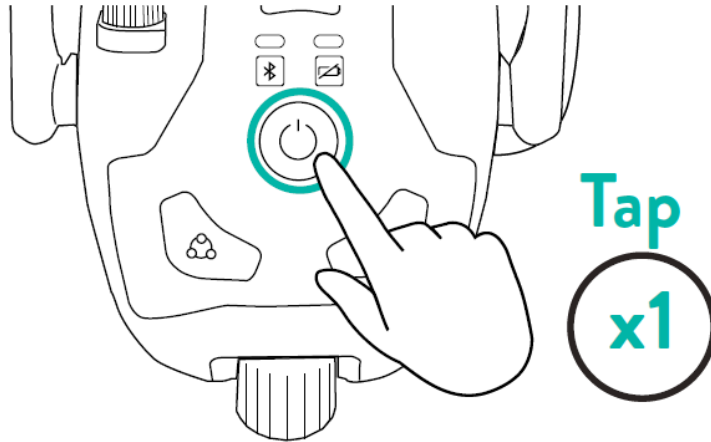

Alternatively, you can tap any button to answer an incoming call

Reject a Call



Reject a Call

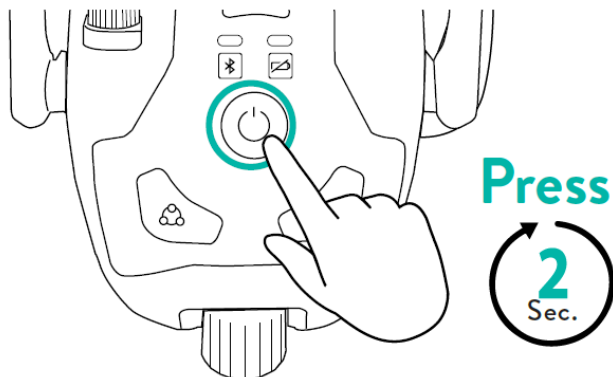

Alternatively, you can long press any button to reject an incoming call

PRIVATE CHAT

Chat privately with one of the group members

1. Choose member for private chat via Mobile App "Midland Teams"

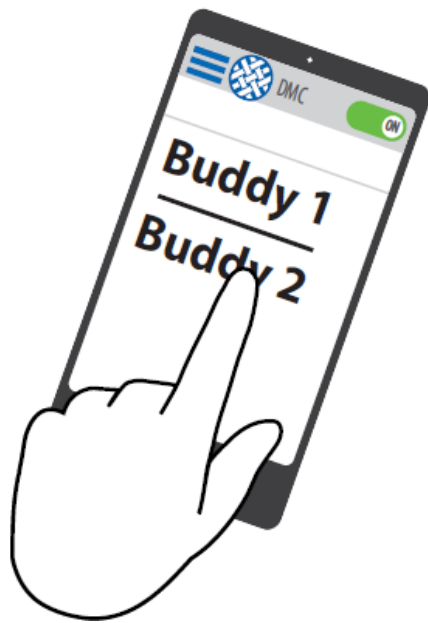

2. Start / Stop chat

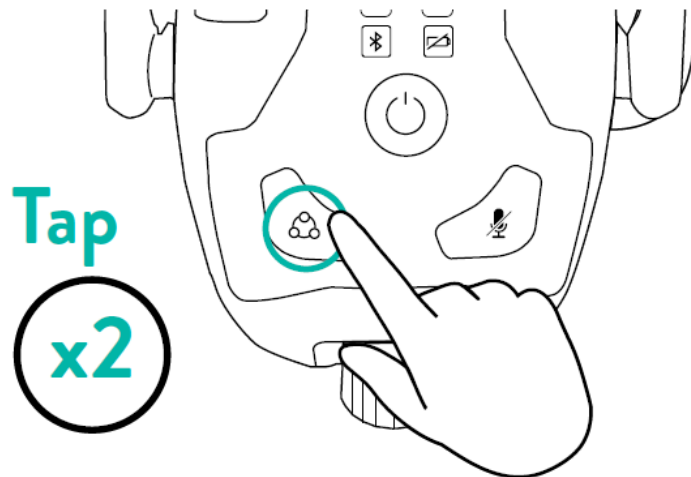

BLUETOOTH & LEISURE FUNCTIONS

MFB Multi Function Button

To Initiate Voice Menu

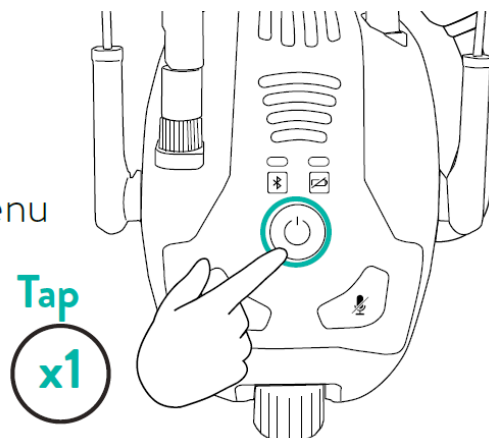

You will hear a list of commands
Mobile Phone Functions

- Speed Dial
- Redial
- Voice Dial

Audio Mute/Unmute Music

- On/off
- Next track
- Previous track

FM Radio

- On/off
- Next station
- Previous station
- Auto scan

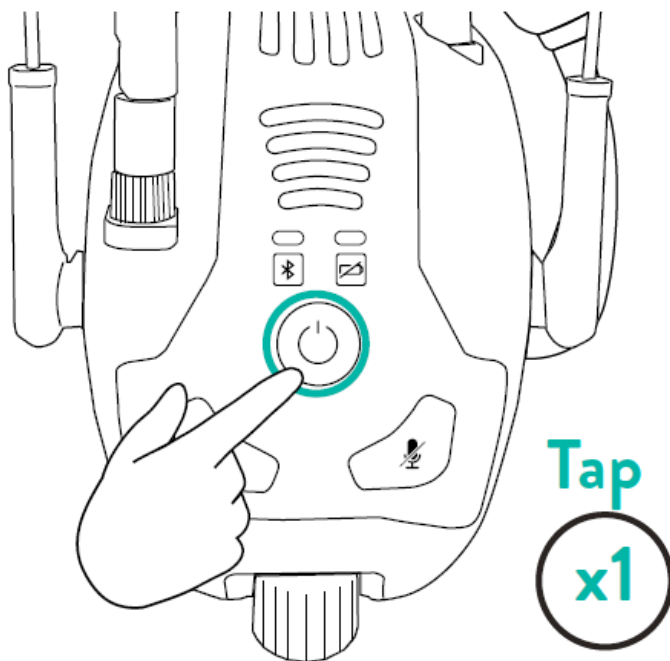

Tap once you hear the command you wish to operate

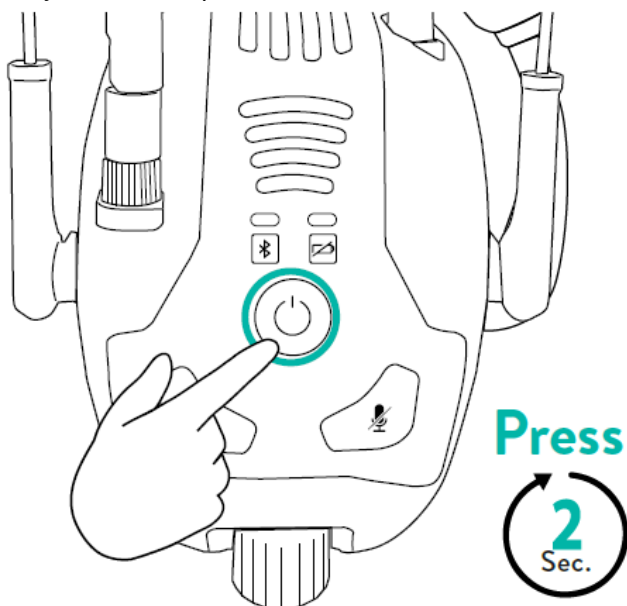

Press to exit the menu

INTERCOM MODE

Intercom Button:

To Initiate Voice Menu

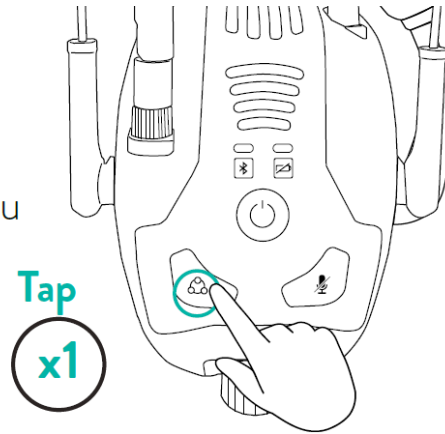

You will hear a list of commands

Group Mute/Unmute

Private Chat

- Start
- Stop

Emergency Call

- Channel management
- (Opens channels menu)
- Two-Way Radio Sharing on/off

Level Dependence

- On/off
- Volume control

Self-hearing

- On/off
- Volume control

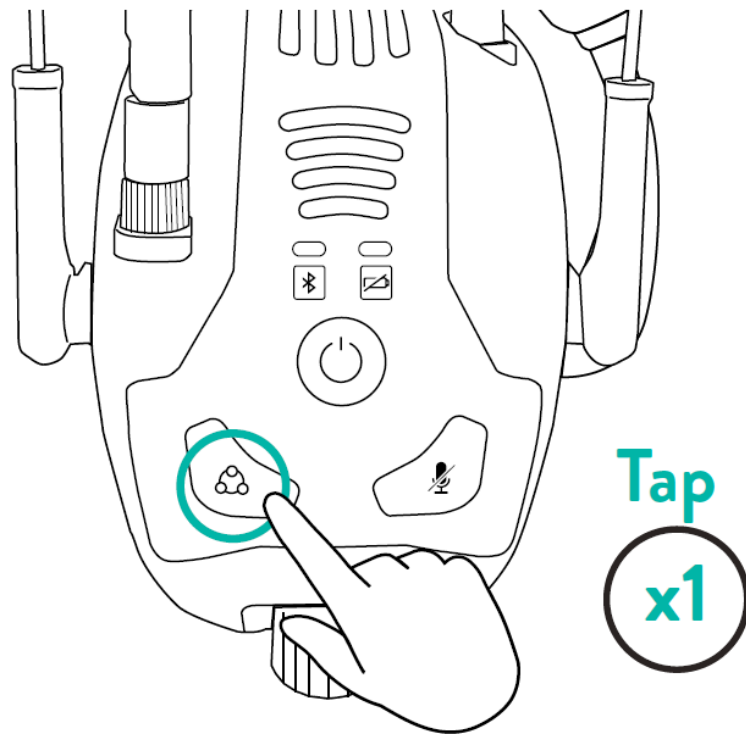

Tap once you hear the command you wish to operate

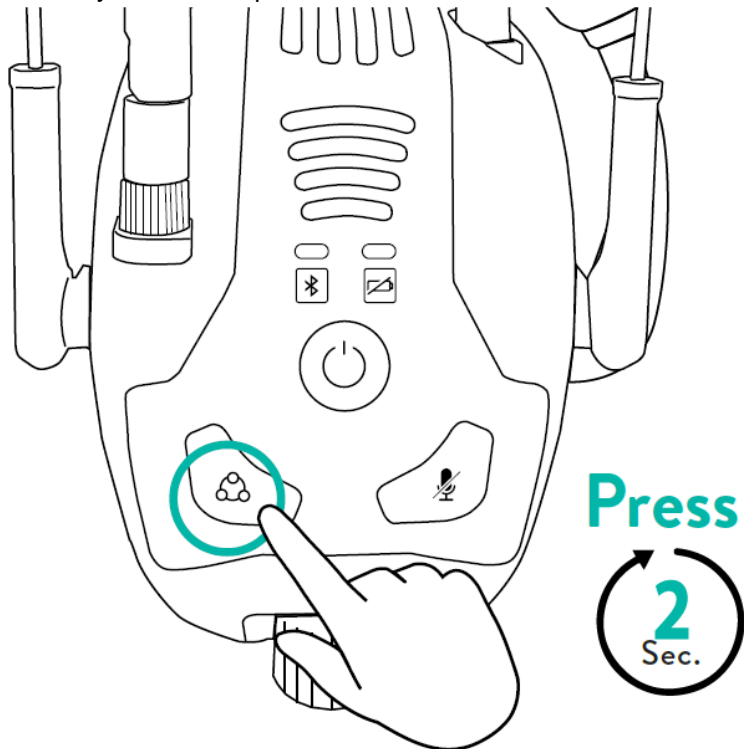

Press to exit the menu

2 WAY RADIO PAIRING

1. Initiate / Cancel Bluetooth Pairing (2 Way Radio)

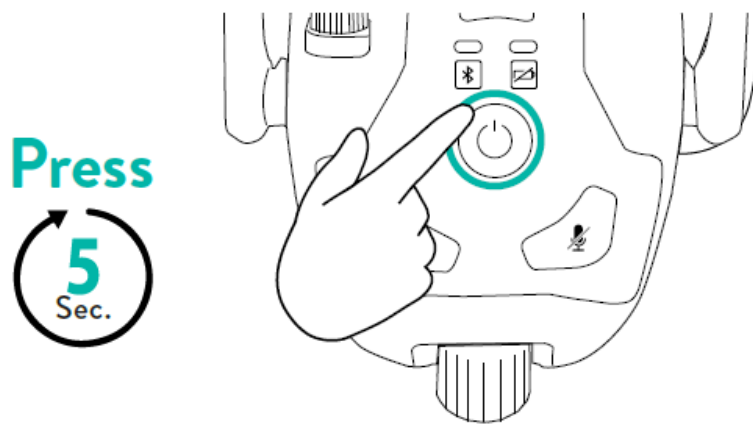

Flash 

2. Choose Bluetooth radios

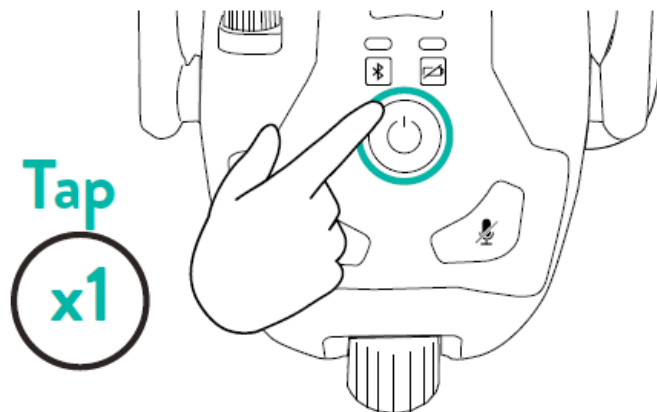

Flash 

3. Pair 2 Way Radio device

Search Bluetooth devices on your 2 Way Radio device and choose "Midland Teams M-15"

Paired successfully Flash 

Frequency	2400 – 2483.5 MHz
Max output power	0,04875 W

KEY BENEFITS

- Intercom System, Dynamic Mesh Communications (DMC™) – Meet Midland Teams M-15 headset, a uniquely dynamic intercom system with self-healing capabilities that connects up to 15 randomly moving team members. The always-on, full-duplex, hands-free communication technology is a 100% autonomous network (no need for any base station), designed to perform under the toughest environments.
- Full-Duplex Communication Technology
Multiple intercom networks can operate in the same terrain allowing several teams to speak simultaneously

without interruption.

- Hands-Free Operation

Natural Voice Operation and Always on Communication allow hands free operation – no need to press buttons or turn dials. The always-on communication technology provides the utmost in safety. Team members can operate/activate the system simply by voice commands such as “Radio On,” allowing team members to keep their hands free and focus on their tasks.

- Level Dependent / Listen Through – Reduces impulse noises and allows ambient noise including amplification of the human voice.

- 100% Autonomous Network

With Midland Teams M-15, no additional base station is necessary, so it works anywhere without the need for additional equipment. Autonomous networks allow team communication where standard systems are blocked or are non-operational.

Documents / Resources

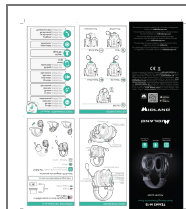

[MIDLAND 15-M Intercom Mesh Headset](#) [pdf] User Guide

15-M Intercom Mesh Headset, 15-M, Intercom Mesh Headset, Mesh Headset, Headset

References

- [▲ Comunicación en movimiento con alto rendimiento](#)
- [▲ Midland Europe | Radio and CB, Motorbike intercom systems and Action Cams](#)
- [🌐 nevada group : distribution, music, pr and radio](#)
- [🔍 Startseite | Alan Electronics](#)
- [▲ Midland - Alan France](#)
- [▲ Comunicación en movimiento con alto rendimiento](#)
- [▲ Midland Europe | Radio and CB, Motorbike intercom systems and Action Cams](#)