



MiDiPLUS Studio M Pro OTG USB Audio Interface User Guide

[Home](#) » [Midiplus](#) » MiDiPLUS Studio M Pro OTG USB Audio Interface User Guide 

MiDiPLUS

Studio M Pro OTG Qucik Start Guide

Contents

- [1 Introduction](#)
- [2 Features](#)
- [3 Start Using](#)
- [4 Connection Example](#)
- [5 Specifications:](#)
- [6 Documents / Resources](#)
- [7 Related Posts](#)

Introduction

Thank you for choosing the Studio M Pro OTG audio interface. Studio M Pro OTG is a 1 in-2 out USB audio interface, with a built-in OTG port and a 3.5mm phone jack, providing you with a faster and more convenient live streaming experience. One high-quality microphone preamp and 24bit/192kHz high-resolution sampling rate, support low-latency ASIO driver on Windows OS and will work straight away without needing to install any drivers on macOS. Please read this manual before you start using, it to help you quickly understand the basic operations and features of Studio M Pro OTG.

Features

- 1 in/2 Out USB audio interface with 24 bit/192 kHz audio resolution
- 1 Mic/Line/Hi-Z combo input with 48V phantom power supply and Input Gain control

- 2 colors Input level LED
- Independent monitor output volume and headphone volume control
- 2 Level Meters
- Connect to your mobile phone through OTG or 3.5mm jack
- OTG input/output
- High-Speed USB 2.0 and bus powered

Hardware Features

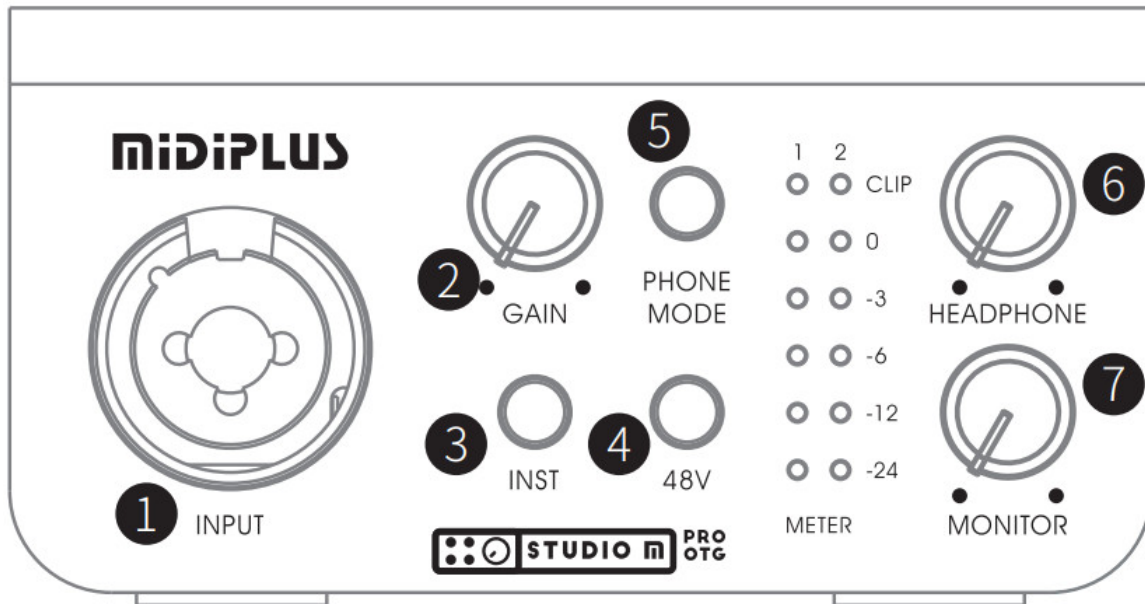

1. Mic/Line/Hi-Z combo input: Connect the microphone via XLR or use the 6.35mm jack to connect your instrument (such as an electric guitar) or line input
2. Input gain control: Adjust the gain level of the microphone, instrument or line input. Rotate counterclockwise to reduce the gain level and clockwise to increase the gain level
3. Instrument input switch button: Switch instrument/line input of 6.35mm input. Line in when the button light is off, instrument in when the button light is on
4. 48V phantom power switch: Turn on 48V phantom power supply of input 1/2 channel
5. OTG switch: The button lights Yellow means both the OTG Input and Output are turned on C) Press the switch, the button lights Red means turn on the route from mobile phone to OTG, press the switch twice to turn off the route C) Long press the switch over 2 seconds, the button tights Green means turn on the route from OTG to the mobile phone, long press the switch again to turn off the route
6. Headphone output level control: Adjust the headphone output level, rotate counterclockwise to reduce the level and rotate clockwise to increase the level, and the knob light is the USB status LED
7. Monitor output level control: Adjust the monitor outputs level. Rotate counterclockwise to reduce the level and clockwise to increase the level

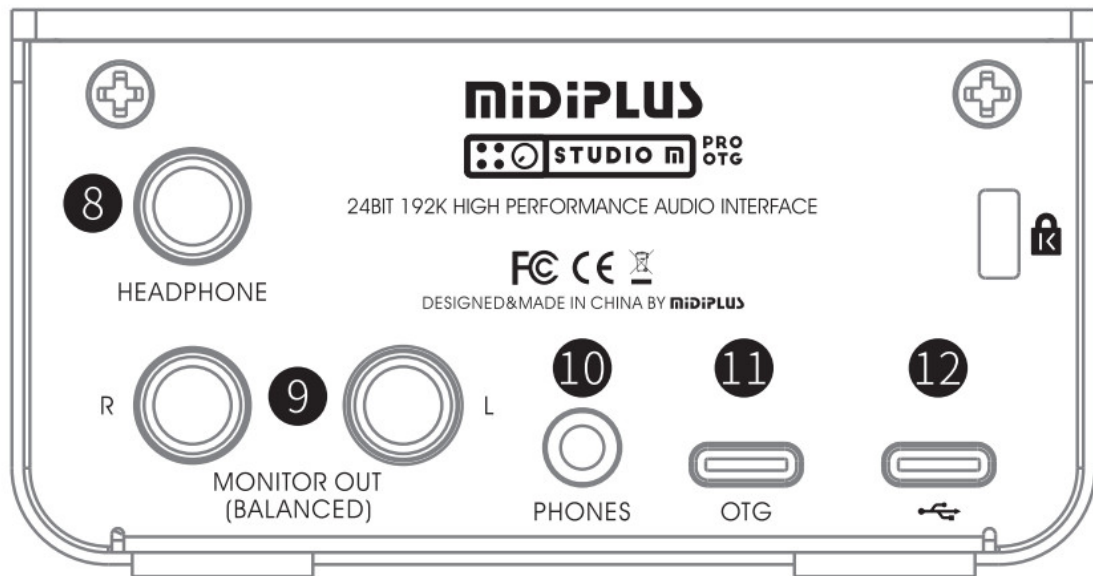

- 8. Headphone output: 6.35mm stereo output, connect to your headphone
- 9. Monitor output: Connect to your monitor
- 10. 3.5mm Phone jack: Connect to your mobile phone via the 3.5 TRRS cable
- 11. Type-C OTG port: Connect to your mobile phone via the Type-C cable
- 12. USB port: Connect to your computer

Start Using

1. Connect Connect the Studio M Pro OTG to a computer by using the included USB A to USB C cable, the USB status LED on the Headphone knob will light on.
2. Installation Windows: Go to <http://www.midiplus.com/cn/support.aspx?id=1> to download and install the latest driver. macOS: No need to install any drivers.
3. Setting the default sound device Windows: Go to Settings> System > Sound and then select the Studio M Pro OTG as your device for Input and Output. macOS: Go to System Preferences> Sound and then select the Studio M Pro OTG as your device for Input and Output.

Connection Example

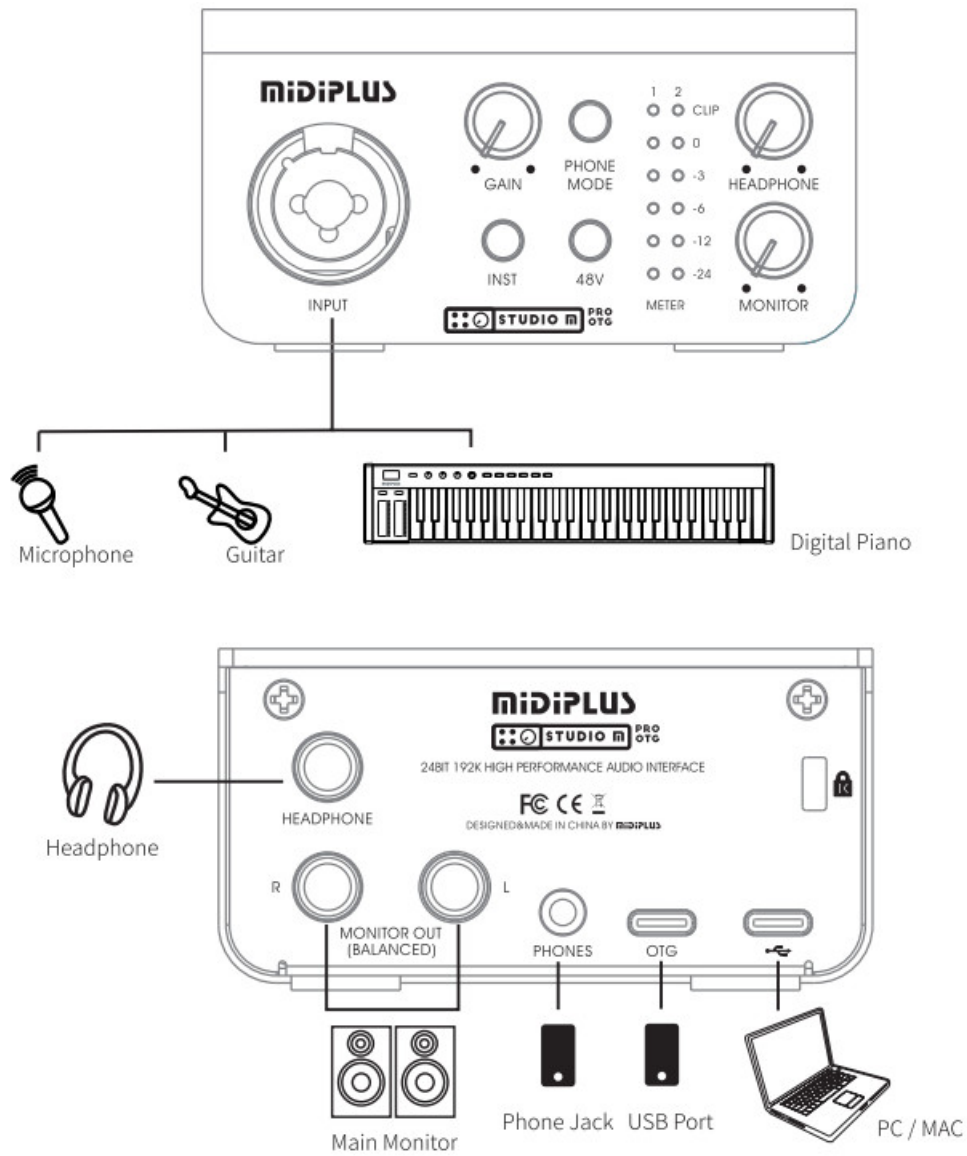

Specifications:

Model	Studio M Pro OTG
Bit depth/Sample rate	24bit/192kHz
I/O	1 x Mic/Line/Hi-Z Combo Input 1 x 1/4" Headphone Output 2 x 1/4" Monitor Outputs 1 x 1/8" Phone jack 1 x OTG port 1 x USB port
Buttons	1 x INST Switch 1 x OTG Switch 1 x 48V Switch
Knobs	1 x Input Gain control 1 x Monitor level control 1 x Headphone Volume control
Dimensions	116m m*90m m*46m m
Accessories	1 x USB Cable, 1 x Quick Start Guide 1 x 1/4" to 1/8" adapter 1x Information paper 1x 1/8" to 1/8" TRRS cable

www.midiplus.com

Documents / Resources

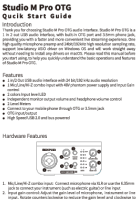
 <p>Studio M Pro OTG Quick Start Guide</p> <p>Introduction</p> <p>1. Connect the Studio M Pro OTG to your computer. Plug the USB cable into the USB port of the computer and the other end into the USB port of the Studio M Pro OTG.</p> <p>2. Turn on the power switch on the top of the Studio M Pro OTG.</p> <p>3. Select the input source (Mic/Line/Hi-Z) using the input selector switch on the top of the Studio M Pro OTG.</p> <p>4. Adjust the input gain using the input gain knob on the top of the Studio M Pro OTG.</p> <p>5. Connect the headphones to the 1/4" headphone output on the top of the Studio M Pro OTG.</p> <p>6. Adjust the headphone volume using the headphone volume knob on the top of the Studio M Pro OTG.</p> <p>7. Press the INST switch on the top of the Studio M Pro OTG to enable the instrument input.</p> <p>8. Press the OTG switch on the top of the Studio M Pro OTG to enable the OTG function.</p> <p>9. Press the 48V switch on the top of the Studio M Pro OTG to enable the 48V phantom power.</p> <p>10. Enjoy your music!</p> <p>Hardware Features</p> <p>1. 24-bit/192kHz sampling rate</p> <p>2. 2x 1/4" monitor outputs</p> <p>3. 1/4" headphone output</p> <p>4. 1/8" phone jack</p> <p>5. 1x USB port</p> <p>6. 1x OTG port</p> <p>7. 1x 48V switch</p> <p>8. 1x INST switch</p> <p>9. 1x OTG switch</p> <p>10. 1x input gain knob</p> <p>11. 1x headphone volume knob</p> <p>12. 1x input selector switch</p> <p>13. 1x power switch</p> <p>14. 1x LED indicator</p> <p>15. 1x carrying case</p> <p>16. 1x USB cable</p> <p>17. 1x 1/4" to 1/8" adapter</p> <p>18. 1x 1/8" to 1/8" TRRS cable</p> <p>19. 1x Quick Start Guide</p> <p>20. 1x Information paper</p>	<p>MiDiPLUS Studio M Pro OTG USB Audio Interface [pdf] User Guide</p> <p>Studio M Pro OTG USB Audio Interface, Studio M Pro OTG, USB Audio Interface</p>
---	--