



Contents [[hide](#)]

- [1 Midea Cube Pint Dehumidifier](#)
- [2 Specifications](#)
- [3 INSTALLATION INSTRUCTIONS](#)
- [4 Optional Caster Installation](#)
- [5 FAQs](#)
- [6 Documents / Resources](#)
 - [6.1 References](#)



Midea Cube Pint Dehumidifier



Specifications

Feature	Details
Usage	Indoor residential applications only
Temperature Range	Above 41°F (5°C)
Air Space	8" on all sides, 16" for air outlet

INSTALLATION INSTRUCTIONS

Positioning the Unit

The dehumidifier should be placed in the area where dehumidification is desired most. Adjacent rooms in which dehumidification is also desired should allow adequate airflow in and out of the space containing the dehumidifier.

- Do not use outdoors.
- This dehumidifier is intended for indoor residential applications only. This dehumidifier should not be used for commercial or industrial applications.
- Place the dehumidifier on a smooth, level floor strong enough to support the unit with a full bucket of water.
- Allow at least 8" of air space on all sides of the unit for air circulation (at least 16" for air outlet).
- Place the unit in an area where the temperature will not fall below 41°F (5 °C). The coils can become covered with frost at lower temperatures, which may reduce performance.
- Place the unit away from any clothes dryer, heater or radiator.
- Close all doors, windows, and other openings to the outdoors in the room.

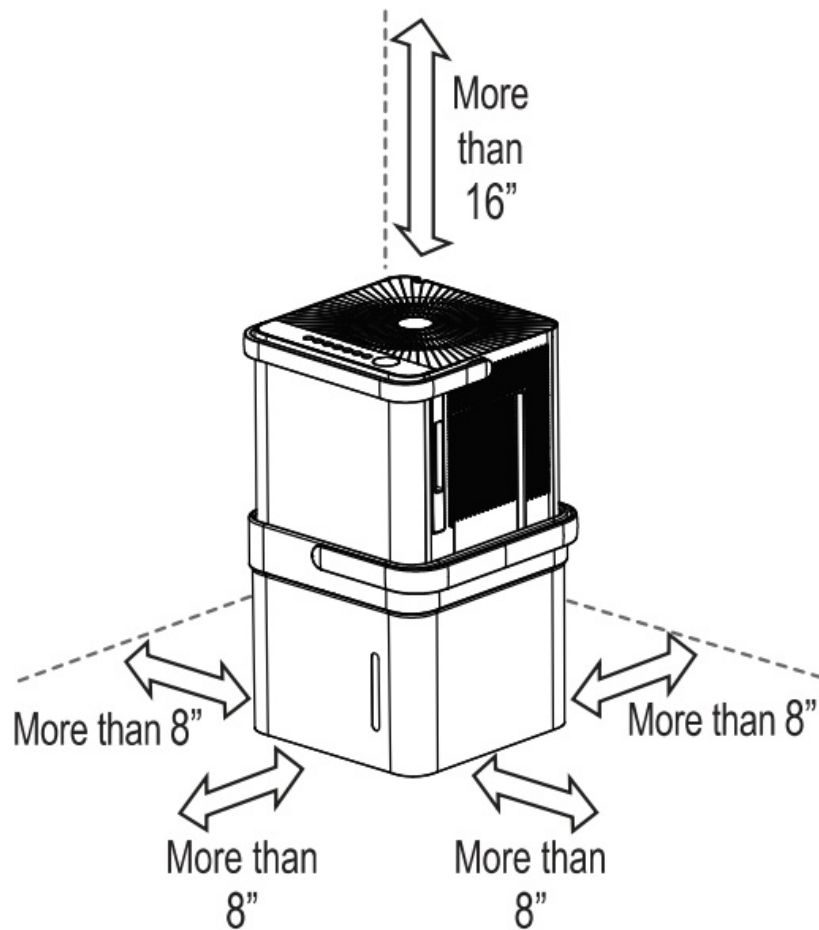

Optional Caster Installation

To install the casters

1. Remove the Dehumidifier from the bucket.
2. Slide each caster into the slot on the bucket's bottom corner as shown below.
3. Place the retaining block into the slot to hold the caster in place.
4. Repeat this for each corner of the bucket until all 4 casters are installed.

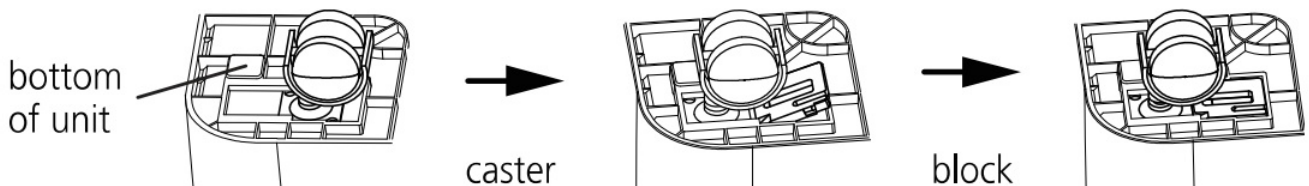

To remove the casters

1. Use a flathead screwdriver to actuate the tab on the retaining block.
2. Remove the retaining block and slide the casters out of the slot on the bucket.

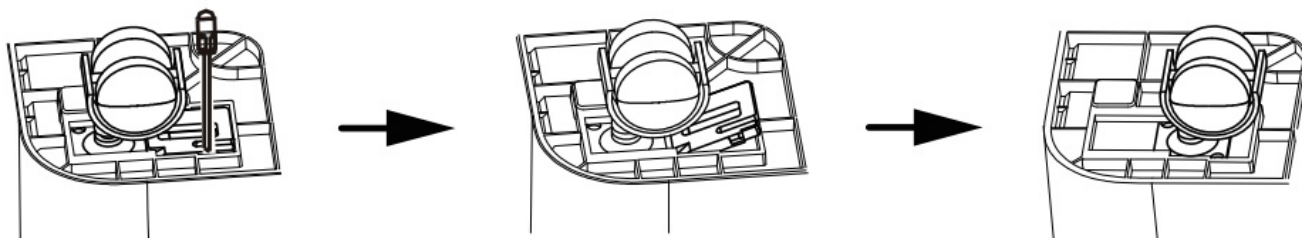

NOTICE

With the casters attached, do not move the unit and bucket assembly while there is water in the bucket. Before rolling the bucket, remove the unit.

Additional Setup and Usage Information

Scan this QR code with your mobile device to see a playlist of helpful videos about your new Cube Dehumidifier.



FAQs

Can I use the dehumidifier outdoors?

No, this dehumidifier is intended for indoor residential applications only.

What is the minimum temperature for operation?

The unit should be placed in an area where the temperature will not fall below 41°F (5°C)

How do I install the casters?

Remove the dehumidifier from the bucket, slide each caster into the slot, and place the retaining block to hold it in place.

Can I move the unit with water in the bucket?

No, you should remove the unit from the bucket before moving it if there is water inside

Documents / Resources

	Midea Cube Pint Dehumidifier [pdf] Installation Guide Cube Pint Dehumidifier, Pint Dehumidifier, Dehumidifier
---	--

References

- [User Manual](#)

📎 Cube Pint Dehumidifier, Dehumidifier, Midea, Pint

📁 Midea Dehumidifier

—Previous Post

[Midea EU-SK108, US-SK108 Smart Kit User Manual](#)

Next Post—

[Midea MIH742FY18K0 Induction Hob with Integrated Hood User Guide](#)

—

Leave a comment

Your email address will not be published. Required fields are marked *

Comment *

Name

Email

Website

☐ Save my name, email, and website in this browser for the next time I comment.

Post Comment

Search:

e.g. whirlpool wrf535swhz

Search

[Manuals+](#) | [Upload](#) | [Deep Search](#) | [Privacy Policy](#) | [@manuals.plus](#) | [YouTube](#)

This website is an independent publication and is neither affiliated with nor endorsed by any of the trademark owners. The "Bluetooth®" word mark and logos are registered trademarks owned by Bluetooth SIG, Inc. The "Wi-Fi®" word mark and logos are registered trademarks owned by the Wi-Fi Alliance. Any use of these marks on this website does not imply any affiliation with or endorsement.