

**Microtouch**  
**MicroTouch NewTral**  
**3 Mouse**



## MicroTouch NewTral 3 Mouse User Manual

[Home](#) » [MICROTOUCH](#) » MicroTouch NewTral 3 Mouse User Manual 

### Contents

- [1 MicroTouch NewTral 3 Mouse User Manual](#)
- [2 FEATURES](#)
- [3 DESCRIPTION](#)
- [4 HARDWARE INSTALLATION](#)
- [5 FCC STATEMENT](#)
- [6 References](#)

**Microtouch**

**MicroTouch NewTral 3 Mouse User Manual**



## FEATURES

- Interface: 2.4 GHz Wireless
- Button: 6 Buttons Programmable(Left & Right Click, Back & Forward, DPI Switch, Scroll Wheel and Middle Button)
- Hand Orientation: Right
- DPI Resolution: Optical Type 800/1600/2400
- Dimensions: 113.81 x 79.63 x 52.59mm
- Note: Battery: 1 X AA

## REQUIREMENT

- Operating system: Windows 7/8/10
- Mac(Not Programmable for Mac System)
- Available USB port

## DESCRIPTION



## HARDWARE INSTALLATION

- Turn on your computer.

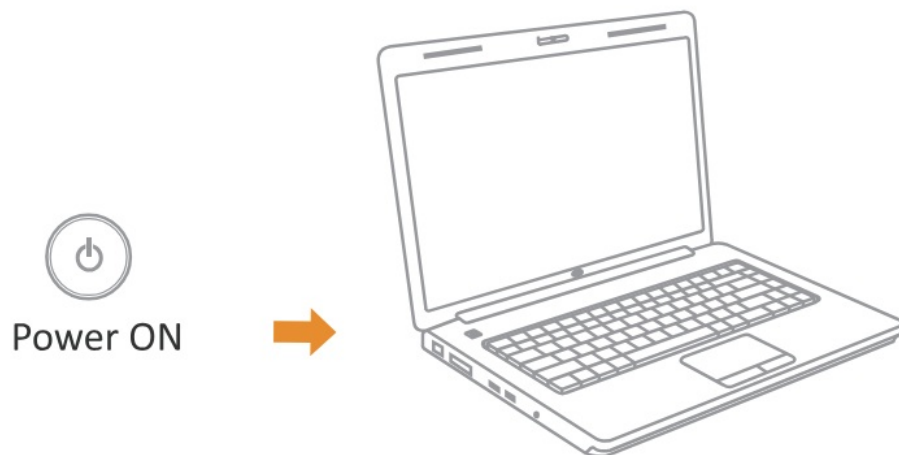

- Pull out the USB Receiver from the bottom of the Neutral 3 mouse and insert it into your computer's USB port.

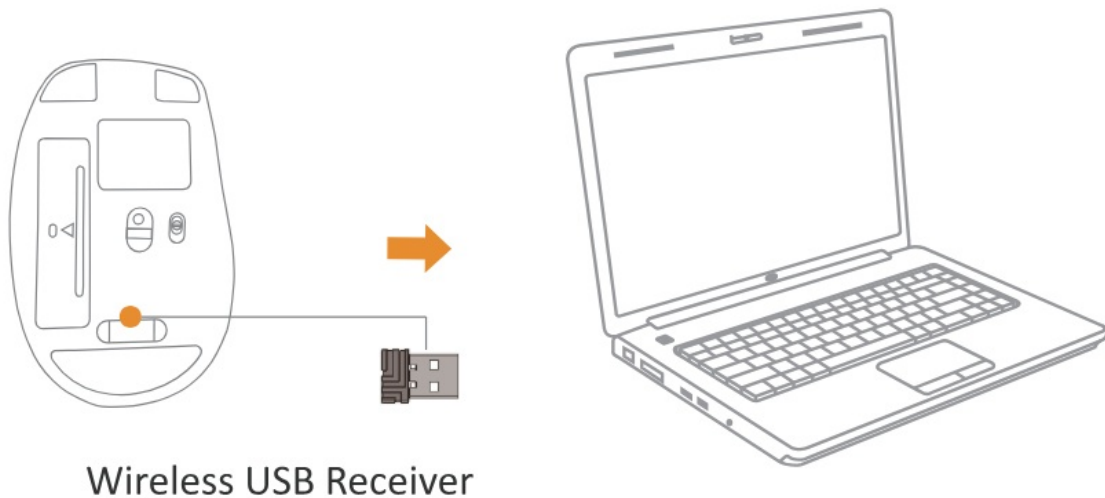

- Your operating system will automatically detect and assign a driver.
- Turn on your mouse with the ON/OFF switch and it will automatically pair with the inserted USB receiver.

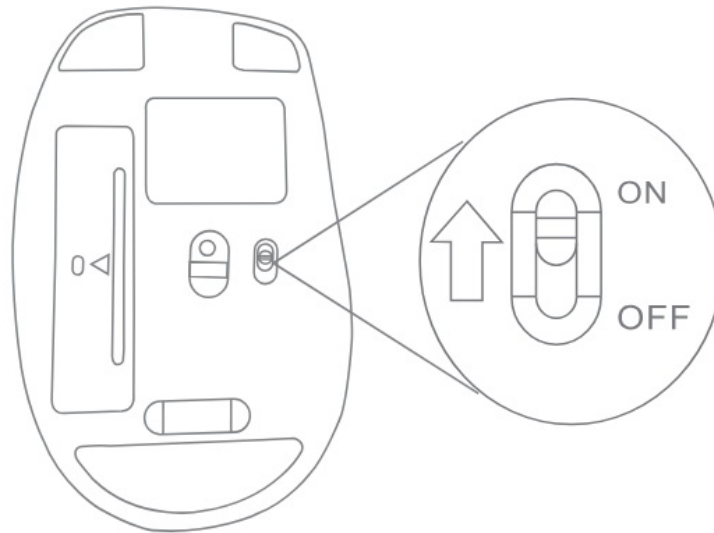

### NEUTRAL 3 MOUSE SOFTWARE INSTRUCTION

Download the software from [web:http://www.newtralmouse.com/download.html](http://www.newtralmouse.com/download.html)

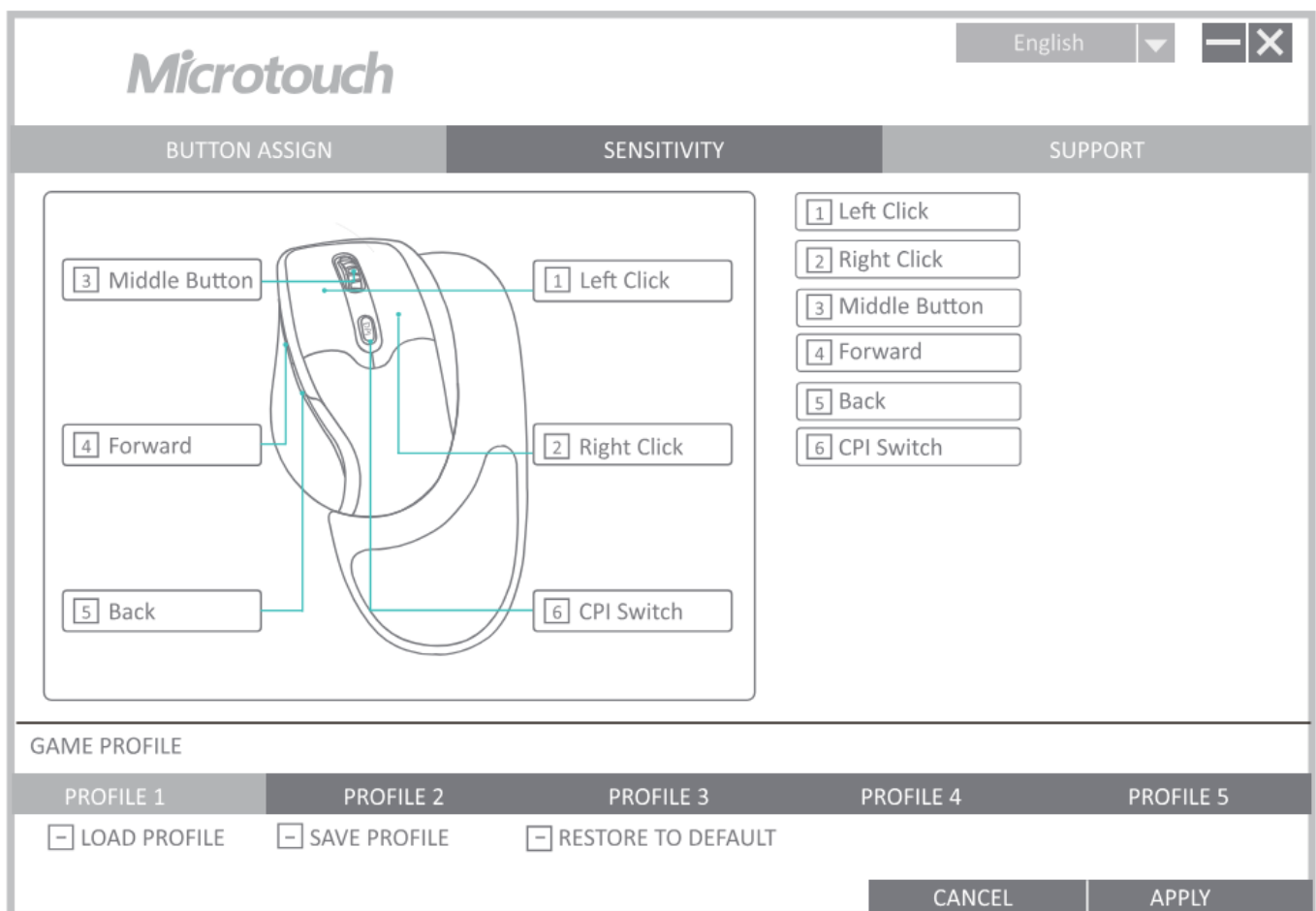

- Once you have followed the installation steps, go into your “system tray” by clicking on the arrow located to the left of your Windows clock and click on the Microtouch Neutral Mouse Wireless.
- You can set the language you want in the top right-hand corner of the menu. the configuration menu has three tabs: “Button assigns”, “Sensitivity” and” Support”.
- The options available on the tabs are explained below.

English

Microtouch

BUTTON ASSIGN

SENSITIVITY

SUPPORT

CPI 1

-

800

1600

2400

+

CPI 2

-

800

1600

2400

+

CPI 3

-

800

1600

2400

+

Acceleration

0

1

2

3

4

5

6

7

8

9

10

SLOW

FAST

■ Accuracy Increasing

Vertical Scrolling Speed

1

2

3

4

5

6

7

8

9

10

SLOW

FAST

Double Click

0

1

2

3

4

5

6

7

8

9

10

SLOW

FAST

Polling Rate

● 125HZ

● 250HZ

● 500HZ

● 1000HZ

GAME PROFILE

PROFILE 1

PROFILE 2

PROFILE 3

PROFILE 4

PROFILE 5

LOAD PROFILE

SAVE PROFILE

RESTORE TO DEFAULT

CANCEL

APPLY

- Click on “BUTTON ASSIGN” to change your mouse button function and click “APPLY” to save the setting. By using the “Restore to default” button you can return all settings to factory default Settings.
- Click on “SENSITIVITY” to change the speed of your mouse cursor as well as adjust
- DPI settings and click”APPLY” to save the setting. By using the “Restore to default” button you can return all settings to the factory default Setting.
- Click on “SUPPORT” you may find the hardware and software information.

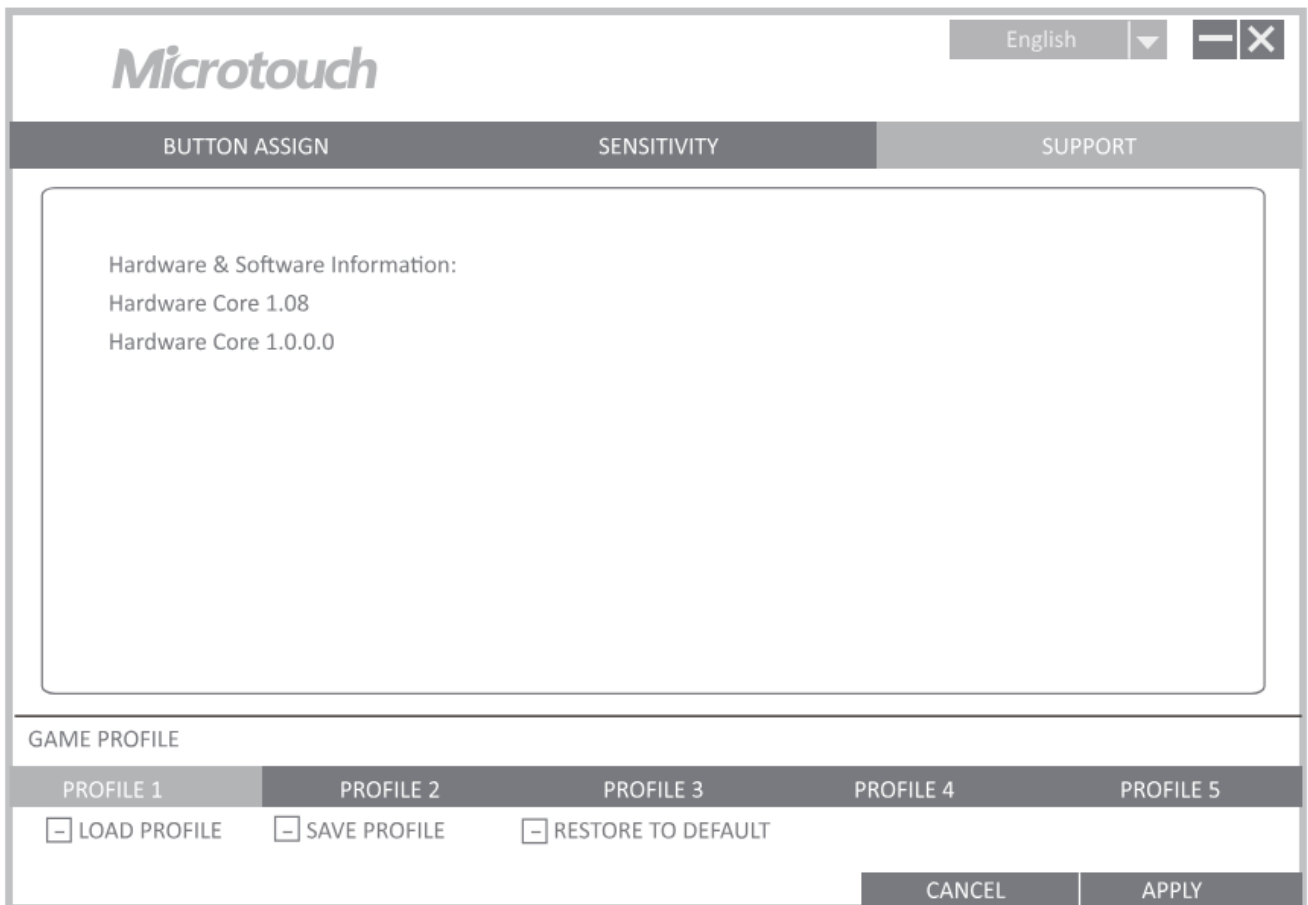

## FCC STATEMENT

This device complies with Part 15 of the FCC Rules. Operation is subject to the following two conditions:

- (1) This device may not cause harmful interference, and
- (2) This device must accept any interference received, including interference that may cause undesired operation.

**Warning:** Changes or modifications not expressly approved by the party responsible for compliance could void the user's authority to operate the equipment.

**NOTE:** This equipment has been tested and found to comply with the limits for a Class B digital device, under Part 15 of the FCC Rules. These limits are designed to provide reasonable protection against harmful interference in a residential installation. This equipment generates uses and can radiate radio frequency energy and, if not installed and used by the instructions, may cause harmful interference to radiocommunications. However, there is no guarantee that interference will not occur in a particular installation. If this equipment does cause harmful interference to radio or television reception, which can be determined by turning the equipment off and on, the user is encouraged to try to correct the interference by one or more of the following measures:

- Reorient or relocate the receiving antenna.
- Increase the separation between the equipment and the receiver.
- Connect the equipment to an outlet on a circuit different from that to which the receiver is connected.
- Consult the dealer or an experienced radio/TV technician for help.

Download PDF: [MicroTouch NewTral 3 Mouse User Manual](#)

## References

- [User Manual](#)

## **Manuals+. Privacy Policy**

This website is an independent publication and is neither affiliated with nor endorsed by any of the trademark owners. The "Bluetooth®" word mark and logos are registered trademarks owned by Bluetooth SIG, Inc. The "Wi-Fi®" word mark and logos are registered trademarks owned by the Wi-Fi Alliance. Any use of these marks on this website does not imply any affiliation with or endorsement.