



microSHIFT SH003-002 Trail Trigger Shifter User Manual

[Home](#) » [microSHIFT](#) » microSHIFT SH003-002 Trail Trigger Shifter User Manual 



Contents

- [1 microSHIFT SH003-002 Trail Trigger Shifter](#)
- [2 Tools and Supplies](#)
- [3 Setup the Cockpit](#)
- [4 Proper Shifter Position](#)
- [5 Horizontal Positioning](#)
- [6 Rotational Positioning](#)
- [7 Tightening the Shifter](#)
- [8 Cable Routing](#)
- [9 Proper Housing Length](#)
- [10 Documents / Resources](#)
- [11 Related Posts](#)

microSHIFT SH003-002 Trail Trigger Shifter



REMINDER

Before installing the products, please read and understand the installation procedures. Improper installation can lead to premature product failures or even injuries. If you have any questions on how to install, please contact us or consult with a professional bicycle mechanic.

Tools and Supplies

1. Torque wrench
2. 4mm Hex bit
3. Allen wrenches

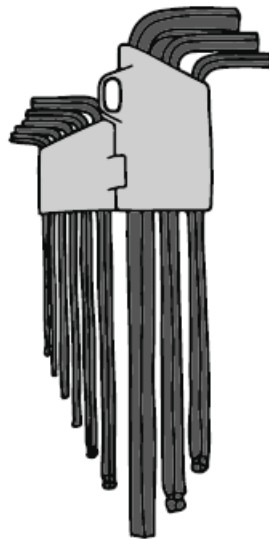
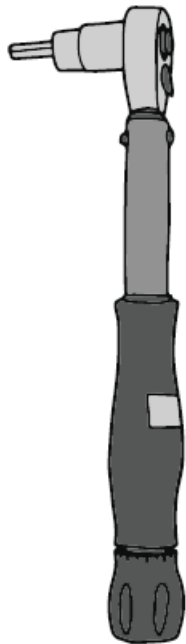

Setup the Cockpit

Start by standing over the bike on flat ground. Install the brake levers, the shifter, and the grip with clamps loosened. Adjust the brake levers to your preference.

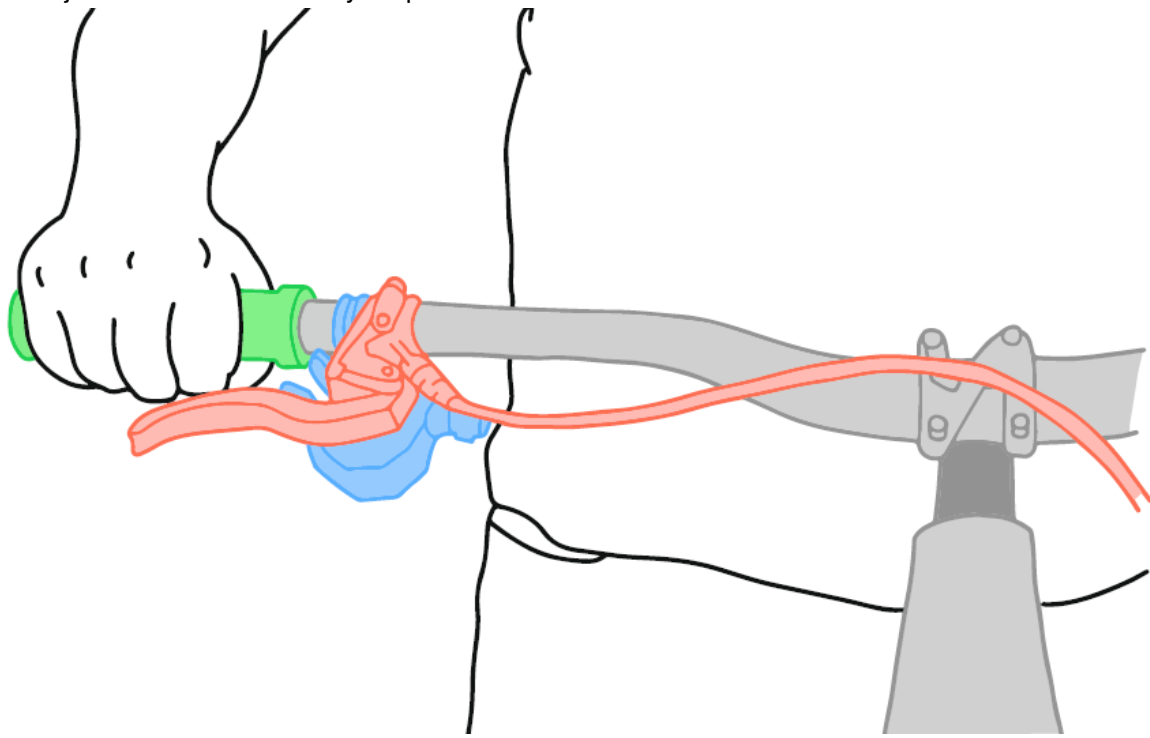

Put your hand in your normal riding position. With your index finger on the brake lever, test out the shifter position of both the upper shift lever and lower shift lever with your thumb. You should be able to reach both levers easily without losing your grip. Repeat step 3 & 4 until the setup is comfortable.

Proper Shifter Position

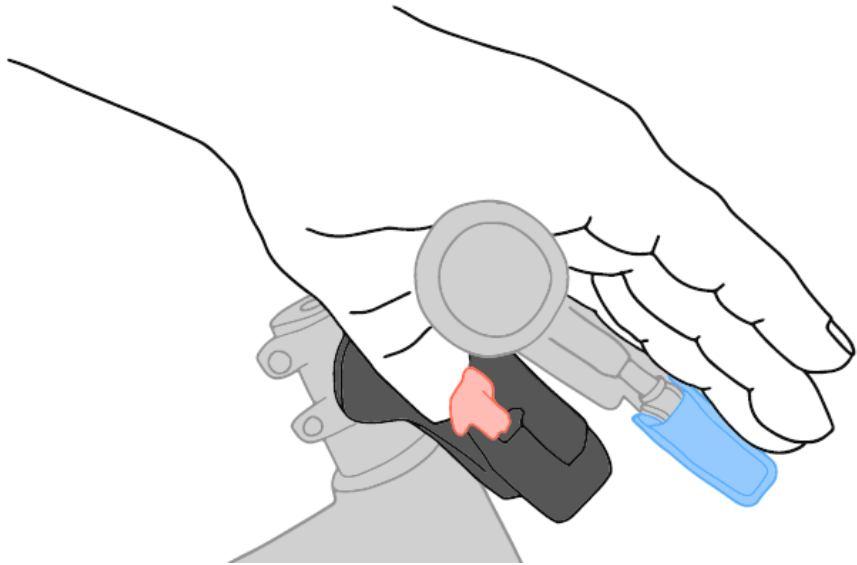
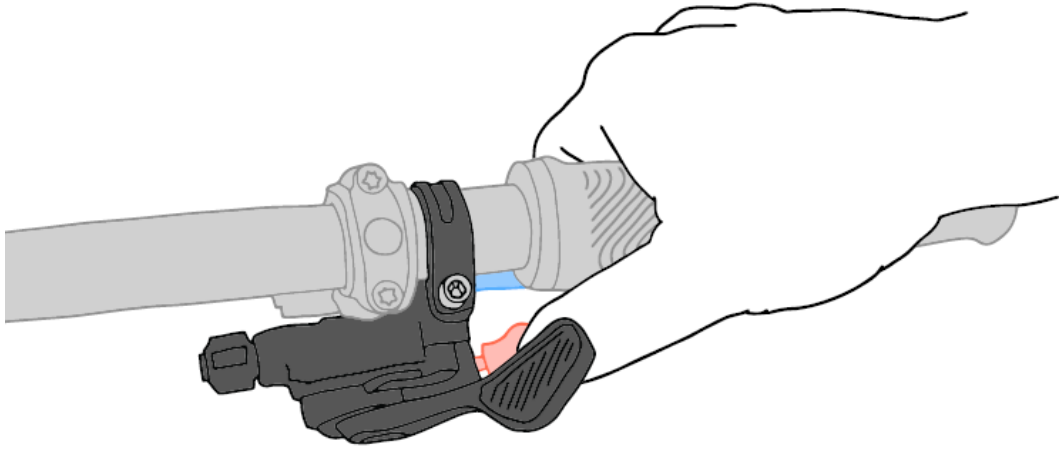

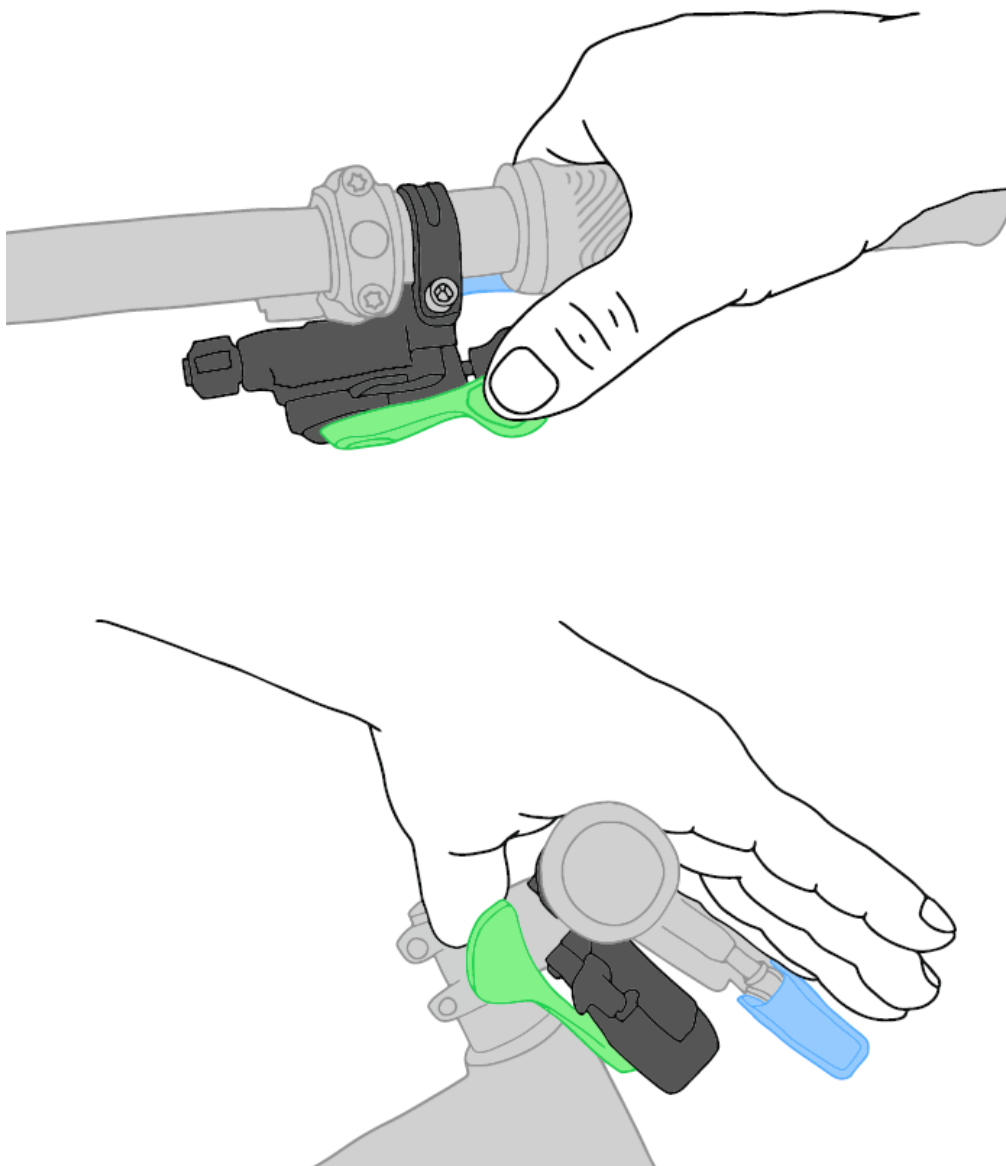

Proper setup of the Trail Trigger shifter is very individual. These instructions will give you a good starting point, but you may need to fine-tune the position after actual riding.

Horizontal Positioning

To position the shifter horizontally, move the shifter left and right along the handlebar. You can place the shifter on the inside or the outside of the brake lever. Repeat the adjustment until the setup is comfortable (Step 2).

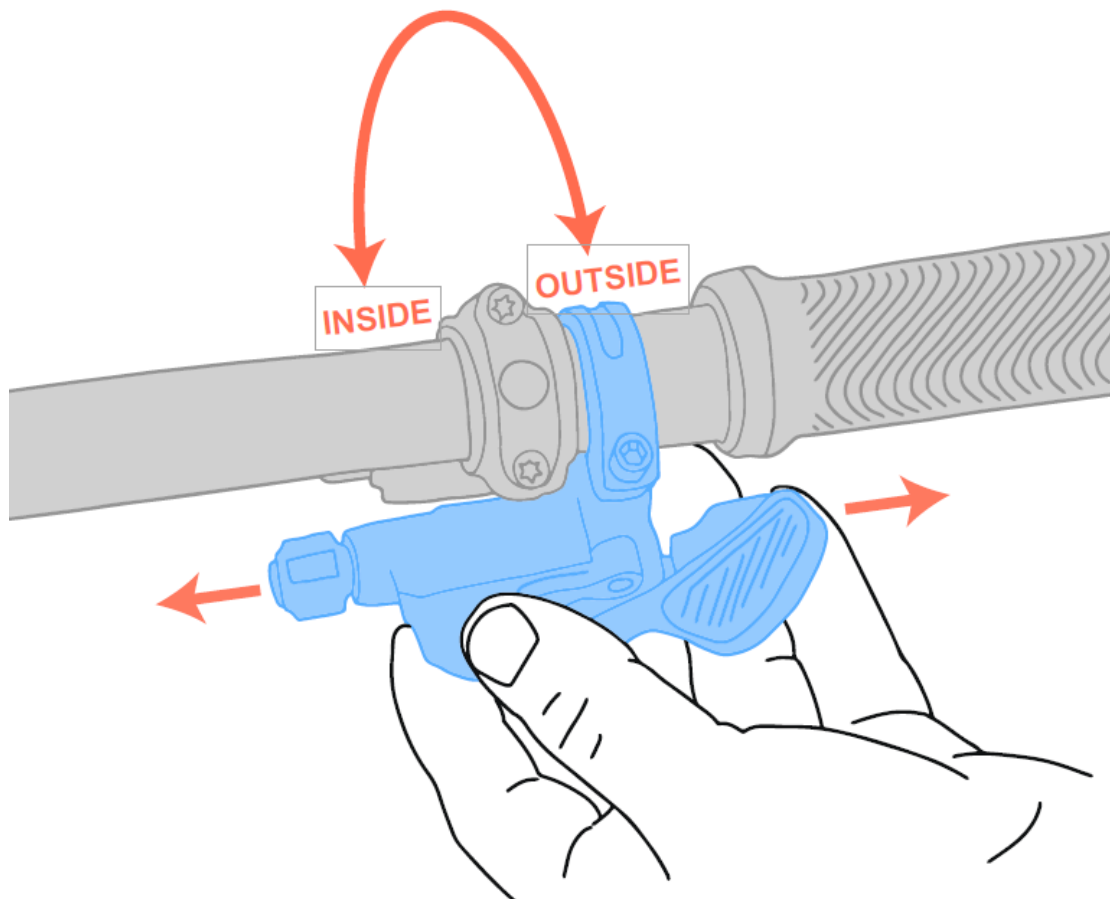

Rotational Positioning

Rotate the shifter around the handlebar. A good starting point is to rotate until the upper shift lever is 0-30 degrees from vertical. Repeat the adjustment until the setup is comfortable (Step 2).

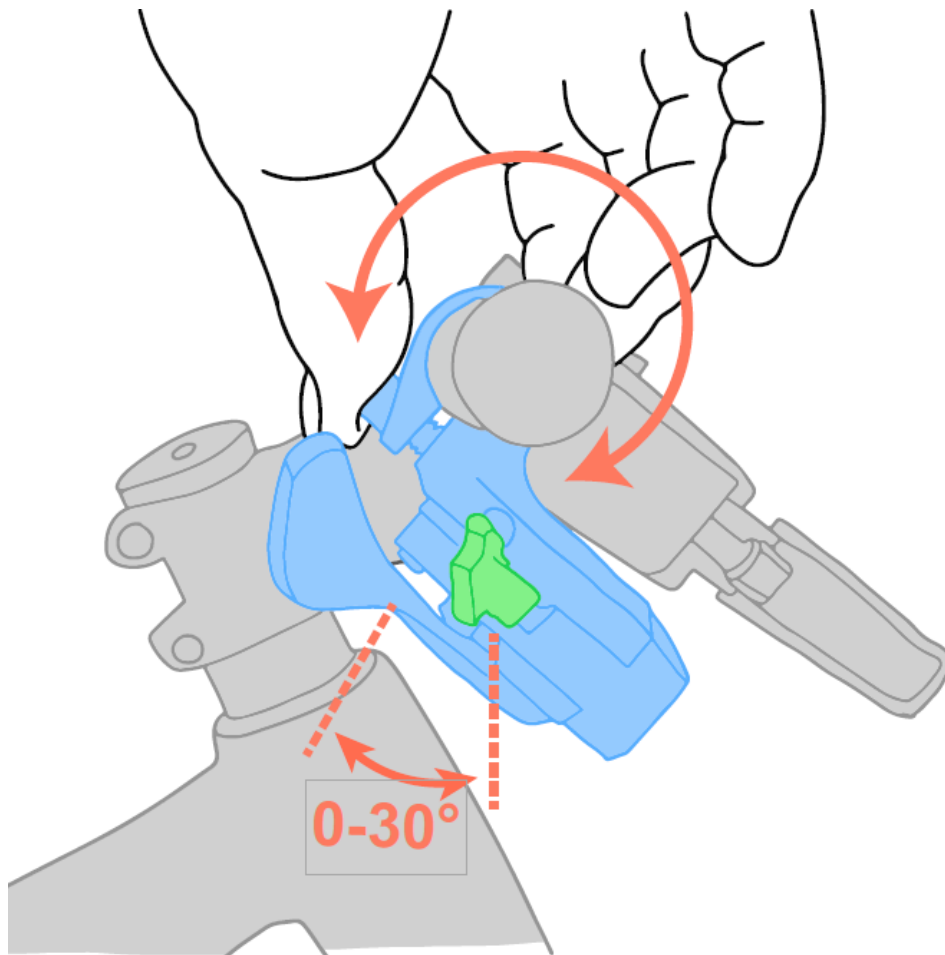

Tightening the Shifter

Tighten the clamp bolt to 5 Nm using a 4mm hex wrench.

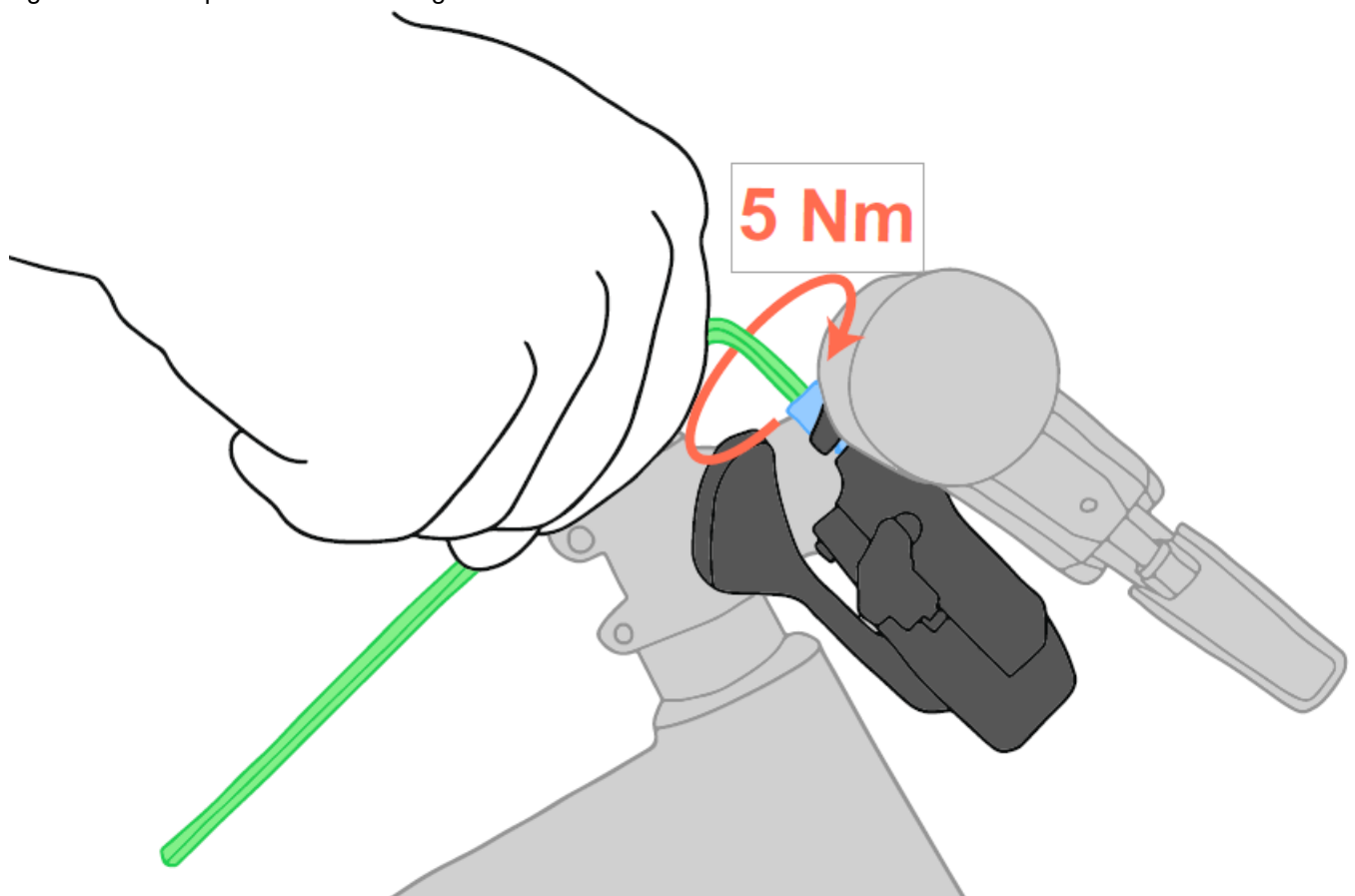

Cable Routing

Before routing the cable, press the upper shift lever to shift all the way to the highest gear. Remove the cable cap.

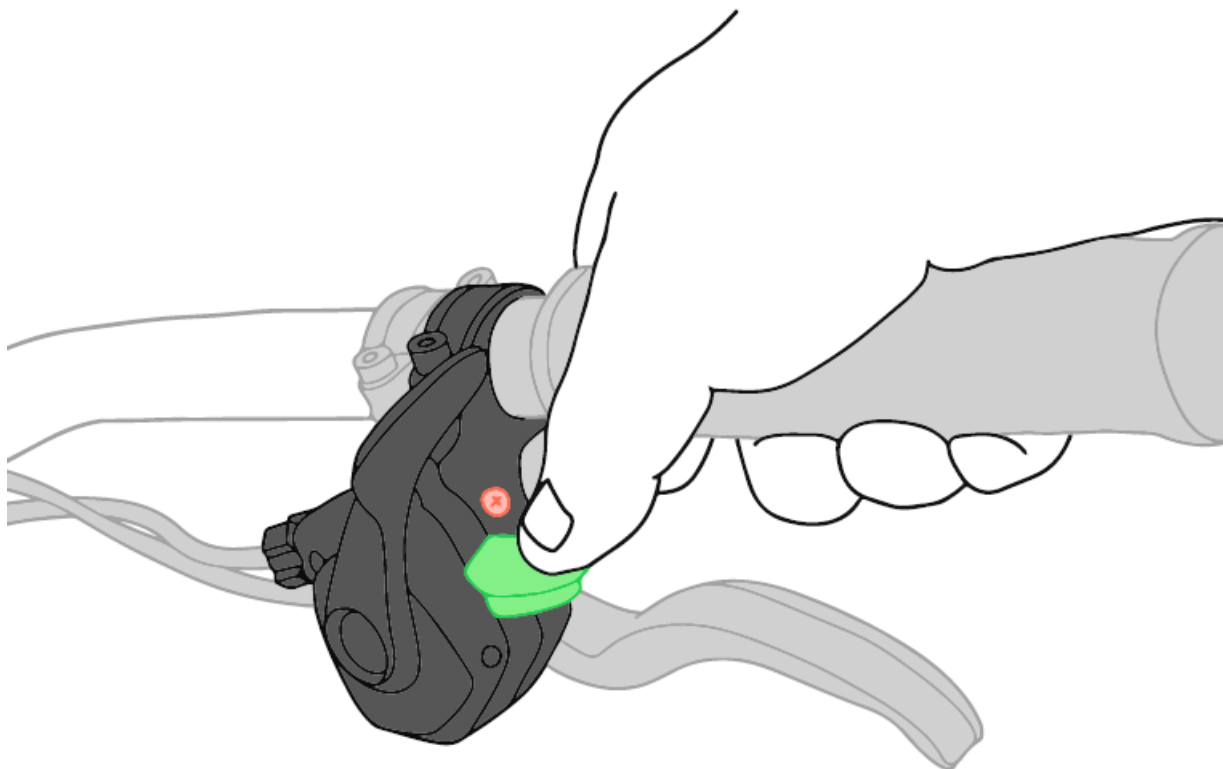

Proper Housing Length

For best shifting performance, avoid sharp bends in the housing and make sure the housing is long enough to freely rotate the handlebar back and forth.

For detailed instructions on cable routing, consult instructions from your frame manufacturer.

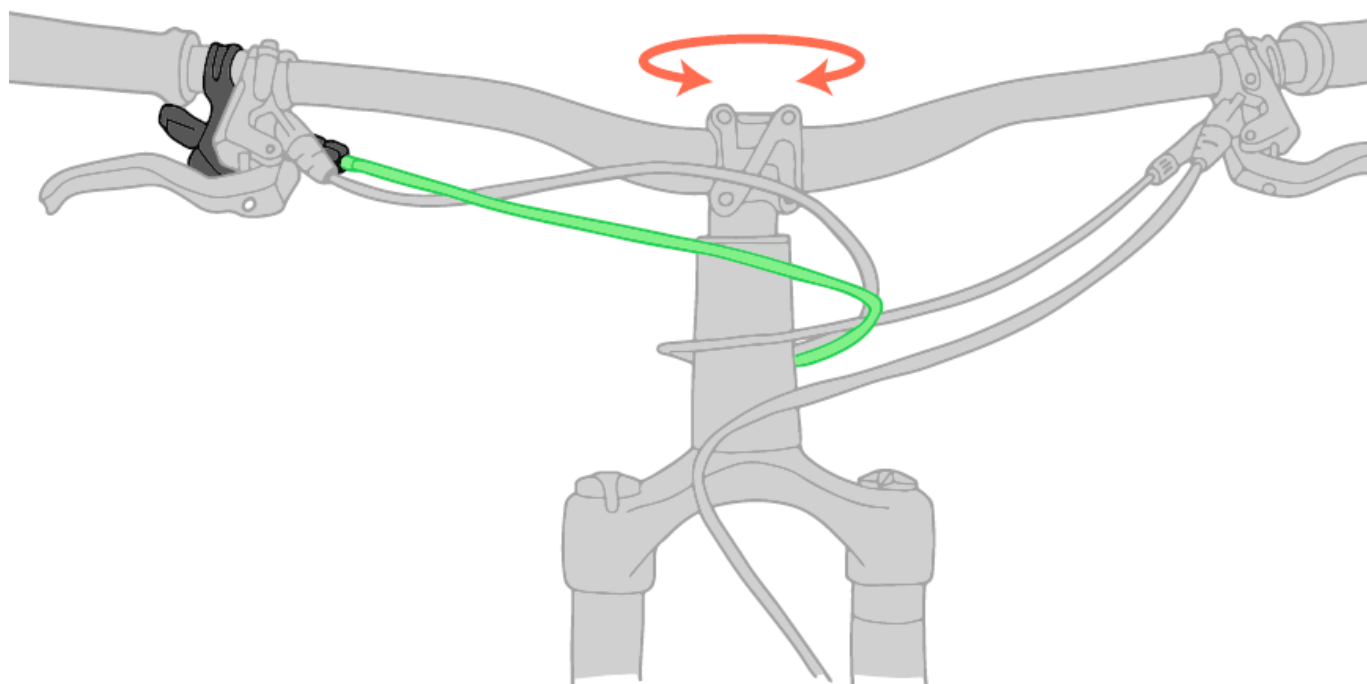

	<p>microSHIFT SH003-002 Trail Trigger Shifter [pdf] User Manual SH003-002 Trail Trigger Shifter, SH003-002, Trail Trigger Shifter</p>
---	---