



## microSHIFT SB006-001 Sword Drop Bar Shifter Installation Guide

[Home](#) » [microSHIFT](#) » microSHIFT SB006-001 Sword Drop Bar Shifter Installation Guide 

# microSHIFT

Sword Drop Bar Shifter  
Installation and Adjustment



© 2023 microSHIFT | AD-II Engineering Inc.  
SB006-001  
[www.microSHIFT.com](http://www.microSHIFT.com)

## Contents

- 1 Important Notice
- 2 Tools and Supplies
- 3 Shift Lever Attachment
- 4 Fold the hood towards the brake lever and unthread the attachment bolt a few turns with a 5mm hex wrench. Set Your Height
- 5 Set Your Angle
- 6 Cable Installation
- 7 Brake Cable Installation
- 8 Optional Reach Adjustment
- 9 Large Shift Paddle Adjustment
- 10 Documents / Resources
  - 10.1 References
- 11 Related Posts

## Important Notice



### REMINDER

Before installing the products, please read and understand the installation procedures. Improper installation can lead to premature product failures or even injuries. If you have any questions on how to install, please contact us or consult with a professional bicycle mechanic.

## Tools and Supplies

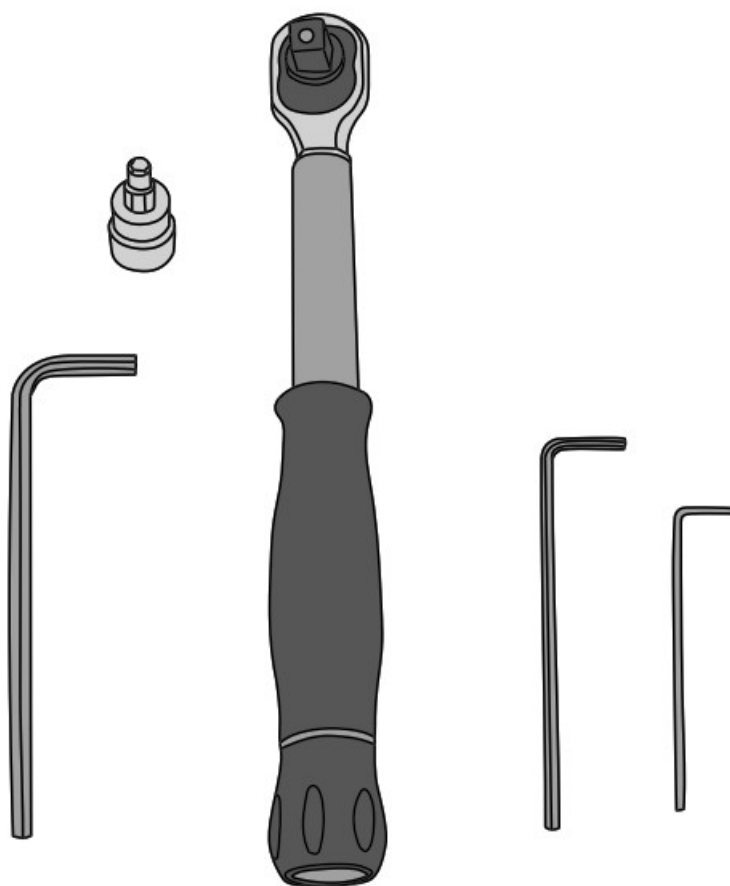

- |   |  |
|---|--|
| 1. Torque Wrench<br>2. 5mm Hex Bit<br>3. 5mm Hex Wrench | 4. 3mm Hex Wrench<br>5. 1.5mm Hex Wrench |
|---|--|



## Shift Lever Attachment

**Fold the hood towards the brake lever and unthread the attachment bolt a few turns with a 5mm hex wrench.**

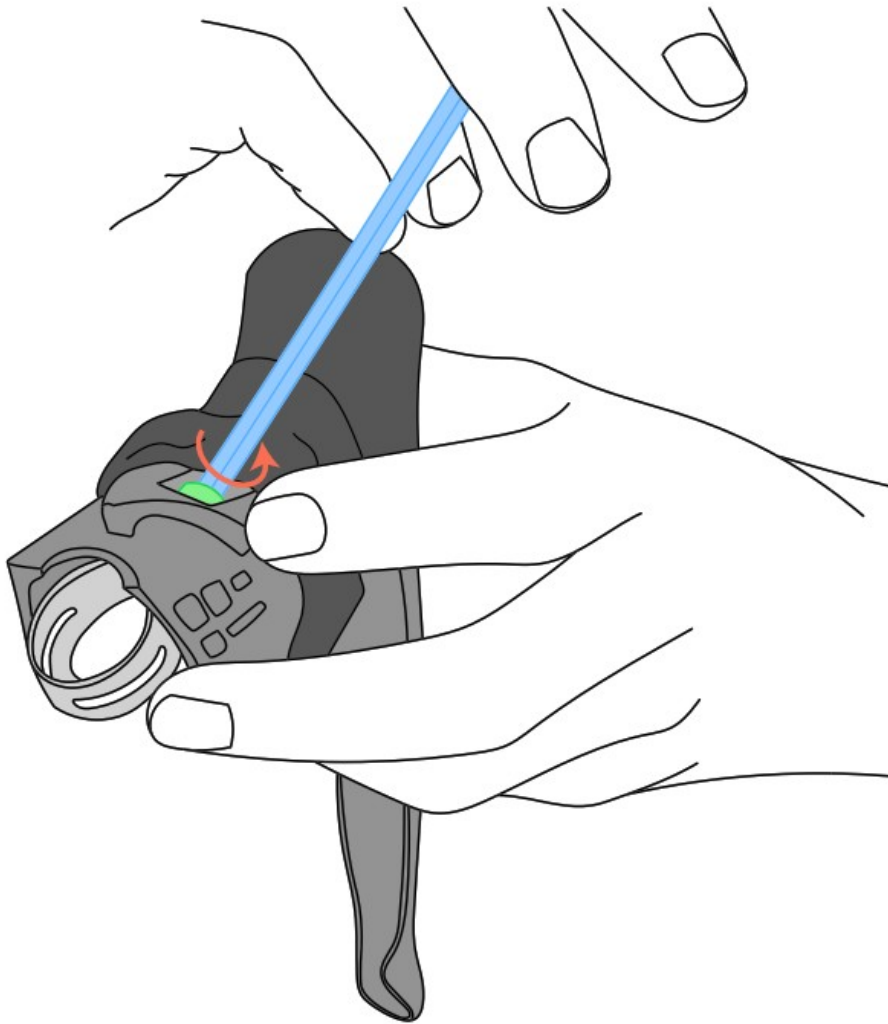

### **Set Your Height**

Position each lever on the handlebar in a location that will be comfortably accessible while riding. A good starting point is to use a straight edge that extends from the lower edge of the drops. Line up the bottom of the brake blade with the flat edge.

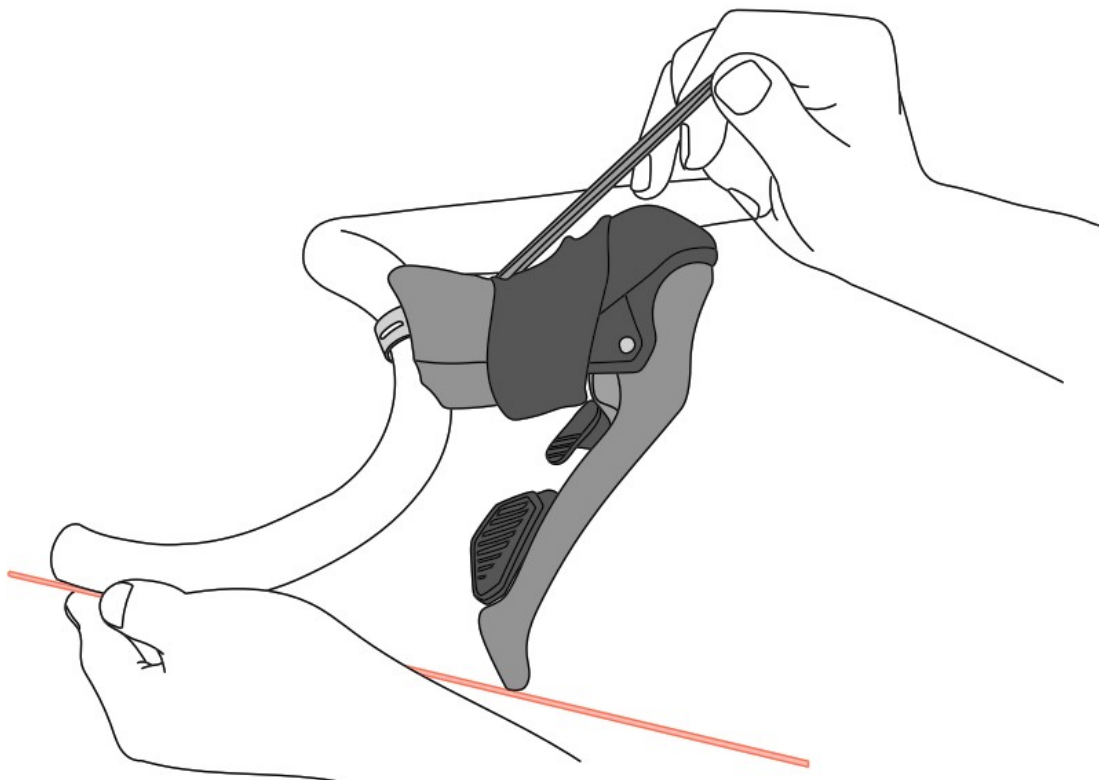

## Set Your Angle

There is a small window of lateral adjustment, but generally the shifters are designed to work best when mounted in line with flare of the handlebar.

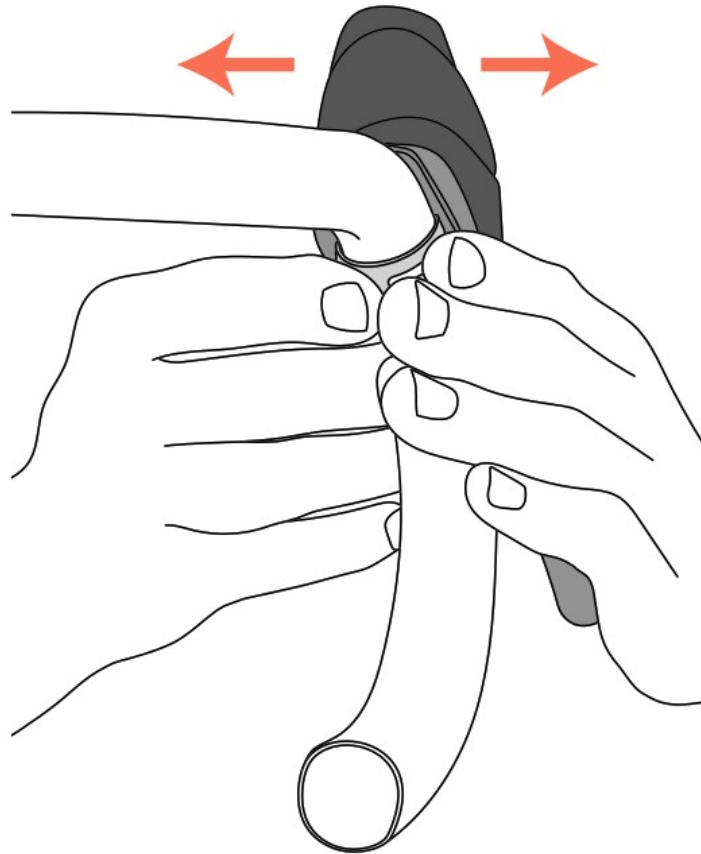

Torque the band clamp to 8Nm and roll the hood back into place.

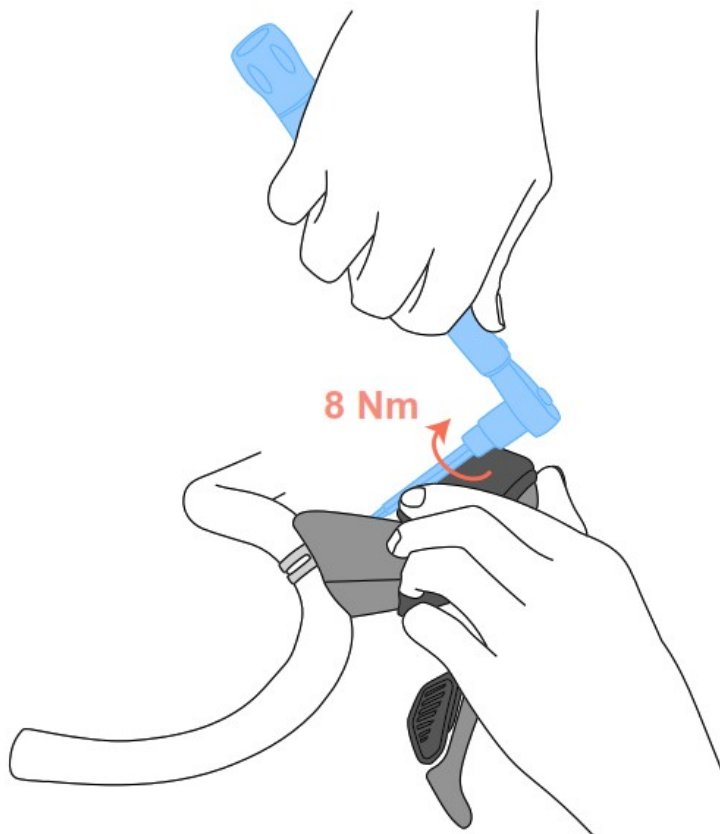

## Cable Installation

The SWORD drop bar shifters come with shift cables and a brake cables.

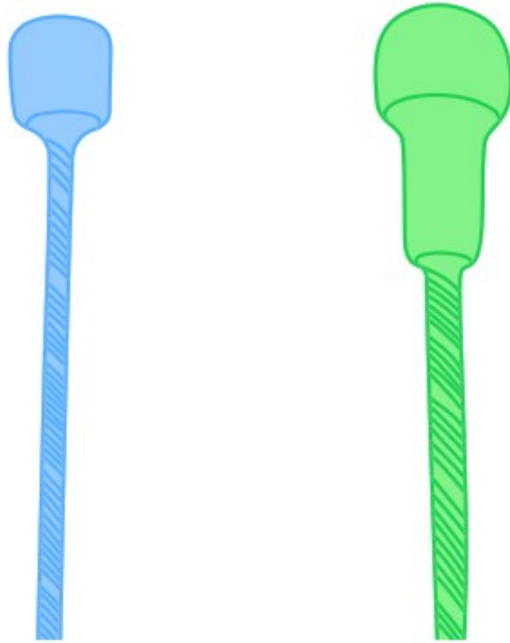

Put the shifter in the high gear/small cog position by pressing the smaller shift lever until it stops indexing.

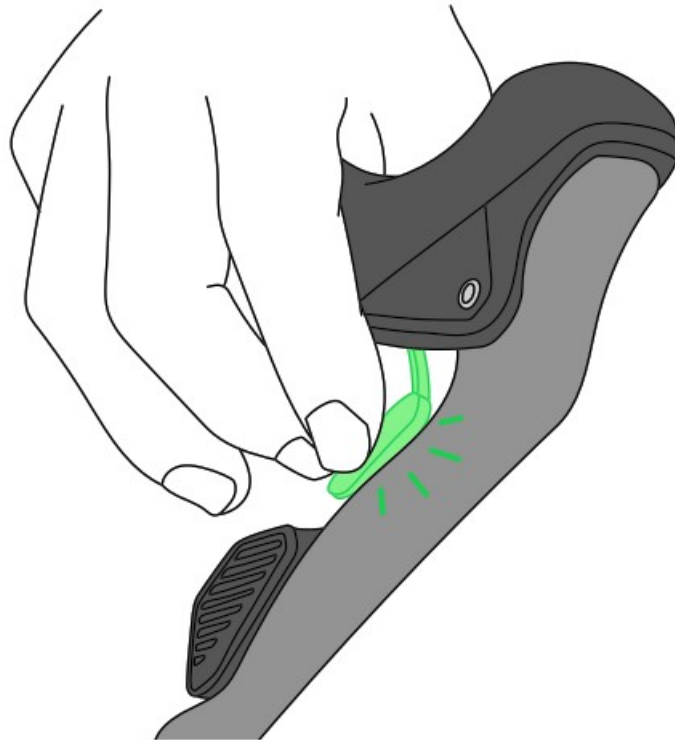

Roll the hood on the shifter towards the brake lever.

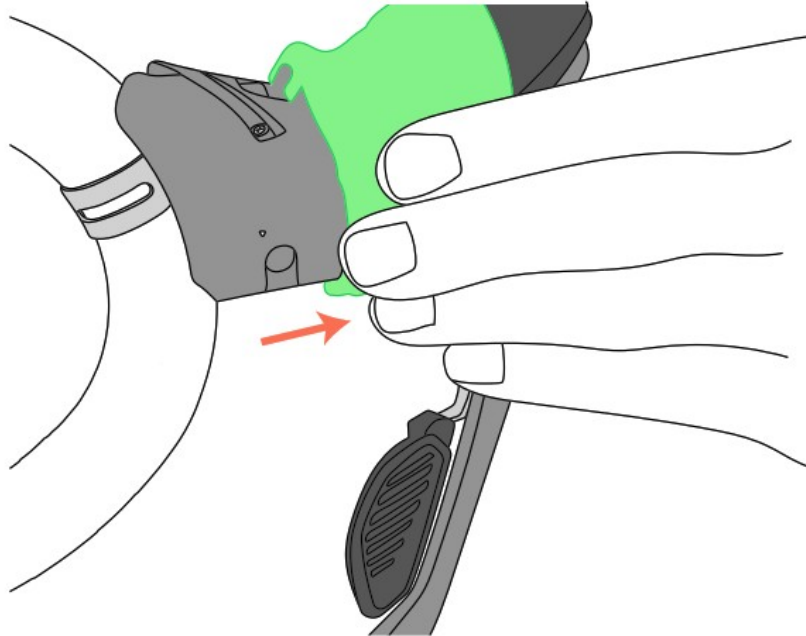

Route the cable through the cable port on the lever body and out through the top of the shifter. Pull tight to make sure the cable head is fully seated in the shifter.

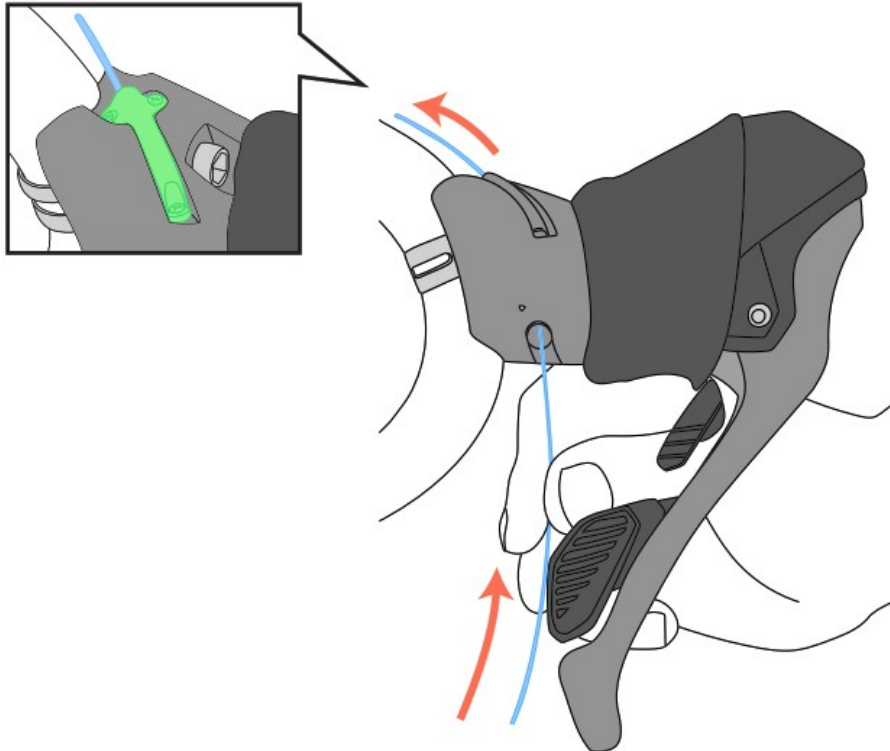

Install a housing cap on the end of your shift housing. Slide the housing around the cable and seat the cap in the housing stop on top of the shifter. Follow your frame manufacturer's guidelines for proper shift cable routing.

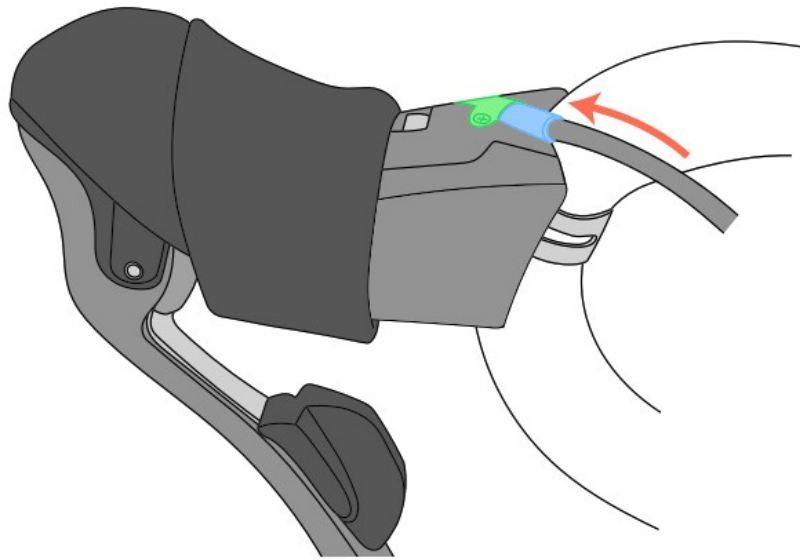

## Brake Cable Installation

Push the brake lever toward the handlebar.

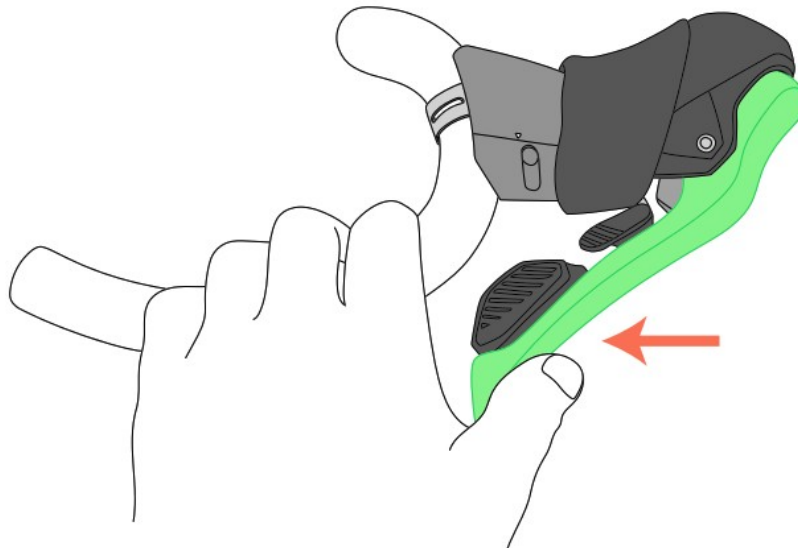

Pass the brake cable through the cable head seat inside the lever body and make sure the head of the cable fully seats in the lever body.



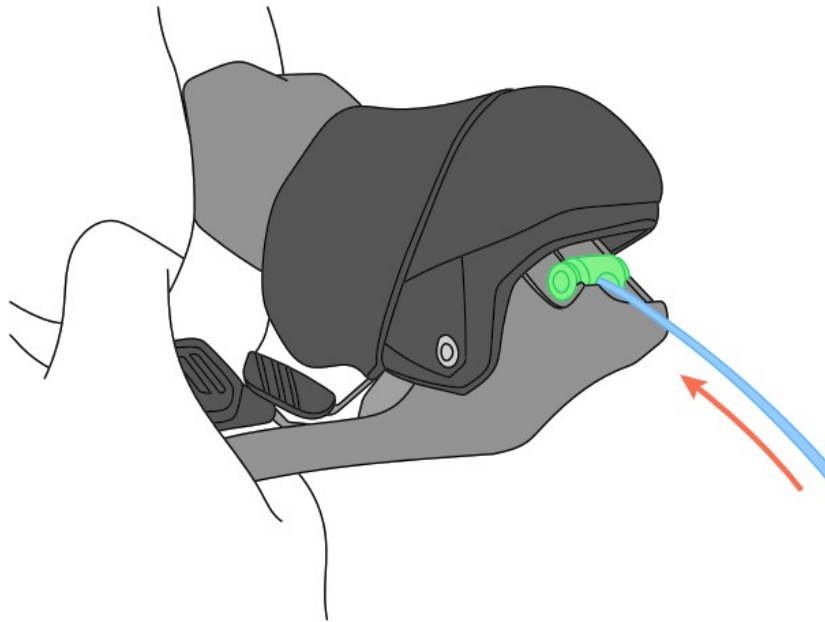

Seat the cable housing in the back side of the lever body.  
Do not use a housing cap between the brake housing and housing stop.  
Follow your frame and brake manufacturer's guidelines for proper cable routing and brake setup.

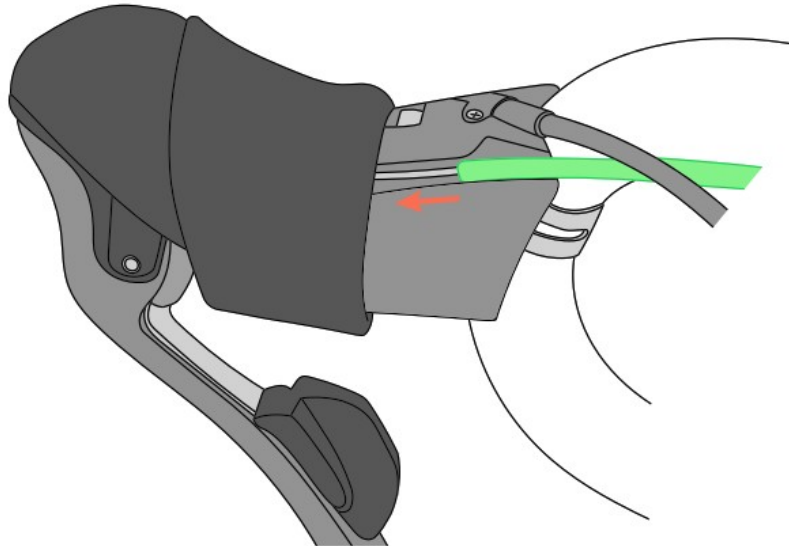

### **Optional Reach Adjustment**

To adjust the reach on the SWORD drop bar levers, peel back the hood from the top of the lever body. Use a 3mm hex wrench to adjust the reach.

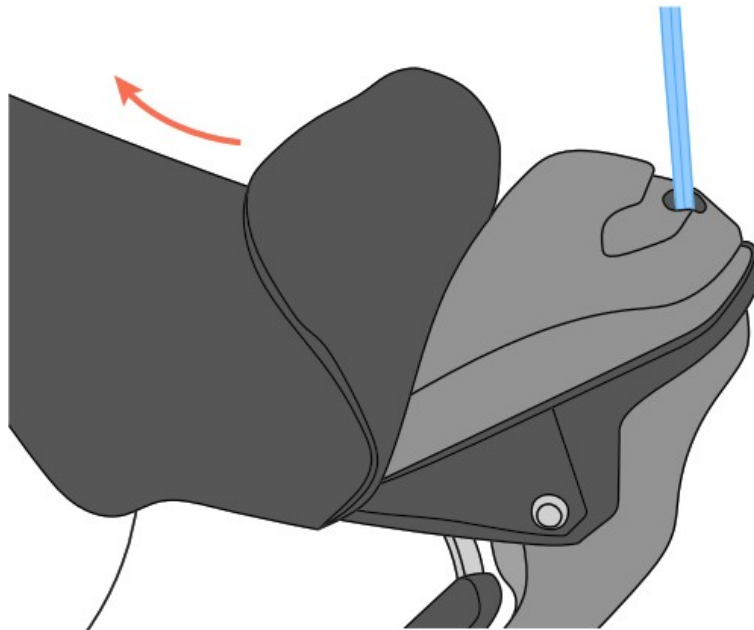

A clockwise adjustment move the lever towards the handlebar.  
And counterclockwise adjustment moves the lever away from the handlebar.

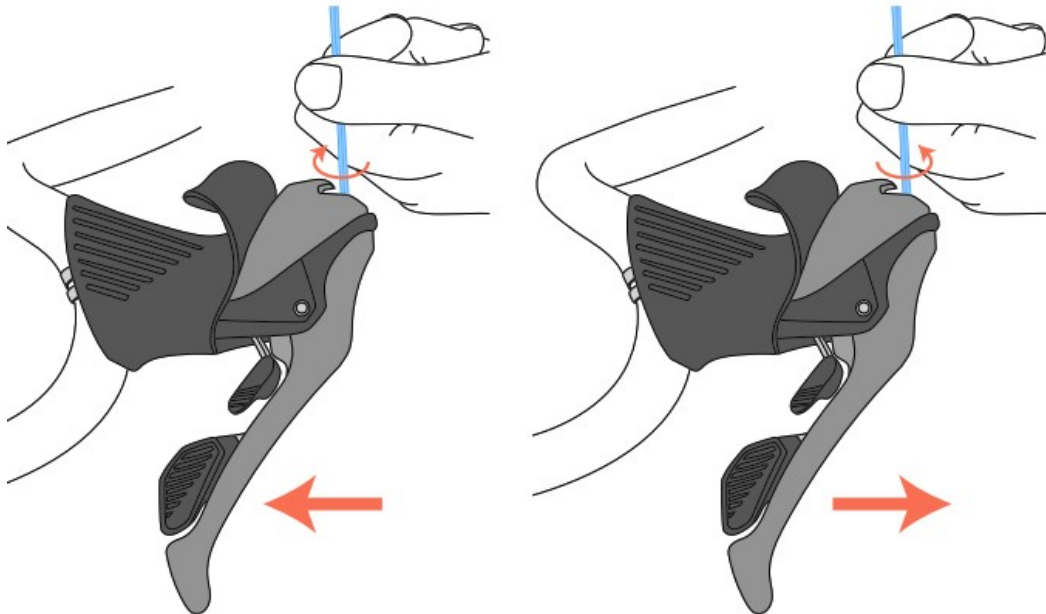

## Large Shift Paddle Adjustment

The reach of the large shift lever can be adjusted between the brake lever and the small shift lever. If the brake lever reach is adjusted, it is important to also adjust the large shift paddle reach. Overadjustment of the large shift lever can cause interference with the small brake lever or small shift lever.

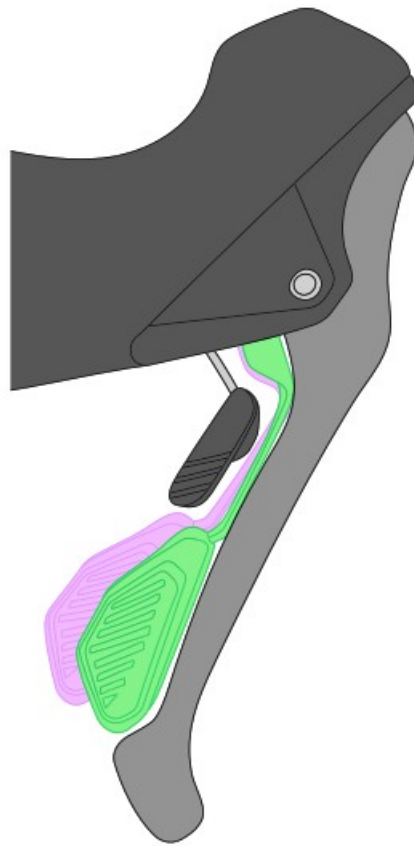

Move the small paddle out of the way and use a 1.5mm hex wrench to adjust the movement of the larger shift paddle.

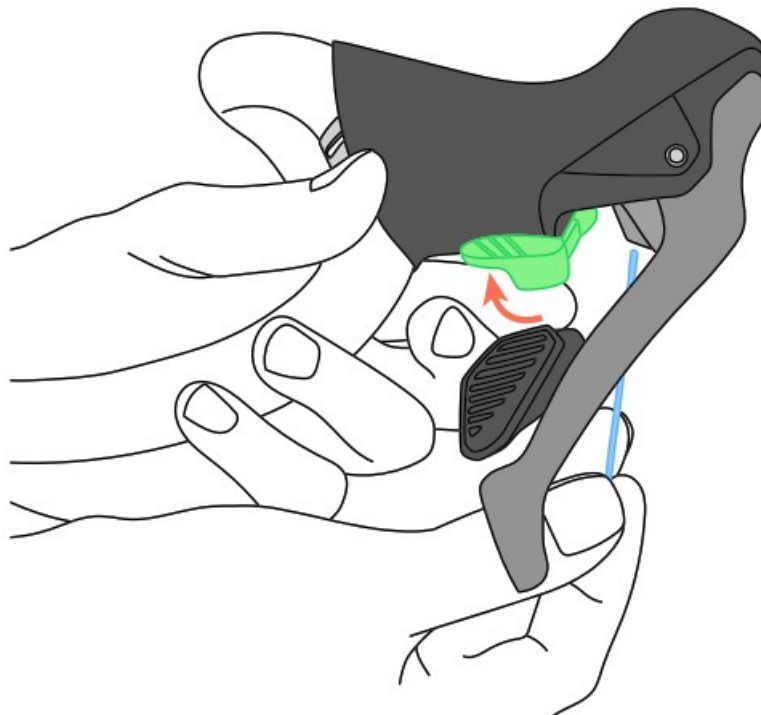

A clockwise adjustment moves the large paddle towards the handlebar and a counterclockwise adjustment moves the paddle away.

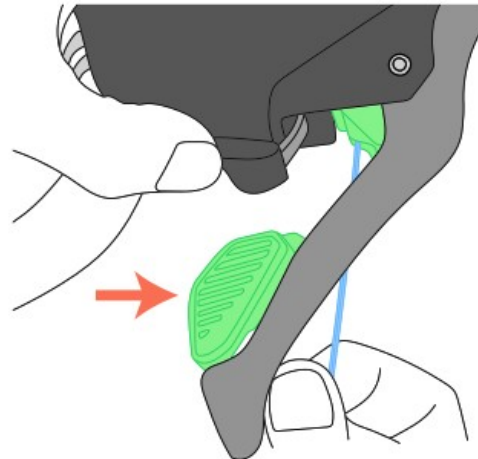
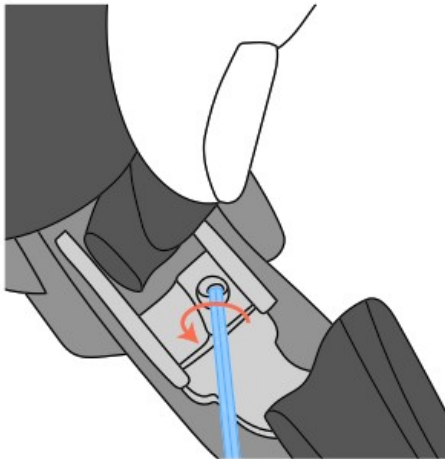
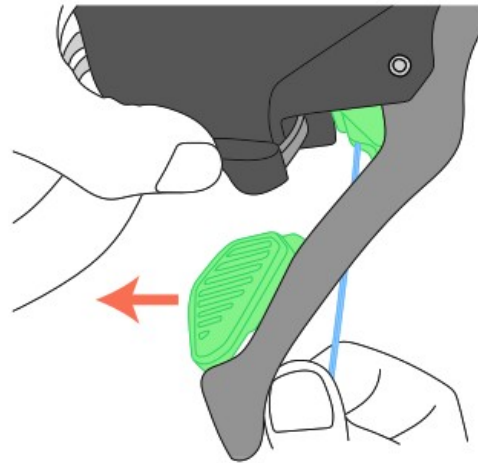
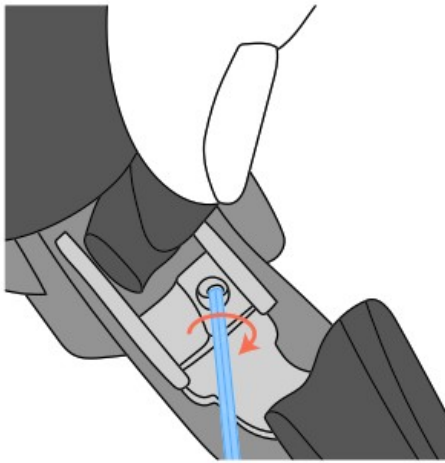

# microSHIFT

[www.microSHIFT.com](http://www.microSHIFT.com)

## Documents / Resources

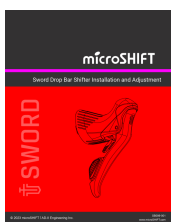

[microSHIFT SB006-001 Sword Drop Bar Shifter](#) [pdf] Installation Guide  
2x10, VerSH006001, SB006-001, Sword Drop Bar Shifter, SB006-001 Sword Drop Bar Shifter, Drop Bar Shifter, Bar Shifter, Shifter

## References

-  [microSHIFT](http://www.microSHIFT.com)