

**MICRO SWISS M3105
FlowTech Hotend**



MICRO SWISS M3105 FlowTech Hotend Installation Guide

[Home](#) » [MICRO SWISS](#) » MICRO SWISS M3105 FlowTech Hotend Installation Guide 

Contents

- [1 MICRO SWISS M3105 FlowTech Hotend](#)
- [2 Specifications](#)
- [3 Tools Required](#)
- [4 What's in the box](#)
- [5 INSTALLATION INSTRUCTION](#)
- [6 SAFETY / PREPARATION](#)
- [7 FAQs](#)
- [8 Documents / Resources](#)
 - [8.1 References](#)
- [9 Related Posts](#)



MICRO SWISS M3105 FlowTech Hotend



Specifications

- **SKU:** M3105
- **Product:** Micro Swiss FlowTech™ Hotend
- **Compatible with:** Creality Ender 3 V3 SE
- **Nozzle Size:** 0.4mm

Tools Required

- 1.5mm Allen wrench
- 2.0mm Allen wrench
- 7mm wrench
- Fine Phillips screwdriver

What's in the box

- Heater Core
- 0.4mm Nozzle
- Silicone Sock
- Crape honing Sprew 2X)
- Fan Duct
- Probe Spacer

- M3 x 12mm screws (2x)

INSTALLATION INSTRUCTION

STEP 1



SAFETY / PREPARATION

- Unload the filament from the printer.
- Allow the hotend to cool down to room temperature.
- Power off the printer.
- Disconnect the power cable.

STEP 2



REMOVE THE FAN SHROUD

- Remove the three screws securing the fan shroud.(2.0mm Allen wrench)
- Pull the fan shroud off of the print head.
- Disconnect the part cooling fan cable from the breakout board.

STEP 3

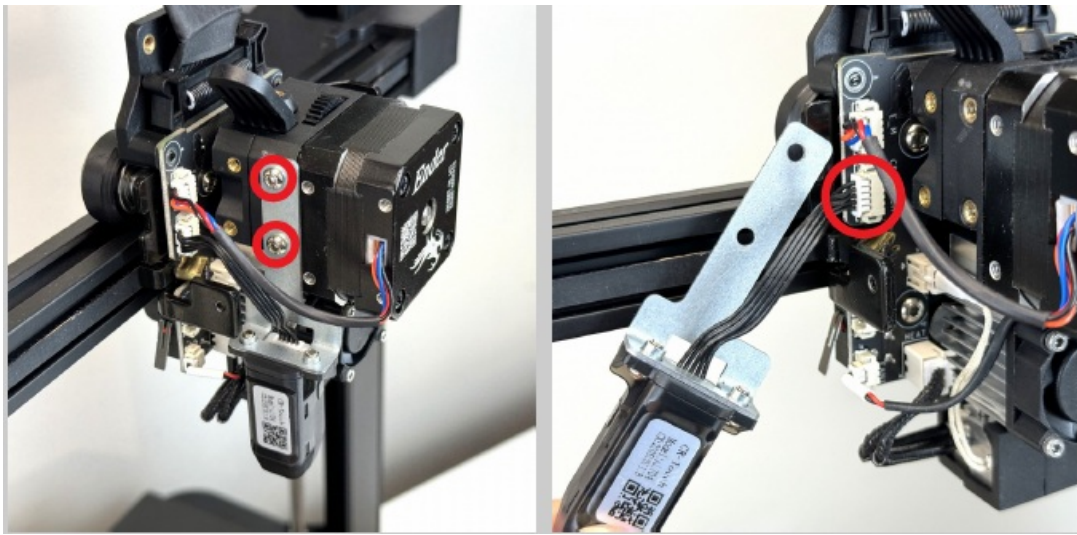

REMOVE THE PROBE BRACKET

- Remove the two M3 screws securing the metal probe bracket to the carriage.(2.0mm Allen wrench)
- Disconnect the probe's ribbon cable from the breakout board.

STEP 4



REMOVE THE ORIGINAL HOTEND

- Remove the two screws securing the heater block.(1.5mm Allen wrench)
- Loosen the set screw located on the rear side of the cooling block. (2.0mm Allen wrench)
- Disconnect the heater and thermistor cables from the breakout board.

STEP 5

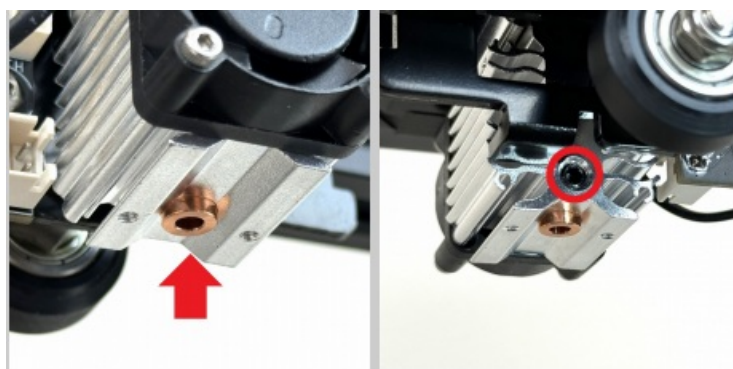

INSTALL THE COPPER THERMAL ADAPTER

- Insert the copper thermal adapter into the cooling block. Ensure that the larger hole is at the bottom.
- Tighten the set screw located on the rear side of the cooling block while pressing the copper thermal adapter up. (2.0mm Allen wrench)

STEP 6

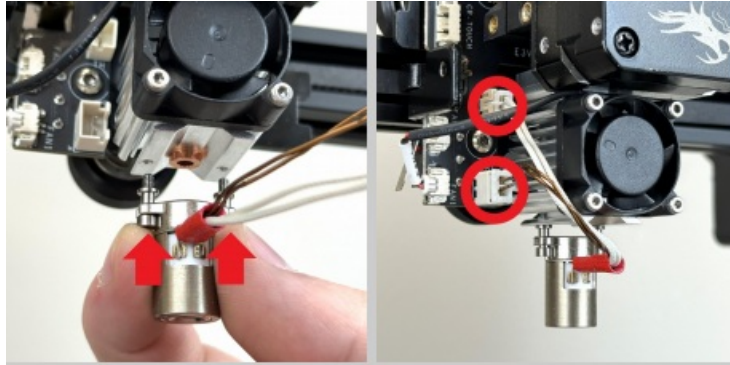

INSTALL THE HEATER CORE

- Attach the heater core to the cooling block using the two provided titanium mounting screws, ensuring the cables extend towards the front of the 3D printer. (1.5mm Allen wrench)
The heater core will still be free to wobble around even after tightening the two screws.
- Connect the heater and thermistor cables to the matching ports on the breakout board.

STEP 7

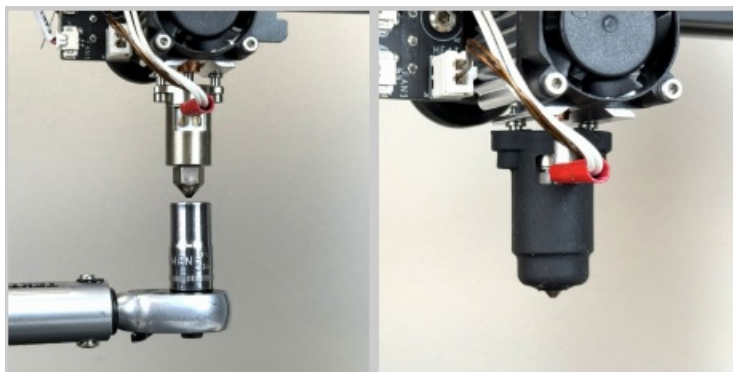

INSTALL THE NOZZLE AND SILICONE SOCK

- Install and tighten the nozzle until it is snug. (7mm wrench)
Recommended torque: 15 inch-pounds / 1.7 Newton Meters.
There is no need to heat the hotend before tightening the FlowTech nozzle.
- Align the cutout slot in the silicone sock with the heater core cables and push it up until it wraps around the top of the heater core.

STEP 8



INSTALL THE PROBE WITH THE SPACER

- Install the spacer between the CR-Touch and metal bracket using the provided M3 screws. (2.0mm Allen wrench)
- Reattach the metal probe bracket to the print head.(2.0mm Allen wrench)
- Reconnect the probe's ribbon cable to the port on the breakout board.

STEP 9



REPLACE THE FAN DUCT

- Unscrew and remove the original part cooling duct.(Fine Phillips screwdriver)
- Insert and secure the provided part cooling duct to the fan shroud. (Fine Phillips screwdriver)

STEP 10



REINSTALL THE FAN SHROUD

- Reattach the part cooling fan connector to the breakout board.

- Place the fan shroud over the print head.
- Install the three screws to secure the fan shroud.(2.0mm Allen wrench)

STEP 11



CALIBRATE THE PROBE

- Plug the power cable back in.
- Power on the 3D printer.
- Select the “Leveling” menu option.
- Wait for the automatic Z offset calibration to finish.

Installation Complete

FAQs

- **Q: Can this hotend be used with other Creality models?**
 - A: The Micro Swiss FlowTech™ Hotend is specifically designed for use with Creality Ender 3 V3 SE and may not be compatible with other models.
- **Q: What is the recommended nozzle size for this hotend?**
 - A: The hotend comes with a 0.4mm nozzle size, which is ideal for general-purpose 3D printing tasks.

Documents / Resources

	<p>MICRO SWISS M3105 FlowTech Hotend [pdf] Installation Guide M3105 FlowTech Hotend, M3105, FlowTech Hotend, Hotend</p>
--	---

References

- [User Manual](#)

