



MICRO-EPSILON WDS P85 Wire Sensor User Guide

[Home](#) » [MICRO-EPSILON](#) » MICRO-EPSILON WDS P85 Wire Sensor User Guide 

MICRO-EPSILON WDS P85 Wire Sensor User Guide

Montageanleitung
Setup Guide
wireSENSOR WDS P85



Contents

- [1 Warnings](#)
- [2 Proper Environment](#)
- [3 Sensor Mounting](#)
- [4 Installing the Encoder](#)
- [5 Guiding and Attaching the Wire](#)
- [6 Declaration of Incorporation](#)
- [7 Documents / Resources](#)
 - [7.1 References](#)

Warnings

- Do not open the sensor housing.
- Do not pull or loop the measuring wire around unprotected body parts.
- Do not pull out the measuring wire beyond the measuring range listed.
- Do not let the measuring wire snap.
- > Risk of injury
- Do not damage the measuring wire.
- Do not oil or grease the measuring wire.
- Do not kink the measuring wire.
- Do not pull the measuring wire diagonally.
- Do not let the measuring wire drag around objects.
- Attach the measuring wire to the measured object while the wire is retracted.

> Damage to or destruction of the sensor

Proper Environment

- **Protection class:** Depending on encoder
- **Temperature range**
- **Operation:** -20 °C ... +80 °C (-4 ... +176 °F)
- f ■ **Storage:** -40 ... +80 °C (-40 ... +176 °F)
- **Humidity:** 5 ... 95 % RH (non-condensing)
- **Ambient pressure:** Atmospheric pressure
- **Vibration:** According to DIN EN 60068-2-6
- **Mechanical shock:** According to DIN EN 60068-2-27

Sensor Mounting

➡ Use four M6 screws and two slot nuts to mount the sensors.

The slot nuts can be mounted on each sensor side and positioned as desired.

The sensor does not have to be oriented in a special way.

➡ Select the installation position in such a way that damage to or contamination of the measuring wire is avoided.

•
1 If possible, prefer an installation position in which the measuring wire exits downward. This prevents liquids from entering the measuring wire outlet.

•
1 Do not let the measuring wire snap! There is no liability for material defects in case of damage due to snapping.

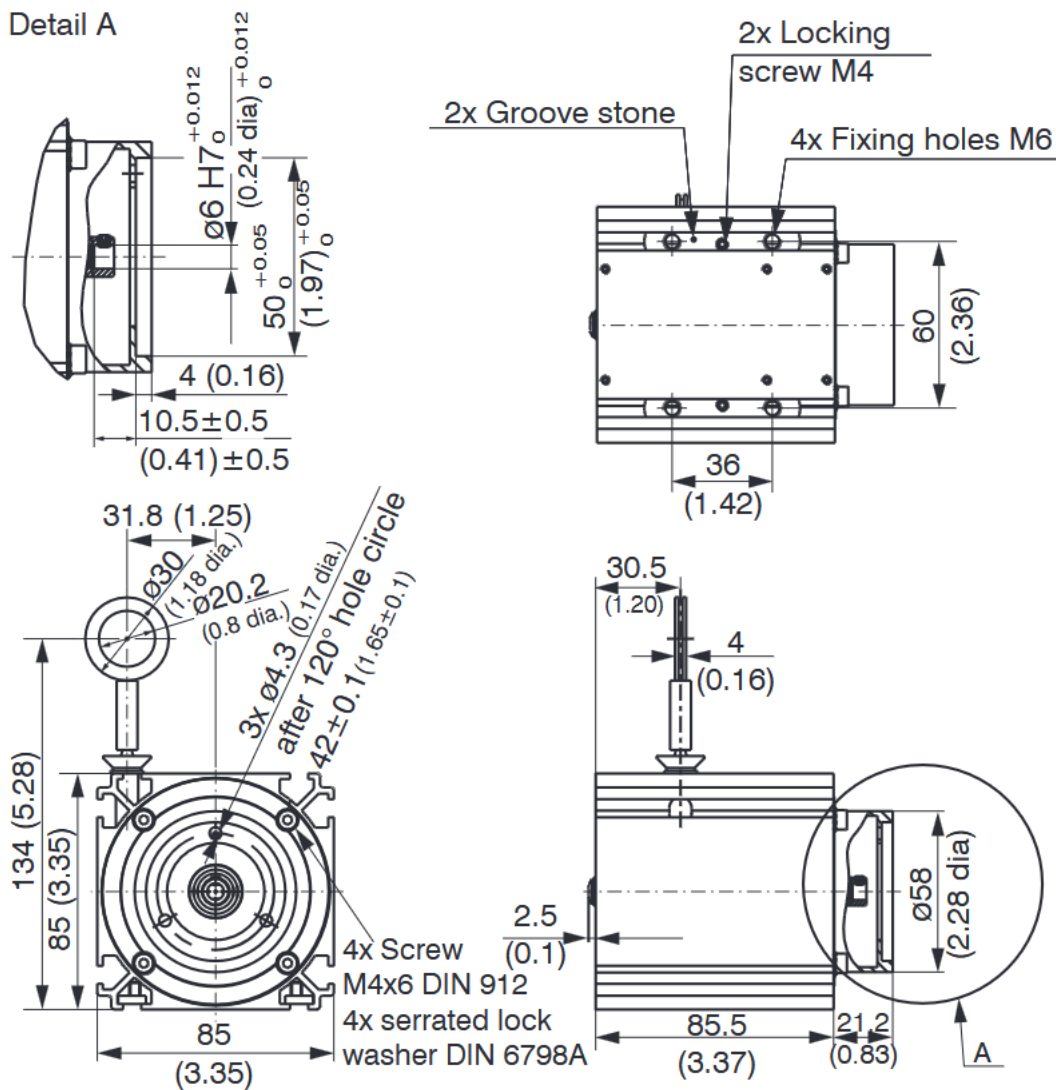

Dimensional drawing wire SENSOR WDS-2500-P85-M, dimensions in mm (inches, rounded off)

Installing the Encoder

- ➡ Fix the coupling half to the encoder shaft. Mount the flange on the encoder (rotary encoder).
- ➡ Mount the encoder/flange assembly on the draw-wire mechanism.

i Make sure that the measuring wire is always tensioned by the spring motor in order to prevent it from jumping off the cable drum.

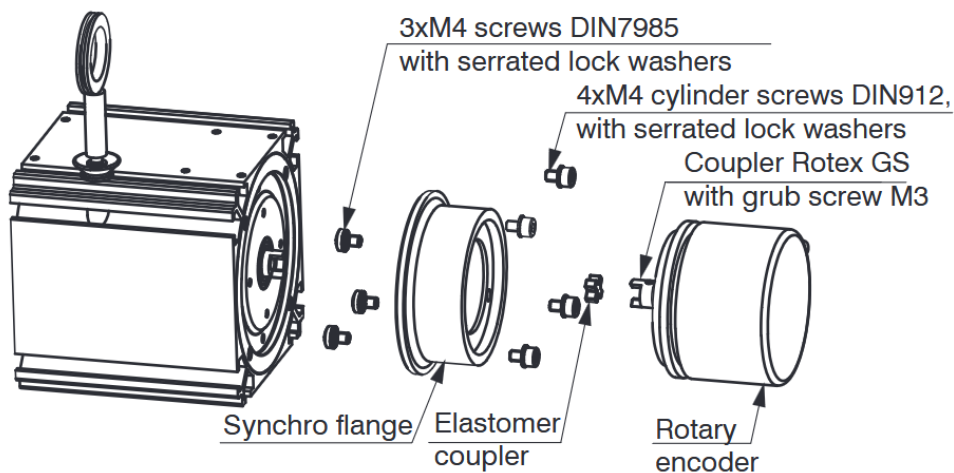

Guiding and Attaching the Wire

If the measuring wire must be pulled out of the sensor to guide the wire or attach it to the measured object:

- the sensor must not be held by a second person during that process,
- the measuring wire must not be pulled out beyond the measuring range listed,
- the area around the sensor must be protected against snapping of the measuring wire.

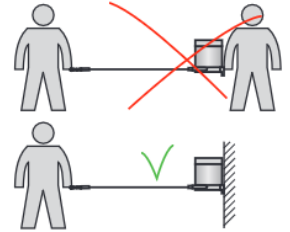

- ➡ Attach the measuring wire to the measured object using an eyelet.
- ➡ Guide the measuring wire vertically out of the sensor housing.

Diagonal pull is only permitted up to 3 degrees.

If you drag the measuring wire over the insertion hole or other objects, the measuring wire will be damaged and/ or tear.

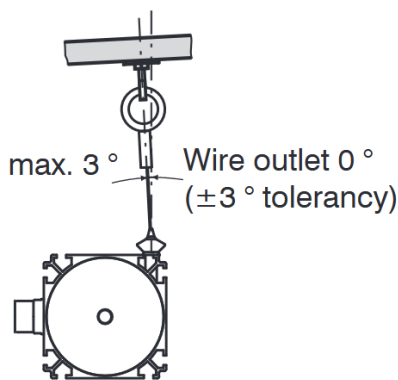

Attachment and maximum diagonal pull of the measuring wire

i If the measuring wire cannot be fed vertically out of the housing, it is essential to use a guide pulley, also see Optional Accessories in the Appendix of the Operating Instructions.

- ➡ Guide the measuring wire in a protected area so that it cannot get caught or otherwise be damaged.

Declaration of Incorporation

Declaration of incorporation according to EC Machinery Directive 2006/42/EC, Annex II B

The manufacturer and person authorized to compile the relevant technical documents

MICRO-EPSILON MESSTECHNIK GmbH & Co. KG
Königbacher Straße 15, 94496 Ortenburg / Germany

hereby declare that the machine designated below complies with the relevant fundamental health and safety requirements of the EC Machinery Directive, including modifications to it applicable at the time of this declaration, based on its design and construction and in the version put on the market by us – to the extent that the scope of supply allows.

Machine design:
Draw-wire sensor
(mechanics and models with potentiometer output)

Type designation: WDS-xxx, WPS-xxx

The following fundamental health and safety requirements according to Annex I of the directive specified above have been applied and complied with:

- No. 1.1.2. Principles of safety integration
- No. 1.7.3. Marking of machinery
- No. 1.7.4. Operating instructions

Furthermore, we declare compliance with the following directives and standards including the modifications applicable at the time this declaration is made:

- Directive 2006/42/EC (machinery)
 - EN ISO 13857:2019 Safety of machinery – Safety distances to prevent hazard zones being reached by upper and lower limbs
 - EN 60204-1:2018 Safety of machinery – Electrical equipment of machines – Part 1: General requirements
- Directive 2011/65/EU (RoHS)
 - EN IEC 63000:2018 Technical documentation for the assessment of electrical and electronic devices with respect to the restriction of hazardous substances

We also declare that the special technical documentation for this partially completed machine has been created in accordance with Annex VII, Part B, and commit ourselves to disclose this to the market surveillance authorities upon request. The commissioning of these partially completed machines is prohibited until the partially completed machine(s) has/have been installed in a machine that meets the requirements of the EC Machinery Directive and for which an EU Declaration of Conformity according to Annex II, Part A exists.

Ortenburg, Germany
July 1, 2021



Dipl.-Ing.(FH) Eduard Huber, MBA
Quality Manager

You can find more information about the sensor in the operating instructions. They are available online at:
<https://www.micro-epsilon.com/download-file/man-wireSENSOR-P85-de-en.pdf>

MICRO-EPSILON MESSTECHNIK GmbH & Co. KG

Koenigbacher Str. 15

94496 Ortenburg / Germany

Tel. +49 8542 / 168-0 / Fax +49 8542 / 168-90

e-mail info@micro-epsilon.com

www.micro-epsilon.com

Your local contact: www.micro-epsilon.com/contact/worldwide/

X977X135-A052114HDR

Documents / Resources



[MICRO-EPSILON WDS P85 Wire Sensor](#) [pdf] User Guide
P85, WDS P85 Wire Sensor, WDS P85, Wire Sensor, Sensor

References

- [!\[\]\(6841ca9b0e023296428e7c9e683b9367_img.jpg\) The leader in outcome-based marketing | Epsilon](#)
- [!\[\]\(e258e347e7683f87061f627f84598eb5_img.jpg\) Home | Micro-Epsilon](#)
- [!\[\]\(1233990ad3f0b7475c568d7bf16af31f_img.jpg\) Worldwide support | Micro-Epsilon](#)
- [!\[\]\(18570b67a4686b081406cd3de636c1c3_img.jpg\) micro-epsilon.com/download-file/man--wireSENSOR-P85--de-en](#)
- [User Manual](#)

Manuals+, Privacy Policy

This website is an independent publication and is neither affiliated with nor endorsed by any of the trademark owners. The "Bluetooth®" word mark and logos are registered trademarks owned by Bluetooth SIG, Inc. The "Wi-Fi®" word mark and logos are registered trademarks owned by the Wi-Fi Alliance. Any use of these marks on this website does not imply any affiliation with or endorsement.