

**MIBOXER®**

**PW2 LED  
Controller**



## MiBoxer PW2 LED Controller Instruction Manual

[Home](#) » [MiBOXER](#) » **MiBoxer PW2 LED Controller Instruction Manual** 

### Contents

- [1 MiBoxer PW2 LED Controller](#)
- [2 Specifications](#)
- [3 FAQ](#)
- [4 Product Features](#)
- [5 Set up output mode](#)
- [6 PUSH Dimming](#)
- [7 2.4G RF Remote control instruction](#)
- [8 Smartphone APP control instruction](#)
- [9 Alexa voice control instruction](#)
- [10 Google Home voice control instruction](#)
- [11 Documents / Resources](#)
  - [11.1 References](#)
- [12 Related Posts](#)

**MiBOXER®**

**MiBoxer PW2 LED Controller**



## Specifications

- Product Name: Subordinate New Brand 2 in 1 LED Controller (WiFi + 2.4G)
- Features: Color temperature adjustable, Dim brightness, 2.4G RF wireless transmission technology, WiFi wireless control, Auto-transming, Device sharing, Tap-to-Run & automaon, Timing seng, Do not disturb mode, Remote control, Biorhythm support, Music rhythm support, Sleep / wake up plan, Scene customization Control Distance: 30m
- Support: Smartphone app control, Third-party voice control, Group control

## FAQ

### Q: How far can the remote control the lights?

















A: The remote control has a distance of up to 30m for controlling the lights.

### Q: Can I link multiple lights to one remote control?

A: Yes, you can link multiple lights to one remote control as long as they are within a 30m distance from each other.

## Product Features

This product uses WiFi + Bluetooth + 2.4G wireless transmission technology, low power consumption, strong antiinterference ability. WiFi + Bluetooth connect network can greatly enhance the connect network experience. When the router is disconnected, Bluetooth can also directly connect and control equipment at close range. After successful network configuration using [Tuya Smart] app to achieve wireless dimming, remote control, group control, scene control, timing control, music movement, biorhythm, sleep plan, wake plan, one key execution, automation, etc. functions. And it supports 2.4G remote control.

	Color temperature adjustable		Remote control Control distance 30m
	Dim brightness		Smartphone app control
	2.4G RF wireless transmission technology		Support third party voice control
	WiFi wireless control support long-range control		Group control
	Auto-transmitting (only for remote control dimming)		Biorhythm
	Device sharing		Support music rhythm
	Tap-to-Run & automation		Sleep / wake up plan
	Timing setting / countdown turn on / off LED light		Support scene customization
	Do not disturb mode		

## Set up output mode

Set up correct output mode based on the feature of lights Setting method: Press “SET” button continuously to switch output mode (attention: it will log out without operation within 3 seconds) Output mode sheet ( confirm output mode based on color of indicator)

Indicator color	Red Light	Green Light
Output	Single Color Mode	Dual White Mode

## PUSH Dimming

### Short press PUSH switch:

Turn ON/OFF light

### Long press PUSH switch:

- Stepless dimming brightness.
- Long press and release your finger, then repeat long pressing to increase or decrease brightness.

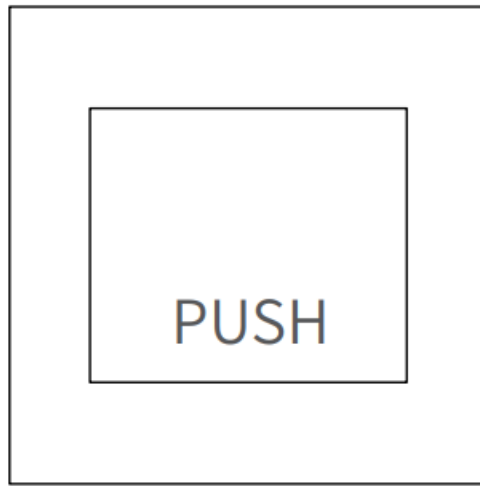

**Compatible with these 2.4G RF remote controls (Purchased separately)**

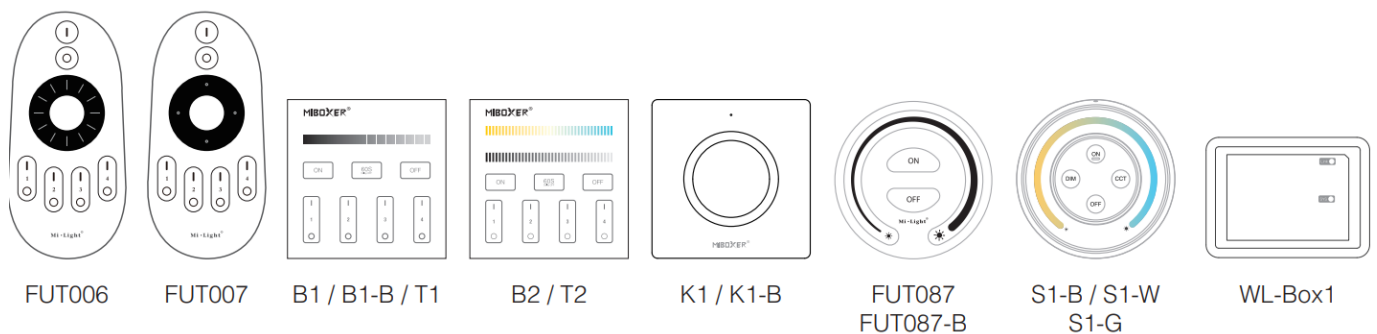

## 2.4G RF Remote control instruction

### 1. Linking Code Instructions

1. Power off 10 seconds and power on again or short press "SET" one time or turn on light via PUSH switch
2. Short press " | " button 3 times within 3 seconds.
3. Lights blink 3 times slowly means linking is done successfully.

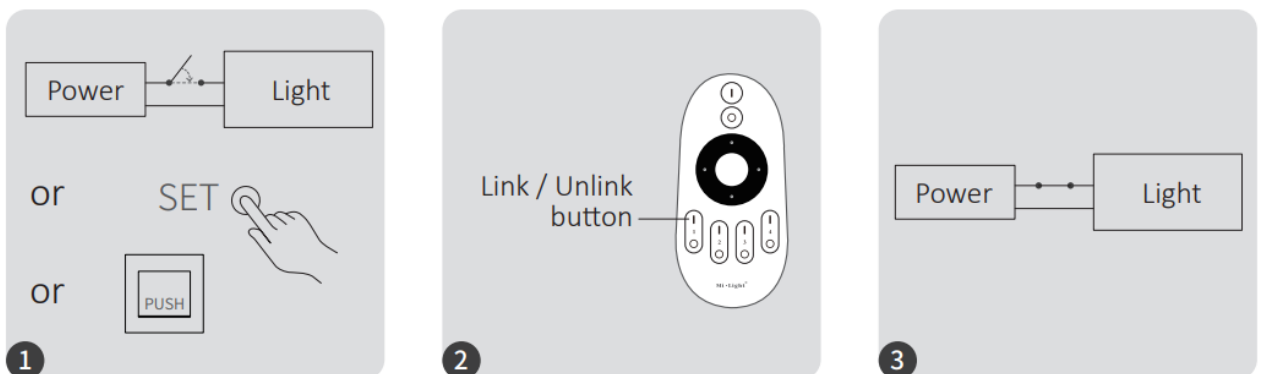

Linking failed if light is not blinking slowly, Please follow above steps again. (Note: Light that have linked can't link again)

### 2. Unlinking Code Instructions

1. Power off 10 seconds and power on again or short press "SET" one time or turn on light via PUSH switch
2. Short press " | " button 3 times within 3 seconds.
3. Lights blink 10 times quickly means unlinking is done successfully.

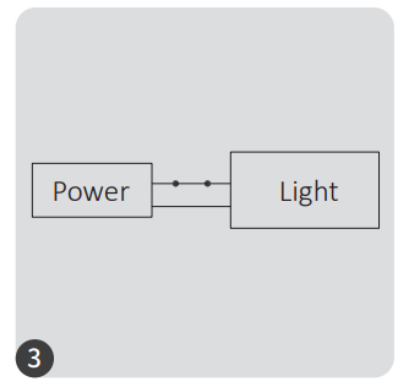
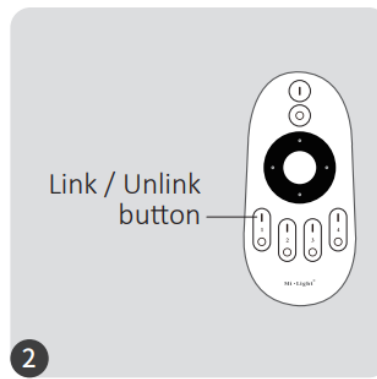
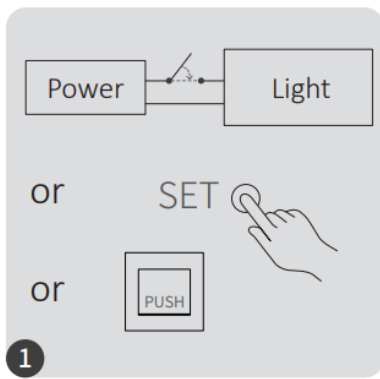

Linking failed if light is not blinking slowly, Please follow above steps again. (Note: Light that have linked can't link again)

### 3. Auto transmitting (2.4G RF remote signal)

The light can transmit remote signal to another light automatically while the distance between lights are 30m, the remote control distance is unlimited.

(Attention: all lights must be linked with same remote)

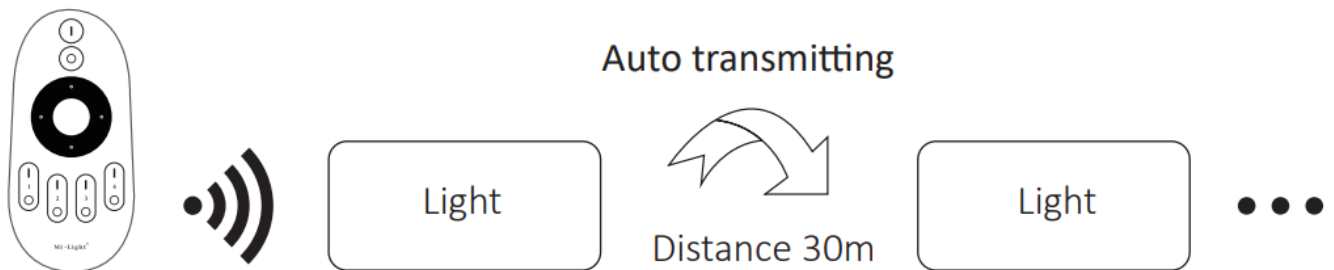

### 4. PWM high frequency / low-frequency switching (only for remote control) Switch to high frequency:

- Press “OFF” button 1 time within three seconds and press “ON” button 5 times,
- Activated successfully once led light flashes 2 times quickly. Switch to low frequency:
- Press “ON” button 1 time within three seconds and press “OFF” button 5 times, Activated successfully once led light flashes 2 times slowly.

### 5. “Do Not Disturb” mode is activated and shut down (default activated) Turn on “Do Not Disturb” mode (wide using in the area which have power failure frequently to save energy)

2.4G RF Remote turn on and turn off instruction Turn on “Do Not Disturb” mode:

Press “OFF” button three times within three seconds and press “ON” button three times, Activated successfully once led light flashes four times quickly.

**Attention:** Do not disturb mode is activated

#### 1. When the light is OFF status (For example: Use app or remote to turn off light)

The light is OFF status once you turn off power and turn on again.

(User must turn off and turn on power twice times to activate light or use APP / remote to activate light)

#### 2. When the light is ON status

- The light is ON status once you turn off and turn on power one time.
- Turn off “Do Not Disturb” mode:
- Press “ON” button three times within three seconds and press “OFF” button three times, closed successfully once led light flashes four times slowly.
- Attention: The light will be always “ON” status if you turn on and turn off power once user closed “Do Not Disturb” mode.

- App turn on and off “Do Not Disturb” mode instruction (check details in page 7)

## Smartphone APP control instruction

Network Configuration (Don't support 5G router)

### 1. Download and install [Tuya Smart] app

Search for [Tuya Smart] in Apple or Google store or scan following QR code to download and install the app. Please open the app click " Register " button to create account while using it in the first time, Log in directly if you already had account.



### 2. Network Configuration

1. Connect controller with power supply.
2. Confirm indicator light is flashing quickly (2 flashes per second),  
If indicator light isn't in fast flashing state, there are two ways to enter:  
Long press " SET" key until indicator light flashing quickly.  
Power off and on controller 3 times.
3. Connect phone with home WiFi network in the 2.4GHz frequency.
4. Open homepage of app and click " + " button at the upper right corner of page.
5. Click " Lighting" on the left side of page and then click " Light Source (BLE+Wi-Fi) "
6. Follow app prompts to complete configuration.

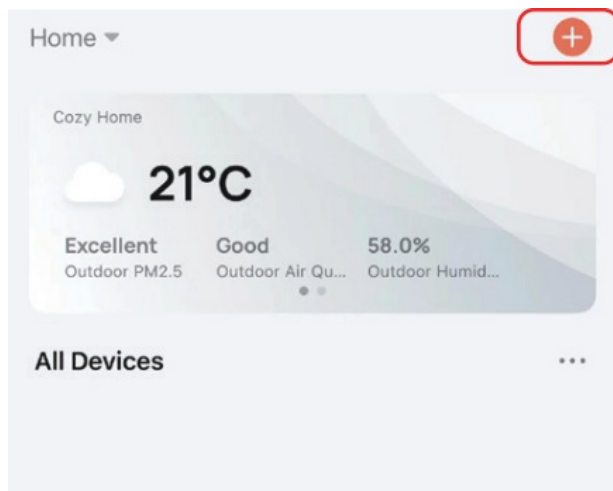

### App turn on and off “Do Not Disturb” mode (default activated)

Click the light which need to be set up or group control — click “More” — click “Power-on behavior” — turn on or off

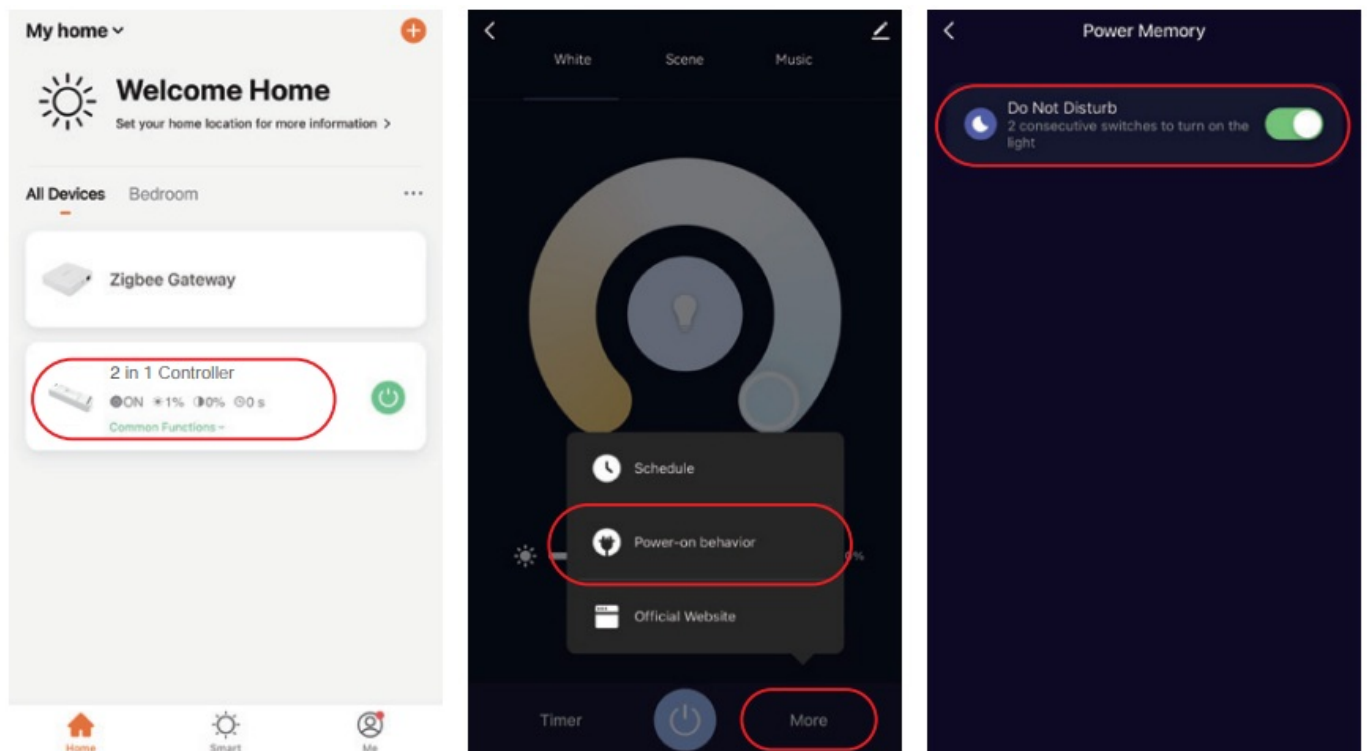

## Alexa voice control instruction

Please add device into [Tuya Smart] app (check details in page 6), then start following steps

1. Open Alexa App
2. Click “More” on the bottom of right corner
3. Click “Skills & Games”
4. Click “🔍” on the top of right corner
5. Type into “Smart life” and search
6. Click “Smart Life” skill, follow instruction to finish configuration and start voice control

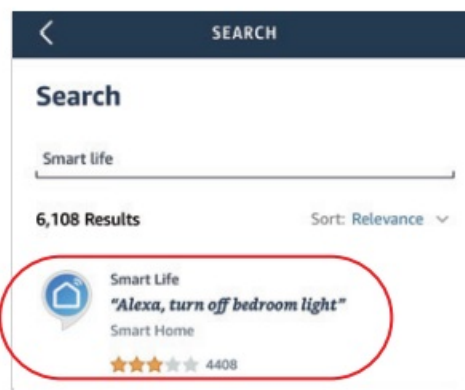
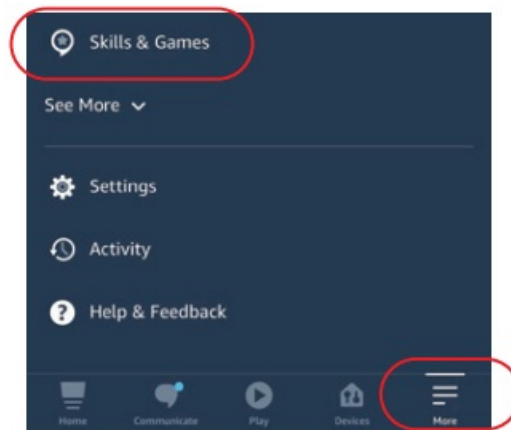

## Google Home voice control instruction

Please add device into [Tuya Smart] app (check details in page 6), then start following steps

1. Open Google Home App
2. Click “+” on the top of left corner
3. Click “Set up device”



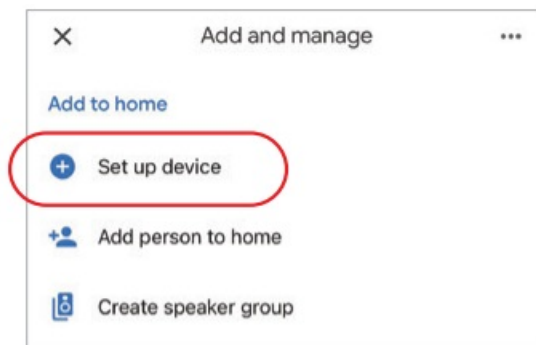
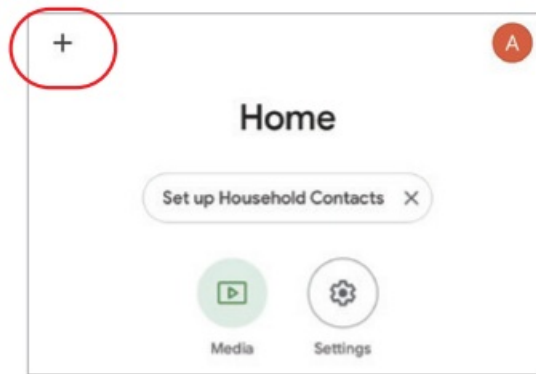

4. Click "Works with Google"
5. Click "🔍" on the top of right corner
6. Type into "Smart life" and search
7. Click "Smart Life" skill, follow instruction to finish configuration and start voice control

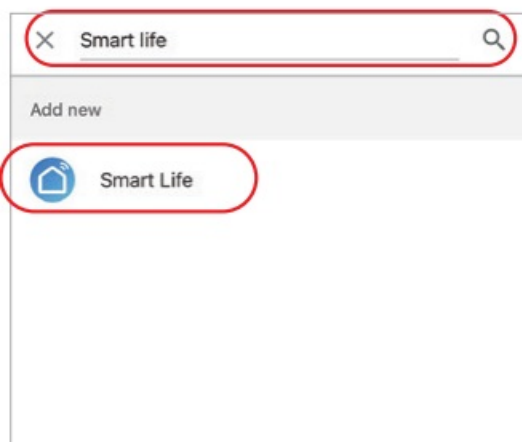
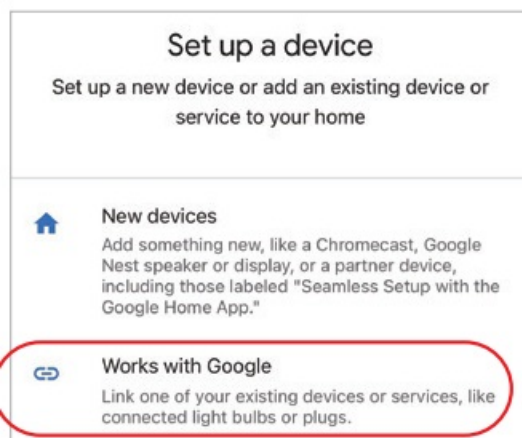

## Attention

1. Please turn off power supply before installation.
2. Please ensure input voltage to be same as requirements from device.
3. Don't disassemble device if you are not expert, otherwise it will damage it.
4. Please do not use the light in the place with widely range metal area or strong electromagnetic wave nearby, otherwise, the remote distance will be seriously affected.

Made in China

## Documents / Resources

<p><b>MIBOXER</b> <small>2 in 1 LED Controller (WiFi + 2.4G)</small> Instruction Manual</p> <p><b>Contents</b></p> <ul style="list-style-type: none"> <li>1. Introduction</li> <li>2. Package Content</li> <li>3. Installation</li> <li>4. Operation</li> <li>5. Troubleshooting</li> <li>6. Safety Precautions</li> <li>7. Warranty</li> <li>8. Contact Us</li> </ul>	<p><a href="#">MiBoxer PW2 LED Controller [pdf] Instruction Manual</a> PW2, PZ2, HW2, PW2 LED Controller, PW2, LED Controller, Controller</p>
--	---

## References

- [User Manual](#)

**Manuals+**, **Privacy Policy**

This website is an independent publication and is neither affiliated with nor endorsed by any of the trademark owners. The "Bluetooth®" word mark and logos are registered trademarks owned by Bluetooth SIG, Inc. The "Wi-Fi®" word mark and logos are registered trademarks owned by the Wi-Fi Alliance. Any use of these marks on this website does not imply any affiliation with or endorsement.