

**MiBOXER®  
HZ2-30A 2  
In 1 LED  
Controller**



## MiBOXER HZ2-30A 2 In 1 LED Controller Instruction Manual

[Home](#) » [MiBOXER](#) » MiBOXER HZ2-30A 2 In 1 LED Controller Instruction Manual 

### Contents

- 1 [MiBOXER HZ2-30A 2 In 1 LED Controller](#)
- 2 [Product features](#)
- 3 [Set up output mode](#)
- 4 [PUSH Dimming](#)
- 5 [2.4G RF Remote control instruction](#)
- 6 [Unlinking Code Instructions](#)
- 7 [Smartphone APP control instruction](#)
- 8 [Philips Hue control instruction](#)
- 9 [Alexa voice control instruction](#)
- 10 [Google Home voice control instruction](#)
- 11 [Frequently Asked Questions](#)
- 12 [Documents / Resources](#)
  - 12.1 [References](#)
- 13 [Related Posts](#)









**MiBOXER®**

**MiBOXER HZ2-30A 2 In 1 LED Controller**



## Product features

Made by new Zigbee 3.0 wireless transmitting technology with low power consumption, strong ability to build network automatically, and anti-interference. with MiBoxer Zigbee gateway to get wireless dimming color temperature and brightness, remote control, timing control, group control, and music rhythm function. Support 2.4G RF remote control.

-  Color temperature adjustable
-  Dim brightness
-  Follow Zigbee 3.0 standard protocol
-  Support Zigbee 3.0 remote control (Zigbee 3.0 gateway is needed)
-  Support 2.4G Remote control
-  Auto-transmitting
-  Support Smartphone app control (Zigbee 3.0 gateway is needed)
-  Support third party voice control (Zigbee 3.0 gateway is needed)

## Various control solution:



Philips  
Hue



MiBoxer  
Zigbee Gateway

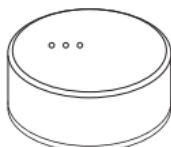

IKEA  
TRÅDFRI



2.4GHz  
Remote



Amazon  
Echo Plus



Set up output mode

- Set up the correct output mode based on the feature of lights
- **Setting method:** Press the “SET” button continuously to switch output mode (attention: it will log out without operation within 3 seconds) Output mode sheet ( confirm output mode based on color of the indicator).

Indicator color	Red Light	Green Light
Output	Single Color Mode	Dual White Mode

PUSH Dimming

Short press PUSH switch

- Turn ON/OFF light

Long press PUSH switch:

- Stepless dimming brightness.
- Long press and release your finger, then repeat long pressing to increase or decrease brightness.

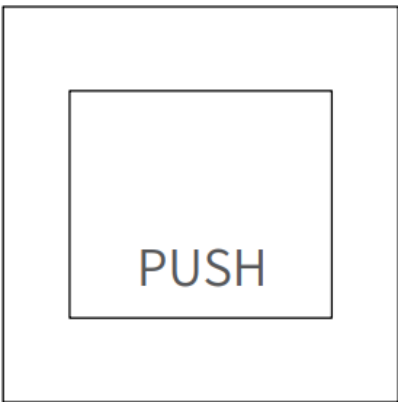

Compatible with these 2.4G RF remote controls (Purchased separately)

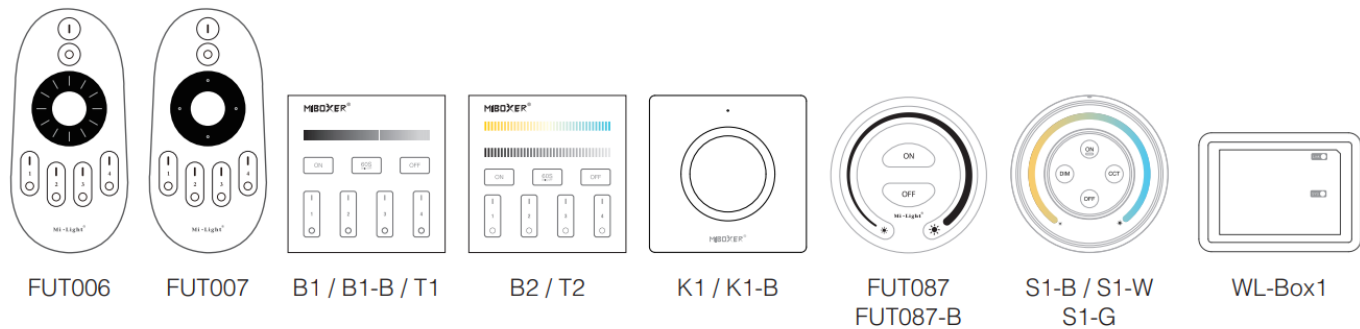

2.4G RF Remote control instruction

Linking Code Instructions

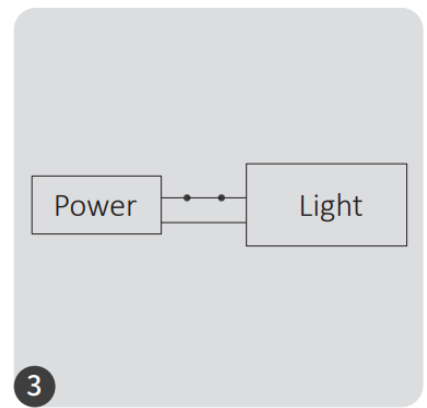
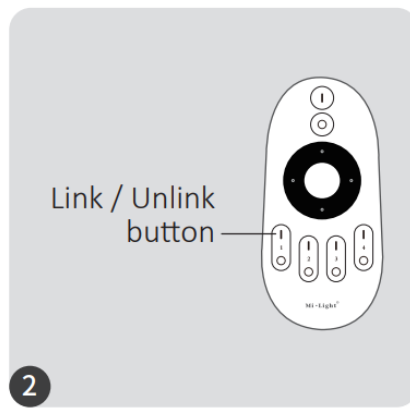
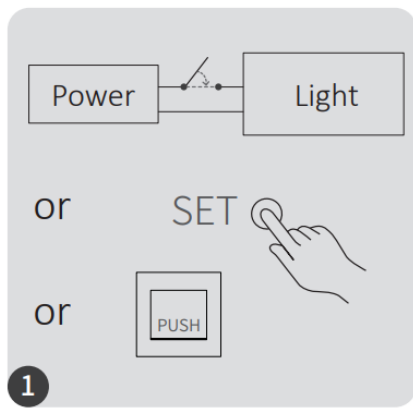

1. Power off 10 seconds and power on again or short press “SET” one time or turn on light via PUSH switch
2. Short press “ I ” button 3 times within 3 seconds.
3. Lights blink 3 times slowly means linking is done successfully.

Linking fails if the light is not blinking slowly, Please follow the above steps again.

(**Note:** Light that has linked can't link again)

### Unlinking Code Instructions

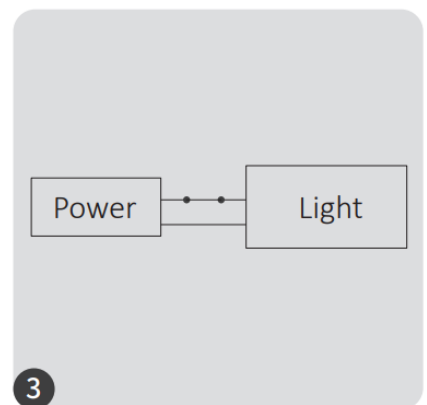
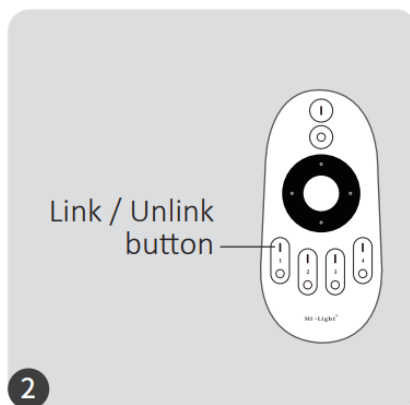
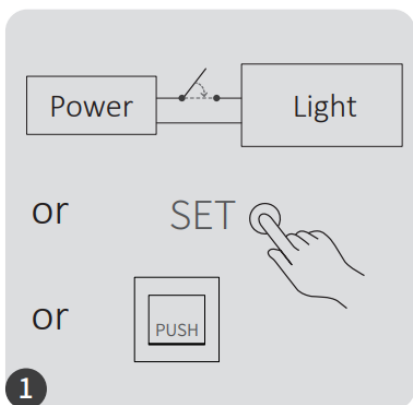

1. Power off for 10 seconds and power on again or short press “SET” one time or turn on light via the PUSH switch
2. Short press the “ I ” button 5 times within 3 seconds.
3. Lights blink 10 times quickly means unlinking is done successfully.

Unlinking fails if the light is not blinking quickly, Please follow the above steps again.

( **Note:** Light hasn't linked that doesn't need to unlink)

- Auto transmitting (2.4G RF remote signal) The light can transmit a remote signal to another light automatically while the distance between lights is 30m, the remote control distance is unlimited.

( **Attention:** all lights must be linked with the same remote)



Auto transmitting



## PWM high frequency / low frequency switching (only for remote control)

### Switch to high frequency

Press “OFF” button 1 time within three seconds and press “ON” button 5 times, Activated successfully once led light flashes 2 times quickly.

### Switch to low frequency:

Press “ON”

button 1 time within three seconds and press “OFF” button 5 times, Activated successfully once led light flashes 2 times slowly.

5). “Do Not Disturb” mode is activated and shut down (default activated)

Turn on “Do Not Disturb” mode (wide using in the area which have power failure frequently to save energy)

## 2.4G RF Remote turn on and turn off instruction

### Turn on “Do Not Disturb” mode

Press “OFF” button three times within three seconds and press the “ON” button three times, Activated successfully once led light flashes four times quickly.

**Attention:** Do not disturb mode is activated

1. When the light is OFF status (For example: Use app or remote to turn off light) The light is OFF status once you turn off power and turn on again. (User must turn off and turn on power twice times to activate light or use APP / remote to activate light)
2. When the light is ON status The light is ON status once you turn off and turn on power one time.

### Turn off the “Do Not Disturb” mode

Press the “ON” button three times within three seconds and press “OFF” button three times, close successfully once the led light flashes four times slowly.

**Attention:** The light will be always in “ON” status if you turn on and turn off the power once the ser closes the “Do Not Disturb” mode. App turns on and off “Do Not Disturb” mode instruction (check details in page 6)

## Smartphone APP control instruction

Added Zigbee 3.0 gateway into “Tuya Smart” App (please review instruction of Zigbee 3.0 gateway)

1. Connect with power supply.
2. Pairing network (attention: factory default is pairing network).
  - **Way one:** Turn off and turn on light 6 times or over 6 times continuously, the light is in breathing status.

- **Way two:** Long press "SET" key until indicator light flashing.
3. Open "Tuya Smart" APP to click Zigbee gateway, then click "Add sub device".
  4. Click "Indicator is flashing quickly".
  5. Support APP dimming or group control and etc once added successfully.

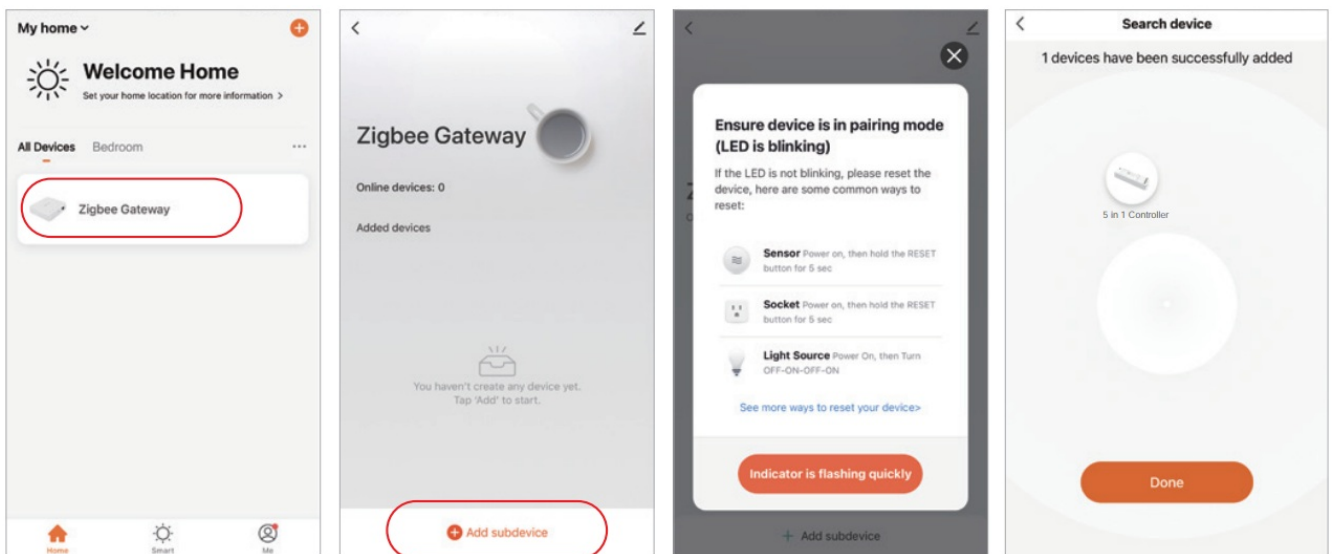

### App turns on and off "Do Not Disturb" mode (default activated)

Click the light which need to be set up or group control — click "More" — click "Power-on behavior" — turn on or off

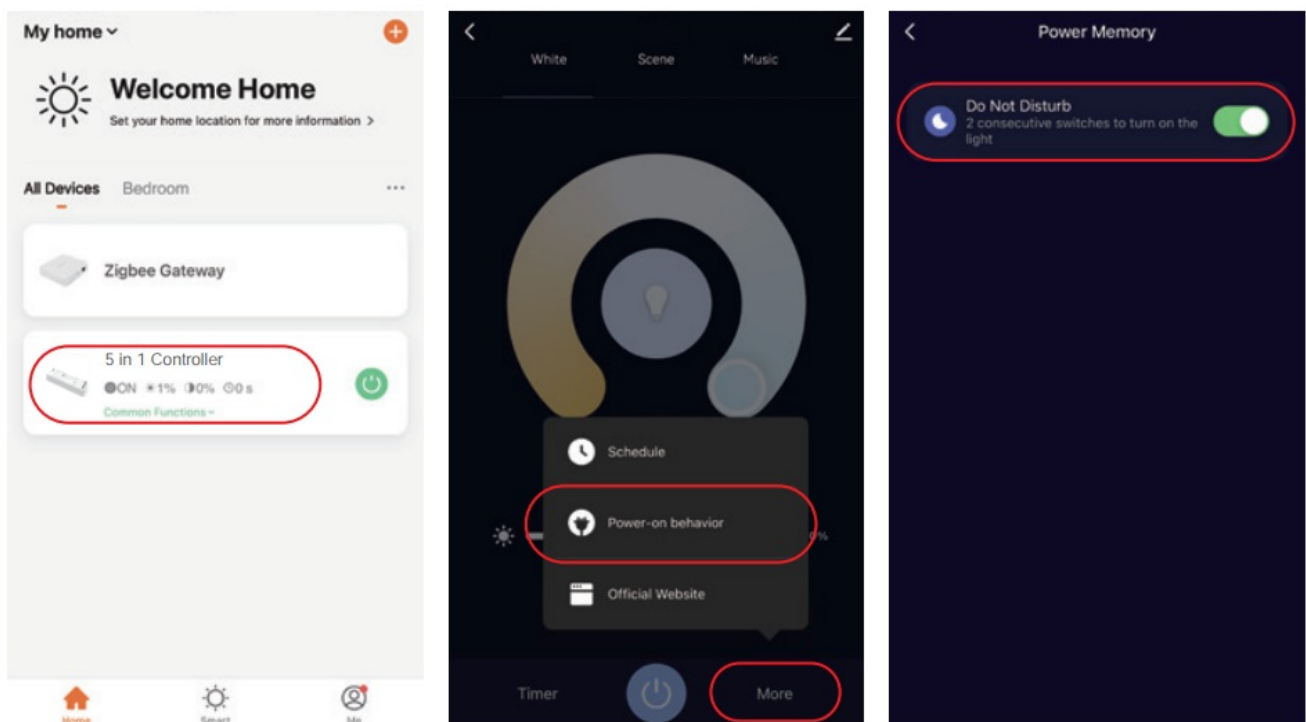

## Philips Hue control instruction

### Added "Philips Hue" into the APP

1. Connect with the power supply
2. Pairing network (attention: factory default is pairing network)
  - **Way one:** Turn off and turn on the light 6 times or over 6 times continuously, the light is in breathing status.
  - **Way two:** Long press the "SET" key until the indicator light flashing.

3. Open "Philips Hue" App to click "SETTINGS" and click "Lights"
4. Click "+" on the top of the right corner
5. Click "Search"
6. Click "Start configuration", Follow the app instructions to complete the configuration.

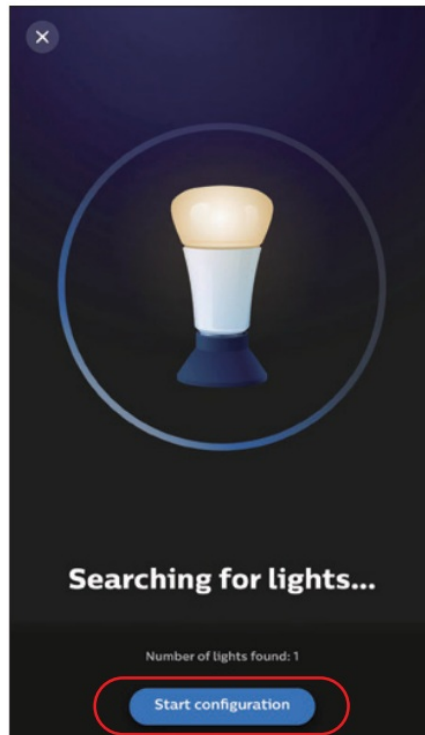
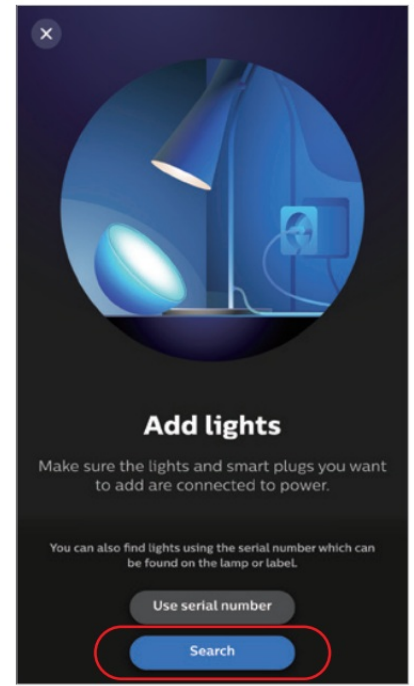
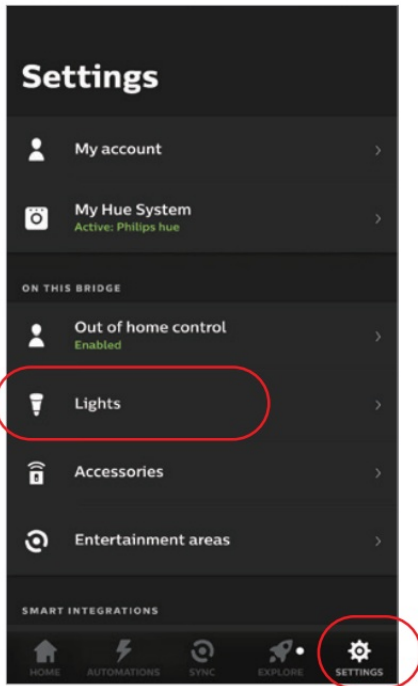

## Alexa voice control instruction

### Alexa control (Audio support Zigbee 3.0 protocol)

You can connect directly if your Amazon ECHO already has built-in zigbee 3.0 protocol, following the model with zigbee 3.0 protocol: Amazon ECHO Plus ( 2nd Gen), ECHO (4th Gen), ECHO Studio, ECHO Show (2. Gen)

1. Connect with the power supply
2. Pairing network (attention: factory default is pairing network)
  - **Way one:** Turn off and turn on the light 6 times or over 6 times continuously, the light is in breathing

status.

- **Way two:** Long press the " SET " key until the indicator light flashes.

3. Say to Amazon ECHO "Alexa, Discover devices" Wait for a while to discover the device, Voice control is activated

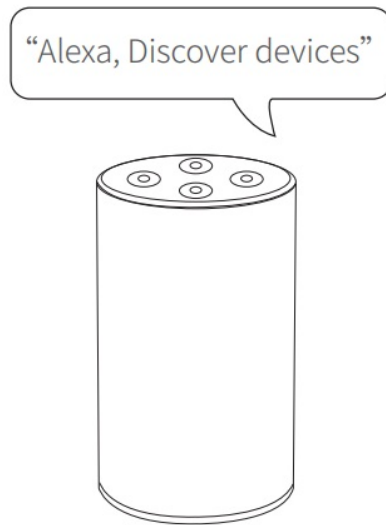



**Alexa control (Audio doesn't support Zigbee 3.0 protocol)**

Please add the device into Miboxer Zigbee 3.0 gateway if your Alexa doesn't support zigbee 3.0 protocol (check details in page 6), then start following steps

1. Open Alexa App
2. Click "More" on the bottom of the right corner
3. Click "Skills & Games"

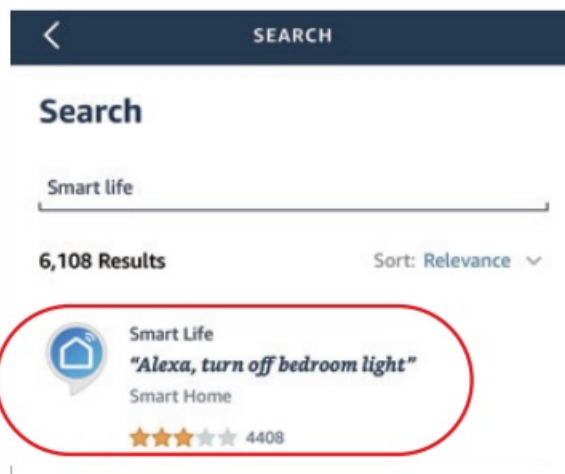
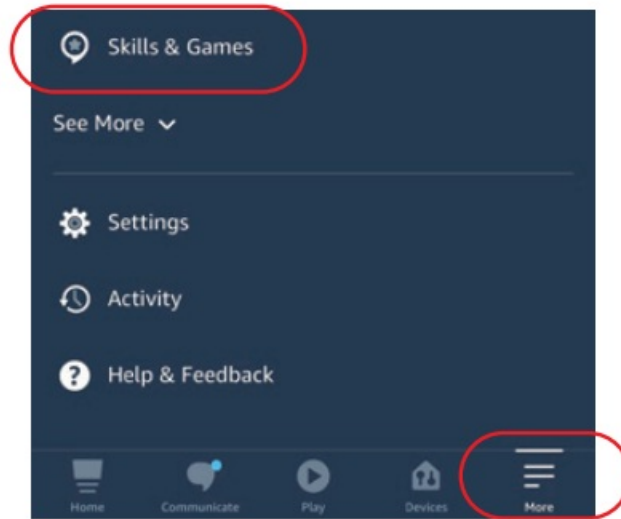



4. Click “” on the top of the right corner
5. Type into “Smart life” and search
6. Click the “Smart Life” skill, follow the instructions to finish the configuration, and start the voice control

## Google Home voice control instruction

Please add device into MiBoxer Zigbee 3.0 gateway (check details on page 6) and start following steps

1. Open the Google Home App
2. Click “+” on the top of left corner
3. Click “Set up device”

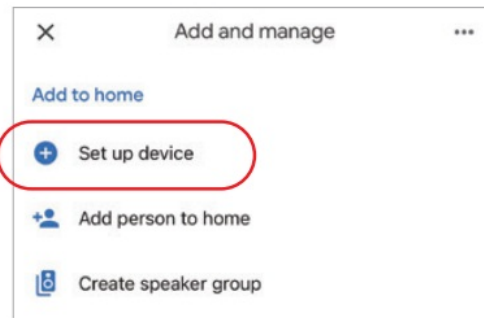
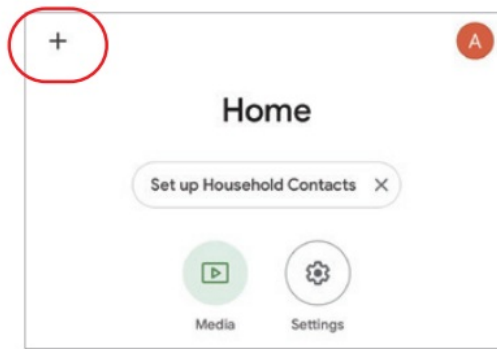

4. Click “Works with Google”

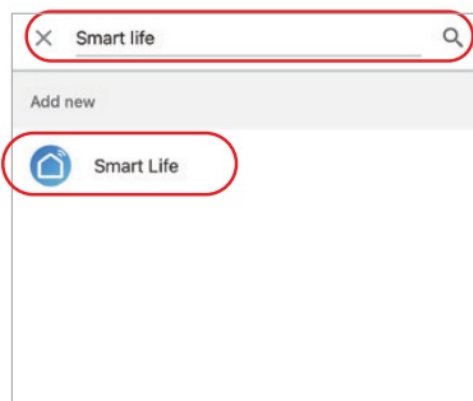
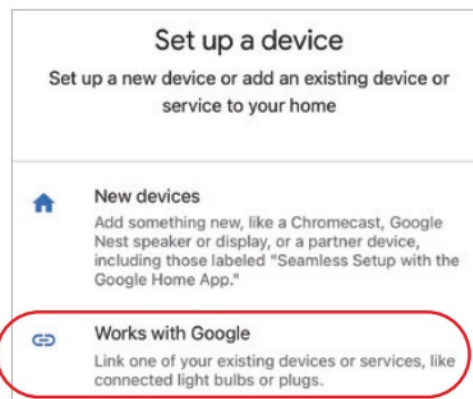

5. Click “” on the top of the right corner

6. Type into “Smart life” and search

7. Click the “Smart Life” skill, follow the instructions to finish the configuration, and start the voice control

## Attention

1. Please turn off the power supply before installation.
2. Please ensure the input voltage to be same as the requirements from the device.
3. Don't disassemble the device if you are not an expert, otherwise, it will damage it.
4. Please do not use the light in a place with a wide range of metal areas or strong electromagnetic waves nearby, otherwise, the remote distance will be seriously affected.

Scan QR code to watch the Zigbee series video instructions Or enter into following link directly  
<https://miboxer.com/light/video/zigbee.html>



## Frequently Asked Questions

### Q: Do I need a Zigbee 3.0 gateway for remote control?

A: Yes, a Zigbee 3.0 gateway is needed for Zigbee 3.0 remote control, smartphone app control, and third-party voice control.

### Q: What is the maximum distance for remote signal transmission?

A: The distance between lights for automatic transmission is 30m, while the remote control distance is unlimited.

### Q: How do I know if the linking/unlinking process was successful?

A: Successful linking is indicated by lights blinking slowly three times, while successful unlinking is indicated by lights blinking quickly ten times.

## Documents / Resources

 2 in 1 LED Controller (Zigbee 3.0 + 2.4G) Instruction Manual	<a href="#">MiBOXER HZ2-30A 2 In 1 LED Controller</a> [pdf] Instruction Manual HZ2-30A, HZ2-30A 2 In 1 LED Controller, 2 In 1 LED Controller, LED Controller, Controller
--------------------------------------------------------------------------------------------------------------------------------------------------------	-----------------------------------------------------------------------------------------------------------------------------------------------------------------------------

## References

-  [Zigbee Series Video - MiBoxer](#)
- [User Manual](#)

This website is an independent publication and is neither affiliated with nor endorsed by any of the trademark owners. The "Bluetooth®" word mark and logos are registered trademarks owned by Bluetooth SIG, Inc. The "Wi-Fi®" word mark and logos are registered trademarks owned by the Wi-Fi Alliance. Any use of these marks on this website does not imply any affiliation with or endorsement.