

MiBOXER®
HW5 5
in 1
LED-controller
WiFi
2.4G



MiBOXER HW5 5 in 1 LED-controller WiFi 2.4G Instructions

















[Home](#) » [MiBOXER](#) » MiBOXER HW5 5 in 1 LED-controller WiFi 2.4G Instructions 

Contents

- [1 MiBOXER HW5 5 in 1 LED-controller WiFi 2.4G](#)
- [2 Product Usage Instructions](#)
- [3 FAQs](#)
- [4 Product Features](#)
- [5 Set up output mode](#)
- [6 Smartphone APP control instruction](#)
- [7 Alexa voice control instruction](#)
- [8 Documents / Resources](#)
 - [8.1 References](#)



MiBOXER HW5 5 in 1 LED-controller WiFi 2.4G

-  Color temperature adjustable
-  Dim brightness
-  2.4G RF wireless transmission technology
-  WiFi wireless control supports long-range control
-  Auto-transmitting (only for remote control dimming)
-  Device sharing
-  Tap-to-Run & automation
-  Timing setting/countdown turn on/off LED light
-  Do not disturb mode
-  Remote control Control distance 30m
-  Smartphone app control
-  Support third-party voice control
-  Group control
-  Biorhythm
-  Support music rhythm
-  Sleep / wake-up plan



- Support scene customization

Set up output mode

- Set up the correct output mode based on the feature of lights
- Setting method: Press the “SET” button continuously to switch output mode (attention: it will log out without operation within 3 seconds)
- Output mode sheet (confirm output mode based on the color of the indicator)

Indicator color	Red Light	Green Light
Output	Single Color Mode	Dual White Mode

PUSH Dimming

- **Short press PUSH switch:**
 - Turn the ON/OFF light
- **Long press PUSH switch:**
 - Stepless dimming brightness.
 - Long press and release your finger, then repeat long pressing to increase or decrease brightness.

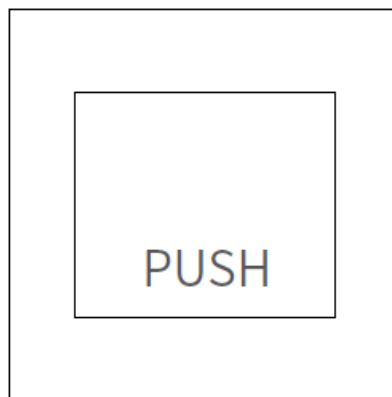

Compatible with these 2.4G RF remote controls (Purchased separately)

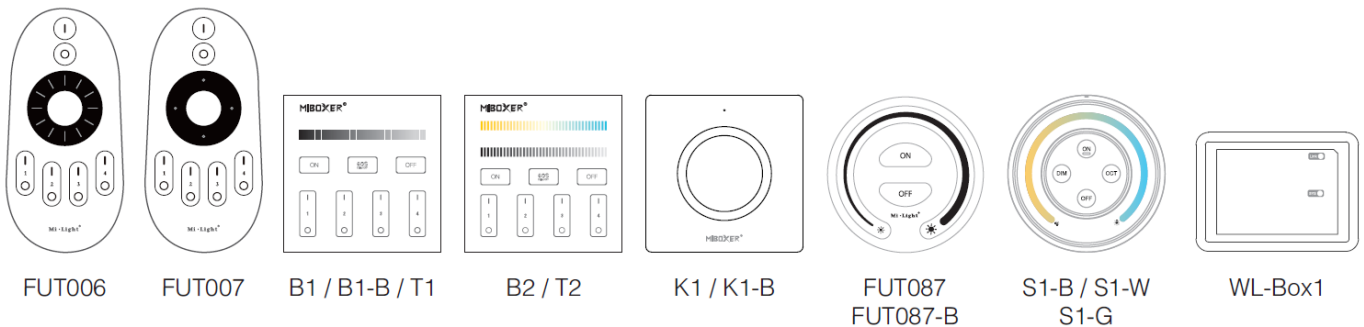

2.4G RF Remote control instruction

1. Linking Code Instructions

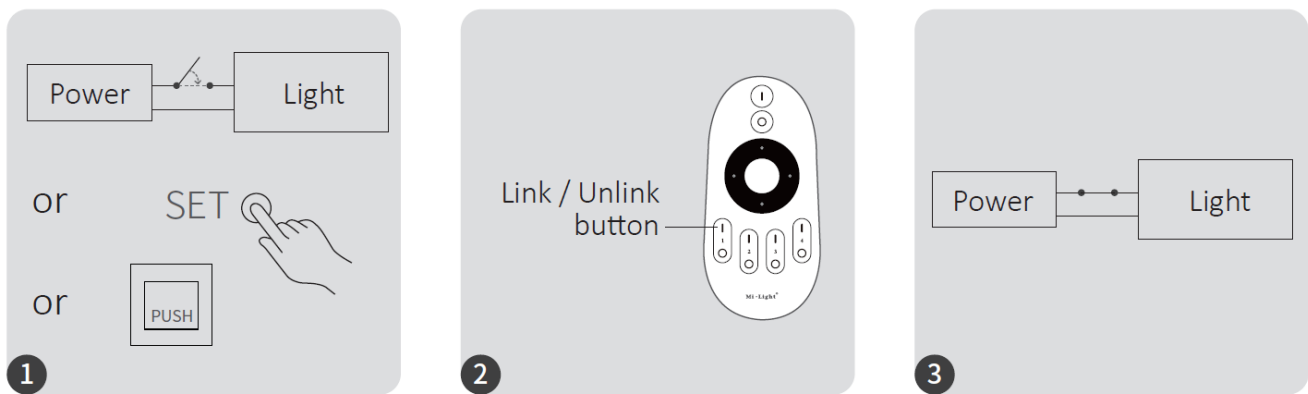

1. Power off for 10 seconds and power on again or short press “SET” one time or turn on the light via the PUSH switch
2. Short press the “|” button 3 times within 3 seconds.
3. Lights blink 3 times slowly means linking is done successfully.
 - Linking fails if the light is not blinking slowly, Please follow the above steps again.
 - **(Note: Light that has linked can't link again)**

2. Unlinking Code Instructions

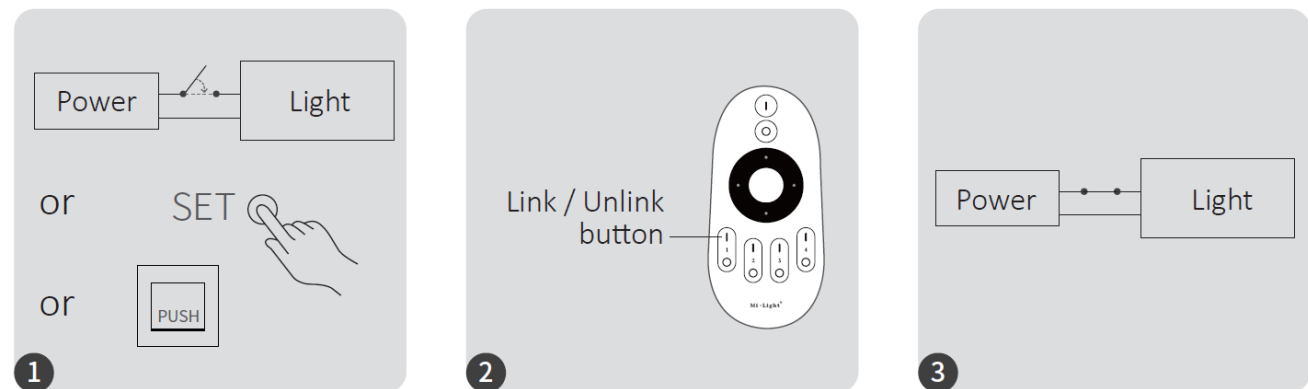

1. Power off for 10 seconds and power on again or short press “SET” one time or turn on the light via the PUSH switch
2. Short press the “|” button 5 times within 3 seconds.
3. Lights blink 10 times quickly means unlinking is done successfully.
 - Unlinking fails if the light is not blinking quickly, Please follow the above steps again.
 - **(Note: Light hasn't linked that doesn't need to unlink)**

3. Auto transmitting (2.4G RF remote signal)

- The light can transmit a remote signal to another light automatically while the distance between lights is 30m, the remote control distance is unlimited.
- **(Attention: all lights must be linked with the same remote)**

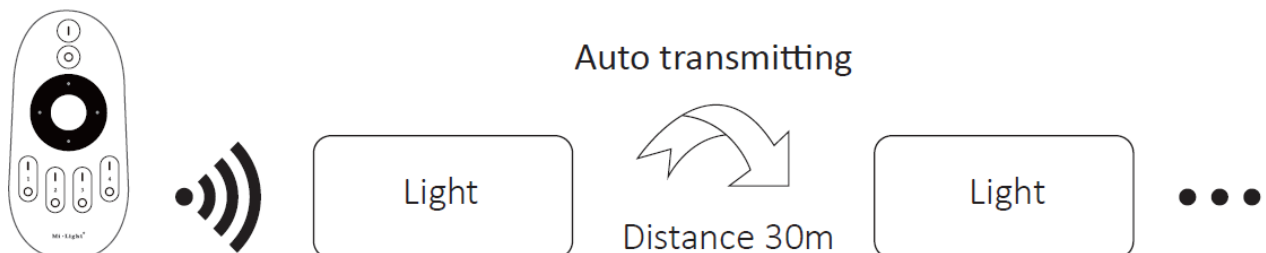

4. PWM high-frequency / low-frequency switching (only for remote control)

- **Switch to high frequency:**
 - Press the “OFF” button 1 time within three seconds and press the “ON” button 5 times,
 - Activated successfully once led light flashes 2 times quickly. Switch to low frequency:

- Press the “ON” button 1 time within three seconds and press the “OFF” button 5 times, Activated successfully once led light flashes 2 times slowly.
5. “Do Not Disturb” mode is activated and shut down (default activated)
- Turn on “Do Not Disturb” mode (wide use in the area which has power failure frequently to save energy)
 - **2.4G RF Remote turn on and turn off instruction**
 - Turn on “Do Not Disturb” mode:
 - Press the “OFF” button three times within three seconds and press the “ON” button three times, Activated successfully once led light flashes four times quickly.
 - **Attention:** Do not disturb mode is activated
 1. When the light is OFF status (For example: Use app or remote to turn off light) The light is OFF status once you turn off power and turn on again (User must turn off and turn on power twice times to activate light or use APP / remote to activate light)
 2. When the light is ON status
 - The light is ON status once you turn off and turn on power one time.
 - **Turn off “Do Not Disturb” mode:**
 - Press the “ON” button three times within three seconds and press the “OFF” button three times, close successfully once the led light flashes four times slowly.
 - **Attention:** The light will be always in “ON” status if you turn it on and turn off the power once the user closes “Do Not Disturb” mode.
 - App turns on and off “Do Not Disturb” mode instruction (check details on page 7)

Smartphone APP control instruction

Network Configuration (Don't support 5G router)

1. Download and install the [Tuya Smart] app Search for [Tuya Smart] in the Apple or Google store or scan the following QR code to download and install the app. Please open the app and click the ” Register ” button to create an account while using it for the first time, Log in directly if you already have an account.



2. Network Configuration

1. Connect controller with power supply.
2. Confirm indicator light is flashing quickly (2 flashes per second),
 - If the indicator light isn't in a fast flashing state, there are two ways to enter:
 - Long press the ” SET” key until the indicator light flashes quickly.

- Power off and on the controller 3 times.
3. Connect the phone to home WiFi network at a 2.4GHz frequency.
 4. Open the homepage of the app and click the” + ” button at the upper right corner of the page.
 5. Click ” Lighting” on the left side of the page and then click ” Light Source (BLE+Wi-Fi) “
 6. Follow the app prompts to complete the configuration.

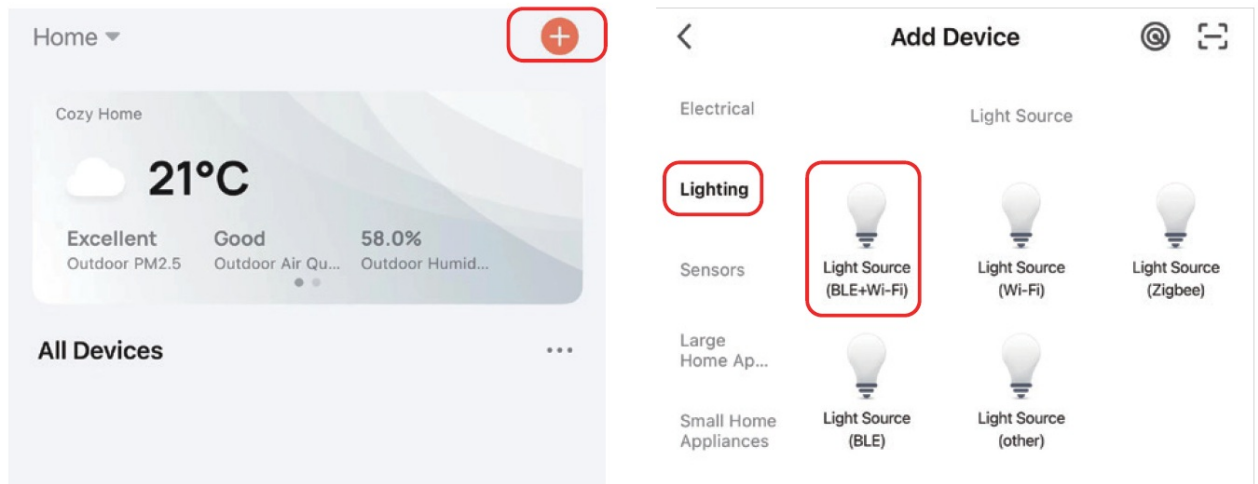

App turns on and off “Do Not Disturb” mode (default activated)

Click the light which needs to be set up or group control — click “More” — click “Power-on behavior” ... turn on or off

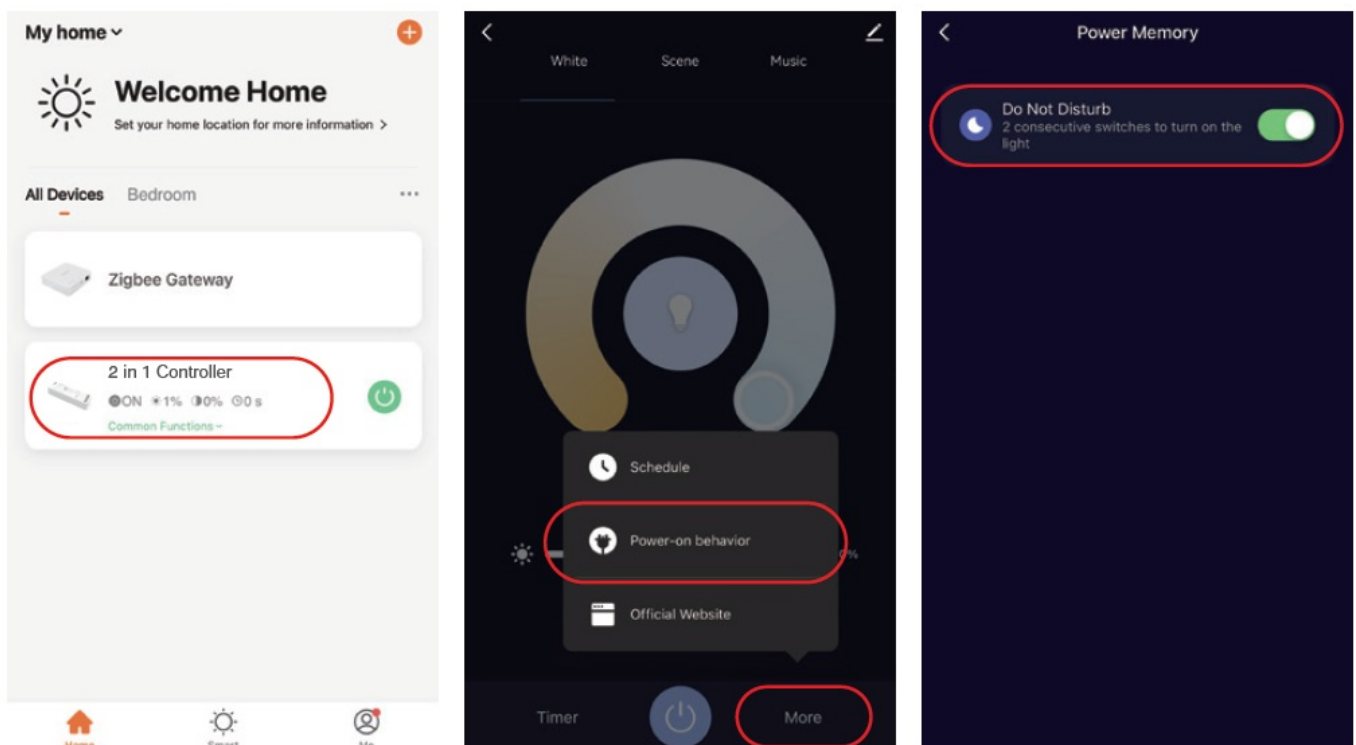

Alexa voice control instruction

Please add the device to the [Tuya Smart] app (check details on page 6), then start following the steps

1. Open Alexa App
2. Click “More” at the bottom of the right corner

3. Click “Skills & Games”

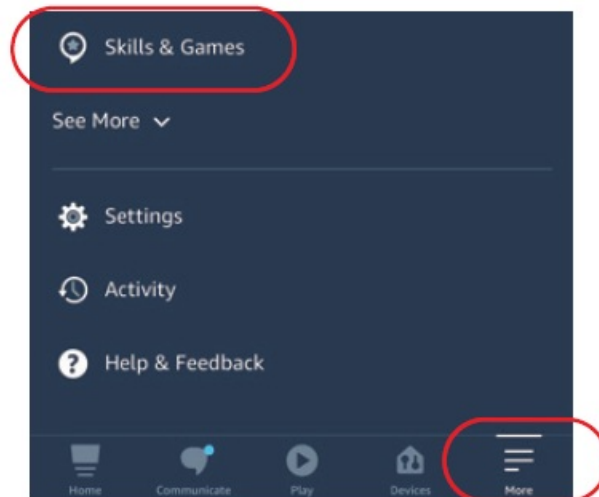

4. Click “Q” on the top of the right corner

5. Type into “Smart life” and search



6. Click the “Smart Life” skill, follow instructions to finish the configuration and start the voice control

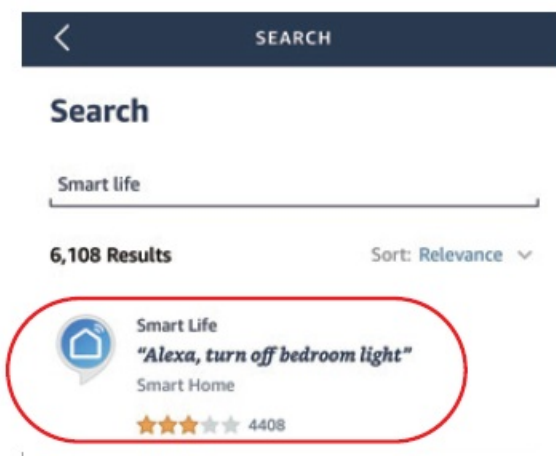

Google Home voice control instruction

Please add the device to the [Tuya Smart] app then start following steps

1. Open the Google Home App

2. Click “+” on the top of left corner

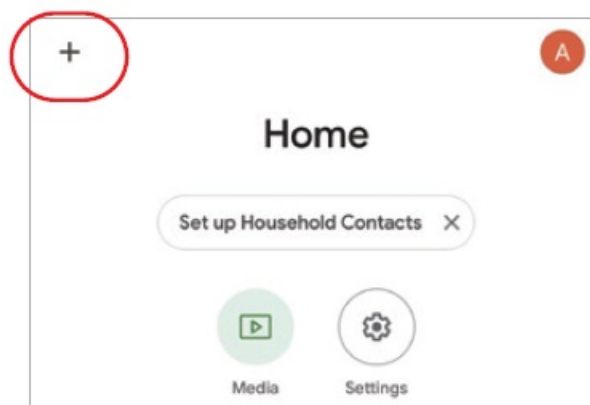

3. Click “Set up device”

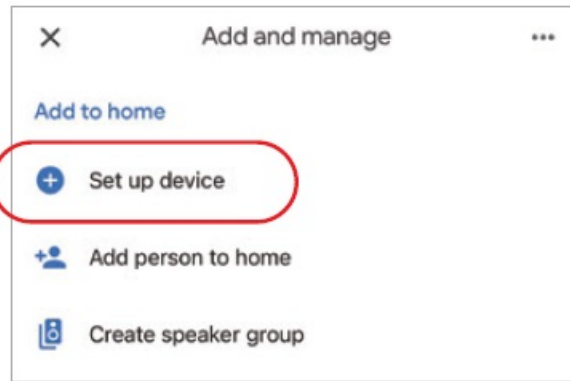

4. Click “Works with Google”

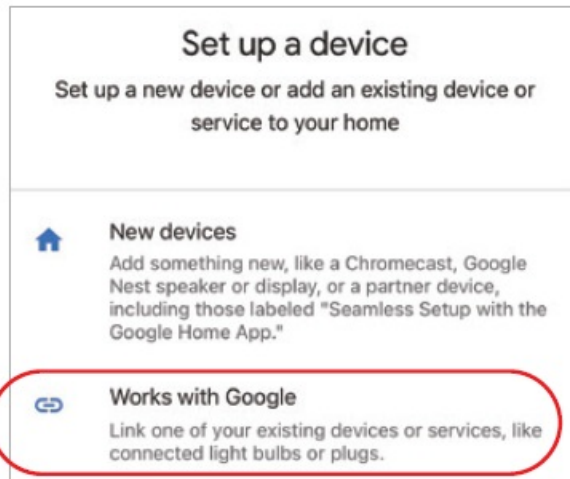

5. Click “Q” on the top of the right corner

6. Type into “Smart life” and search

7. Click the “Smart Life” skill, follow the instructions to finish the configuration, and start voice control.

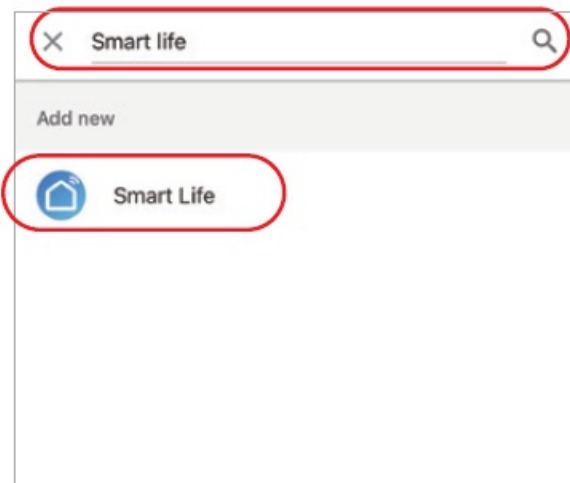

Attention

1. Please turn off the power supply before installation.
2. Please ensure the input voltage to be same as the requirements from the device.
3. Don't disassemble the device if you are not an expert, otherwise, it will damage it.
4. Please do not use the light in a place with a wide range of metal areas or strong electromagnetic waves nearby, otherwise, the remote distance will be seriously affected.

Documents / Resources

