



MIBOXER FUT035Z 2 In 1 LED Controller Instruction Manual

[Home](#) » [MiBOXER](#) » MIBOXER FUT035Z 2 In 1 LED Controller Instruction Manual 

Contents

- [1 MIBOXER FUT035Z 2 In 1 LED Controller](#)
- [2 Product Information](#)
- [3 Product features](#)
- [4 Set up output mode](#)
- [5 2.4G RF Remote control instruction](#)
- [6 Smartphone APP control instruction](#)
- [7 Philips Hue control instruction](#)
- [8 Alexa voice control instruction](#)
- [9 Documents / Resources](#)
 - [9.1 References](#)



MIBOXER FUT035Z 2 In 1 LED Controller







Product Information

The Subordinate New Brand 2 in 1 LED Controller is a versatile device that combines Zigbee 3.0 and 2.4G technologies. It is designed with low power consumption and has the ability to automatically build a network with minimal interference. The controller is compatible with the MiBoxer Zigbee gateway, allowing for wireless dimming of color temperature and brightness, as well as remote control, timing control, group control, and music rhythm functionality. It also supports 2.4G RF remote control. The controller follows the Zigbee 3.0 standard protocol and can be controlled using a Zigbee 3.0 remote control (requires Zigbee 3.0 gateway). It also supports 2.4G remote control and can be controlled via a smartphone app (requires Zigbee 3.0 gateway). Additionally, it is compatible with third-party voice control systems (requires Zigbee 3.0 gateway). The controller supports various control solutions from brands like Philips, MiBoxer, IKEA, and the 2.4GHz Amazon Remote Echo Plus.

Product features

Made by new Zigbee 3.0 wireless transmitting technology with low power consumption, strong ability to build network automatically and anti-interference. with MiBoxer Zigbee gateway to get wireless dimming color temperature and brightness, remote control, timing control, group control, music rhythm function. Support 2.4G RF remote control.

-  • Color temperature adjustable
-  • Dim brightness
-  • Follow Zigbee 3.0 standard protocol
-  • Support Zigbee 3.0 remote control (Zigbee 3.0 gateway is needed) Support 2.4G Remote control
-  • Auto-transmitting
- Support Smartphone app control (Zigbee 3.0 gateway is needed) Support third party voice control (Zigbee 3.0 gateway is needed)

Various control solutions:



Philips
Hue



MiBoxer
Zigbee Gateway

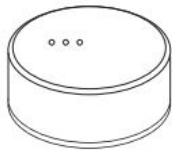

IKEA
TRÅDFRI



2.4GHz
Remote



Amazon
Echo Plus



Set up output mode

Set up correct output mode based on the feature of lights

Setting method: Press "SET" button continuously to switch output mode (attention: it will log out without operation within 3 seconds) Output mode sheet (confirm output mode based on color of indicator)

Indicator color	Red Light	Green Light
Output	Single Color Mode	Dual White Mode

PUSH Dimming

- **Short press PUSH switch:**

Turn ON/OFF light

- **Long press PUSH switch:**

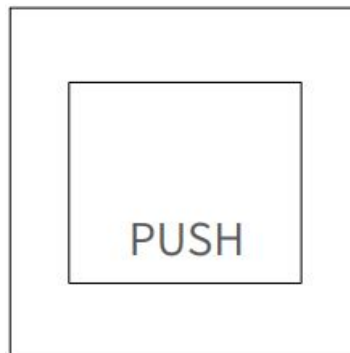

- Stepless dimming brightness.
- Long press and release your finger, then repeat long pressing to increase or decrease brightness.

Compatible with these 2.4G RF remote controls (Purchased separately)



FUT006



FUT007



B1 / B1-B / T1

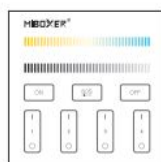

B2 / T2

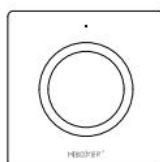

K1 / K1-B

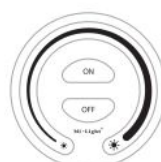

FUT087
FUT087-B



S1-B / S1-W
S1-G

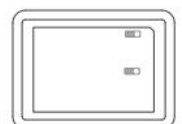

WL-Box1

2.4G RF Remote control instruction

1. Linking Code Instructions

1. Power off 10 seconds and power on again or short press “SET” one time or turn on light via PUSH switch.

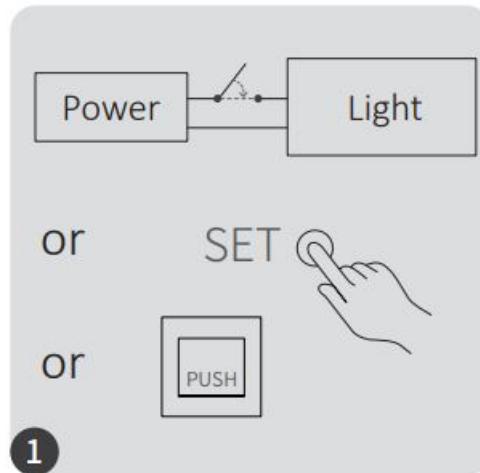

2. Short press "I" button 3 times within 3 seconds.



3. Lights blink 3 times slowly means linking is done successfully.

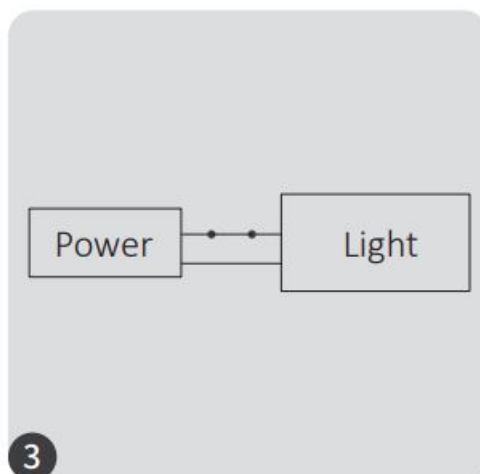

Linking failed if light is not blinking slowly, Please follow above steps again. (Note: Light that have linked can't link again).

2. Unlinking Code Instructions

1. Power off 10 seconds and power on again or short press “SET” one time or turn on light via PUSH switch.

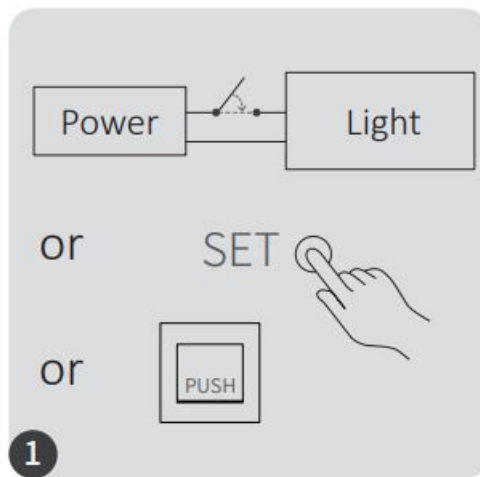

2. Short press "I" button 5 times within 3 seconds.

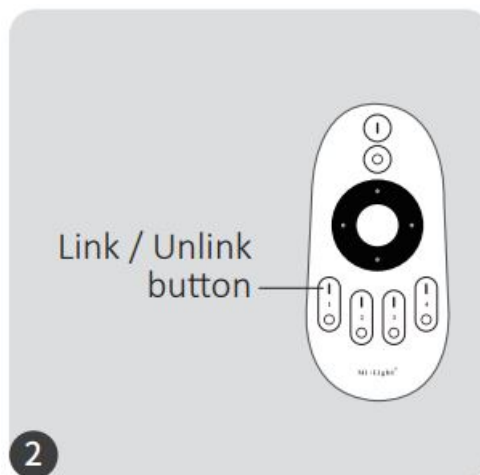

3. Lights blink 10 times quickly means unlinking is done successfully.

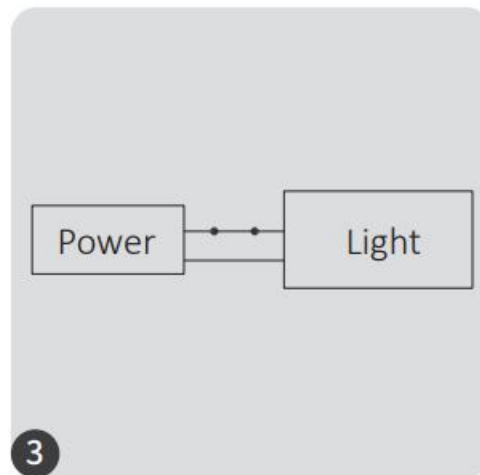

Unlinking failed if light is not blinking quickly, Please follow above steps again. (Note: Light haven't linked that don't need to unlink)

3. Auto transmitting (2.4G RF remote signal)

The light can transmit remote signal to another light automatically while the distance between lights are 30m, the remote control distance is unlimited. (Attention: all lights must be linked with same remote).

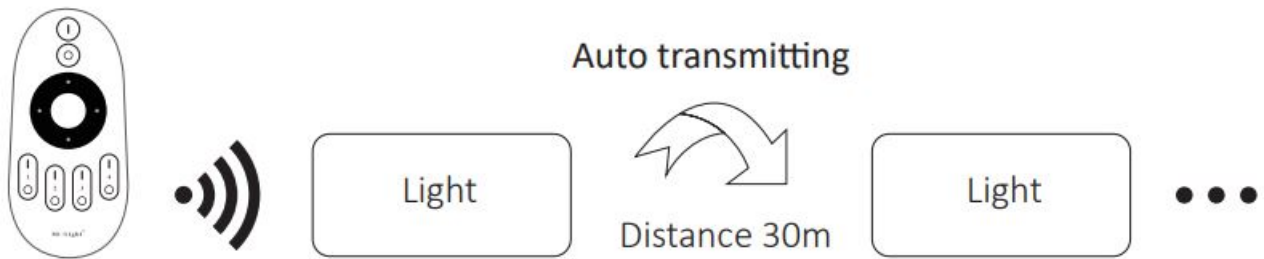

4. PWM high frequency / low frequency switching (only for remote control)

1. **Switch to high frequency (16KHz):**

Press “OFF” button 1 time within three seconds and press “ON” button 5 times, Activated successfully once led light flashes 2 times quickly.

2. **Switch to low frequency (250Hz):**

Press “ON” button 1 time within three seconds and press “OFF” button 5 times, Activated successfully once led light flashes 2 times slowly.

5. “Do Not Disturb” mode is activated and shut down (default activated)

Turn on “Do Not Disturb” mode (wide using in the area which have power failure frequently to save energy)

2.4G RF Remote turn on and turn off instruction

Turn on “Do Not Disturb” mode:

Press “OFF” button three times within three seconds and press “ON” button three times, Activated successfully once led light flashes four times quickly.

Attention: Do not disturb mode is activated

1. When the light is OFF status (For example: Use app or remote to turn off light) The light is OFF status once you turn off power and turn on again. (User must turn off and turn on power twice times to activate light or use APP / remote to activate light)

2. When the light is ON status The light is ON status once you turn off and turn on power one time.

Turn off “Do Not Disturb” mode:

Press “ON” button three times within three seconds and press “OFF” button three times, closed successfully once led light flashes four times slowly.

Attention: The light will be always “ON” status if you turn on and turn off power once user closed “Do Not Disturb” mode.

App turn on and off “Do Not Disturb” mode instruction (check details in page 6)

Smartphone APP control instruction

Added Zigbee 3.0 gateway into “Tuya Smart” App (please review instruction of Zigbee 3.0 gateway)

1. Connect with power supply.
2. Pairing network (attention: factory default is pairing network).
 - Way one: Turn off and turn on light 3 times or over 3 times continuously, the light is in breathing status.
 - Way two: Long press ” SET ” key until indicator light flashing.
3. Open “Tuya Smart” APP to click Zigbee gateway, then click “Add sub device”.
4. Click “Indicator is flashing quickly”.
5. Support APP dimming or group control and etc once added successfully.

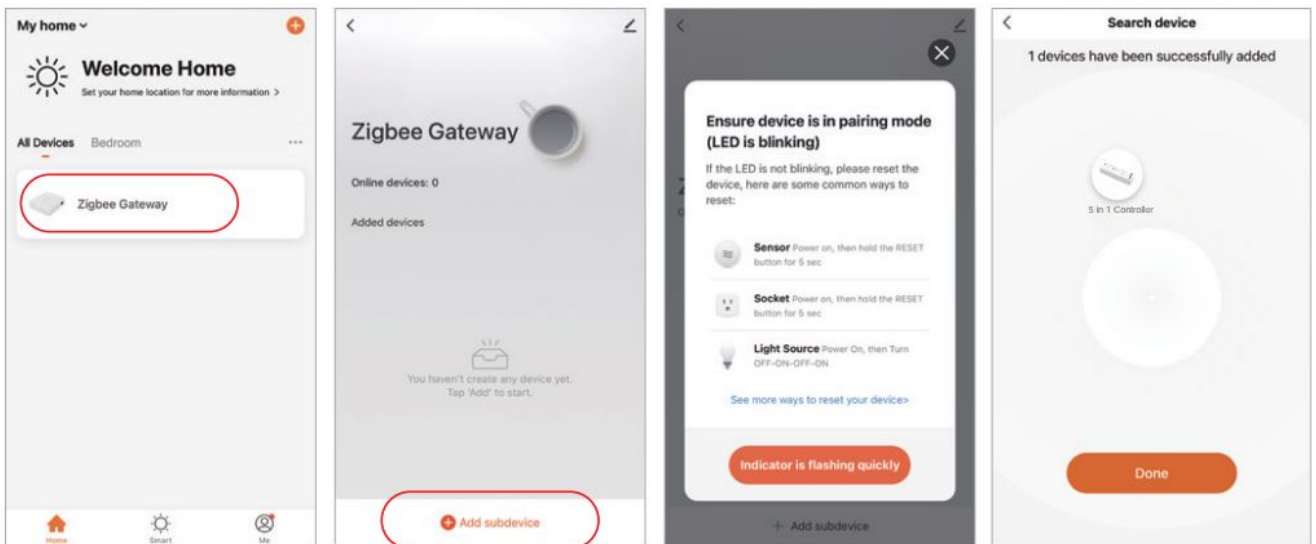

App turn on and off “Do Not Disturb” mode (default activated)

Click the light which need to be set up or group control — click “More” — click “Power-on behavior” — turn on or off.

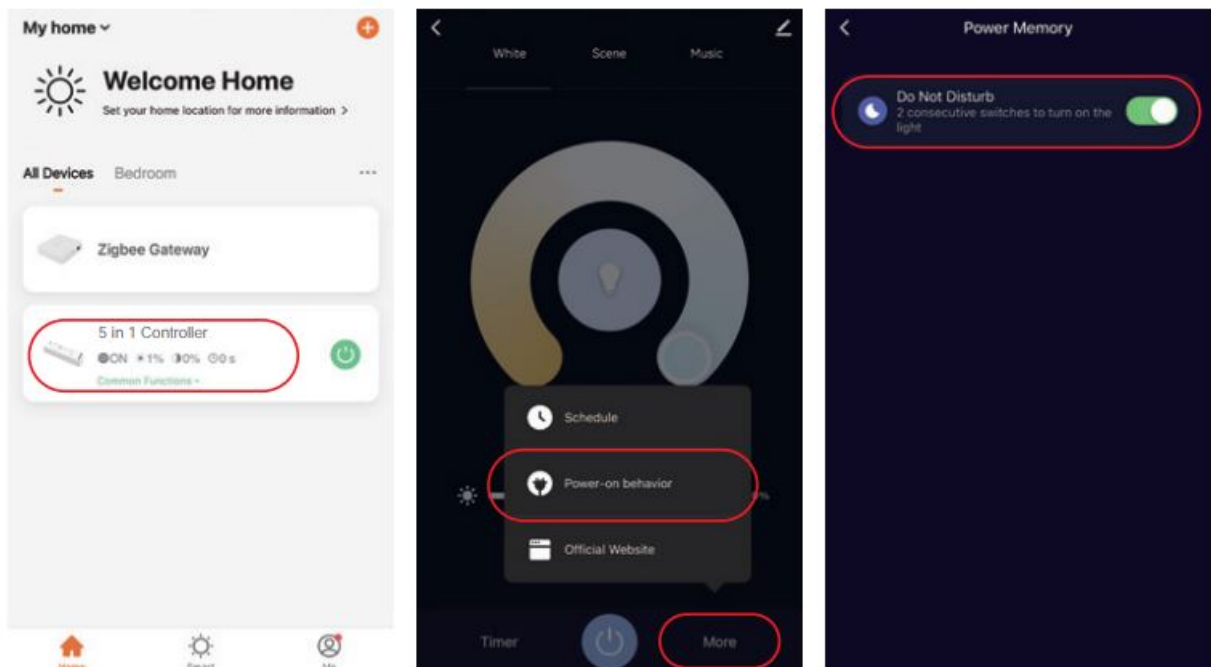

Philips Hue control instruction

Added “Philips Hue” into APP

1. Connect with power supply
2. Pairing network (attention: factory default is pairing network)
 - **Way one:** Turn off and turn on light 3 times or over 3 times continuously, the light is in breathing status.
 - **Way two:** Long press ” SET ” key until indicator light flashing.
3. Open “Philips Hue” App to click “SETTINGS” and click “Lights”
4. Click “+” on the top of right corner
5. Click “Search”
6. Click “Start configuration”, Follow the app instruction to complete configuration

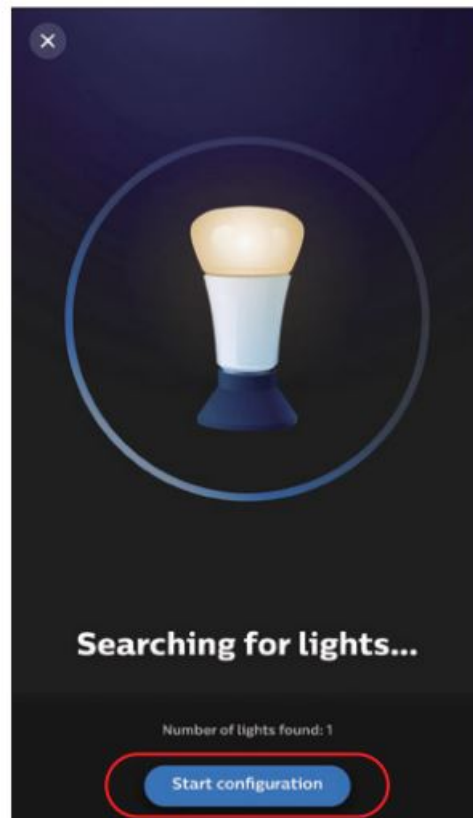
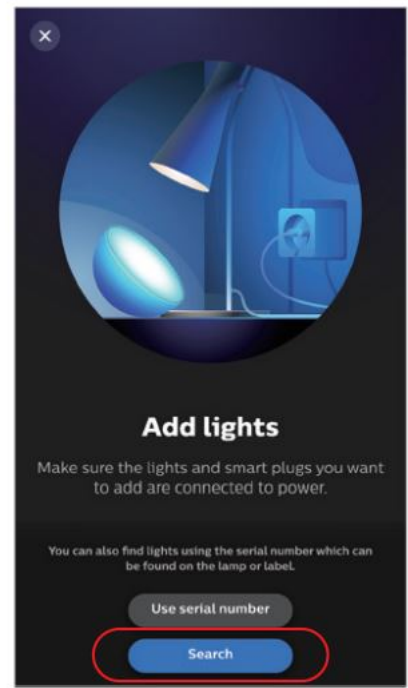
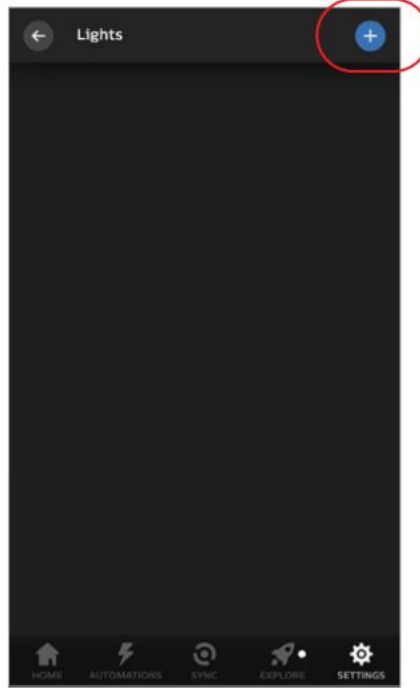
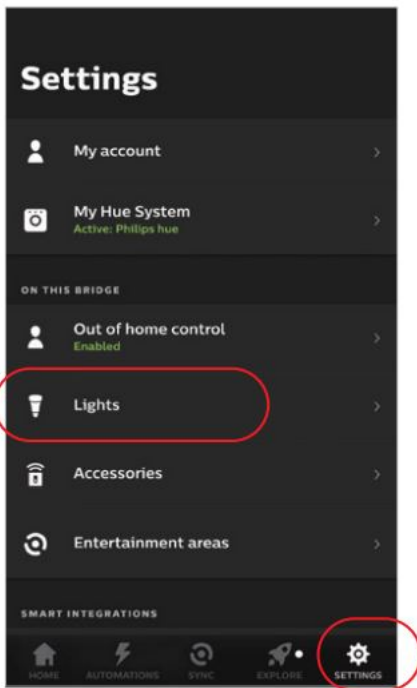

Alexa voice control instruction

Alexa control (Audio support Zigbee 3.0 protocol)

You can connect directly if your Amazon ECHO already is built-in zigbee 3.0 protocol, following model with zigbee 3.0 protocol: Amazon ECHO Plus (2nd Gen), ECHO (4th Gen), ECHO Studio, ECHO Show (2. Gen)

1. Connect with power supply
2. Pairing network (attention: factory default is pairing network)

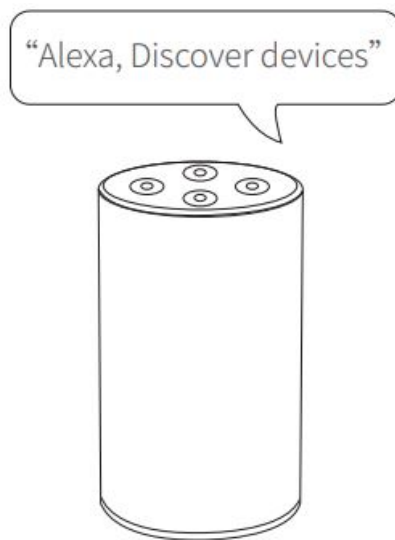

- **Way one:** Turn off and turn on light 3 times or over 3 times continuously, the light is in breathing status.
 - **Way two:** Long press "SET" key until indicator light flashing.
3. Say to Amazon ECHO "Alexa, Discover devices" Wait for a while to discover device, Voice control is activated

Alexa control (Audio don't support Zigbee 3.0 protocol)

Please add device into Miboxer Zigbee 3.0 gateway if your Alexa don't support zigbee 3.0 protocol (check details in page 6), then start following steps

1. Open Alexa App
2. Click "More" on the bottom of right corner
3. Click "Skills & Games"

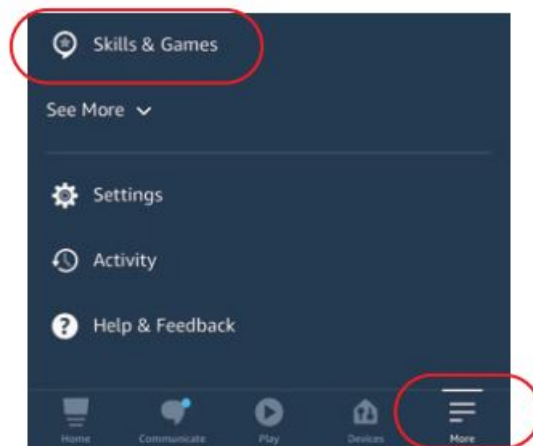

4. Click " " on the top of right corner
5. Type into "Smart life" and search
6. Click "Smart Life" skill, follow instruction to finish configuration and start voice control

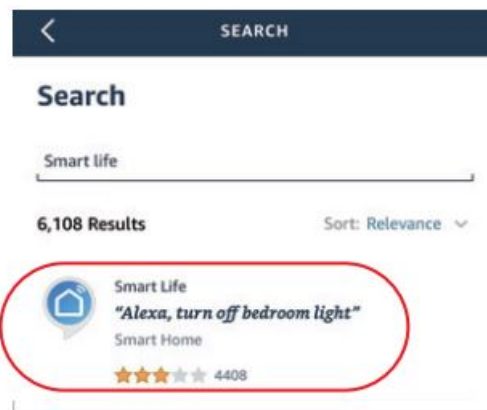

Google Home voice control instruction

Please add device into MiBoxer Zigbee 3.0 gateway (check details in page 6) and start following steps

1. Open Google Home App

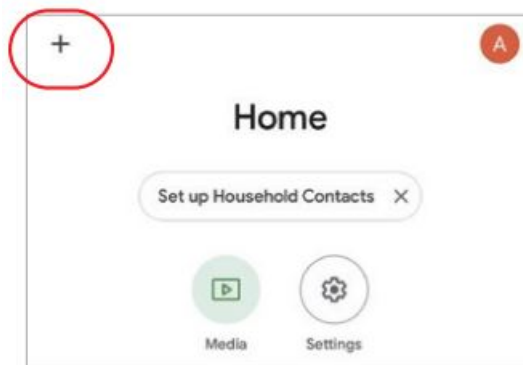

2. Click "+" on the top of left corner
3. Click "Set up device"

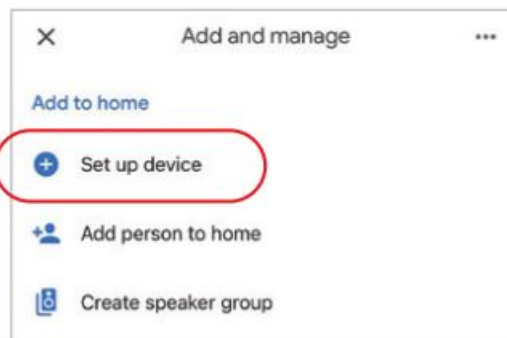

4. Click "Works with Google"

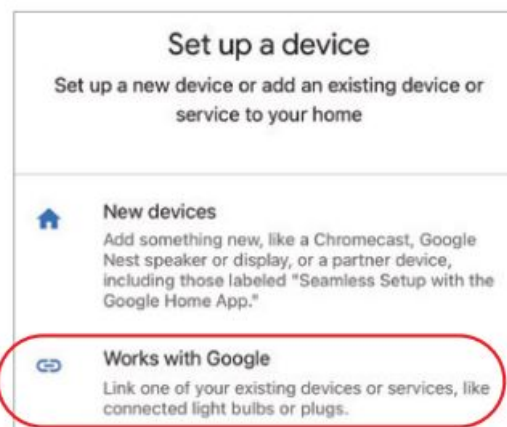

5. Click " " on the top of right corner
6. Type into "Smart life" and search

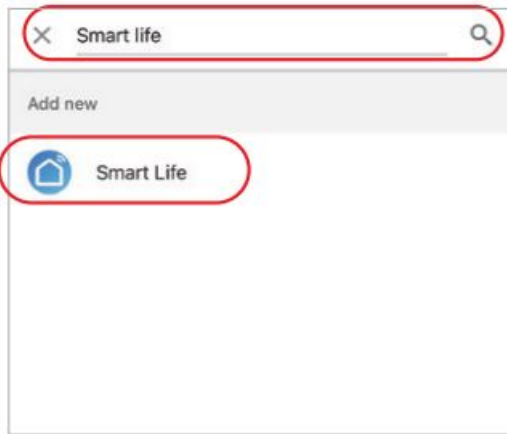

7. Click “Smart Life” skill, follow instructioin to finish configuration and start voice control

Attention

1. Please turn off power supply before installation.
2. Please ensure input voltage to be same as requirements from device.
3. Don't disassemble device if you are not expert, otherwise it will damage it.
4. Please do not use the light in the place with widely range metal area or strong electromagnetic wave nearby, otherwise, the remote distance will be seriously affected.

Scan QR code to watch Zigbee series video instruction Or enter into following link directly

<https://miboxer.com/light/video/zigbee.html>



Documents / Resources

	<p>MIBOXER FUT035Z 2 In 1 LED Controller [pdf] Instruction Manual FUT035Z 2 In 1 LED Controller, FUT035Z, 2 In 1 LED Controller, LED Controller, Controller</p>
--	---

References

- [Zigbee Series Video - MiBoxer](#)
- [Zigbee Series Video - MiBoxer](#)