

[Skip to content](#)

Manuals:

User Manuals Simplified.



MIBOXER B8 8-Zone Smart Panel Remote Controller Installation Guide

[Home](#) » [MiBOXER](#) » MIBOXER B8 8-Zone Smart Panel Remote Controller Installation Guide



Mi. light
Subordinate New Brand

8-Zone Smart Panel Remote Controller
Model No.: B8

- Contents** [hide](#)
[1 Features](#)
[2 Parameters](#)
[3 Installation/ Dismantlement](#)
[4 Linking Instructions](#)
[5 Documents / Resources](#)
[6 Related Posts](#)

Features

This 8-zone smart panel remote is made of an elegant salinity panel and high-precision touching IC; touching is more stable and sensitive. And adopt worldwide used 2.4GHz frequency, GFSK control method, with the features of low power consumption, long-distance transmitting, strong anti-interference, and fast communication rate; can control specified Mi-Light smart light with color, color temperature, saturation, and brightness changing. Working on all our MiBoxer LED lamps, controller and panel controllers, etc.

Parameters

Model No.: B8		Transmission Frequency: 2.4GHz
Working Voltage: 3V(2*AAA Battery) / DC3.3V		Modulation Method: GFSK
Transmitting Power: 6dBm		Control Distance: 30m
Standby Power: 30uA		Working Temp.: -20~60 °C
		Size: 106*146*20mm
Panel Remote	Compatible	Compatible Products
Controller Name	Remote Model	
8-Zone Smart Panel	FUT089	RGB+CCT series
Remote Controller		LED Bulb series
		LED Floodlight series
		5 in 1 Smart LED Controller

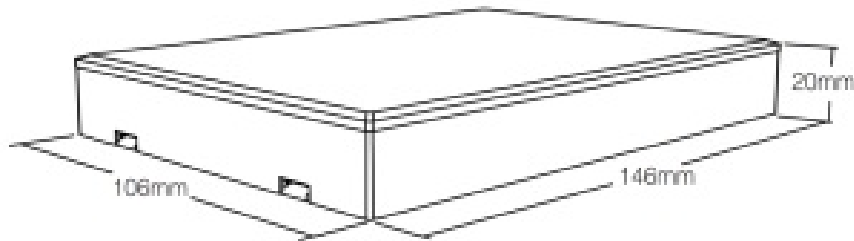

Function of keys

Remark:
When touching the button, the LED indicates the lamp will flash once with a different sound(Touch slider with no sound).

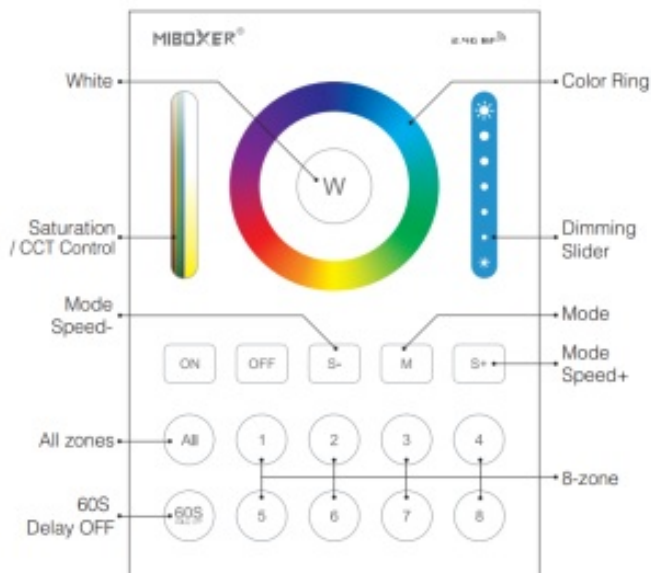

Touch the color ring to change colors.



Under white light mode, adjust color temperature; Under color light mode, change color saturation.



Slide the brightness slider to adjust the brightness.

W Press the button to get white light.

ON Turn on the linked lights. Long press the "ON" button for 10 seconds to set up the button sound.

OFF Turn off the linked lights. Long press the "OFF" button for 10 seconds to close the button sound.

60S Delay OFF Press the button, to open the "60S delay " Function, the indicating lamp will shine; Press again cancel the "60S delay" Function, the indicating lamp will be off.

M Dynamic mode switching button.

S- Lower the dynamic mode speed.

S+ Accelerate the dynamic mode speed.

ALL Press the "ALL" button, to control all linked lights, and the indicating lamp shine meanwhile.

1.....8 Press 1-8 zone, to control the corresponding ... zone linked lights, and indicate the lamp will shine.

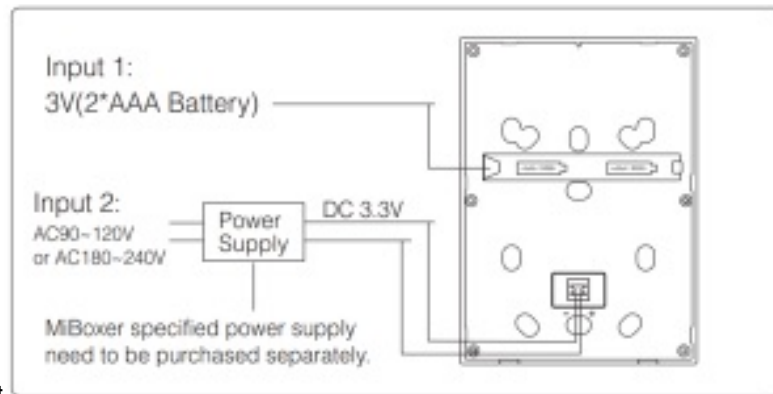
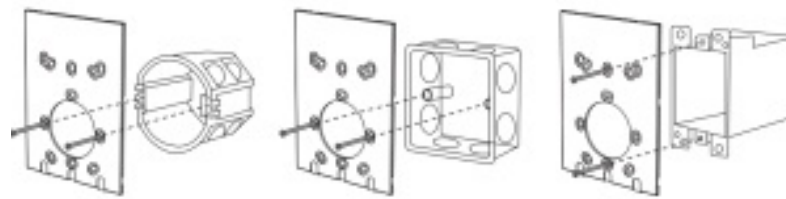

Installation/ Dismantlement

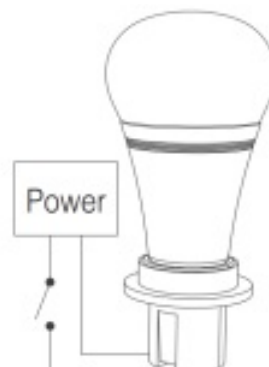
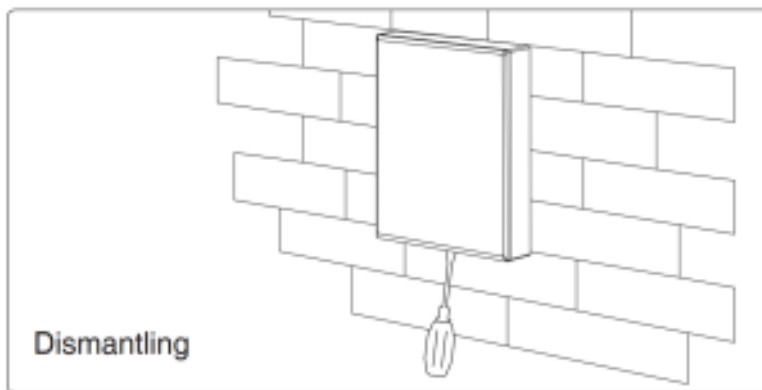
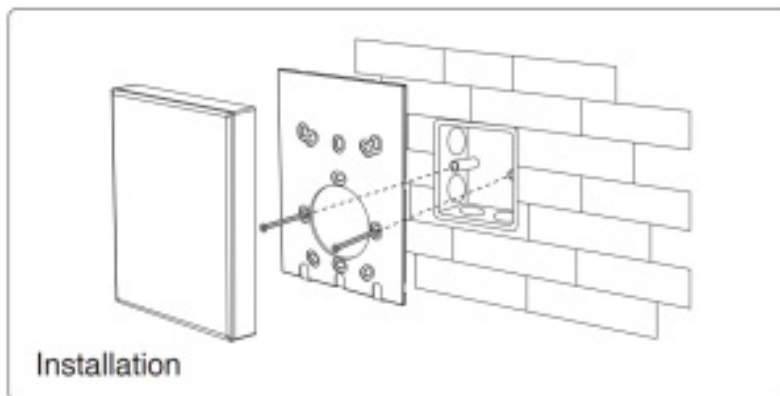

Linking Instructions

- 1 Click the 1-8 zones button you want to link, the corresponding indicating lamp will shine.
2. Switch off the light, after 10 seconds switch on again

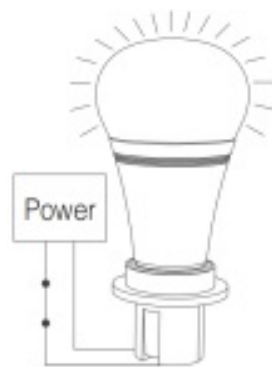

3 .hen the light is on, short press " " 3 times within 3 seconds

4. The light blinks 3 times slowly means the linking is done successfully.



If the light does not blink slowly, the linking failed, Pls switch off the light again, and follow the above steps again.

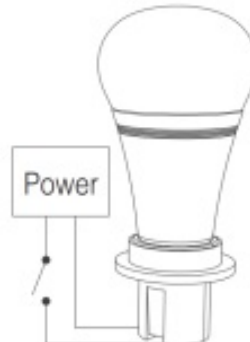

Unlinking Instructions

1 . Click the 1-8 zones button you want to unlink, the corresponding indicating lamp will shine. Unlinking must be the same zone with the Linking

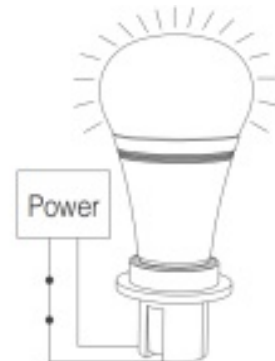

2 . Switch off the light, after 10 seconds switch on again.

3 . When the light is on, short press " " 5 times within 3 seconds

4 . The light blinking 10 times quickly, means unlinking successfully.



If the light does not blink quickly, the unlink failed, pls switch off the light again, and follow the above steps to unlink again.



Made in China

Documents / Resources



[MIBOXER B8 8-Zone Smart Panel Remote Controller](#) [pdf] Installation Guide
B8, 8-Zone Smart Panel Remote Controller

Manuals+,

- [home](#)
- [privacy](#)