



MiBOXER 5 in 1 LED Controller Zigbee 3.0 + 2.4G Instruction Manual

[Home](#) » [MiBOXER](#) » MiBOXER 5 in 1 LED Controller Zigbee 3.0 + 2.4G Instruction Manual 

Contents

- [1 MiBOXER 5 in 1 LED Controller Zigbee 3.0 + 2.4G Instruction](#)
- [2 Product features](#)
- [3 Set up output mode](#)
- [4 Compatible with these 2.4G RF remote controls](#)
- [5 \(Purchased separately\)RF Remote control instruction](#)
- [6 Smartphone APP control instruction](#)
- [7 Philips Hue control instruction](#)
- [8 Alexa voice control instruction](#)
- [9 Google Home voice control instruction](#)
- [10 DMX512 LED Transmitter Control](#)
- [11 Attention](#)
- [12 Documents / Resources](#)
 - [12.1 References](#)
- [13 Related Posts](#)



MiBOXER 5 in 1 LED Controller Zigbee 3.0 + 2.4G Instruction



Product features

Made by new Zigbee 3.0 wireless transmitting technology with low power consumption, strong ability to build network automatically and anti-interference. with MiBoxer Zigbee gateway to get wireless dimming color, remote control, timing control, group control, music rhythm function. Support 2.4G RF remote control.



- 16 Millions of colors to choose
- Color temperature adjustable
- Dim brightness
- Follow Zigbee 3.0 standard protocol
- Support Zigbee 3.0 remote control (Zigbee 3.0 gateway is needed)



- Support 2.4G Remote control
- Auto-transmitting & Synchronization
- Support Smartphone app control(Zigbee 3.0 gateway is needed)
- Support third party voice control(Zigbee 3.0 gateway is needed)
- DMX512 controllable (Only for RGB+CCT output mode DMX512 LED transmitter is needed)

Various control solution

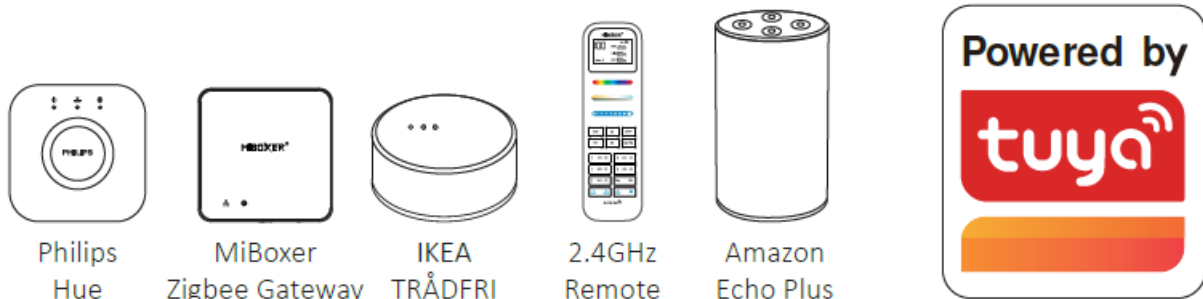

Set up output mode

Set up correct output mode based on the feature of lights Setting method: Press “SET” button continuously to switch output mode (attention: it will log out without operation within 3 seconds) Output mode sheet (confirm output mode based on color of indicator)

Indicator color	Red Light	Red Light	Red Light	Green Light	Blue Light
Output	Single Color	Dual White	RGB	RGBW	RGB+CCT

Compatible with these 2.4G RF remote controls

(Purchased separately)

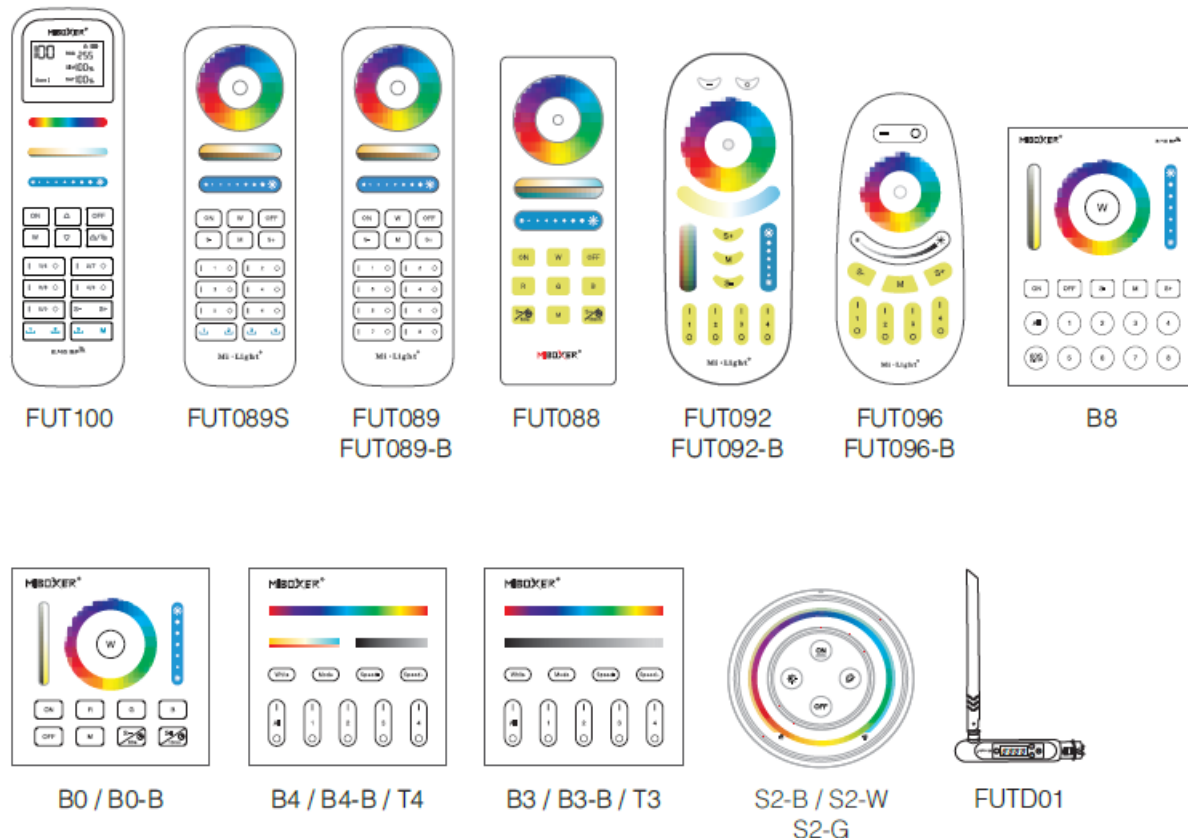

RF Remote control instruction

Linking Code Instructions

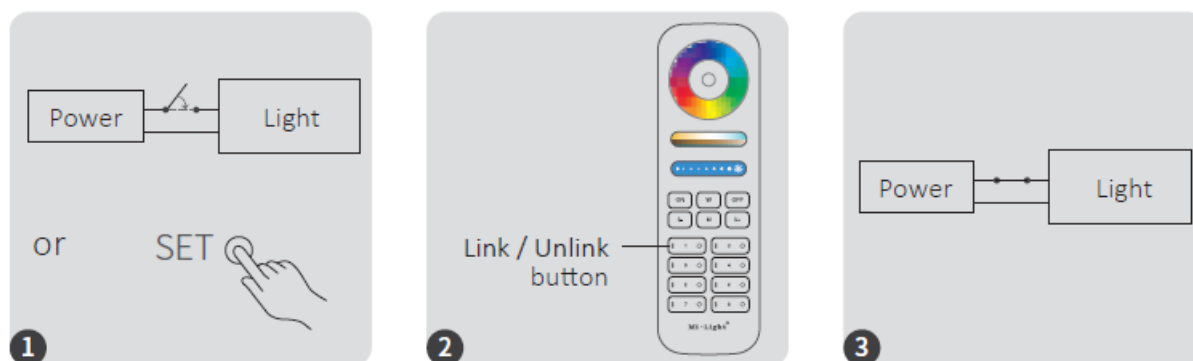

1. Power off 10 seconds and power on again or short press "SET" one time
2. Short press "I" button 3 times within 3 seconds.
3. Lights blink 3 times slowly means linking is done successfully.

Linking failed if light is not blinking slowly, Please follow above steps again. (Note: Light that have linked can't link again)

Unlinking Code Instructions



1. Power off 10 seconds and power on again or short press “SET” one time
2. Short press “I” button 5 times within 3 seconds.
3. Lights blink 10 times quickly means unlinking is done successfully.

Unlinking failed if light is not blinking quickly, Please follow above steps again. (Note: Light haven't linked that don't need to unlink)

Auto transmitting & Synchronization (only for remote control)

Remote signal auto transmitting

One light can transmit the signals from the remote control to another light within 30m, as long as there is a light within 30m, the remote control distance can be limitless.

Dynamic modes auto synchronization

Multi lights can synchronize if they are in same dynamic mode and linked with same remote (distance between each light is within 30m)

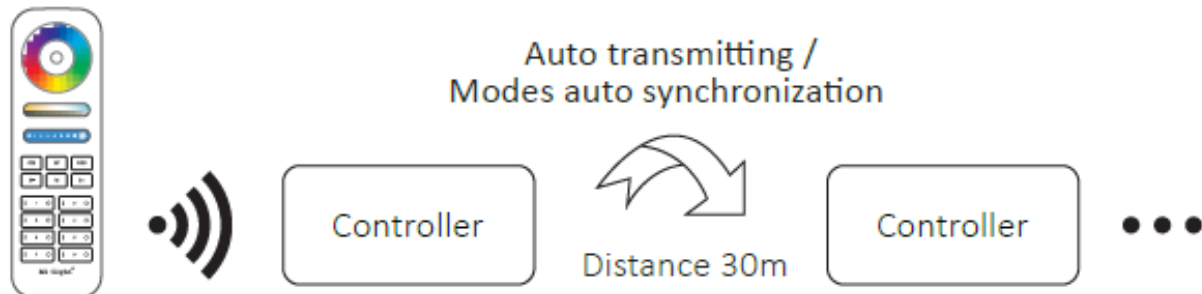

Dynamic mode table selection (only for remote control)

Select dynamic mode table 1:

While the light is in static mode, short press “S+” button 5 times quickly until blue light flashes 3 times slowly, static mode is activated successfully.

Select dynamic mode table 2:

While the light is in static mode, short press “S-” button 5 times quickly until yellow light flashes 3 times slowly, static mode is activated successfully.

Dynamic mode table 1 (default)

Number	Dynamic Mode	Brightness / Saturation / Speed
1	Mardi Gras	Adjustable
2	Automatic color change	
3	Sam	
4	Gemstone	
5	Twilight	
6	American	
7	Fat Tuesday	
8	Party	
9	Slow Color Splash	

Dynamic mode table 2 (need to switch manually)

Number	Dynamic Mode	Brightness / Saturation / Speed
1	Seven colors gradual change	Adjustable
2	White light Gradual change	
3	RGB gradual change	
4	Seven colors jump to change	
5	Jump to change randomly	
6	Red light gradual change +Flash 3 times	
7	Green light gradual change +Flash 3 times	
8	Blue light gradual change +Flash 3 times	
9	White light gradual change +Flash 3 times	

PWM high frequency / low frequency switching (only for remote control)

- **Switch to high frequency (16KHz):**

Press “OFF” button 1 time within three seconds and press “ON” button 5 times, Activated successfully once led light flashes 2 times quickly.

- **Switch to low frequency (250Hz):**

Press “ON” button 1 time within three seconds and press “OFF” button 5 times, Activated successfully once led light flashes 2 times slowly.

“Do Not Disturb” mode is activated and shut down (default activated)

Turn on “Do Not Disturb” mode (wide using in the area which have power failure frequently to save energy)

RF Remote turn on and turn off instruction

Turn on “Do Not Disturb” mode:

Press “OFF” button three times within three seconds and press “ON” button three times, Activated successfully once led light flashes four times quickly.

Attention: Do not disturb mode is activated

1. When the light is OFF status (For example: Use app or remote to turn off light) The light is OFF status once you turn off power and turn on again. (User must turn off and turn on power twice times to activate light or use APP / remote to activate light)
2. When the light is ON status The light is ON status once you turn off and turn on power one time.

Turn off “Do Not Disturb” mode:

Press “ON” button three times within three seconds and press “OFF” button three times, closed successfully once led light flashes four times slowly.

Attention: The light will be always “ON” status if you turn on and turn off power once user closed “Do Not Disturb” mode.

App turn on and off “Do Not Disturb” mode instruction (check details in page 8)

Smartphone APP control instruction

Added Zigbee 3.0 gateway into “Tuya Smart” App (please review instruction of Zigbee 3.0 gateway)

1. Connect with power supply.
2. Pairing network (attention: factory default is pairing network).
Way one: Turn off and turn on light 3 times or over 3 times continuously, the light is in breathing status.
Way two: Long press ” SET ” key until indicator light flashing.
3. Open “Tuya Smart” APP to click Zigbee gateway, then click “Add sub device”.
4. Click “Indicator is flashing quickly”.
5. Support APP dimming or group control and etc once added successfully.

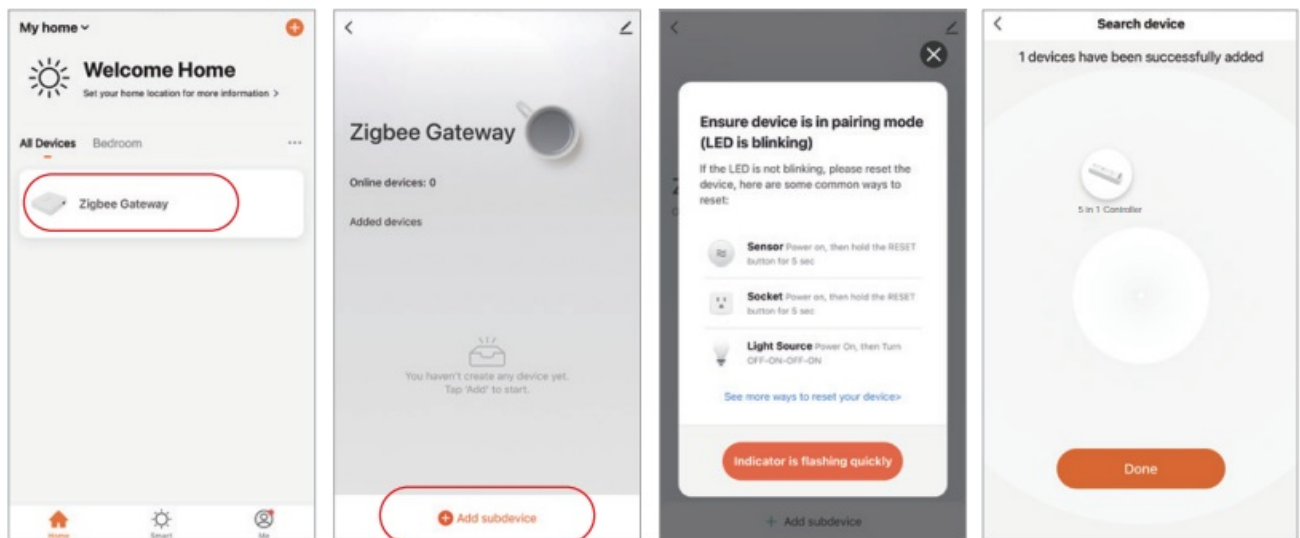

App turn on and off “Do Not Disturb” mode (default activated)

Click the light which need to be set up or group control — click “More” — click “Power-on behavior” — turn on or off

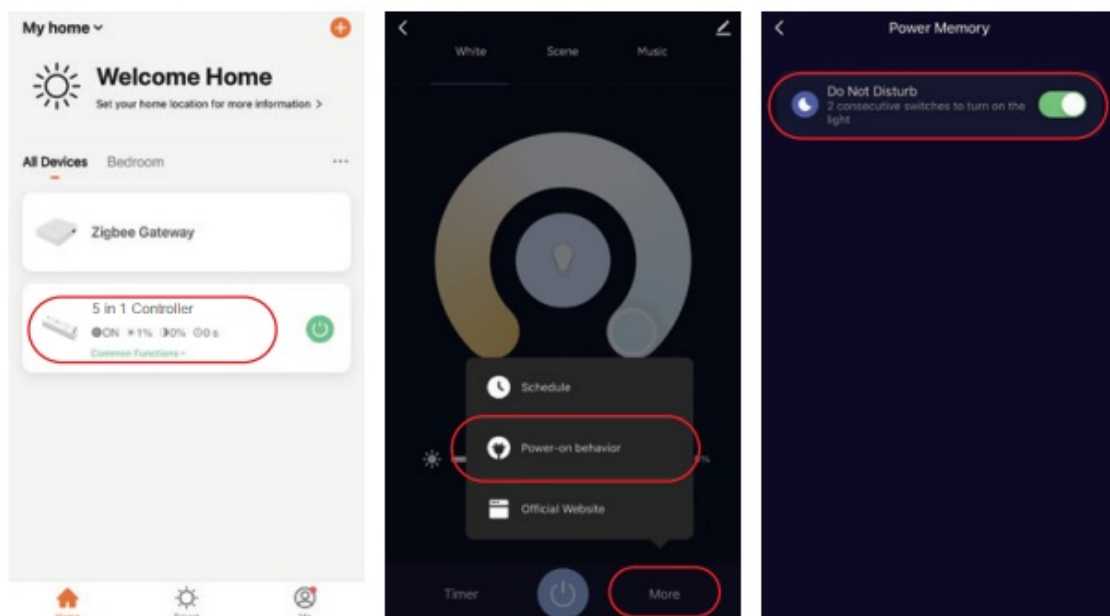

Philips Hue control instruction

Added “Philips Hue” into APP

1. Connect with power supply
2. Pairing network (attention: factory default is pairing network)
Way one: Turn off and turn on light 3 times or over 3 times continuously, the light is in breathing status. **Way two:** Long press ” SET ” key until indicator light flashing.
3. Open “Philips Hue” App to click “SETTINGS” and click “Lights”
4. Click “+” on the top of right corner
5. Click “Search”
6. Click “Start configuration”, Follow the app instruction to complete configuration

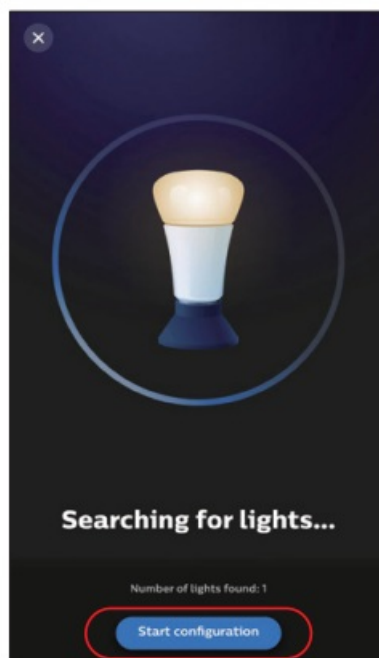
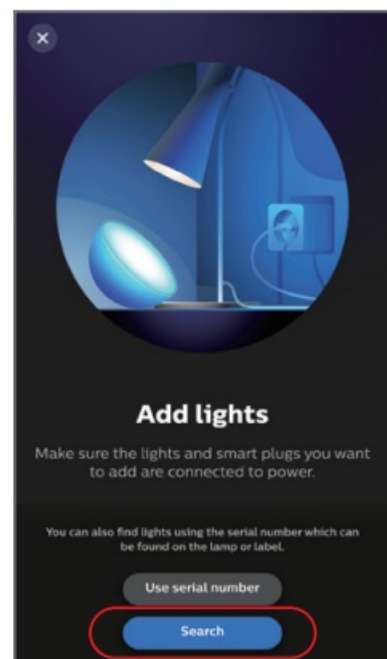
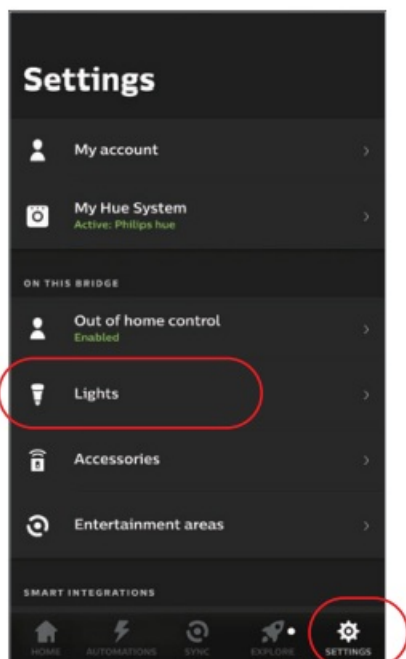

Alexa voice control instruction

Alexa control (Audio support Zigbee 3.0 protocol)

You can connect directly if your Amazon ECHO already is built-in zigbee 3.0 protocol, following model with zigbee 3.0 protocol: Amazon ECHO Plus (2nd Gen), ECHO (4th Gen), ECHO Studio, ECHO Show (2. Gen)

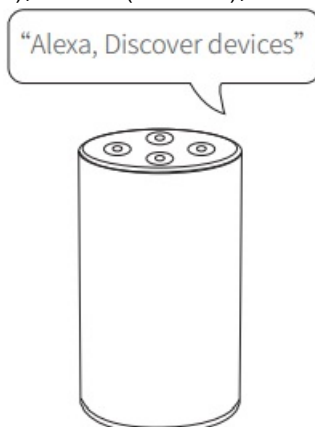

1. Connect with power supply
2. Pairing network (attention: factory default is pairing network)
Way one: Turn off and turn on light 3 times or over 3 times continuously, the light is in breathing status.
Way two: Long press " SET " key until indicator light flashing.
3. Say to Amazon ECHO "Alexa, Discover devices" Wait for a while to discover device, Voice control is activated

Alexa control (Audio don't support Zigbee 3.0 protocol)

Please add device into Miboxer Zigbee 3.0 gateway if your Alexa don't support zigbee 3.0 protocol (check details in page 8), then start following steps

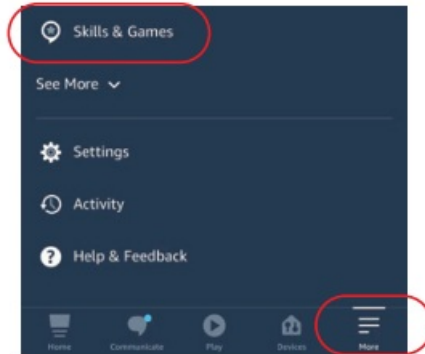

1. Open Alexa App
2. Click "More" on the bottom of right corner
3. Click "Skills & Games"

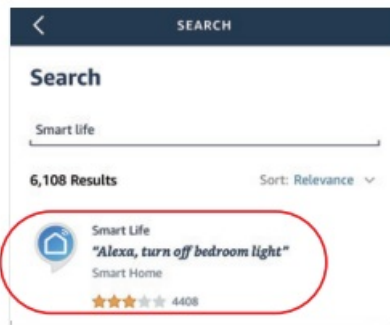

4. Click " " on the top of right corner
5. Type into "Smart life" and search
6. Click "Smart Life" skill, follow instruction to finish configuration and start voice control

Google Home voice control instruction

Please add device into MiBoxer Zigbee 3.0 gateway (check details in page 8) and start following steps

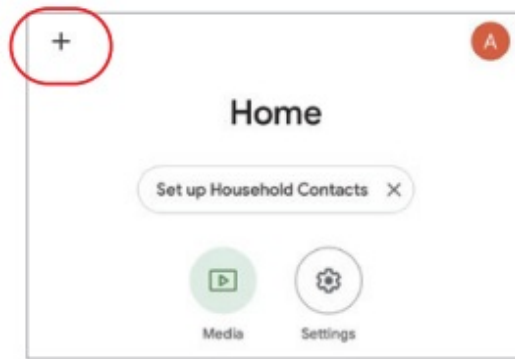

1. Open Google Home App
2. Click “+” on the top of left corner

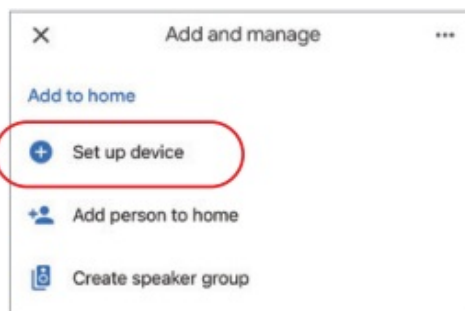

3. Click “Set up device”

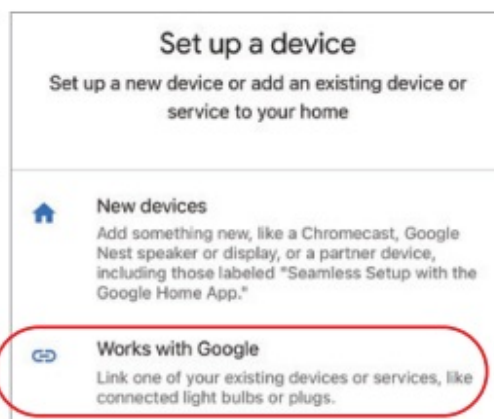

4. Click “Works with Google”

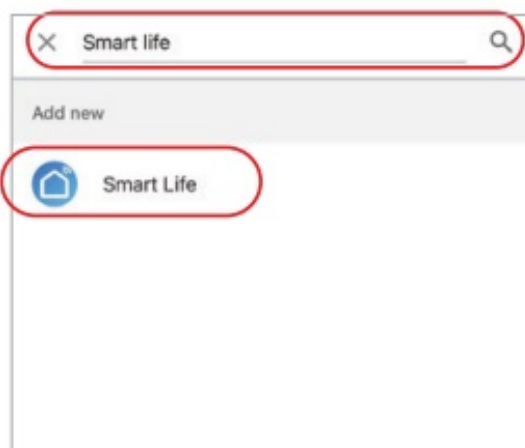

5. Click “ ” on the top of right corner
6. Type into “Smart life” and search
7. Click “Smart Life” skill, follow instruction to finish configuration and start voice control

DMX512 LED Transmitter Control

(Purchased separately)

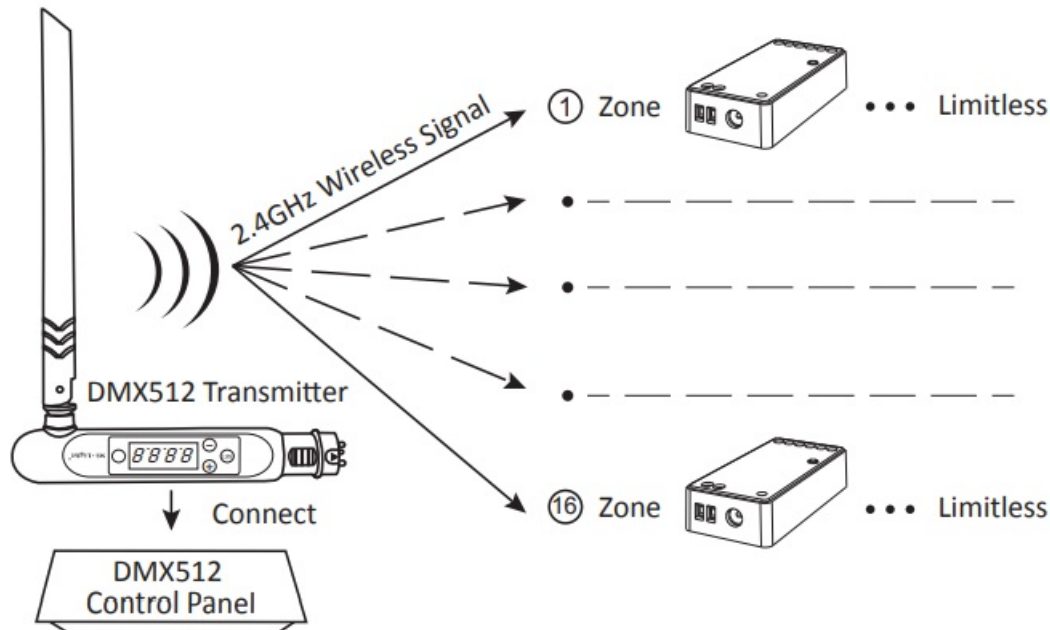

DMX512 LED Transmitter Link/Unlink

1. Follow instruction of DMX512 transmitter (FUTD01), Choose the zone for the light by pressing “+” or “-” (e.g. “CH12” means zone 12)

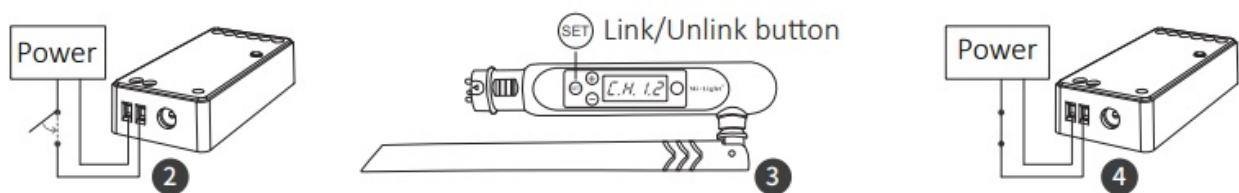

Link

The controller is powered off for 10 seconds and then powered on, or press “SET” button 1 time
Short pr SETess “ ” 3 times within 3 seconds while the indicator of controller is ON
Link is done once indicator of controller flashes 3 times slowly

Unlink

The controller is powered off for 10 seconds and then powered on, or press “SET” button 1 time.
Short pr SET Press “ ” 5 times within 3 seconds while the indicator of controller is ON
Unlink is done once indicator of controller flashes 10 times quickly

If the link or unlink failed, please follow the above steps again.

Connect to LED strip diagram

Controller input voltage must be in accordance with the required voltage of LED Strips.

Connect to Single Color LED strip diagram





otherwise, the remote distance will be seriously affected.



Scan QR code to watch Zigbee series video instruction Or enter into following link directly
<https://miboxer.com/light/video/zigbee.html>



Documents / Resources

			
5 in 1 LED Controller (Zigbee 3.0 + 2.4G) Instruction Manual			
<hr/>			
Contents		MiBOXER 5 in 1 LED Controller Zigbee 3.0 + 2.4G [pdf] Instruction Manual	
Product Details	1	5 in 1 LED Controller Zigbee 3.0 2.4G, 5 in 1 LED Controller, LED Controller, Zigbee 3.0 2.4G L	
Key Features	2	ED Controller, Zigbee 3.0 LED Controller, Zigbee 2.4G LED Controller, Zigbee LED Controller	
LED Controller	3		
LED Controller	4		
LED Controller	5		
LED Controller	6		
LED Controller	7		
LED Controller	8		
LED Controller	9		
LED Controller	10		
LED Controller	11		
LED Controller	12		
LED Controller	13		
LED Controller	14		
LED Controller	15		
LED Controller	16		
LED Controller	17		
LED Controller	18		

References

- [!\[\]\(d328bb1c8b293dce97ce8ae48fe06a23_img.jpg\) Zigbee Series Video - MiBoxer](#)