



MIBOXER 2 in 1 LED Controller (WiFi + 2.4G) Instruction Manual

[Home](#) » [MiBOXER](#) » MIBOXER 2 in 1 LED Controller (WiFi + 2.4G) Instruction Manual 

MIBOXER 2 in 1 LED Controller (WiFi + 2.4G)



Contents







- 1 Product features
- 2 Set up output mode
- 3 PUSH Dimming
- 4 Compatible with these 2.4G RF remote controls (Purchased separately)
 - 4.1 Linking Code Instructions
 - 4.2 Unlinking Code Instructions
 - 4.3 Auto transmitting (2.4G RF remote signal)
 - 4.4 PWM high frequency / low frequency switching
 - 4.5 "Do Not Disturb" mode is activated and shut down (default activated)
- 5 Smartphone APP control instruction
 - 5.1 Network Configuration (Don't support 5G router)
 - 5.2 App turn on and off "Do Not Disturb" mode (default activated)
- 6 Alexa voice control instruction
- 7 Google Home voice control instruction
- 8 Attention
- 9 Documents / Resources
- 10 Related Posts

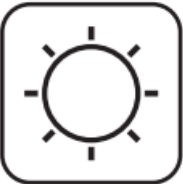

Product features



This product uses WiFi + Bluetooth + 2.4G wireless transmission technology, low power consumption, strong anti-

interference ability. WiFi + Bluetooth connect network can greatly enhance the connect network experience. When the router is disconnected, Bluetooth can also directly connect and control equipment at close range.

Artier successful network configuration using [Toya Smart] app to achieve wireless dimming, remote control, group control, scene control, timing control, music movement, biorhythm, sleep plan, wake plan, one key execution, automation, etc. functions. And it supports 2.4G remote control.

	Color temperature adjustable
	Dim brightness
	2.4G RF wireless transmission technology
	Wi-Fi wireless control support long-range control
	Auto-transmitting (only for remote control dimming)
	Device sharing
	Tap-to-Run & automation

	Timing setting / countdown turn on / off LED light
	Do not disturb mode
	Remote control Control distance 30m
	Smartphone app control
	Support third party voice control
	Group control
	Biorhythm
	Support music rhythm

	Sleep / wake up plan
	Support scene customization

Set up output mode

Set up correct output mode based on the feature of lights Setting method: Press “SET” button continuously to switch output mode (attention: it will log out without operation within 3 seconds)
Output mode sheet (confirm output mode based on color of indicator)

Indicator color	Red Light	Green Light
Output	Single Color Mode	Dual White Mode

PUSH Dimming

Short press PUSH switch:

Turn ON/OFF light

Long press PUSH switch:

- Steeples dimming brightness.
- Long press and release your finger, then repeat long pressing to increase or decrease brightness

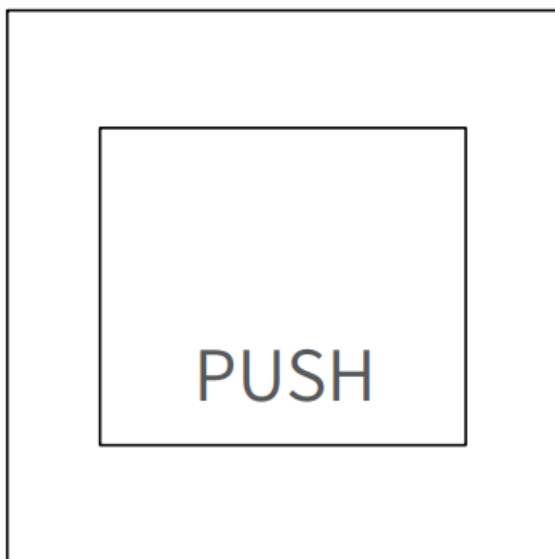

Compatible with these 2.4G RF remote controls Purchased separately)

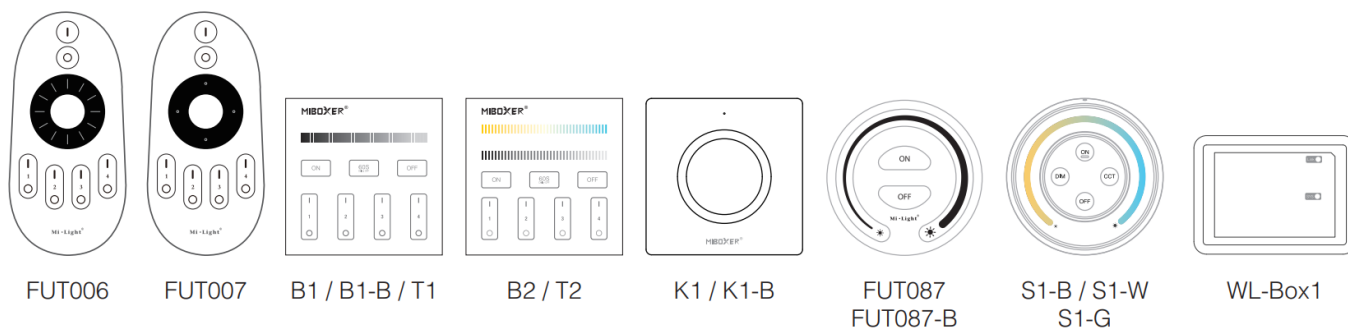

2.4G RF Remote control instruction

Linking Code Instructions

Power off 10 seconds and power on again or short press “SET” one time or turn on light via PUSH switch

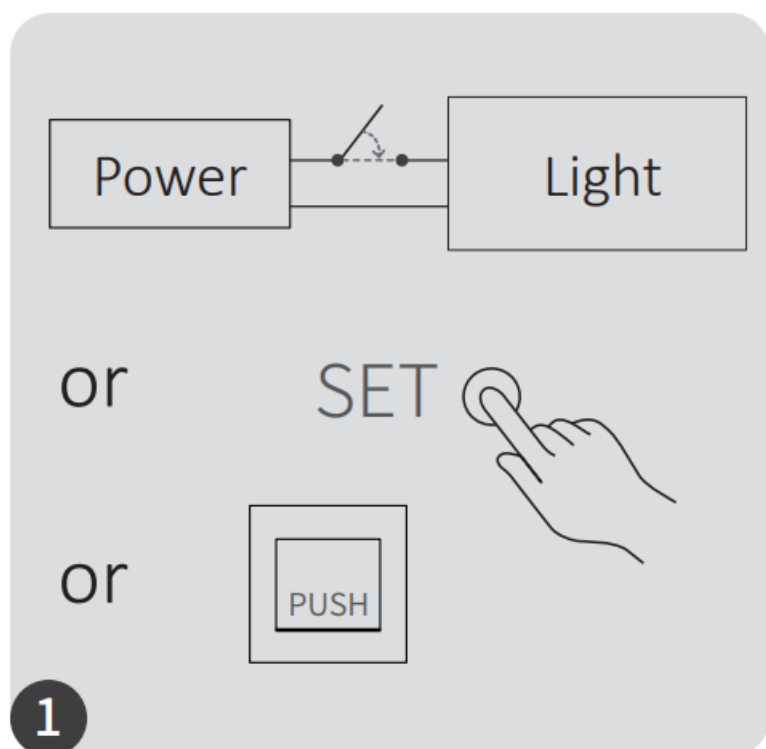

Short press "I" button 3 times within 3 seconds.

Link / Unlink
button

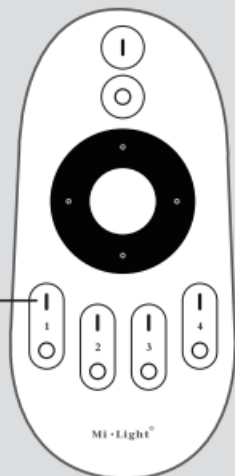

2

Lights blink 3 times slowly means linking is done successfully.

Power



Light

3



Linking failed if light is not blinking slowly, Please follow above steps again. (Note: Light that have linked can't link again)

Unlinking Code Instructions

Power off 10 seconds and power on again or short press "SET" one time or turn on light via PUSH switch

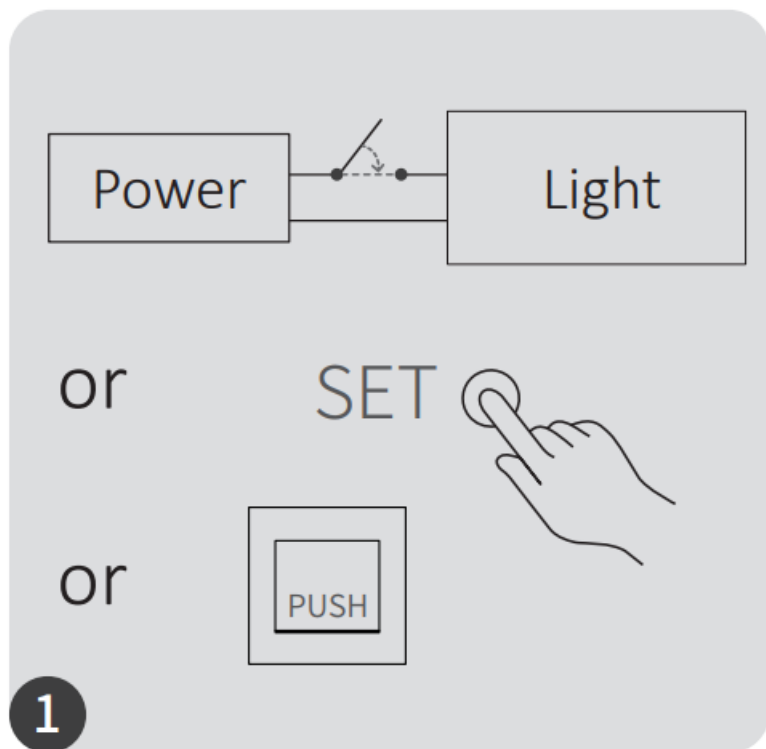

Short press "I" button 5 times within 3 seconds

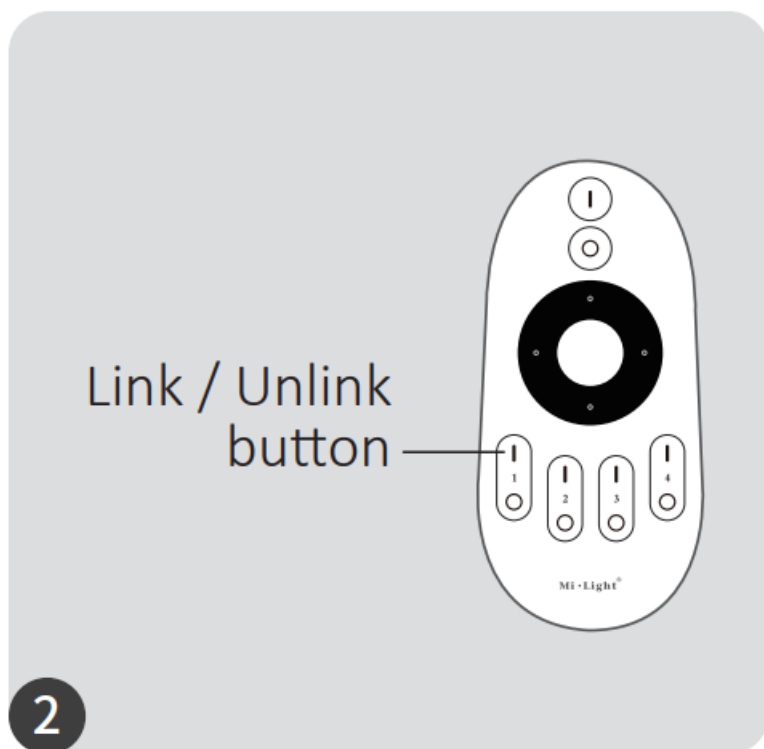

Lights blink 10 times quickly means unlinking is done successfully

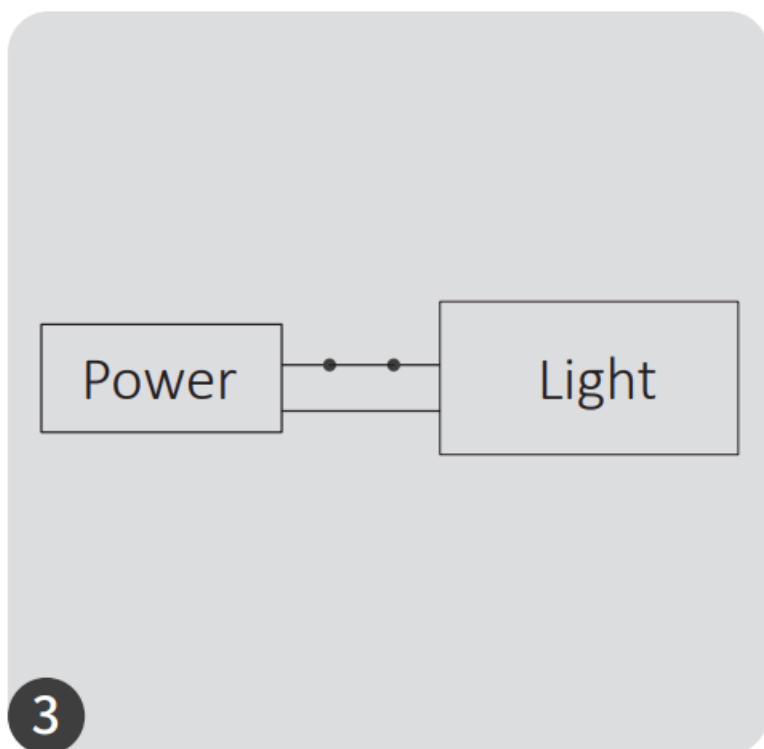

Unlinking failed if light is not blinking quickly, Please follow above steps again. (Note: Light haven't linked that don't need to unlink)

Auto transmitting (2.4G RF remote signal)

The light can transmit remote signal to another light automatically while the distance between lights are 30m, the remote control distance is unlimited. (Attention: all lights must be linked with same remote)

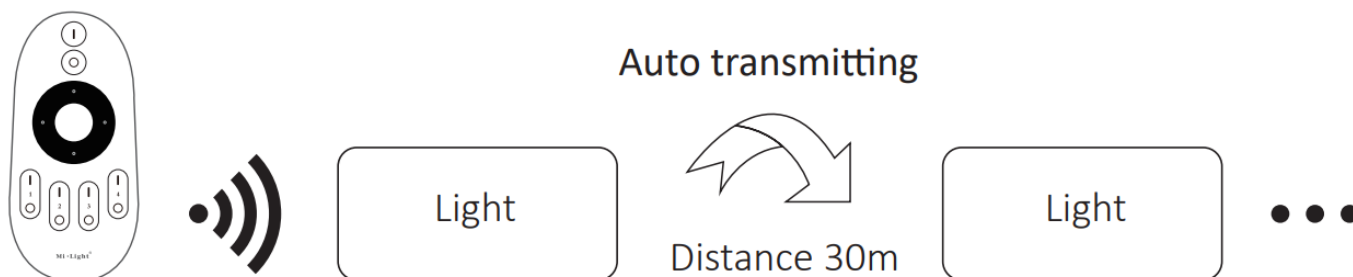

PWM high frequency / low frequency switching

Switch to high frequency (16KHz): Press "OFF" button 1 time within three seconds and press "ON" button 5 times, Activated successfully once led light flashes 2 times quickly.

Switch to low frequency (250Hz):

Press "ON" button 1 time within three seconds and press "OFF" button 5 times, Activated successfully once led light flashes 2 times slowly.

Do Not Disturb" mode is activated and shut down (default activated)

Turn on "Do Not Disturb" mode (wide using in the area which have power failure frequently to save energy)

2.4G RF Remote turn on and turn off instruction

Press “OFF” button three times within three seconds and press “ON” button three times, Activated successfully once led light flashes four times quickly.

Attention: Do not disturb mode is activated

1. When the light is OFF status (For example: Use app or remote to turn off light)

The light is OFF status once you turn off power and turn on again. (User must turn off and turn on power twice times to activate light or use APP / remote to activate light)

2. When the light is ON status The light is ON status once you turn off and turn on power one time.

Turn off “Do Not Disturb” mode:

Press “ON” button three times within three seconds and press “OFF” Press “ON” button three times button three times, closed successfully once led light flashes four times slowly.

Attention: The light will be always “ON” status if you turn on and turn off power once user closed “Do Not Disturb” mode.

App turn on and off “Do Not Disturb” mode instruction (check details in page 7)

Smartphone APP control instruction

Network Configuration (Don't support 5G router)

1. Download and install [Tuya Smart] app Search for [Tuya Smart] in Apple or Google store or scan following QR code to download and install the app. Please open the app click ” Register ” button to create account while using it in the first time, Log in directly if you already had account.



2. Network Configuration

(1) Connect controller with power supply.

(2) Confirm indicator light is flashing quickly (2 flashes per second),

If indicator light isn't in fast flashing state, there are two ways to enter:

- Long press ” SET ” key until indicator light flashing quickly.
- Power off and on controller 3 times.

(3) Connect phone with home WiFi network in the 2.4GHz frequency.

- (4) Open homepage of app and click ” + ” button at the upper right corner of page.
- (5) Click ” Lighting ” on the left side of page and then click ” Light Source (BLE+Wi-Fi) ”
- (6) Follow app prompts to complete configuration.

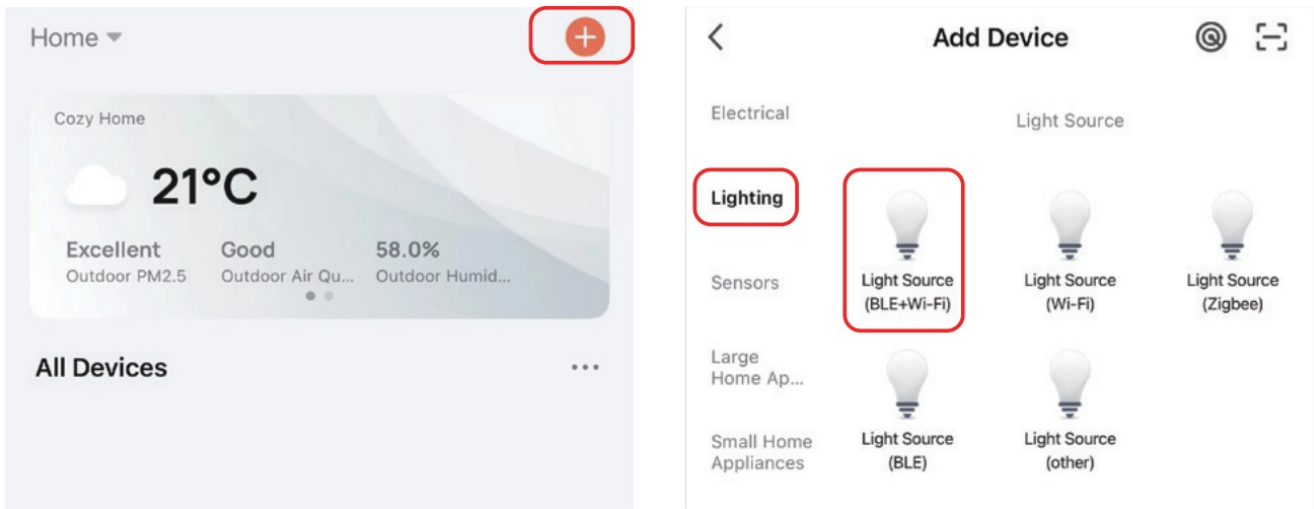

App turn on and off “Do Not Disturb” mode (default activated)

Click the light which need to be set up or group control — click “More” — click “Power-on behavior” — turn on or of

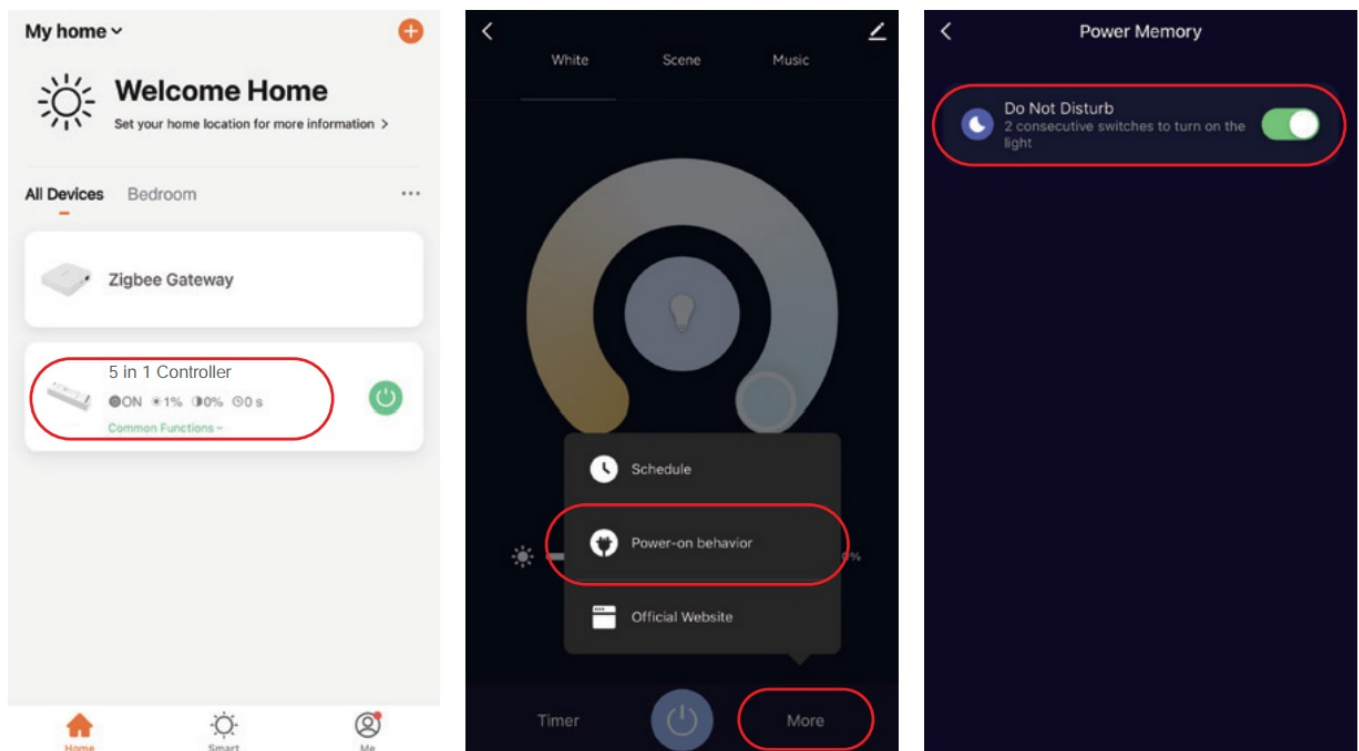

Alexa voice control instruction

Please add device into [Tuya Smart] app (check details in page 6), then start following steps

1. Open Alexa App
2. Click “More” on the bottom of right corner
3. Click “Skills & Games”

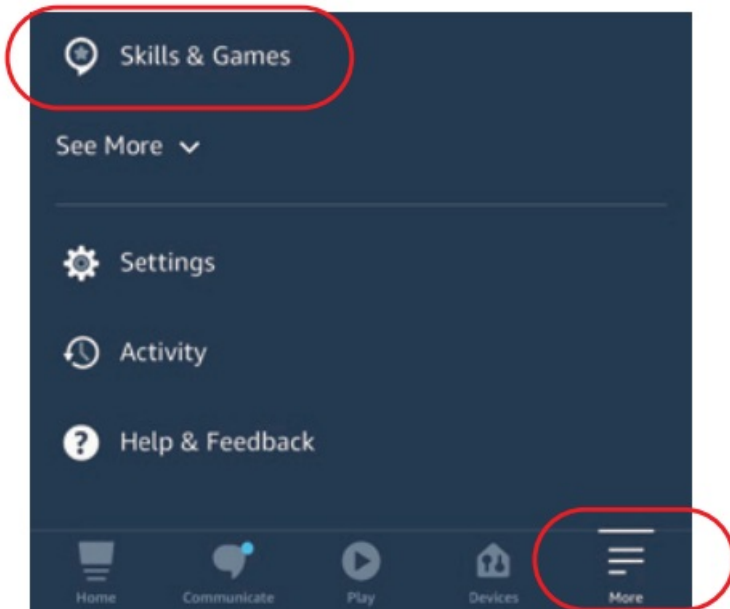

4. Click “ ” on the top of right corner
5. Type into “Smart life” and search



6. Click “Smart Life” skill, follow instruction to finish configuration and start voice control

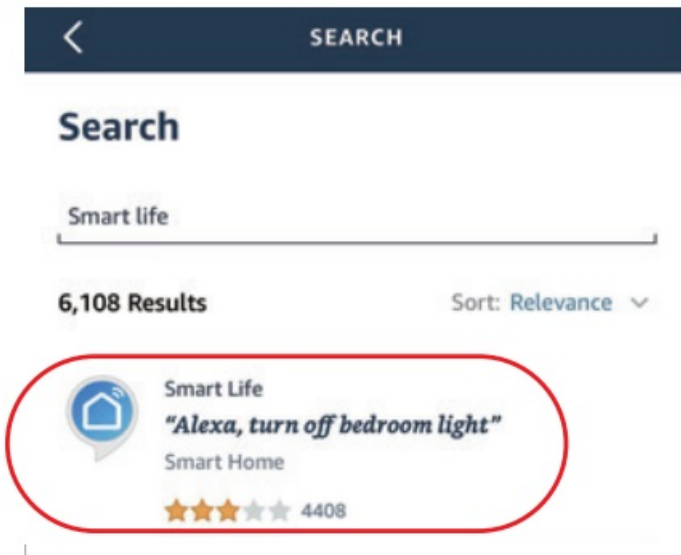

Google Home voice control instruction

Please add device into [Tuya Smart] app (check details in page 6), then start following steps

1. Open Google Home App
2. Click “+” on the top of left corner

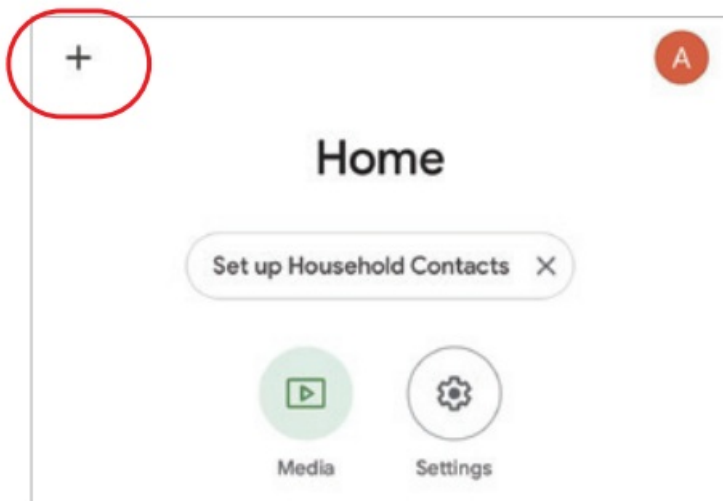

3. Click "Set up device"

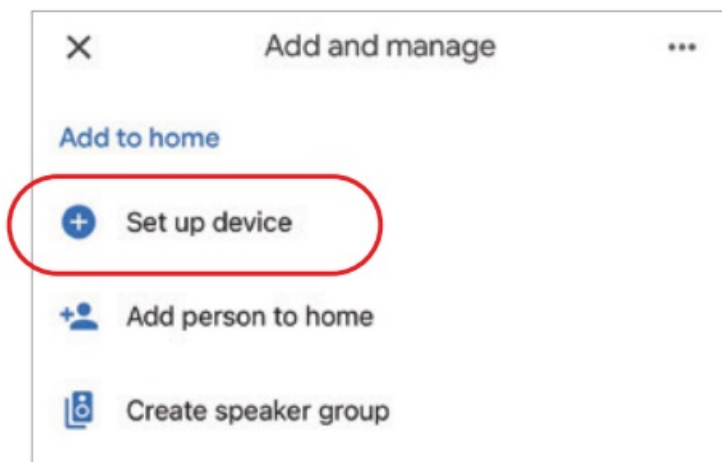

4. Click "Works with Google"

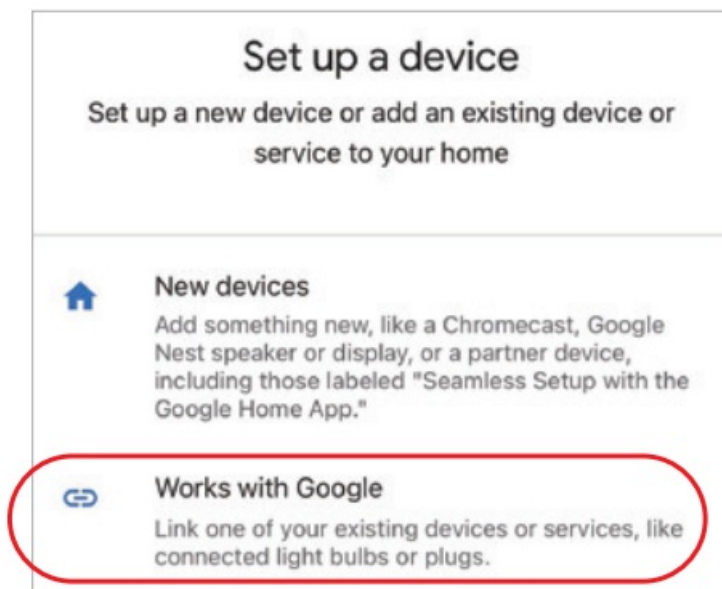

5. Click " " on the top of right corner

6. Type into "Smart life" and search

7. Click "Smart Life" skill, follow instruction to finish configuration and start voice control.

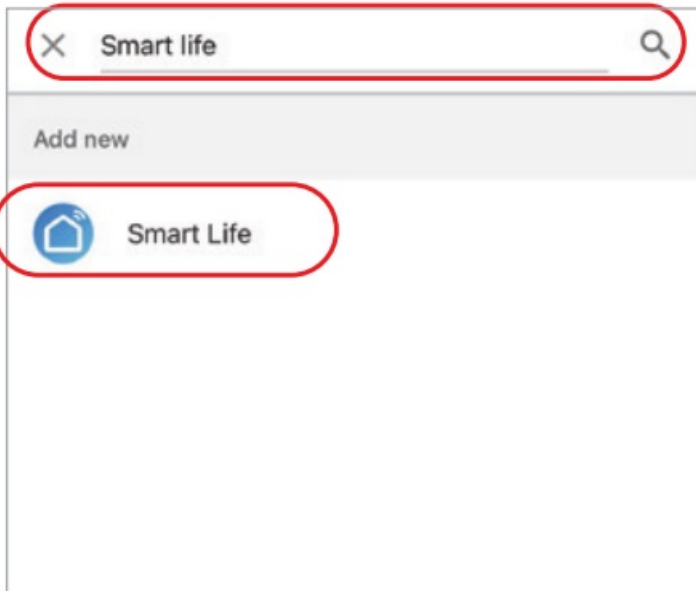

Attention

1. Please turn off power supply before installation.
2. Please ensure input voltage to be same as requirements from device.
3. Don't disassemble device if you are not expert, otherwise it will damage it.
4. Please do not use the light in the place with widely range metal area or strong electromagnetic wave nearby, otherwise, the remote distance will be seriously affected.



Scan QR code to watch WiFi series video instruction Or enter into following link directly

https://miboxer.com/light/video/wifi_2.html



MiBOXER®

2 in 1 LED Controller WiFi 2.4G, 2 in 1, LED Controller WiFi 2.4G, Controller WiFi 2.4G

2 in 1 LED Controller WiFi 2.4G, 2 in 1, LED Controller WiFi 2.4G, Controller WiFi 2.4G