

# MeTra 99-8152 Vehicles With Factory Navigation Installation Guide



## Contents

- [1 INSTALLATION INSTRUCTIONS FOR PART 99-8152](#)
- [2 Lexus GS SERIES 1998-2005](#)
  - [2.1 Not For Use In Vehicles With Factory Navigation](#)
  - [2.2 99-8152 DASH DISASSEMBLY](#)
    - [2.2.1 LEXUS GS SERIES 1998-2005](#)
  - [2.3 99-8152 KIT ASSEMBLY](#)
    - [2.3.1 DIN MOUNT RADIO PROVISION WITH POCKET](#)
    - [2.3.2 ISO MOUJIT RADIO WITH POCKET](#)
  - [2.4 99-8152 FINAL ASSEMBLY](#)
    - [2.4.1 FINAL ASSEMBLY](#)
    - [2.4.2 FINAL WIRING CONNECTIONS](#)
    - [2.4.3 METRA / EIA WIRING CODE](#)
  - [2.5 NOTES](#)
- [3 Documents / Resources](#)
  - [3.1 References](#)
- [4 Related Posts](#)

## INSTALLATION INSTRUCTIONS FOR PART 99-8152

### APPLICATIONS

#### **Lexus GS SERIES 1998-2005**

**Not For Use In Vehicles With Factory Navigation**



## KIT FEATURES

---

- DIN Radio Provision with pocket
- ISO Radio Provision with pocket

## KIT COMPONENTS

---

A) Radio Housing B) Mounting Brackets C) ISO Snap In Brackets D) ISO Trim Plate E) (2) #8 x 3/8" Screws

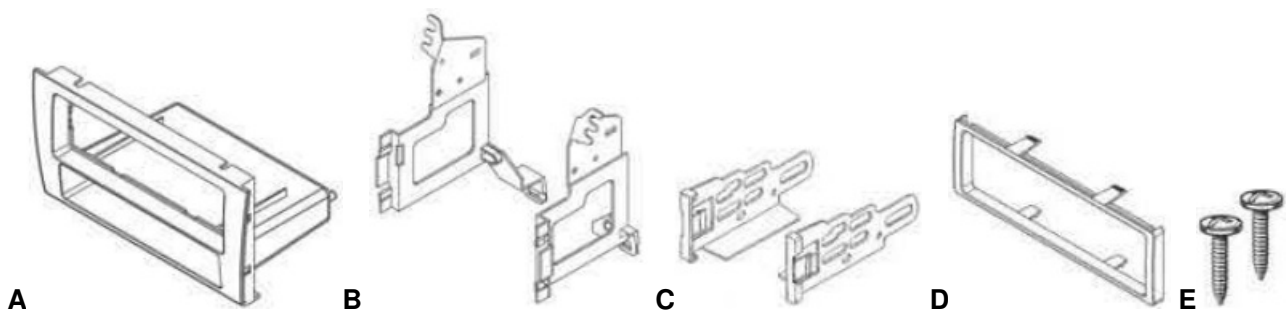

### TOOLS REQUIRED:

Panel Removal Tool or Small Flat Blade Screwdriver



Phillips Screwdriver



## 99-8152 DASH DISASSEMBLY

### LEXUS GS SERIES 1998-2005

- 1 Disconnect the negative battery terminal to prevent an accidental short circuit.
- 2 Unsnap and remove vent/clock assembly from above climate controls. ( **Figure A** )



3 Unsnap and remove ashtray assembly from below radio. **(Figure B)**

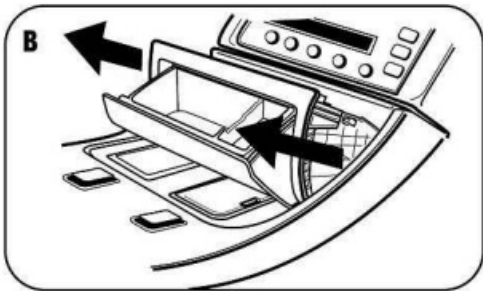

4 Remove two screws from behind vent/clock assembly. **(Figure C)**

5 Remove (2) screws from behind ashtray assembly. **(Figure C)**

6 Unplug and remove radio/climate controls assembly. **(Figure C)**

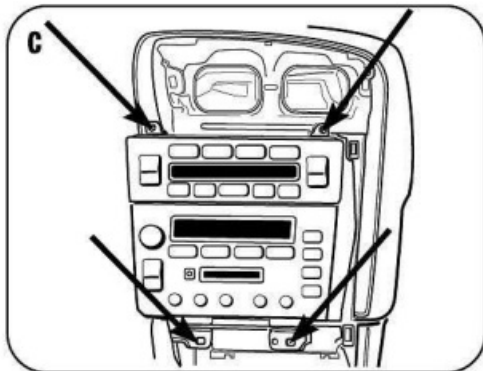

6 Remove side brackets to separate the radio from the climate controls. **(Figure D)**

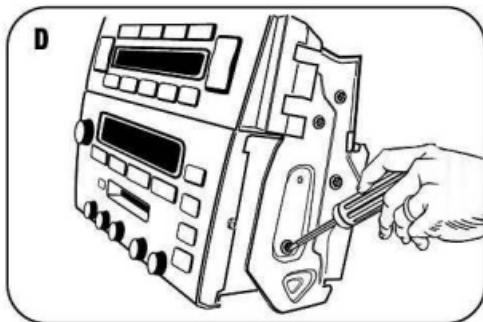

#### 99-8152 KIT ASSEMBLY

#### DIN MOUNT RADIO PROVISION WITH POCKET

1 Snap the mounting brackets to the radio housing and secure using (2) #8 x3/8" screws provided with kit. **(Figure**

A)

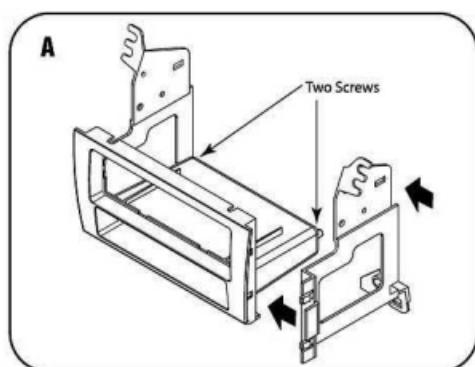

2 Align the climate controls with the mounting holes in the top of the mounting brackets. Secure the climate controls to the brackets using the (4) factory screws previously removed. **(Figure B)**

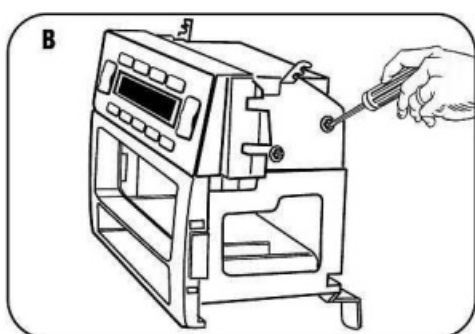

3 Slide the DIN cage into the Radio Housing assembly and secure by bending the metal locking tabs outward. **(Figure C)**

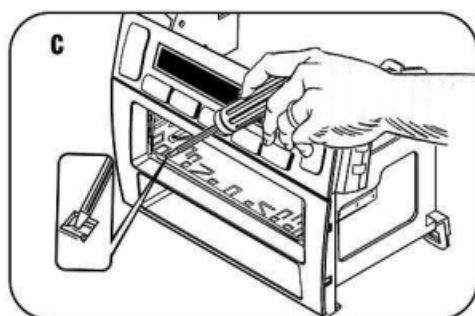

4 Slide the aftermarket radio into the cage/radio housing assembly until it snaps into place. **(Figure D)**

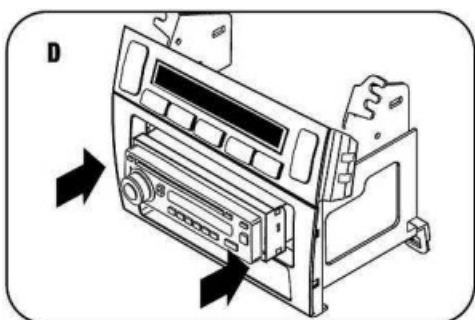

Continue to final assembly.

**1** Snap the mounting brackets to the radio housing and secure using (2) #8 x3/8" screws provided with kit. **(Figure A)**

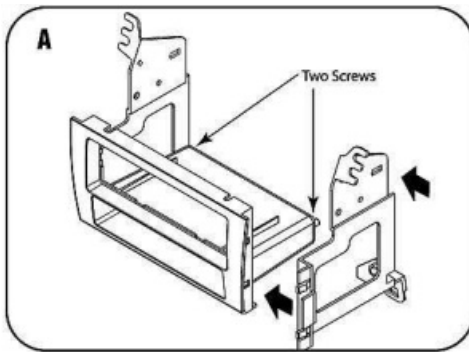

**2** Align the climate controls with the mounting holes in the top of the mounting brackets. Secure the climate controls to the brackets using the (4) factory screws previously removed. **(Figure B)**

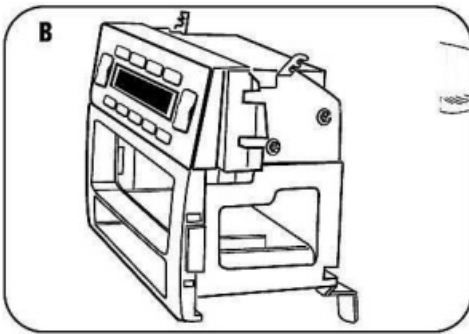

**3** Align the holes in the ISO brackets with the holes in the radio. Mount the brackets to the radio using screws supplied with the radio. **(Figure C)**

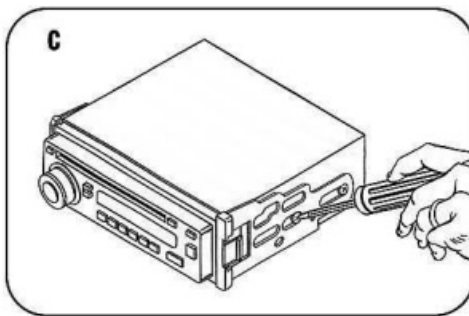

**4** Slide the radio/bracket assembly into the radio housing until it snaps into place. **(Figure D)**

**5** Snap the ISO trim-plate onto the front of the assembled radio and housing. **(Figure D)**

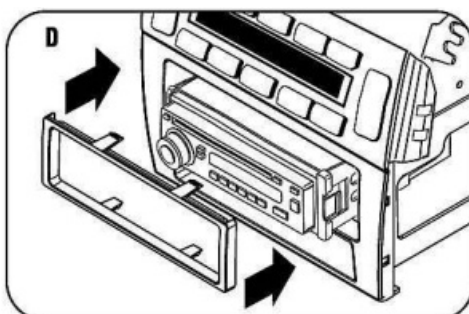

Continue to final assembly.

**NOTE: To remove the radio unsnap and remove the ISO trim-plate. Using a flat blade screwdriver disengage ISO brackets from the radio housing and slide radio out of radio housing.**

## 99-8152 FINAL ASSEMBLY

### FINAL ASSEMBLY

- 1** Locate the factory wiring harness in the dash and make the connection as shown. Metra recommends using the proper mating adapter and making the connections as shown. (Isolate and individually tape off the ends of any unused wires to prevent electrical short circuit.)
- 2** Re-connect the negative battery terminal and test the unit for proper operation.
- 3** Reassemble radio and dash assemblies in reverse order of disassembly.

### FINAL WIRING CONNECTIONS

Make wiring connections using the EIA color code chart shown below and the instructions included with the head unit. Metra recommends making connections as shown below; Strip, Splice, Solder, Tape. Isolate and individually tape off ends of any unused wires to prevent electrical short circuit.

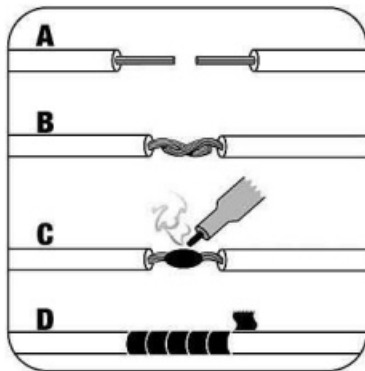

- A) Strip wire ends back 1/2"**
- B) 'Twist ends together**
- C) Solder**
- D) Tape**

### METRA / EIA WIRING CODE

12V Ignition / Ace ... Red  
12V Batt / Memory .. Yellow  
Ground ..... Black\*  
Power Antenna ... .. Blue  
Amp Turn-On ..... Blue / White  
Amp Ground ..... .. Black/ White  
Illumination..... Orange  
Dimmer ..... Orange / White  
Right Front (+) ..... Gray  
Right Front(-)..... Gray / Black  
Left Front(+) ..... White  
Left Front (-) ..... White / Black  
Right Rear(+ )..... Violet  
Right Rear (-) ..... Violet/ Black  
Left Rear(+ )..... Green  
Left Rear (-) ..... Green / Black

**\*NOTE:** When a Black wire is not present, ground radio to vehicle chassis. All colors may not be present on all leads due to manufacturer's specifications.

## NOTES

---

---

---

---

---



1-800-221-0932



[www.metraonline.com](http://www.metraonline.com)

REV. 04/25/08 © COPYRIGHT 2004 METRA ELECTRONICS CORPORATION INST99-8152

---

## Documents / Resources



[MeTra 99-8152 Vehicles With Factory Navigation](#) [pdf] Installation Guide  
99-8152 Vehicles With Factory Navigation, 99-8152, Vehicles With Factory Navigation, Factory Navigation, Navigation

## References

- [Metra Online | Welcome to Metra Auto Parts Online Warehouse](#)
- [User Manual](#)

This website is an independent publication and is neither affiliated with nor endorsed by any of the trademark owners. The "Bluetooth®" word mark and logos are registered trademarks owned by Bluetooth SIG, Inc. The "Wi-Fi®" word mark and logos are registered trademarks owned by the Wi-Fi Alliance. Any use of these marks on this website does not imply any affiliation with or endorsement.