



MERRYIOT WL10 Leak Detection Owner's Manual

[Home](#) » [MerryIoT](#) » MERRYIOT WL10 Leak Detection Owner's Manual 

Contents

- 1 MERRYIOT WL10 Leak Detection
- 2 Description
- 3 Specifications
- 4 Operation
- 5 Messages
- 6 Battery
- 7 Label format information
- 8 Important Product & Safety Instructions
- 9 Notices
- 10 Cautions
- 11 Regulatory
- 12 Federal Communication Commission Interference Statement
- 13 Configuration Downlink Command
- 14 BLE FOTA Downlink Command
- 15 Documents / Resources
 - 15.1 References
- 16 Related Posts



MERRYIOT WL10 Leak Detection



Description

The Water Leakage Sensor utilizes LoRaWAN connectivity to send uplink notifications and buzzer alarms when a water leak is detected.

There are also vibration and tilt detection in case of tampering.

Specifications

Mechanical



Sensor

- Length x Width x Height
 - 26.5mm x 70mm x 70 mm
- Weight
 - 54g without battery
 - 89g with battery
- Sensor
 - Combined with temperature, humidity, and water leak detection functions
 - Buzzer for notifying the user
 - Tamper detection

Environmental

- Temperature
 - 0°C to +50°C
- IP Rating
 - IP 67 equivalent

Power

- Source
 - 1.5V AA Alkaline 2700 mAh battery x 2pcs
- System Maximum Voltage
 - 3.0V
- System Minimum Voltage
 - 2.4V
- Current
 - 135mA maximum

2.4 Radio

- Frequency
 - Either 863–870MHz for EU models and 902–928MHz for North America
- Rx Sensitivity (Conducted)
 - -140dBm
- Antenna Gain
 - -2dBi Peak, -5dBi Avg

User Interface

- LEDs
 - One blue LED
- Button
 - Test Button
- Buzzer
 - Alarm 0cm 75dB

Certifications and Conformity

- FCC
 - On-going
- CE
 - On-going
- IC
 - On-going

Additional Features

- Battery Monitoring

Operation

Transport Mode

They are shipped with batteries inside the sensor. Default the sensor is in transport mode which means not to activate operation.

Installation Mode

- Users need to press the button over 5 seconds to activate operation into installation mode. When the Sensor tries to join the network, it will keep blinking for 3 seconds.
- Once the sensor joins the network, the LED will keep on for 3 seconds and send an uplink.
- Users can press the button for over 5 seconds to try to join the network again.
- The device will send uplink three times with FW version when the device joined successfully.

Default Operation

- During default operation the device will send a message to the network anytime there is a sufficient delta in the environmental conditions
 - Water leakage status change dry/wet (dry to wet Buzzer alarm)
 - Tamper detected (Buzzer alarm)
 - Button pressed (No buzzer alarm)
 - Keepalive message (No buzzer alarm).
- Users can press the button to send a test message to the network.
- The device will send a message saying it has been inactive for 60 minutes.
- While in default mode the device will flash the LED 3 times within 100ms only when the user presses the test button.

Messages

LoRaWAN Packets for this device uses port 126.

Status

Triggers

Water Leakage Sensor Packet Triggers

- The device will send a message when it has been inactive for 60 minutes.
- Water leakage detected (when the status changes from dry to wet), will send 3 uplinks with an interval of 5 seconds.
- Water leakage detection per 5 minutes.

Tamper Trigger:

Immediately send a message

Button Pressed Trigger:
Immediately send a message

Payload

- Port
 - 126
- Payload Length
 - 4 bytes

Bytes	0	1	2	3
Field	Status	Battery	Temp.	RH

Status	Sensor status	
	Bit [0]	1 – Water leakage detected, 0 – Dry
	Bit [1]	1 – Button pressed, 0 - Button released
	Bit [2]	1 – Tamper detected, 0 - No tamper detected
	Bits [7:3]	RFU
Battery	Battery level	
	Bits [3:0]	unsigned value v , range 0 – 15; battery voltage in $V = (21 + v) \div 10$.
	Bits [7:4]	RFU
Temperature	Environment Temperature	
	Bits [7:0]	sign integer temperature in °C -20~50 °C
RH	Relative humidity as measured by a digital sensor	
	Bits [6:0]	unsigned value in %, range 0-100. The value 127 indicates measurement error.
	Bit [7]	RFU

Battery

Replacement

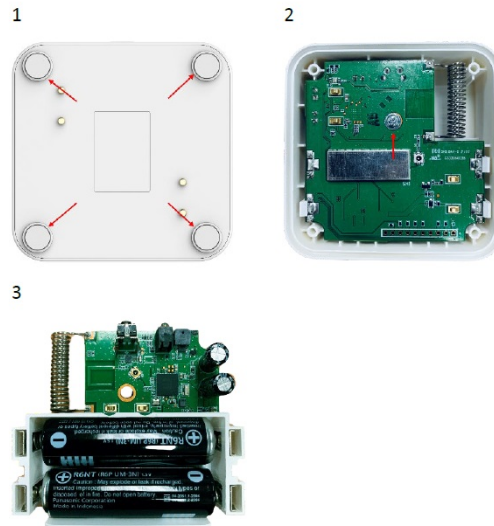

Use Alkaline battery (AA) only.

Remove the bottom cover, remove the screw which fixes the circuit board, then turn the device upside-down, the board will fall out easily. Replace the batteries. (cross-slot screwdriver required)

Cautions:

Operate with antistatic gloves is preferred.

Avoid touching the circuit board other than the battery holder.

Do not remove the battery holder from the circuit board.

Cautions

CAUTION: Disposal of a battery (or battery pack) into a fire or a hot oven, or mechanically crushing or cutting of a battery (or battery pack) can result in an **EXPLOSION!**

Leaving a battery (or battery pack) in an extremely high temperature surrounding environment can result in an **EXPLOSION** or leakage of flammable liquid or gas.

A battery (or battery pack) subjected to extremely low air pressure may also result in an **EXPLOSION** or leakage of flammable liquid or gas.

Discard used batteries according to the manufacturer's instructions.

CAUTION: The unit is provided with a battery-powered circuit.

There is a danger of explosion if the battery is incorrectly replaced.

Replace only with the same or equivalent type recommended by the manufacturer.

Discard used batteries according to the manufacturer's instructions.

Risk of Explosion if Battery is replaced by an Incorrect Type. Dispose of Used Batteries according to the Instructions.

Label format information

Device back label

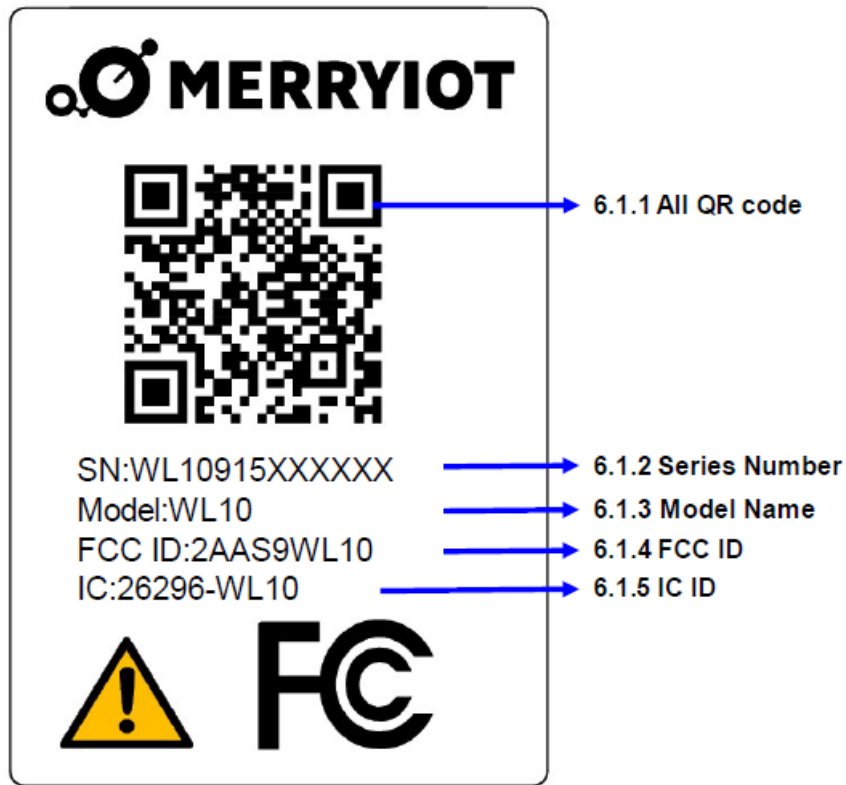

All QR code

URN:LW:D0: 0016160000000007:0016160000XXXXXX:01632004

The total maximum resulting character sentence is 48 alphanumeric characters long.

JoinEUI

900MHz: 0016160000000007. (US)

800MHz: 0016160000000008. (EU)

Uses a hexadecimal representation resulting in 16 characters.

6.1.1.2 DevEUI

0016160000XXXXXX.

Uses a hexadecimal representation resulting in 16 characters

6.1.1.3 ProfileID

The profile identifier encodes a Vendor Identifier and a Vendor Profile Identifier as a hexadecimal representation resulting in 8 characters.

VendorID

0163

VendorID is assigned by the LoRa Alliance.

VendorProfileID

900MHz: 2004 (US)

800MHz: 3004 (EU)

Serial Number

SN: WL10915XXXXXX

Not including in QR code.

Model Name

MODEL: WL10.
Fixed code, not including in QR code.

FCC ID
2AAS9WL10

IC ID
26296-WL10

Caution!

For more information, please refer to chapter 5.2. and 10.

Packaging label

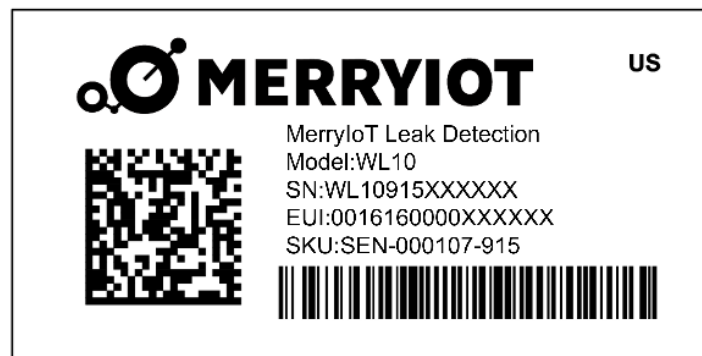

GS1 DataMatrix

- The GS1 Application Identifier (21) indicates that the GS1 Application Identifier data field contains a serial number.
- The GS1 Application Identifier (92) assigned to the company's internal information is DevEUI.

Important Product & Safety Instructions

For the most current and more detailed information about Browan features and settings as well as safety instructions, please download the user manual for the products online at www.browan.com before the use of any Browan products or services.

Certain sensors contain magnets. Keep away from ALL Children! Do not put it in your nose or mouth. Swallowed magnets can stick to intestines causing serious injury or death. Seek immediate medical attention if magnets are swallowed.

These products are not toys and contain small parts that can be dangerous to children under 3 years old. Do not allow children or pets to play with products.

Observe proper precautions when handling batteries. Batteries may leak or explode if improperly handled.

Observe the following precautions to avoid a sensor explosion or fire:

- Do not drop, disassemble, open, crush, bend, deform, puncture, shred, microwave, incinerate, or paint the sensors, Hub, or other hardware.
- Do not insert foreign objects into any opening on the sensors or Hub, such as the USB port.
- Do not use the hardware if it has been damaged—for example, if cracked, punctured, or harmed by water.

- Disassembling or puncturing the battery (whether integrated or removable) can cause an explosion or fire.
- Do not dry the sensors or battery with an external heat source such as a microwave oven or hairdryer.

Warnings

- Do not place naked flame sources, such as lighted candles, on or near the equipment.
- The battery shall not be exposed to excessive heat such as sunshine, fire, or the like.
- Do not dismantle, open or shred battery packs or cells.
- Do not expose batteries to heat or fire. Avoid storage in direct sunlight.
- Do not short-circuit the battery. Do not store batteries in a box or drawer where they may short-circuit each other or be short-circuited by other metal objects.
Do not remove a battery from its original packaging until required for use.
- Do not subject batteries to mechanical shock.
- In the event of a battery leaking, do not allow the liquid to come in contact with the skin or eyes. If a contact has been made, wash the affected area with copious amounts of water, and seek medical advice.
- Do not use any charger other than that specifically provided for use with the equipment.
- Observe the plus (+) and minus (-) marks on the battery and equipment and ensure correct use.
- Do not use any which is not designed for use with the product.
- Do not mix cells of different manufacture, capacity, size, or type within a device.
- Keep batteries out of the reach of children.
- Seek medical advice immediately if a battery has been swallowed.
- Always purchase the correct battery for the equipment.
- Wipe the battery terminals with a clean dry cloth if they become dirty.

Notices

- Avoid exposing your sensors or batteries to very cold or very hot temperatures. Low or high-temperature conditions may temporarily shorten the battery life or cause the sensors to temporarily stop working.
- Take care in setting up the Hub Gateway and other hardware. Follow all installation instructions in the User Guide. Failure to do so may result in injury.
- Do not install hardware equipment while standing in water or with wet hands. Failure to do so can result in electric shock or death. Use caution when setting up all electronic equipment.
- When charging the sensors, do not handle the sensors with wet hands. Failure to observe this precaution could result in electric shock.
- PROP 65 WARNING: This product contains chemicals known to the State of California to cause cancer and birth defects or other reproductive harm
- Cleaning Browan Products: Use a clean dry cloth or wipe to clean Browan products. Do not use detergent or abrasive materials to clean the Browan products, as this may damage the sensors.

Cautions

CAUTION: Disposal of a battery (or battery pack) into a fire or a hot oven, or mechanically crushing or cutting of a battery (or battery pack) can result in an EXPLOSION!

Leaving a battery (or battery pack) in an extremely high temperature surrounding environment can result in an EXPLOSION or leakage of flammable liquid or gas.

A battery (or battery pack) subjected to extremely low air pressure may also result in an EXPLOSION or leakage of flammable liquid or gas.

Discard used batteries according to the manufacturer's instructions.

CAUTION: The unit is provided with a battery-powered circuit.

There is a danger of EXPLOSION if the battery is incorrectly replaced.

Replace only with the same or equivalent type recommended by the manufacturer. Discard used batteries according to the manufacturer's instructions.

Risk of EXPLOSION if Battery is replaced by an Incorrect Type. Dispose of Used Batteries According to the Instructions.

Regulatory

- Hereby, Browan Communications Inc. declares that the radio equipment for Browan products complies with Directive 2014/53/EU.

This device complies with Part 15 of the FCC Rules and RSS Standards of Industry Canada.

- Operation is subject to the following two conditions: (1) this device may not cause harmful interference, and (2) this device must accept any interference received, including interference that may cause undesired operation.
- This symbol means that according to local laws and regulations your product should be disposed of separately from household waste. When this product reaches its end of life, take it to a collection point designated by local authorities. Some collection points accept products for free. The separate collection and recycling of your product at the time of disposal will help conserve natural resources and ensure that it is recycled in a manner that protects human health and the environment.

Federal Communication Commission Interference Statement

This equipment has been tested and found to comply with the limits for a Class B digital device, pursuant to Part 15 of the FCC Rules. These limits are designed to provide reasonable protection against harmful interference in a residential installation. This equipment generates, uses, and can radiate radio frequency energy and, if not installed and used in accordance with the instructions, may cause harmful interference to radio communications. However, there is no guarantee that interference will not occur in a particular installation. If this equipment does cause harmful interference to radio or television reception, which can be determined by turning the equipment off and on, the user is encouraged to try to correct the interference by one of the following measures:

- Reorient or relocate the receiving antenna.
- Increase the separation between the equipment and receiver.
- Connect the equipment into an outlet on a circuit different from that to which the receiver is connected.
- Consult the dealer or an experienced radio/TV technician for help.

FCC Caution: Any changes or modifications not expressly approved by the party responsible for compliance could void the user's authority to operate this equipment.

This device complies with Part 15 of the FCC Rules. Operation is subject to the following two conditions:

1. This device may not cause harmful interference, and
2. this device must accept any interference received, including interference that may cause undesired operation.

IMPORTANT NOTE:

Radiation Exposure Statement:

The product complies with the US portable RF exposure limit set forth for an uncontrolled environment and is safe for intended operation as described in this manual. Further RF exposure reduction can be achieved if the product can be kept as far as possible from the user body or set the device to lower output power if such a function is available. This transmitter must not be co-located or operating in conjunction with any other antenna or transmitter.

Industry Canada statement:

This device contains license-exempt transmitter(s)/receiver(s) that comply with Innovation, Science, and Economic Development Canada's license-exempt RSS(s). Operation is subject to the following two conditions:

1. This device may not cause interference
2. This device must accept any interference, including interference that may cause undesired operation of the device

The product complies with the Canada portable RF exposure limit set forth for an uncontrolled environment and is safe for intended operation as described in this manual. Further RF exposure reduction can be achieved if the product can be kept as far as possible from the user body or set the device to lower output power if such a function is available.

This equipment should be installed and operated with a minimum distance of 0cm between the radiator & your body.

Configuration Downlink Command

Configuration Command

- Port
 - 204

Payload

Bytes	0	1	2
Field	Cmd	Config	

Cmd**Command**

1 byte

Bit [7:0]

0x00 – Set keepalive interval.

default: 3600 sec. (Min: 15 sec.)

*Note: If keep alive interval value < detection interval value,
“detection interval” will be used as the uplink time.)

0x03 – Set sensor detection interval

default value: 300 sec

value range: 15~65535

0x04 – Set tamper detection on/off

default: enable

0x05 – Set buzzer alarm period(seconds)

default: 3

Config**Configuration (1 or 2 bytes)**

See the table as follows:

Command	Command Description	Data Length
0x00	Get Sensor Configuration (Only for unconfirmed downlink) *Note: little-endian format.	0 byte
0x00	Set keepalive interval. *Note: little-endian format.	2 bytes

	0x03	Set detection interval *Note: little-endian format.	2 bytes
	0x04	Bit[0] = 1: Enable tamper detection, 0: Disable tamper detection Bit[7:1] = RFU	1 byte
	0x05	Buzzer alarm period in seconds	1 byte

Payload Content

Command content

Ex:

00100E || 032C01 || 0401 || 0503

00 100E => Set keepalive interval: 0x0E10 -> 3600 (sec)

03 2C01 => Set detection interval: 0x012C -> 300(seconds)

04 01 => Enable tamper detection: 0x01

05 03 => Buzzer alarm period in 3 seconds: 0x03

Response Content

(Only for unconfirmed downlink)

(Only for unconfirmed downlink)

Port	204
Payload Length	10 bytes
Payload Content	Response content Example: 00100E 032C01 0401 0503 00 100E => Set keepalive interval: 0x0E10 -> 3600 (sec) 03 2C01 => Set detection interval: 0x012C -> 300(seconds) 04 01 => Enable tamper detection: 0x01 05 03 => Buzzer alarm period in 3 seconds: 0x03

Frame Count 1 Content

Payload Length	9 bytes
Payload Content	<p>Frame count 1 content</p> <p>Ex:</p> <p>01 04200000 7ff1f102</p> <p>01 => command ID</p> <p>04200000 => HW ID: 0x00002004 (little-endian format)</p> <p>7ff1f102 => FW version: 0x02f1f17f (little-endian format)</p>

BLE FOTA Downlink Command

- Port
 - 206
- Payload Length
 - 3 bytes

Payload

Bytes	0~2
Payload	0x444655

Documents / Resources

	<p>MERRYIOT WL10 Leak Detection [pdf] Owner's Manual WL10, Leak Detection</p>
---	---

References

- [BROWAN COMMUNICATIONS INC.](#)