



MERRYIOT Sensors and for Amazon Sidewalk Installation Guide

[Home](#) » [MerryIoT](#) » MERRYIOT Sensors and for Amazon Sidewalk Installation Guide 

Contents

- [1 MERRYIOT Sensors and for Amazon Sidewalk](#)
- [2 Safety Warning](#)
- [3 What is Amazon Sidewalk](#)
- [4 Input / Output](#)
- [5 Sensor Introduction](#)
- [6 Sensor Installation](#)
- [7 APP Functions](#)
- [8 Battery Replacement](#)
- [9 Documents / Resources](#)
 - [9.1 References](#)



MERRYIOT Sensors and for Amazon Sidewalk



Safety Warning

Read this manual before attempting to install the device!

Failure to observe the recommendations included in this manual may be dangerous or cause a violation of the law. The manufacturer, Browan Communications Inc. will not be held responsible for any loss or damage resulting from not following the instructions of this user manual.

- The device must not be dismantled or modified in any way.
- The device is only intended for indoor use. Do not expose it to moisture.
- The device is not intended to be used as a reference sensor, and Browan Communications Inc. will not be held liable for any damage which may result from inaccurate readings.
- The battery should be removed from the device if it is not to be used for an extended period. Otherwise, the battery might leak and damage the equipment. Never leave a discharged battery in the battery compartment.
- The device must never be subjected to shocks or impacts.
- To clean the device, wipe with a soft moistened cloth. Use another soft, dry cloth to wipe dry. Do not use any detergent or alcohol to clean the device.

What is Amazon Sidewalk



Amazon Sidewalk – Connecting Wireless IoT Devices at Homes and Beyond

Amazon Sidewalk connects homes and communities together. It's a shared network that helps devices connect to the Internet and work better. Many Ring and Echo devices can act as a Sidewalk Bridge via Bluetooth and the 900MHz spectrum to provide a secure connection for low-bandwidth devices in the home and around the neighbourhood. Customers with an Amazon Sidewalk Bridge contribute a small portion of their internet bandwidth, which is pooled together to create a neighbourhood network that benefits all Amazon Sidewalk-enabled devices in a community. This helps MerryIoT devices stay connected with Amazon Sidewalk coverage and no recurring fees for customers to access Sidewalk.

How MerryIoT and Amazon Sidewalk can benefit your daily life.

MerryIoT provides a complete solution for your home and asset monitoring that helps increase a level of security and safety to your property and loved ones. With the help of Amazon Sidewalk, all MerryIoT smart devices stay connected and continue to work over longer distances. A nearby Amazon Sidewalk gateway will pick up messages from the connected MerryIoT device and route them to the MerryIoT application via an integrated AWS cloud with multiple layers of data encryption for customer privacy protection. Today, Amazon Sidewalk include many Echo devices and select Ring devices that securely connect Sidewalk-enabled endpoints to the Amazon Sidewalk network and provide services to you and your neighbors.



MerryloT Air Quality CO2 (CD10)

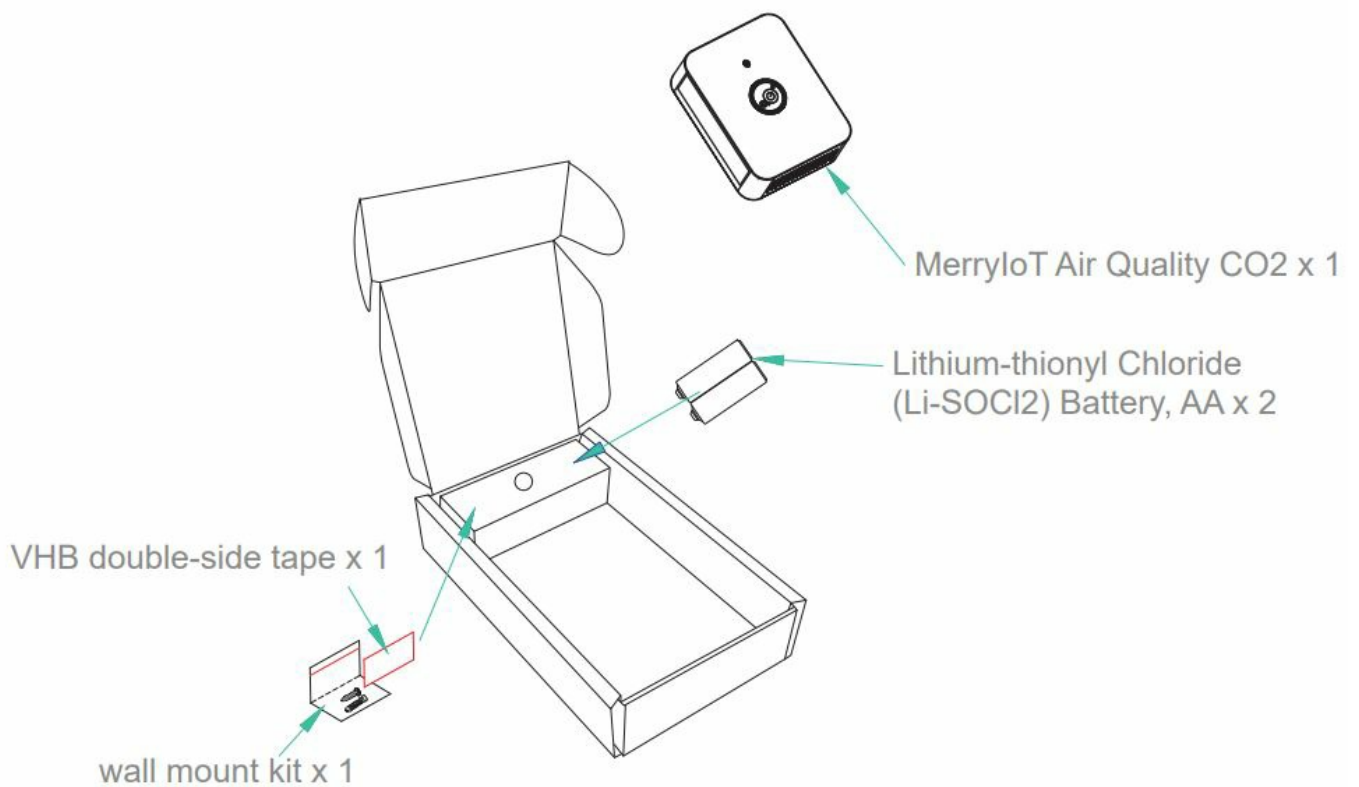

MerryloT Motion Detection (MS10)

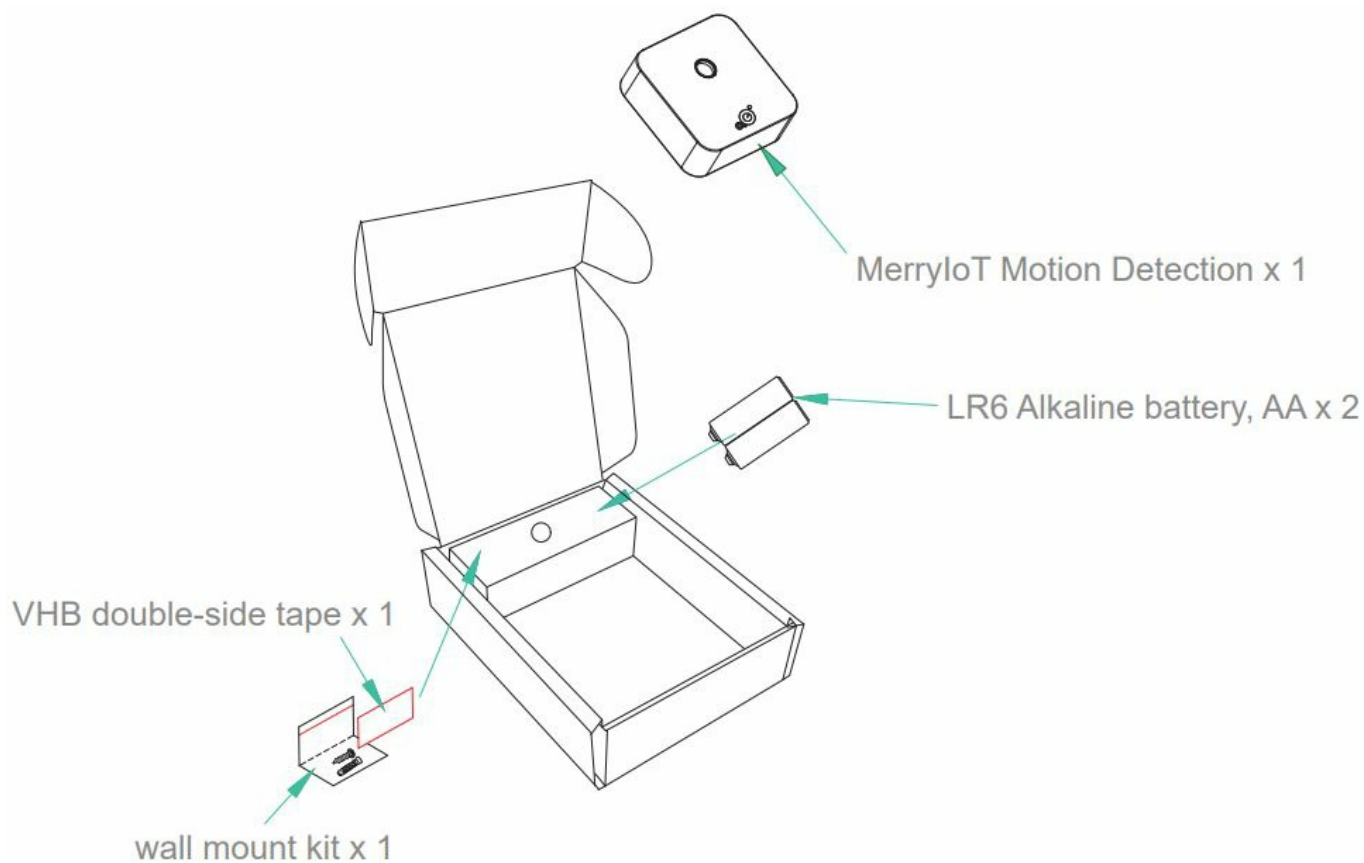

MerryloT Open/Close (DW10)

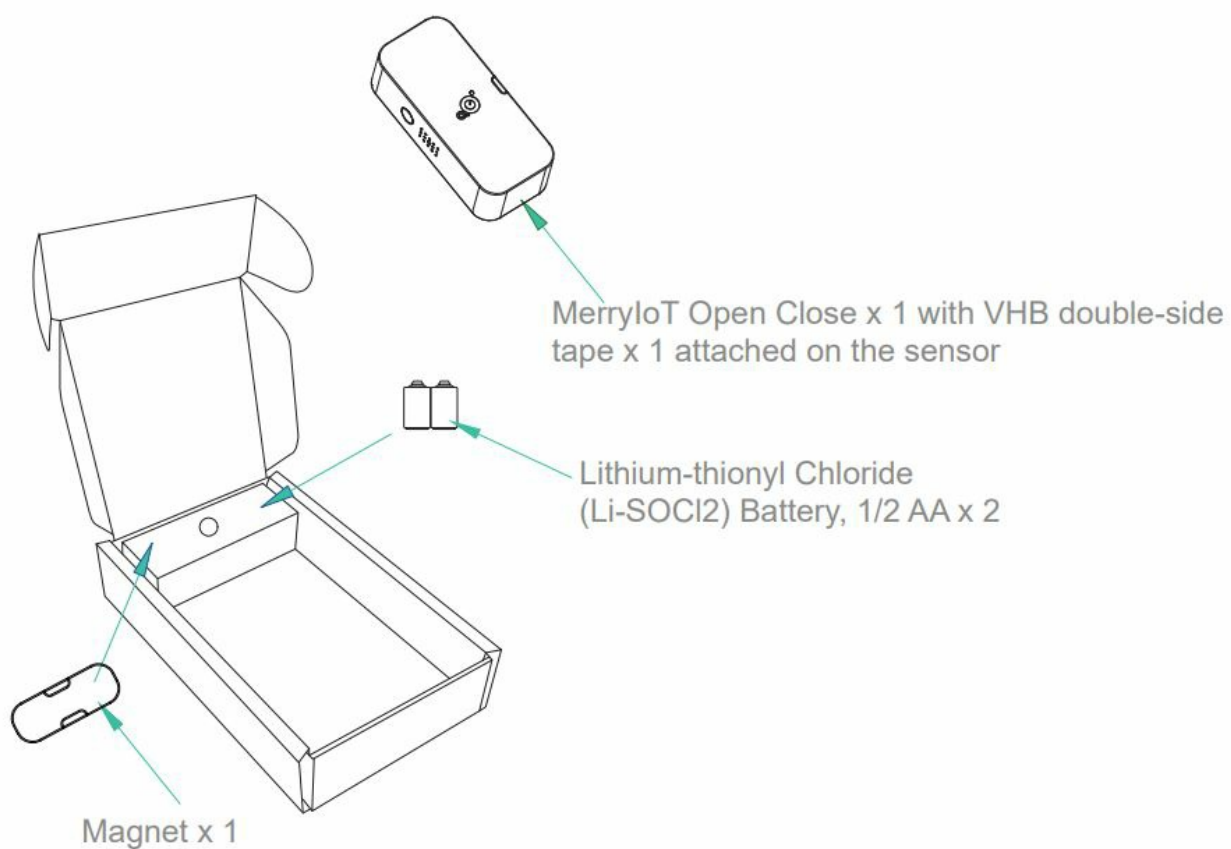

MerryloT Leak Detection (WL10)



Input / Output

MerryIoT Air Quality CO2 (CD10)

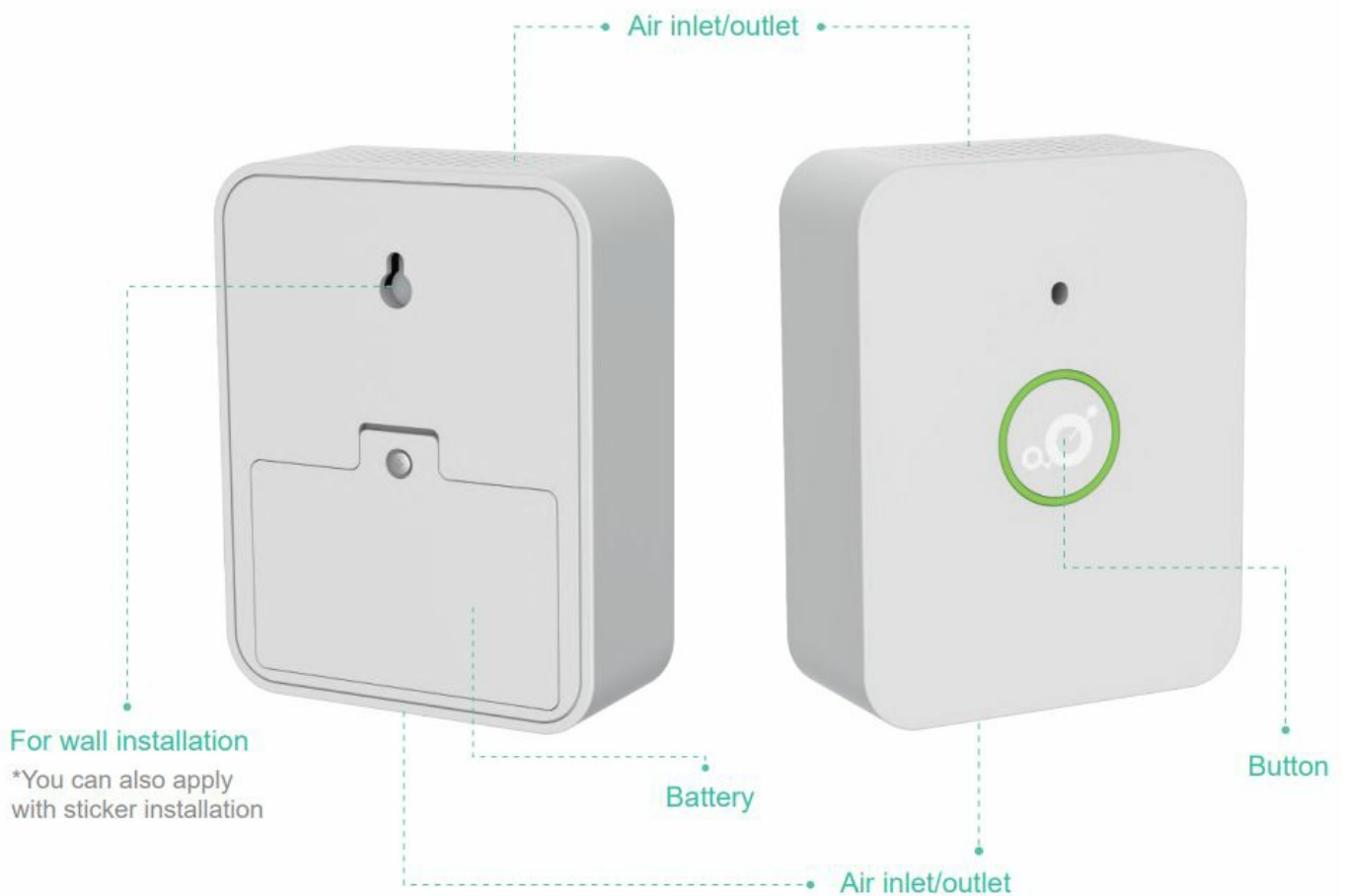

MerryIoT Motion Detection (MS10)

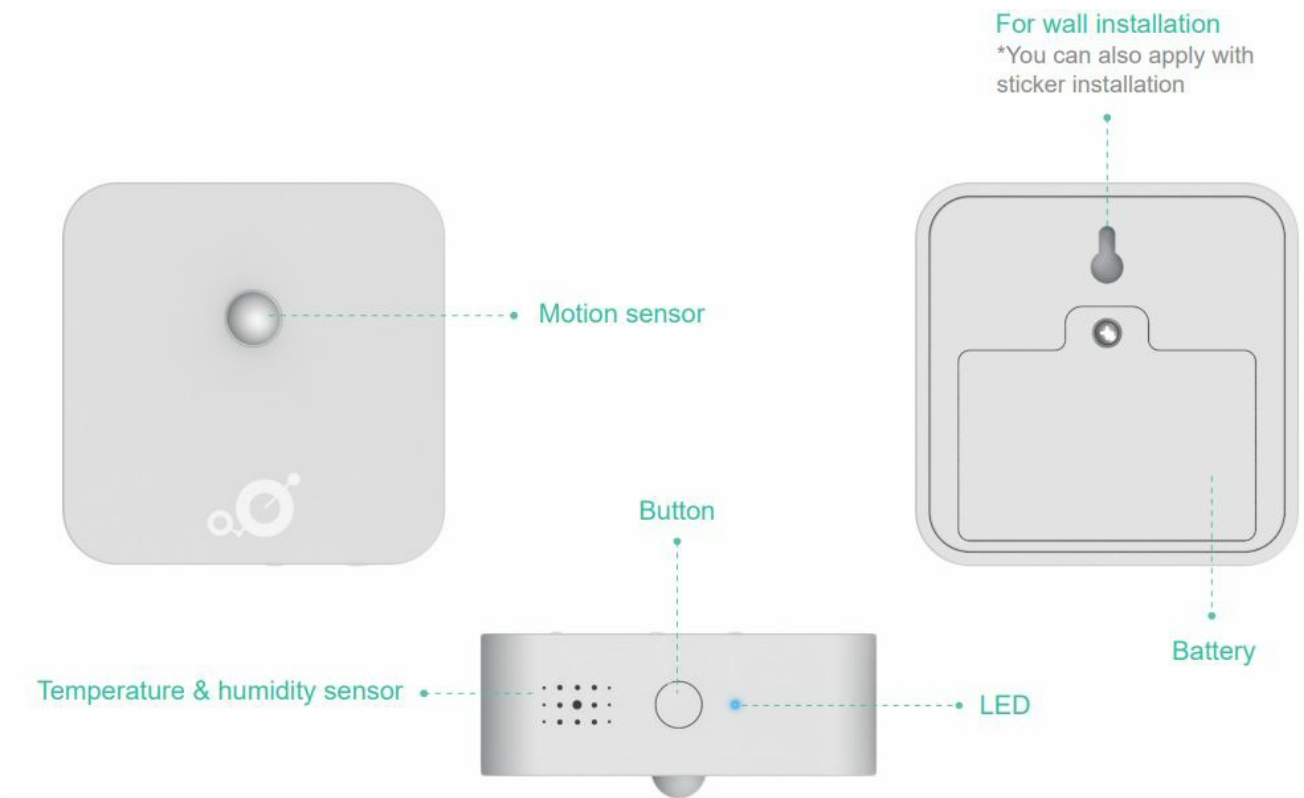

MerryIoT Open/Close (DW10)



MerryIoT Leak Detection (WL10)

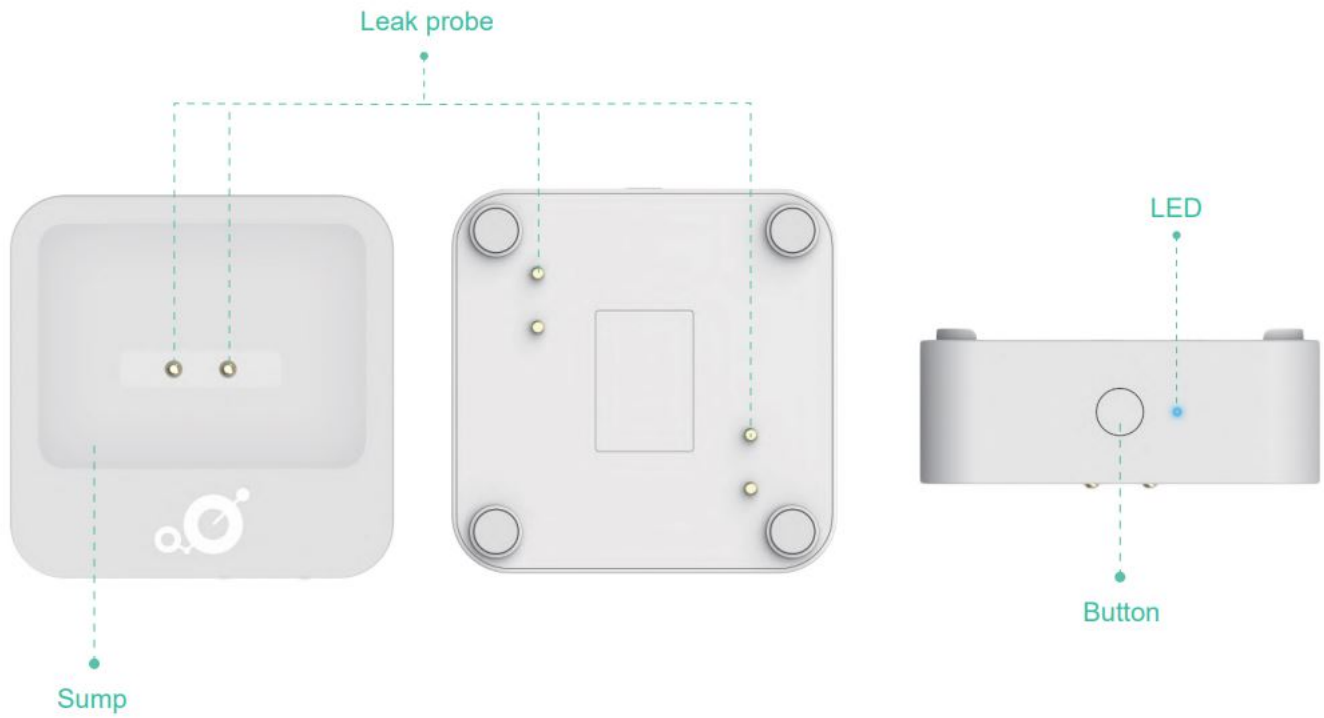

Sensor Introduction

MerryloT Air Quality CO2 sensor (CD10) is a professional smart device that works with Amazon Sidewalk. Its minimalistic design makes it ideal for wall mounting, whether at home or in the workplace. This sensor offers comprehensive monitoring of CO2 levels, temperature, and humidity.

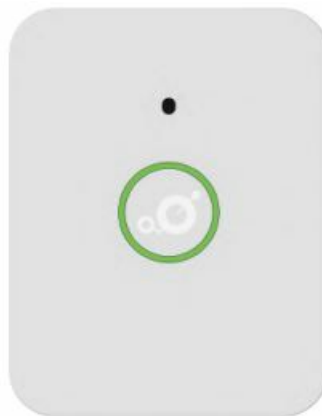

MerryloT Air Quality CO2
CD10

Features

- 3 sensors in 1 (CO2 & Temperature & Humidity)
- Built-in buzzer for alarm if the CO2 level is more than 1000 ppm
- Long-range coverage over Amazon Sidewalk's 900MHz wireless network Coverage test button for easy installation
- Up to 2 years of battery lifetime
- Note: Battery life is mainly determined by the reporting frequency. Other factors include moisture and high temperature.

MerryIoT motion detector (MS10) is an easy step toward a safer home. It monitors front and back doors, driveways, sheds, garages, and gates, making it suitable for all your properties. This sensor also provides an additional level of security for your loved ones. Moreover, it promptly alerts you in case of emergencies.



MerryIoT Motion Detection
MS10

Features

- 4 sensors in 1 (PIR & Temperature & Humidity & Vibration)
- Detect human presence accurately
- Long-range coverage over Amazon Sidewalk's 900MHz wireless network
- Coverage test button for easy installation
- Alarm message for the device is been moved or tampered with
- Up to 3 years of battery lifetime
- Note: Battery life is mainly determined by the reporting frequency. Other factors include moisture and high temperature.
- Ultrawide range detection
 - 125° Horizontal
 - 100° Vertical
 - Up to 7m distance

MerryIoT Open/Close sensor (DW10) gives you peace of mind, anywhere, anytime. Get real-time alerts at the exact moment you have unexpected guests, broken windows, opened safes, an opened mailbox or escaped pets.



MerryIoT Open/Close
DW10

Features

- 4 sensors in 1 (Open/Close & Temperature & Humidity & Vibration)
- Long-range coverage over Amazon Sidewalk's 900MHz wireless network
- Coverage test button for easy installation
- Alarm message for the device is been moved or tampered with
- Up to 3 years of battery lifetime
- Note: Battery life is mainly determined by the reporting frequency. Other factors include moisture and high temperature.

MerryIoT Water Leak Sensor (WL10) will instantly notify you as soon as it detects water leakage. You can now say goodbye to concerns about leaks or flooding in your basement, under your sinks, around your water heater, or anywhere else in your home.



MerryIoT Leak Detection
WL10

Features:

- 4 sensors in 1 (Drip/Leak/Flood & Temperature & Humidity & Vibration)
- Built-in water sensing probes on top and bottom for leak/flooding detection
- Long-range coverage over Amazon Sidewalk's 900MHz wireless network
- Coverage test button for easy installation
- Alarm message for the device is been moved or tampered with
- Up to 3 years of battery lifetime
- Note: Battery life is mainly determined by the reporting frequency. Other factors include moisture and high temperature.

Sensor Installation

1. Please make sure you have Sidewalk coverage before installing the MerryIoT Sensors. To check the Sidewalk coverage in your neighbourhood, visit <https://coverage.sidewalk.amazon> and follow these steps:
 1. Type your location on the top right corner.
 2. According to the vicinity of your location, find your accurate location to see if any Sidewalk coverage around here.

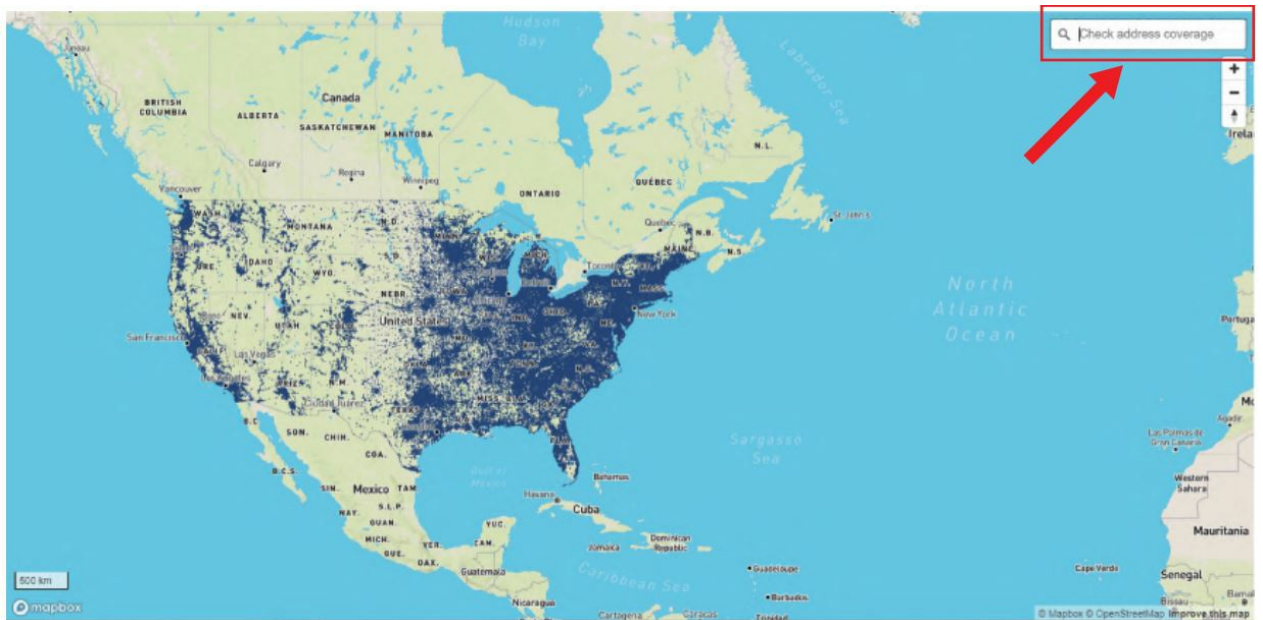

2. Install and launch the MerryIoT mobile application on your phone.



*Search: MerryIoT for Amazon Sidewalk



3. Register your account.
Sign in by social media:

① Press Sign In.



② Select Sign In WITH GOOGLE/APPLE.



③ Add your group, you will see the main view after.

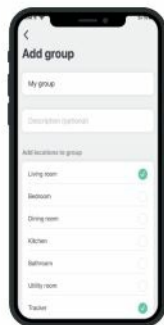

Sign in successfully



Create an account:

① Press Sign In.



② Fill in your information.



③ Confirm your mail (fill in the verification code).



④ Press Sign In and select "Sign In WITH EMAIL".



⑤ Add your group, you will see the main view after.

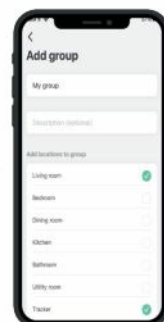

4. Add your device to the App.



MerryIoT Air Quality CO2
CD10

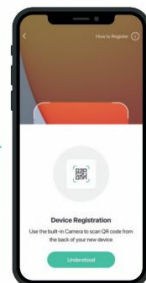

After scan



Fill in the name and the location



Click "complete".
Once the group page appears, you will have successfully added your sensors!



MerryIoT Motion Detection
MS10



After scan



Fill in the name and the location



Click "complete".
Once the group page appears, you will have successfully added your sensors!

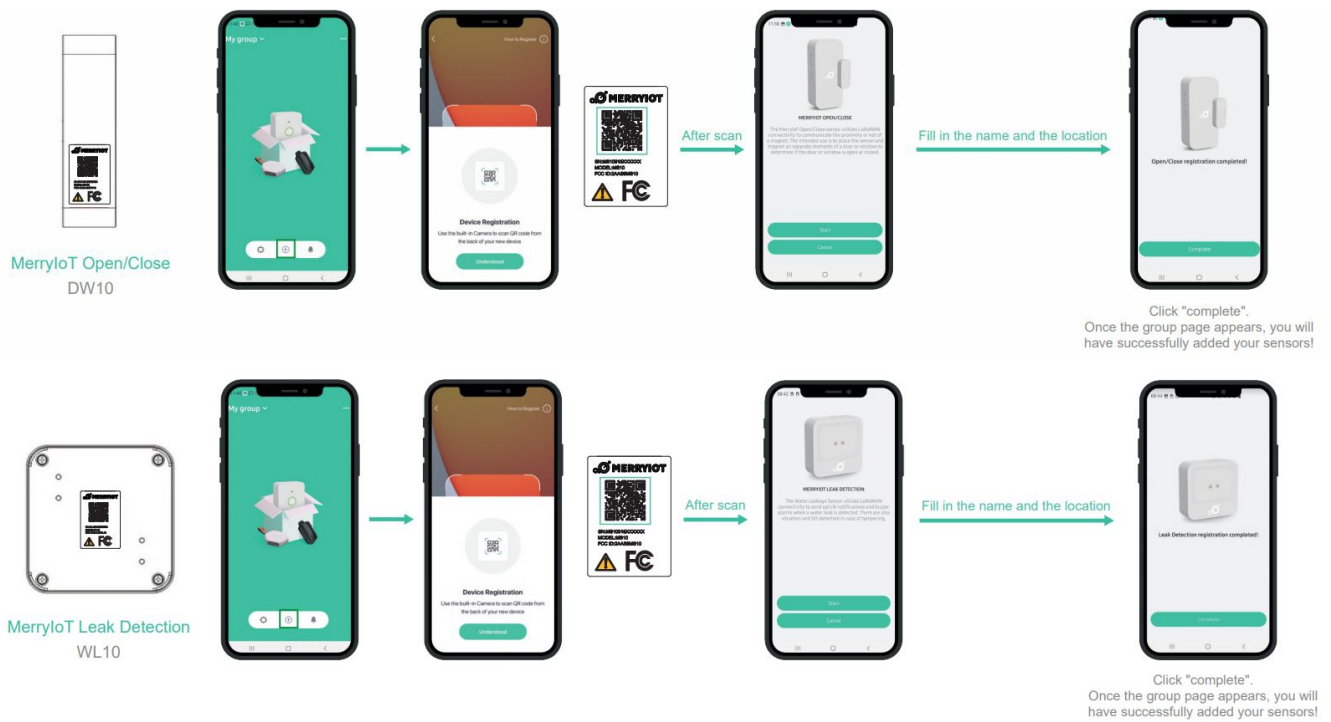

5. When the sensor is successfully online, the LED will keep on for 3 seconds.
6. Press the button on the sensor, the sensor's real-time status will be updated.
7. Once the Sensor is successfully connected, the following icon will appear on the dashboard.

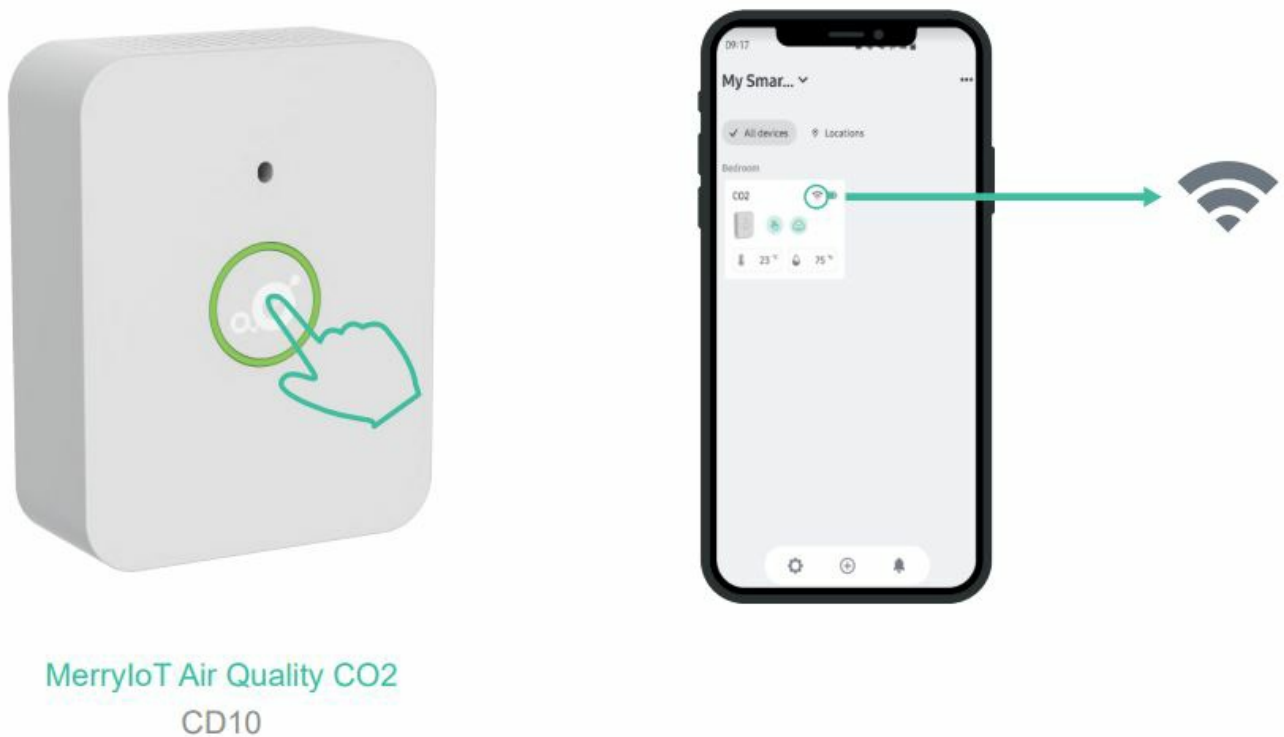



MerryIoT Motion Detection
MS10



MerryIoT Open/Close
DW10

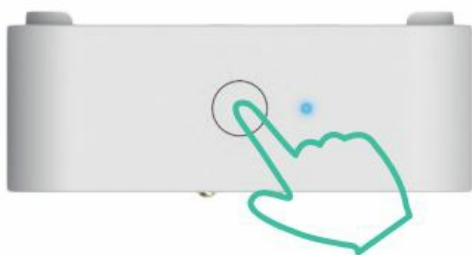

MerryIoT Leak Detection
WL10



8. Once the Sensor is connected, install the Sensor to your desired location

MerryIoT Air Quality CO2 (CD10)

It is important to note that the CO2 sensor unit should be mounted at 48 inches (122cm) above the floor and kept away from external doors or windows, which may make the space appear to have more fresh air than it actually does. Think of CO2 behaving like water it rises from the bottom, similar to how water fills a cup. This principle applies to indoor spaces such as draft coolers, restaurants, breweries, and grow facilities. Because CO2 gas is denser than regular air, it tends to flow down stairs or collect in low-lying areas first.

So, please avoid this placement:

- Restricted airflow
- In direct sunlight from windows
- Close to heat sources

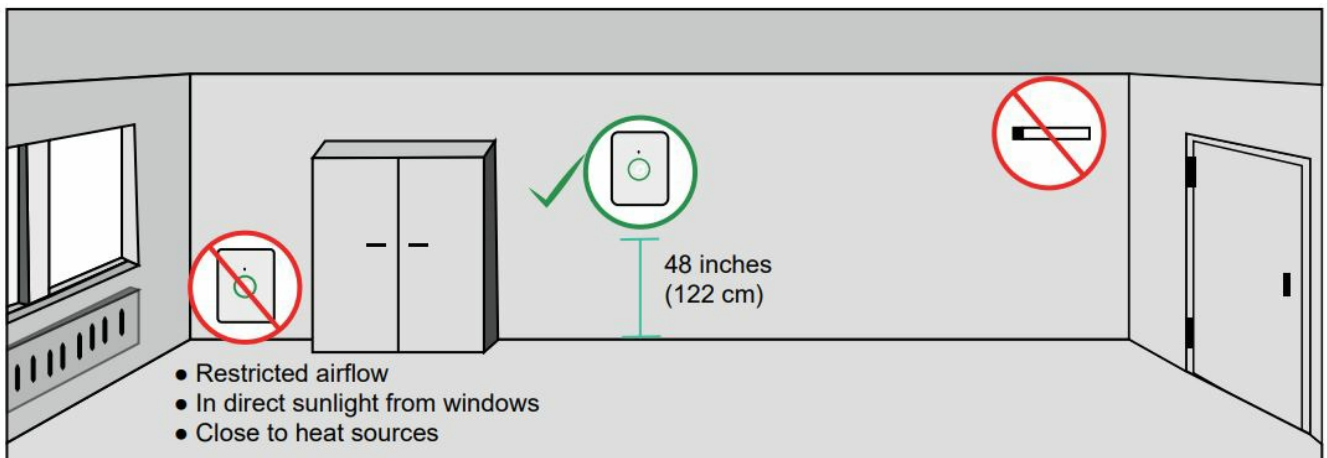

MerryIoT Motion Detection (MS10)

Assets where intruders are most likely to enter or for other applications related to occupied spaces include the following:

1. Garage Entrance (for security purposes)
 1. The eye of the sensor should be oriented in the direction where intruders may approach.
2. Meeting Room (for occupied space purposes)
 1. It is recommended to install 2 MerryIoT Motion Detections within a single space to determine its occupancy status. One sensor should be positioned with its sensor eye directed towards the entrance of the space, and the other one pointing at where people assumed to be staying in the space.

Garage Entrance



Meeting Room

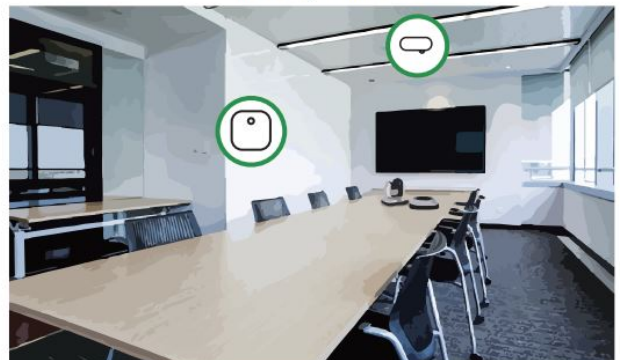

MerryIoT Open/Close (DW10)

1. Clean the installation area.
2. Remove the protective layer from the double-sided tape on the door sensor, place the door sensor in the desired position (the fixed part of your door or window), and press firmly for at least 5 seconds.
3. Remove the protective layer from the double-sided tape on the magnet, place the magnet in the desired position (align the magnet marking with the hall sensor marking on the sensor), and press firmly for at least 5 seconds.

Note: the maximum sensing distance is 10mm.

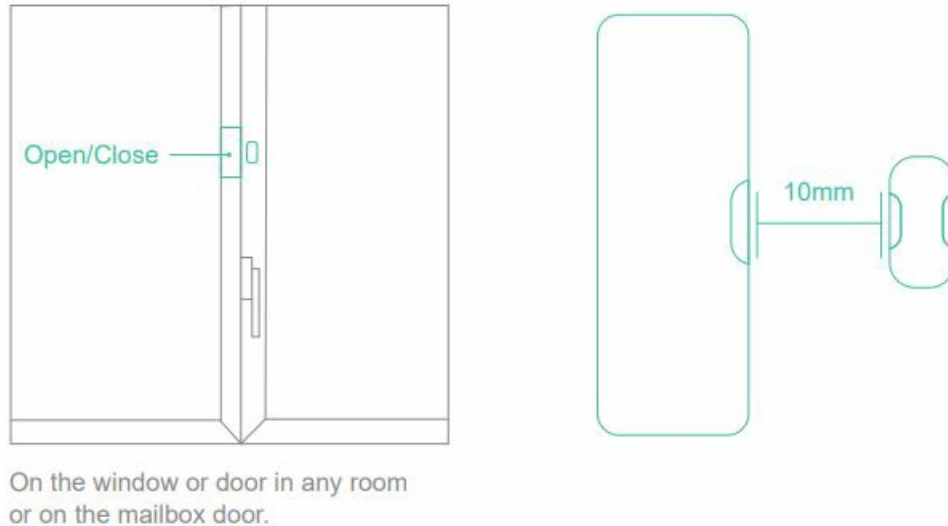

MerryIoT Leak Detection (WL10)

The most common application for our water detection sensors is placing them underneath AC units, which are prone to leaks. However, it is important to also address other possible risks, such as existing pipework, heating systems, kitchens, toilets and areas that might be likely to flood first during extreme weather conditions (by doors/windows). It is recommended to install multiple MerryIoT Leak Detection Sensors in one space, where the potential leakage may occur.

1. For Home basement use.
2. For server rooms and data centres.

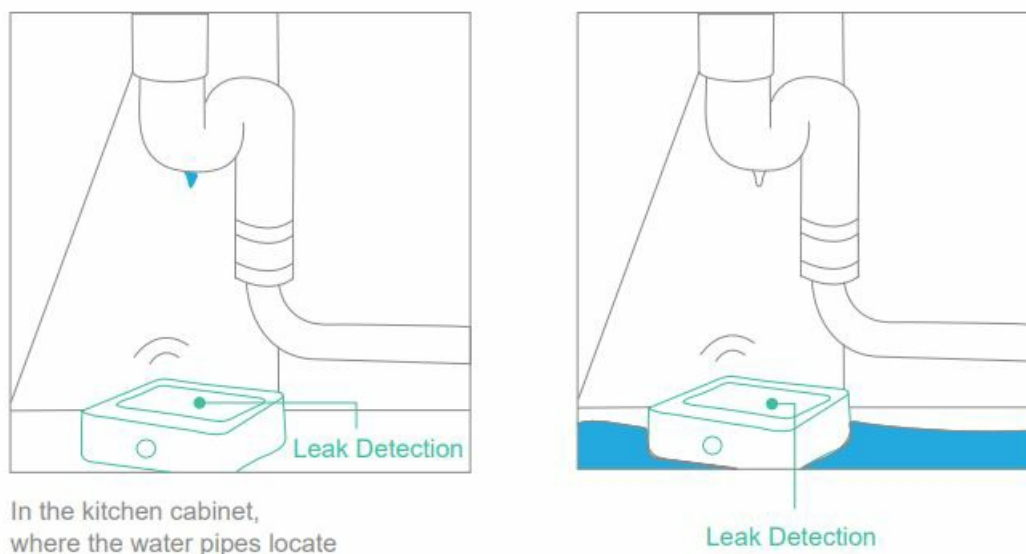

APP Functions

MerryIoT Air Quality CO2 (CD10)

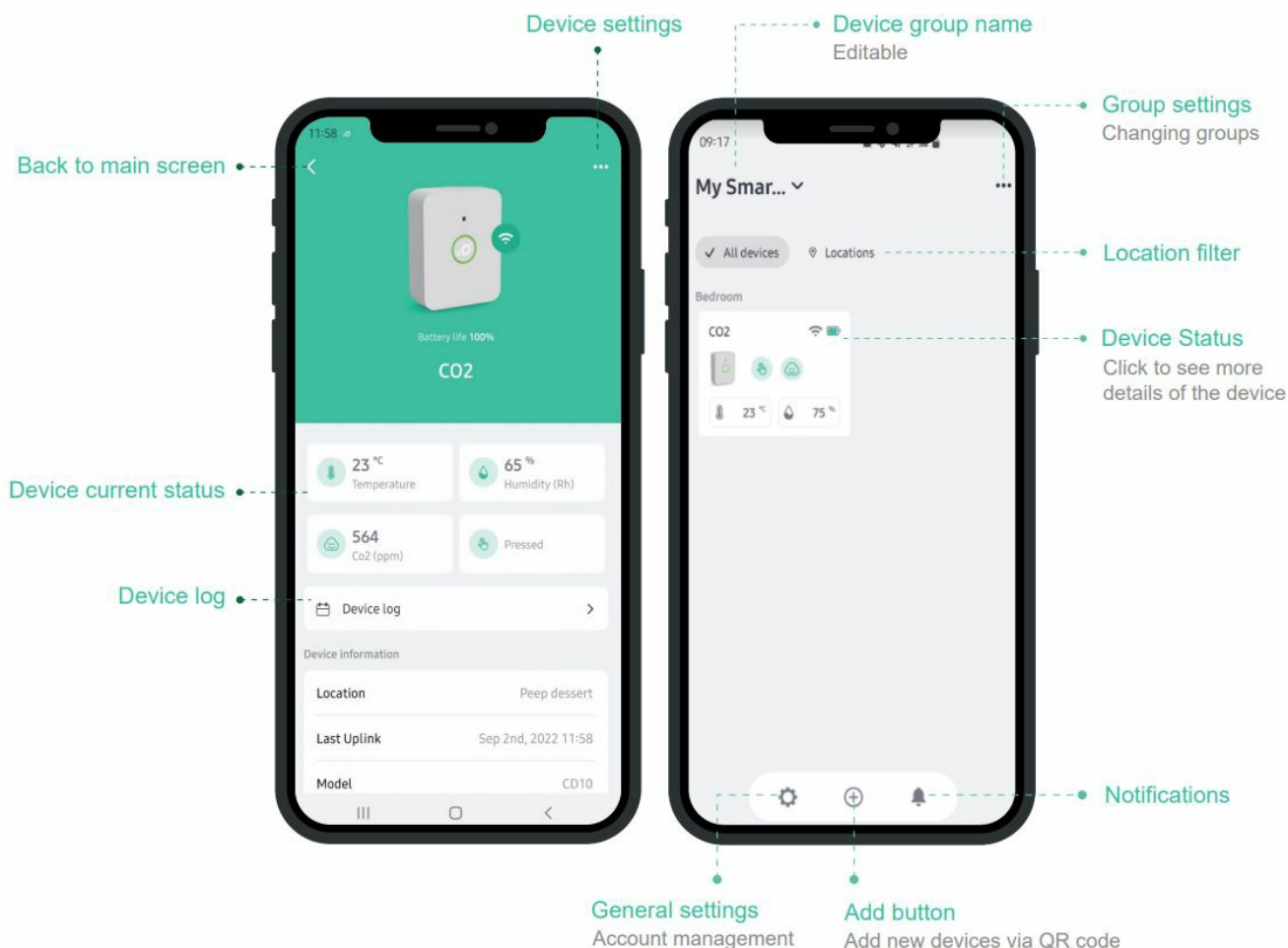

Icons

Battery status
 Sufficient (green): >3.0V
 Low (yellow): >2.8V
 Exhausted (red): ≤2.8V

Connection status
 On/off

22°C Temperature (°C/°F)

50% Relative Humidity (%)

Both the icons of Temperature and Relative Humidity will be updated by 2 situations:

- Periodically every 1 hour
- Press the device's test button

Button pressed
 This icon will be displayed on your app dashboard when you press the device's test button, also the CO2 level, temperature and humidity will be updated at the same time.

Air quality/CO₂ concentration
 Excellent (green): <800 ppm
 Good (yellow): 800-1000 ppm
 Bad (red): >1000 ppm

This icon will be updated by 3 situations:

- Periodically every 1 hour
- Immediately if the CO2 level is more than 1000 ppm
- Press the device's test button

MerryIoT Motion Detection (MS10)

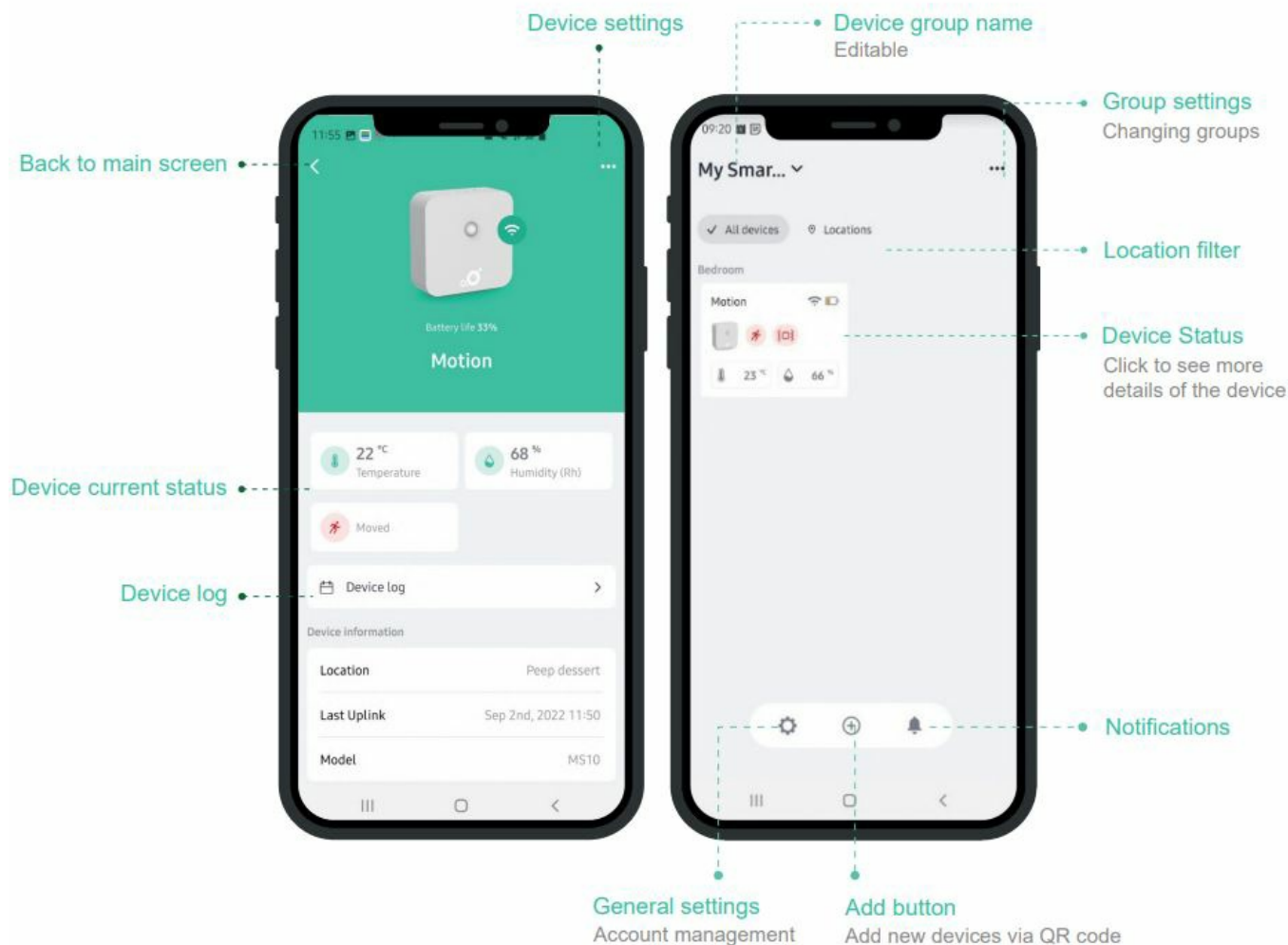

Icons



Battery status

Sufficient (green): >2.6V
Low (yellow): >2.5V
Exhausted (red): ≤2.5V



Connection status

On/off



Temperature (°C/°F)



Relative Humidity (%)

Both the icons of Temperature and Relative Humidity will be updated by 2 situations:

1. Periodically every 1 hour
2. Press the device's test button



Button pressed

This icon will be displayed on your app dashboard when you press the device's test button, also the CO2 level, temperature and humidity will be updated at the same time.



Motion detected

This icon will be displayed on your app dashboard immediately when the device detect a human motion, and the icon will disappear if there is no human detection in the last 5 minutes.



Device is being tampered

This icon will be displayed on your app dashboard immediately when the device is been moved or tampered.

MerryIoT Open/Close (DW10)

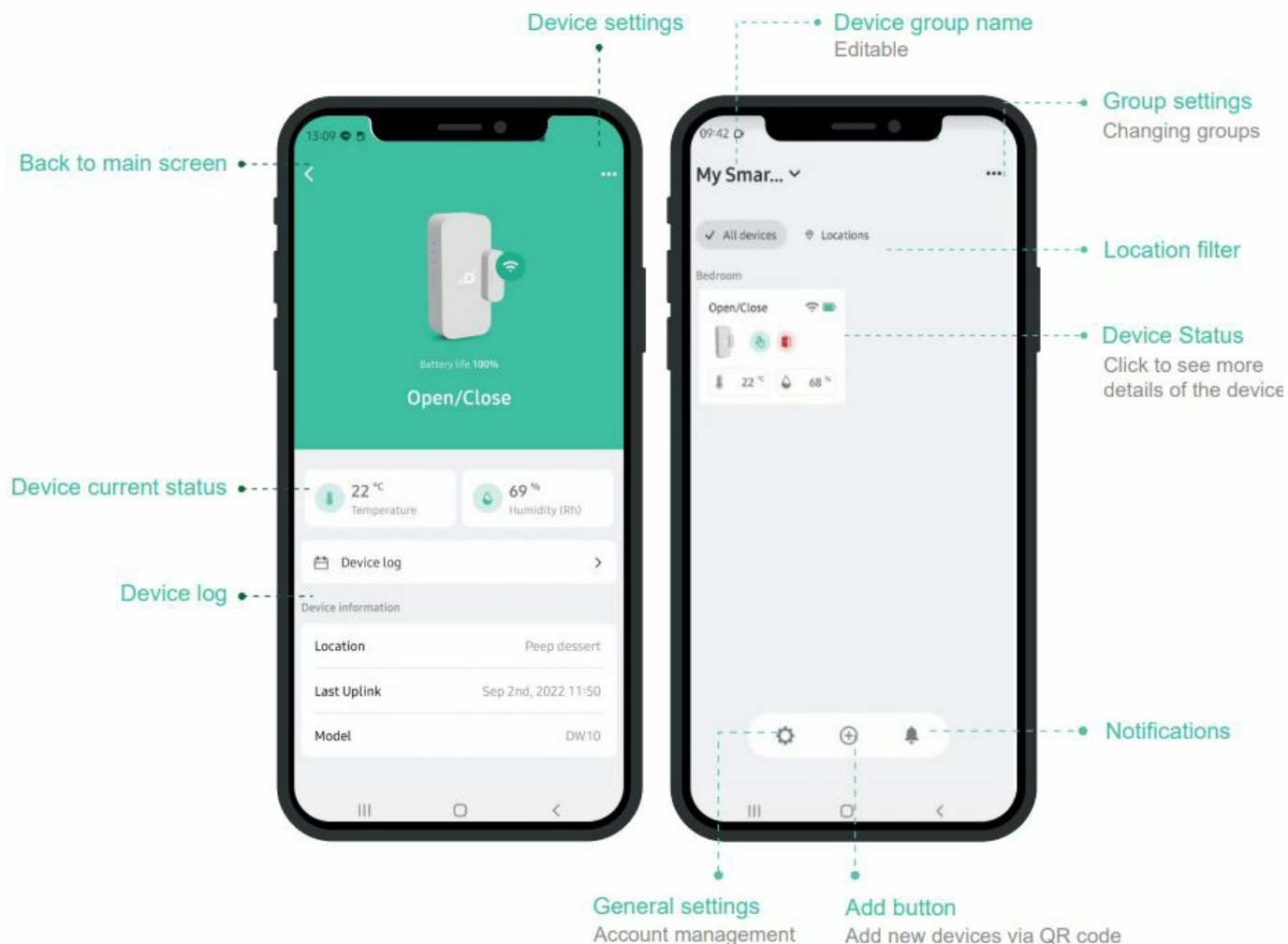

Icons



Battery status
Sufficient (green): >3.0V
Low (yellow): >2.6V
Exhausted (red): ≤2.6V



Connection status
On/off



Temperature (°C/°F)



Relative Humidity (%)

Both the icons of Temperature and Relative Humidity will be updated by 2 situations:

1. Periodically every 1 hour
2. Press the device's test button



Button pressed
This icon will be displayed on your app dashboard when you press the device's test button, also the CO2 level, temperature and humidity will be updated at the same time.



Door or window status
This icon will be updated every 6 hours, and when each door/window opens/closes.



Device is being tampered
This icon will be displayed on your app dashboard immediately when the device is been moved or tampered.

MerryIoT Leak Detection (WL10)

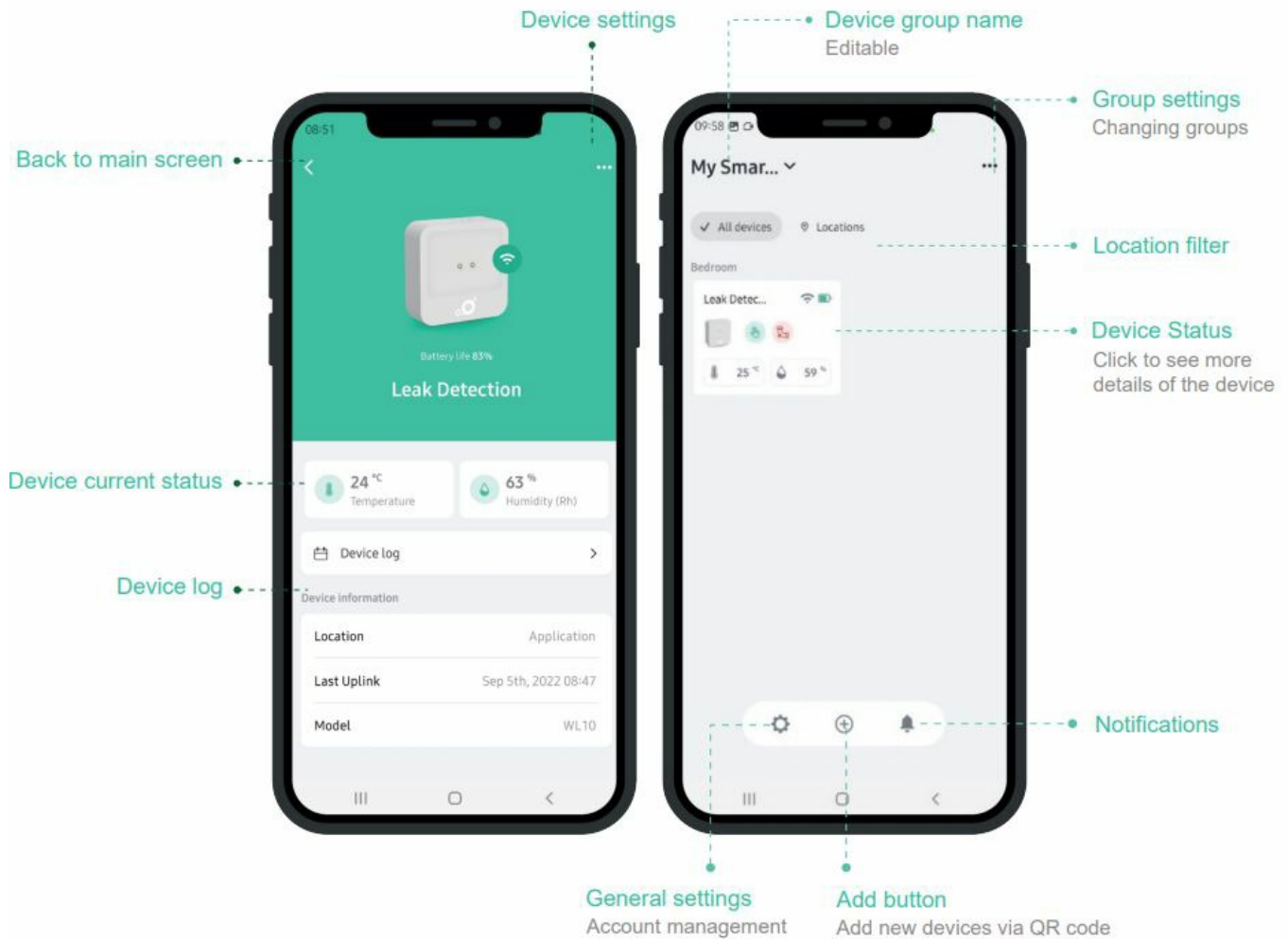

Icons



Battery status

Sufficient (green): >2.6V
Low (yellow): >2.5V
Exhausted (red): ≤2.5V



Connection status

On/off



Temperature (°C/°F)



Relative Humidity (%)

Both the icons of Temperature and Relative Humidity will be updated by 2 situations:

1. Periodically every 1 hour
2. Press the device's test button



Button pressed

This icon will be displayed on your app dashboard when you press the device's test button, also the CO2 level, temperature and humidity will be updated at the same time.



Water leak detected

This icon will be displayed on your app dashboard immediately when the device detect a leak/flooding event, and the icon will disappear when the water dry up.



Device is being tampered

This icon will be displayed on your app dashboard immediately when the device is been moved or tampered.

Battery Replacement

MerryIoT Air Quality CO2 (CD10)

1. Tools: Cross-type screwdriver x1 (PH0).



2. Remove the battery cover of the sensor with a cross-type screwdriver (PH0 size).

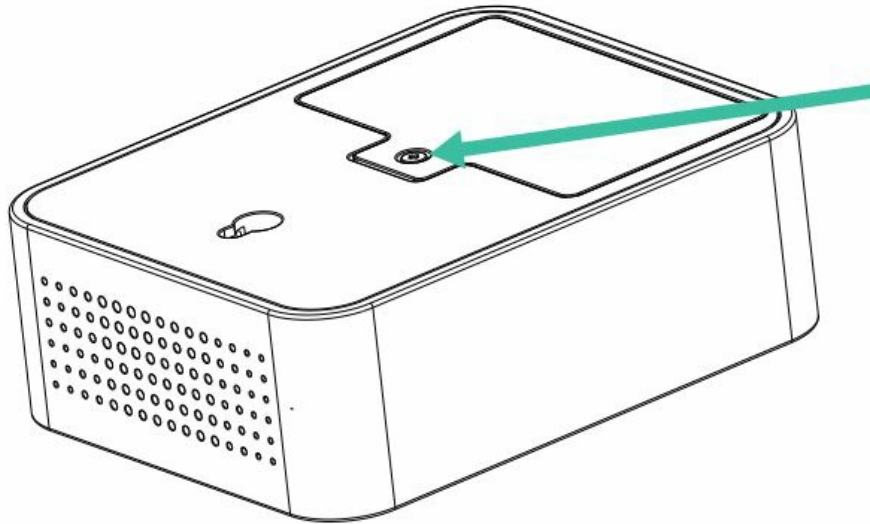

3. Replace the battery with new ones (Li-SiO₂ battery, "ER14505", AA size x2 pcs). *Caution: Using batteries other than the ones provided may lead to performance loss, reduced battery life, and device damage.

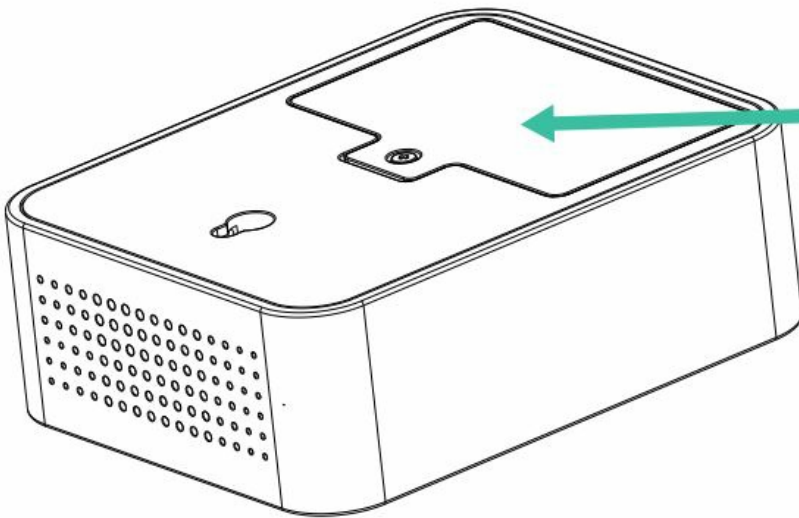

X2

ER14505*
Lithium-thionyl Chloride
(Li-SOCl₂) Battery, AA

Ensure proper disposal according to environmental regulations. Mixing of cells can result in battery leakage and suboptimal device performance.

4. Re-assemble the battery cover.

MerryIoT Motion Detection (MS10)

1. Tools: Cross-type screwdriver x1 (PH0).



2. Remove the battery cover of the sensor with a cross-type screwdriver (PH0 size).

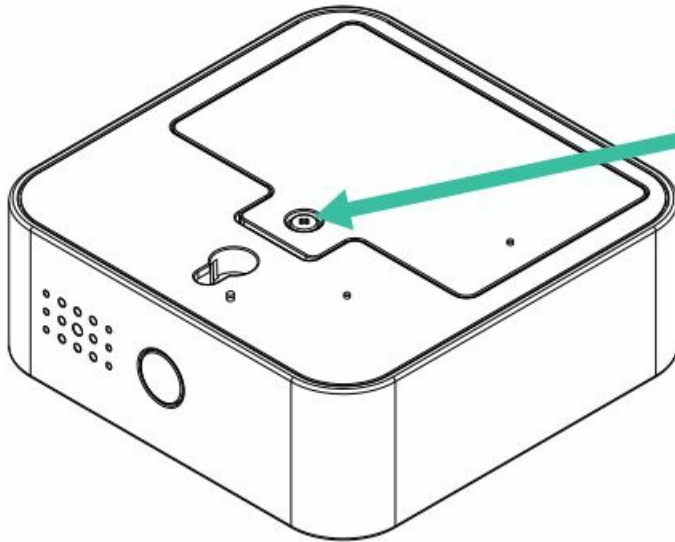

3. Replace the battery with new ones (Alkaline Battery, "LR6", AA size x2 pcs). *Caution: Using batteries other than the ones provided may lead to performance loss, reduced battery life, and device damage. Ensure proper disposal according to environmental regulations. Mixing of cells can result in battery leakage and suboptimal device performance.

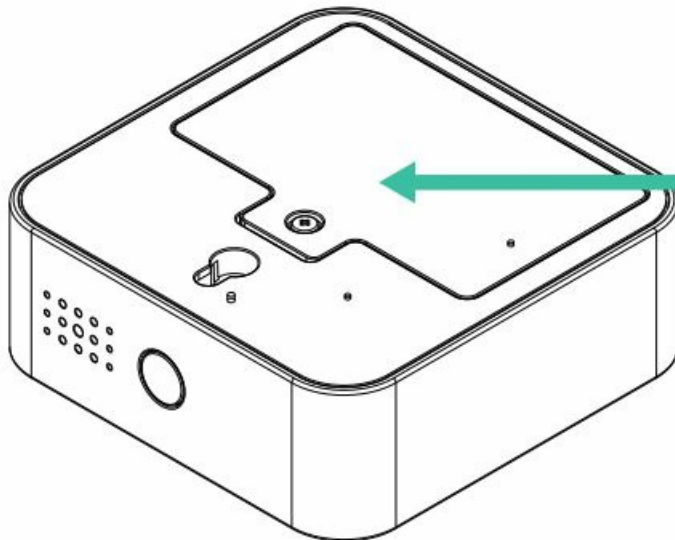

X2

Alkaline AA
LR6 Alkaline battery, AA

4. Re-assemble the battery cover.

MerryIoT Motion Detection (MS10)

1. Tools: Cross-type screwdriver x1 (PH0).



2. Remove the battery cover of the sensor with a cross-type screwdriver (PH0 size).

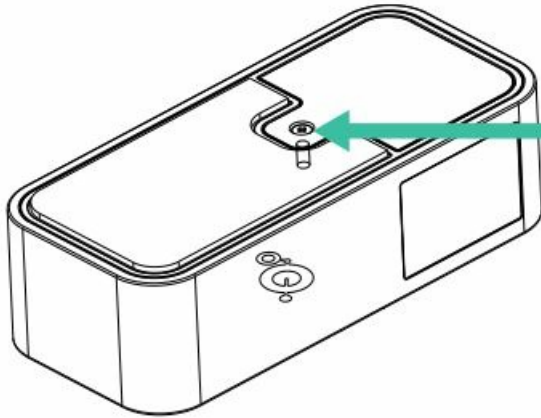

3. Replace the battery with new ones (Li-SiO₂ battery, "ER14250", 1/2 AA size x2 pcs). *Caution: Using batteries other than the ones provided may lead to performance loss, reduced battery life, and device damage. Ensure proper disposal according to environmental regulations. Mixing of cells can result in battery leakage and suboptimal device performance.

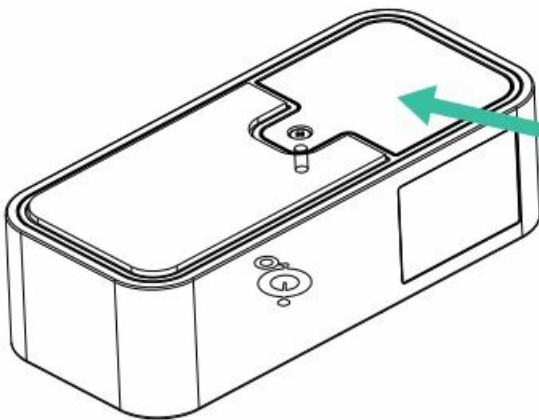

X2

ER14505*
Lithium-thionyl Chloride
(Li-SOCl₂) Battery, AA

4. Re-assemble the battery cover.

MerryIoT Leak Detection (WL10)

1. Tools: Cross-type screwdriver x1 (PH1), Star-type screwdriver x1 (T8H), Plastic disassembly stick (recommended).

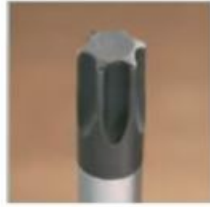

2. Remove 4 rubber stands of the sensor with a disassembly stick.

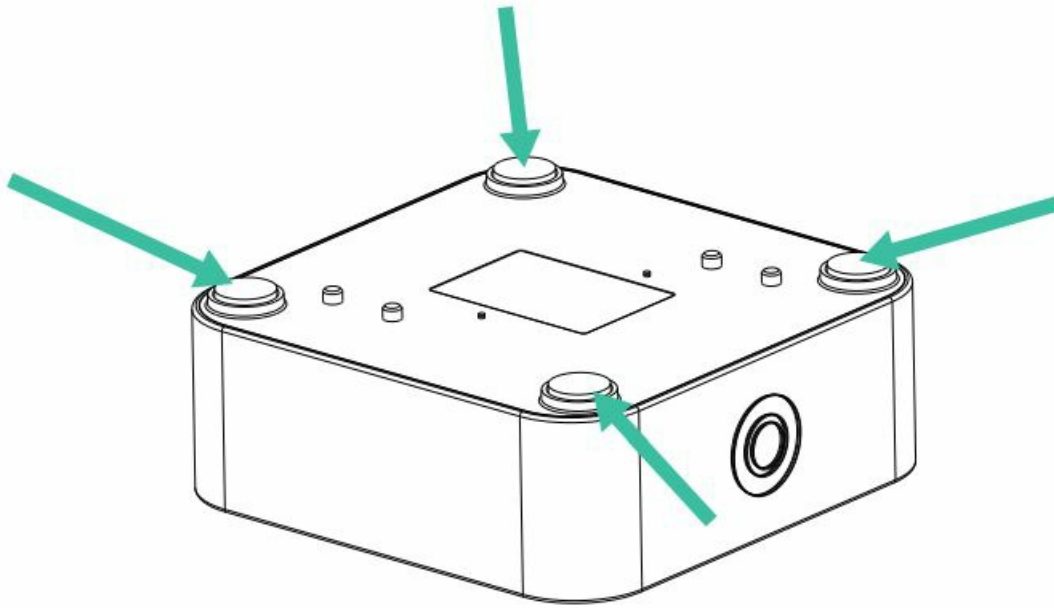

3. Remove the bottom cover of the sensor with a star-type screwdriver (T8H size). *Caution: Removing the bottom cover may affect the water-tightness. Please get help from the Browan team before you do so.

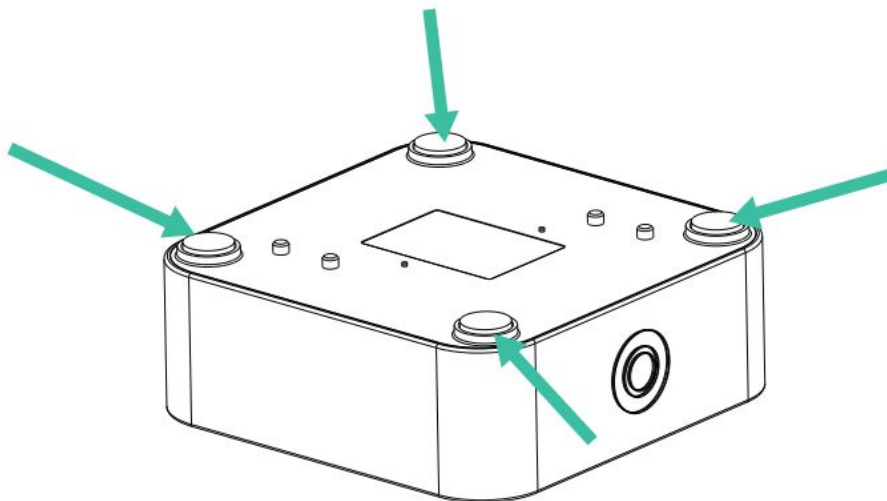

4. Remove the circuit board of the sensor with a cross-type screwdriver x1 (PH1).

Caution: Avoid touching the circuit board with bare hands. Touching boards can release static discharge. Please wear a plastic/rubber glove.

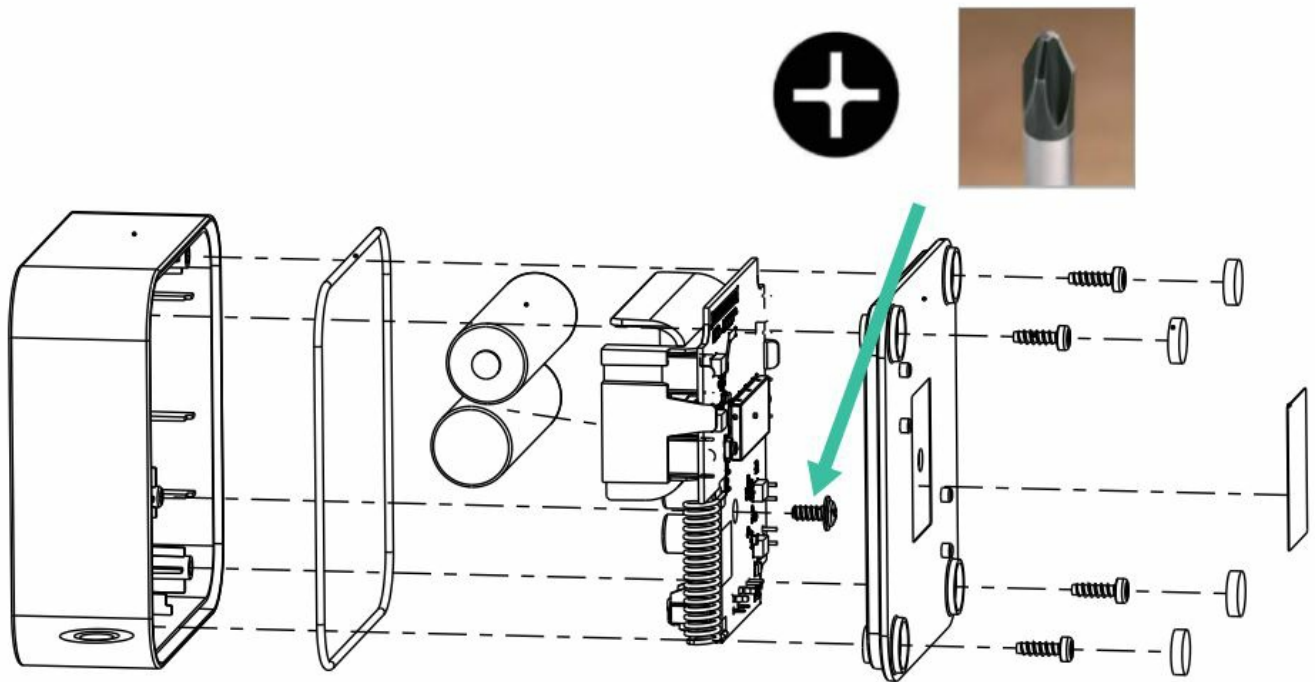

5. Replace the battery with new ones (Alkaline Battery, “LR6”, AA x2 pcs).

- Caution: DO NOT remove the battery holder.
- Caution: Using batteries other than the ones provided may lead to performance loss, reduced battery life, and device damage. Ensure proper disposal according to environmental regulations. Mixing of cells can result in battery leakage and suboptimal device performance.

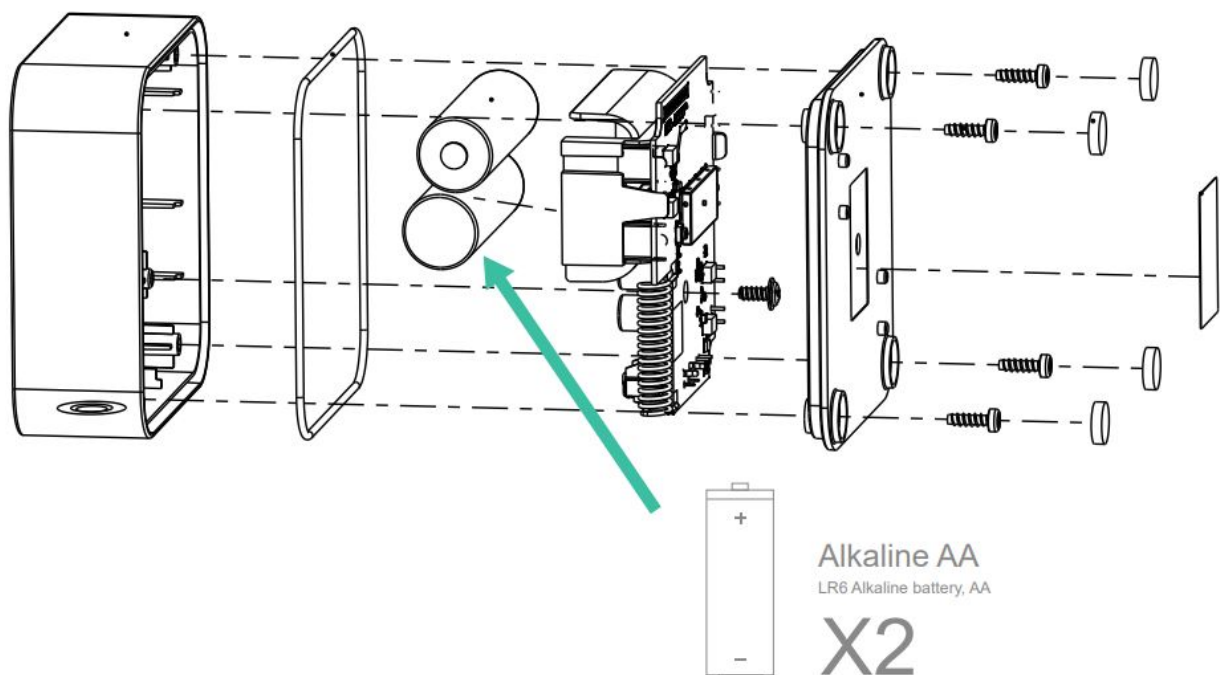

6. Re-assemble the battery cover.

- **Why do I get the error message “Device was not founded” while binding the MerryIoT sensor through the MerryIoT Sidewalk sensor APP?**
 - Answer: Since the MerryIoT Sidewalk sensor APP is only for a sidewalk version of MerryIoT sensors, kindly check with your supplier whether the one you purchased is for use with the MerryIoT Sidewalk version.
- **How long will it take to get the CO2 value?**

- Answer: It takes at least 20 minutes to get the CO2 value by manual activation, or 1 hour automatically.
- Why do I have to “sign in” via Google/Apple ID twice?
 - Answer: The first “sign in” is identified as a pre-sign-up process in AWS Cognito which the MerryIoT Sensor uses to manage third-party social media registration. Once the pre sign-up is complete, the mobile App page will redirect you to the “sign in” page again, then, you can sign in to the mobile APP successfully.
- 4. Why do the APP malfunction when I log in or switch accounts?
 - Answer: If the APP displays abnormality after logging in for the first time or switching accounts, please fully close the APP and then reopen it.

Copyright

© 2022 BROWAN COMMUNICATIONS INC. This document is copyrighted with all rights reserved. No part of this publication may be reproduced, transmitted, transcribed, stored in a retrieval system, or translated into any language in any form by any means without the written permission of BROWAN COMMUNICATIONS INC.

Notice

BROWN COMMUNICATIONS INC. reserves the right to change specifications without prior notice. While this manual has been compiled with great care, it may not be deemed as an assurance of product characteristics. BROWN COMMUNICATIONS INC. shall be liable only to the degree specified in the terms of sale and delivery. The reproduction and distribution of the documentation and software supplied with this product and the use of its contents are subject to written authorization from BROWAN COMMUNICATIONS INC.

Trademark

The products described in this document are licensed products of BROWAN COMMUNICATIONS INC.

Contact Us

- Website: <https://www.merryiot.com>
- E-mail: sales@merryiot.com
- support@merryiot.com
- Address: Brown Communications Incorporation

No.15-1 Zhonghua Rd., Hsinchu Industrial Park, Hukou, Hsinchu, Taiwan, 30352

Documents / Resources



[MERRYIOT Sensors and for Amazon Sidewalk](#) [pdf] Installation Guide
Sensors and for Amazon Sidewalk, Sensors, and for Amazon Sidewalk, Amazon Sidewalk, Sidewalk

References

- [🌐 Sidewalk Coverage Maps](#)
- [🏠 MerryIoT_Home](#)
- [🏠 MerryIoT_FAQ](#)
- [📖 User Manual](#)

[Manuals+](#), [Privacy Policy](#)