



merrithew Valve Replacement Instructions Installation Guide

[Home](#) » [Merrithew](#) » merrithew Valve Replacement Instructions Installation Guide 



Valve replacement

Contents

[1 Valve Replacement Instructions](#)

[2 Documents / Resources](#)

[2.1 References](#)

Valve Replacement Instructions

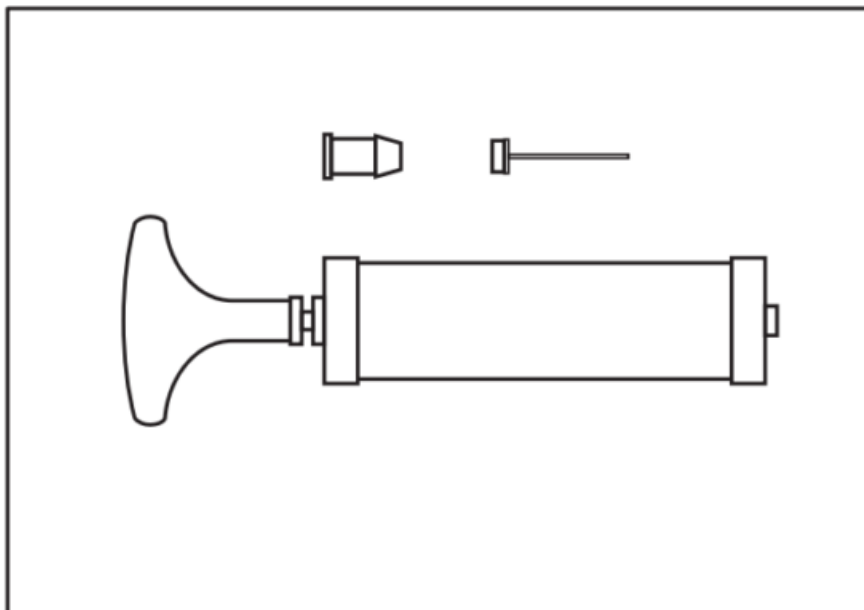

Replacement Valve, Needle, Pump.

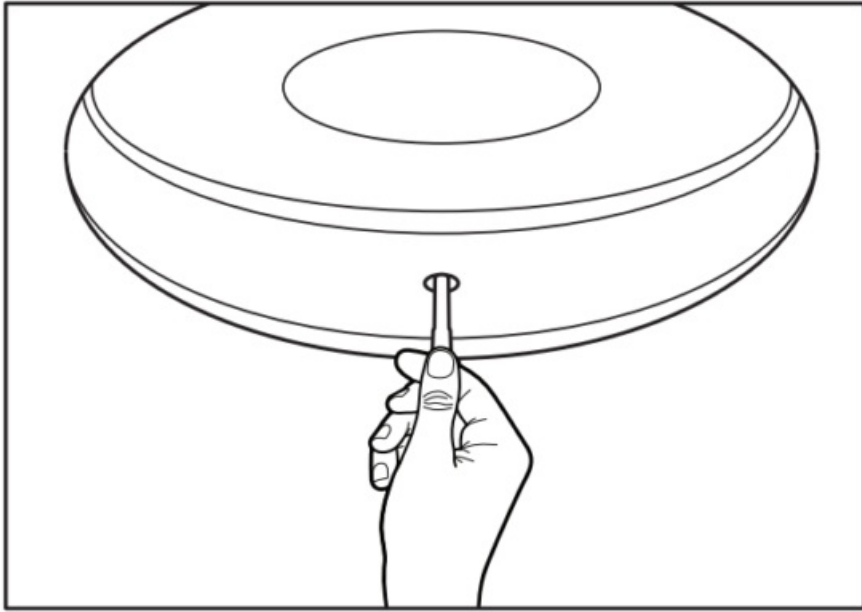

Remove existing plug.

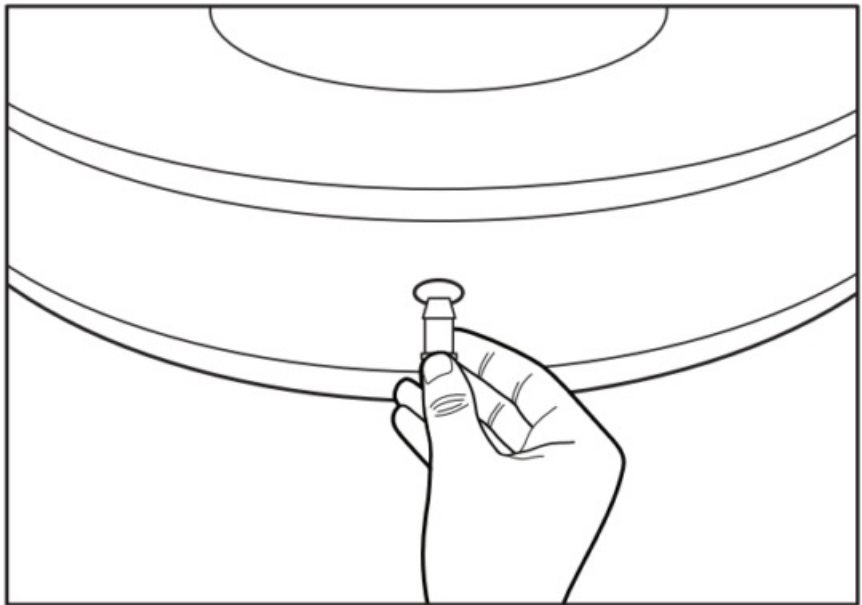

Insert Replacement Valve.

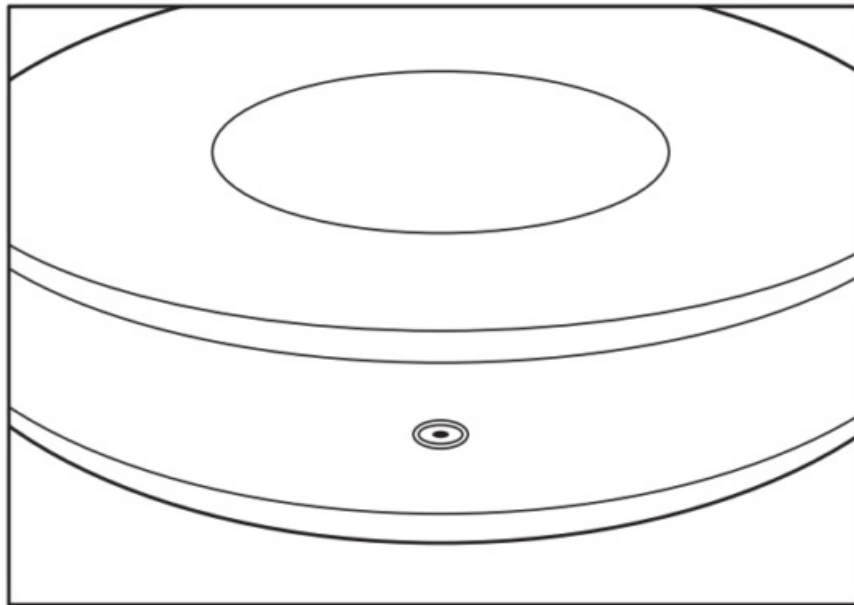

Ensure valve is pushed in all the way.

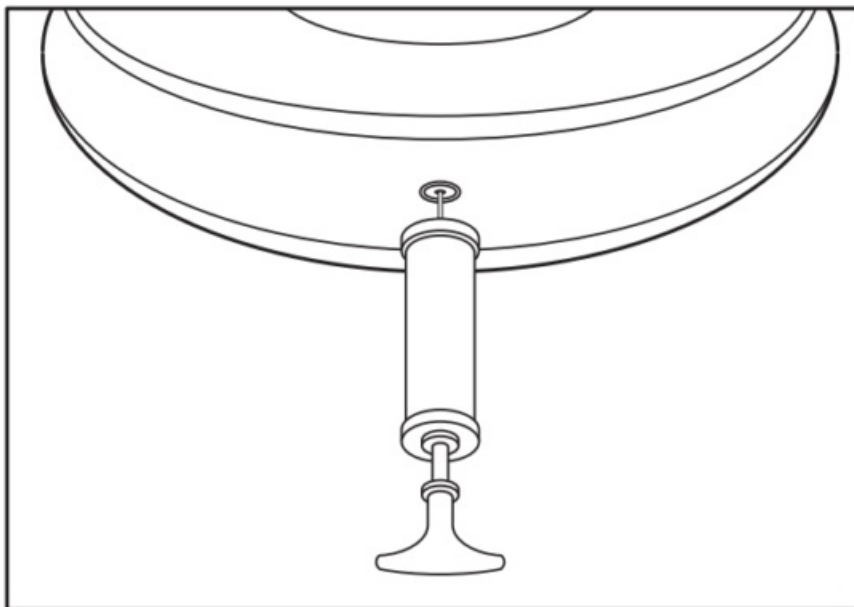

Insert Needle and Pump to inflate.

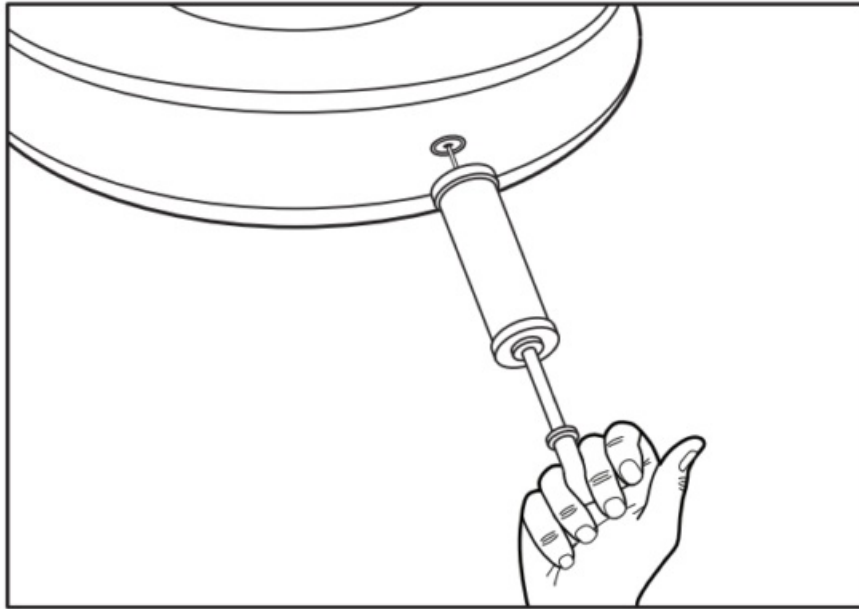

Inflate to desired fullness.

PC-ST05153-1 MAY24 TM/_® Trademark or registered trademark of Merrithew International Inc., used under license. All rights reserved

Documents / Resources

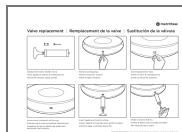

[merrithew Valve Replacement Instructions](#) [pdf] Installation Guide
Valve Replacement Instructions, Replacement Instructions, Instructions

References

- [User Manual](#)

Manuals+. Privacy Policy

This website is an independent publication and is neither affiliated with nor endorsed by any of the trademark owners. The "Bluetooth®" word mark and logos are registered trademarks owned by Bluetooth SIG, Inc. The "Wi-Fi®" word mark and logos are registered trademarks owned by the Wi-Fi Alliance. Any use of these marks on this website does not imply any affiliation with or endorsement.