

**MERCUSYS®**

**MA70XE  
WLAN  
Bluetooth  
PCI Express  
Adapter**



# MERCUSYS MA70XE WLAN Bluetooth PCI Express Adapter Installation Guide

[Home](#) » [MERCUSYS](#) » MERCUSYS MA70XE WLAN Bluetooth PCI Express Adapter Installation Guide 

## Contents

- [1 MERCUSYS MA70XE WLAN Bluetooth PCI Express Adapter](#)
- [2 Before You Start](#)
- [3 Disable Bluetooth](#)
- [4 Connect to a Computer](#)
- [5 Install Drivers](#)
- [6 Pair With Bluetooth Devices](#)
- [7 Safety Information](#)
- [8 Frequently Asked Questions](#)
- [9 Documents / Resources](#)
  - [9.1 References](#)
- [10 Related Posts](#)

**MERCUSYS®**

**MERCUSYS MA70XE WLAN Bluetooth PCI Express Adapter**



## Before You Start

1. If you plan on using Bluetooth and already have connected Bluetooth devices, proceed with step 1. Otherwise, skip to step 2.
2. For Wi-Fi 7 models, make sure you are using Windows 11(64-bit) or above, and your Router or Access Point supports the Wi-Fi 7 standard.

## Disable Bluetooth

- a. Right-click My Computer, select Manage, go to Device Manager.
- b. Expand the Bluetooth node to find your existing Bluetooth device.
- c. Right-click the existing Bluetooth device and select Disable.

Note: Make sure you have disabled all existing Bluetooth devices (both built-in and third-party).

## Connect to a Computer

- a. Turn off your computer, unplug the power cable then remove the case panel.
- b. Connect the provided Bluetooth USB cable to the adapter.

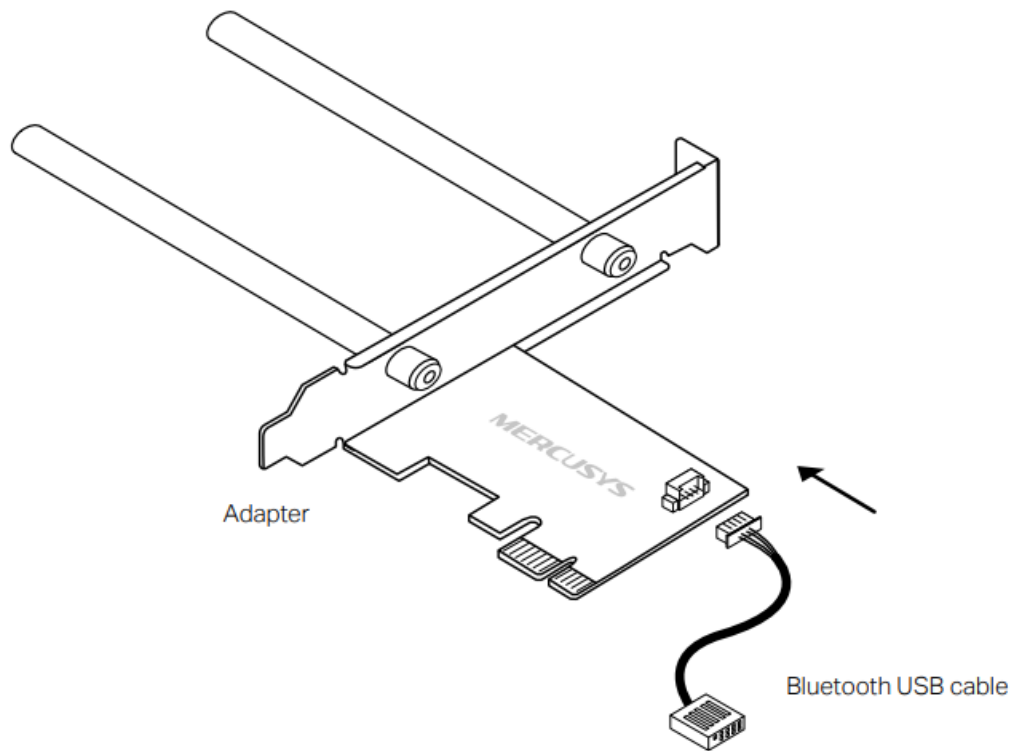

- c. Locate an available PCI-E slot ( X1, X4, X8, or X16) and carefully insert the adapter.

Note: If the bracket is not suitable for your computer, detach it from the adapter's board and replace it with the low-profile bracket.

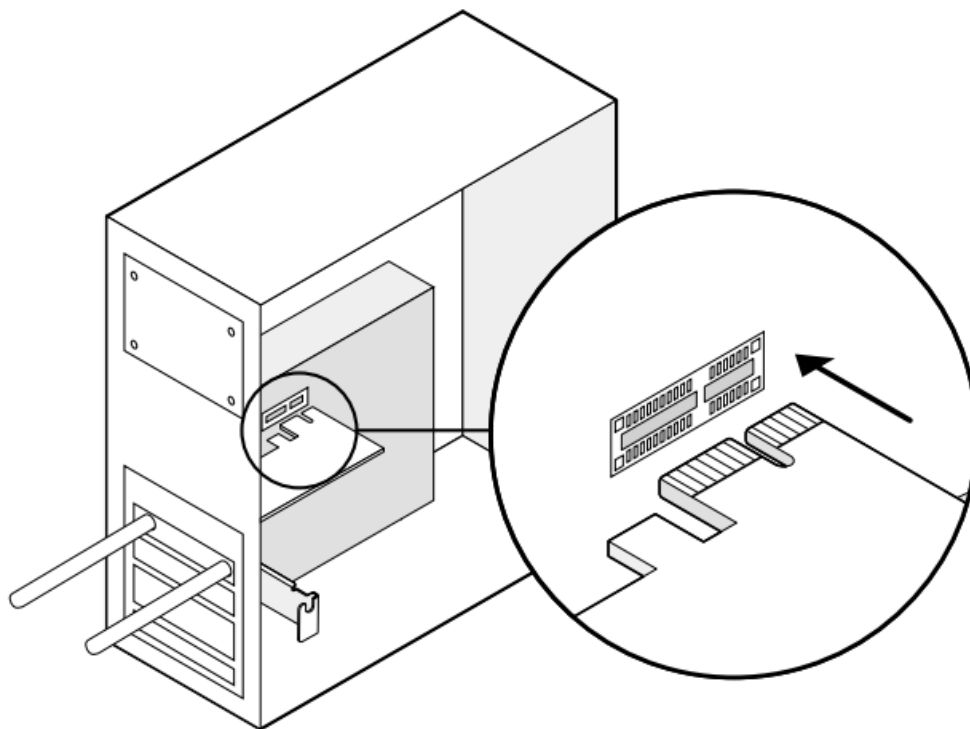

- d. Locate an available F\_USB connector and carefully plug the Bluetooth USB cable into it.

Note: If the Bluetooth USB cable is not correctly connected to the motherboard, Bluetooth function won't work even after driver installation

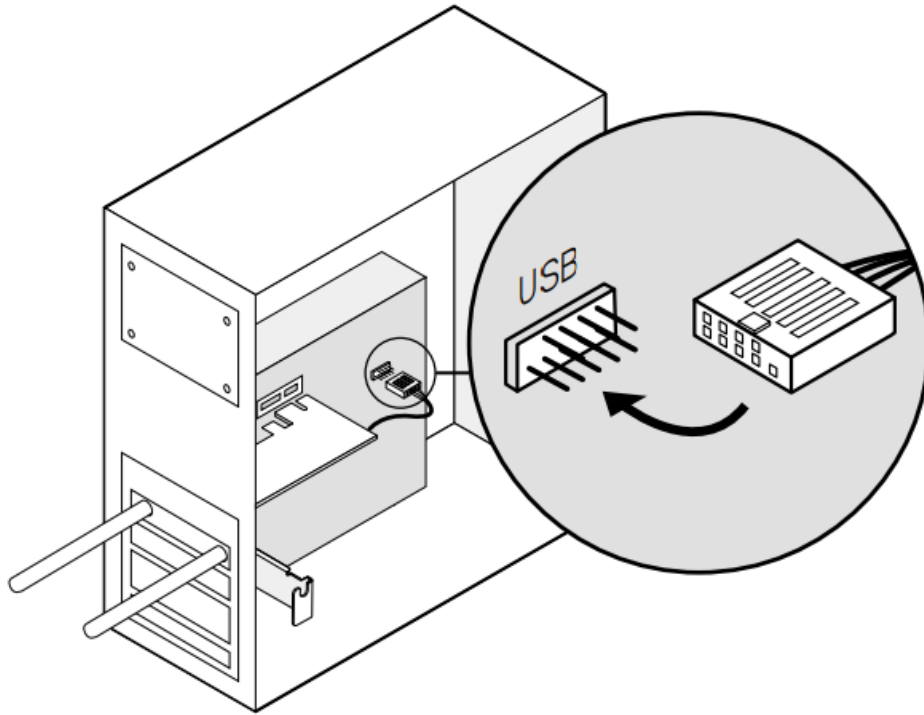

To continue, flip the page over.

- e. Replace the case panel, plug in the power cable and turn on your computer

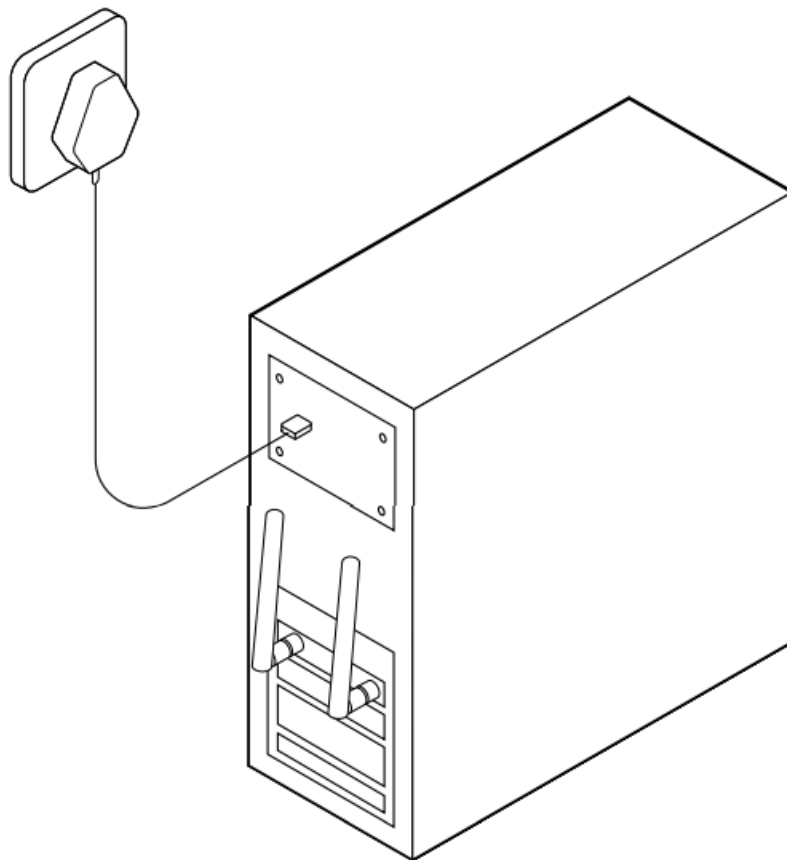

## Install Drivers

- a. Insert the CD and run the Autorun.exe. Tip: You can also check the new release and download the driver at [www.mercusys.com/support](http://www.mercusys.com/support).

- b. Install the Wi-Fi and Bluetooth drivers.





1. Wi-Fi: Click  and follow the onscreen instructions to complete the Wi-Fi installation.

2. Bluetooth: Click  and follow the onscreen instructions to complete the Bluetooth installation.

#### Notes:

- DO NOT run the driver installations at the same time. When one driver is being installed, please wait until the installation is complete and then try to install the other.
- If an unknown publisher message pops up, select Yes to continue.
- If Windows User Account Control requires admin credentials, type user username and password of your Windows administrator account.

#### Join a Wireless Network

- a. Click the network icon on the taskbar (the icon might look like one of these: , , , or ).
- b. Select your Wi-Fi network, click Connect, and enter the password when prompted.

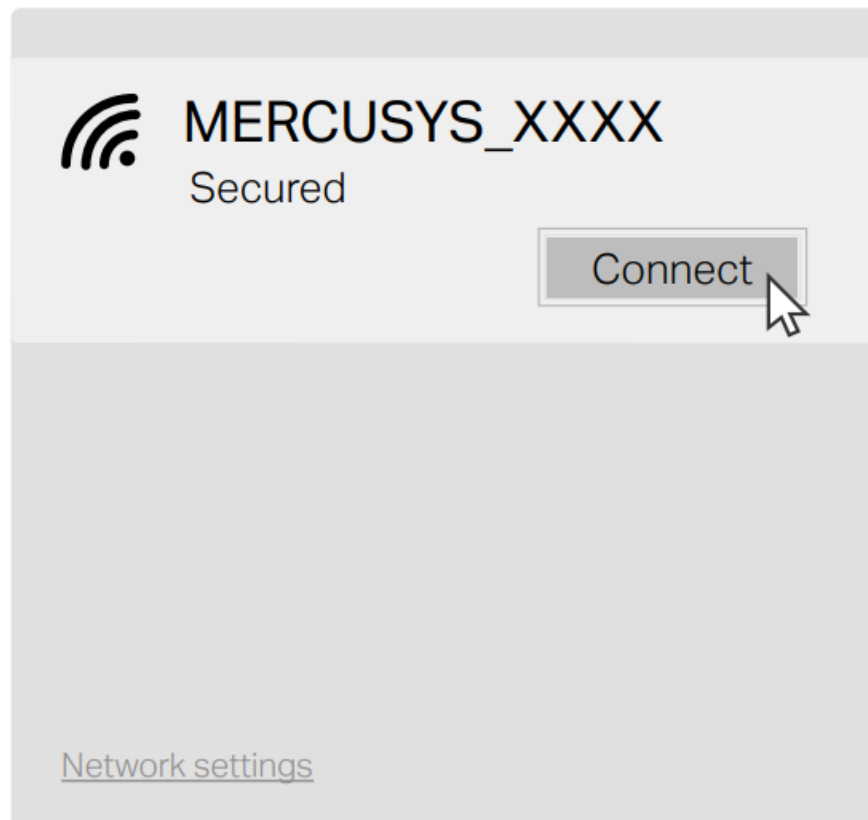

#### Pair With Bluetooth Devices

- a. Right-click the  (Bluetooth) icon on the taskbar. If it's not displayed, turn on Bluetooth in your PC settings first.
- b. Select Add a Bluetooth Device or Add a Device to scan for available devices.
- c. Select your Bluetooth device from the list and follow the onscreen instructions to complete pairing.

Note: Make sure your device's Bluetooth is enabled and discoverable.

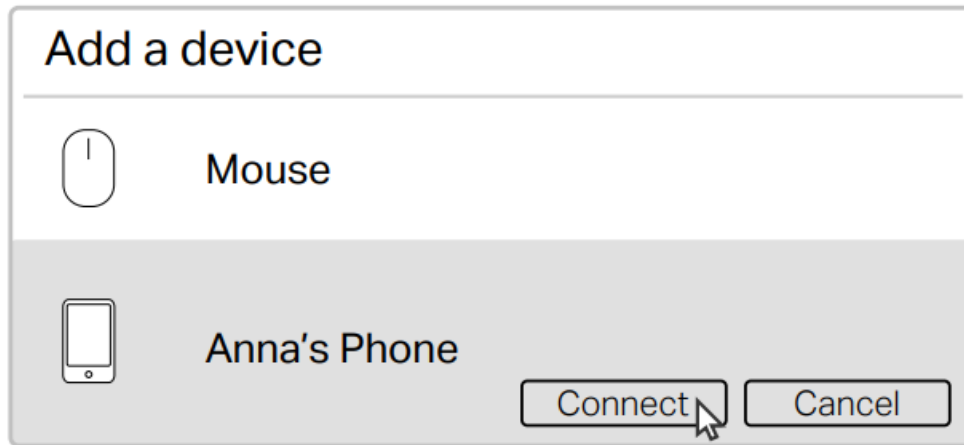

## Support

For technical support, the user guide and more information, please visit <https://www.mercusys.com/support>.

## Safety Information

- Keep the device away from water, fire, humidity or hot environments.
- Do not attempt to disassemble, repair, or modify the device. If you need service, please contact us.
- Do not use the device where wireless devices are not allowed.
- This equipment can be powered only by equipment that complies with Power Source Class 2 (PS2) or Limited Power Source (LPS) defined in the standard of IEC 62368-1.

Mercusys hereby declares that the device is in compliance with the essential requirements and other relevant provisions of directives 2014/53/EU, 2011 /65/EU and (EU) 2015/863. The original EU Declaration of Conformity may be found at <https://www.mercusys.com/en/ce> Mercusys hereby declares that the device is in compliance with the essential requirements and other relevant provisions of the Radio Equipment Regulations 2017. The original UK Declaration of Conformity may be found at <https://www.mercusys.com/support/ukca/>



Images may differ from your actual product. ©2024 MERCUSYS 7107500349 REV2.1.0

## Frequently Asked Questions



- **Q: What do I do if my Bluetooth function doesn't work even after driver installation?**
  - A: Ensure that the Bluetooth USB cable is correctly connected to the motherboard's F\_USB connector.
- **Q: How can I get technical support?**

- A: Visit [www.mercusys.com/support](http://www.mercusys.com/support) for technical support, user guides, and more information.

## Documents / Resources

	<a href="#">MERCUSYS MA70XE WLAN Bluetooth PCI Express Adapter</a> [pdf] Installation Guide MA70XE, MA70XE WLAN Bluetooth PCI Express Adapter, MA70XE, WLAN Bluetooth PCI Express Adapter, Bluetooth PCI Express Adapter, PCI Express Adapter, Adapter
---	---

## References

-  [Support-Welcome to MERCUSYS](#)
-  [Regulatory Compliance - Welcome to MERCUSYS](#)
-  [Support-Welcome to MERCUSYS](#)
- [User Manual](#)

[Manuals+](#), [Privacy Policy](#)

This website is an independent publication and is neither affiliated with nor endorsed by any of the trademark owners. The "Bluetooth®" word mark and logos are registered trademarks owned by Bluetooth SIG, Inc. The "Wi-Fi®" word mark and logos are registered trademarks owned by the Wi-Fi Alliance. Any use of these marks on this website does not imply any affiliation with or endorsement.