

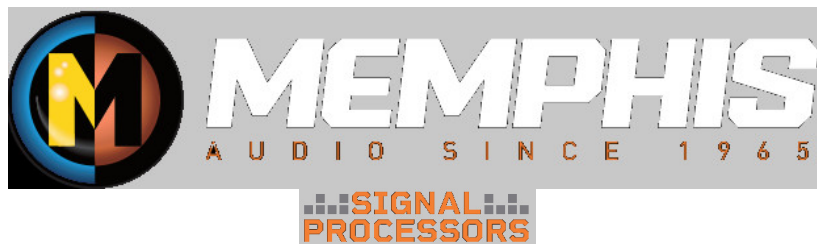

MEMPHIS LL2BE 2-Channel Line Output Converter with Digital Bass Restoration Instructions

[Home](#) » [MEMPHIS](#) » MEMPHIS LL2BE 2-Channel Line Output Converter with Digital Bass Restoration Instructions 



**LL2BE
2-CHANNEL LINE OUTPUT CONVERTER
WITH DIGITAL BASS RESTORATION**

Contents

- [1 DC TURN ON](#)
- [2 ENHANCED BASS COMPENSATION](#)
- [3 SETUP](#)
- [4 SPECIFICATIONS](#)
- [5 FEATURES](#)
- [6 SINGLE AMPLIFIER WIRING](#)
- [7 MULTI AMPLIFIER WIRING](#)
- [8 Documents / Resources](#)
- [9 Related Posts](#)

DC TURN ON

Connect the power, ground, and speaker level inputs. When you turn on the factory audio system, the LL2BE will turn on. After the LL2BE turns on, it will provide a 12-volt trigger output to turn on your amplifier as well.

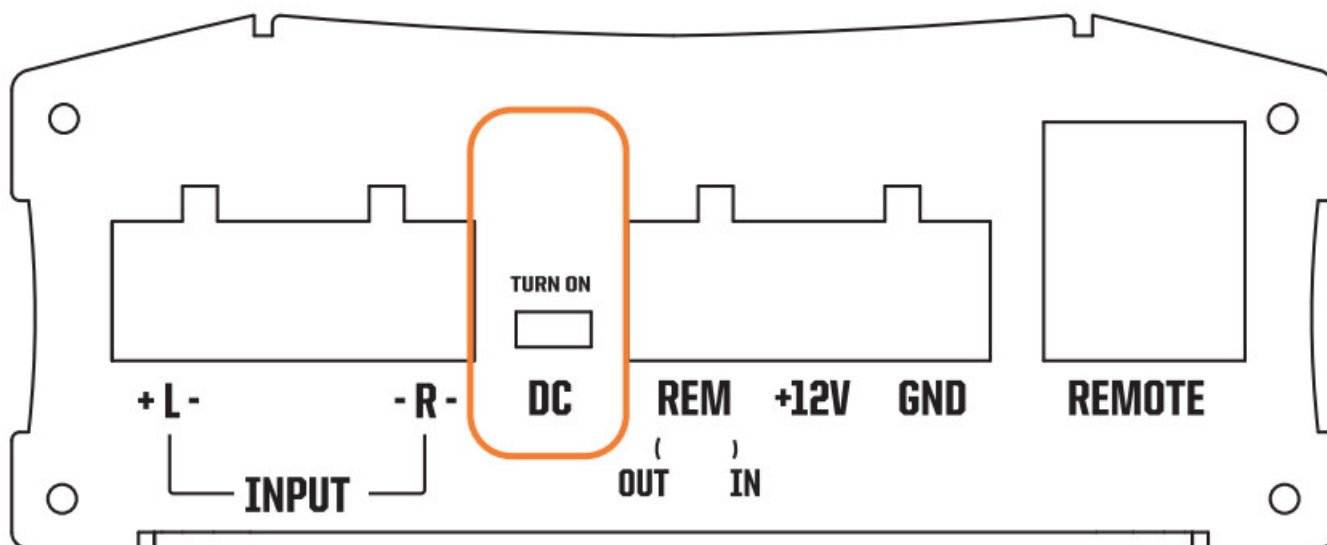

ENHANCED BASS COMPENSATION

Factory speaker systems will compress bass at a high volume. The Enhanced Bass Compensation will restore this loss of bass making your music sound as it was intended-

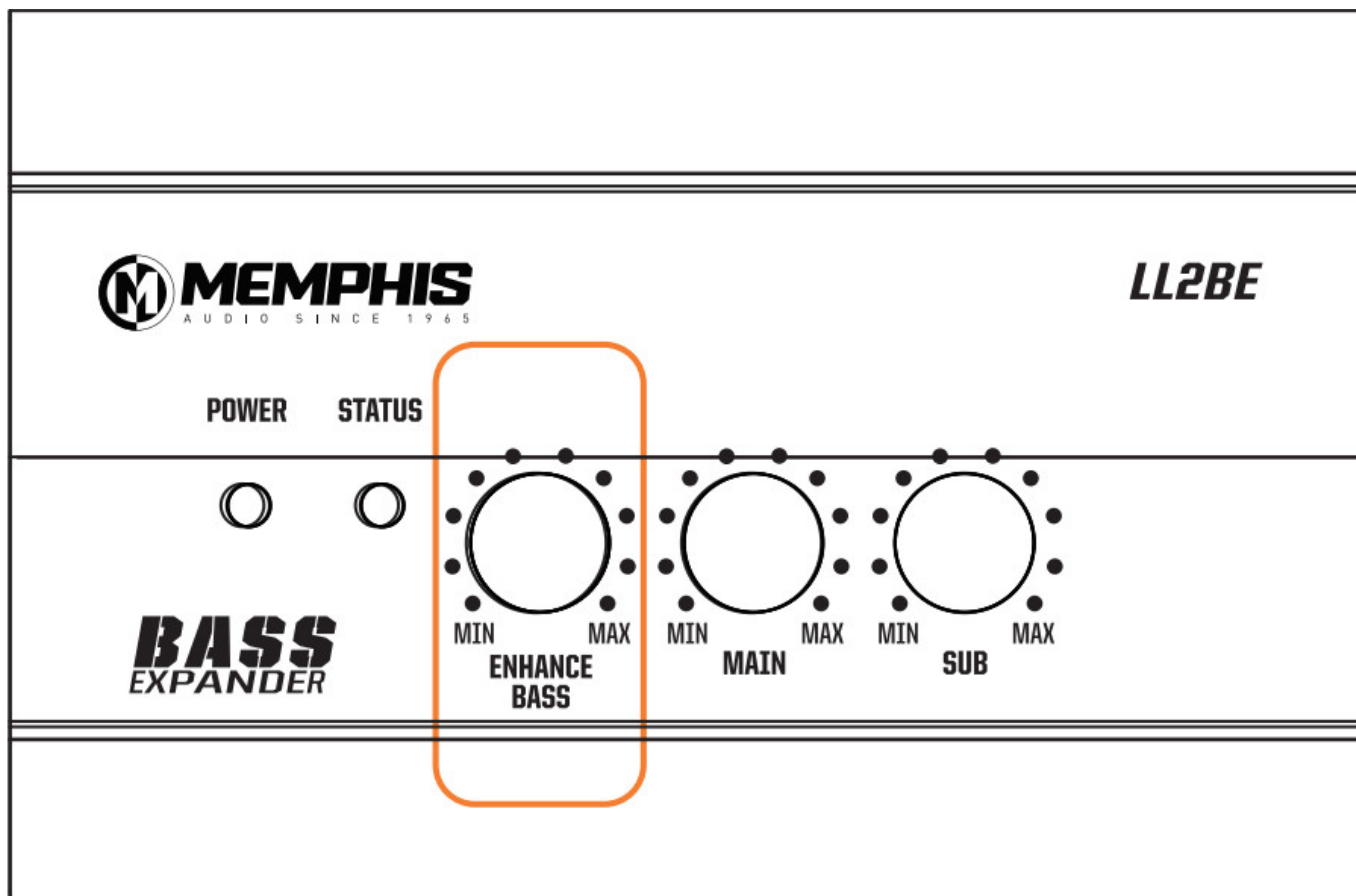

SETUP

1. Turn the system on and play the music that has bass.
2. Turn up the volume while you listen for the bass.
3. Listen for the bass to drop of. Once it does, leave the volume and do not adjust the volume level of your system.
4. Set the ENHANCED BASS LEVEL CONTROL on the top of the LL2BE to the center.
5. Using a small screwdriver, turn the ENHANCED BASS THRESHOLD clockwise slowly until you hear the bass return.
6. Re-adjust the ENHANCED BASS LEVEL CONTROL on the top of the unit to achieve the proper amount of bass compensation. Once this is set, your installer-

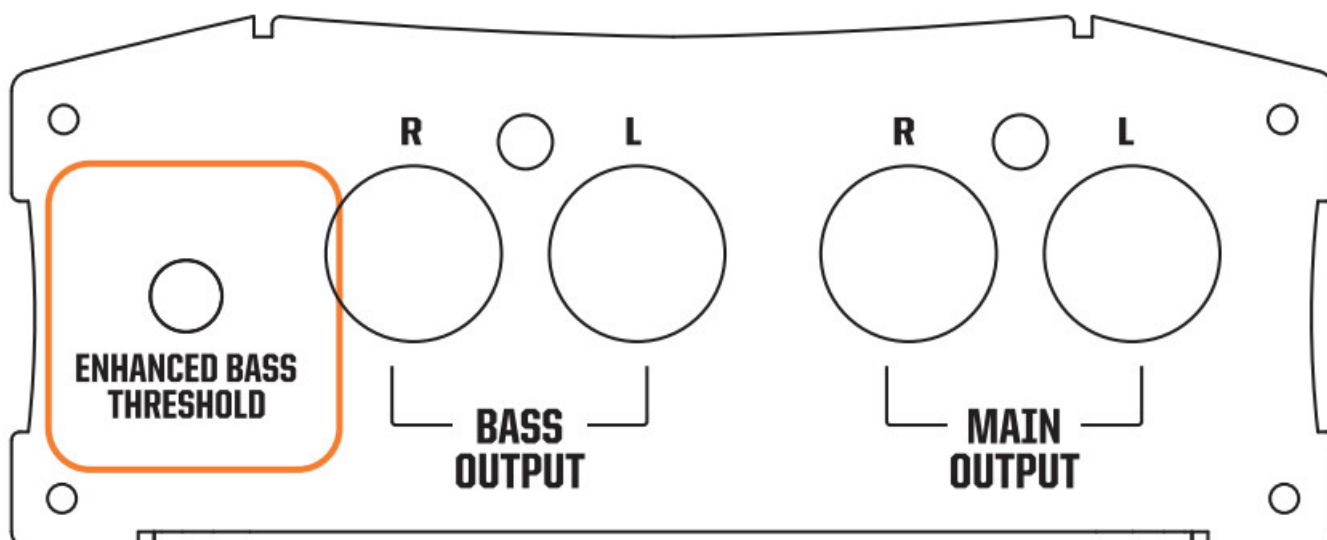

SPECIFICATIONS

Maximum Speaker Level Input	400 wat
Maximum Preamp Output	9.8Vrms
Optional Dash Level Control Remote	+0dB / -
Frequency Response	33 Hz –
Total Harmonic Distortion	1%
Signal to Noise Ratio (Ref to 2Vrms out, unity gain)	-91.3dB
Input Impedance	20K ohr
Output Impedance	150 ohn

Bass Enhancement



FEATURES

- Speaker level inputs accepts up to 400 watts RMS
- Bass compensation
- Selectable auto-turn on
- 9.5V Pre-out • 12Volt trigger out
- Dual amplifier options
- Level matching controls
- Optional dash remote level included

SINGLE AMPLIFIER WIRING

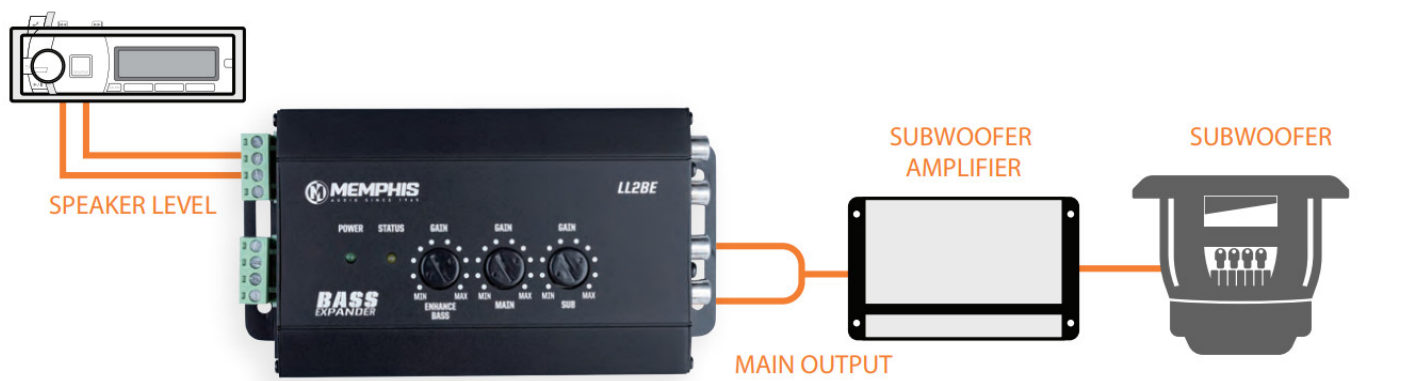

MULTI AMPLIFIER WIRING

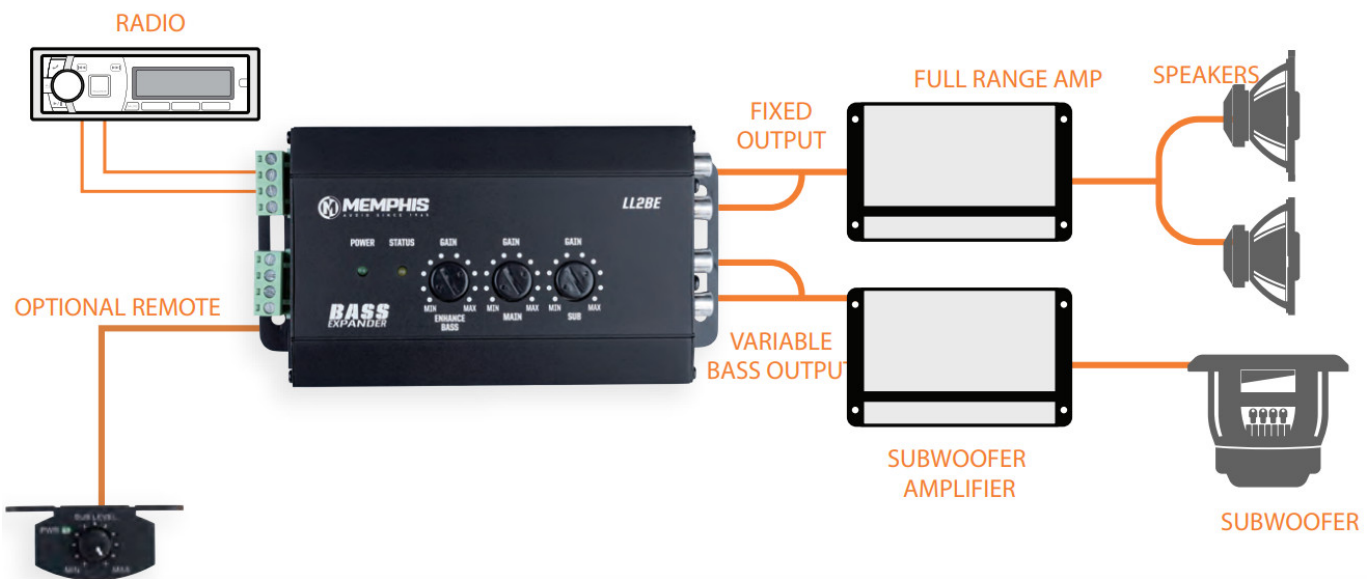

Documents / Resources

	<p>MEMPHIS LL2BE 2-Channel Line Output Converter with Digital Bass Restoration [pdf] Instructions</p> <p>LL2BE, 2-Channel Line Output Converter with Digital Bass Restoration, 2-Channel Line Output Converter, Output Converter, Converter, LL2BE 2-Channel Line Output Converter with Digital Bass Restoration, Line Output Converter with Digital Bass Restoration, Converter with Digital Bass Restoration</p>
--	--