



[Home](#) » [meloght](#) » **meloght MESLD130DWG PIR LED Wall Lights with Motion Sensor Instruction**

**Manual** 

## **Contents** [ [hide](#) ]

- [1 meloght MESLD130DWG PIR LED Wall Lights with Motion Sensor](#)
- [2 Specification](#)
- [3 COMPONENTS AND STRUCTURE](#)
- [4 PARTS LIST](#)
- [5 HOW TO OPERATE THE APP](#)
- [6 HOW TO CONNECT WITH ALEXA AND GOOGLE ASSISTANT APP](#)
- [7 Induction recording](#)
- [8 PREPARATION](#)
- [9 INSTALLATION STEPS](#)
- [10 TROUBLESHOOTING](#)
- [11 FCC Warning](#)
- [12 Documents / Resources](#)
  - [12.1 References](#)

**meloght<sup>®</sup>**

**meloght MESLD130DWG PIR LED Wall Lights with Motion Sensor**



## Specification

- Model MESLD 130DWG
- Input Voltage 100-120V 60Hz
- Input Current 1.3A
- Rated Power 120W
- Luminous Flux 1200lm
- CCT 2700-6500K
- CRI 280
- Power Factor 0.5
- L-70B50 lifetime 30000hours L70B50 @250
- Beam Angle 120
- ta -20-400C/-40F-1040F
- Luminaire Location SUITABLE FOR WET LOCATIONS

## DIMENSIONS

- Model MESLD130DWG
- Dimensions (LxHxW) 400x234x130 mm / 15.7x9.21x5.12 in
- Weight 1.12kg / 2.47lb

**Note:** The testing standard of the product's luminous flux: Place the three/two lights on the same horizontal surface for testing, and the tested luminous flux is the accurate luminous flux.

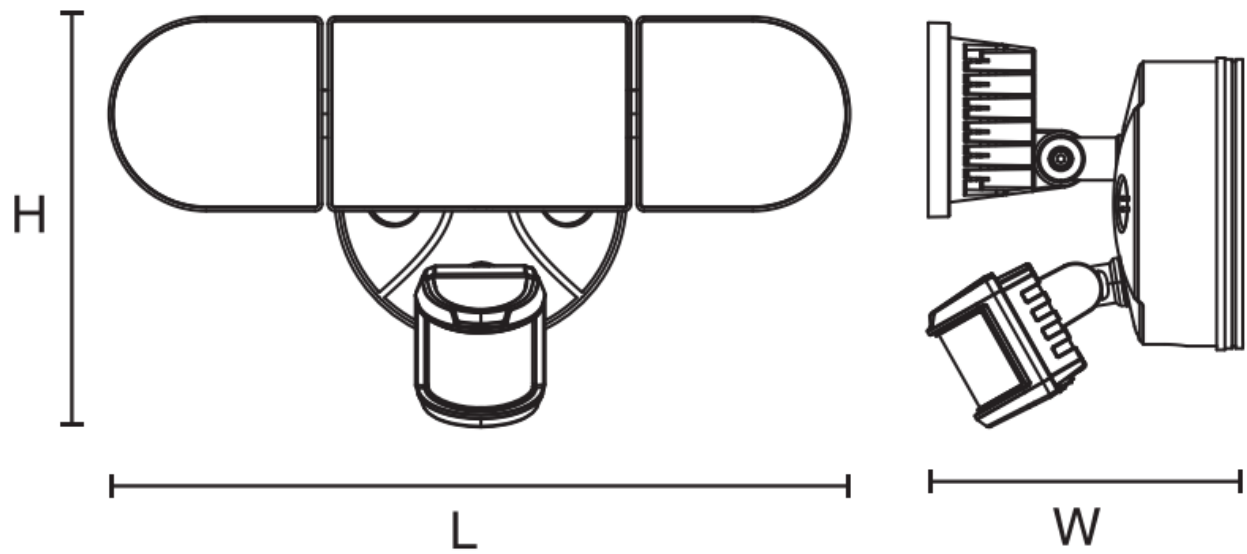

## COMPONENTS AND STRUCTURE

### MESLD130DWG

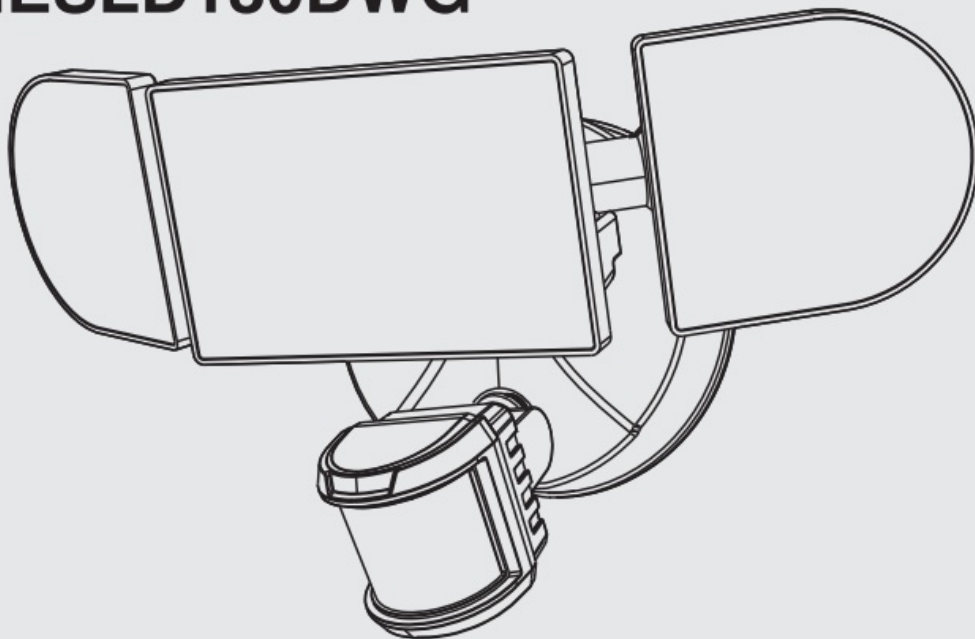

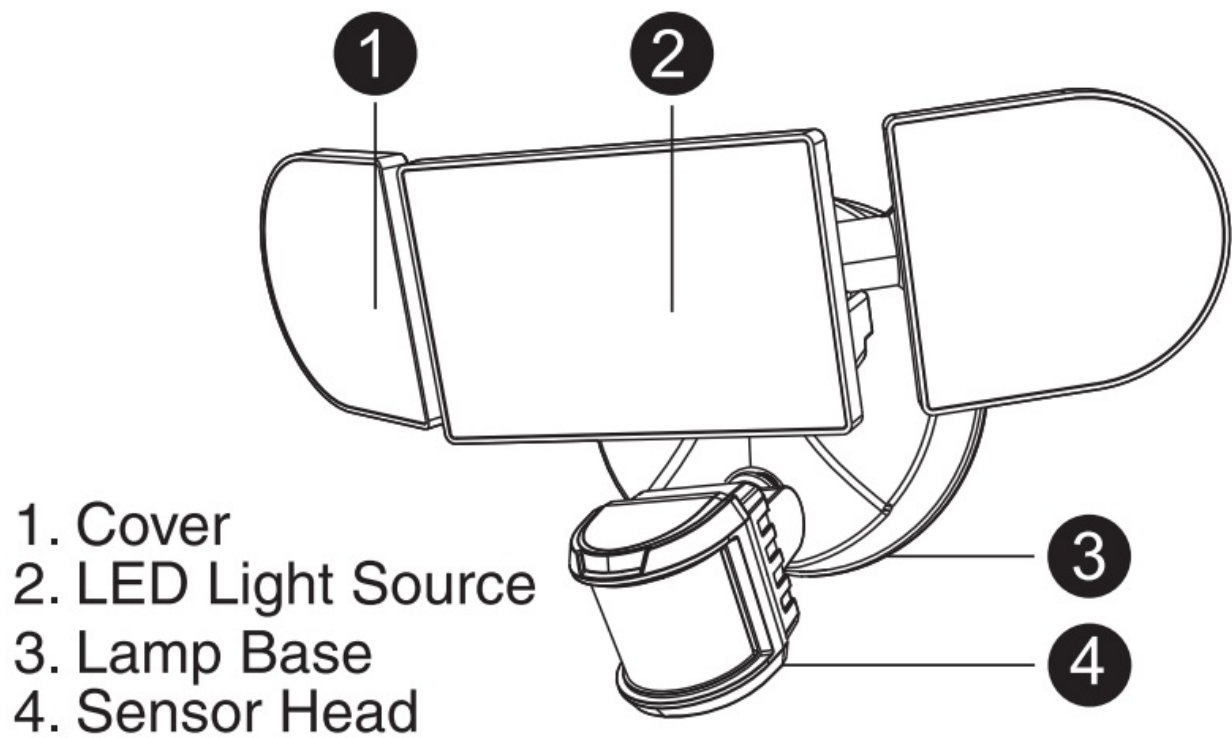

## PARTS LIST

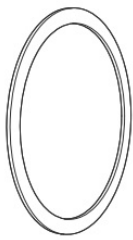

**A** EVA Gasket  
QTY: 1

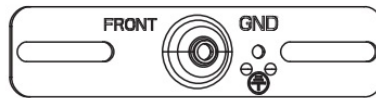

**B** Mounting Bracket  
QTY: 1



**C** Machine Screw  
QTY: 2

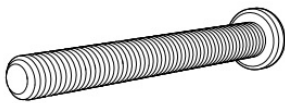

**E** Long Machine Screw  
QTY: 1



**F** Silicone Gasket  
QTY: 1

## PAIRING LED LIGHT WITH “Smart Life “OR “Smart Life-Smart Living” APP

### Step 1. Get the App and the Account

1. “Smart Life” OR “Smart Life-Smart Living” App Download. There are 2 options for obtaining and downloading the “Smart Life” OR “Smart Life-Smart Living” App on your smart device.

1. Scan the QR code, find the corresponding icon, and click to obtain it. As shown in the left image.

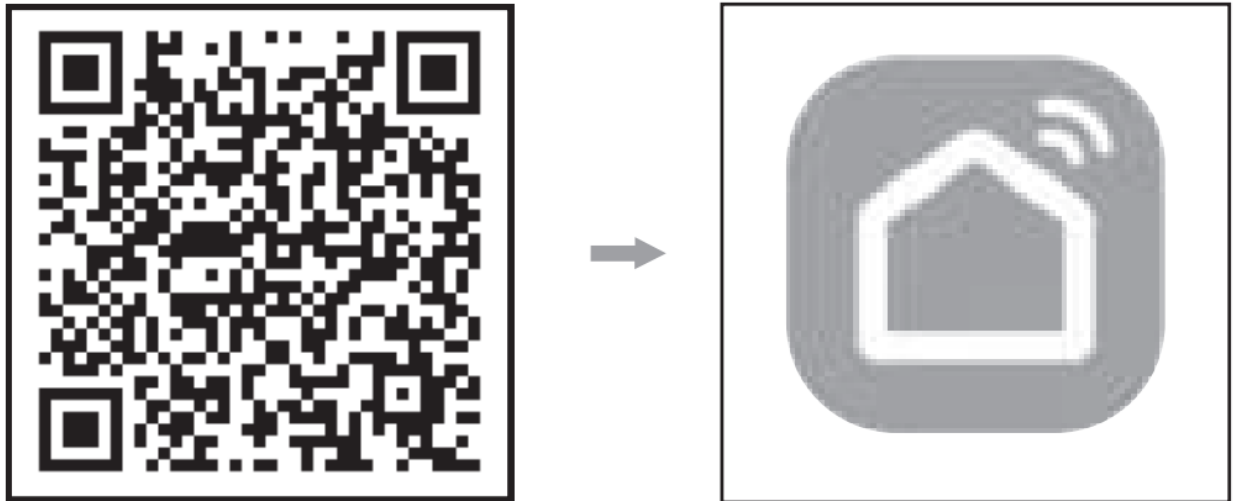

2. Search for “Smart Life” OR “Smart Life-Smart Living” in the App Store or Google Play.

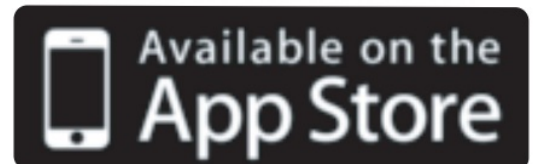

2. Enter the “Smart Life” OR “Smart Life-Smart Living” App. Register an account and log in. If you already have an account for the App, please select “Log in with existing account”.

**Note:** You will need your “Smart Life” OR “Smart Life-Smart Living” App username and password pair with Amazon Alexa and/or Google Assistant.

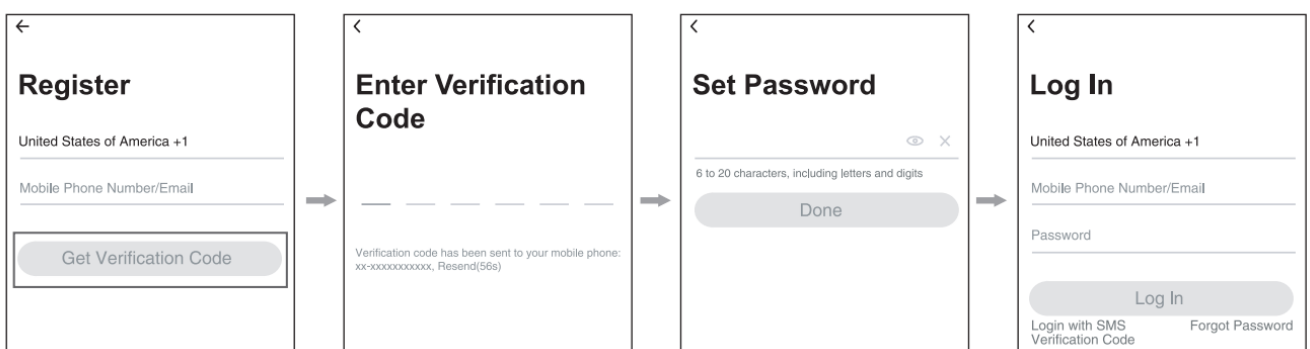

3. Please turn on the Wi-Fi and Bluetooth before connecting LED lights to the “Smart Life” OR “Smart Life-Smart Living” App.



#### 4. Step 4: How to Pair the LED Light

Set the light to the pending pairing state.

1. Power on the LED Light.
2. Turn the light on and off 3 times until it starts flashing, indicating that the light is ready for pairing.

##### **Method 1**

1. Tap the “+” button in the top right corner and tap “Add Device” to add a device.
2. The app will automatically search for the device. After discovering the device, tap “Add”.
3. Enter your Wi-Fi password to join your network. Please Note:
  1. (a) This smart LED Light can only support a 2.4 GHz network and cannot work with a 5.0 GHz network.
  2. (b) Please check if your home network is 2.4 GHz and make sure that your phone has been connected to your Wi-Fi network. Please ensure your network is not hidden.



4. Wait for the device to register (about 30-60 seconds).
5. Tap “Done” to complete the light pairing.
6. You can tap ” Z ” to change the device name.



## Method 2

1. Tap the “+” button in the top right corner and tap ‘Add Device” to add a device.
2. Tap lil-ightingil and then ‘Light Source” to enter the next page.
3. Tap the Next button to pair the LED Light.

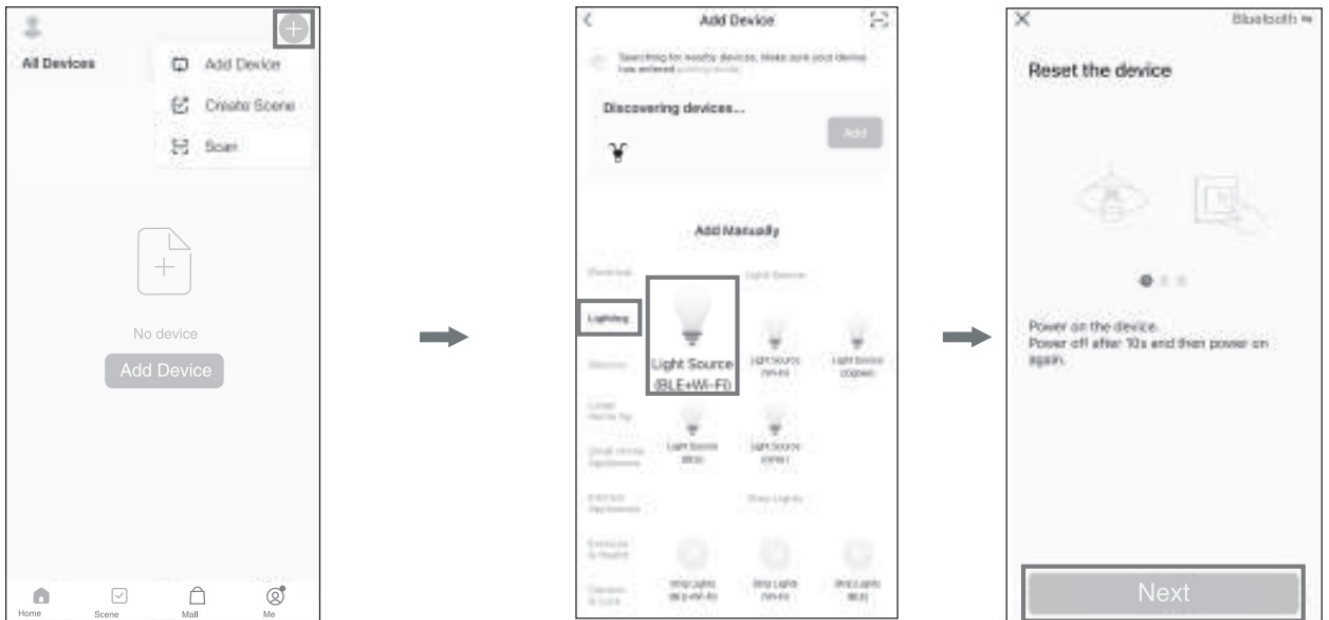

4. Enter your Wi-Fi password to join your network. Please Note:
  1. (a) This smart LED Light can only support a 2.4 GHz network and cannot work with a 5.0 GHz network.
  2. (b) Please check if your home network is 2.4 GHz and make sure that your phone has been connected to your Wi-Fi network. Please ensure your network is not hidden.
5. Wait for the device to register (about 30-60 seconds).
6. Tap “Done” to complete the light pairing.



## HOW TO OPERATE THE APP

1. Color Temperature and Brightness Adjustment



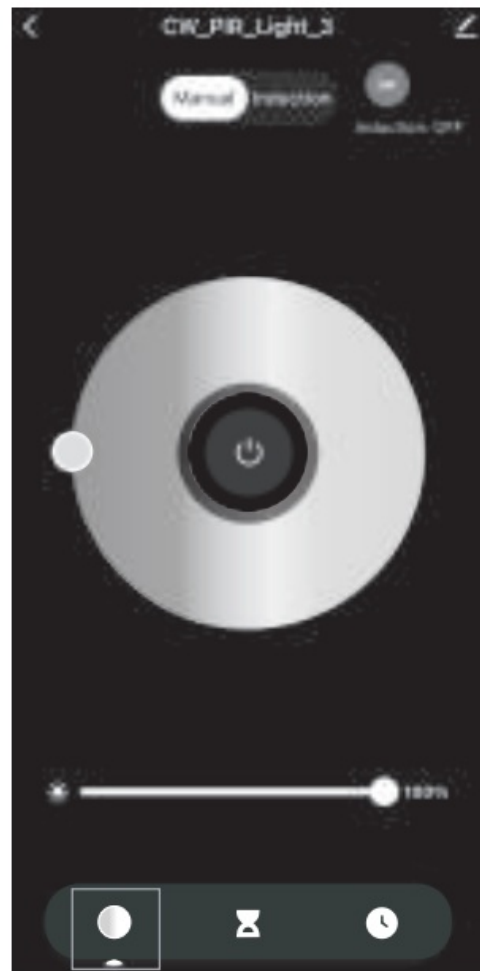

## 2. Delay Setting



## 3. Schedule



#### 4. Motion Sensing Settings

1. Sensing distance setting Low (13-26ft), Middle (26-49ft) High (49-72ft). .9 FI  
Indu(Son
2. Full light duration setting from 5s to 60 minutes.

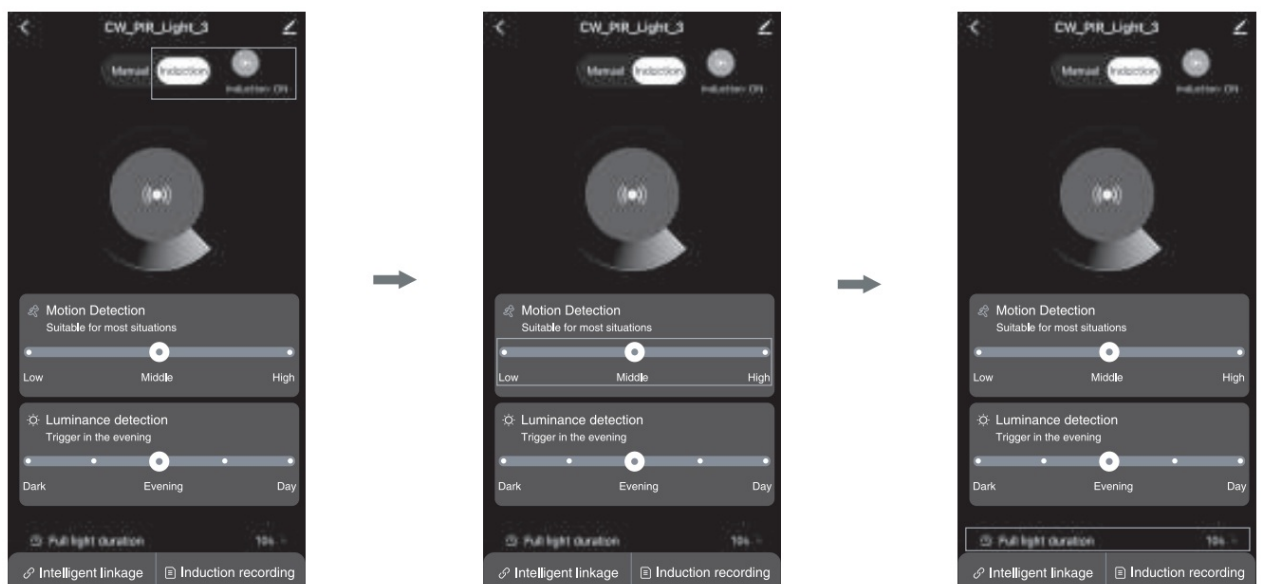

5. Dusk-to-Dawn Settings The sensitivity can be set to Day, Dusk, Evening, Night, and Dark, and the light will be on at the selected time.

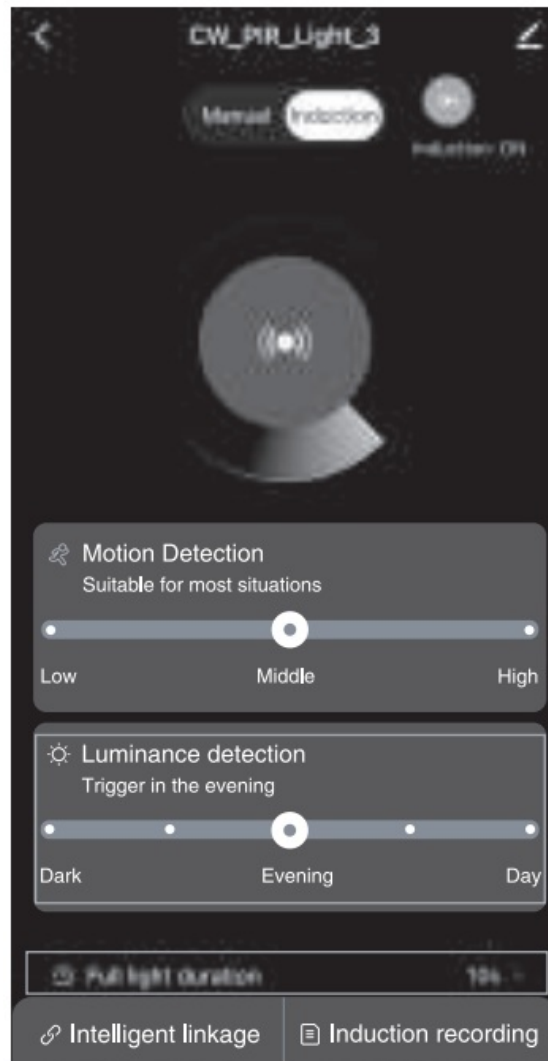

6. Slight Bright Mode Here, you can choose the slight bright mode and its brightness. Microlight duration setting Microlight duration can be set from 1min to 8hrs, or it can be set to be always on.

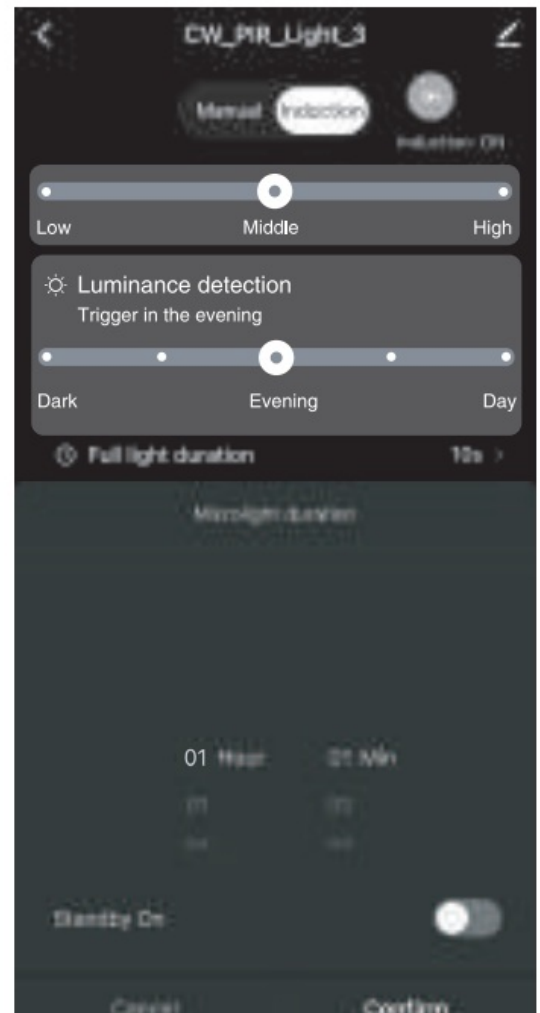
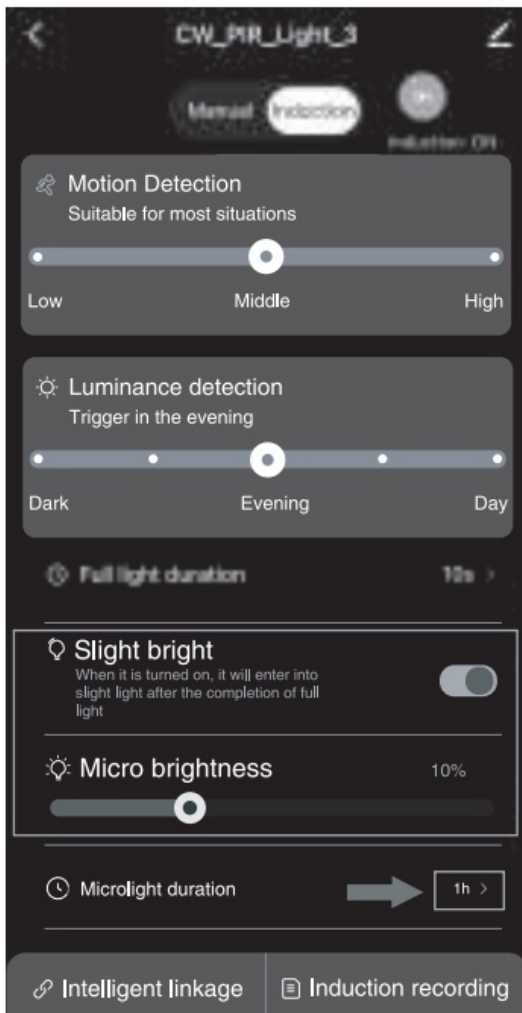

7. Intelligent linkage. See the timed light shut-off example below. Use this method to configure other scenes.

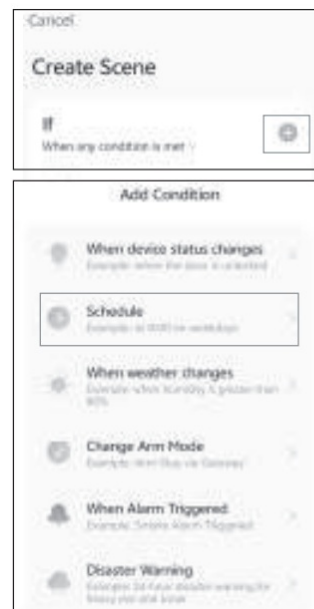
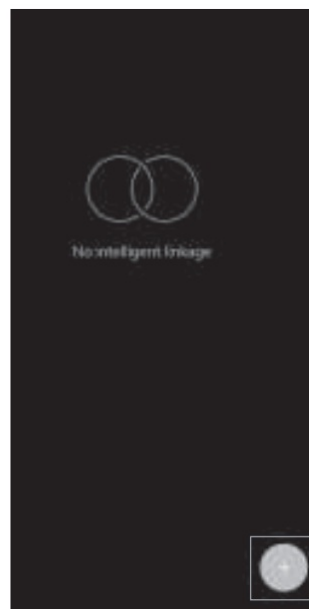
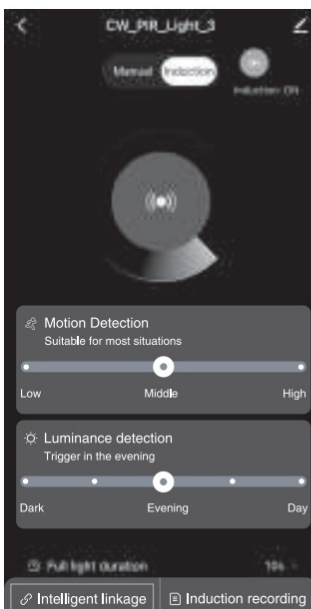

## HOW TO CONNECT WITH ALEXA AND GOOGLE ASSISTANT APP

Intelligent linkage + if(+) —+ Schedule —time —Confirm —+ Device —+ On/Off Off Save —Next —Save — Enter scene name Confirm Save.



## Induction recording

Record the time when motion is detected. Tap “Me”, find the third-party voice device you want to connect to, and tap it, then follow the steps to connect.

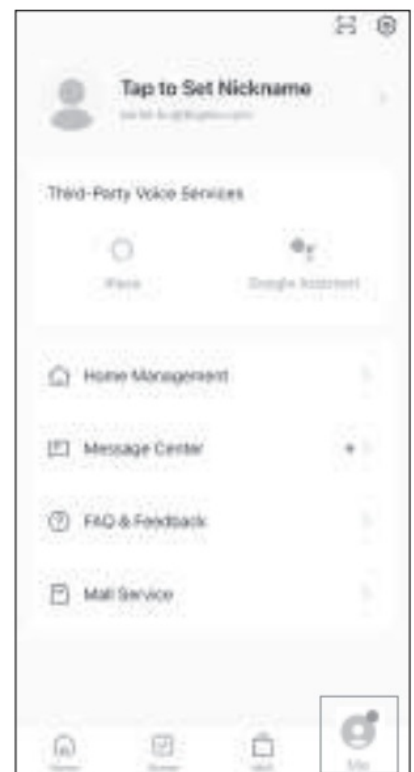
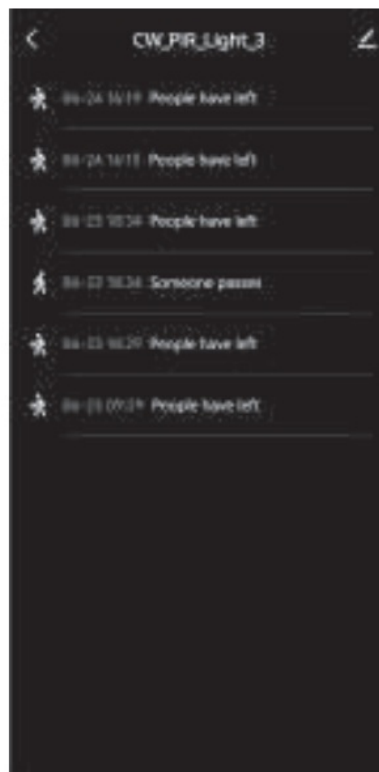
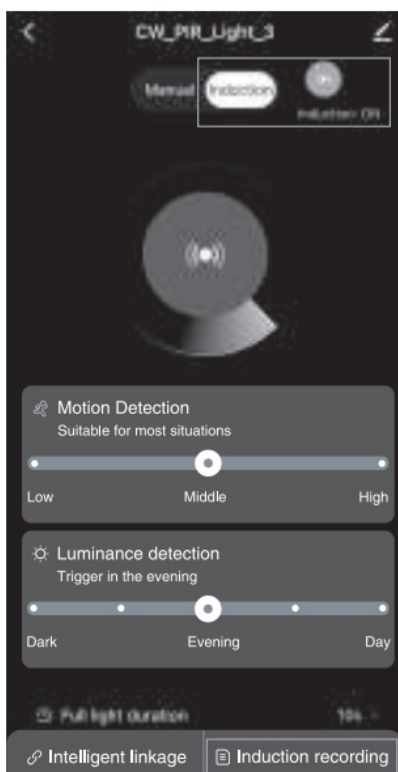

## OPERATION INSTRUCTIONS

Detection Range: 1800

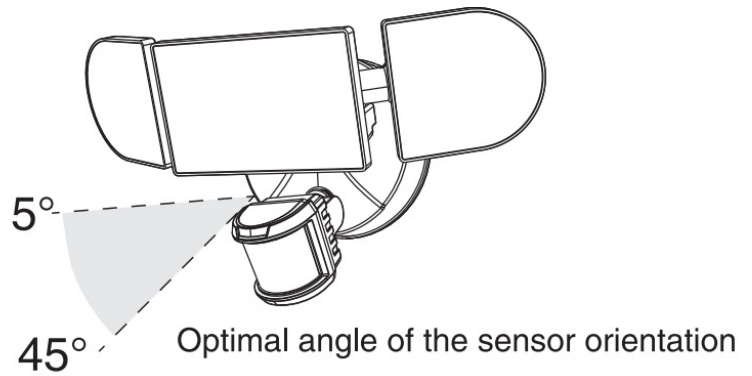
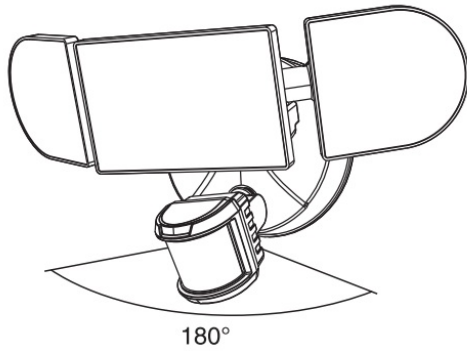

### NOTE:

1. The PIR sensor shall always be tilted slightly downward.
2. The orientation angle of the sensor shall be between 5-450.

**RECOMMENDED INSTALLATION HEIGHT: 6.5-13.1 feet above the ground.**

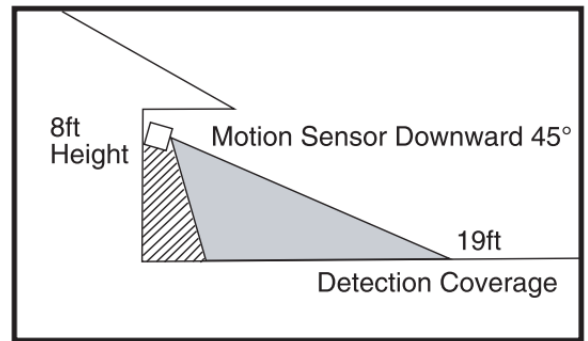
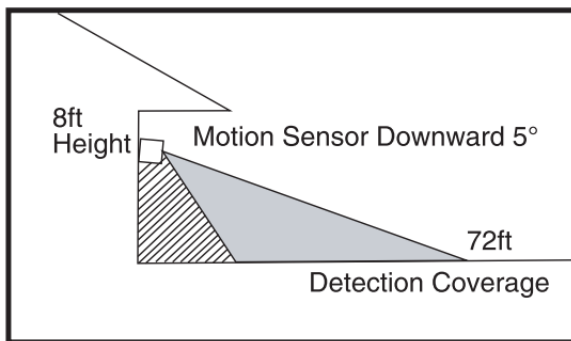

When mounted 8ft above the ground and the sensor is 5° down, the maximum sensing distance is about 72ft. When mounted 8ft above the ground and the sensor is 45° down, the minimum sensing distance is about 19ft.

**Note:** The detection distance of the sensor is the farthest when the ambient temperature is 25 °C. Any temperature fluctuations above or below 25°C will affect the detection distance. If the light continues to detect motion while it is on, it will remain on until the motion stops.

**Walk straight to the flood light, sensitivity will be lower, pass the flood light from the side, and sensitivity will be higher.**

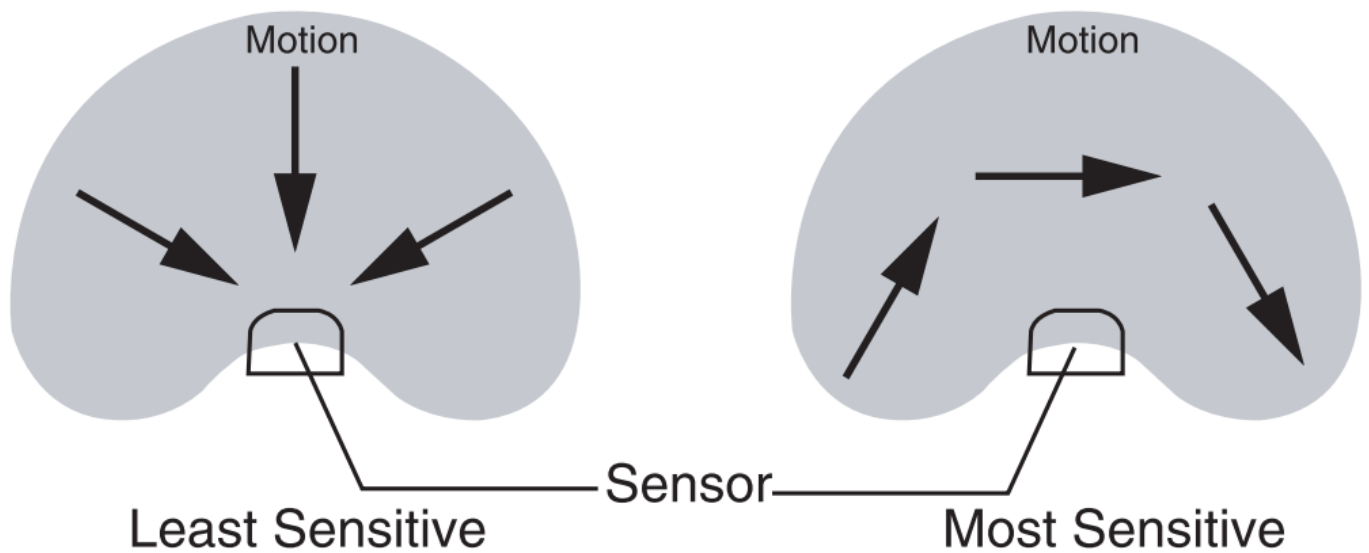

## PREPARATION

**NOTE:** Before beginning assembly of the product, make sure all parts are present.

Compare parts with the parts list. If any part is missing or damaged, do not attempt to assemble the product. Estimated Assembly Time: 30-60 minutes. Recommended to be installed 2.5m (8.2ft) above the ground but not higher than 5m (16.4ft).

**Product appearance may vary from the image shown.**

## TOOLS REQUIRED



Flathead  
screwdriver



screwdriver



Silicone Sealant

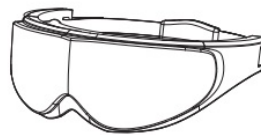

Eye Protection



Pliers



Step Ladder

**WARNING:** THIS PRODUCT MUST BE INSTALLED BY THE APPLICABLE INSTALLATION CODE BY A PERSON FAMILIAR WITH THE CONSTRUCTION AND OPERATION OF THE PRODUCT AND THE HAZARDS INVOLVED.

**CAUTION:** PLEASE MAKE SURE YOUR WALL SWITCH AND POWER MAIN CIRCUIT BREAKER ARE BOTH OFF. IF IN DOUBT ABOUT ELECTRICAL INSTALLATION, CONSULT A LICENSED ELECTRICIAN.

## PREPARATION

**RISK OF SHOCK:** BEFORE BEGINNING INSTALLATION, TURN OFF ELECTRICITY AT THE CIRCUIT BREAKER BOX OR THE MAIN FUSE BOX.

**NOTE:** BE SURE TO USE WIRE NUTS/CONNECTORS RATED FOR THE CORRECT GAUGE AND NUMBER OF WIRES USED. MAKE SURE THERE ARE NO EXPOSED WIRE BUNDLES OUTSIDE THE WIRE NUT/CONNECTOR (IF APPLICABLE). BE CAREFUL NOT TO DAMAGE OR CUT THE WIRE INSULATION (COVERING) DURING INSTALLATION. DO NOT LET THE WIRES TOUCH ANY SHARP EDGES.

**WARNING:** DO NOT CONNECT THIS LIGHT FIXTURE TO AN UNGROUNDED ELECTRICAL SYSTEM. ATTACH GROUND FIXTURE WIRE TO EITHER THE GREEN GROUND SCREW ON THE MOUNTING PLATE OR THE GROUND WIRE IN THE OUTLET BOX. INSTALLING THIS LIGHT IN AN UNGROUNDED ELECTRICAL SYSTEM MAY CAUSE THE METAL PARTS OF THE LIGHT TO CARRY CURRENT IF ANY WIRES OR WIRE CONNECTIONS ARE DAMAGED OR LOOSE. IN THIS CASE, ANYONE WHO TOUCHES THE LIGHT WILL RECEIVE AN ELECTRIC SHOCK, RESULTING IN INJURY OR DEATH.

## INSTALLATION STEPS

FOR WET LOCATIONS, MAKE SURE TO FILL THE GAP OF THE EVA GASKET AND MOUNTING SURFACE WITH SEALING COMPOUND OR SILICONE GLUE.

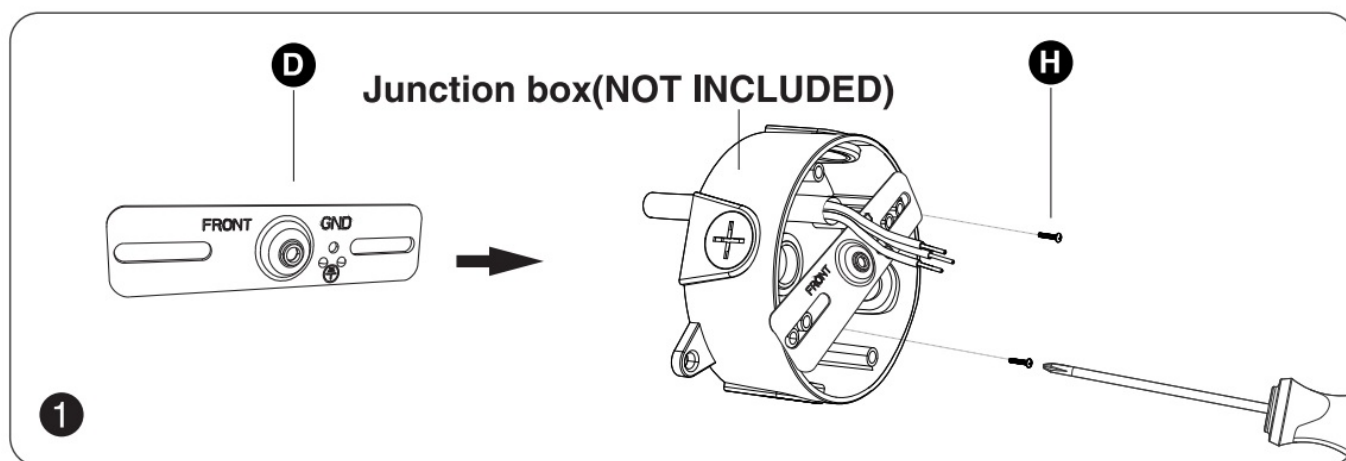



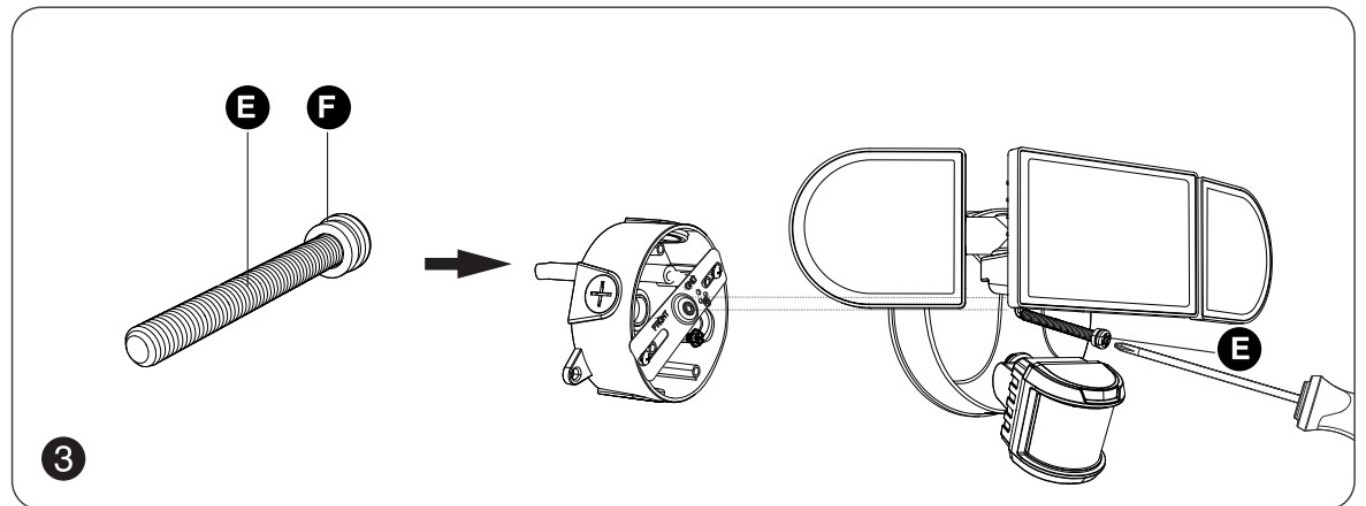
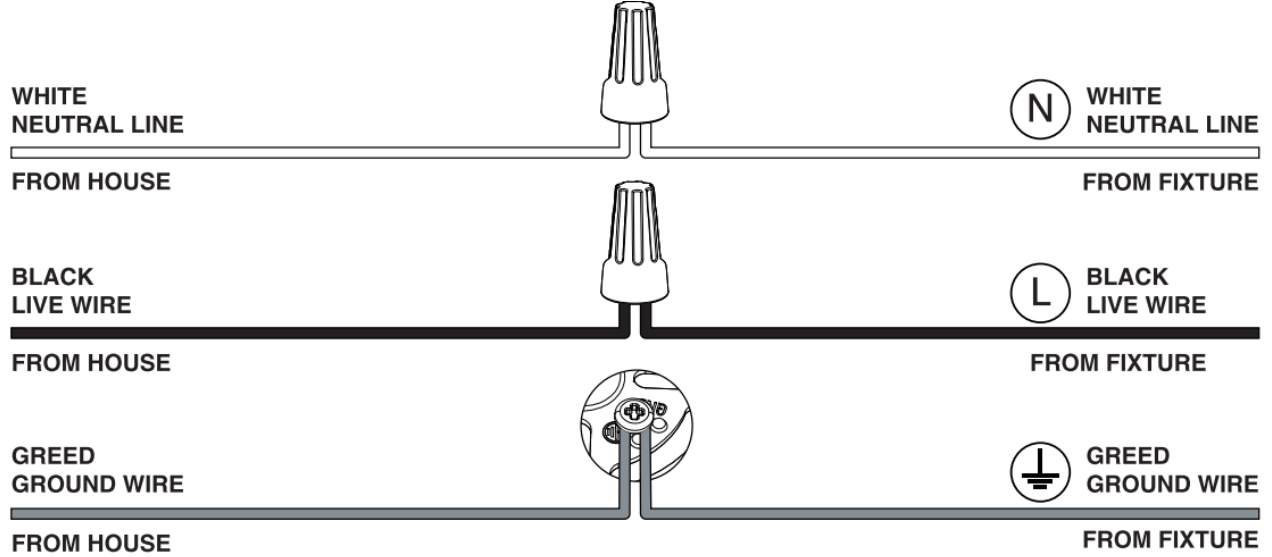
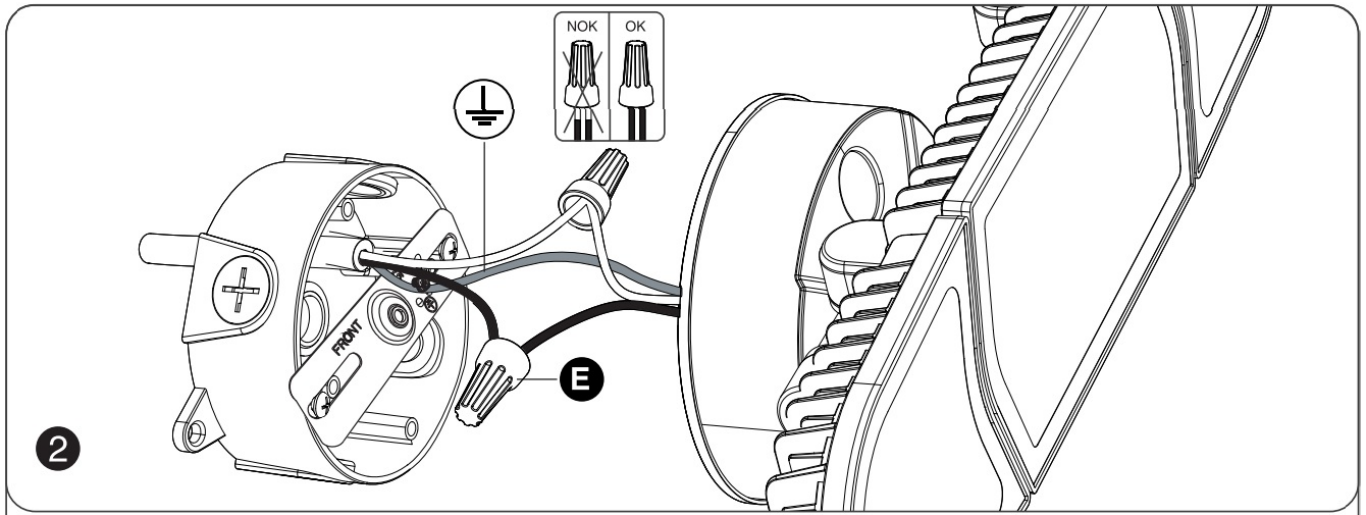

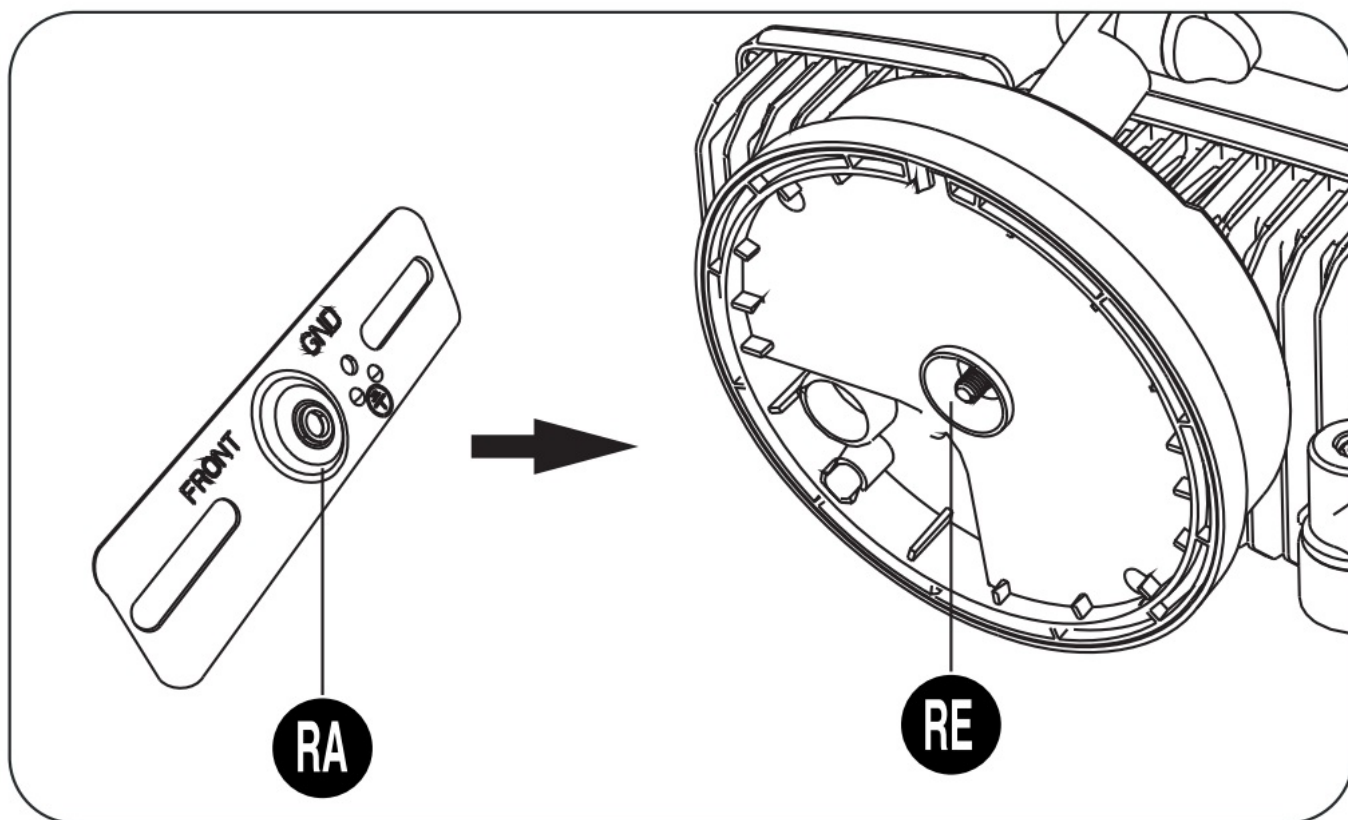

**Note:** The raised part (RA) of the metal plate must be engaged with the recessed part (RE) of the base; otherwise, it cannot be installed.

## TROUBLESHOOTING

Malfunction	Cause	Remedy
LED senses a movement, the light does not light up	<ol style="list-style-type: none"> <li>1. The light is not energized</li> <li>2. Other surrounding light sources make the light misjudge it as daytime</li> <li>3. During the day, the brightness is in night mode</li> <li>4. Internal wiring is loose</li> </ol>	<ol style="list-style-type: none"> <li>1. Check power-on status</li> <li>2. Turn off the nearby lights or sensor head to other directions</li> <li>3. Reset</li> <li>4. Rewiring after power failure</li> </ol>
LED sensor light did not go out, continued to light up	Continuous movement within the sensing range	Check the relevant area and retune or override the sensor head if necessary
LED sensor light illuminates during the day	The shadows around the sensor make it mistakenly think it's night	<ol style="list-style-type: none"> <li>1. Do not cover the sensor head</li> <li>2. Place the light in a place where the light is bright enough during the day</li> </ol>
LED sensor light flashing	Surrounded by other unstable light sources shining onto the induction	Avoid being exposed to such light sources
LED lights turn on unexpectedly	<ol style="list-style-type: none"> <li>1. Wind blows the branches and bushes within the sensing range</li> <li>2. Sensing cars on the road</li> <li>3. Sudden temperature change due to climate factors or fans, exhaust from open windows</li> </ol>	<ol style="list-style-type: none"> <li>1. Adjust its scope</li> <li>2. Adjust its scope</li> <li>3. Change irradiation area</li> </ol>

## FCC Warning

Any Changes or modifications not expressly approved by the party responsible for compliance could void the user's authority to operate the equipment. This device complies with part 15 of the FCC Rules. Operation is subject to the following two conditions:

1. This device may not cause harmful interference, and
2. This device must accept any interference received, including interference that may cause undesired operation.

**Note:** This equipment has been tested and found to comply with the limits for a Class B digital device, pursuant to part 15 of the FCC Rules. These limits are designed to provide reasonable protection against harmful interference in a residential installation. This equipment generates uses and can radiate radio frequency energy and, if not installed and used according to the instructions, may cause harmful interference to radio

communications. However, there is no guarantee that interference will not occur in a particular installation. If this equipment does cause harmful interference to radio or television reception, which can be determined by turning the equipment off and on, the user is encouraged to try to correct the interference by one or more of the following measures:

- Reorient or relocate the receiving antenna.
- Increase the separation between the equipment and receiver.
- Connect the equipment to an outlet on a circuit different from that to which the receiver is connected.
- Consult the dealer or an experienced radio/TV technician for help.

This equipment complies with FCC radiation exposure limits set forth for an uncontrolled environment. This equipment should be installed and operated with a minimum distance of 20cm between the radiator & your body.

**Manufacturer/Hersteller:** Zhuo Yue Lighting International Co., Limited

**Address/Adresse:** Unit C 9/F Winning House, No.73 Wing Lok Street, Sheung Wan, Hong Kong, HK

**Email:** [zhuoyuehk2@outlook.com](mailto:zhuoyuehk2@outlook.com)

**UK Importer:** MDH LIGHTING LTD

**Address:** 69 Aberdeen Avenue, Cambridge CB2 8DL, United Kingdom

## Documents / Resources

	<p><a href="#">meloght MESLD130DWG PIR LED Wall Lights with Motion Sensor [pdf]</a> In struction Manual</p> <p>2BBGOMESLD130DWG, MESLD130DWG PIR LED Wall Lights with Moti on Sensor, MESLD130DWG, PIR LED Wall Lights with Motion Sensor, LE D Wall Lights with Motion Sensor, Wall Lights with Motion Sensor, Lights with Motion Sensor, Motion Sensor, Sensor, Lights</p>
---	--

## References

- [User Manual](#)

📁 meloght

💎 2BBGOMESLD130DWG, LED Wall Lights With Motion Sensor, Lights, Lights with Motion Sensor, meloght, MESLD130DWG, MESLD130DWG PIR LED Wall Lights with Motion Sensor, Motion Sensor, Pir LED Wall Lights with Motion Sensor, Sensor, Wall Lights with Motion Sensor

---

## Leave a comment

Your email address will not be published. Required fields are marked \*

Comment \*

Name

Email

Website

☐ Save my name, email, and website in this browser for the next time I comment.

**Post Comment**

**Search:**

e.g. whirlpool wrf535swhz

**Search**

[Manuals+](#) | [Upload](#) | [Deep Search](#) | [Privacy Policy](#) | [@manuals.plus](#) | [YouTube](#)

This website is an independent publication and is neither affiliated with nor endorsed by any of the trademark owners. The "Bluetooth®" word mark and logos are registered trademarks owned by Bluetooth SIG, Inc. The "Wi-Fi®" word mark and logos are registered trademarks owned by the Wi-Fi Alliance. Any use of these marks on this website does not imply any affiliation with or endorsement.