



Melitta Look Therm Timer Instruction Manual

[Home](#) » [Melitta](#) » Melitta Look Therm Timer Instruction Manual 

Contents

- [1 Melitta Look Therm Timer](#)
- [2 Operating Instructions](#)
- [3 Safety notice](#)
- [4 Before first use](#)
- [5 Set water hardness](#)
- [6 Making coffee](#)
- [7 Using the insulated pot](#)
- [8 Timer Feature](#)
- [9 Cleaning and maintenance](#)
- [10 Notes on disposal](#)
- [11 Documents / Resources](#)
 - [11.1 References](#)
- [12 Related Posts](#)



Melitta Look Therm Timer



Operating Instructions



- START button

- CALC button
- TIMER button
- h (hours)/ m (minutes) button
- display
- water tank lid
- water level display
- handle to open the swivel filter
- drip stop

Dear customer,

Thank you for buying our Look Therm Filter coffee maker. We hope you will be very happy with it. If you need further information or if you have any questions please contact Melitta® or visit us on the Internet at www.international.melitta.de

For your safety

The appliance complies with all valid European guidelines. The appliance has been tested and certified by an independent test institute. Please read the safety notes and the operating manual in full. To avoid danger you must pay attention to the safety and operating instructions. Melitta® is not liable for damage caused by ignoring these instructions.

Safety notice

This appliance is intended for use in households and similar areas, such as.

- in kitchens for employees in shops, offices and other commercial areas
- in agricultural companies
- in motels, hotels and other residential facilities and bed and breakfast establishments Any other use is considered to be improper use and may result in personal injury or damage to property. Melitta® is not liable for damage caused by improper use.

Please observe the following instructions to avoid injuries in case of misuse:

- The appliance must not be placed in a cupboard during operation.
- Connect the appliance only to a properly installed earthed socket.
- The appliance must always be disconnected from the power supply when unsupervised and before assembly, disassembly or cleaning.
- During operation, parts of the appliance such as the steam out-let at the filter become very hot. Avoid touching these parts and avoid contact with hot steam.
- Do not open the filter holder during brewing.
- Do not use the appliance if the power cable is damaged.
- Do not allow the power cable to come into contact with liquids.
- Never immerse the appliance in water.
- Do not clean the parts that come into contact with food with aggressive cleaning agents or scouring cream. Remove detergent residues with clean water. Further information on cleaning can be found under "Cleaning and care".
- This appliance can be used by children from 8 years of age or older if they are supervised or have been instructed in the safe use of the equipment and have understood the potential hazards. Cleaning and

maintenance must not be carried out by children unless they are 8 years or older and are supervised. Keep the appliance and the power cable away from children under 8 years of age.

- The appliance may be used by persons with reduced physical, sensory or mental abilities or lack of experience and/or knowledge if they are supervised or have been instructed in the safe use of the appliance and have understood the potential hazards.
- Children must not play with the appliance
- Replacement of the power cable and all other repairs may only be carried out by Melitta® Customer Service or by an authorized repair shop.

Insulated jug

- Do not use the jug in the microwave.
- Do not place the jug on a hot stove.
- Do not use the jug to store dairy products or baby food, as there is a risk of bacterial growth.
- Do not lay the filled jug on its side, as the liquid may escape.
- Clean the outer casing with a soft, damp cloth.

ONLY for plastic jugs with glass insert

- To prevent damage to the glass flask, do not use hard or sharp-edged objects (e. g. cutlery, dishwashing brushes or similar) for stirring or cleaning, and do not fill with ice cubes or carbonated liquids.
- Do not subject the glass flask to high-temperature fluctuations.

Before first use

- Ensure that the power supply in your home corresponds to that on the model plate on the base of the appliance.
- Connect the appliance to a power source. Unused cable can be stored in the base of the appliance. 1

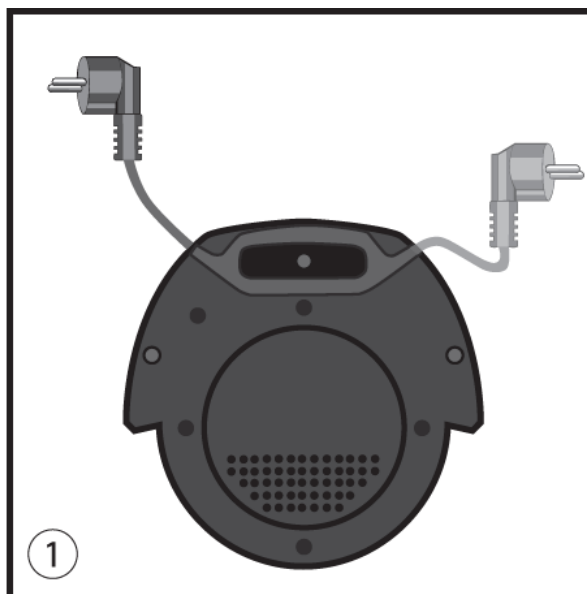

- Set the current time using the buttons “h” and “m” 2



. This goes faster if you hold down the button. The appliance is only ready to use once the time has been set. You can turn the display light on or off by simultaneously pressing the h and m buttons 3

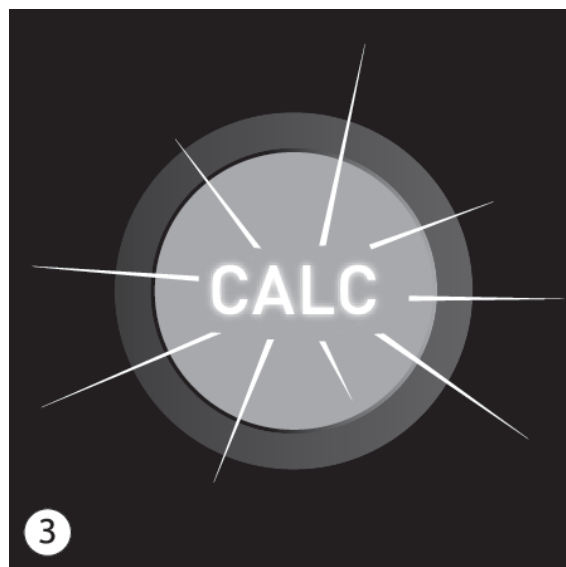

for longer than two seconds

- All appliances have been tested during production to ensure they work perfectly. Therefore there may be for example water deposits remaining. Rinse the appliance twice with the maximum amount of water and without a filter bag or ground coffee, in order to clean it.
- For the best coffee enjoyment and convenient use, the appliance is equipped with various features. These features are explained below.

Set water hardness

Depending on water hardness limescale may build up in the appliance. This increases the appliance energy consumption as the lime scale on the heating element can prevent the water from heating effectively. To avoid damage the appliance must be descaled regularly. The descaling display helps you with this. If the CALC button is permanently lit this shows that the appliance needs to be descaled. The appliance is pre-set for a high level of water hardness (level 4). You can out the level of water hardness in your area by asking your local water provider or by using water hardness measuring strips available in the shops. For softer water, the descaling display can be adjusted to descale less often.

- Hold down the CALC-button 2 and by briefly pressing the m-button 3 set the desired level of water hardness. The hardness setting will then show in the display
- Once you have set the desired level of water hardness, let go of the CALC-button. Your settings are now

saved.

- The settings and display are shown in the table.

Hardness setting	I	II	III	IV
°dH	<7° dH	7-14° dH	14-21° dH	>21° dH
Display ②	1	2	3	4

Please note:

- Water hardness cannot be programmed while brewing.
- The last water hardness level chosen remains even after removing the power cable.

Making coffee

- Ensure that the appliance is connected to the power source.
- Open the lid on the water tank. 5



- Fill the water tank with the desired amount of water using the therm jug. With the help of the water level display on the tank 6



you can choose the correct number of cups.

- Small cup symbol = approx. 85ml coffee per cup,
- large cup symbol = approx. 125 ml coffee per cup.
- Close the lid on the water tank and place the therm jug with closed lid in the appliance.
- Open the swivel filter 7



to the left.

- Fold a Melitta® filter bag 1×4® at the embossed seam and place it in the filter holder. 8

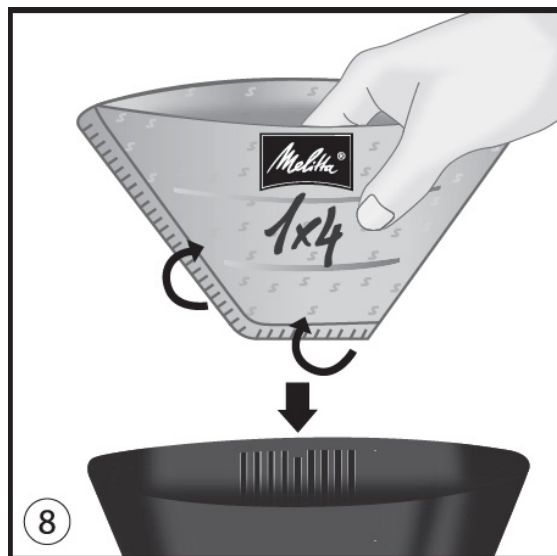

Press the filter bag into the filter holder by hand, to ensure a good fit.

- Put the ground coffee into the filter. The amount depends on your personal taste. We recommend using 6g of ground coffee per large cup.
- Swivel the filter back into the appliance. An audible click tells you it is inserted properly.
- With the Melitta® AromaSelector® 9



you can set the taste of your coffee with just one hand: From mild-aromatic to strong intensive.

- Turn the appliance on 4. Brewing begins.
- The appliance switches off automatically at the latest 15 minutes after being switched on. This avoids unnecessary use of electricity and saves energy. You can of course turn the machine off manually at any time.
- The drip stop prevents your coffee from dripping when you remove the pot from the appliance. 10



- With the help of the detachable inner filter you can dispose of the filter bag simply and easily.

Using the insulated pot

- The brewed coffee flows through the central valve in the insulated lid of the pot.
- To pour coffee press down on the sealing lever 13.

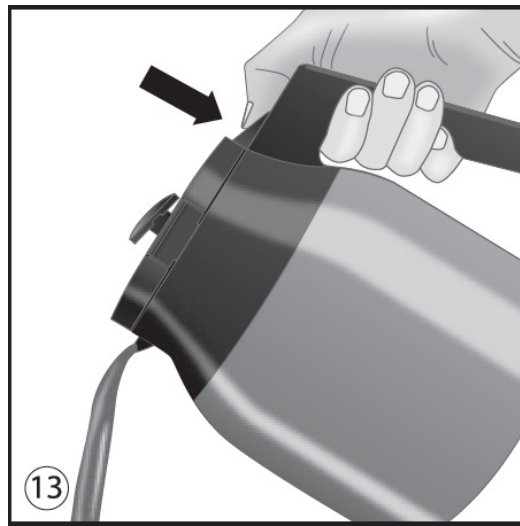

- Remove the lid simply by pressing the seals on the side while lifting the lid up 14.

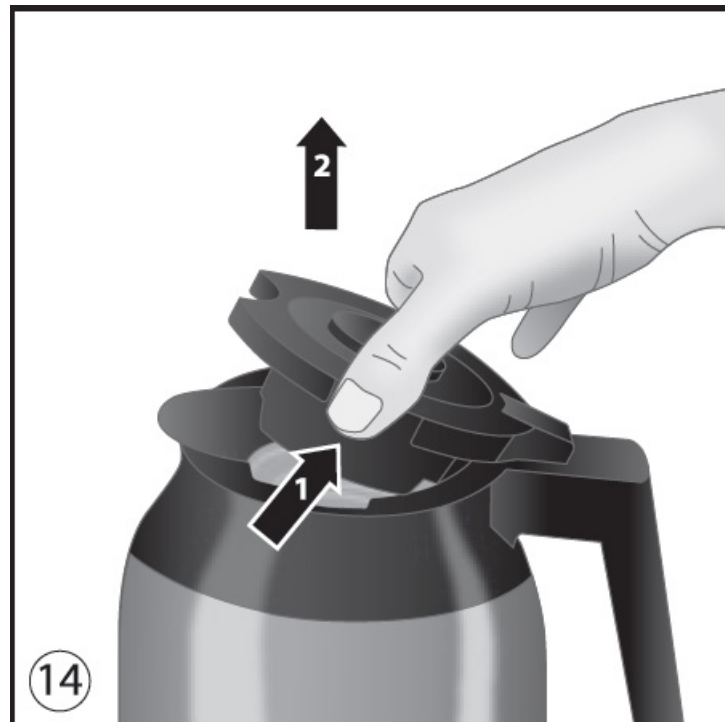

Timer Feature

The appliance is equipped with a TIMER feature. This starts the brewing process at the time you program.

- Prepare the appliance as described in point 5 'making coffee but without pressing the START button.
- To set the desired start time, hold down the TIMER button. The time you program it the display will show 00:00.
- Set the desired start time by repeatedly pressing the h and m buttons. This goes faster if you hold down the button.
- After letting go of the TIMER button the current time will show. The chosen start time is saved until you set a different time or remove the appliance from the power source.
- By briefly pressing the TIMER button 11 the timer feature is activated for the next brewing process. To show this the TIMER button 11 is illuminated and the programmed start time shows briefly in the display 2.
- The appliance automatically starts to make coffee at the time you have set.
- As long as you do not remove the plug from the socket or set a new start time, the previous start time is saved.
- By briefly pressing the TIMER button 11 you can deactivate the timer feature at any time. The light in the TIMER button 11 goes off.

- If you want to make coffee before the start time you have programmed, press the START button 4. The TIMER feature will be deactivated.

Cleaning and maintenance

External cleaning

- The housing can be cleaned with a soft damp cloth.
- The jug lid, the filter insert and the swivel filter 12 can be washed in the dishwasher.

Descaling

Based on the water hardness level you have set (see point 3) the descaling program should be run promptly after the CALC button 3 lights up.

- Follow the manufacturer's instructions regarding amounts and pour the descaler into the water tank. We recommend using Melitta® Anti Calc Filter Café Machines.
- Briefly press the CALC button 3, it will start to flash.
- The descaling process will now run automatically. To remove even stubborn limescale the descaling process takes 25 minutes. The remaining time is shown in the display.
- Attention: Only by carrying out the descaling process completely will all limescale deposits be removed and the light on the CALC button will go off. The descaling process should therefore not be interrupted before it has run for the full 25 minutes.
- When the descaling process is completed the light on the CALC button will go off. The appliance will turn off automatically.
- At the end of the descaling process, the appliance should be rinsed twice through, using the maximum amount of water without coffee. This will remove any remaining limescale deposits.

Notes on disposal



- Appliances labeled with this symbol are subject to European guidelines for WEEE (Waste Electrical and Electronic Equipment).
- Electric appliances do not go in the household bin. Dispose of the appliance in an environmentally friendly way using suitable collection systems.
- Packaging materials are raw materials and can be recycled. Please recycle them.

Documents / Resources

	Melitta Look Therm Timer [pdf] Instruction Manual Look Therm Timer, Look Therm, Therm Timer, Timer
---	---

References

-  [Melitta® Online Shop](#) | [Melitta® Online Shop](#)
-  [Melitta® Online Shop](#)

-  [Melitta® Boutique en ligne](#)
-  [Melitta® Online Shop](#)
-  [Melitta® Online Shop](#)

Manuals+.