



# Melitta LOOK Therm Timer Filter Coffee Machine Instruction Manual

[Home](#) » [Melitta](#) » Melitta LOOK Therm Timer Filter Coffee Machine Instruction Manual 

## Contents

- [1 Melitta LOOK Therm Timer Filter Coffee Machine](#)
- [2 Safety notice](#)
- [3 Before preparing first cup of coffee](#)
- [4 Coffee Preparation](#)
- [5 Cleaning and maintenance](#)
- [6 Therm jugs generally](#)
- [7 Notes on disposal](#)
- [8 Terms of Guarantee](#)
- [9 Melitta UK Ltd.](#)
- [10 Documents / Resources](#)
  - [10.1 References](#)
- [11 Related Posts](#)



**Melitta LOOK Therm Timer Filter Coffee Machine**



## Dear customer

Thank you for buying our Look® Therm filter coffee maker. We hope you will be very happy with it. If you need further information or if you have any questions please contact Melitta® or visit us on the Internet at [www.melitta.co.uk](http://www.melitta.co.uk)

## For your safety

- The appliance complies with all valid European guidelines.
- The appliance complies with all valid United Kingdom guidelines.

The appliance has been tested and certified by an independent test institute. Please read the safety notes and the operating manual in full. To avoid danger you must pay attention to the safety and operating instructions. Melitta® is not liable for damage caused by ignoring these instructions.

## Safety notice

This appliance is intended for use in households and similar areas, such as

- in kitchens for employees in shops, offices and other commercial areas
- in agricultural companies
- in motels, hotels and other residential facilities and bed and breakfast establishments. Any other use is considered to be improper use and may result in personal injury or damage to property. Melitta® is not liable

for damage caused by improper use.

### **Please observe the following instructions to avoid injuries in case of misuse**

- The appliance must not be placed in a cupboard during operation.
- Connect the appliance only to a properly installed earthed socket.
- The appliance must always be disconnected from the power supply when unsupervised and before assembly, disassembly or cleaning.
- During operation, parts of the appliance such as the steam outlet at the filter become very hot. Avoid touching these parts and avoid contact with hot steam.
- Do not open the filter holder during brewing.
- Do not use the appliance if the power cable is damaged.
- Do not allow the power cable to come into contact with liquids.
- Never immerse the appliance in water.
- Do not clean the parts that come into contact with food with aggressive cleaning agents or scouring cream. Remove detergent residues with clean water. Further information on cleaning can be found under "Cleaning and care".
- This appliance can be used by children from 8 years of age or older if they are supervised or have been instructed in the safe use of the equipment and have understood the potential hazards. Cleaning and maintenance must not be carried out by children, unless they are 8 years or older and are supervised. Keep the appliance and the power cable away from children under 8 years of age.
- The appliance may be used by persons with reduced physical, sensory or mental abilities or lack of experience and/or knowledge if they are supervised or have been instructed in the safe use of the appliance and have understood the potential hazards.
- Children must not play with the appliance
- Replacement of the power cable and all other repairs may only be carried out by Melitta® Customer Service or by an authorised repair shop.

### **Before preparing first cup of coffee**

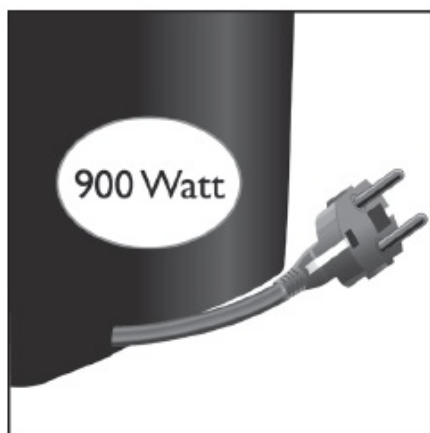

①

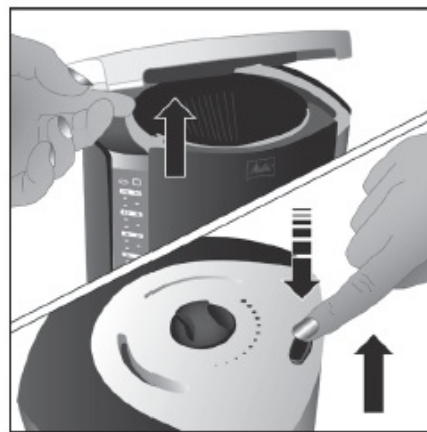

②



③



④



⑤

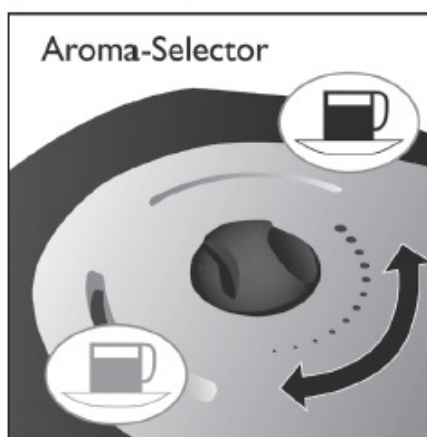

⑥

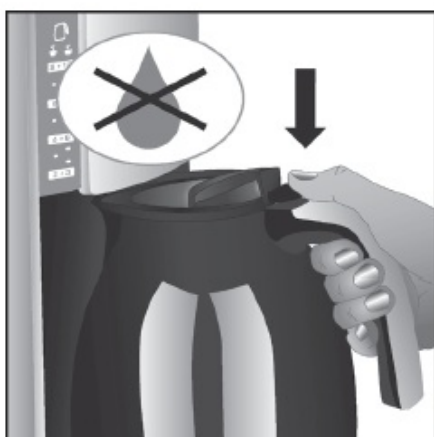

⑦



⑧

- Read operating and safety instructions carefully!
- Check the voltage in your home (has to correspond with the information at the bottom of the coffeemaker).
- Insert plug – cord can be lengthened or shortened by using cable storage a.

- Clean inner parts of the coffeemaker by two complete brewing processes only with clear water (see “Coffee Preparation” Point 1 – 8, but without using filter bag and coffee).

## Coffee Preparation

1. Open the filterlid 2.
2. Fill in needed amount of fresh, cold water into the water tank 3. By means of cup scale on the water tank 4 you can define the desired amount of cups (small cup symbol = 90 ml ready coffee per cup, big cup symbol = 125 ml ready coffee per cup).
3. Fold a Melitta® filterbag size 1×4® and place it in the filter 5.
4. Fill needed amount of ground coffee (recommendation: 1 measuring spoon = 6-8 g per cup) into the filter.
5. Close the filterlid.
6. Only LOOK De Luxe/Selection: by using the Aroma-Selector you can choose the coffee result – from mild to strong – to your personal taste 6.
7. Place the therm jug with the lid into the appliance. Drip-stop 7 is opened. Jug lid is needed to activate the drip stop. Using the jug without the lid the drip stop did not work, this may result in overflows.
8. Switch on the appliance – on/off switch lights up 8. The brewing process starts.
9. LOOK is equipped with an auto-shut-off function appliance shuts off after 15 min. automatically.
10. For pouring out coffee press lever on the jug lid. Switch appliance off between two brewing cycles and leave it to cool down for approx. 5 minutes.

## Cleaning and maintenance

- Before cleaning always remove plug from socket.
- Never immerse appliance or cord in water.
- Use a soft damp cloth to clean the exterior.
- Filter insert is dishwasher proof.
- **Descaling:** Regularly descaling ensures perfect operation we recommend to descale the appliance after every 40 filtrations. Prepare and use descaler as advised on the package by the descaler manufacturer.

## Therm jugs generally

- Never immerse jug in water or clean it in dishwasher! Rinse with hot water only after each use.
- Clean tenacious staining with special cleaner.
- Use a soft damp cloth to clean the exterior.
- Not lay down the filled jug, liquid may come out.
- Do not place the jug on a hotplate.
- Do not use the jug in microwave-oven.
- Do not use jug for storage of milk products or baby food, bacteria may develop.

## Therm jug with glass flask inside

- Avoid extreme variations in temperature.
- Never stir jug content with metal spoon, do not fill in ice-cubes or carbonated drinks to avoid damages of glass

insert.

- After fall down or heavier shocks glass insert may break. Do not drink the content because glass splitters may be inside.

## Notes on disposal

- Appliances labelled with this symbol are subject to European guidelines for WEEE (Waste Electrical and Electronic Equipment).
- Electric appliances do not go in the household bin. Dispose of the appliance in an environmentally friendly way using suitable collection systems.
- Packaging materials are raw materials and can be recycled. Please recycle them.

## Terms of Guarantee

In addition to the legal guarantee claims, to which the end user is entitled relative to the seller, for this device, if it was purchased from a dealer authorized by Melitta® due to his consulting competence, we grant a manufacturer's guarantee under the following conditions:

1. The guarantee period begins with the day the product was sold to the end user. The guarantee is 24 months. The purchase date of the device must be verified by a purchase receipt. The device was designed and built for household use only. It is not dedicated for a commercial use. Guarantee performances lead neither to an extension of the guarantee period nor to a new beginning of the guarantee period for the device or installed spare parts.
2. Within the guarantee period we will correct all device defects that are based on material or manufacturing errors, through repair or replacement of the device at our discretion. Replace parts become the property of Melitta®.
3. Defects that occurred due to improper connection, improper handling, or repair attempts by nonauthorized persons are not covered by the guarantee. The same applies for failure to comply with the use, care, and maintenance instructions as well for the use of consumables (e.g. cleaning and decalcifying agents or water filters) that do not correspond to the original specifications. Wear parts (e.g. seals and valves) and fragile parts like glass are excluded from the guarantee.
4. Guarantee performances are processed via the Service Hotlines for the respective country (see information below).
5. These guarantee conditions apply for devices purchased and used in UK. If devices are purchased in foreign countries or brought into foreign countries, then guarantee performances will only be provided as specified in the guarantee conditions applicable for this country.

## Melitta UK Ltd.







- Hortonwood 45 Telford, Shropshire, TF1 7FA United Kingdom
- **Tel:** +44(0)800 0288002
- [www.melitta.co.uk](http://www.melitta.co.uk)



## Documents / Resources

	<p><a href="#">Melitta LOOK Therm Timer Filter Coffee Machine</a> [pdf] Instruction Manual LOOK Therm Timer Filter Coffee Machine, LOOK Therm, Timer Filter Coffee Machine, Filter Coffee Machine, Coffee Machine, Machine</p>
---	--

## References

-  [Melitta® Online Shop | Melitta® Online Shop](#)
-  [Melitta® Online Shop](#)
-  [Passionate About Coffee | Melitta®](#)
-  [Melitta® Online Shop | Melitta® Online Shop](#)
-  [Melitta® Online Shop](#)
-  [Melitta® Boutique en ligne](#)
-  [Melitta® Online Shop](#)
-  [Melitta® Online Shop](#)