



Melitta filter coffee maker machine Instruction Manual

[Home](#) » [Melitta](#) » Melitta filter coffee maker machine Instruction Manual 

Melitta filter coffee maker machine Instruction Manual



Dear customer,

Thank you for buying our Easy Timer filter coffee maker. We hope you will be very happy with it. If you need further information or if you have any questions please contact Melitta® or visit us on the Internet at www.international.melitta.de

For your safety

The appliance complies with all valid European guidelines.



The appliance has been tested and certified by an independent test institute:



Please read the safety notes and the operating manual in full. To avoid danger you must pay attention to the safety and operating instructions. Melitta® is not liable for damage caused by ignoring these instructions.

Contents

- [1 Safety notice](#)
- [2 Before first use](#)
- [3 Setting the hotplate](#)
- [4 Making coffee](#)
- [5 Timer Feature](#)
- [6 Cleaning and maintenance](#)
- [7 Notes on disposal](#)
- [8 Terms of guarantee](#)
- [9 Contact Us](#)
- [10 Documents / Resources](#)
 - [10.1 References](#)
- [11 Related Posts](#)

Safety notice

- The appliance is suitable for use in private households or for preparing coffee in amounts usual in private households. All other use is contrary to that intended and can lead to injury or damage. Melitta® is not liable for damage caused by using the appliance in ways other than that intended.
- The appliance must not be kept in a cupboard when in use.
- Connect the appliance only to a correctly installed socket.
- Disconnect the device from mains power when it is being cleaned or is not being used for longer periods.
- The hotplate becomes very hot during use and remains hot for a considerable time even after brewing is finished. Contact with the hotplate can lead to burns, do not touch the hotplate.
- During brewing very hot steam is released from the filter. Do not touch this part and avoid contact with the hot steam.
- Do not open the filter while brewing.
- Ensure that the power cable does not come into contact with the hotplate.
- Do not use the appliance if the power cable is damaged.
- Never immerse the appliance in water.
- Do not let the power cable come into contact with water.
- Do not use the glass pot in the microwave.
- Do not clean parts which come into contact with water or coffee (e.g. water tank, filter, coffee pot) with abrasive cleaning materials or scouring cream. Remove detergent residues with clean water.

- This appliance can be used by children who are 8 years old or over, if they are supervised or have been instructed in the safe use of the appliance and have understood the dangers associated with it. Cleaning and maintenance of the appliance should not be undertaken by children unless they are 8 years old or over and are supervised. The appliance and power cable should be kept away from children under 8 years old.
- The appliance can be used by people with limited physical, sensory or mental aptitude, or who have limited experience or knowledge, if they are supervised or instructed in how to use the appliance safely and have understood the dangers involved in using it.
- Children must not play with the appliance.
- Replacement of the power cable and all other repairs should only be carried out by Melitta Customer Service personnel.

Before first use

- Ensure that the power supply in your home corresponds to that on the model plate on the base of the appliance.
- Connect the appliance to a power source. Unused cable can be stored in the base of the appliance. **1**
- Set the current time using the buttons “h” and “m” **2**. This goes faster if you hold down the button. **The appliance is only ready to use once the time has been set.** You can turn the display light on or off by simultaneously pressing the h and m buttons **2** for longer than two seconds
- All appliances have been tested during production to ensure they work perfectly. Therefore there may be for example water deposits remaining. Rinse the appliance twice with the maximum amount of water and without a filter bag or ground coffee, in order to clean it.
- For the best coffee enjoyment and convenient use, the appliance is equipped with various features. These features are explained below.

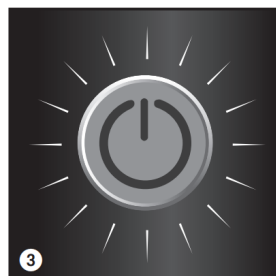
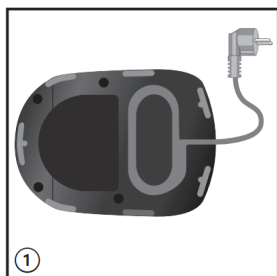

Setting the hotplate

Keeping coffee warm on the hotplate affects the taste of your coffee. To avoid this you should enjoy your coffee fresh, by drinking it as soon after brewing as possible. Unnecessary warming also uses valuable energy. The factory settings for the appliance are for 40 minutes of warming. After this the hotplate turns off automatically. This time can be changed as needed:

- Hold down the START-button **3** and by briefly pressing the h-button **2** set the desired time (20, 40 or 60 minutes). The current warming time will be shown in the display **2**.
- Once you have set the desired warming time let go of the button. Your setting is now saved.
- The last setting chosen remains even after removing the power cable.

Making coffee

- Ensure that the appliance is connected to the power source.
- Open the lid on the water tank. **4**
- Fill the water tank with the desired amount of water using the glass pot. With the help of the water level display on the tank **5** you can choose the correct number of cups.
Small cup symbol = approx. 85 ml coffee per cup,
large cup symbol = approx. 125 ml coffee per cup.
- Close the lid on the water tank and place the glass pot with closed lid in the appliance.
- Open the swivel filter **6** to the left.
- Fold a Melitta® filter bag 1×4® at the embossed seam and place it in the filter holder. **7** Press the filter bag into the filter holder by hand, to ensure a good fit.
- Put the ground coffee into the filter. The amount depends on your personal taste. We recommend using 6g of ground coffee per large cup.
- Swivel the filter back into the appliance.
- Turn the appliance on **3**. Brewing begins.
- After making your coffee the hotplate will keep it warm and will turn off automatically after the time you have set (see point 3). This avoids unnecessary use of electricity and saves energy. You can of course turn the machine off manually at any time.
- The drip stop prevents your coffee from dripping when you remove the pot from the appliance. **8**

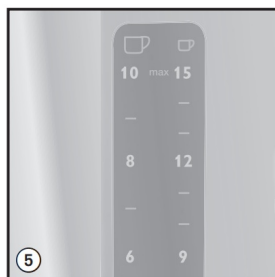
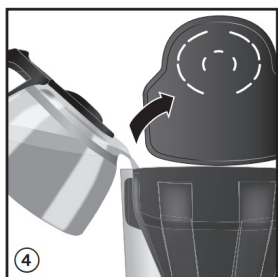

Timer Feature

The appliance is equipped with a TIMER feature. This starts the brewing process at a time you programme.

- Prepare the appliance as described in point 4 'making coffee', but without pressing the START button.
- To set the desired start time, hold down the TIMER button **9**. The first time you programme it the display will show 00:00. While setting the timer the word 'timer' appears in the display.
- Set the desired start time by repeatedly pressing the h and m buttons **2**. This goes faster if you hold down the button.
- After letting go of the TIMER button the current time will show. The chosen start time is saved until you set a different time or remove the appliance from the power source.
- By briefly pressing the TIMER button **9** the timer feature is activated for the next brewing process. To show this the TIMER button **9** is illuminated and the programmed start time shows briefly in the display **2**.
- The appliance automatically starts to make coffee at the time you have set.
- As long as you do not remove the plug from the socket or set a new start time, the previous start time is saved.
- By briefly pressing the TIMER button **9** you can deactivate the timer feature at any time. The light in the TIMER button **9** goes off.
- If you want to make coffee before the start time you have programmed, press the START button **3**. The TIMER

feature will be deactivated.

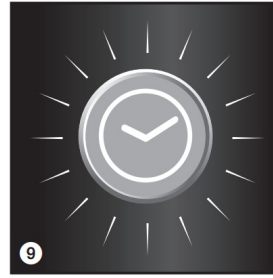
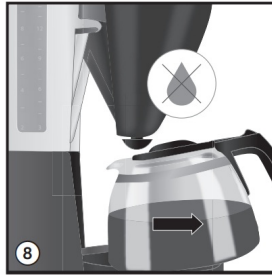

Cleaning and maintenance

External cleaning

- The housing can be cleaned with a soft damp cloth.
- The glass pot and lid and the swivel filter **10** can be washed in the dishwasher.
- When cold, the hotplate can be cleaned with a soft damp cloth.

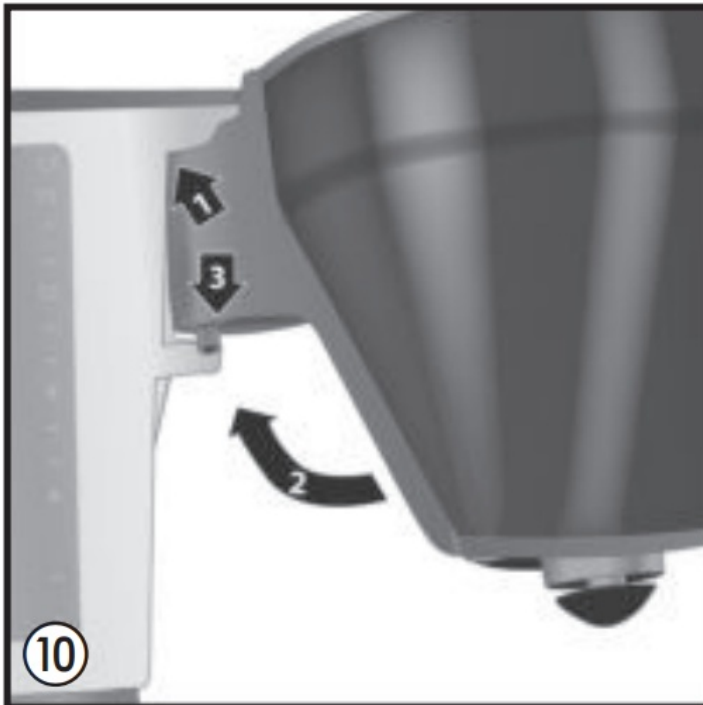

Descaling

Depending on water hardness the appliance can become calcified with use. This also increases the appliance's energy consumption as lime scale on the heating element can prevent the water heating effectively. To avoid damage the appliance must be descaled regularly.

The descaling process consists of 2 steps, both of which must be completed.

1. Descaling

- Follow the manufacturers instructions regarding amounts and pour the descaler into the water tank. We recommend using "Melitta® Anti Calc Filter Café Machines".
- Turn the appliance on and follow the descaler manufacturer's instructions.
- When the descaler liquid has fully run through the appliance then it should be turned off.

2. Rinsing

- After step 1 the appliance must be rinsed with fresh water. To do this allow the machine to cool for a short time (approx. two minutes) then fill the appliance with the maximum amount of water.
- Turn the appliance on and allow all the water to flow through it. Then turn the appliance off immediately.
- Repeat the rinsing process.

Notes on disposal

- Appliances labelled with this symbol  are subject to European guidelines for WEEE (Waste Electrical and Electronic Equipment).
- Electric appliances do not go in the household bin. Dispose of the appliance in an environmentally friendly way using suitable collection systems.
- Packaging materials are raw materials and can be recycled. Please recycle them.

Terms of guarantee

In addition to the legal guarantee claims, to which the end user is entitled relative to the seller, for this device, if it was purchased from a dealer authorized by Melitta® due to his consulting competence, we grant a manufacturer's guarantee under the following conditions:

1. The guarantee period begins with the day the product was sold to the end user. The guarantee is 24 months. The purchase date of the device must be verified by a purchase receipt. The device was designed and built for household use only. It is not dedicated for a commercial use. Guarantee performances lead neither to an extension of the guarantee period nor to a new beginning of the guarantee period for the device or installed spare parts.
2. Within the guarantee period we will correct all device defects that are based on material or manufacturing errors, through repair or replacement of the device at our discretion. Replace parts become the property of Melitta®.
3. Defects that occurred due to improper connection, improper handling, or repair attempts by nonauthorized persons are not covered by the guarantee. The same applies for failure to comply with the use, care, and maintenance instructions as well for the use of consumables (e.g. cleaning and decalcifying agents or water filters) that do not correspond to the original specifications. Wear parts (e.g. seals and valves) and fragile parts like glass are excluded from the guarantee.
4. Guarantee performances are processed via the Service Hotlines for the respective country (see information below).
5. These guarantee conditions apply for devices purchased and used in UK. If devices are purchased in foreign countries or brought into foreign countries, then guarantee performances will only be provided as specified in the guarantee conditions applicable for this country.

Contact Us

Melitta International GmbH – UK Division
32 A Thorpe Wood Business Park
Thorpe Wood
Peterborough PE3 6SR



Documents / Resources

 <p>Melitta Easy Timer filter coffee maker machine</p> <p>DE: Gebrauchsanweisung GB: Operating Instructions FR: Manuel d'instructions NL: Gebruiksaanwijzing IT: Manuale d'uso</p> <p>DE: Bedienungsanleitung GB: Operating Instructions FR: Manuel d'instructions NL: Gebruiksaanwijzing IT: Manuale d'uso</p>	<p>Melitta filter coffee maker machine [pdf] Instruction Manual filter coffee maker machine, coffee maker machine</p>
---	---

References

-  [Melitta® Online Shop | Melitta® Online Shop](#)
-  [Melitta® Online Shop](#)
-  [Melitta® Online Shop | Melitta® Online Shop](#)
-  [Melitta® Online Shop](#)
-  [Melitta® Boutique en ligne](#)
-  [Melitta® Online Shop](#)
-  [Melitta® Online Shop](#)