



Melitta 1100108-08 LOOK Selection Filter Coffee Machine Instruction Manual

[Home](#) » [Melitta](#) » Melitta 1100108-08 LOOK Selection Filter Coffee Machine Instruction Manual 

Contents

- [1 Melitta 1100108-08 LOOK Selection Filter Coffee Machine](#)
- [2 Operating Instructions](#)
- [3 ASSEMBLY](#)
- [4 Safety notice](#)
- [5 Cleaning and maintenance](#)
- [6 Documents / Resources](#)
 - [6.1 References](#)
- [7 Related Posts](#)



Melitta 1100108-08 LOOK Selection Filter Coffee Machine



Operating Instructions



- CALC button
- START button
- water level display
- handle to open the swing filter

- water tank lid
- AromaSelector®

ASSEMBLY

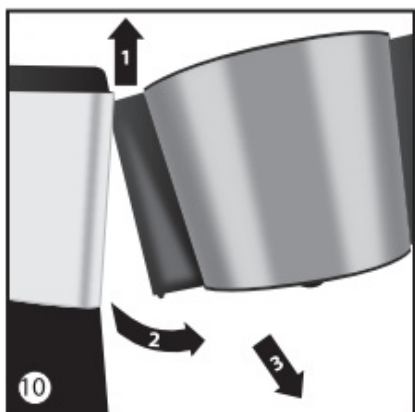
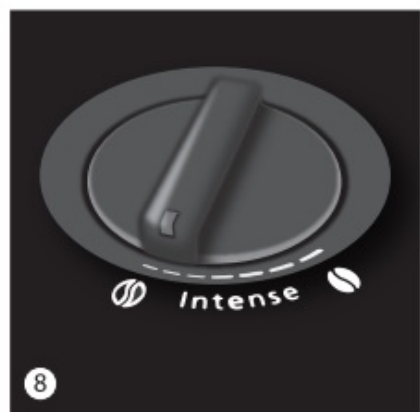
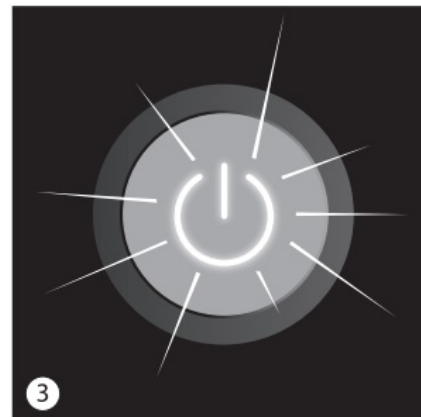
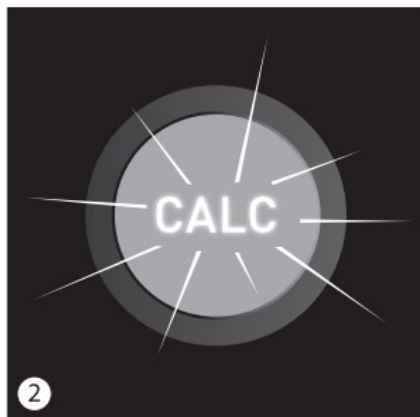
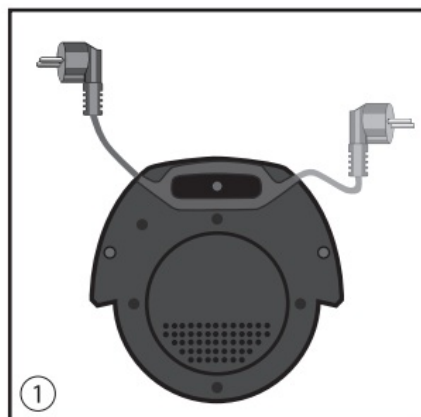

Safety notice

This appliance is intended for use in households and similar areas, such as

- in kitchens for employees in shops, offices and other commercial areas
- in agricultural establishments
- in motels, hotels and other residential facilities and bed and breakfast establishments

Any other use is considered to be improper use and may result in personal injury or damage to property. Melitta® is not liable for damage caused by improper use.

Please observe the following instructions to avoid injuries in case of misuse:

- The appliance must not be placed in a cupboard during operation.
- Connect the appliance only to a properly installed earthed socket.
- The appliance must always be disconnected from the power supply when unsupervised and before assembly, disassembly or cleaning.
- During operation, parts of the appliance such as the steam outlet at the filter become very hot. Avoid touching these parts and avoid contact with hot steam.
- Do not open the filter holder during brewing.
- The hotplate becomes very hot during use and remains hot for a long time after the brewing process. Contact with the hot plate can cause burns, so avoid touching it.
- Make sure that the power cable does not touch the hot plate.
- Do not use the appliance if the power cable is damaged.
- Do not allow the power cable to come into contact with liquids.
- Never immerse the appliance in water.
- Do not use the jug in the microwave.
- Do not clean the parts that come into contact with food with aggressive cleaning agents or scouring cream. Remove detergent residues with clean water. Further information on cleaning can be found under

„Cleaning and care“.

- This appliance can be used by children from 8 years of age or older if they are supervised or have been instructed in the safe use of the equipment and have understood the potential hazards. Cleaning and maintenance must not be carried out by children, unless they are 8 years or older and are supervised. Keep the appliance and the power cable away from children under 8 years of age.
- The appliance may be used by persons with reduced physical, sensory or mental abilities or lack of experience and/or knowledge if they are supervised or have been instructed in the safe use of the appliance and have understood the potential hazards.
- Children must not play with the appliance
- Replacement of the power cable and all other repairs may only be carried out by Melitta® Customer Service or by an authorized repair shop.

Before first use

- Ensure that the power supply in your home corresponds to that on the model plate on the base of the appliance.

- Connect the appliance to a power source. Unused cable can be stored in the base of the appliance a.
- All appliances have been tested during production for perfect functioning. Therefore there may be for example water deposits remaining. Rinse the appliance twice with the maximum amount of water and without a filter bag or ground coffee, in order to clean it.
- For the best coffee enjoyment and convenient use, the appliance is equipped with various features. These features are explained below.

Set water hardness

- Depending on water hardness lime scale may build up in the appliance. This increases the appliance’s energy consumption as lime scale on the heating element can prevent the water heating effectively. To avoid damage the appliance must be descaled regularly. The descaling display helps you in this. If the CALC-button b is permanently lit this shows that the appliance needs to be descaled.

The appliance is pre-set for a high level of water hardness (level 4). You can find out the level of water hardness in your area by asking your local water provider or by using water hardness measuring strips available in the shops. For softer water the descaling display can be adjusted to descale less often:

- Hold down the CALC button b for longer than 2 seconds. The CALC button starts to flash. In the factory settings the CALC button flashes briefly four

Hardness setting	1	2	3	4
°dH	<7° dH	7-14° dH	14-21° dH	>21° dH
Flash rhythm CALC button ②	...■.....■...	...■■.....■■...	...■■■.....■■■...	...■■■■.....■■■■...

Table 1

Warming time setting	20 minutes	40 minutes	60 minutes
Flash rhythm START button ③	...■.....■...	...■■.....■■...	...■■■.....■■■...

Hardness setting	1	2	3	4
°dH	<7° dH	7-14° dH	14-21° dH	>21° dH
Flash rhythm CALC button ②	...■.....■...	...■■.....■■...	...■■■.....■■■...	...■■■■.....■■■■...

Table 1

Warming time setting	20 minutes	40 minutes	60 minutes
Flash rhythm START button ③	...■.....■...	...■■.....■■...	...■■■.....■■■...

Table 2

times with the following pauses ... ■■■■ ■■■■

- You can set the water hardness at three further levels. Each time you briefly press the CALC button b the display changes to flashing one, two or three times, each time followed by a pause (... ■..., ... ■■..., ... ■■■...).
- The settings and display are shown in the following table 1.
- Once you have set the desired hardness level, again hold the CALC button b down for longer than two seconds. The light goes off and your settings are saved.

Please note:

- Water hardness cannot be programmed while brewing.
- The last water hardness level chosen remains even after removing the power cable.

Setting the hotplate

Keeping coffee warm on the hotplate affects the taste of your coffee. To avoid this you should enjoy your coffee fresh by drinking it as soon after brewing as possible. Unnecessary warming also uses valuable energy. The factory settings for the appliance are for 40 minutes of warming. After this the hotplate turns off automatically. This time can be changed as needed:

- Press the START button c longer than two seconds.
- In the factory settings the START button c flashes briefly twice with the following pause (... ■ ■ ...)
- There are two other settings for the warming time. By briefly pressing the START button c the display changes to flashing three times or once, each time followed by a pause (... ■■■..., ... ■..., ... ■...). • The settings and display are shown in table 2.
- Once you have set the desired warming time, confirm your settings by pressing the START button c for longer than two seconds. Your settings are now saved
- The last setting chosen remains even after removing the power cable.

Making coffee

- Ensure that the appliance is connected to the power source.
- Open the lid on the water tank d.
- Fill the water tank with the desired amount of water using the glass pot. With the help of the water level display on the tank e you can choose the correct number of cups. Small cup symbol = approx. 85ml coffee per cup, large cup symbol = approx. 125 ml coffee per cup.
- Close the lid on the water tank and place the glass pot with closed lid in the appliance.
- Open the swing filter f to the left.
- Fold a Melitta® filter bag 1×4® at the embossed seam and place it in the filter holder g. Press the filter bag into the filter holder by hand, to ensure a good fit.
- Put the ground coffee into the filter. The amount depends on your personal taste. We recommend using 6-8 g of ground coffee per large cup.
- Swing the filter back into the appliance. An audible click tells you it is inserted properly.
- With the Melitta® Aroma Selector h you can set the taste of your coffee with just one hand: From mild-aromatic



() to strong-intensive ().



- Turn the appliance on c. Brewing begins.
- After making your coffee the hotplate will keep it warm and will turn off automatically after the time you have set (see point 4). This avoids unnecessary use of electricity and saves energy. You can of course turn the machine off manually at any time.
- The drip stop prevents your coffee from dripping, when you remove the pot from the appliance i.
- With the help of the detachable inner filter you can dispose of the filter bag simply and easily.

Cleaning and maintenance

External cleaning

- The housing can be cleaned with a soft damp cloth.
- The glass pot and lid, the filter insert and the swing filter j can be washed in the dishwasher.
- When cold, the hotplate can be cleaned with a soft damp cloth.

Descaling

- The CALC button b lights up again if the appliance has been turned off without descaling. The CALC button will go off again only after the descaling programme has been completely finished.
- Based on the water hardness level you have set (see point 3) the descaling programme should be run promptly after the CALC button b lights up.
- Follow the manufacturers instructions regarding amounts and pour the descale into the water tank. We recommend using Melitta® „Anti Calf Liquid for Filter Coffee & Aqua Machines“.
- Briefly press the CALC button b, it will start to flash.
- The descaling process will now run automatically. To remove even stubborn limescale the descaling process takes 25 minutes.

Attention: Only by carrying out the descaling process completely will all limescale deposits be removed and the light on the CALC button will go off. The descaling process should therefore not be interrupted before it has run for the full 25 minutes.

- When the descaling process is completed the light on the CALC button will go off. The appliance will turn off automatically.
- At the end of the descaling process, the appliance should be rinsed twice through, using the maximum amount of water without coffee. This will remove any remaining limescale deposits.

Note on disposal



- Appliances labelled with this symbol are subject to European guidelines for WEEE (Waste Electrical and Electronic Equipment).
- Electric appliances do not go in the household bin. Dispose of the appliance in an environmentally friendly way using suitable collection systems.

- Packaging materials are raw materials and can be recycled. Please recycle them.

Documents / Resources

	Melitta 1100108-08 LOOK Selection Filter Coffee Machine [pdf] Instruction Manual 1100108-08 LOOK Selection Filter Coffee Machine, 1100108-08, LOOK Selection Filter Coffee Machine, Filter Coffee Machine, Coffee Machine, Machine
---	---

References

- [User Manual](#)