



Melitta 100801 Optima Timer Filter Coffee Machine Instruction Manual

[Home](#) » [Melitta](#) » Melitta 100801 Optima Timer Filter Coffee Machine Instruction Manual 

Contents

- [1 Melitta 100801 Optima Timer Filter Coffee Machine](#)
- [2 Safety notice](#)
- [3 Timer function](#)
- [4 Adjustable warm-keeping time](#)
- [5 Descaling program](#)
- [6 Cleaning and maintenance](#)
- [7 Hints for disposal](#)
- [8 Terms of Guarantee](#)
- [9 Documents / Resources](#)
 - [9.1 References](#)
- [10 Related Posts](#)



Melitta 100801 Optima Timer Filter Coffee Machine



Dear customer,

- Thank you for buying our Optima Timer filter coffee maker. We hope you will be very happy with it.
- If you need further information or if you have any questions please contact Melitta® or visit us on the Internet at www.melitta.co.uk
- For your safety
- The appliance complies with all valid European guidelines.
- The appliance complies with all valid United Kingdom guidelines.
- The appliance has been tested and certified by an independent test institute.
- Please read the safety notes and the operating manual in full. To avoid danger you must pay attention to the safety and operating instructions. Melitta® is not liable for damage caused by ignoring these instructions.

Safety notice

- This appliance is intended for use in households and similar areas, such as in kitchens for employees in shops, offices and other commercial areas
- in agricultural establishments
- in motels, hotels and other residential facilities and bed and breakfast establishments Any other use is

considered to be improper use and may result in personal injury or damage to property. Melitta® is not liable for damage caused by improper use.

- Please observe the following instructions to avoid injuries in case of misuse:
- The appliance must not be placed in a cupboard during operation.
- Connect the appliance only to a properly installed earthed socket.
- The appliance must always be disconnected from the power supply when unsupervised and before assembly, disassembly or cleaning.
- During operation, parts of the appliance such as the steam outlet at the filter become very hot. Avoid touching these parts and avoid contact with hot steam.
- Do not open the filter holder during brewing.
- The hotplate becomes very hot during use and remains hot for a long time after the brewing process. Contact with the hot plate can cause burns, so avoid touching it.
- Make sure that the power cable does not touch the hot plate.
- Do not use the appliance if the power cable is damaged.
- Do not allow the power cable to come into contact with liquids.
- Never immerse the appliance in water.
- Do not use the jug in the microwave
- Do not clean the parts that come into contact with food with aggressive cleaning agents or scouring cream. Remove detergent residues with clean water. Further information on cleaning can be found under "Cleaning and care".
- This appliance can be used by children from 8 years of age or older if they are supervised or have been instructed in the safe use of the equipment and have understood the potential hazards.
- Cleaning and maintenance must not be carried out by children, unless they are 8 years or older and are supervised. Keep the appliance and the power cable away from children under 8 years of age.
- The appliance may be used by persons with reduced physical, sensory or mental abilities or lack of experience and/or knowledge if they are supervised or have been instructed in the safe use of the appliance and have understood the potential hazards.
- Children must not play with the appliance
- Replacement of the power cable and all other repairs may only be carried out by Melitta® Customer Service or by an authorised repair shop.

Before preparing the first cup of coffee

- Connect appliance to socket. Cord can be lengthened or shortened by using the cable storage (1)

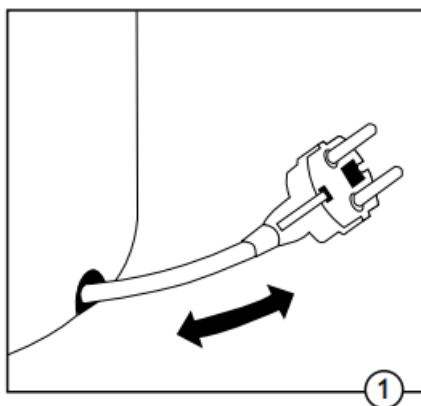

- The display (LCD) is illuminated and flashes.

- Set the time by using the buttons „H“ and „MIN“ (2). A quick run is possible by pressing the buttons constantly.

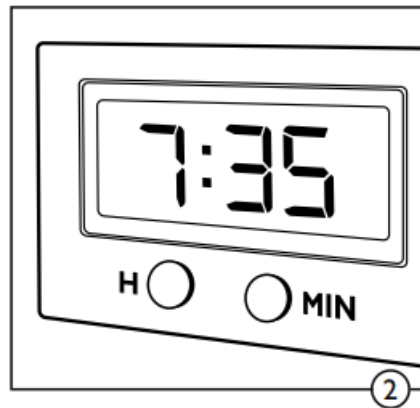

- To save energy, the LCD-light switches off 2 seconds after last use of one of the buttons. If you want to have a constant lighting of the display press the buttons “H” and “MIN” together for longer than 1 second. Switching off the light can be done the same way.
- For cleaning the appliance before first use, fill the watertank with clear, cold water. Press button “ON/OFF” (3) to start the cleaning process.
- Switch off the appliance with “ON/OFF” button after the end of the brewing process. Repeat this once.

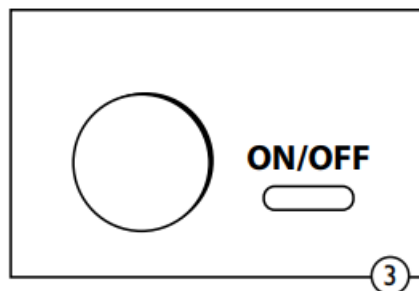

Adjusting the water hardness

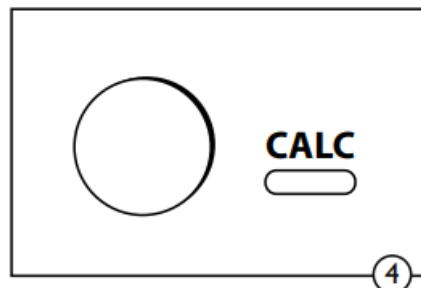

- To maintain value and function of the appliance it has an integrated descaling program.
- The appliance can be programmed with 4 degrees of water hardness. It is set to high water hardness in the factory.
- We recommend an individual adjustment based on your local degree of hardness. You can ask your local water supplier or use a special control strip for determining.
- To adjust degree of hardness press button „CALC“ (4) and keep it pressed. The display shows the factory-provided presetting. For adjustment press button „MIN“ as long as the display shows your desired degree of hardness. 2 seconds after releasing the “CALC” button, the display shows the time again.
- Your chosen water hardness is programmed. The last adjustment maintains even when the appliance will be disconnected from the socket.

Coffee preparation

- To maintain the best aroma of your coffee keep the coffee packaging always closed and store it in a refrigerator.
- We recommend to use 6g ground coffee per cup for best taste. To secure an optimal brewing result fold the filterbag 102® as described on the packaging.
- Fill the removable water tank (6) with fresh, cold water. The needed amount of water based on cups to prepare can be read off the cup scale on the water tank.

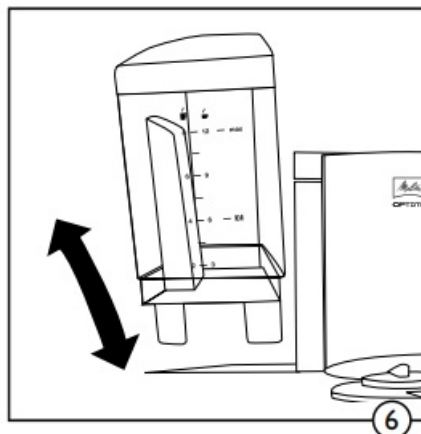

- Insert the water tank again.
- Swivel out the filter (7). Place a filterbag into the filtercone and fill in your desired quantity of ground coffee into the filterbag. Swivel filter back until it snaps in.

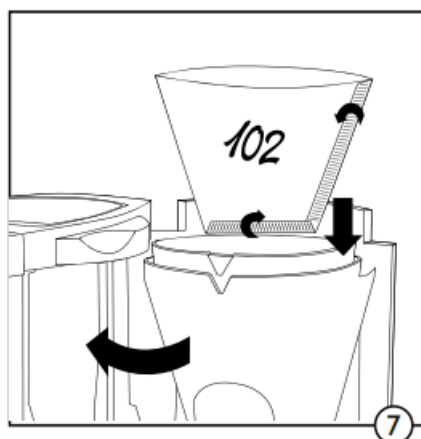

- Press „ON/OFF“ button (3). The green LED is illuminated and the brewing process starts.
- After end of brewing you can remove the jug from the appliance. The drip stop avoids dripping.
- Let the appliance cool down for 5 minutes between 2 brewing cycles.

Timer function

- The appliance is equipped with a timer function. With this function, the brewing process can be started automatically at a pre-programmed time.
- Set the desired starting time by using the buttons „H“ and „MIN“ (2). A quick run is possible by pressing the buttons constantly.
- After releasing the button „TIMER“, the current or when the appliance disconnected from socket.
- By pressing the “TIMER” button again shortly, the function is activated for the next brewing cycle. Blue
- LED light shows activation and the programmed starting time is visible in the display for a few seconds.
- The timer-function can be de-activated by a further press on the “TIMER” button. The blue LED light expires.
- The brewing process can be started independently from the timer-function by pressing the “ON/OFF” button.

Adjustable warm-keeping time

- Long-term warm-keeping of the coffee on the warming plate leads to loss of taste.
- Therefore we recommend a warm-keeping time of not longer than 30 minutes.
- This time is presented for securing optimal coffee quality and also to avoid unneeded energy consumption.
- If you want to keep your coffee warm for a longer time, you can set the time in 4 steps until the appliance switches off automatically.
- For setting the warm-keeping time keep the “ON/OFF” button pressed. 0:30 appears in the display.
- Set the needed warm-keeping time by pressing the “MIN” button in 30-minute steps (up to 2 hours max.)
- After releasing the “ON/OFF” button, the current time appears again after 2 seconds.
- The last setting maintains even when the appliance will be disconnected from a socket.

Descaling program

- To secure a proper function of the appliance, it has to be descaled regularly. We recommend using Swirl Oxy-Power or Swirl Citrus-Clean. To simplify this necessary process, the appliance is equipped with a descaling program.
- Once the number of brewing cycles, based on the individual adjustment of water hardness, is reached, the red LED (O) lights up permanently.
- This shows that descaling should be done short term.
- To start descaling, fill the water tank with a descaling agent according to the information on its packaging
- Press the “CALC” button (@). The red LED flashes.
- The descaling process takes 25 minutes. The remaining time is shown in the display.
- The red LED expires after the descaling process has finished. The appliance switches off automatically and the display shows the current time again.
- Clean the appliance after descaling by 2 brewing cycles with clear water without coffee to remove sealer residues.

Cleaning and maintenance

- Remove the cord from the socket before you clean the appliance.
- Never immerse the appliance or cord in water.
- Clean the surface with a soft, damp cloth.
- Clean the parts which are in contact with coffee after each use. Filter cone and glass jug are dishwasher safe.
- The water tank can be cleaned under running water
- Do not use harsh and abrasive brushes.

Hints for disposal

- Please inform yourself about disposal rules for electrical appliances at your dealer or community.
- Packaging materials are resources and therefore reusable. Please give it back to the renewable resource cycle.

Terms of Guarantee

In addition to the legal guarantee claims, to which the end user is entitled relative to the seller, for this device, if it was purchased from a dealer authorized by Melitta® due to his consulting competence, we grant a manufacturer's guarantee under the following conditions:

1. The guarantee period begins with the day the product was sold to the end user. The guarantee is 24 months. The purchase date of the device must be verified by a purchase receipt. The device was designed and built for household use only. It is not dedicated for a commercial use. Guarantee performances lead neither to an extension of the guarantee period nor to a new beginning of the guarantee period for the device or installed spare parts.
2. Within the guarantee period we will correct all device defects that are based on material or manufacturing errors, through repair or replacement of the device at our discretion. Replace parts become the property of Melitta®.
3. Defects that occurred due to improper connection, improper handling, or repair attempts by nonauthorized persons are not covered by the guarantee. The same applies for failure to comply with the use, care, and maintenance instructions as well for the use of consumables (e.g. cleaning and decalcifying agents or waterfilters) that do not correspond to the original specifications. Wear parts (e.g. seals and valves) and fragile parts like glass are excluded from the guarantee.
4. Guarantee performances are processed via the Service Hotlines for the respective country (see information below).
5. These guarantee conditions apply for devices purchased and used in UK. If devices are purchased in foreign countries or brought into foreign countries, then guarantee performances will only be provided as specified in the guarantee conditions applicable for this country.

- **Melitta UK Ltd.**
- **Hortonwood 45**
- **Telford, Shropshire, TF1 7FA**
- **United Kingdom**
- **Tel: +44(0)800 0288002**



- www.melitta.co.uk

Documents / Resources

 <p>100801 Optima Timer Filter Coffee Machine</p>	<p>Melitta 100801 Optima Timer Filter Coffee Machine [pdf] Instruction Manual</p> <p>100801 Optima Timer Filter Coffee Machine, 100801, Optima Timer Filter Coffee Machine, Timer Filter Coffee Machine, Filter Coffee Machine, Coffee Machine</p>
--	---

References

-  [Melitta® Online Shop | Melitta® Online Shop](#)
-  [Servis elektroniky, opravy elektrospotřebičů, elektro servis - BELS cz s.r.o.](#)
-  [Melitta® Online Shop](#)
-  [Passionate About Coffee | Melitta®](#)
-  [Melitta® Online Shop | Melitta® Online Shop](#)
-  [Melitta® Online Shop](#)
-  [Cafeteras automáticas, de goteo y accesorios para café | Melitta®](#)
-  [Melitta® Boutique en ligne](#)
-  [Melitta® Online Shop](#)
-  [Melitta® Online Shop](#)