



meliconi Facile 5 Plus Remote Control User Guide

[Home](#) » [meliconi](#) » meliconi Facile 5 Plus Remote Control User Guide 

meliconi Facile 5 Plus Remote Control User Guide



BATTERY TEST

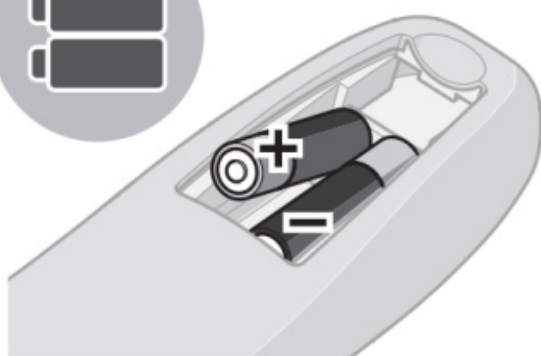

x2 AAA/LR03



NO RECHARGEABLE

Press and hold button 5 and check that the LED on the remote control remains continuously lit until the button is released. If the LED flashes or stays off the batteries used are not sufficiently charged: replace them.



The **Facile 5+** remote control is a universal remote control. For this reason it must be programmed by following the procedure listed below.

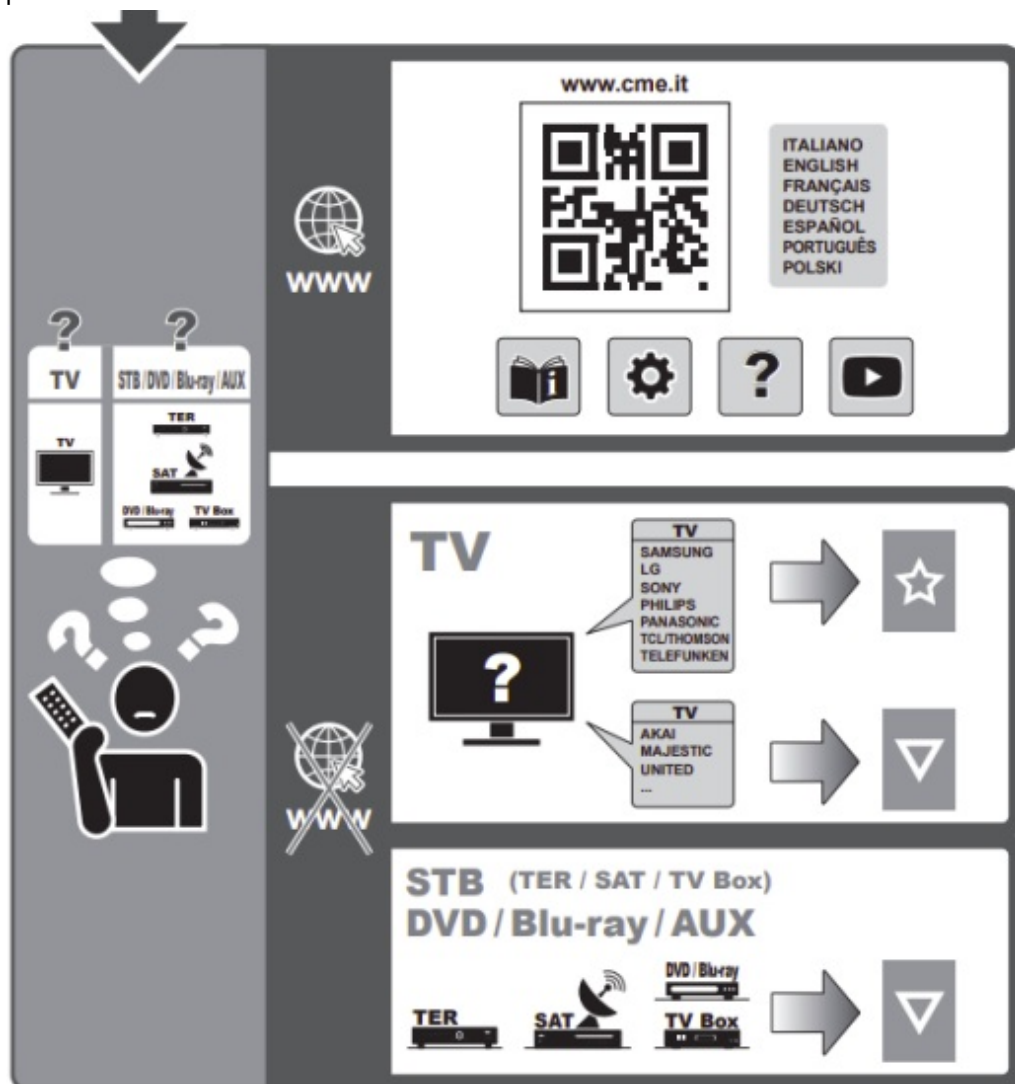



NOTE

The remote control reproduces the infrared signals of the original remote control. Radio frequency functions (e.g. voice commands and pointer) are not supported.



By quickly pressing the  button, select “TV” on the remote control.

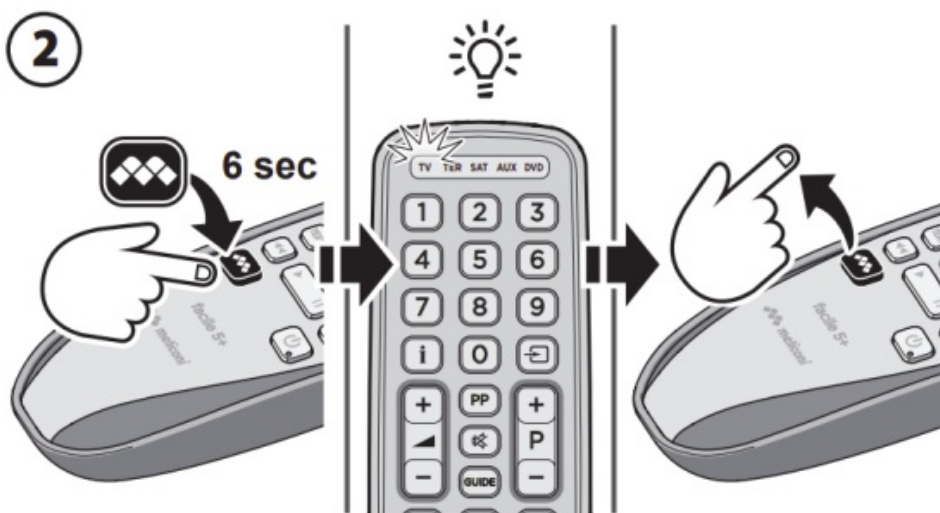

Press and hold the “M” button until the top LED lights up. Release the button.

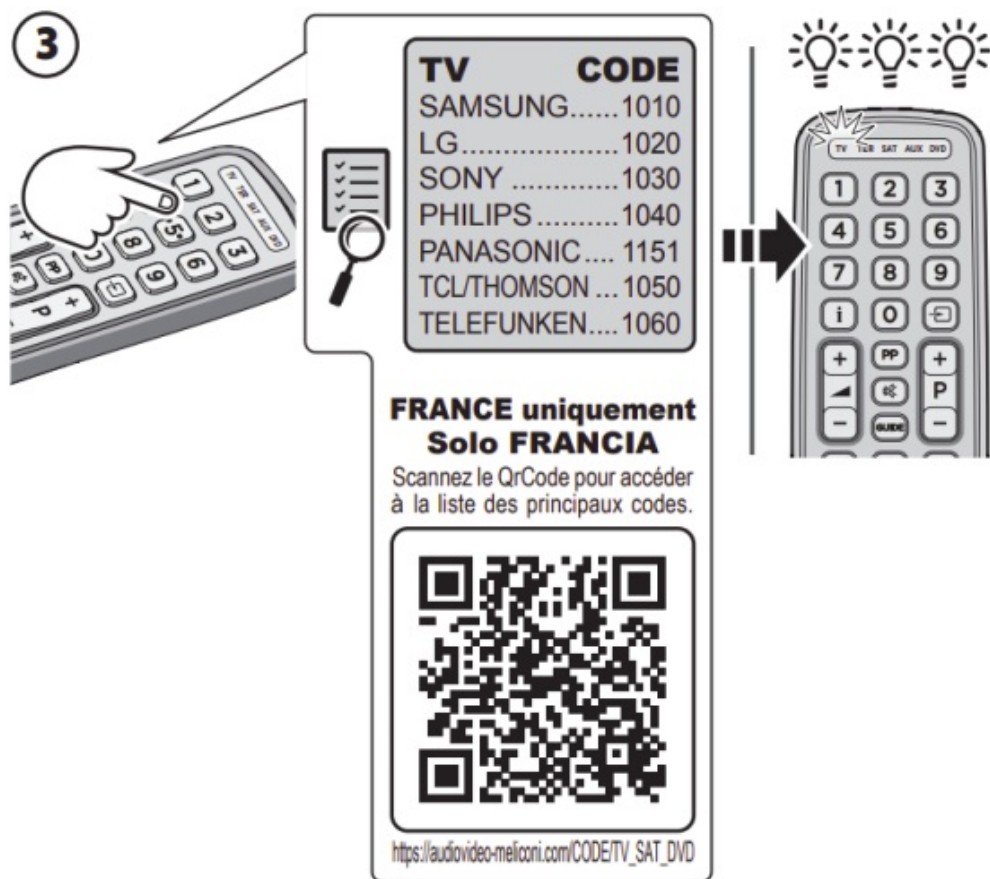

Use the numeric keys to enter the code previously found. The LED will make 3 flashes of confirmation.

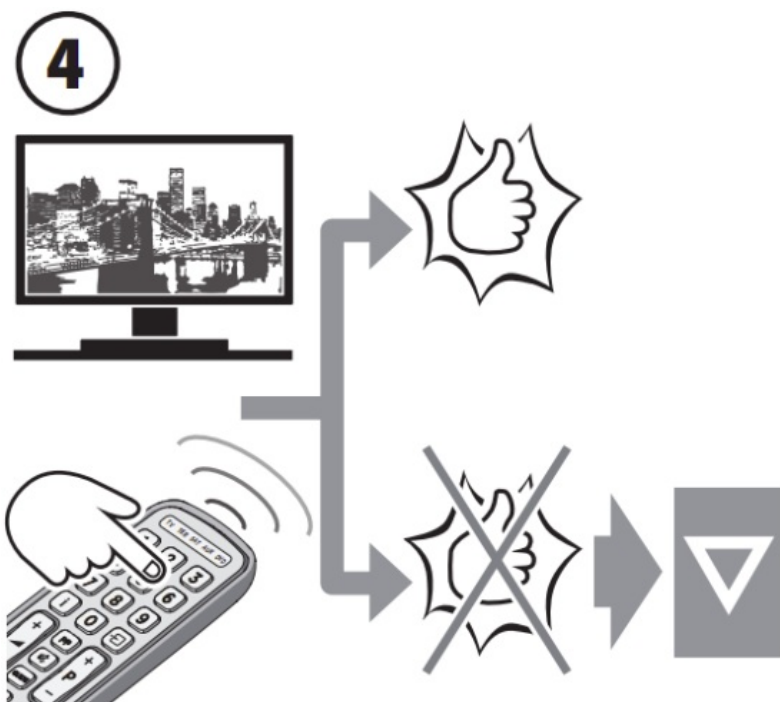

Check that the keys function correctly. If they do not all function correctly, go to point below.

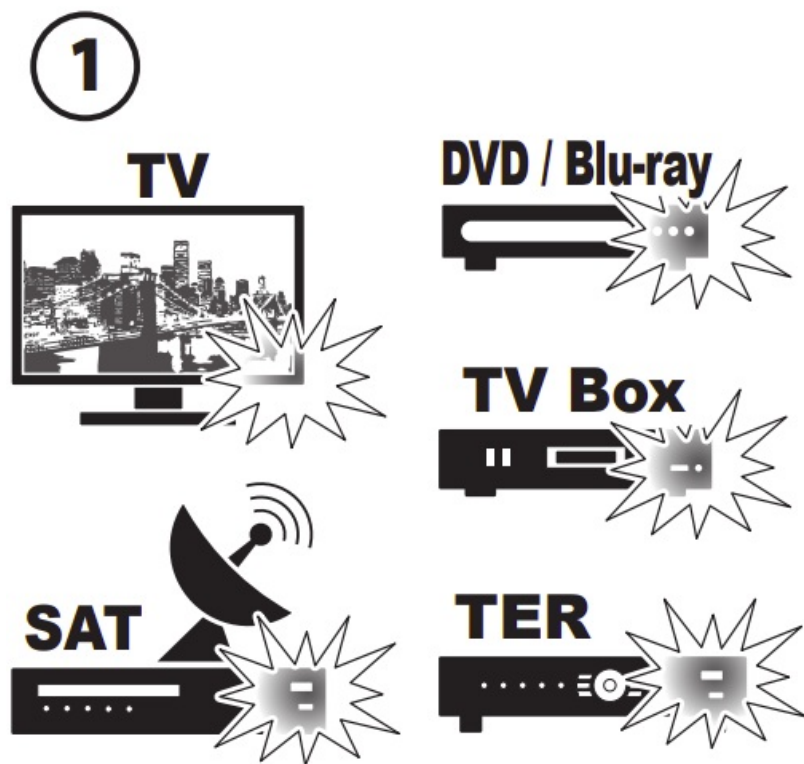

Switch on the device to be controlled.



Select the device to control (TV / TER / SAT / AUX / DVD).

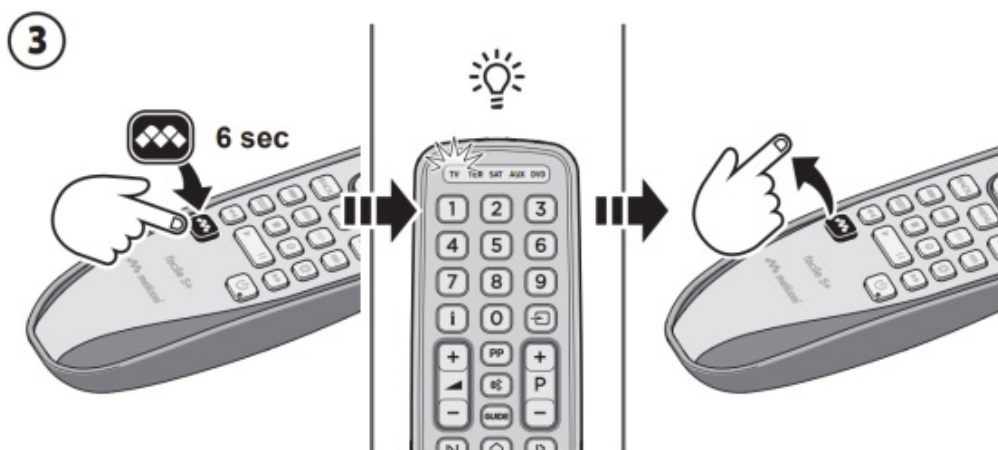

Press and hold the  button until the top LED lights up. Release the button.

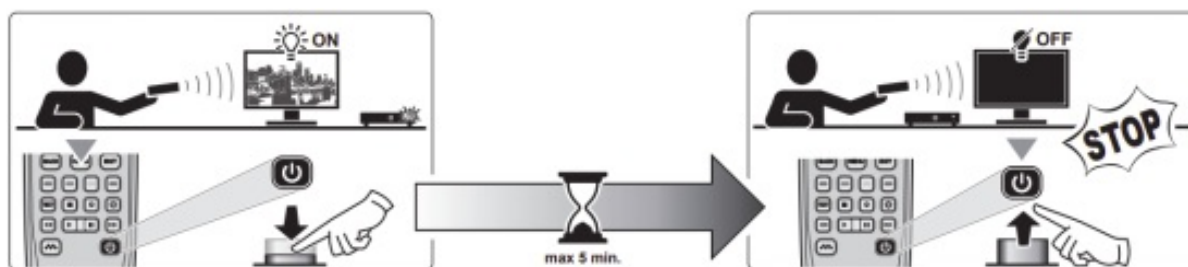

Point the remote control at the device, hold down the  button and release it as soon as the device switches off (max 5 minutes).



Check that the keys function correctly. If it does not work, repeat procedure “ ” or contact customer service.

Contents

1 SAFETY WARNINGS

2 Documents / Resources

2.1 References

3 Related Posts

SAFETY WARNINGS



- Read the safety warnings and instructions before using the product and keep them for future reference.
- If the product is passed on to third parties, always include this manual and the safety warnings with it.
- The product contains small parts which could detach and be swallowed (suffocation hazard), keep away from children or pets.
- If a part is accidentally swallowed, contact a Physician/go to Accident and Emergency at once to have it removed.
- Do not expose the remote control to sources of excessive heat, such as direct sunlight, fire or the like.
- Keep away from water and liquids in general. Never immerse in water or liquids.
- Never attempt to dry the remote control by heating it (e.g. using a hair dryer, oven or microwave).
- To avoid electric shock, do not tamper with or attempt to open the device.
- Do not use a damaged product.
- If the product has to be disposed of, or at its end-of-life, refer to the “DISPOSING OF THE PRODUCT” section of this manual.
- Do not misuse the product.
- If fluid leaks from the battery, wipe it away without touching it directly with your hands (irritant and corrosive).
- Do not open the product.
- All repairs must be performed by a qualified centre.
- Only use batteries of the specified type.
- When fitting batteries, take care that the poles correspond.



DISPOSING OF THE PRODUCT The crossed-out bin symbol shown on the product indicates that it must be collected separately from other waste at the end of its useful life. Users must therefore take it to the appropriate separate waste collection centers for electrical and electronic waste, or hand it in to the retailer when purchasing a device of the same type. Proper separate waste collection for end-of-life devices so they can be sent for recycling, treatment or eco-compatible disposal helps to avoid possible negative effects for the environment and health, and aids recycling of the materials the device is composed of.



WARNING Batteries must not be taken apart, thrown into the fire or dispersed in the environment. Improper use may cause damage to the environment or health. The bin symbol indicates that batteries must be disposed of in accordance with the regulations in force; make sure you are familiar with the regulations governing the collection of worn-out batteries and accumulators in your country.



telecomandi@meliconi.com
hotline@meliconi.fr



Documents / Resources



[meliconi Facile 5 Plus Remote Control](#) [pdf] User Guide
Facile 5 Plus, Facile 5 Plus Remote Control, Remote Control, Control

References

-  [CME / MELICONI](#)
-  [Meliconi - Lo specialista dell'accessorio](#)
-  [Liste non exhaustive des Codes TV - TNT - SAT - TVBOX et DVD](#)
- [User Manual](#)

[Manuals+](#), [Privacy Policy](#)

This website is an independent publication and is neither affiliated with nor endorsed by any of the trademark owners. The "Bluetooth®" word mark and logos are registered trademarks owned by Bluetooth SIG, Inc. The "Wi-Fi®" word mark and logos are registered trademarks owned by the Wi-Fi Alliance. Any use of these marks on this website does not imply any affiliation with or endorsement.