

Meiyaxuan
Meiyaxuan MOKX-1
WiFi Repeater
Software



Model No: MOKX-1
FCC ID: 28EZXMOKX-1



Meiyaxuan MOKX-1 WiFi Repeater Software User Guide

[Home](#) » [Meiyaxuan](#) » Meiyaxuan MOKX-1 WiFi Repeater Software User Guide 

Contents

- [1 Meiyaxuan MOKX-1 WiFi Repeater Software](#)
- [2 Product Usage Instructions](#)
- [3 LED Explanation](#)
- [4 Q&A](#)
- [5 FCC Requirement](#)
- [6 Documents / Resources](#)
 - [6.1 References](#)
- [7 Related Posts](#)

Meiyaxuan Meiyaxuan MOKX-1 WiFi Repeater Software



Model No: MOKX-1
FCC ID: 28EZXMOKX-1

Product Specifications

- Power Output: 8KW

- Compatibility: Suitable for various devices
- Material: Durable plastic and metal components
- Color: Black

Product Usage Instructions

Initial Setup

1. Unbox the product carefully and remove all packaging materials.
2. Place the device on a flat, stable surface near a power source.
3. Connect the power cord to the device and plug it into a power outlet.

Operating the Device

1. Press the power button to turn on the device.
2. Adjust the settings using the control panel or remote control, if applicable.
3. Monitor the device while it is in operation to ensure proper functioning.

Cleaning and Maintenance

1. Before cleaning, ensure the device is unplugged and cooled down.
2. Use a damp cloth to wipe the exterior of the device gently.
3. Regularly check and clean any filters or vents to prevent dust buildup.

Frequently Asked Questions (FAQ)

- **Q: How do I troubleshoot if the device is not powering on?**

A: Check the power source, ensure the power cord is securely connected, and try plugging the device into a different outlet.

- **Q: Can this device be used with international voltage standards?**





A: This device is designed for use with standard voltage levels. Using it with international standards may require a voltage converter.

- **Q: Is it safe to leave the device unattended during operation?**

A: It is recommended to never leave the device unattended while in operation for safety reasons. Always turn it off when not in use.

Quick User Guide

LED Explanation

Icon	Indication	Status
	POWER LED	The power on indicator is steady on
	WLAN LED	Always bright when working normally
	WPS LED	If no signal trunk is on, or the signal is red, the trunk is steady on
	LAN LED	Steady on: The port is properly connected. Blinking: Data is being transmitted

Function Description

Find the right place to power the product, As shown in the figure below. The user can select the room where the signal needs to be enhanced. If you buy more than one, you can place different rooms.

Note: if the network cable is inserted directly from the main router, please use AP mode configuration.

Button Explanation

WPS Button: If your host router supports WPS function, you can press the WPS button and then press the WPS button of the WiFi Repeater to establish a secure connection between the host router and the WiFi Repeater. Press and hold for 8 seconds to restore repeater factory. **Side Reset button:** This button is used to restore factory default Settings, press and hold for 8 seconds. settings.

Step Description

1. B1 .Open the phone settings,scan Wi-Fi hotspots,select SSID as Repeater _XXXX ,then connect it.
- 2.

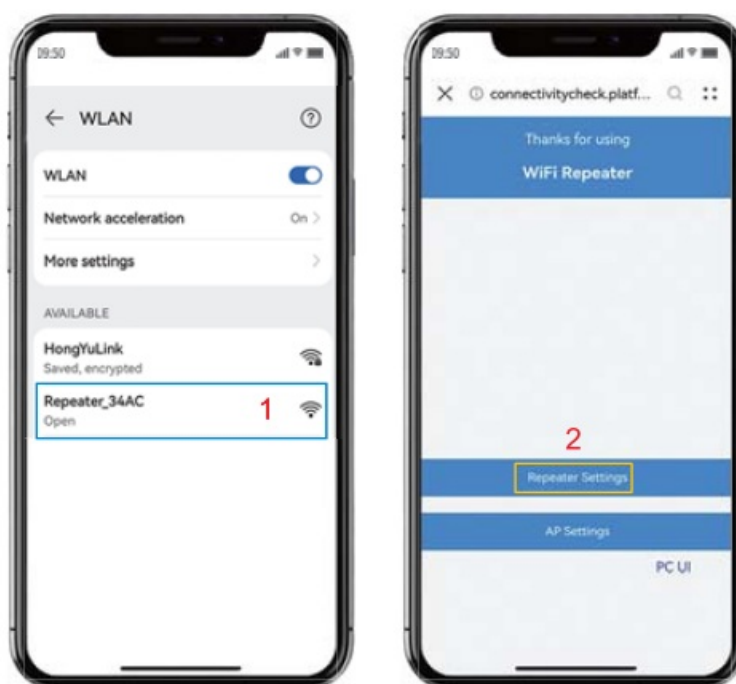

B2.Then your phone will Jump a new page auto.and select Repeater

Setting. (If you use network cable to connect router.please select AP Setting) The figure is are below:

3. B3. Wait for the product to automatically scan the SSID, select Main Wi-Fi SSID and enter the password.If can't find main Router SSID, please swipe the list up and down or refresh it again.

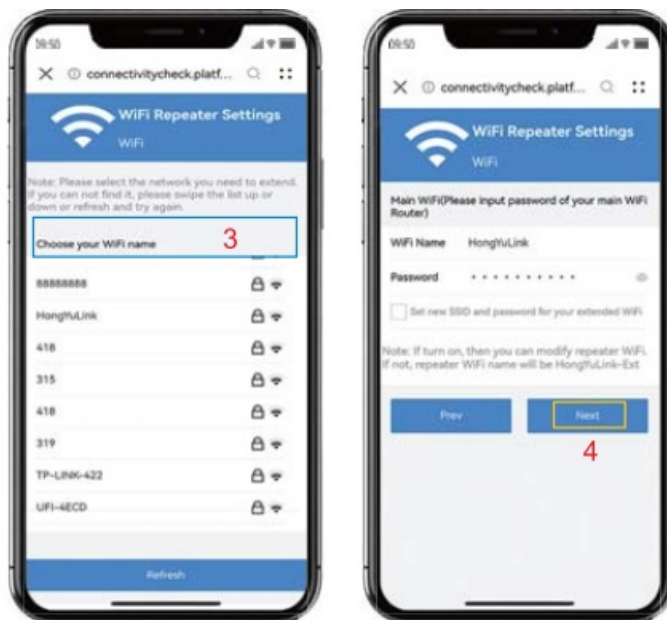

4. B4. If you need a different hotspot name and password, please check the box, as shown in the figure below and modify it.



5. B5. The information after configuration is shown in the figure above. if necessary to modify the configuration, press the side RST key for more than 8 seconds Reconfigure after returning to factory settings.

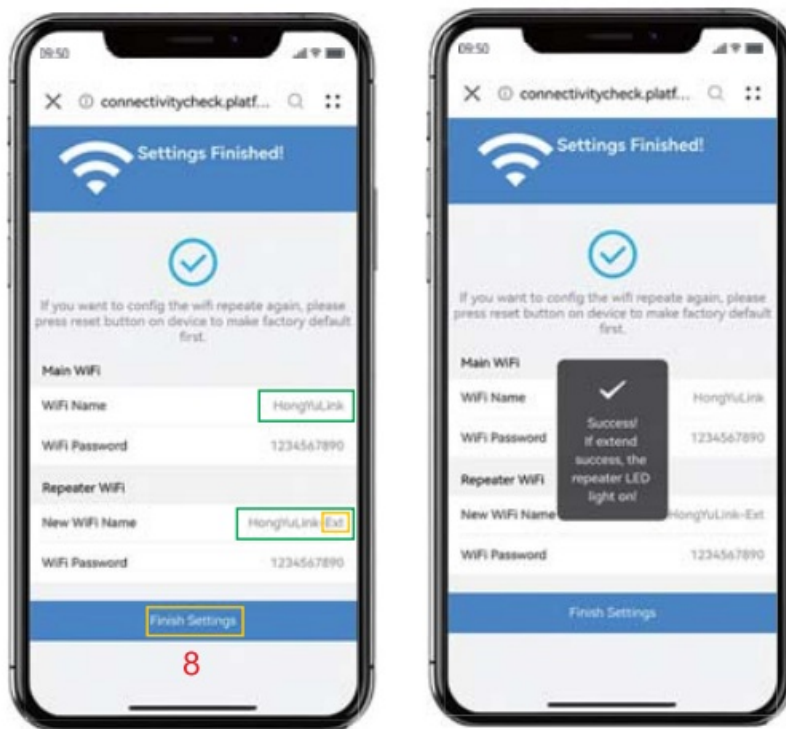

Q&A

1. QA1:How to modify configuration information?

If you want to modify the configuration information after configuration, please press the top RST key for more than 8 seconds. Reconfigure after returning to factory settings.

2. QA2:How to do when stopped halfway during configuration?

If the iPhone device and iPad device are stopped halfway during configuration, you need to ignore this hotspot and reconfigure in the-Fi setting interface again.

3. QA3:How to do when device cannot jump up the config page?

Make sure your computer is connected to this extended network device and is set to automatically get an IP address. If it does not appear, go to the router's DHCP client list to get the current IP address of the repeater and reset the repeater.

4. QA4:How to do to set the same or different SSID and password?

Refer to step B4, new hotspot name and password can be changed by the user. The default is different from the hotspot name of the main router.and the password is the same. Users can modify it.

5. QA5:What if the new hotspot name cannot be connected to the internet after the configuration is completed?

In this case, the configuration is unsuccessful, or the password of the upper main router is wrong.Please press the reset button to restore the factory and reconfigure.

FCC Requirement

changes or modifications not expressly approved by the party responsible for compliance could void the user's authority to operate the equipment.

This device complies with Part 15 of the FCC Rules. Operation is subject to the following two conditions:

1. This device may not cause harmful interference, and
2. This device must accept any interference received, including interference that may cause undesired operation.

Note: This equipment has been tested and found to comply with the limits for a Class B digital device, pursuant to Part 15 of the FCC Rules. These limits are designed to provide reasonable protection against harmful interference in a residential installation. This equipment generates, uses, and can radiate radio frequency energy, and if not installed and used in accordance with the instructions, may cause harmful interference to radio communications. However, there is no guarantee that interference will not occur in a particular installation. If this equipment does cause harmful interference to radio or television reception, which can be determined by turning the equipment off and on, the user is encouraged to try to correct the interference by one or more of the following measures:

- Reorient or relocate the receiving antenna.
- Increase the separation between the equipment and receiver.
- Connect the equipment into an outlet on a circuit different from that to which the receiver is connected.
- Consult the dealer or an experienced radio/TV technician for help.

This equipment complies with FCC radiation exposure limits set forth for an uncontrolled environment. This equipment should be installed and operated with a minimum distance of 20cm between the radiator & your body. This transmitter must not be co-located or operating in conjunction with any other antenna or transmitter.

Documents / Resources

	Meiyaxuan MOKX-1 WiFi Repeater Software [pdf] User Guide MOKX-1, MOKX-1 WiFi Repeater Software, WiFi Repeater Software, Repeater Software, Softw are
---	---

References

- [User Manual](#)

[Manuals+](#), [Privacy Policy](#)

This website is an independent publication and is neither affiliated with nor endorsed by any of the trademark owners. The "Bluetooth®" word mark and logos are registered trademarks owned by Bluetooth SIG, Inc. The "Wi-Fi®" word mark and logos are registered trademarks owned by the Wi-Fi Alliance. Any use of these marks on this website does not imply any affiliation with or endorsement.