

**MEIKEE SWL-01 LED Multi Functional Portable Work Light**



# MEIKEE SWL-01 LED Multi Functional Portable Work Light Instruction Manual

[Home](#) » [MEIKEE](#) » MEIKEE SWL-01 LED Multi Functional Portable Work Light Instruction Manual 

## Contents

- [1 MEIKLE SWL-01 LED Multi Functional Portable Work Light](#)
- [2 Product Structure Introduction](#)
- [3 Work Light Product Parameters](#)
- [4 The function of the switch](#)
- [5 Documents / Resources](#)
  - [5.1 References](#)

# MEIKEE

**MEIKLE SWL-01 LED Multi Functional Portable Work Light**



Thank you for purchasing the MEIKEE product. To ensure a perfect experience, please follow the instructions for use.

If you have any questions about this product, please feel free to contact our customer service team ASAP, and our after-sales department will solve any issue for our VIP customers.

E-mail: [meikee@meikeelighting.com](mailto:meikee@meikeelighting.com)

## Product Structure Introduction

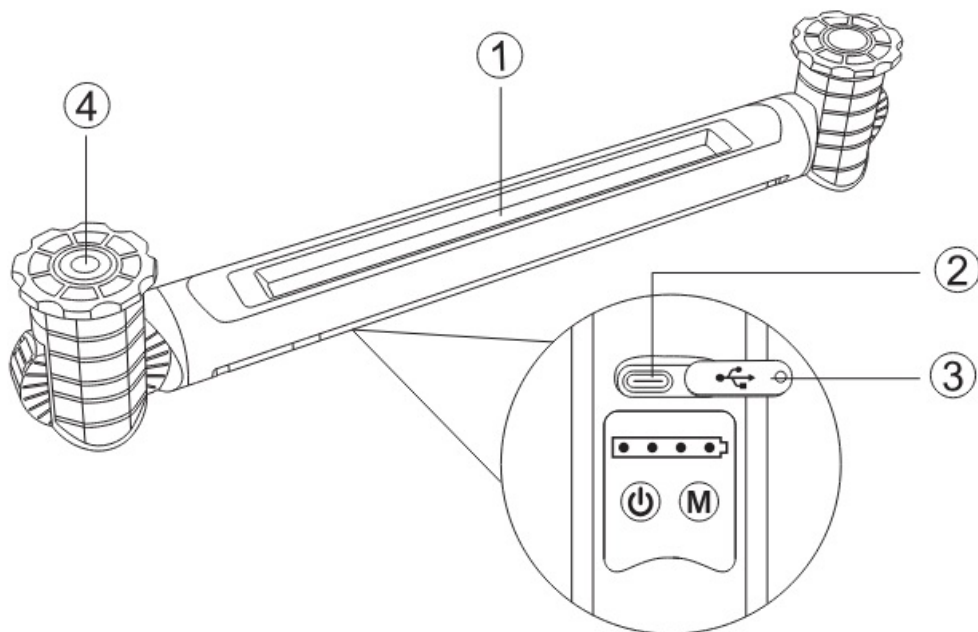

1. Lighting luminous surface
2. TPC charging port
- Input: 5V/2A**
3. Dustproof plug
4. Magnetic

## Work Light Product Parameters

Product Model	SWL-01
LED	140PCS(70PCS White Light + 35PCS Red light + 35PCS Blue Light)
Lighting angle	60°(Floodlight type, large irradiated area)
Lighting mode	6500K-SOS
	Red-Blue-SOS
Brightness mode	3-Levels, 100%-50%-30% cyclic adjustment
Continuous light time	100%(2.5H)-50%(5H)-30%(8.5H)
Battery life	Charge and discharge cycles: About 500 times
Charging voltage	5V/2A(About 2H)
Waterproof grade	IP65
Operating temperature	Charging:0~45℃, Working:-20~45℃
Storage temperature	-5℃-35℃
Main material	PC,ABS,Aluminum
Warming Tips: After charging and discharging up to 500 rounds, the battery capacity is only about 60%-75% of the original capacity.	

## The function of the switch

1.  Battery indicator – 1 green indicator light on 25% power /green indicator light on 50% power / 3 green indicator lights on 75% power / 4 green indicator lights on 100% power.

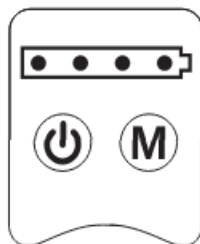

The green light flashes when charging, the light corresponding to the full level of power stays on, and all the green lights stay on when the battery is fully charged. When the battery is about to run out of power, all four lights flash at the same time. Short press to check the power of the light, and the indicator light turns off after 5S.

2.  Power Button: Long press to turn on default 100% (high) brightness – Press to 50% (medium) brightness – Press to 30% (low) brightness – Long press to turn off (can short press to turn off after staying in any mode for more than 5 seconds )
3. **M** Mode Button: (Press to cycle) 6500K – 6500K flashing – red light – red light flashing – blue light – blue light flashing

### Warning

1. Please charge the light according to the voltage in the parameter of the user manual.
2. Built-in battery, please prohibit high-temperature baking and explosive force extrusion impact. Keep away from fire sources.
3. To protect your eyes, please do not stare at the LED light-emitting surface for a long time.
4. In any case, the light should not be covered by insulation pads or similar.

### C&E Connection E-Commerce (DE) GmbH

- Zum Linnegraben 20, 65933, Frankfurt am Main, Germany
- E-mail: [info@ce-connection.de](mailto:info@ce-connection.de)
- Tel: +49 (069) 27246648

### CET PRODUCT SERVICE LTD.

- Beacon House Stokenchurch Business Park, Ibstone Rd, Stokenchurch High Wycombe HP14 3FE UK
- Tel: +447419325266
- E-mail: [info@cetproduct.com](mailto:info@cetproduct.com)

Contact: [meikee@meikeelighting.com](mailto:meikee@meikeelighting.com)  
Website: <http://www.meikeelighting.com>

---

Documents / Resources

	<p><a href="#">MEIKEE SWL-01 LED Multi Functional Portable Work Light</a> [pdf] Instruction Manual SWL-01 LED Multi Functional Portable Work Light, SWL-01, LED Multi Functional Portable Work Light, Multi Functional Portable Work Light, Functional Portable Work Light, Portable Work Light , Work Light</p>
---	--

References

- [User Manual](#)

[Manuals+](#), [Privacy Policy](#)

This website is an independent publication and is neither affiliated with nor endorsed by any of the trademark owners. The "Bluetooth®" word mark and logos are registered trademarks owned by Bluetooth SIG, Inc. The "Wi-Fi®" word mark and logos are registered trademarks owned by the Wi-Fi Alliance. Any use of these marks on this website does not imply any affiliation with or endorsement.