

MEETION K210 Wireless Bluetooth Keyboard



MEETION K210 Wireless Bluetooth Keyboard User Manual

[Home](#) » [MEETION](#) » MEETION K210 Wireless Bluetooth Keyboard User Manual 

Contents

- [1 MEETION K210 Wireless Bluetooth Keyboard](#)
- [2 MULTIMEDIA FUNCTION KEYS](#)
- [3 CHARGE INDICATION \(KEYBOARD\)](#)
- [4 WARRANTY CARD](#)
- [5 Documents / Resources](#)
 - [5.1 References](#)
- [6 Related Posts](#)



MEETION K210 Wireless Bluetooth Keyboard



key K210
USER'S MANUAL
WIDELECC KEVDAn

MULTIMEDIA FUNCTION KEYS

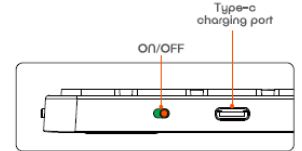
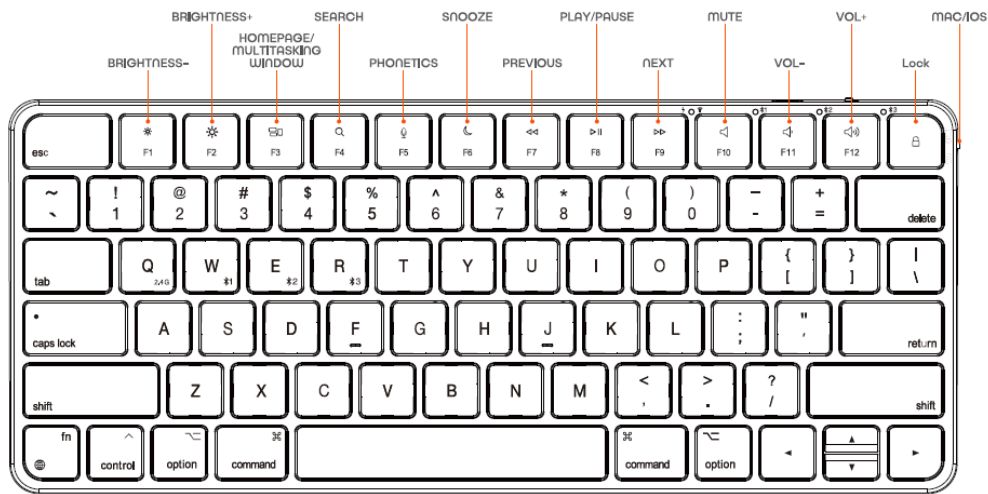

2.4G CONNECTION(KEYBOARD)

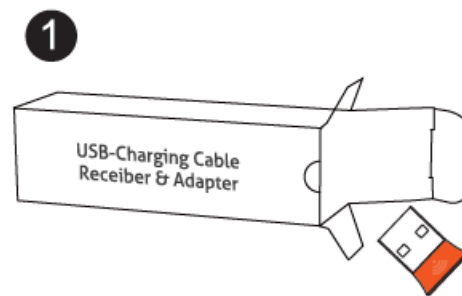

1. Open the accessory box and remove the receiver from it
- 2.

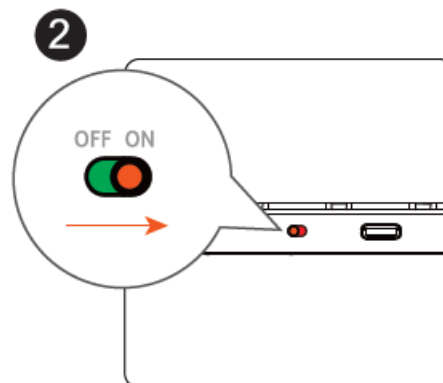

Turn on the keyboard power switch

- 3.

3



Short press “fn” and “2.4G” at the same time Green light on, switch to 2.4G channel

4.

4

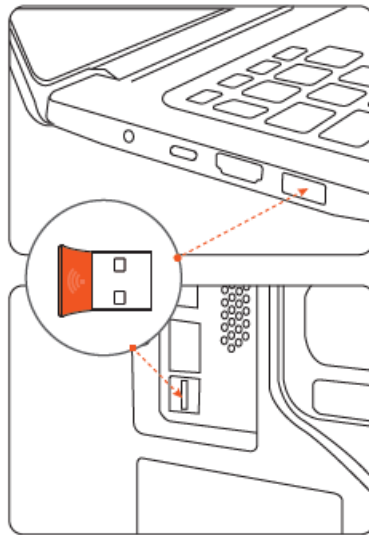

Insert computer USB interface

BLUETOOTH CONNECTION(KEYBOARD)

1

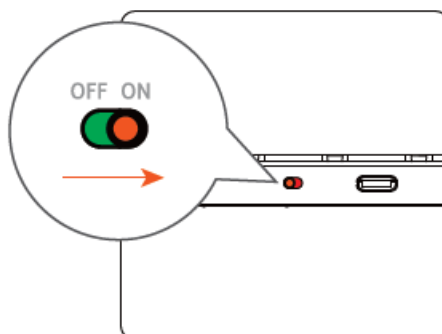

1. Turn on the keyboard power switch

2.

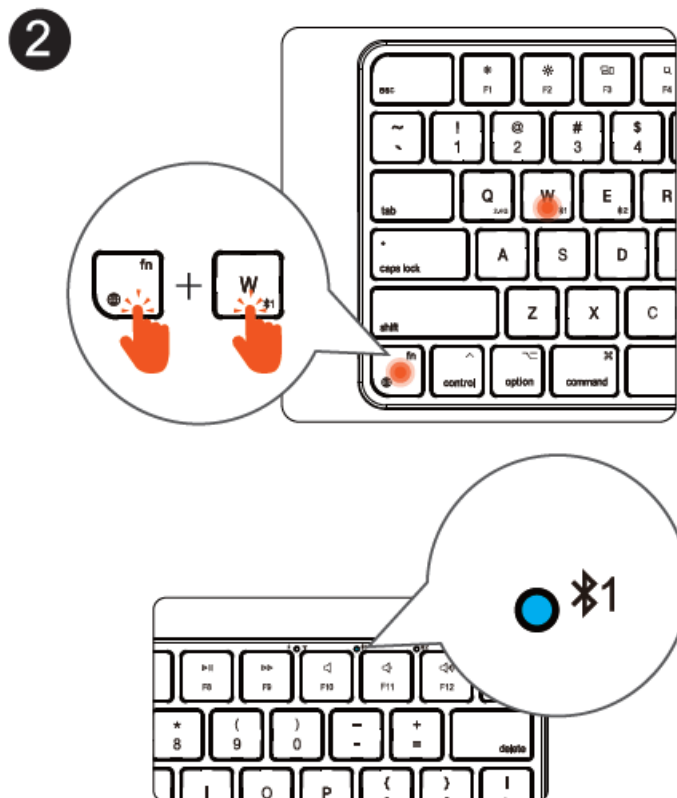

Short press “fn” and “Bluetooth 1” at the same time Blue light is on, switch to Bluetooth 1 channel;Long press again for 3s, blue light flashes, enter Bluetooth 1 pairing mode

3.

3

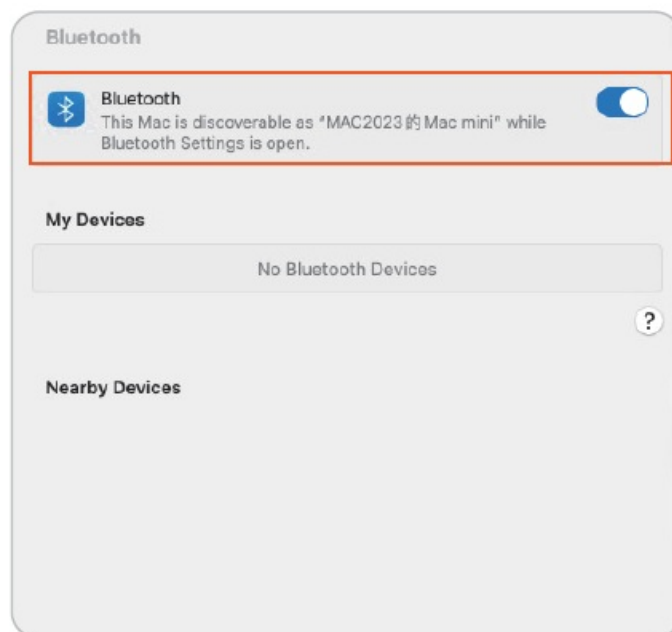

Turn on the computer Bluetooth switch to enter the Bluetooth settings page

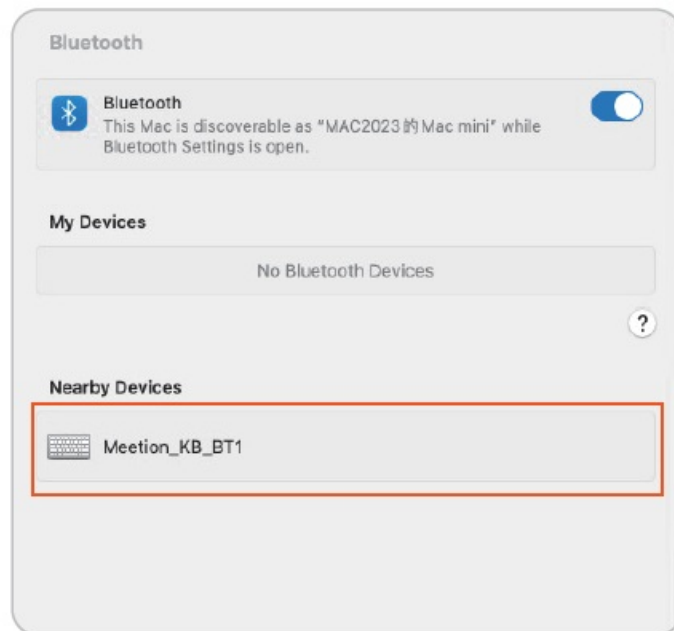

Click to add Bluetooth or other devices, click to add Bluetooth mouse, keyboard, and other devices

4

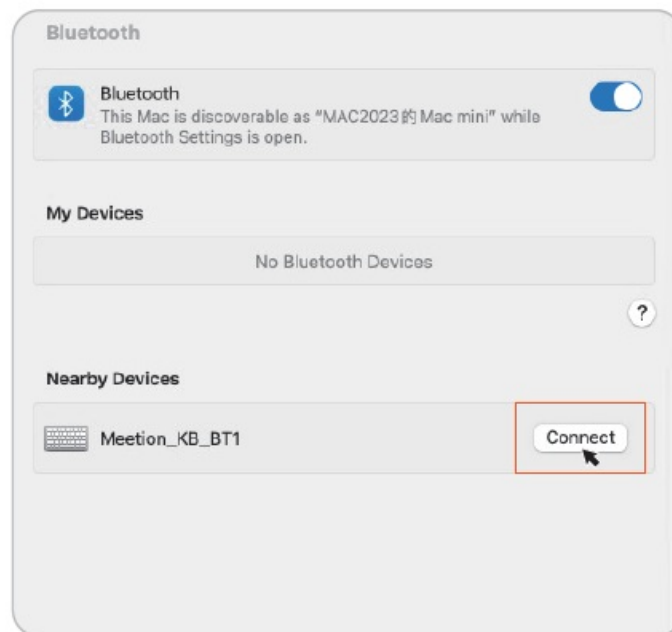

4. Find the device named Meetion_KB_BT1 and click on Add Pairing

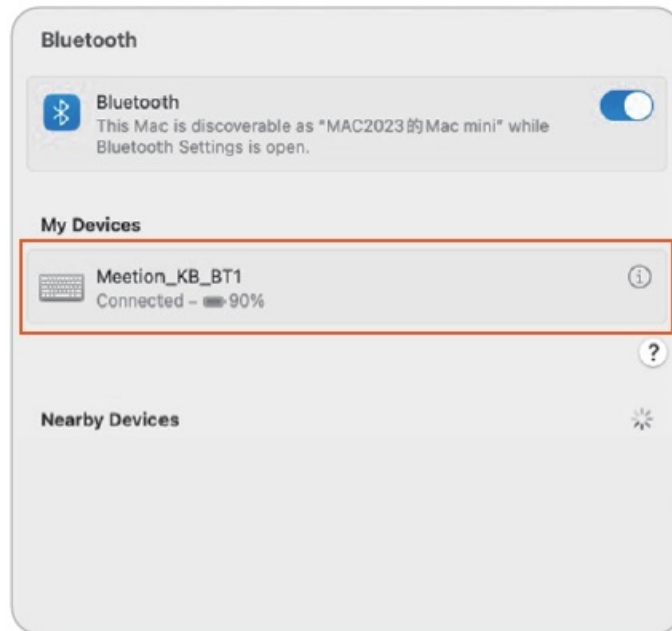

Paired successfully

BLUETOOTH Connection(KEYBOARD) 2

1. Turn on the keyboard power switch
- 2.

1

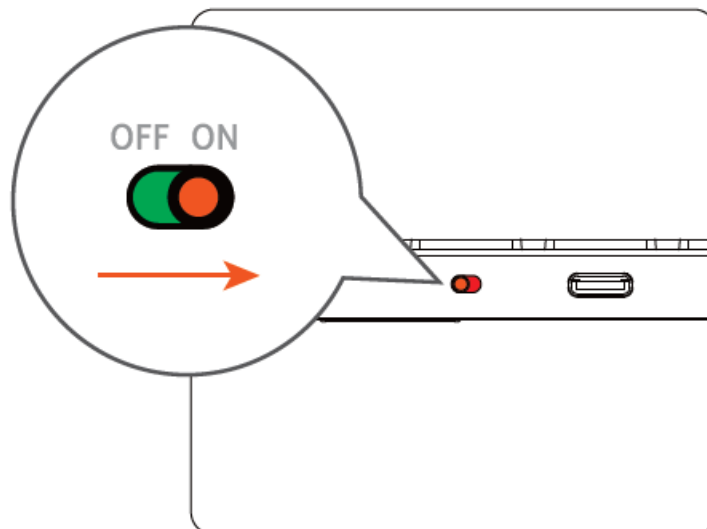

Short press “fn” and “Bluetooth 2” at the same time Blue light is on, switch to Bluetooth 2 channel; Long press again for 3s, blue light flashes, enter Bluetooth 2 pairing mode

2

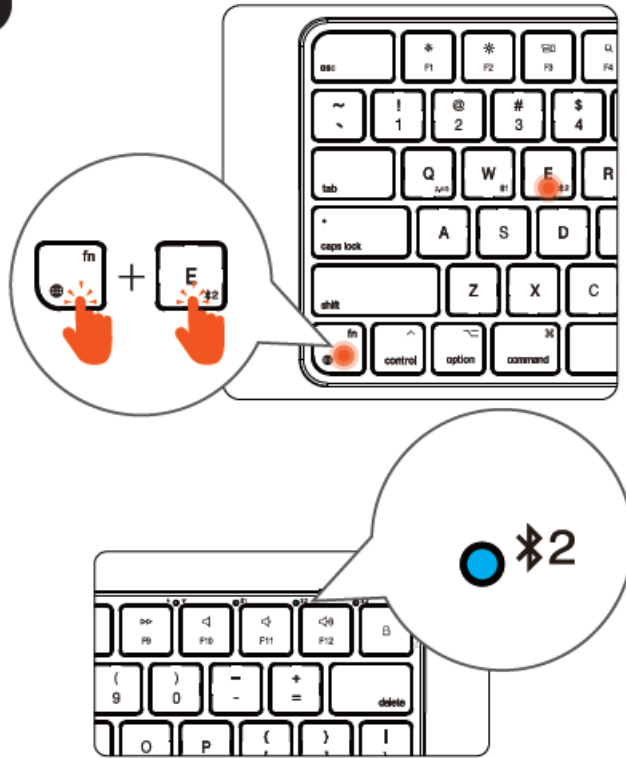

3. Turn on the computer Bluetooth switch to enter the Bluetooth settings page

3

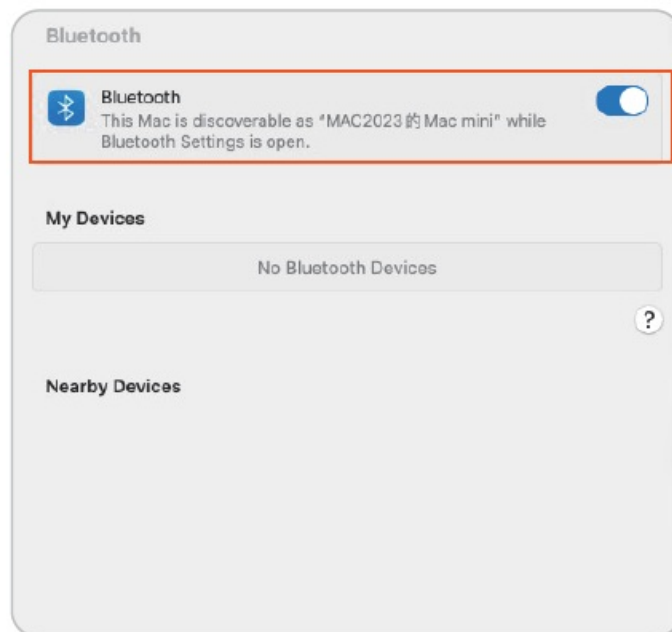

Click to add Bluetooth or other devices, click to add Bluetooth mouse, keyboard, and other devices

4.

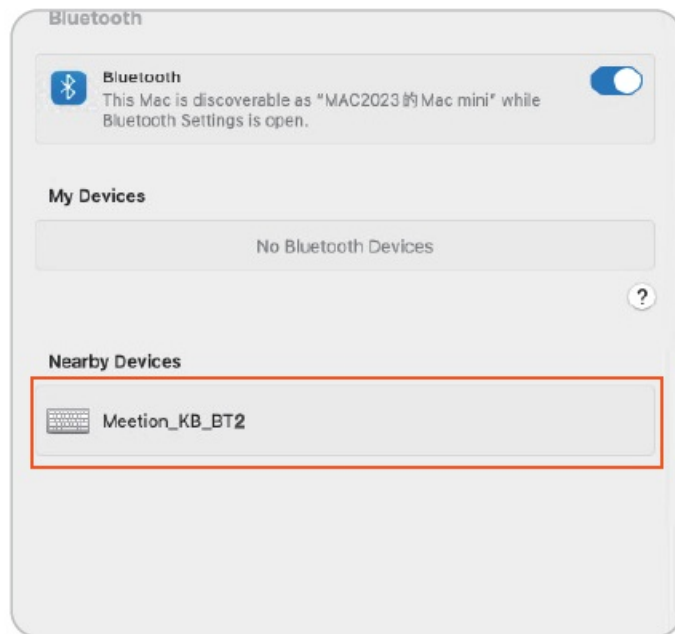

Find the device named Meetion_KB_BT2 and click on Add Pairing

4

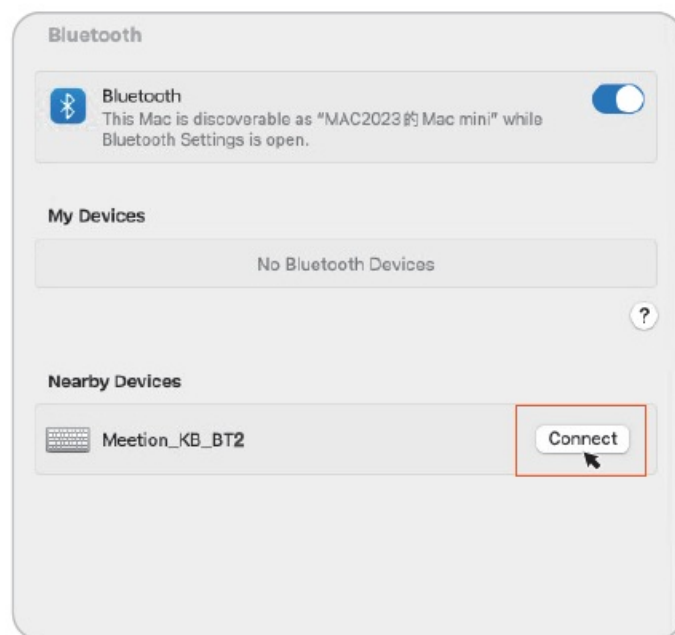

Paired successfully

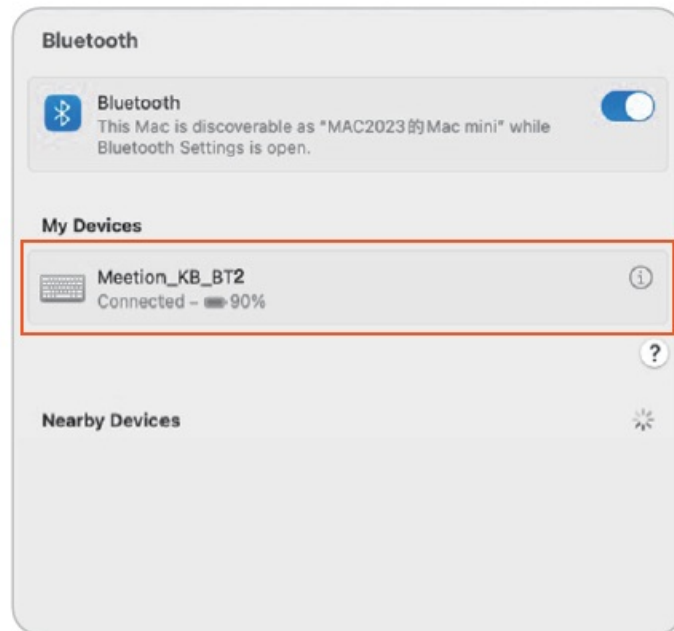

BLUETOOTH CONNECTION(KEYBOARD) 3

1

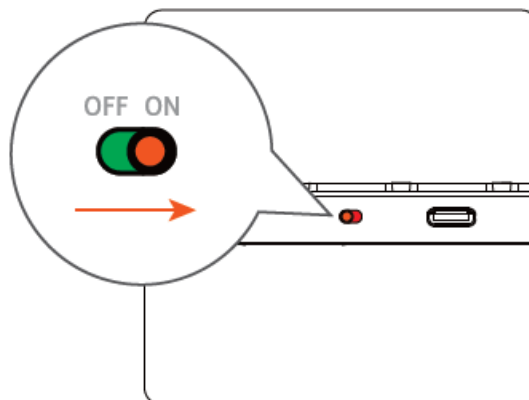

Turn on the keyboard power switch

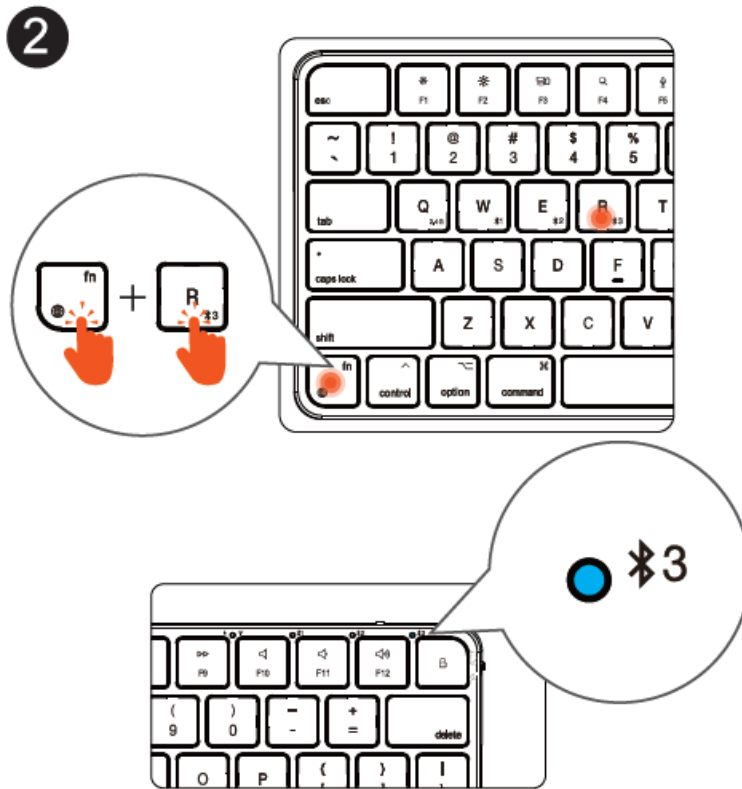

Short press “fn” and “Bluetooth 3” at the same time Blue light is on, switch to Bluetooth 3 channel; Long press again for 3s, blue light flashes, enter Bluetooth 3 pairing mode

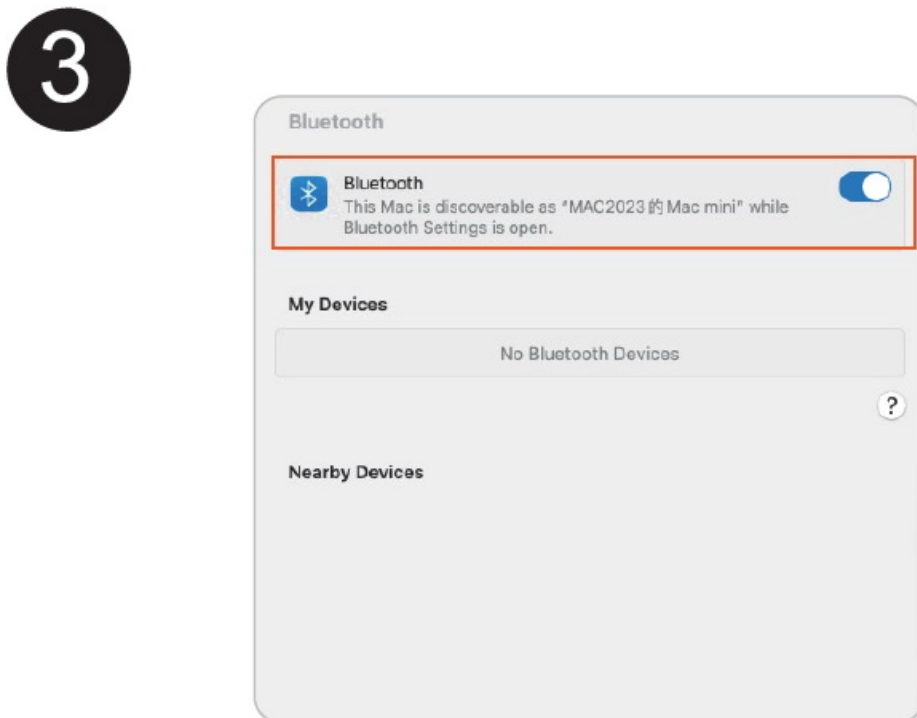

Turn on the computer Bluetooth switch to enter the Bluetooth settings page

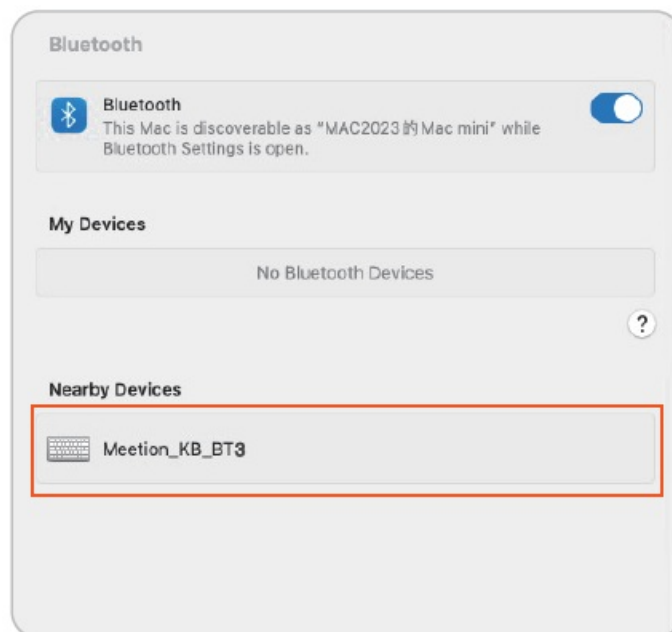

Click to add Bluetooth or other devices, click to add Bluetooth mouse, keyboard, and other devices

4

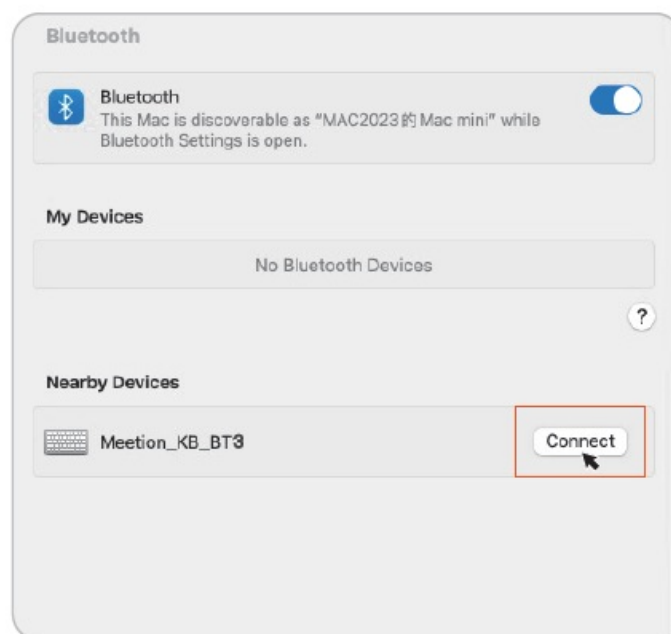

Find the device named Meetion_KB_BT3 and click on Add Pairing

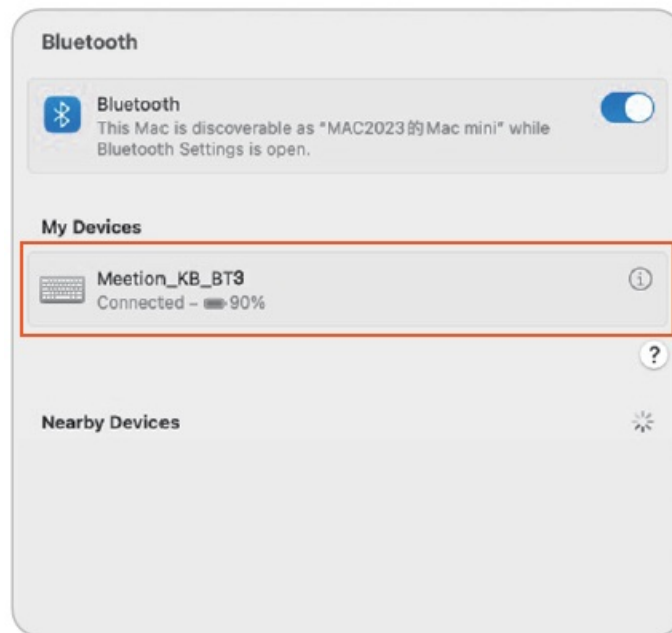

Paired successfully

CHARGE INDICATION (KEYBOARD)

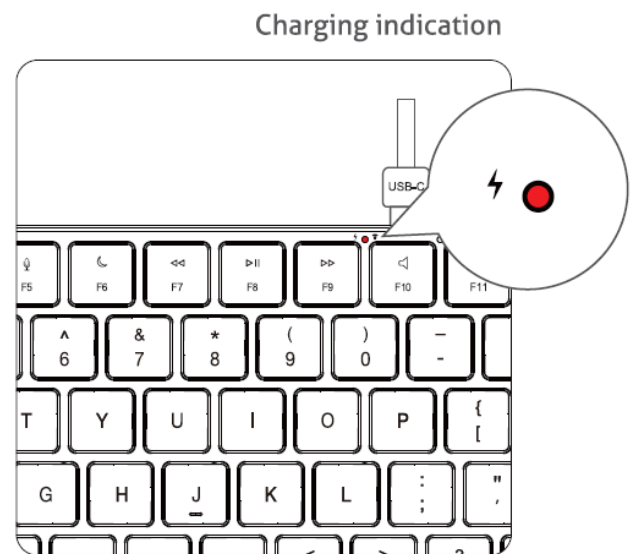
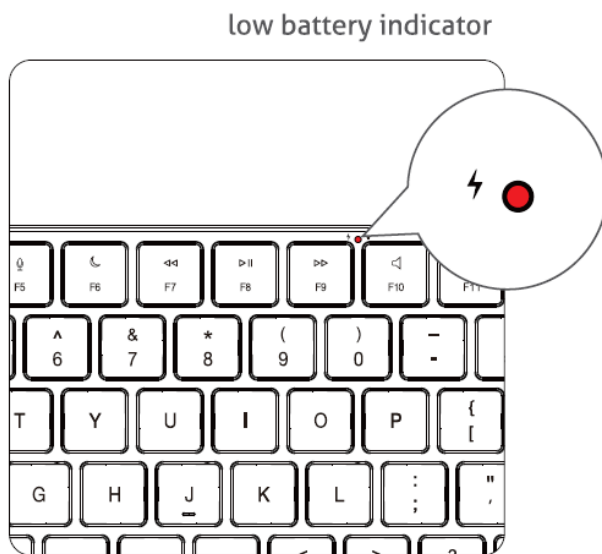

This red light is blinking, the battery is low
This red light is always on, the battery is charging

Battery full indication

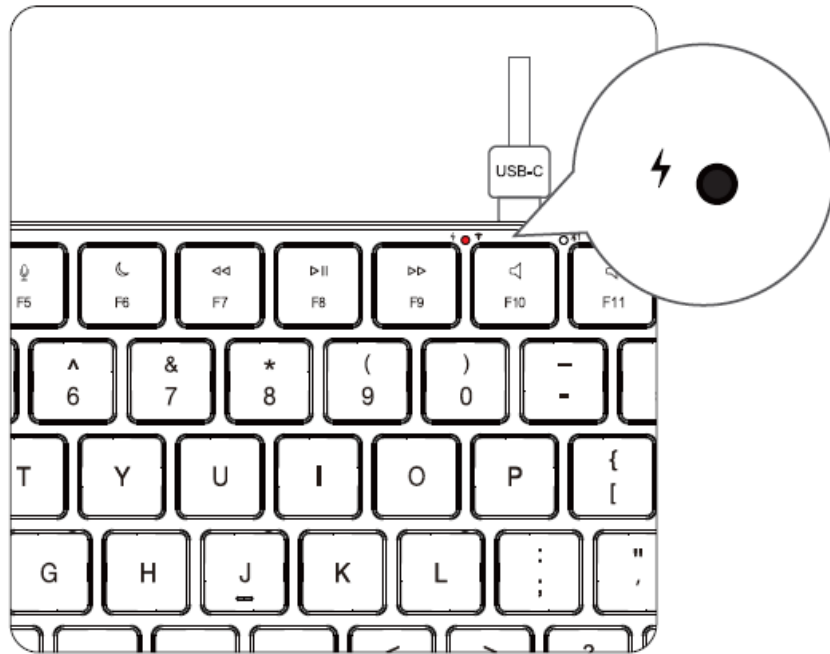

Red light is off, battery is fully charged

Note: The charging voltage should not exceed 5V, otherwise the product circuit will be damaged,

GENERAL

All products under the MEETION brand comply with the US FCC standards with **FCC ID: 24706**. The product is made in accordance with RoHS standard.

PRECAUTIONS

1. This product contains a rechargeable lithium battery.
 1. Do not dismantle, strike, crush, or put it into a fire.
 2. Stop using it immediately if severe swelling occurs.
 3. Do not place it in a high-temperature environment.
2. Do not use this device near water.
3. Only use a dry cloth to clean this product.
4. Please follow the manufacturer's instructions for use.
5. If the device is damaged, for example, if liquid enters it, if it gets wet in the rain or becomes damp, or if it cannot operate normally, it must be repaired. For repair matters, it should be entrusted to qualified maintenance personnel.

KIND TIPS

If the product is not in use for a long time, it is recommended to charge it every three months to activate the lithium battery inside the product and prevent battery failure due to long periods of non-use.

WARRANTY CARD

Model No.	
Date of Sale	
Seller	
Serial Number	

Address of the Seller _____

Phone of the Seller _____

Seller Signature & Stamp

Stamp

To be Filled in by Service Center

Date of Receipt _____	Date of Receipt _____	Date of Receipt _____
Date of Return _____	Date of Return _____	Date of Return _____
Special Marks _____	Special Marks _____	Special Marks _____

• TECHNICAL SUPPORT

- Having technical problems with this product?
- Send an email to service@meetion.com
- For more information please visit: www.meetion.com

Documents / Resources

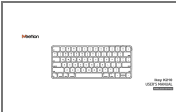
	MEETION K210 Wireless Bluetooth Keyboard [pdf] User Manual K210 Wireless Bluetooth Keyboard, K210, Wireless Bluetooth Keyboard, Bluetooth Keyboard, Keyboard
---	---

References

- [User Manual](#)

[Manuals+](#), [Privacy Policy](#)

This website is an independent publication and is neither affiliated with nor endorsed by any of the trademark owners. The "Bluetooth®" word mark and logos are registered trademarks owned by Bluetooth SIG, Inc. The "Wi-Fi®" word mark and logos are registered trademarks owned by the Wi-Fi Alliance. Any use of these marks on this website does not imply any affiliation with or endorsement.