



# Meetion DirectorC Ergonomic Wireless Keyboard and Mouse User Manual

[Home](#) » [MEETION](#) » Meetion DirectorC Ergonomic Wireless Keyboard and Mouse User Manual 

## Meetion DirectorC Ergonomic Wireless Keyboard and Mouse User Manual



 In Mac system, the default shortcut keys are function keys. In Windows system, the default shortcut keys are F1 F12. when Fn lock is closed, you need to press Fn+Shortcut to achieve the shortcut function. (Press Fn+Esc to open/close Fn lock)

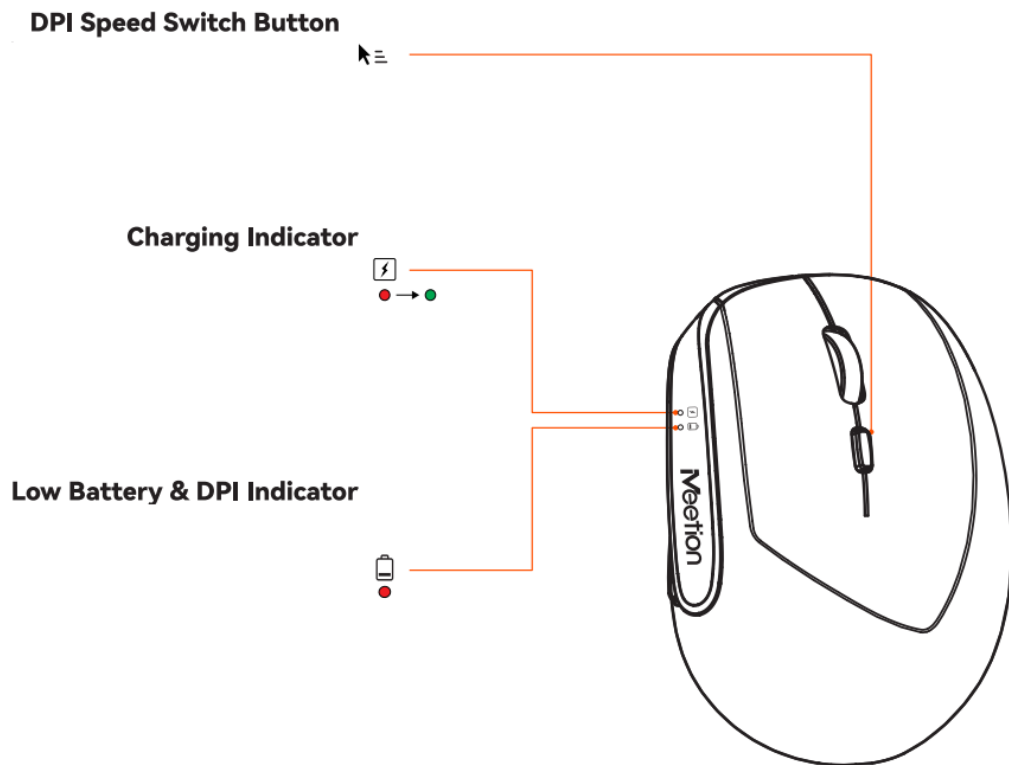

### DPI Speed Switch Button

Pressing this button will switch to different mouse pointer movement speeds, from slow to fast:  
800/1200/1600/2400

### Charging Indicator

Charging status: When charging the device, the red indicator light in this position will be on continuously, and the green indicator light will be on when the device is fully charged

### Low Battery & DPI Indicator

When the device is low on power, the red indicator at this location will flash to remind you to charge the device.

Also the red light blinks when you switch the mouse DPI: Switch to 800DPI, the red light blinks 1 time Switch to 1200DPI, the red light blinks twice Switch to 1600DPI, red light blinks 3 times Switch to 2400DPI, red light blinks 4 times

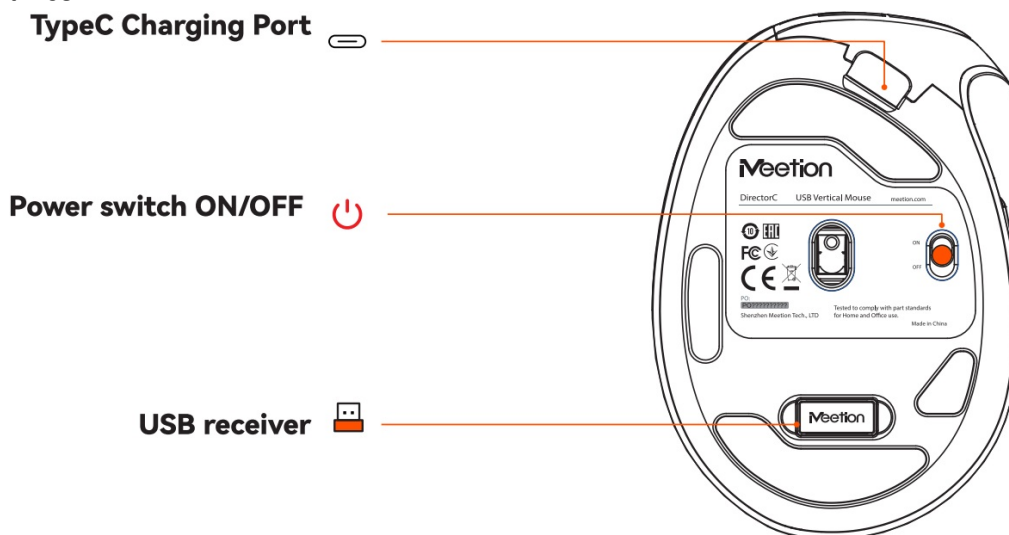

### TypeC Charging Port

It is recommended to use the included charging cable to charge your device

### Power switch ON/OFF

Toggle the switch up and down to switch the machine on and off

### USB receiver

Mouse 2.4G mode USB receiver

	<b>Red light is always on:</b> Key board is charging <b>Green light is always on:</b> The battery is full <b>Red blinking:</b> Keyboard is low battery		FN Lock		Home		Email		Music
	<b>Green light always on:</b> NUM keypad on <b>Green light off:</b> NUM keypad off		Previous		Play/Pause		Next		Copy
	<b>Green light always on:</b> Caps lock on <b>Green light off:</b> Caps lock off		Paste		Cut		Search		Back
	<b>Green light always on:</b> Scroll lock on <b>Green light off:</b> Scroll lock is switched off		Computer		IME Toggler		Task View		Lock screen
	<b>Green light always on:</b> FN Lock on <b>Tip:</b> FN lock will switch the function of F1-F12 buttons when it is opened.		Calculators		Projector		Open System Settings		

The keyboard will automatically homogenize the computer system. When connected to a computer, if the computer cannot automatically recognize the system, please manually switch the computer system from Switch the keyboard to macOS system. Switch the keyboard to Windows systems.

## Contents

- [1 Usage Guidelines](#)
- [2 Documents / Resources](#)
- [2.1 References](#)
- [3 Related Posts](#)

## Usage Guidelines

1. Insert the USB receiver into the USB port of your computer.

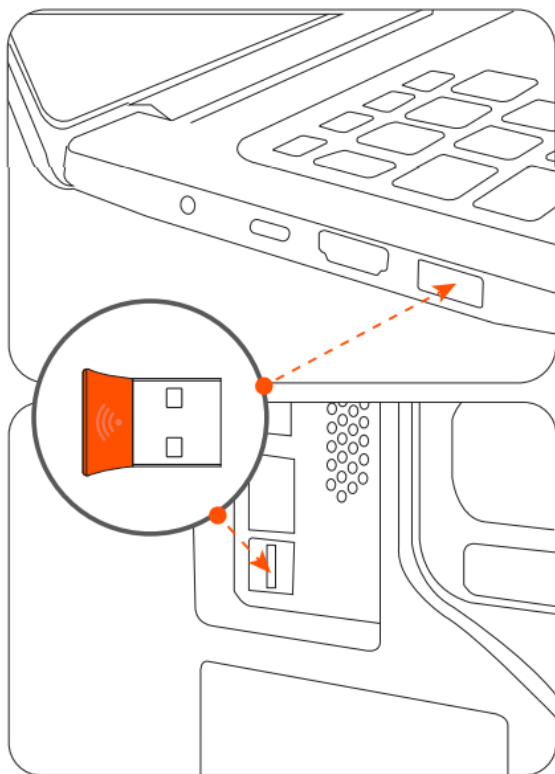

2. Toggle the switch to the right to the “ON” position to turn the unit on.

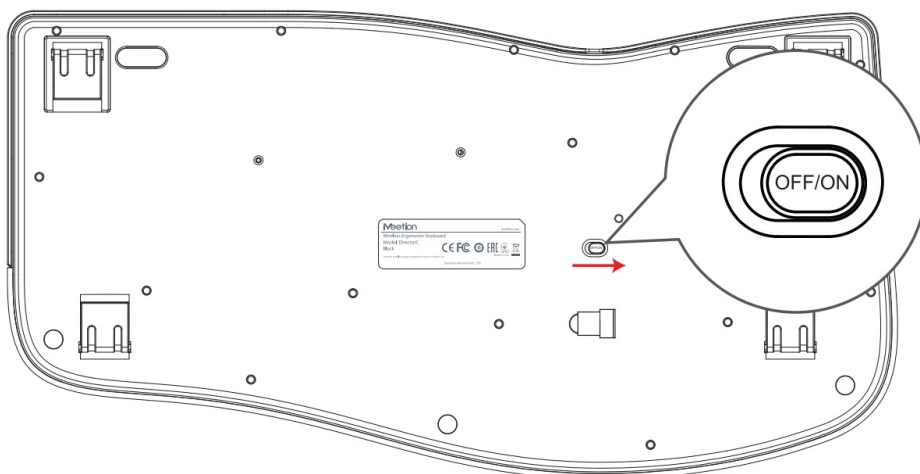

3. Toggle the switch upward to the “ON” position to turn the device on, get ready!

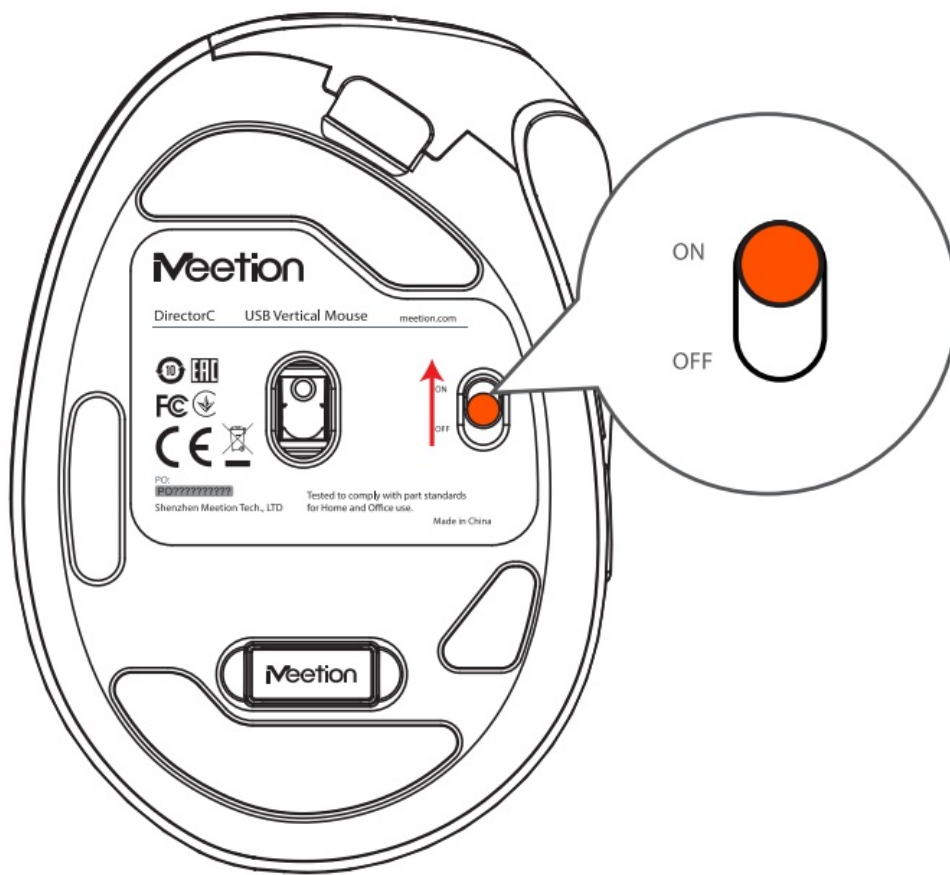

## GENERAL

AI MEETION brand products comply with US FCC standards (FCC ID:

2A706-MT062724/2A706-MT06272

5), EU CE standards/CAUK standards.

The product is made in accordance with RoHS standard.

## PRECAUTIONS

1. This product contains a rechargeable lithium battery.
2. Do not dismantle,strike,crush,or putitinto a fire.
3. Stop using it immediately if severe swelling occurs.
4. Do not place it in a high-temperature environment.
5. Do not use this device near water.
6. Only use a dry cloth to clean this product. 4.Please follow the manufacturer's instructions for use.
7. If the device is damaged,for example,if liquid enters it,if it gets wet in the rain or becomes damp,or if it cannot operate normally,it must be repaired.For repair matters,it should be entrusted to qualified maintenance personnel.

## KIND TIPS

If the product is not in use for a long time,it is recommended to charge it every three months to activate the lithium battery inside the product and prevent battery failure due to long periods of non-use.

## FCC Warning:

This equipment has been tested and found to comply with the limits for a Class B digital device, pursuant to part 15 of the FCC Rules. These limits are designed to provide reasonable protection against harmful interference in a residential installation. This equipment generates, uses and can radiate radio frequency energy and, if not installed and used in accordance with the instructions, maycause harmful interference to radio communications. However,

there is no guarantee that interference will not occur in a particular installation. If this equipment does cause harmful interference to radio or television reception, which can be determined by turning the equipment off and on, the user is encouraged to try to correct the interference by one or more of the following measures:

- Reorient or relocate the receiving antenna.
- Increase the separation between the equipment and receiver.
- Connect the equipment into an outlet on a circuit different from that to which the receiver is connected.
- Consult the dealer or an experienced radio/TV technician for help.

**Caution:** Any changes or modifications to this device not explicitly approved by manufacturer could void your authority to operate this equipment.

This device complies with part 15 of the FCC Rules. Operation is subject to the following two conditions:

(1) This device may not cause harmful interference, and (2) this device must accept any interference received, including interference that may cause undesired operation.

This equipment complies with FCC radiation exposure limits set forth for an uncontrolled environment. This equipment should be installed and operated with minimum distance 0cm between the radiator and your body.



Having technical problems with this product? Send an email to [service@meetion.com](mailto:service@meetion.com) For more information please visit: [www.meetion.com](http://www.meetion.com)

## Documents / Resources

	<a href="#">Meetion DirectorC Ergonomic Wireless Keyboard and Mouse</a> [pdf] User Manual MT062724, 2A7O6-MT062724, 2A7O6MT062724, DirectorC Ergonomic Wireless Keyboard and Mouse, DirectorC, Ergonomic Wireless Keyboard and Mouse, Wireless Keyboard and Mouse, Keyboard and Mouse
---	--

## References

- [User Manual](#)

### [Manuals+](#), [Privacy Policy](#)

This website is an independent publication and is neither affiliated with nor endorsed by any of the trademark owners. The "Bluetooth®" word mark and logos are registered trademarks owned by Bluetooth SIG, Inc. The "Wi-Fi®" word mark and logos are registered trademarks owned by the Wi-Fi Alliance. Any use of these marks on this website does not imply any affiliation with or endorsement.