



Meetion B0CGYXNYZZ Ergonomic Computer Bluetooth Wireless Keyboard and Mouse User Guide

[Home](#) » [MEETION](#) » Meetion B0CGYXNYZZ Ergonomic Computer Bluetooth Wireless Keyboard and Mouse User Guide 



Contents

- 1 **FN+MULTIMEDIA FUNCTION KEYS**
- 2 **4G CONNECTION(MOUSE)**
- 3 **4G CONNECTION(KEYBOARD)**
- 4 **GENERAL**
- 5 **PRECAUTIONS**
- 6 **WARRANTY CARD**
- 7 **Documents / Resources**
 - 7.1 **References**

FN+MULTIMEDIA FUNCTION KEYS

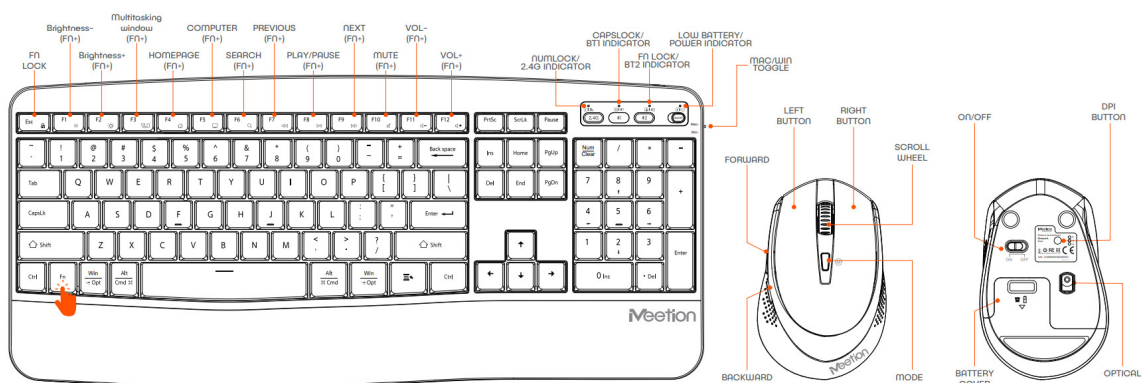

4G CONNECTION(MOUSE)

1. Open the battery compartment cover on the bottom of the mouse and insert an AA battery

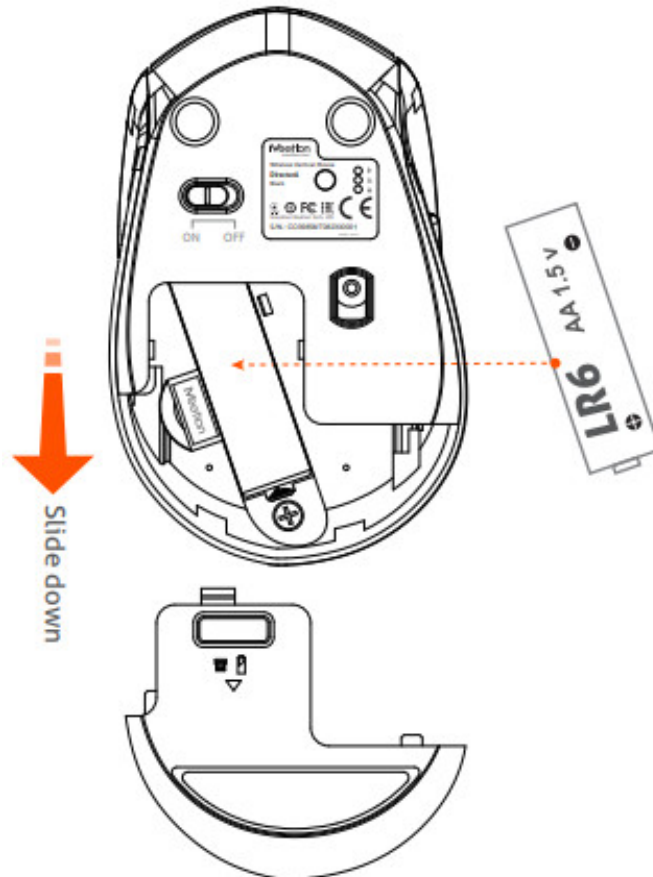

2. Turn on the mouse power switch

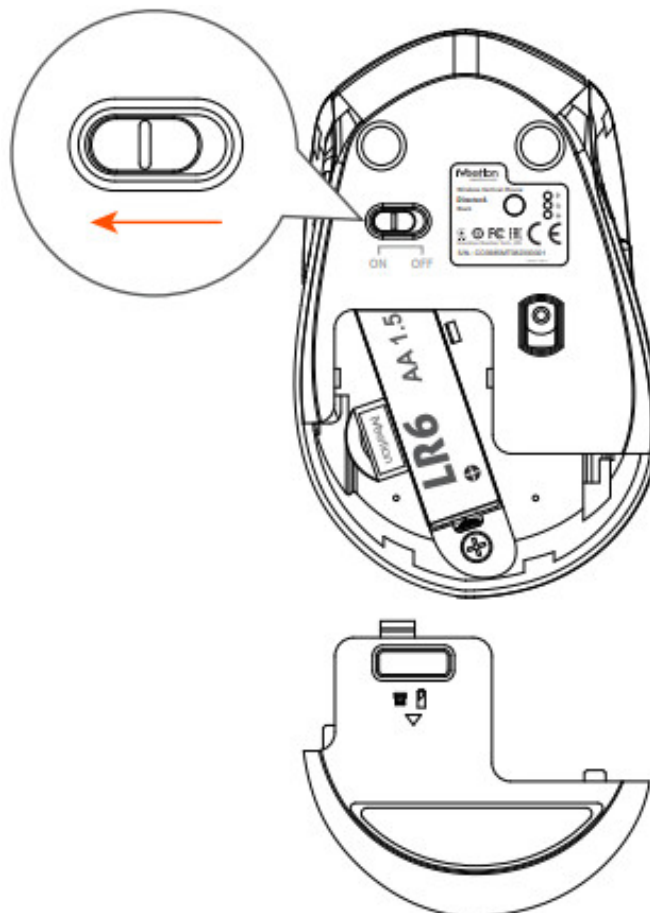

3. Remove the USB receiver at the bottom of the mouse and close the battery compartment cover

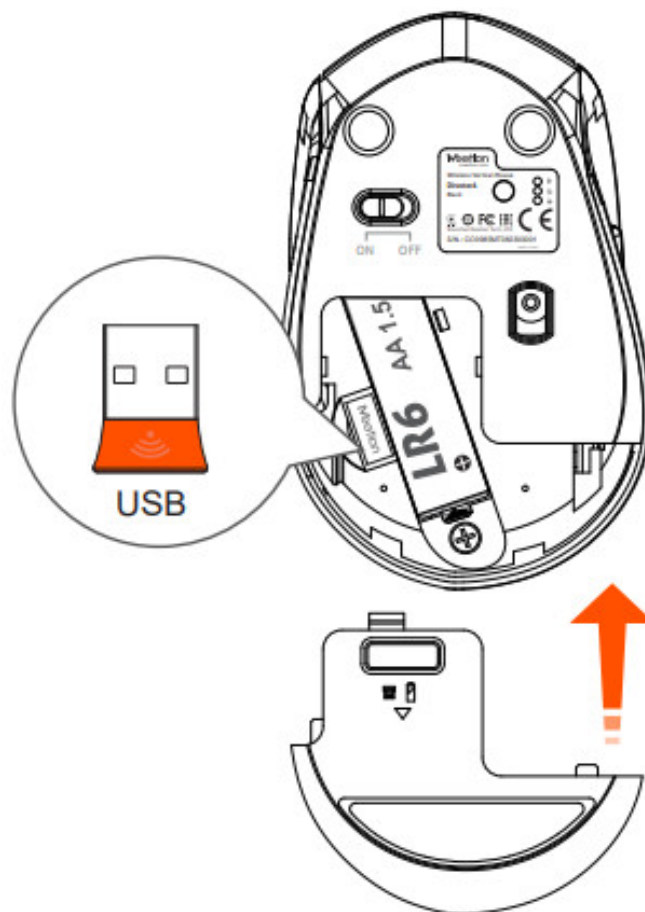

4. Press the mode switch button to switch to 2.4G mode, and the light is green

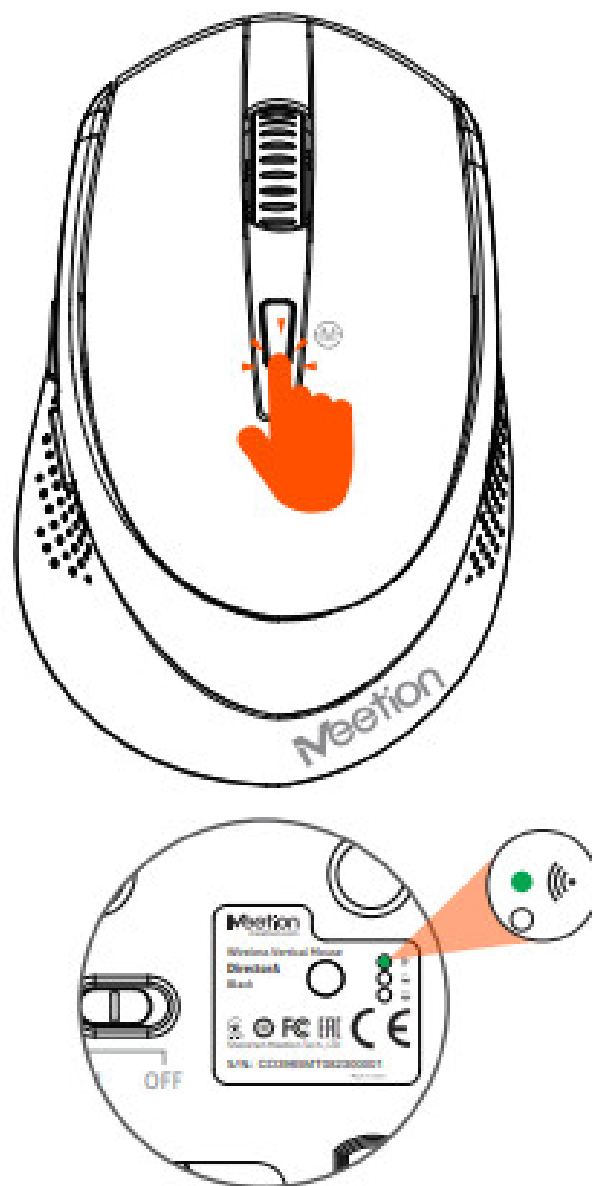

5. Insert computer USB interface

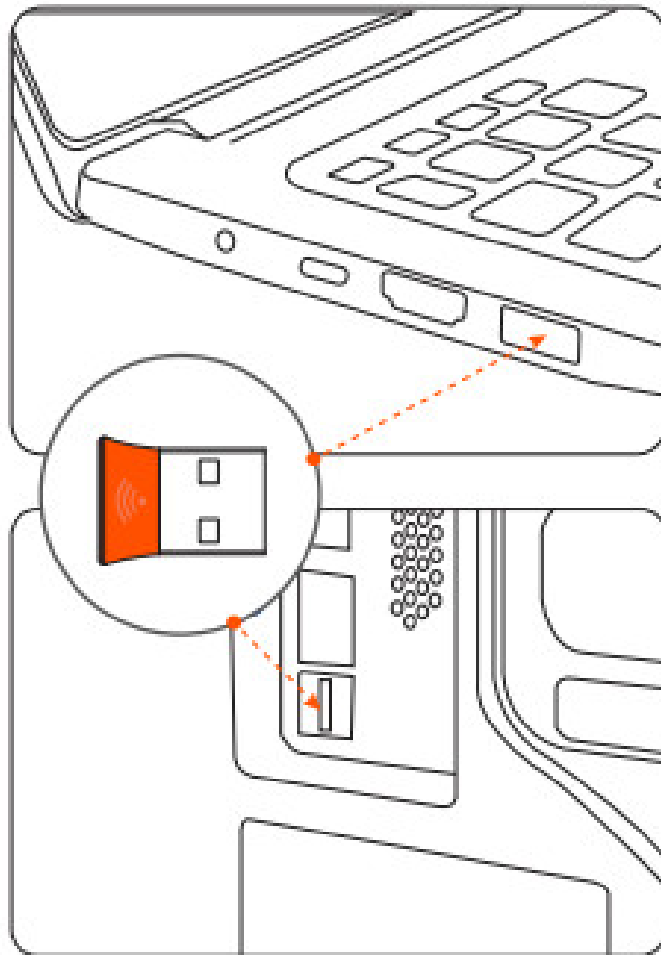

(When the product is used for the first time, an automatic hardware installation prompt will pop up in the lower right corner of the computer)

4G CONNECTION(KEYBOARD)

1. Open the battery case cover on the bottom of the keyboard and insert 2 AAA batteries

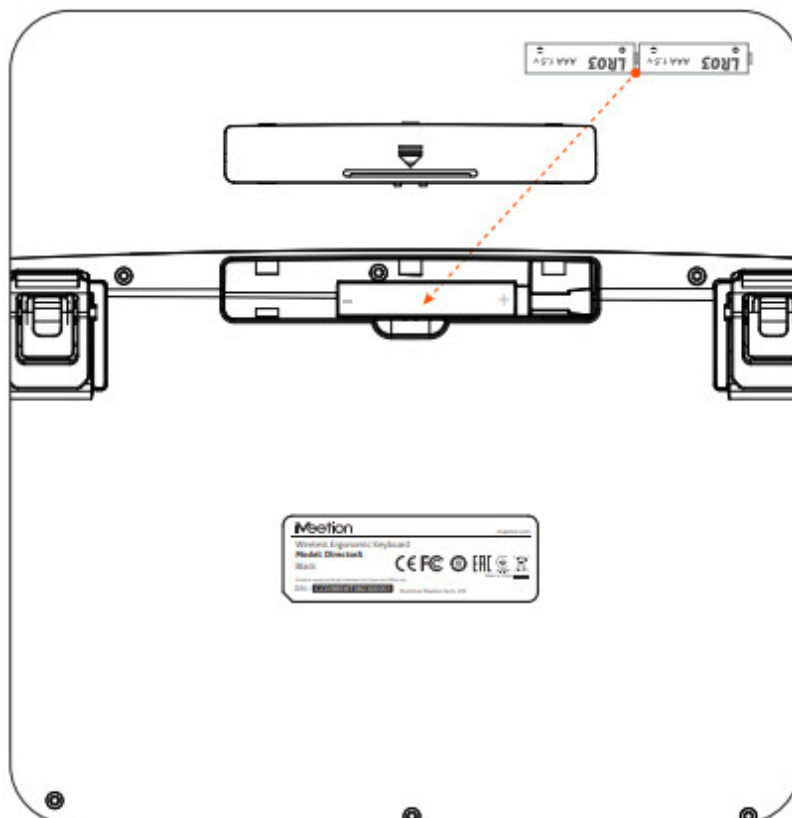

2. Turn on the keyboard power switch

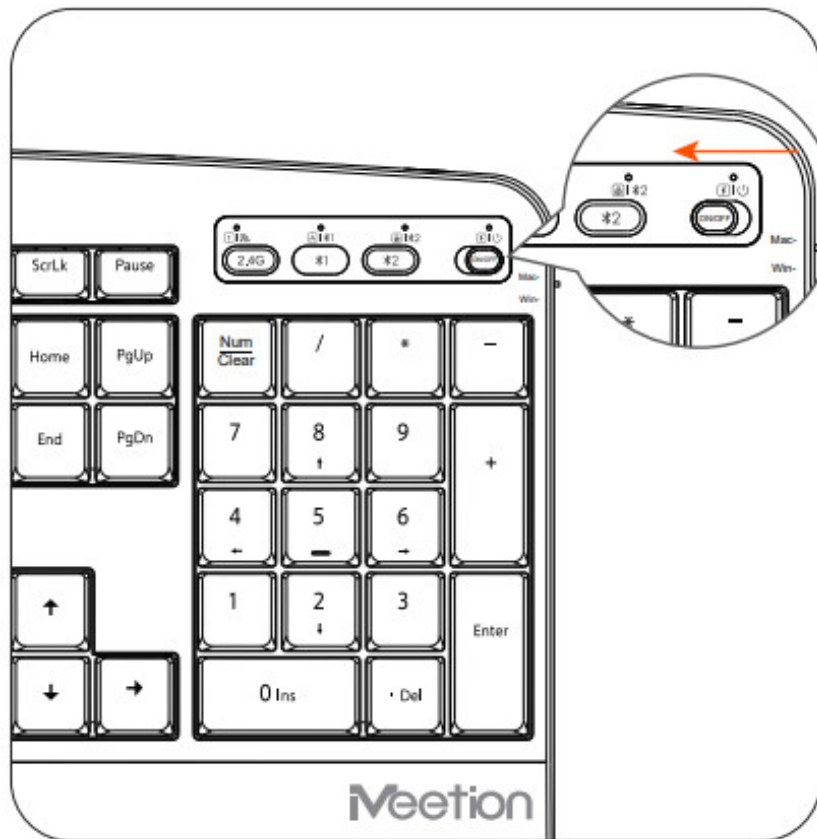

3. Tap here to enter 2.4G mode

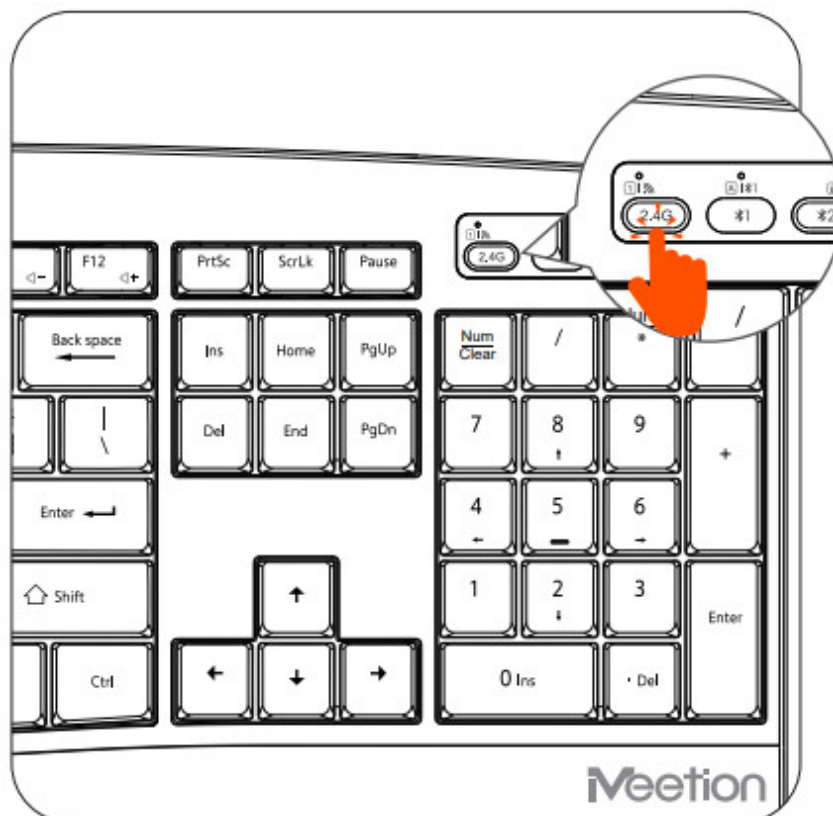

BLUETOOTH CONNECTION(MOUSE) ❶

1. Open the battery compartment cover on the bottom of the mouse and insert an AA battery

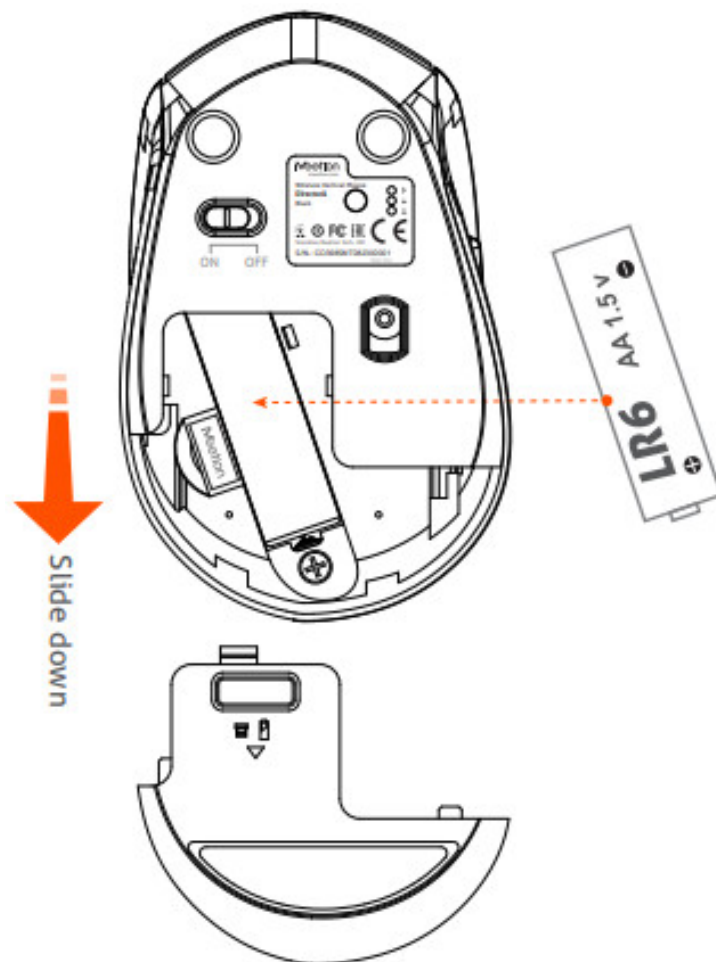

2. Turn on the mouse power switch, and close the battery case cover

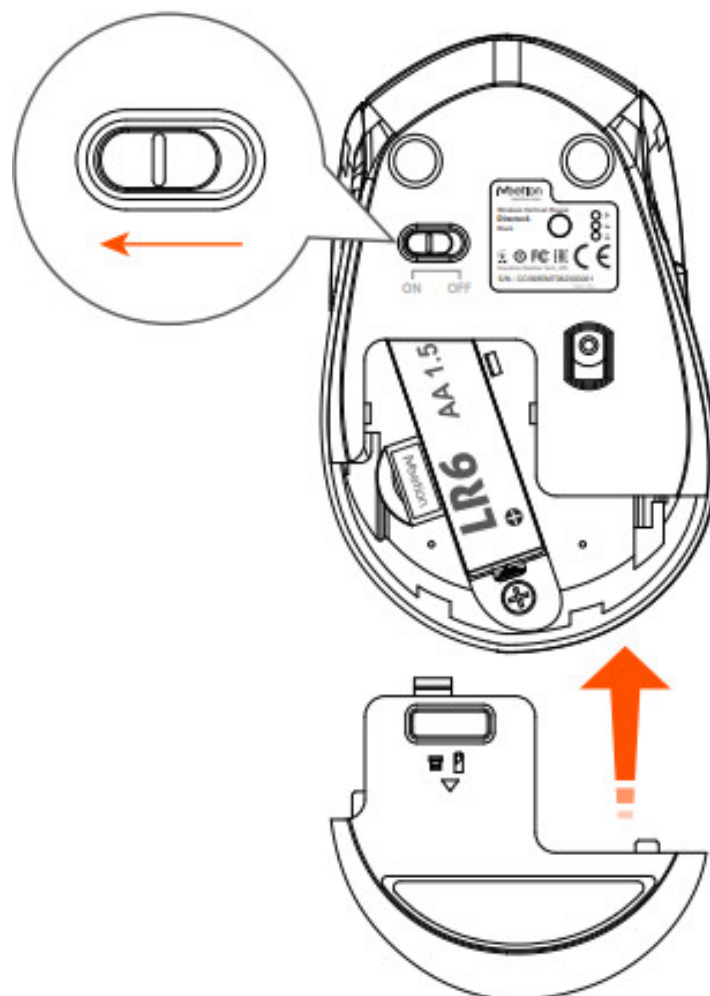

3. Short press the mode switch button, switch to Bluetooth 1, then the blue light flashes you can perform code

matching

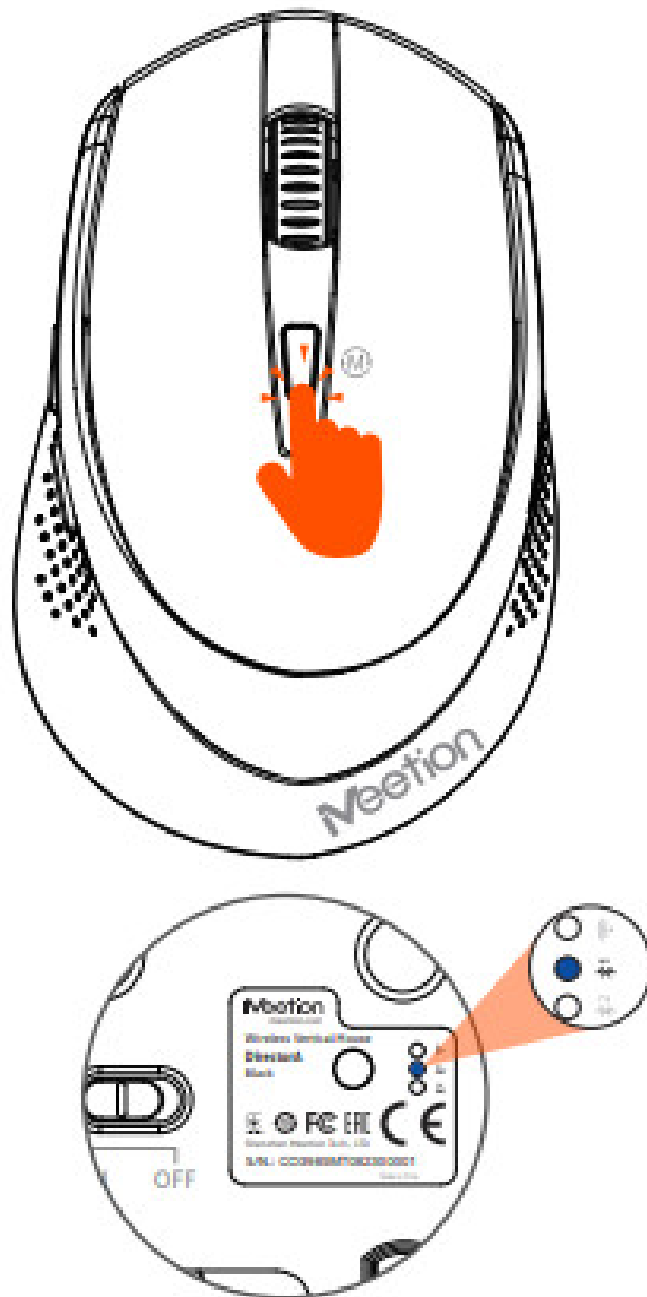

4. Turn on the computer Bluetooth switch to enter the Bluetooth settings page

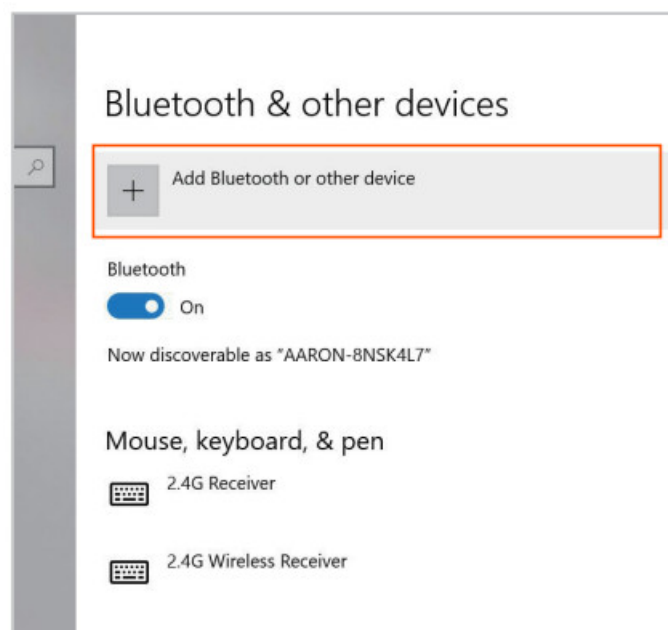

Click to add Bluetooth or other devices, click to add Bluetooth mouse, keyboard, and other devices

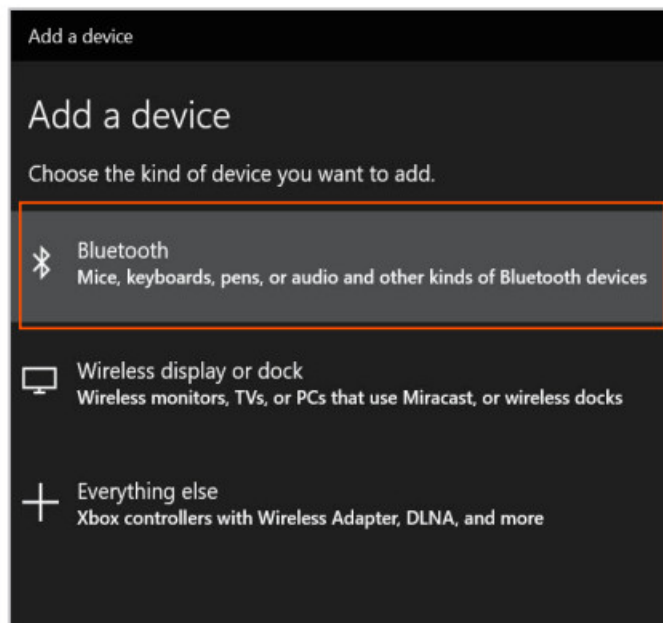

5. Find the device named Meetion_MS_BT1 and click on Add Pairing

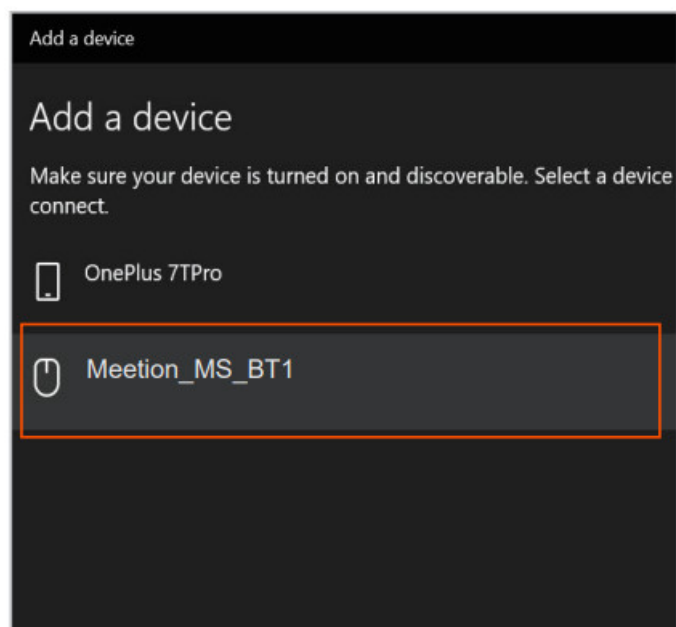

Paired successfully

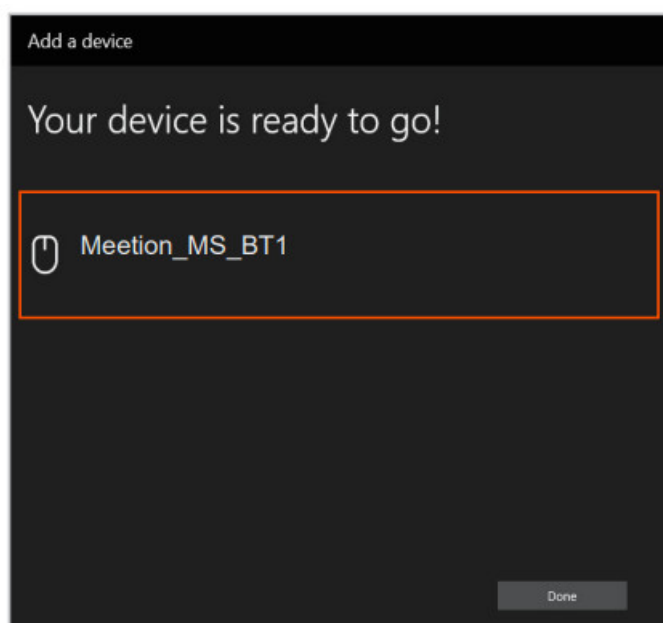

BLUETOOTH CONNECTION(MOUSE) ✂ 2

1. Open the battery compartment cover on the bottom of the mouse and insert an AA battery

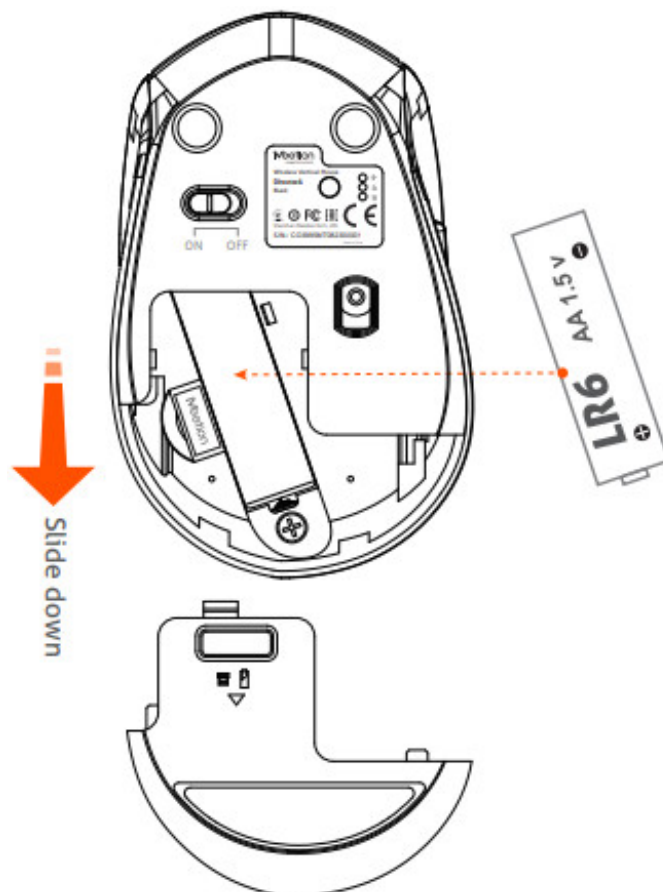

2. Turn on the mouse power switch, and close the battery case cover

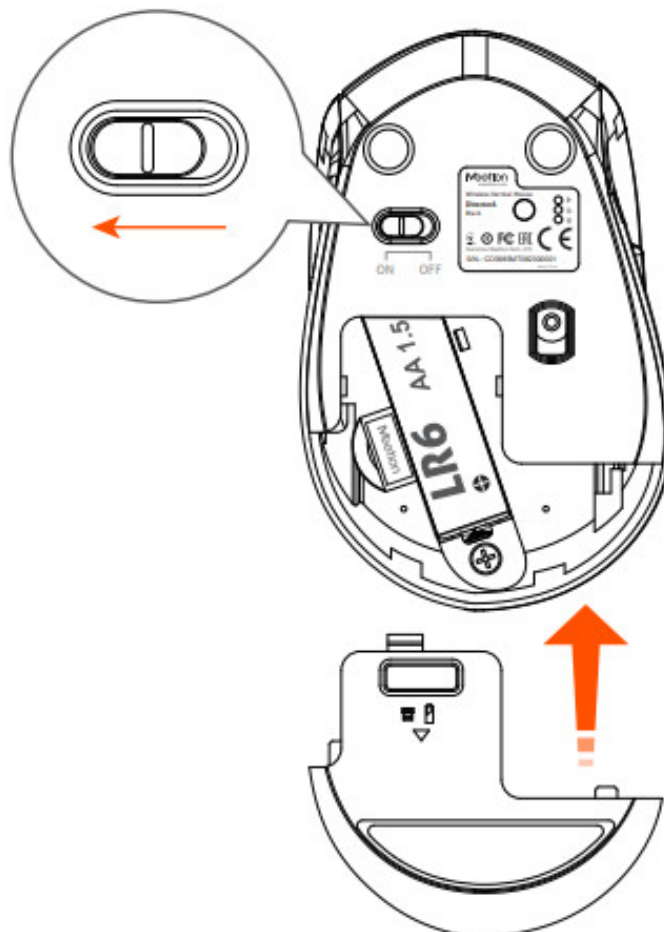

3. Short press the mode switch button, switch to Bluetooth 2, then the blue light flashes you can perform code

matching

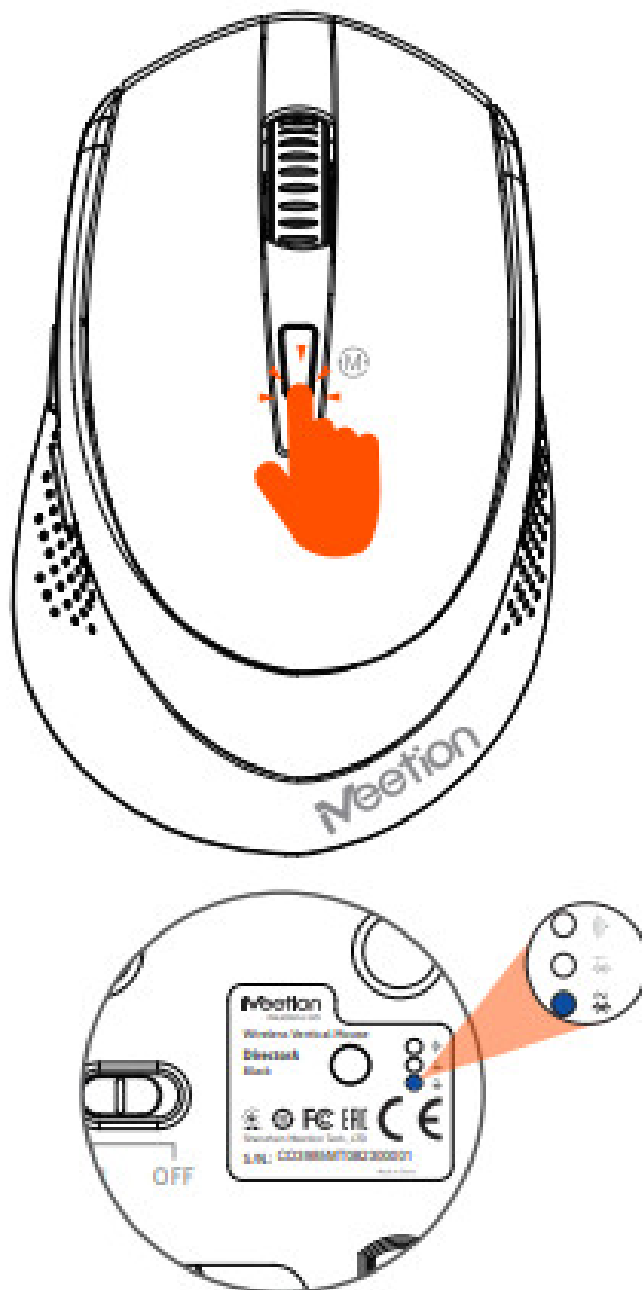

4. Turn on the computer Bluetooth switch to enter the Bluetooth settings page

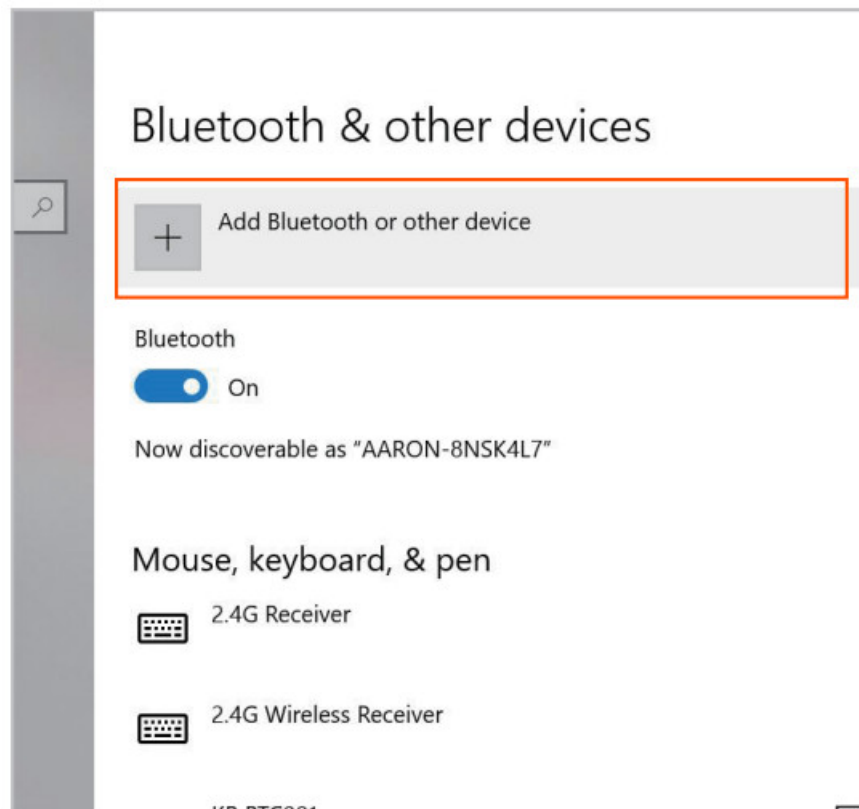

Click to add Bluetooth or other devices, click to add Bluetooth mouse, keyboard, and other devices

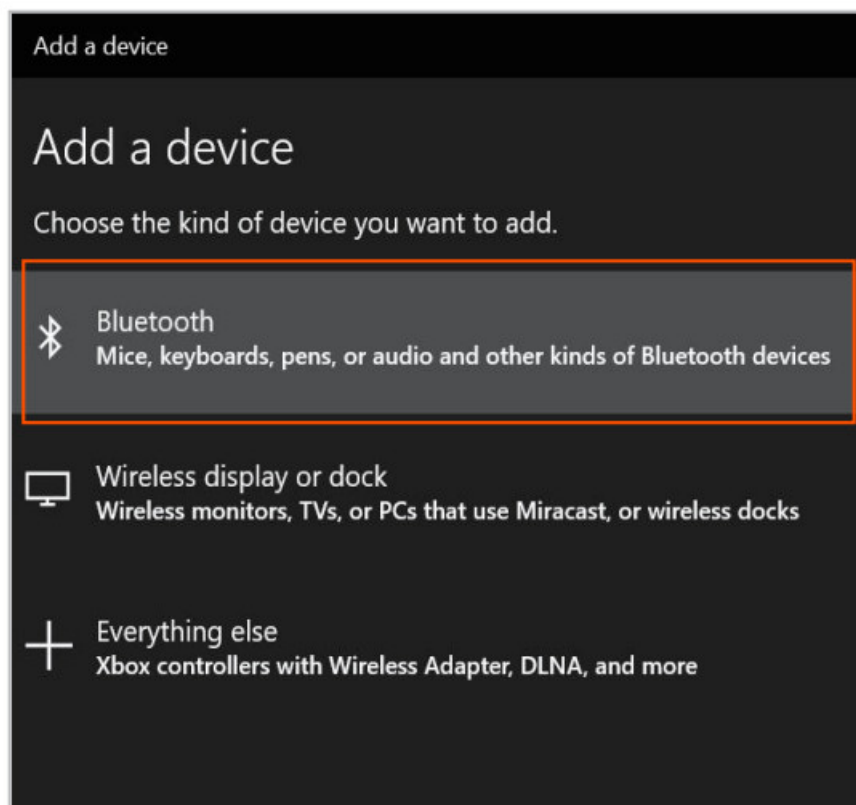

5. Find the device named Meetion_MS_BT2 and click on Add Pairing

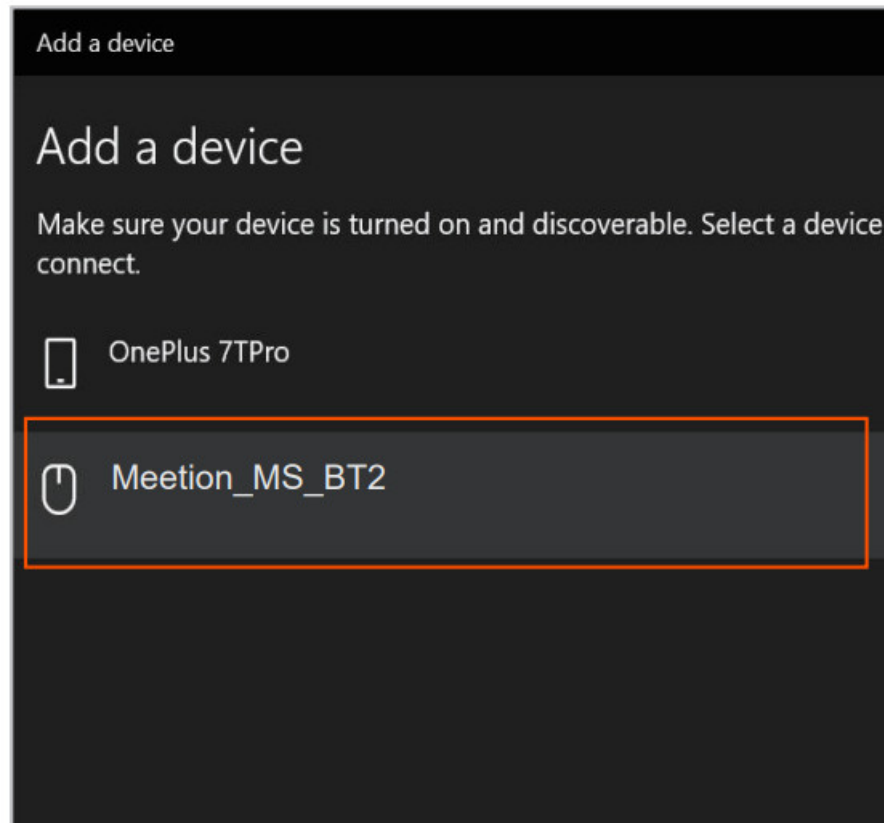

Paired successfully

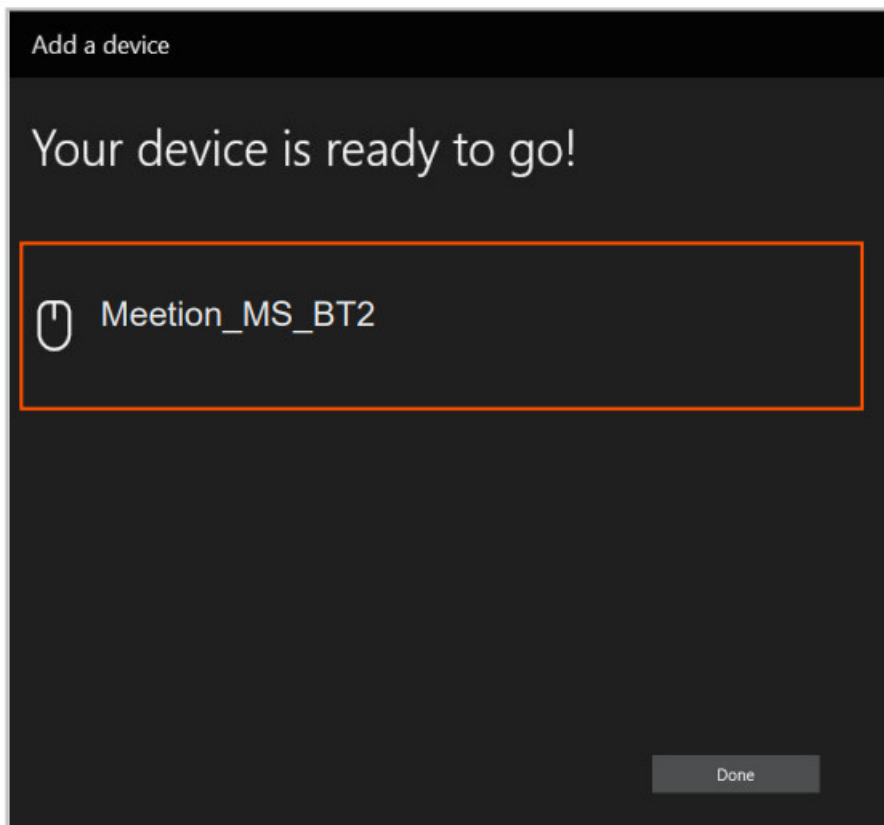

BLUETOOTH CONNECTION(KEYBOARD) ✧ 1

1. Turn on the keyboard power switch

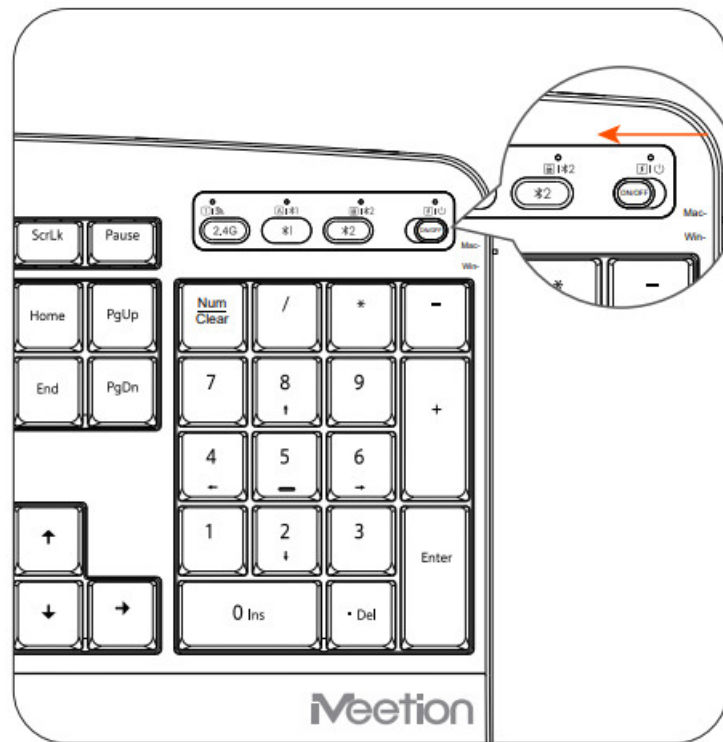

2. Click here to enter Bluetooth 1 mode pairing, blue light flashing

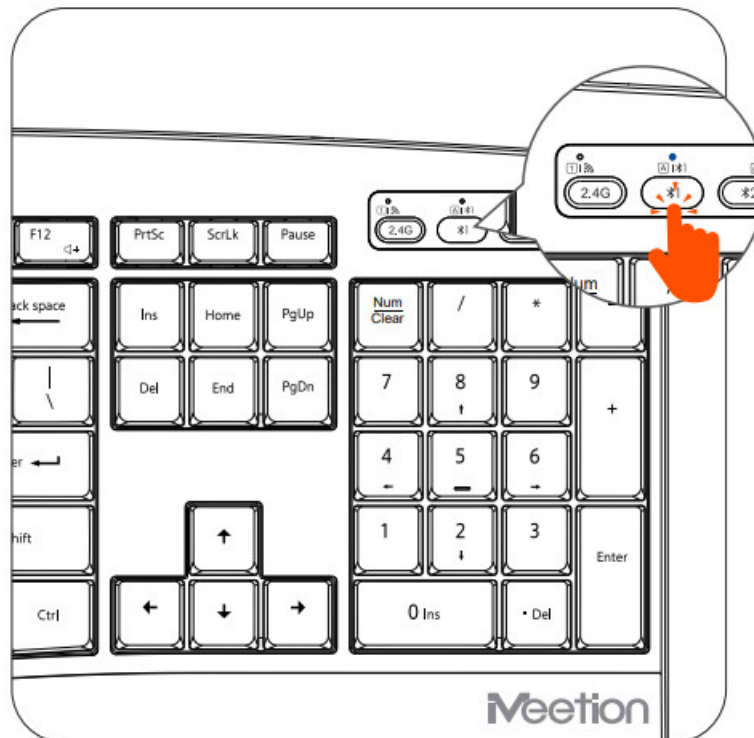

3. Turn on the computer Bluetooth switch to enter the Bluetooth settings page

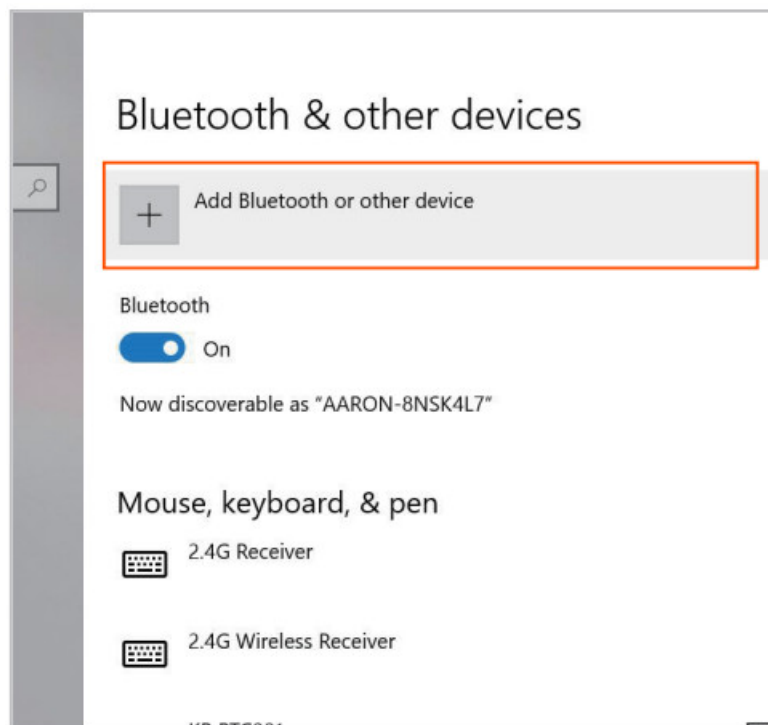

Click to add Bluetooth or other devices, click to add Bluetooth mouse, keyboard, and other devices

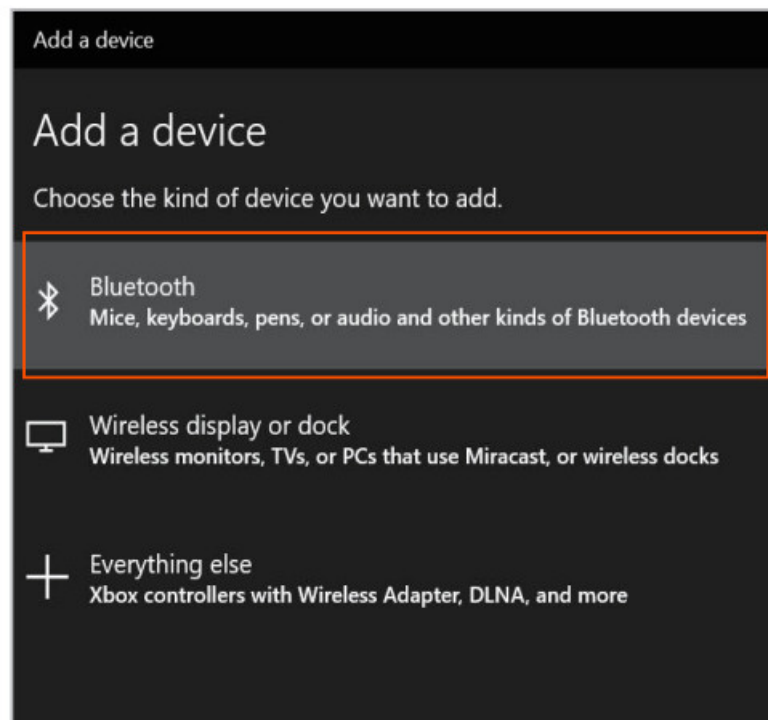

4. Find the device named Meetion_KB_BT1 and click on Add Pairing Android Connection

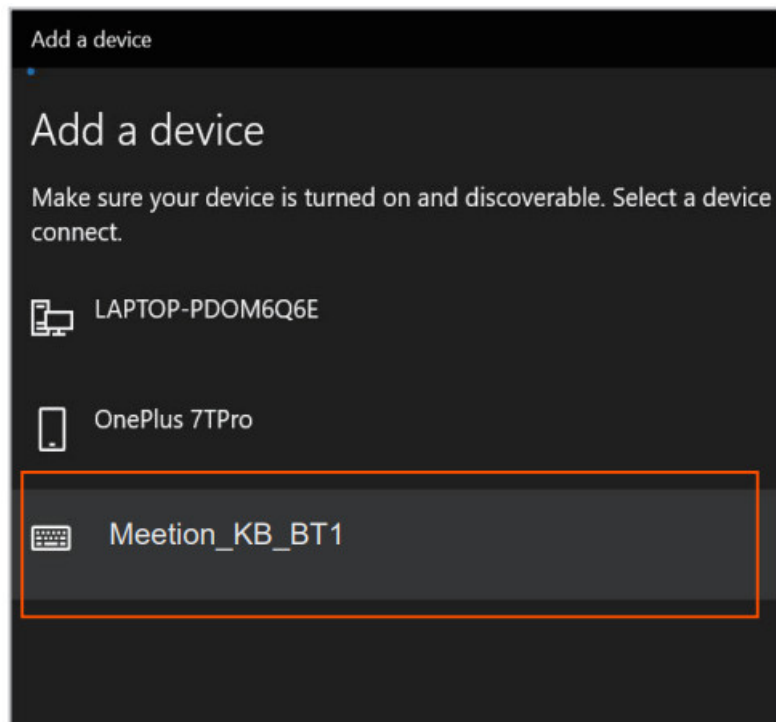

Paired successfully

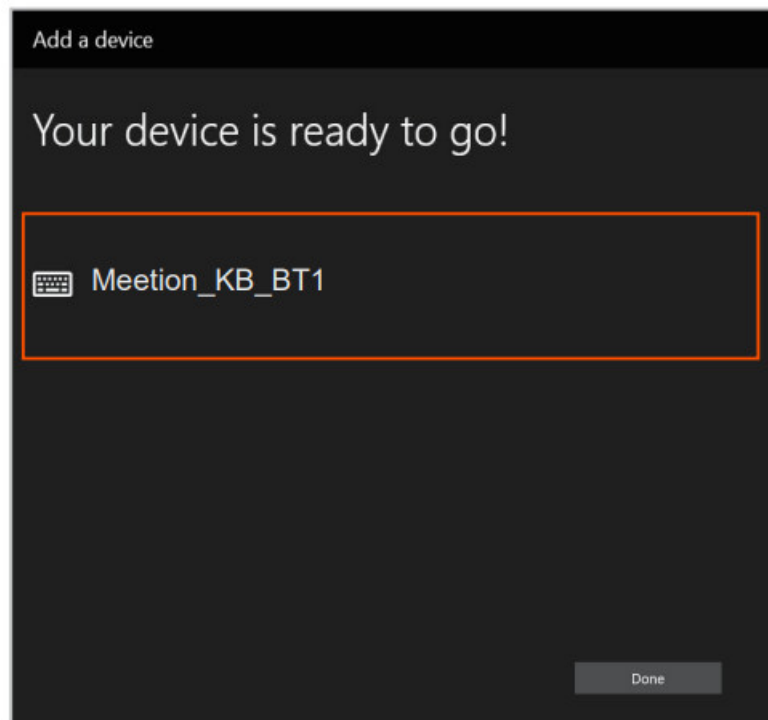

BLUETOOTH CONNECTION(KEYBOARD) 2

1. Turn on the keyboard power switch

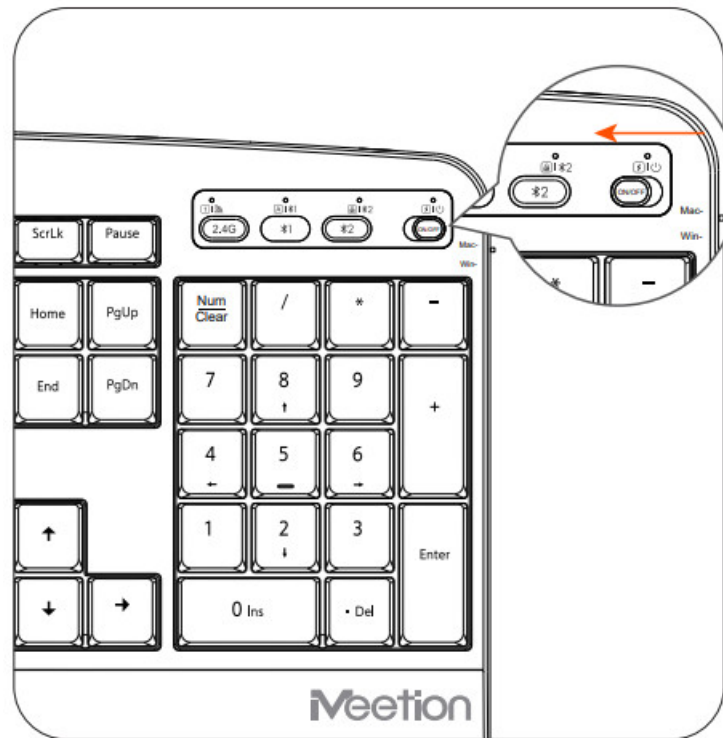

2. Click here to enter Bluetooth 2 mode pairing, blue light flashing

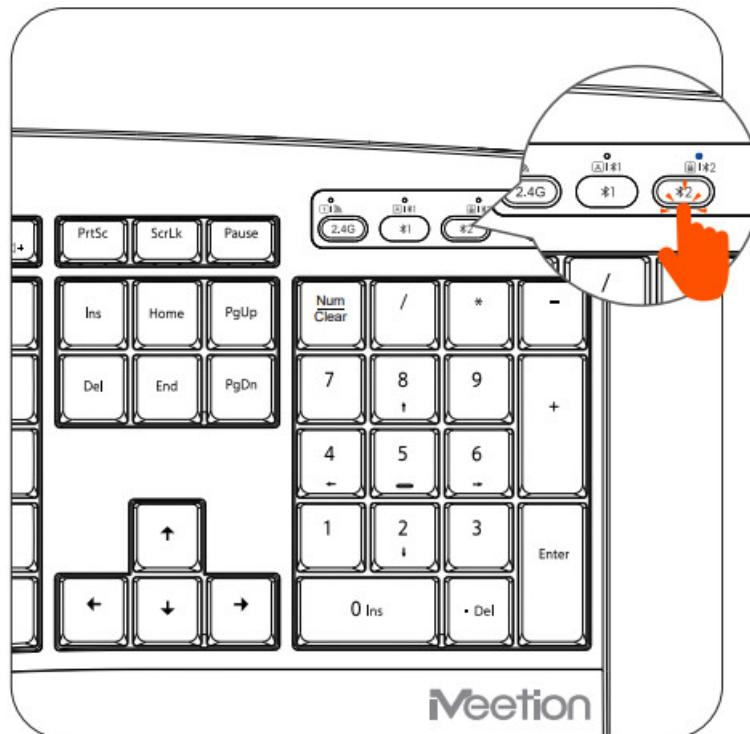

3. Turn on the computer Bluetooth switch to enter the Bluetooth settings page

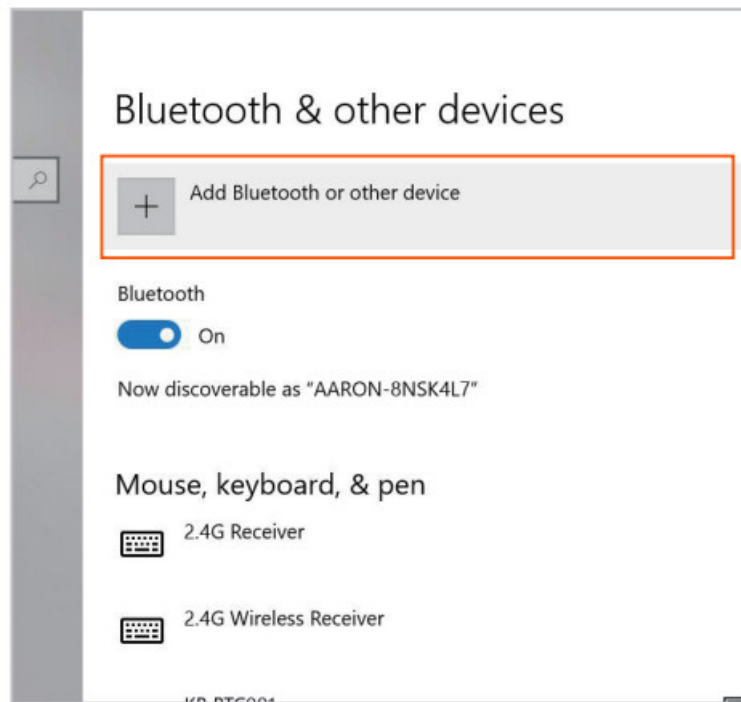

Click to add Bluetooth or other devices, click to add Bluetooth mouse, keyboard, and other devices

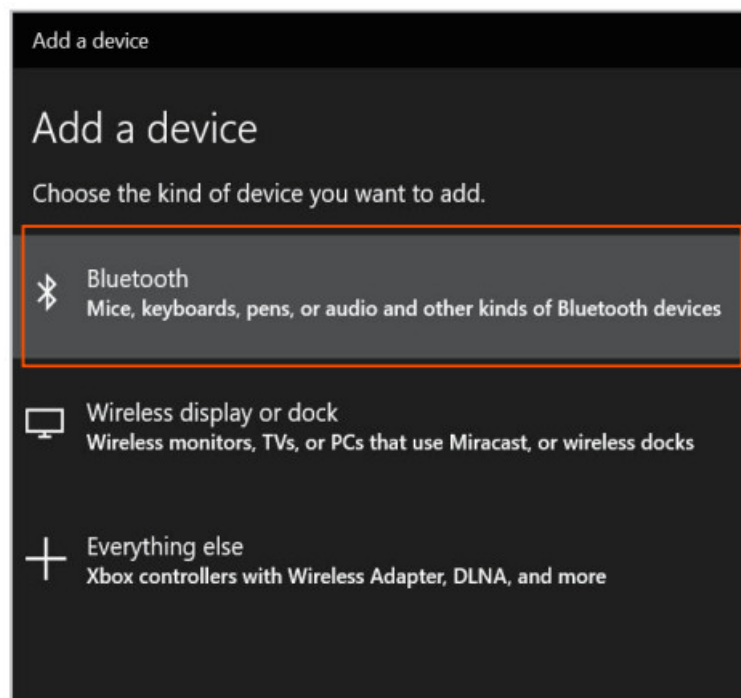

4. Find the device named Meetion_KB_BT2 and click on Add Pairing

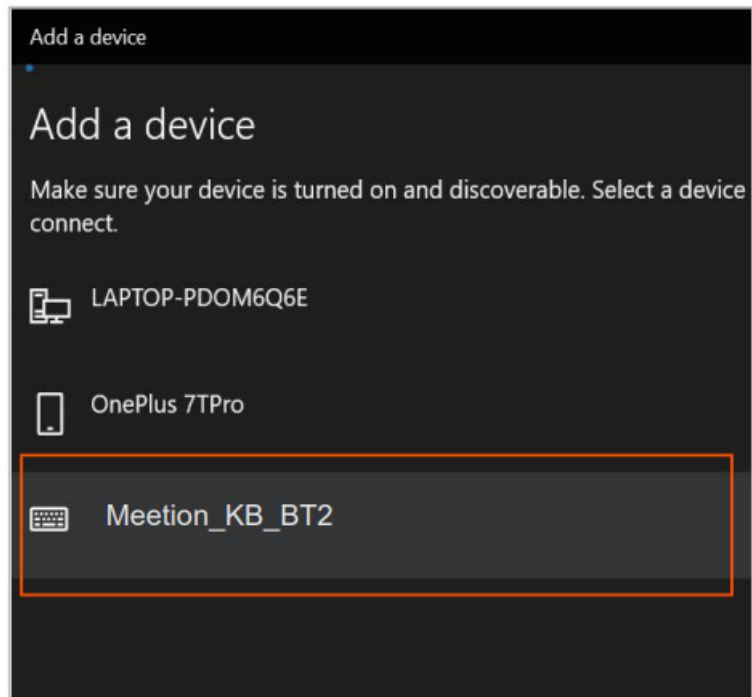

Paired successfully

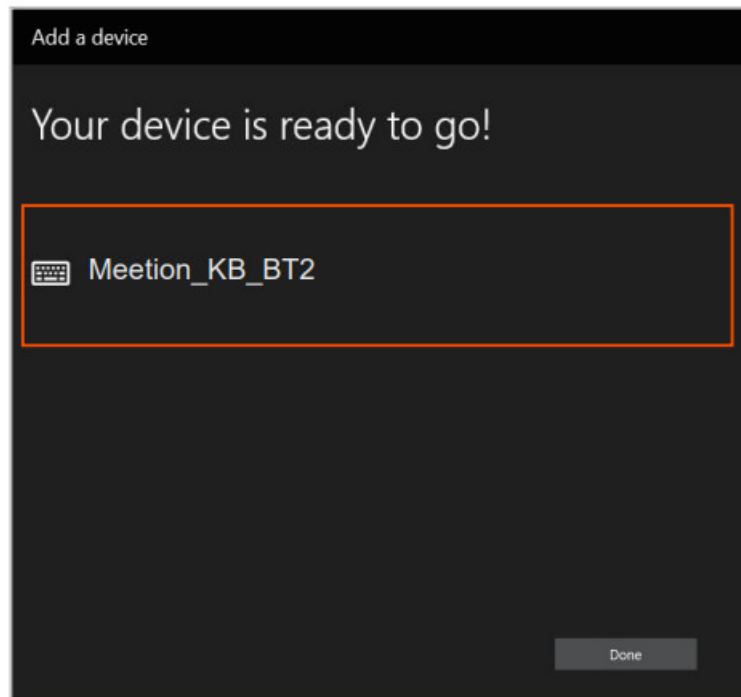

DPI ADJUSTMENT (MOUSE)

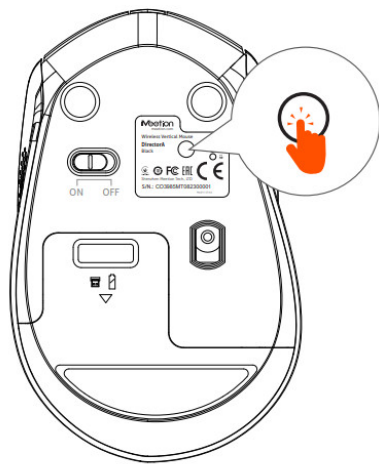

Press the DPI button once, 800 DPI (slow cursor movement)

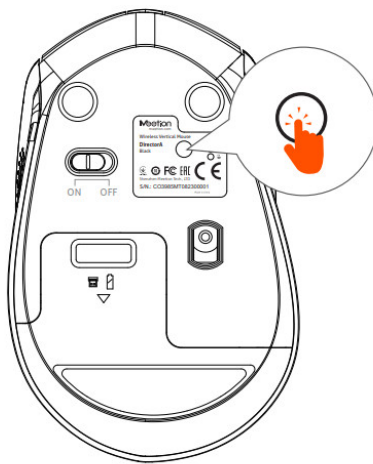

Press the DPI button again, 1200 DPI (cursor moves moderately)

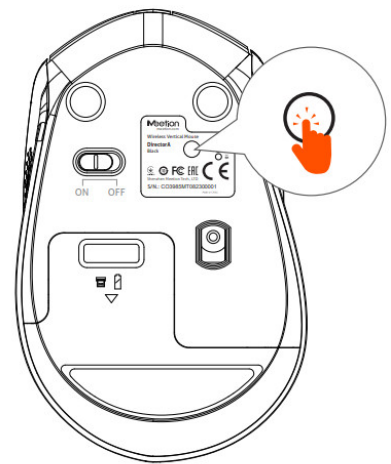

Press the DPI button again for 1600 DPI (faster cursor movement)

GENERAL

All products under the MEETION brand comply with the US FCC standards with FCC ID: 2A706.
The product is made in accordance with RoHS standard.

PRECAUTIONS

1. This product contains a 1*AAA battery 2*AA battery.
 - (1) Do not dismantle, strike, crush, or put it into a fire.
 - (2) Stop using it immediately if severe swelling occurs.
 - (3) Do not place it in a high-temperature environment.
2. Do not use this device near water.
3. Only use a dry cloth to clean this product.
4. Please follow the manufacturer's instructions for use.
5. If the device is damaged, for example, if liquid enters it, if it gets wet in the rain or becomes damp, or if it cannot operate normally, it must be repaired. For repair matters, it should be entrusted to qualified maintenance personnel.

KIND TIPS

If the product will not be used for a long period of time, it is recommended to turn off the power switch of the keyboard and mouse, and to remove the batteries to prevent them from failing due to prolonged non-use.

WARRANTY CARD

Model No.	
Date of Sale	
Seller	
Serial Number	
Address of the Seller	
Phone of the Seller	
Seller Signature & Stamp	Stamp

To be Filled in by Service Center		
Date of Receipt	Date of Receipt	Date of Receipt
Date of Return	Date of Return	Date of Return
Special Marks	Special Marks	Special Marks



Having technical problems with this product?

Send an email to service@meetion.com

For more information please visit: www.meetion.com

Documents / Resources

	<p>Meetion B0CGYXNYZZ Ergonomic Computer Bluetooth Wireless Keyboard and Mouse [pdf] User Guide</p> <p>B0CGYXNYZZ Ergonomic Computer Bluetooth Wireless Keyboard and Mouse, B0CGYXNYZZ, Ergonomic Computer Bluetooth Wireless Keyboard and Mouse, Computer Bluetooth Wireless Keyboard and Mouse, Bluetooth, Wireless Keyboard and Mouse, Keyboard and Mouse</p>
--	--

References

-  [Meetion | The Perfect Gaming Accessories Supplier For Gaming Mouse, Office Mouse, And Sports Gear](#)
- [User Manual](#)