



Medtronic MiniMed Reservoir 3.0ml User Guide

[Home](#) » [Medtronic](#) » Medtronic MiniMed Reservoir 3.0ml User Guide



Medtronic

Mini Med® Reservoir
Reservoir



Contents [[hide](#)

[1 Indications for Use](#)

[2 Contraindications](#)

[3 Warnings](#)

[4 Precautions](#)

[5 Warranty](#)

[6 Documents / Resources](#)

[6.1 References](#)

[7 Related Posts](#)

Indications for Use

This reservoir is indicated for the subcutaneous infusion of medication, including insulin, from compatible Medtronic insulin pumps and infusion sets.

Refer to your Medtronic insulin pump user guide for compatibility.

Contraindications

This reservoir is contraindicated for the infusion of blood or blood products.

Warnings

Reservoir and transfer guard are sterile, nonpyrogenic, and for single use only.

Do not clean or resterilize. Reuse of the reservoir may lead to any one of the following: insulin degradation, infection, inaccurate medication delivery, or leaks which may cause damage to the pump.

Do not use if package has been opened or damaged.

Dispose of transfer guard safely in sharps container.

Failure to remove trapped air from reservoir may result in inaccurate delivery of medication.

If insulin, or any liquid, gets inside the tubing connector, it can temporarily block the vents that allow the pump to properly fill the infusion set. This may result in the delivery of too little or too much insulin, which can cause hyperglycemia or hypoglycemia. If this occurs, start over with a new reservoir and infusion set.

Precautions

Insulin should be at room temperature before filling reservoir.

Once reservoir is filled, use promptly. Do not store.

Check for leaks after changing the reservoir and infusion set.









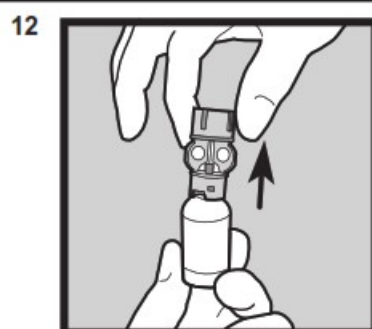
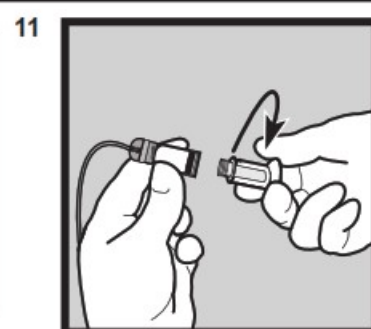
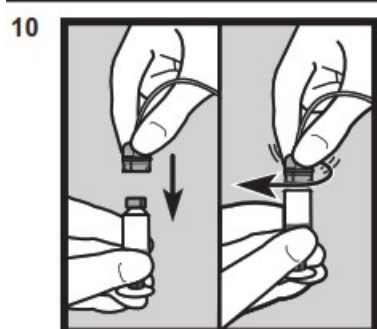
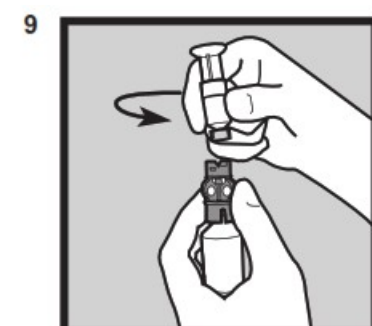
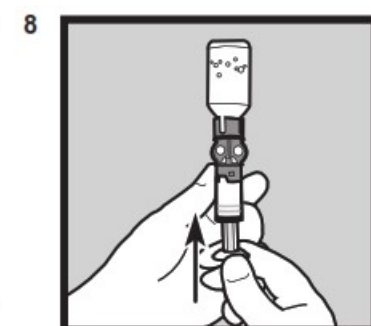
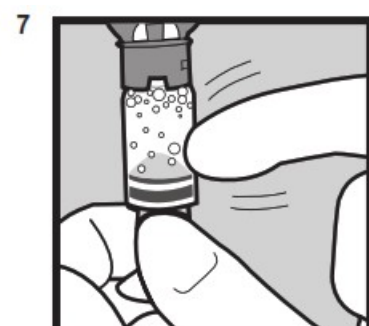
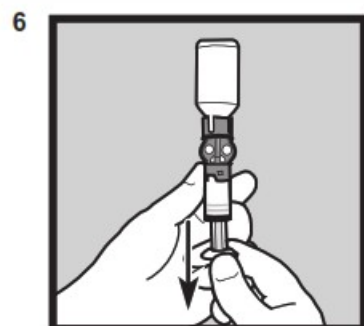
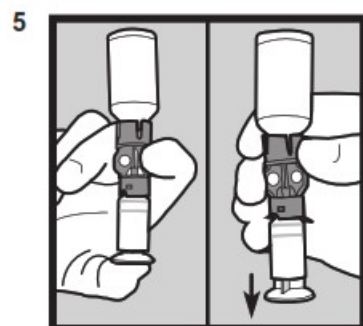
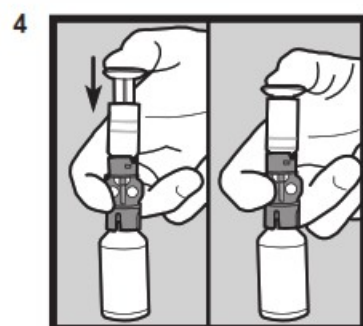
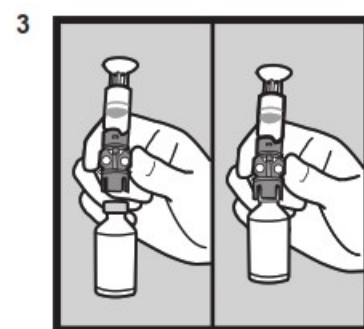
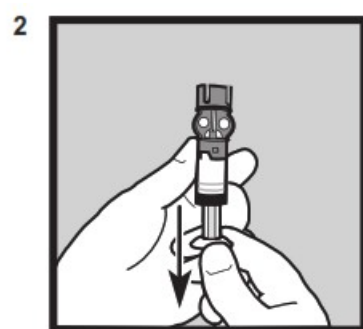
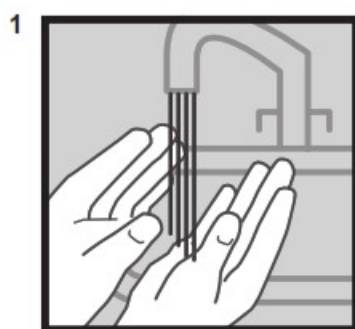

Conduct your first setup in the presence of your healthcare professional.

Warranty

Visit <http://www.medtronicdiabetes.com/warranty>.

Refer to pump and infusion set user guides for installation and filling.



	Use by date
	Open here
	Do not reuse
	Batch code
	Caution
	Sterilized with Ethylene Oxide
	Catalogue Model Number
	Replace every three days
	Nonpyrogenic
	Does not contain Latex
	Consult instructions for use



Medtronic Mini Med
18000 Devonshire Street Northridge, CA 91325 USA
800 646 4633
818 576 5555
www.medtronicdiabetes.com

D9195886-2AF2_a
RX Only



(01)00643169591714(10)NA

©2015 Medtronic Mini Med, Inc. All rights reserved.
Mini Med® is a registered trademark of Medtronic Mini Med, Inc.

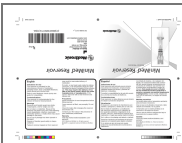

[Medtronic MiniMed Reservoir 3.0ml](#) [pdf] User Guide
MiniMed Reservoir 3.0ml, MiniMed, Reservoir 3.0ml

References

- [M Medtronic: Diabetes Products And Therapy Options](#)