



MEARI WF-A211L Smart Camera User Manual

[Home](#) » [MEARI](#) » MEARI WF-A211L Smart Camera User Manual 



MEARI

G02T(Q)

QUICK GUIDE

WiFi Outdoor P/T Battery Wireless Camera

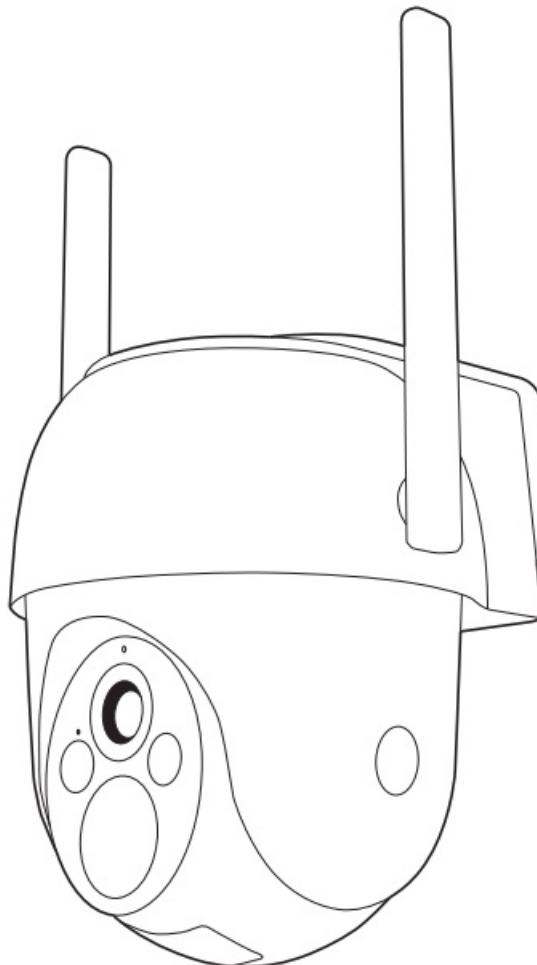

support@arenti.com

Contents

- 1 Quick start guide
- 2 Packing list
- 3 Product description
- 4 Installation
- 5 Product configuration
- 6 Pairing
- 7 Specification
- 8 Legal notice
- 9 Documents / Resources
 - 9.1 References

Quick start guide

1. Packing list
2. Product description
3. Installation
4. Product configuration
5. Specification
6. Legal notice

Packing list



Camera X1



Bracket X1



Power adaptor X1



Screw package X1



Power cable X1



Quick guide X1

Product description

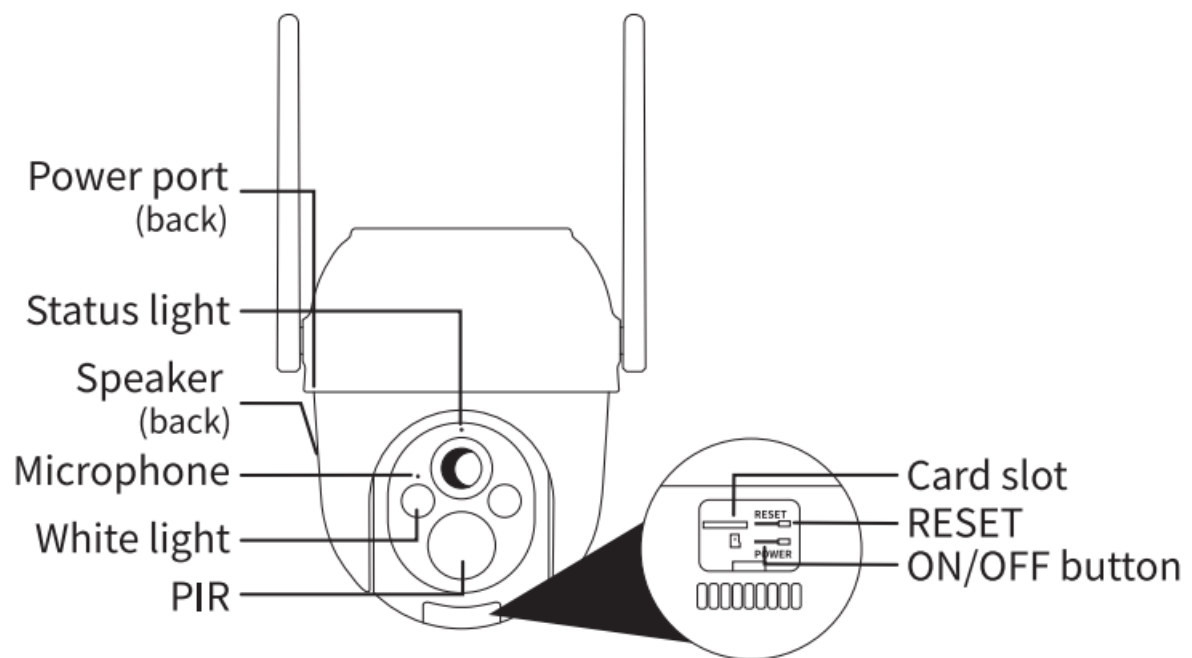

Flashing red light (slow)	Wait for network config
Flashing red light (fast)	Connecting the network
Fixed red light	Camera is malfunctional
Fixed blue light	Camera is working correctly

Installation

Wall Mounting

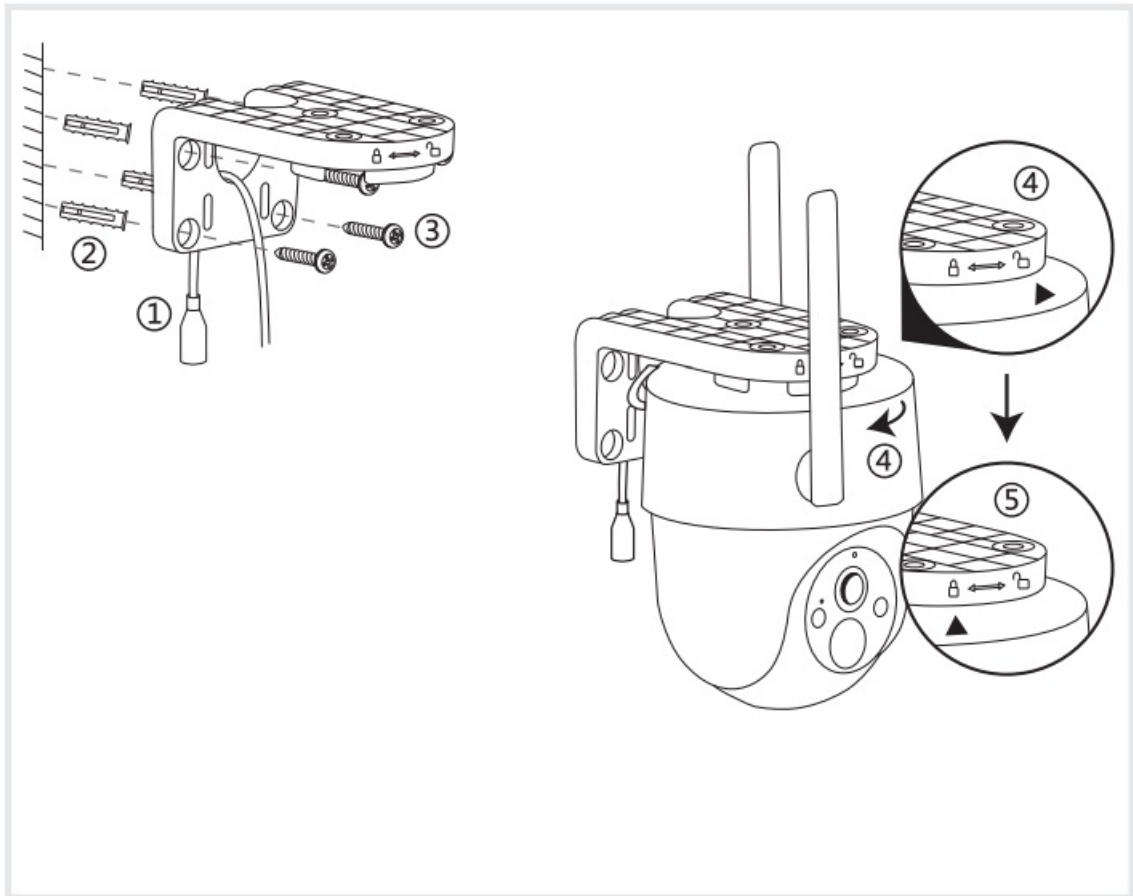

1. Take camera power cable through the bracket.
2. 2/3. Install expansion screws and mounting screws.
3. Insert the camera into the bracket and point the camera black arrow at the bracket Un lock logo.
4. Rotate the camera until it snaps into the bracket with the black arrow pointing at the Lock logo.

Cell Mounting

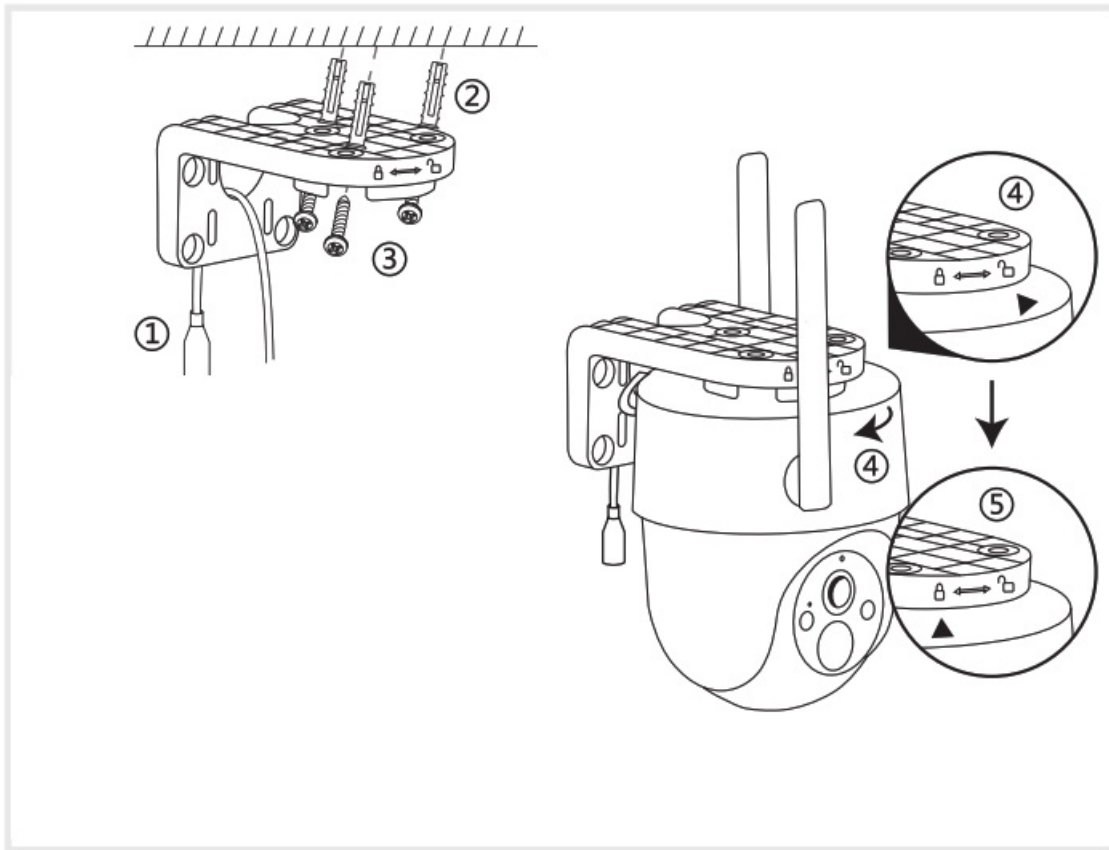

1. Take camera power cable through the bracket.
2. 2/3. Install expansion screws and mounting screws.
3. Insert the camera into the bracket and point the camera black arrow at the bracket Unlock logo.
4. Rotate the camera until it snaps into the bracket with the black arrow pointing at the Lock logo.

Product configuration

Scan QR code to download and install the Arenti APP. Or you can search "Arenti" on App Store (iOS) or Google Play (Android).

Registration

Open the App. If you are a new user, tap to create a new account and follow the prompts to complete account setup.

Note: Please read and agree to the Privacy Policy and Terms of Use before creating your account.

Pairing

Open App home page, click "+" >> "Add Device" or "Add" and select icon according to actual camera.

Power on the device. For about 30s, the camera will emit start-up tone and LED indicator will flash red slowly.

Note: When pairing, please put the camera and mobile phone close to the router. If camera is not in the red slow blinking after 30 seconds of powering on, press and hold the reset button for 5s to reset, and then restart to pair the camera with the APP.

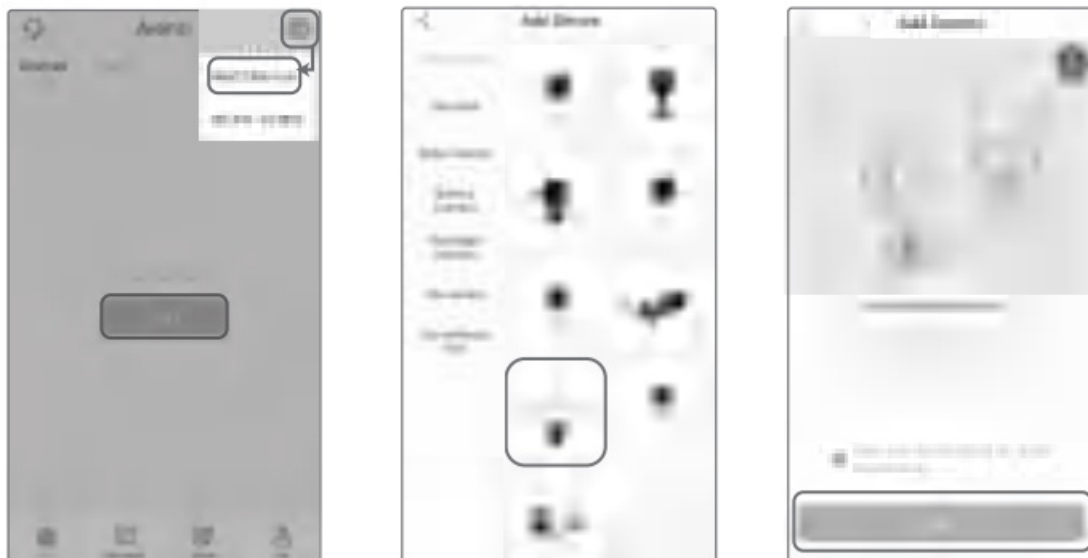

Select the Wi-Fi network and input the password, and then click “Next”. Make sure that your phone has connected to a fluent and steady Wi-Fi already.

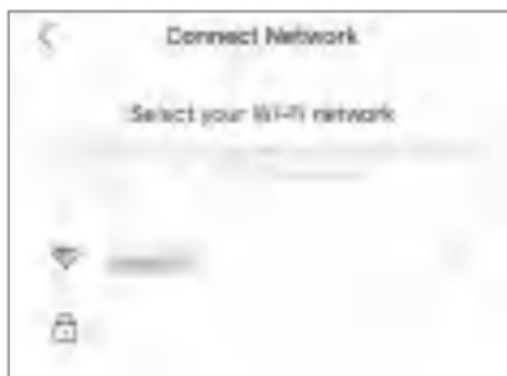

Click “Next” and use the camera to scan the QR code in the App on your mobile phone, when the sound “dong dong dong” is heard, click “Notification tone heard.”, and then the LED indicator will become solid blue after few seconds.

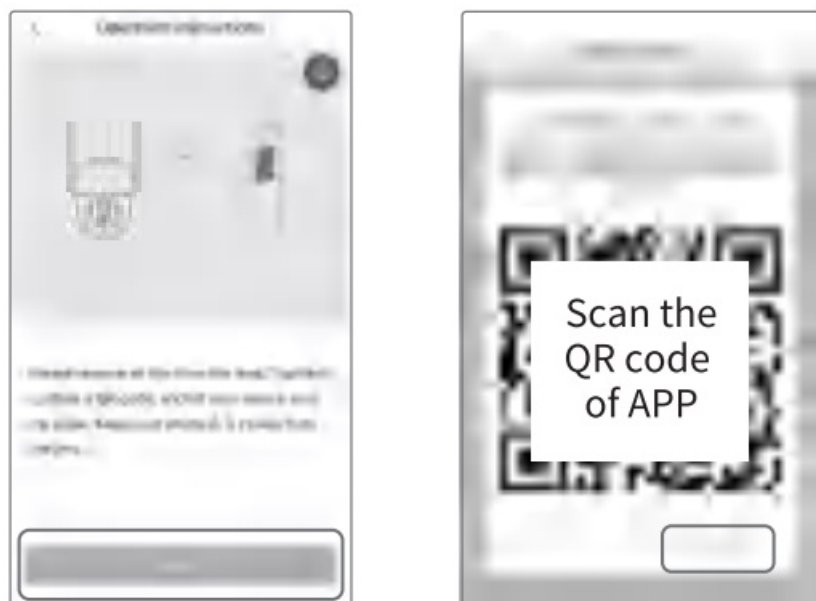

If no device is found and the pairing process is not successful, please refer to the following instructions:

1. Ensure that the Wi-Fi network is set to 2.4GHz.

2. Verify that the entered Wi-Fi password is correct and that the mobile device is connected to the same Wi-Fi network.
3. Make sure the camera is in pairing mode.
4. Check for network activity on your Wi-Fi.

If none of the solutions work or if you have any other issues, please contact support@arenti.com for assistance.

Notice

If you have multiple cameras, please follow steps again to add devices one by one.

To change Wi-Fi network, please restore the camera to factory settings and follow steps to add the camera.

Pairing via Bluetooth (exclusively for GO2Q)

Turn on your phone's Bluetooth.

Open APP home page, click "+" >> "Scan Code", then scan the QR code pasted on the device casing with the App of your phone, and add the camera to the App.

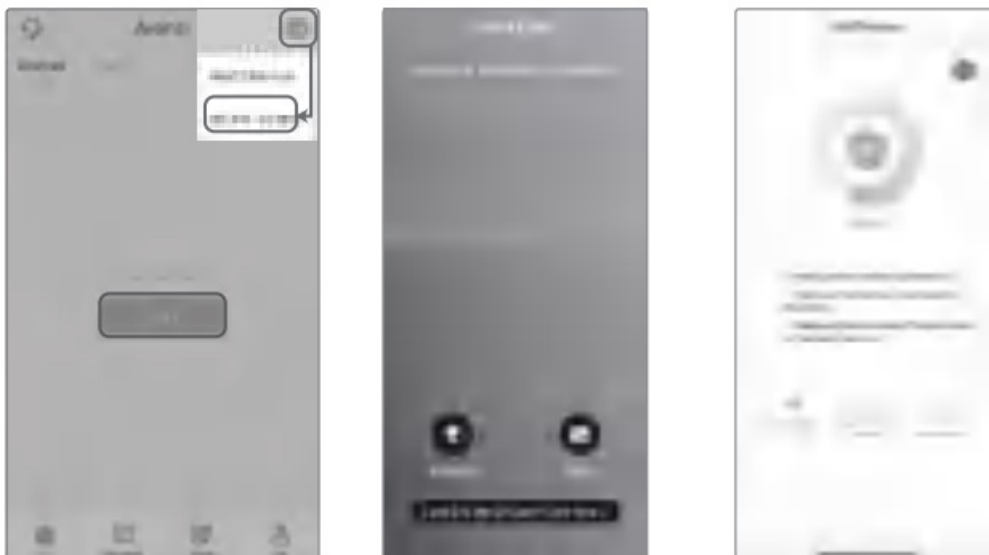

Specification

Product name	GO2T	GO2Q
Resolution	2304 x 1296	2560 x 1440
Angle of view	100°	
IR Distance	Up to 10m	
Working temp	-20°C to 50°C	
Local storage	Micro SD card (Max. 128GB)	Micro SD card (Max. 256GB)
Input power	DC 5V / 1A	
Consumption	Max. 4W	
Supported phone OS	iOS 9 / Android 5.0 and above version	
2.4G Wi-Fi	2412-2472 MHz (Max. power<20dBm)	

Legal notice

Support www.arenti.com

Symbols  Direct current (DC)



 Don't throw batteries or out of order products with the household waste (garbage). The dangerous substances that they are likely to include may harm health or the environment. Make your retailer take back the products or use selective collect of garbage proposed by your city.



Hereby, we declares that the radio equipment type GOI(Q)' is in compliance with the Directive 2014/53/EU

The full test of the EU declaration of conformity is available at the following Internet address: www.arenti.com

Documents / Resources

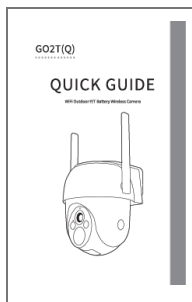

[MEARI WF-A211L Smart Camera](#) [pdf] User Manual
WF-A211L Smart Camera, WF-A211L, Smart Camera, Camera

References

- [User Manual](#)