



# MEAN WELL EPS-65S Series 65W Single Output Switching Power Supply Owner's Manual

[Home](#) » [MEAN WELL](#) » MEAN WELL EPS-65S Series 65W Single Output Switching Power Supply Owner's Manual 

## Contents

- [1 MEAN WELL EPS-65S Series 65W Single Output Switching Power Supply](#)
- [2 Features](#)
- [3 Applications](#)
- [4 GTIN CODE](#)
- [5 Description](#)
- [6 Model Encoding](#)
- [7 SPECIFICATION](#)
- [8 Block Diagram](#)
- [9 Derating Curve](#)
- [10 Static Characteristics](#)
- [11 Mechanical Specification](#)
- [12 Installation Manual](#)
- [13 Documents / Resources](#)



**MEAN WELL EPS-65S Series 65W Single Output Switching Power Supply**



## Features

- 3"×2" miniature size
- Universal AC input / Full range
- ClassII(without FG) installations
- No load power consumption<0.1W
- High efficiency up to 91%
- For 1U applications
- Protections: Short circuit / Overload / Over voltage
- Cooling by free air convection
- 30~70°Cwide range of operating temperature
- LED indicator for power on
- 3 years warranty



## Applications

- Industrial electrical equipment
- Mechanical equipment
- Factory automation equipment
- Handheld electronic device

## GTIN CODE

**EPS - 65 S - 3.3**

- Series name
- Output wattage
- Small size
- Output voltage

	HOLD UP TIME (Typ.)	30ms / 230VAC      12ms / 115VAC at full load						
INPUT	VOLTAGE RANGE Note.5	80 ~ 264VAC						
	FREQUENCY RANGE	47 ~ 63Hz						
	EFFICIENCY (Typ.)	80%	84%	85%	88%	89%	90%	91%
	AC CURRENT (Typ.)	1.5A / 115VAC      1A / 230VAC						
	INRUSH CURRENT (Typ.)	COLD STAR 30A/115VAC 50A/230VAC						
	LEAKAGE CURRENT(max.)	0.25mA/264VAC						
PROTECTION	OVERLOAD	115 ~ 150% rated output power						
		Protection type : Hiccup mode, recovers automatically after fault condition is removed						
	OVER VOLTAGE	3.8~4.46V	5.75~6.75V	8.62~11.3V	13.8~16.2V	17.25~20.25V	27.6~32.4V	55.2~64.8V
Protection type : Shut down o/p voltage, re-power on to recover								
ENVIRONMENT	WORKING TEMP.	-30 ~ +70°C (Refer to “Derating Curve”)						
	WORKING HUMIDITY	20% ~ 90% RH non-condensing						
	STORAGE TEMP., HUMIDITY	-40 ~ +85°C, 10 ~ 95% RH						
	TEMP. COEFFICIENT	±0.03% / °C (0 ~ 50°C)						
	OPERATING ALTITUDE Note.6	5000 meters						
	VIBRATION	10 ~ 500Hz, 2G 10min./1cycle, period for 60min. each along X, Y, Z axes						
SAFETY & EMC  (Note. 7)	SAFETY STANDARDS	UL62368-1, TUV BS EN/EN62368- 1, BS EN/EN60335-1, CCC GB4943.1, EAC TP TC 004 approved						
	WITHSTAND VOLTAGE	I/P-O/P: 3KVAC						
	ISOLATION RESISTANCE	I/P-O/P:100M Ohms / 500VDC / 25°C/ 70% RH						
	EMC EMISSION	Compliance to BS EN/EN55032(CISPR32) Class B, BS EN/EN61000-3-2,3, GB9254.1 Class B,GB17625 Class A,EAC TP TC 020						
	EMC IMMUNITY	Compliance to BS EN/EN61000-4-2,3,4,5,6,8,11, BS EN/EN55035, Heavy industry Level , EAC TP TC 020						

<b>OTHERS</b>	<b>MTBF</b>	3334.3K hrs min. Telcordia SR-332 (Bellcore) ; 706.6K hrs min. MIL-HDBK-217F (25°C)
	<b>DIMENSION</b>	76.2*50.8*24mm or 3" * 2" *0.945" inch (L*W*H)
	<b>PACKING</b>	0.11Kg; 120pcs/14.2Kg/0.94CUFT
<b>NOTE</b>	<p>1. All parameters NOT specially mentioned are measured at 230VAC input, rated load and 25°C of ambient temperature.</p> <p>2. 33% Duty cycle maximum within every 30 seconds. Average output power should not exceed the rated power.</p> <p>3. Ripple &amp; noise are measured at 20MHz of bandwidth by using a 12" twisted pair-wire terminated with a 0.1uf &amp; 47uf parallel capacitor.</p> <p>4. Tolerance : includes set up tolerance, line regulation and load regulation.</p> <p>5. Derating may be needed under low input voltages. Please check the derating curve for more details .</p> <p>6. The ambient temperature derating of 3.5°C/1000m with fanless models and of 5°C/1000m with fan models for operating altitude higher than 2000m(6500ft).</p> <p>7. The power supply is considered a component which will be installed into a final equipment. The final equipment must be re-confirmed that it still meets EMC directives. For guidance on how to perform these EMC tests, please refer to "EMI testing of component power.</p> <p>(as available on <a href="http://www.meanwell.com">http://www.meanwell.com</a>)</p> <p>※ Product Liability Disclaimer For detailed information, please refer to <a href="https://www.meanwell.com/serviceDisclaimer.aspx">https://www.meanwell.com/serviceDisclaimer.aspx</a></p>	

## Block Diagram

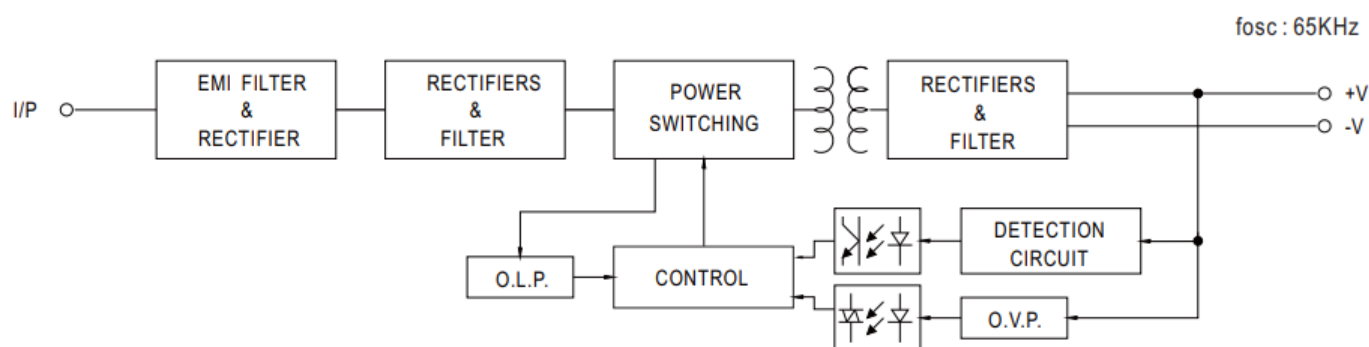

## Derating Curve

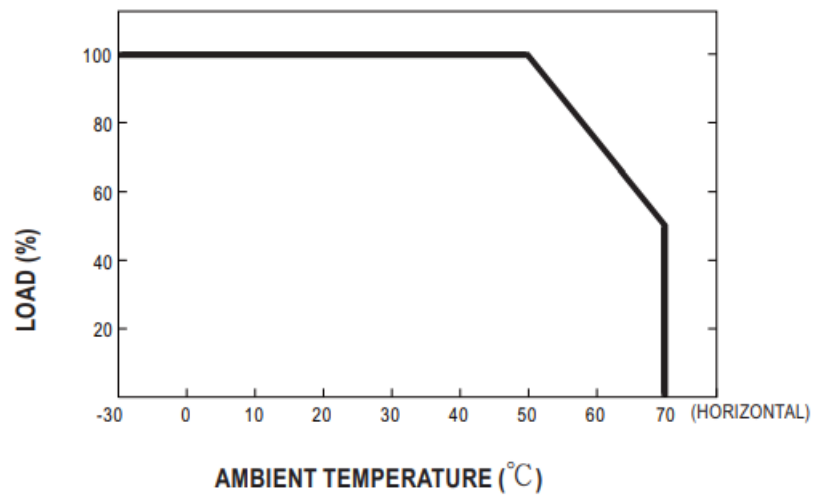

## Static Characteristics

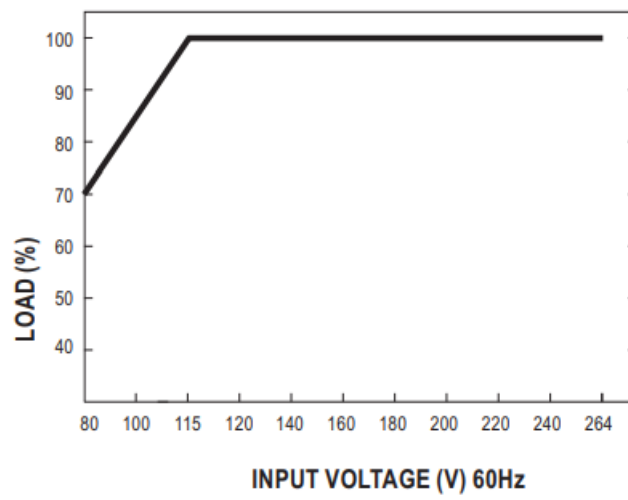

## Mechanical Specification

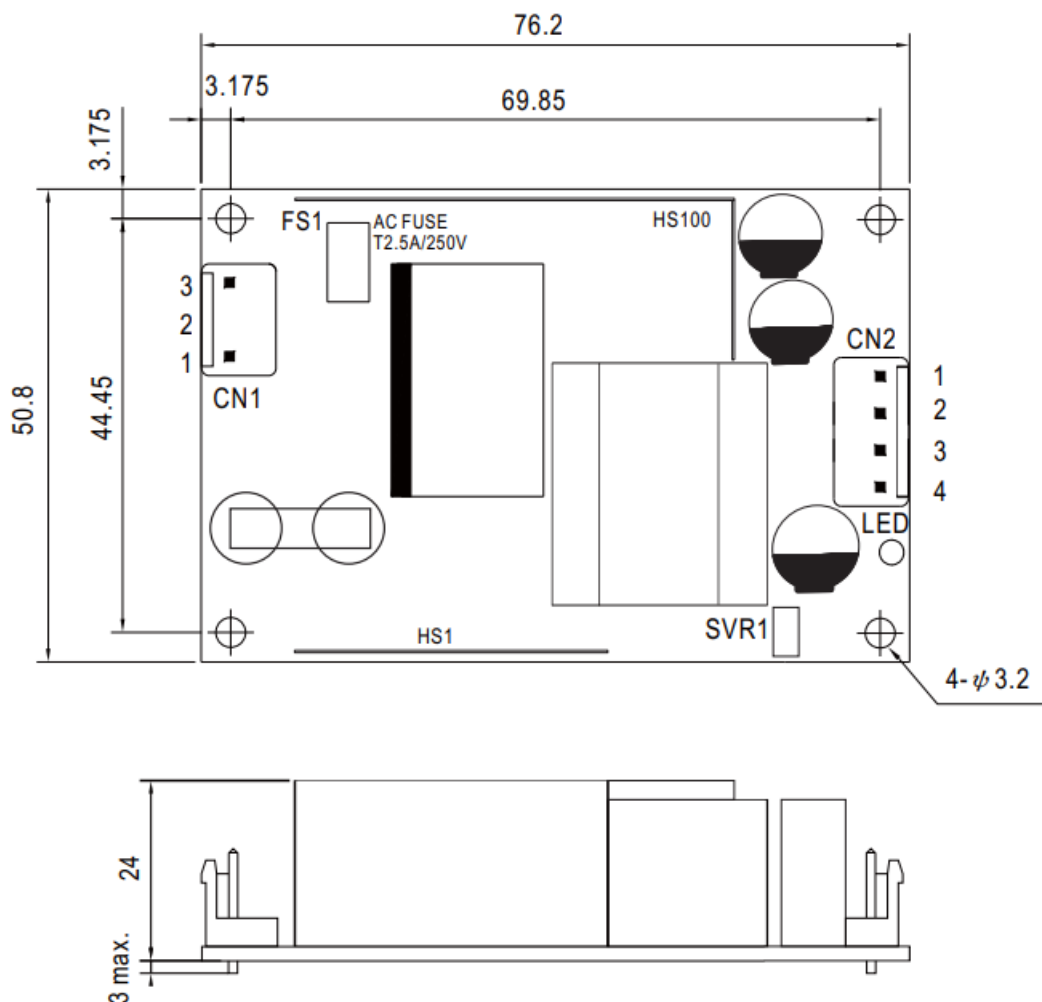

#### AC Input Connector (CN1) : JST B3P-VH or equivalent

Pin No.	Assignment	Mating Housing	Terminal
1	AC/N	JST VHR or equivalent	JST SVH-21T-P1.1 or equivalent
2	No Pin		
3	AC/L		

#### DC Output Connector (CN2) : JST B4P-VH or equivalent

Pin No.	Assignment	Mating Housing	Terminal
1	+V	JST VHR or equivalent	JST SVH-21T-P1.1 or equivalent
2	+V		
3	-V		
4	-V		

#### Installation Manual

Please refer to : <http://www.meanwell.com/manual.html>

	<p><a href="#">MEAN WELL EPS-65S Series 65W Single Output Switching Power Supply</a> [pdf] Owner's Manual</p> <p>EPS-65S-SPEC_2023-09-18-082428_wbra.PDF, EPS-65S, EPS-65S Series 65W Single Output Switching Power Supply, 65W Single Output Switching Power Supply, Output Switching Power Supply, Switching Power Supply, Power Supply</p>
---	---