



**APC-12 Series
12W Single
Output Switching
Power Supply**



MEAN WELL APC-12 Series 12W Single Output Switching Power Supply Owner's Manual

[Home](#) » [MEAN WELL](#) » MEAN WELL APC-12 Series 12W Single Output Switching Power Supply Owner's Manual 

Contents

- [1 MEAN WELL APC-12 Series 12W Single Output Switching Power Supply](#)
- [2 Product Usage Instructions](#)
- [3 FAQs](#)
- [4 Features](#)
- [5 Specifications](#)
- [6 Block Diagram](#)
- [7 Documents / Resources](#)
 - [7.1 References](#)
- [8 Related Posts](#)



MEAN WELL APC-12 Series 12W Single Output Switching Power Supply



Product Usage Instructions

• Installation

- Please ensure that the L line is connected to the positive pole and the N line is connected to the negative pole under DC input.

• Powering On

- Connect the power supply to a suitable power source within the specified voltage and frequency range.

• Maintenance

- Refer to the user manual for any IP water-proof function installation cautions and application notes before using the product.

FAQs

• What is the maximum current rating for the APC-12 series power supply?

- The maximum current rating for the APC-12 series power supply is 700mA.

• Is the product suitable for LED lighting luminaire applications in the EU?

- No, this product is not intended for LED lighting luminaire applications in the EU. The LPF/NPF/XLG series are recommended for such applications.

• How many units can be connected to a 16A circuit breaker at 230VAC?

- 17 units can be connected with a circuit breaker of type B, while 29 units can be connected with a circuit breaker of type C at 230VAC.

Features

- Constant current design
- Universal AC input / Full range
- Protections: Short circuit / Over voltage
- Fully isolated plastic case
- Small and compact size
- Cooling by free air convection
- Class II power unit, no FG
- Class 2 power unit
- Pass LPS
- IP42 design
- Suitable for LED related fixture or appliances (such as LED Decoration or Advertisement devices)(Note.6)
- 100% full load burn-in test
- Low cost / High reliability
- 2 years warranty

GTIN CODE

- MW Search: <https://www.meanwell.com/serviceGTIN.aspx>.

Specifications

MODEL		APC-12-350		APC-12-700	
OUTPUT	RATED CURRENT	350mA		700mA	
	DC VOLTAGE RANGE	9~36V		9~18V	
	RATED POWER	12.6W		12.6W	
	RIPPLE & NOISE (max.) <small>Note.2</small>	300mVp-p		250mVp-p	
	VOLTAGE TOLERANCE <small>Note.3</small>	±5.0%			
	CURRENT ACCURACY	±8.0%			
	LINE REGULATION	±1.0%			
	LOAD REGULATION	±3.0%			
	SETUP, RISE TIME	3000ms, 180ms / 230VAC 3000ms, 150ms / 115VAC at full load			
	HOLD UP TIME (Typ.)	20ms/230VAC,15ms/115VAC at full load			
INPUT	VOLTAGE RANGE <small>Note.4</small>	90 ~ 264VAC 127 ~ 370VDC			
	FREQUENCY RANGE	47 ~ 63Hz			
	EFFICIENCY(Typ.)	82%		80%	
	AC CURRENT	0.2A/230VAC;0.35A/115VAC			
	INRUSH CURRENT(Typ.)	COLD START 70A(twidth=150μs measured at 50% Ipeak) at 230VAC			
	MAX. No. of PSUs on 16A CIRCUIT BREAKER	17 units (circuit breaker of type B) / 29 units (circuit breaker of type C) at 230VAC			
	LEAKAGE CURRENT	0.25mA / 240VAC			
PROTECTION	OVER VOLTAGE	39.6~ 46.8V		20.7 ~ 24.3V	
		Protection type : Shut off o/p voltage, clamping by zener diode			
ENVIRONMENT	WORKING TEMP.	-30 ~ 70℃ (Refer to "Derating Curve")			
	WORKING HUMIDITY	20 ~ 90% RH non-condensing			
	STORAGE TEMP., HUMIDITY	-40 ~ +80℃, 10 ~ 95% RH			
	TEMP. COEFFICIENT	±0.2%/℃ (0 ~ 50℃)			
	VIBRATION	10 ~ 500Hz, 2G 10min./1cycle, period for 60min. each along X, Y, Z axes			
SAFETY & EMC <small>(Note 5)</small>	SAFETY STANDARDS <small>Note.7</small>	UL8750,CSA C22.2 No.250.0-08, BIS IS15885, EAC TP TC 004,BS EN/EN 62368-1 approved			
	WITHSTAND VOLTAGE	I/P-O/P:3.75KVAC			
	ISOLATION RESISTANCE	I/P-O/P:>100M Ohms / 500VDC / 25℃/ 70% RH			
	EMC EMISSION	Compliance to BS EN/EN55032,BS EN/EN61000-3-2,BS EN/EN61000-3-3, EAC TP TC 020			
	EMC IMMUNITY	Compliance to BS EN/EN55035,BS EN/EN61000-4-2,3,4,5,6,8,11; light industry level(surge 2KV), EAC TP TC 020			
OTHERS	MTBF	6418.1K hrs min. Telcordia SR-332 (Bellcore); 1097.4K hrs min. MIL-HDBK-217F (25℃)			
	DIMENSION	77*40*29(L*W*H)			
	PACKING	0.08Kg; 120pcs/11.8Kg/1.06CUFT			
NOTE	1. All parameters NOT specially mentioned are measured at 230VAC input, rated load and 25℃ of ambient temperature. 2. Ripple & noise are measured at 20MHz of bandwidth by using a 12" twisted pair-wire terminated with a 0.1uf & 47uf parallel capacitor. 3. Tolerance : includes set up tolerance, line regulation and load regulation. 4. Derating may be needed under low input voltage. Please check the static characteristic for more details. Please connect L line to the positive pole and N line to the negative pole under DC input. 5. The power supply is considered as a component that will be operated in combination with final equipment. Since EMC performance will be affected by the complete installation, the final equipment manufacturers must re-qualify EMC Directive on the complete installation again. (as available on https://www.meanwell.com/Upload/PDF/EMI_statement_en.pdf) 6. This product is not intended for LED lighting luminaire applications in the EU.(In the EU the LPF/NPF/XLG series are recommended.) 7. The model certified for CCC(GB19510.14, GB19510.1, GB17743 and GB17625.1) is an optional model . Please contact MEAN WELL for details. 8. The ambient temperature derating of 3.5℃/1000m with fanless models and of 5℃/1000m with fan models for operating altitude higher than 2000m(6500ft). 9. For any application note and IP water proof function installation caution, please refer our user manual before using. https://www.meanwell.com/Upload/PDF/LED_EN.pdf ※ Product Liability Disclaimer : For detailed information, please refer to https://www.meanwell.com/serviceDisclaimer.aspx				

Mechanical Specification

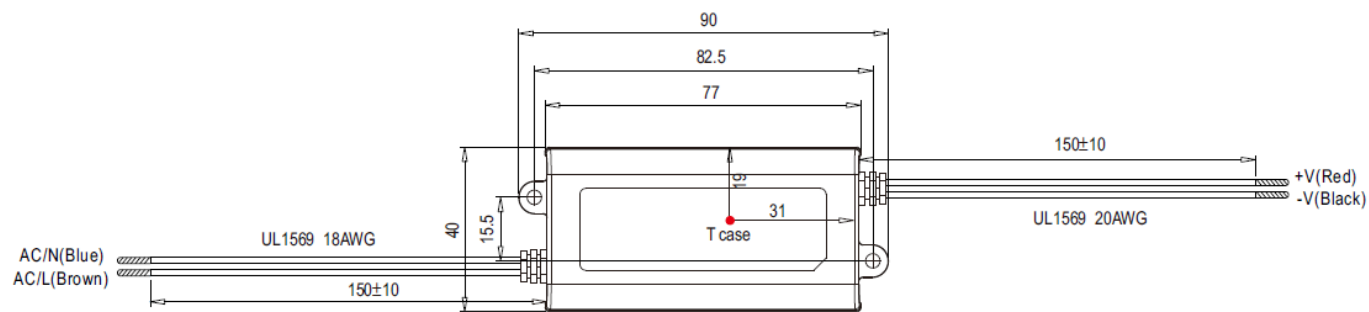

※ T case: Max. Case Temperature

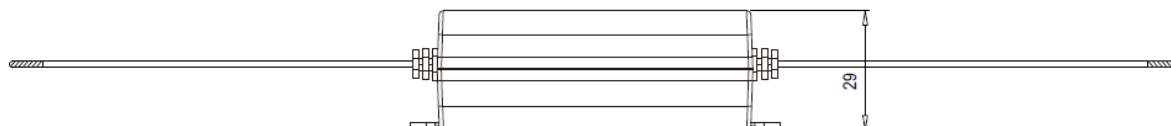

Block Diagram

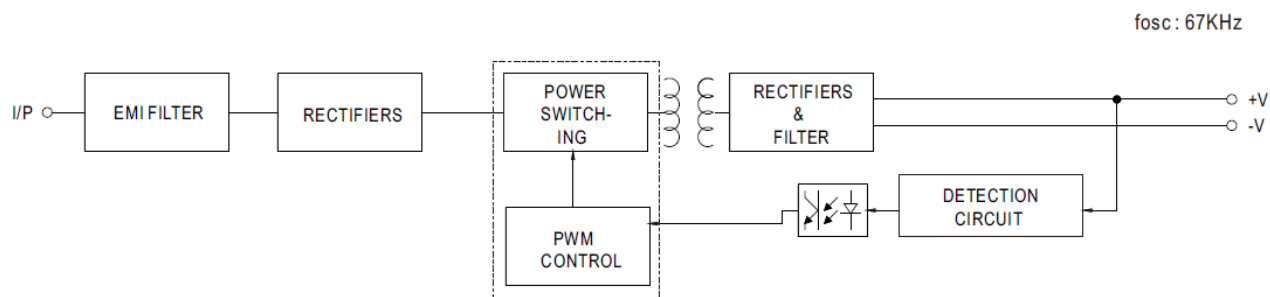

Derating Curve

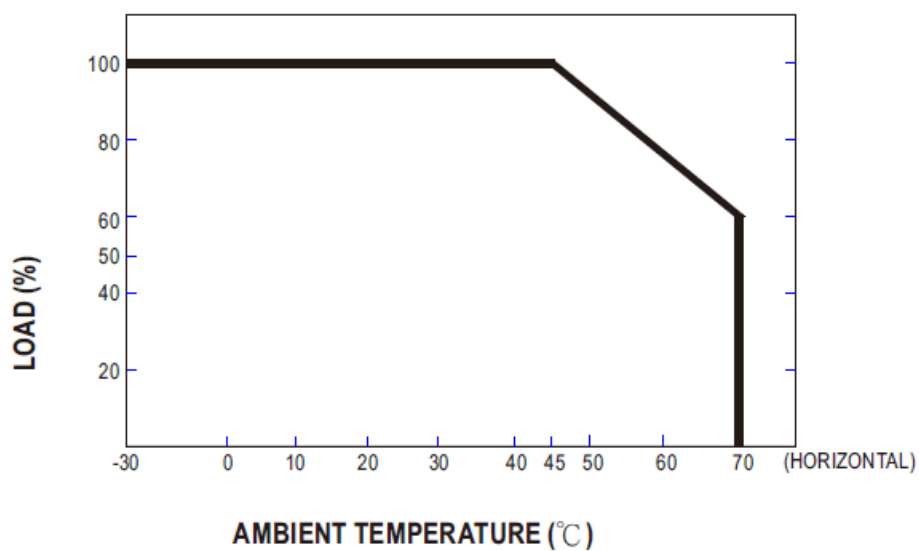

Static Characteristics

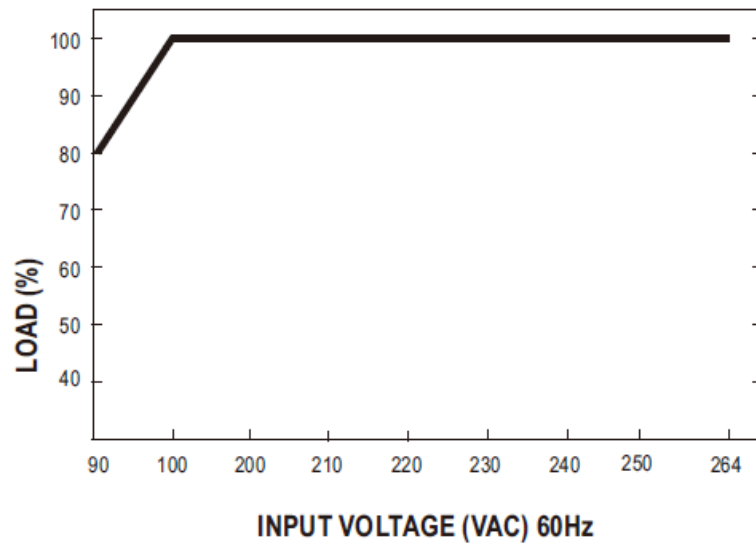

EFFICIENCY vs LOAD (APC-12-350)

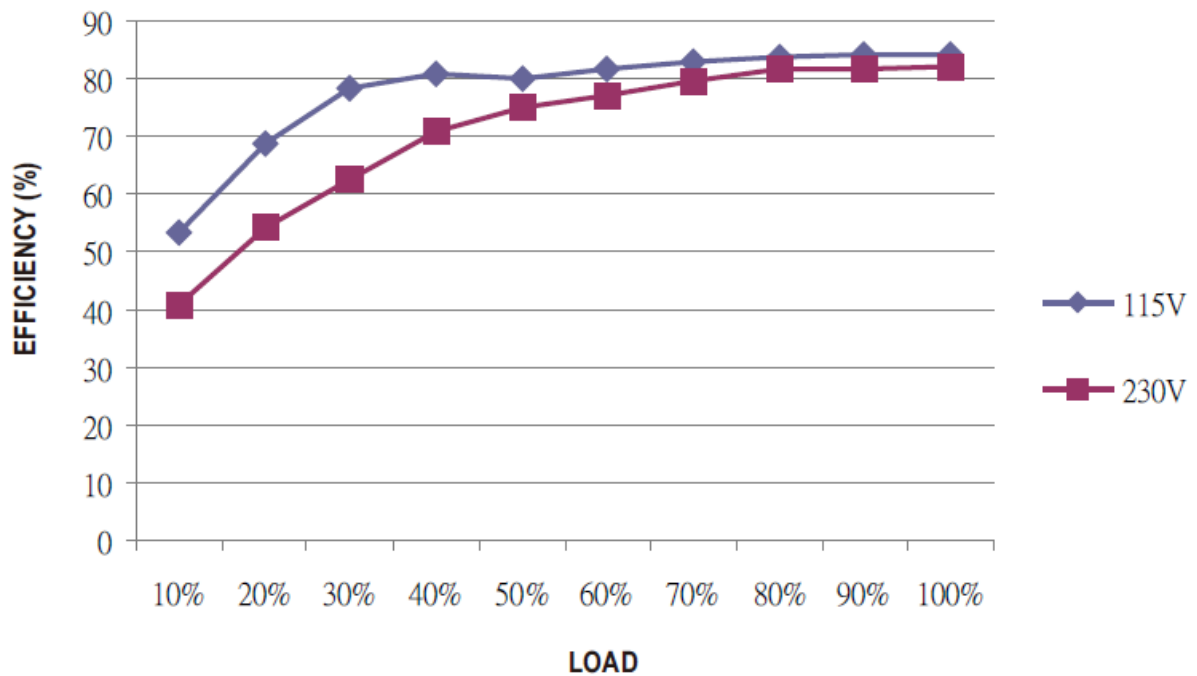

- Unit: mm
- Downloaded from [Arrow.com](https://www.arrow.com).
- File Name: APC-12-SPEC 2024-01-08



Documents / Resources

	<p>MEAN WELL APC-12 Series 12W Single Output Switching Power Supply [pdf] Owner's Manual</p> <p>APC-12 Series 12W Single Output Switching Power Supply, APC-12 Series, 12W Single Output Switching Power Supply, Output Switching Power Supply, Switching Power Supply, Power Supply, Supply</p>
---	--

References

- [User Manual](#)

[Manuals+.](#) [Privacy Policy](#)

This website is an independent publication and is neither affiliated with nor endorsed by any of the trademark owners. The "Bluetooth®" word mark and logos are registered trademarks owned by Bluetooth SIG, Inc. The "Wi-Fi®" word mark and logos are registered trademarks owned by the Wi-Fi Alliance. Any use of these marks on this website does not imply any affiliation with or endorsement.