

**MCHOSE
X75 Mechanical
Keyboard**



MCHOSE X75 Mechanical Keyboard User Manual

[Home](#) » [MCHOSE](#) » MCHOSE X75 Mechanical Keyboard User Manual 

Contents

- [1 MCHOSE X75 Mechanical Keyboard](#)
- [2 X75 Function Specification](#)
- [3 WIRELESS CONNECTION](#)
- [4 SPECIFICATION](#)
- [5 CHARGING INSTRUCTION](#)
- [6 Documents / Resources](#)
 - [6.1 References](#)

MCHOSE

MCHOSE X75 Mechanical Keyboard



X75 Function Specification

RGB atmosphere light / Power indicator

Mode switch:

- 1.The top position **【2.4G】** indicates 2.4GHz mode.
- 2.The middle position **【B】** indicates wireless mode.
- 3.The bottom position **【OFF】** indicates USB wired mode.

Volume Control Knob

Clockwise it turn volume +

Counterclockwise it turn volume -

Press it turn silent mode

Type-C port

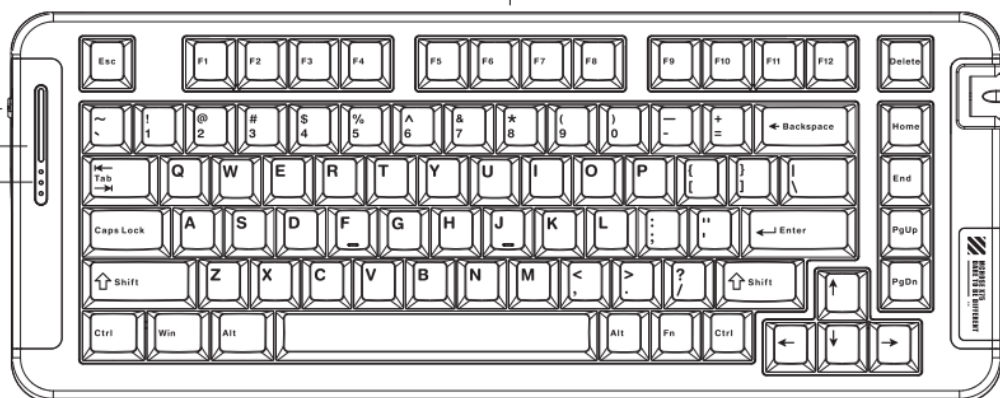

Indicate from top to bottom:

1. CAP indicator
2. SCR indicator
3. WIN locked indicator

Metal magnetic nameplate

2.4GHz receiver slot

Keyboard turning off: Switch the side toggle to [USB] mode and unplug the cable to disconnect. Keyboard polling rate: 1000Hz in wired mode, 1000Hz in 2.4GHz mode, 125Hz in wireless mode.

Attention: The images in this manual are all schematic diagrams and may deviate from the actual product. Please refer to the actual product for accuracy.

2.4GHZ CONNECTION

Manual pairing dongle: Switch the toggle to the position [2.4G] to enter 2.4GHz mode. Press [FN+*~] and hold for 3 seconds, the indicator will quickly flash GREEN to enter the pairing mode. Plug the included dongle into the desired device, (indicator light) will become normal when the 2.4GHz wireless mode connects successfully.

Note: The dongle is default paired.

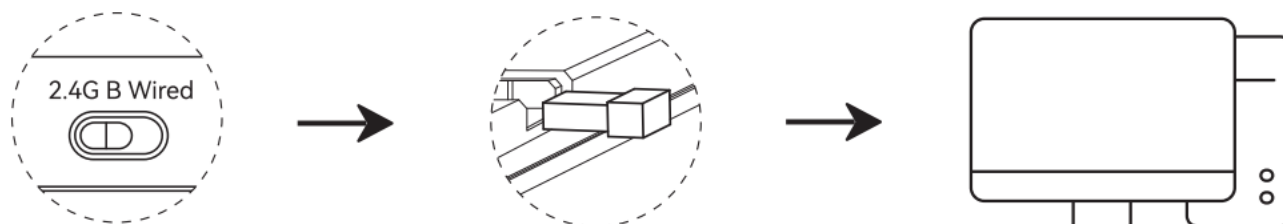

1. Switch the toggle to [2.4G] to enter the 2.4GHz mode.
2. Open the nameplate cover from the lower right corner of the keyboard and take out the USB dongle from the dongle compartment.
3. Insert the USB dongle into the USB port on your computer. The keyboard is now ready for use.

WIRELESS CONNECTION

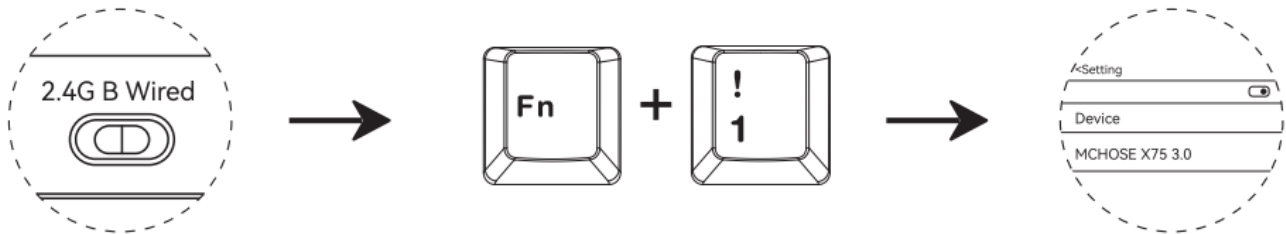

1. Switch the toggle to [B] to enter the wireless mode.
2. Press the combination key to switch to wireless and hold for about 3 seconds until the blue light flashes quickly to activate wireless pairing.
3. Search for the wireless device name [MCHOSE X75 3.0] or [MCHOSE X75 5.0] on your device, and click to connect, the the wireless indicator light will go back to normal after successful pairing.

The wireless device names for channels 1, 2, and 3 are [MCHOSE X75 3.01 or [MCHOSE X75 5.0). Press the combination key and hold for about 3 seconds until the corresponding wireless channel indicator light flashes quickly, indicating that the keyboard has entered detect pairing or search mode, and can be paired and connected to the device;

- Press the combination key “Fn”+number keys “1”, “2”, or “3” to switch devices.

WIRED CONNECTION

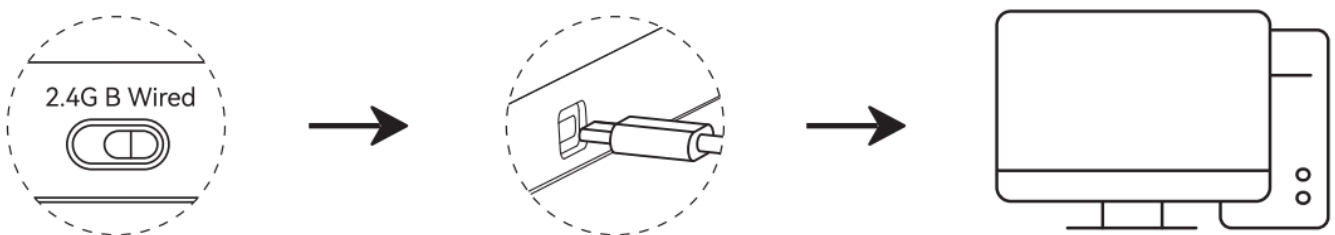

POWER SAVING MODE

In 2.4GHz wireless mode, the keyboard backlight will turn off after 1 minute of inactivity. Press any key to activate it.

BACKLIGHT EFFECT

- Press the combination key [FN+`] to switch 16 backlights.
- In combination with the drive software and music rhythm RGB sound effects, you can choose from 10 lighting modes.
- Both wired mode and 2.4GHz wireless mode support custom functions and macro definitions for each key.
- The drive allows for customization of over 16 million colors.

CHECK THE CURRENT STATUS USING THE INDICATOR LIGHT

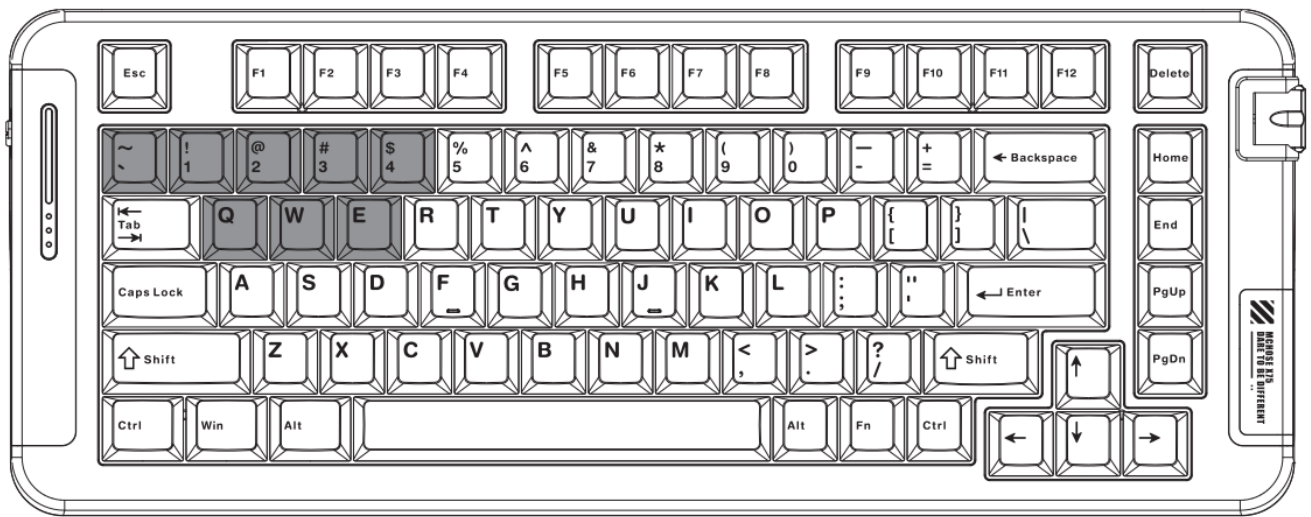

- Press the [Fn] key to check the following status:
- Current connection mode (2.4GHz, wireless, wired).
- Current wireless channels (channels 1, 2, 3).
- Current device system mode (Android, WIN, MAC).

The corresponding buttons will light up to indicate the current status. Release the Fn key to restore the light effect.

- 2.4GHz mode: “~” key
- Wireless channel: “1, 2, 3” keys
- Wired mode: “4” key
- Device system mode: “Q, W, E” keys

FN KEY COMBINATION FUNCTIONS

FN +	ESC	1	2	3	Q	W	E
	Reset (Hold for 3 s)	Wireless device 1	Wireless device 2	Wireless device 3	Android System	Windows System	Mac System
	~	\	Tab	↑	↓	←	→
	2.4GHz pairing (Hold for 3 s)	Switch backlight mode	Switch backlight color	Backlight brightness+	Backlight brightness-	Backlight speed-	Backlight speed+
	Right Shift	/?	Right Alt	Right Ctrl	B	Z	Left Shift
	Switch the side light mode	Switch the side light colors	Cycle switch side light brightness levels	Cycle switch side light speed levels	Switch atmosphere light to power mode	Switch atmosphere light colors	Switch atmosphere lighting mode
	Win	U	I	O	Del		
	Lock Win	PRTSC	SCRLK	PAUSE	INS		

- FN+ WIN: Locks or unlocks the Win key. (In Windows systems, the indicator light remains lit when the Win key is locked, and the Win key becomes inactive).
- When switched to Mac System from Windows, the functions of the WIN key and Left ALT key are interchanged.
- Additionally, F1-F12 keys will function as multimedia keys.
- In 2.4GHz/wireless mode (without connecting the USB cable), press FN+B to display the power status. A green light indicates full power, while the light strip decreases when power decreases.
- When in low power, the light turns red.
- FN+1: Wireless Channel 1. Press briefly to switch channels, and press, and hold for 3 s to enter pairing mode.
- FN+2: Wireless Channel 2. Press briefly to switch channels, and press and hold for 3 s to enter pairing mode.
- FN+3: Wireless Channel 3. Press briefly to switch channels, and press and hold for 3 s to enter pairing mode.

ANDROID SYSTEM F-ZONE SINGLE PRESS FUNCTION AND FN COMBINATION FUNCTION

Key	F1	F2	F3	F4	F5	F6
Press the single key	Screen brightness -	Screen brightness +	Switch window	Back to desktop	Backlight brightness-	Backlight brightness+
Press with FN combination key	F1	F2	F3	F4	F5	F6
Key	F7	F8	F9	F10	F11	F12
Press the single key	Previous song	Play/Pause	Next song	Mute	Volume -	Volume +
Press with FN combination key	F7	F8	F9	F10	F11	F12

WINDOWS SYSTEM F-ZONE SINGLE PRESS FUNCTION AND FN COMBINATION FUNCTION

Key	F1	F2	F3	F4	F5	F6
Press the single key	F1	F2	F3	F4	F5	F6
Press with FN combination key	Home page	Email	Switch window	Open the Explorer	backlight brightness-	backlight brightness+
Key	F7	F8	F9	F10	F11	F12
Press the single key	F7	F8	F9	F10	F11	F12
Press with FN combination key	Previous song	Play/Pause	Next song	Mute	Volume -	Volume +

MAC SYSTEM F-ZONE SINGLE PRESS FUNCTION AND FN COMBINATION FUNCTION

Key	F1	F2	F3	F4	F5	F6
Press the single key	Screen brightness -	Screen brightness +	Switch window	Back to desktop	Backlight brightness-	Backlight brightness+
Press with FN combination key	F1	F2	F3	F4	F5	F6

Key	F7	F8	F9	F10	F11	F12
Press the single key	Previous song	Play/Pause	Next song	Mute	Volume -	Volume +
Press with FN combination key	F7	F8	F9	F10	F11	F12

When switched to Mac System from Windows, the functions of the WIN key and Left ALT key are interchanged.

SPECIFICATION

- Model: X75
- Rated voltage: DC 3.7V
- Battery capacity: 4000mAH rechargeable lithium battery
- Charging voltage/current: DC 5V= 1.5A
- Connectivity: Wireless / 2.4G / wired
- Charging interface: Type-C port

CHARGING

By connecting the keyboard to the computer with the provided USB cable, the keyboard will charge. During the charging process, the status of the indicator light will flash continuously. Once fully charged, the status indicator light will turn green. In 2.4GHz/wireless mode (without connecting the USB cable), press FN+B to display the power status. A green light indicates full power, while the light strip decreases when power decreases. When in low power, the light turns red.

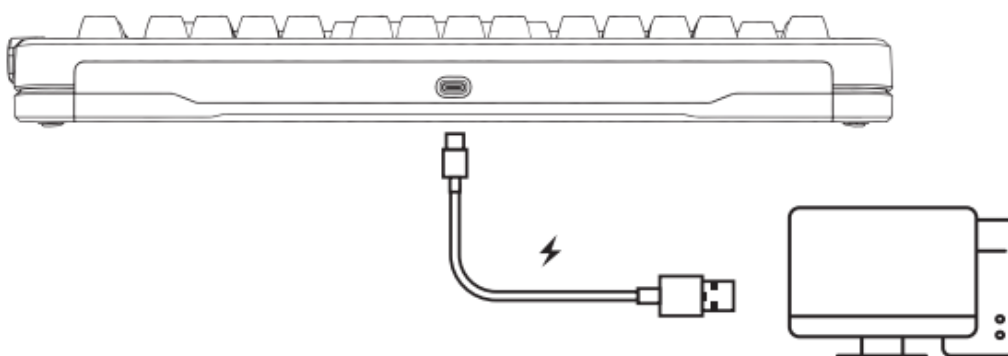

COMPUTER SYSTEM REQUIREMENTS

1. Wired/2.4G mode: Windows All (Win XP, Win7, Win8, Win10), for Win95 and Win98, the drive is required.
2. Wired mode/2.4G receiver: A USB 1.1 or higher port is required.
3. MCHOSE X75 3.0-wireless mode: Win/ or lower system.
4. CHOSE X75 5.0-wireless mode: Win8, Win10, or higher system.
5. Wireless mode: MAC hardware above BT3.0, BLE4.0, BLE5.0. Android phone and tablet.

NOTE: This equipment has been tested and found to comply with the limits for a Class B digital device, under

FCC Rules

These limits are designed to provide reasonable protection against harmful interference in a residential installation. This equipment generates, uses, and can radiate radio frequency energy and, if not installed and used by the instructions, may cause harmful interference to radio communications. However, there is no guarantee that interference will not occur in a particular installation. If this equipment does cause harmful interference to radio or television reception, which can be determined by turning the equipment off and on, the user is encouraged to try to correct the interference by one or more of the following measures:

- Reorient or relocate the receiving antenna.
- Increase the separation between the equipment and the receiver.
- Connect the equipment to an outlet on a circuit different from that to which the receiver is connected.
- Consult the dealer or an experienced radio/TV technician for help.
- Changes or modifications not expressly approved by the party responsible for compliance could void the user's authority to operate the equipment.

This device complies with Part 15 of the FCC Rules. Operation is subject to the following two conditions: (1) this device may not cause harmful interference, and (2) this device must accept any interference received, including interference that may cause undesired operation.

CHARGING INSTRUCTION

1. Suggest charging only by connecting the keyboard to the computer with the provided USB cable;
2. Don't charge the keyboard by using a fast charger for a mobile phone.
3. Don't charge the keyboard with substandard or non-compliant power adapters.
4. Don't charge the keyboard with over-voltage or over-current power adapters.
5. While charging, please keep away from high-temperature devices.
6. Please turn off the power when you have finished for a long time.

The above instructions apply to the other devices with charging functions (Keyboards, mice, headphones, speakers, etc.)

WARRANTY CARD

Thank you for purchasing our company's products. If there are any quality issues with the products during the warranty period, please contact us. Please provide this warranty card when contacting us so that we can provide you with comprehensive after-sales service.

Product Items

Customer Name:

Serial NO.:

Warranty Address

Purchase Date:

Warranty Contact:

Purchase Channel

TEL/ E-mail:

Sales: Postal Code: A

Documents / Resources



[MCHOSE X75 Mechanical Keyboard](#) [pdf] User Manual
X75 Mechanical Keyboard, X75, Mechanical Keyboard, Keyboard

References

- [User Manual](#)

[Manuals+](#), [Privacy Policy](#)

This website is an independent publication and is neither affiliated with nor endorsed by any of the trademark owners. The "Bluetooth®" word mark and logos are registered trademarks owned by Bluetooth SIG, Inc. The "Wi-Fi®" word mark and logos are registered trademarks owned by the Wi-Fi Alliance. Any use of these marks on this website does not imply any affiliation with or endorsement.