

MCHOSE K99 Mechanical Keyboard



# MCHOSE K99 Mechanical Keyboard User Guide

[Home](#) » [MCHOSE](#) » MCHOSE K99 Mechanical Keyboard User Guide 

## Contents

- 1 MCHOSE K99 Mechanical Keyboard
- 2 Product Overview
- 3 CONNECTION
- 4 POWER DISPLAY
- 5 CHARGE
- 6 SPECIFICATIONS
- 7 INSTRUCTIONS FOR CHARGING
- 8 Documents / Resources
  - 8.1 References

# MCHOSE

**MCHOSE K99 Mechanical Keyboard**



## Product Overview

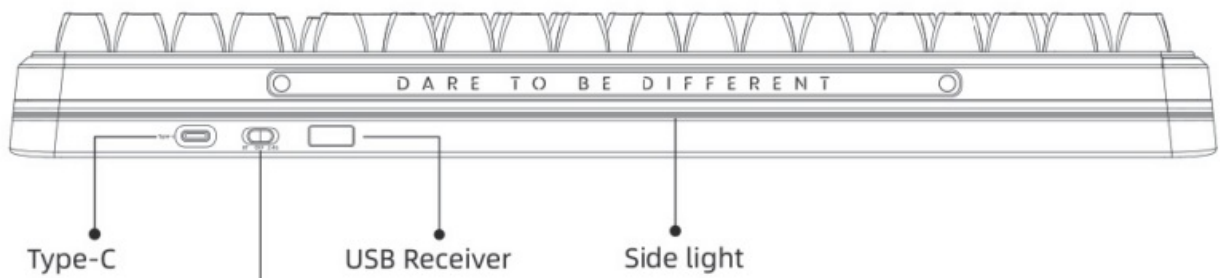

1. Leftmost [BT] indicates Bluetooth mode
2. Middle [OFF] indicates the USB cable mode
3. On the far right, [2.4G] indicates 2.4 mode

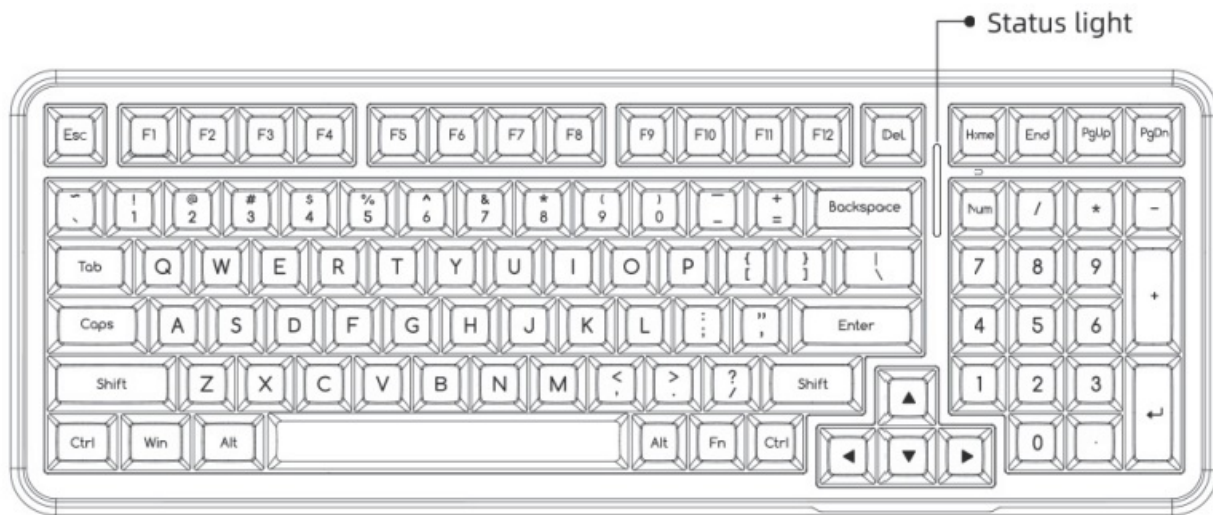

- Keyboard OFF: You need to dial the keyboard to [OFF] cable mode and unplug the port connection, you can shut it down.
- Keyboard return rate: Wired mode 1000Hz, 2.4G mode 1000Hz, BT mode 125Hz.
- Note: The pictures in this manual are schematic drawings, there may be deviations from the actual, please refer to the actual.

## CONNECTION

### 2.4G CONNECTION

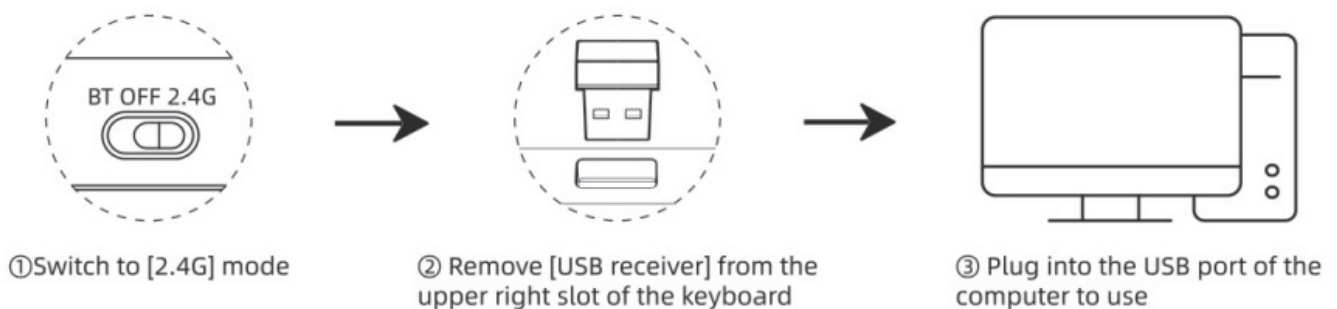

- Manual code alignment: Turn the upper switch to [2.4G mode], and then long press [FN+ '~ key] for 3 seconds, [indicator light] the green light flashes quickly to enter the code alignment state, at this time, the USB receiver is inserted into the computer port, [indicator light] returns to normal mode, 2.4G connection is successful, then the code alignment is completed. (Factory default has been coded)

### BT CONNECTION

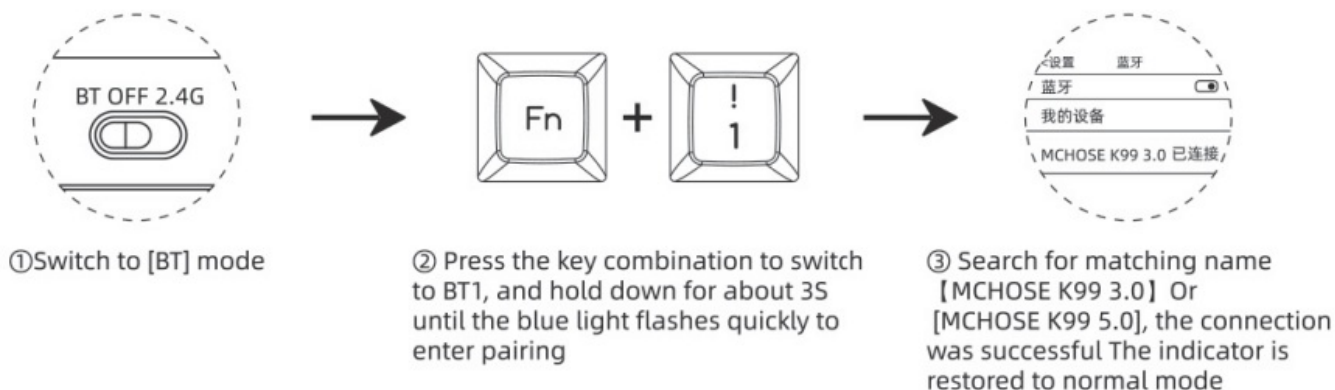

The pairing names of Bluetooth channels 1, 2, and 3 were [MCHOSE K99 3.0] or [MCHOSE K99 5.0].

- BT channel 2 key combination is [FN+2@1], I Indicator light 1 is purple light;
- BT channel 3 key combination is [FN+3#], I Indicator light 1 is green; Hold down the combination key for about 3s until the corresponding Bluetooth channel indicator blinks quickly, indicating that the keyboard enters the code matching or search mode, and the device can be paired and connected.
- Press the combination key Fn+ number key 1, 2 or 3 to switch devices.

## WIRED CONNECTION

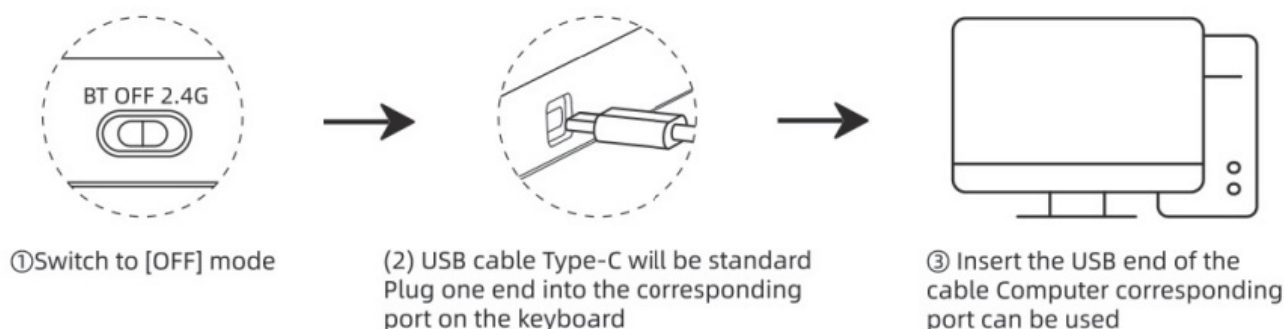

## • POWER SAVING MODE

- Keyboard In wireless mode, the keyboard has no action, the backlight is off after 3 minutes, and the BT /2.4G is disconnected after 30 minutes, Press any key to connect back.

## • LIGHT EFFECT INSTRUCTIONS

- Press the [FN+Del] key combination to switch 17 light effects: drift (restore default rear light effect), steady on mode, breathing mode, Dream rainbow, Hair-trigger, walk in the rain, rainbow roulette, button ripples. stars, flow, follow, is dazzling wave, rotating windmill. Colourful waterfall, flower-rich, game mode (four directional keys and W/A/S/D and ESC a total of 9 keys bright blue light).
- With the driver, the key light colour can be customized.

## FN KEY COMBINATION DESCRIPTION (LIGHTING FUNCTION)

Fn +	~`	1!	2@	3#	A	S	Del
	2.4G	BT1	BT2	BT3	Windows System	Mac System	Light mode switching
	End	\	{[	]}]	:;	"'	Win
	Side light mode switch	Side light color switch	Side light brightness -	Side light brightness+	Side light speed -	Side light speed+	Lock Win key
	▲	▼	▶	◀	⏏	R Shift	Esc
	Backlight brightness +	Backlight brightness-	Backlight speed +	Backlight speed -	Backlight color switch	On/off backlight	Factory recovery
	+ =	2	8	6	4	Home	
	Status indicator color change	Status indicator brightness -	Status indicator brightness +	Status indicator speed +	Status indicator speed -	Status indicator Pattern change	

- Fn+Win= Lock/unlock the Win key (in Windows, when the indicator is steady on, the Win key cannot be used).
- In the Windows system, if you switch to the Mac system mode, the Win and left Alt keys will be switched, and F1-F12 is the multimedia key function.
- Fn+1= BT device 1, short press to switch, long press 3s pairing.
- Fn+2= BT device 2, short press to switch, long press 3s pairing.
- Fn+3= BT device 3, short press to switch, long press 3s pairing.

#### WINDOWS: FN KEY COMBINATION DESCRIPTION (MULTIMEDIA FUNCTION)

Key position	F1	F2	F3	F4	F5	F6
single press	F1	F2	F3	F4	F5	F6
Fn combination	Brightness -	Brightness +	Win+Tab	Win+E	/	/

Key position	F7	F8	F9	F10	F11	F12
single press	F7	F8	F9	F10	F11	F12
Fn combination	previous piece	play / Pause	next track	Mute	volume-	volume+

#### MAC: FN KEY COMBINATION DESCRIPTION (MULTIMEDIA FUNCTION)

Key position	F1	F2	F3	F4	F5	F6
single press	Brightness -	Brightness +	Win+Tab	Win+E	/	/
Fn combination	F1	F2	F3	F4	F5	F6

Key position	F7	F8	F9	F10	F11	F12
single press	previous piece	play / Pause	next track	Mute	volume-	volume+
Fn combination	F7	F8	F9	F10	F11	F12

Under the Windows system, after switching to the Mac system, the Win and left Alt keys will be swapped.

## POWER DISPLAY

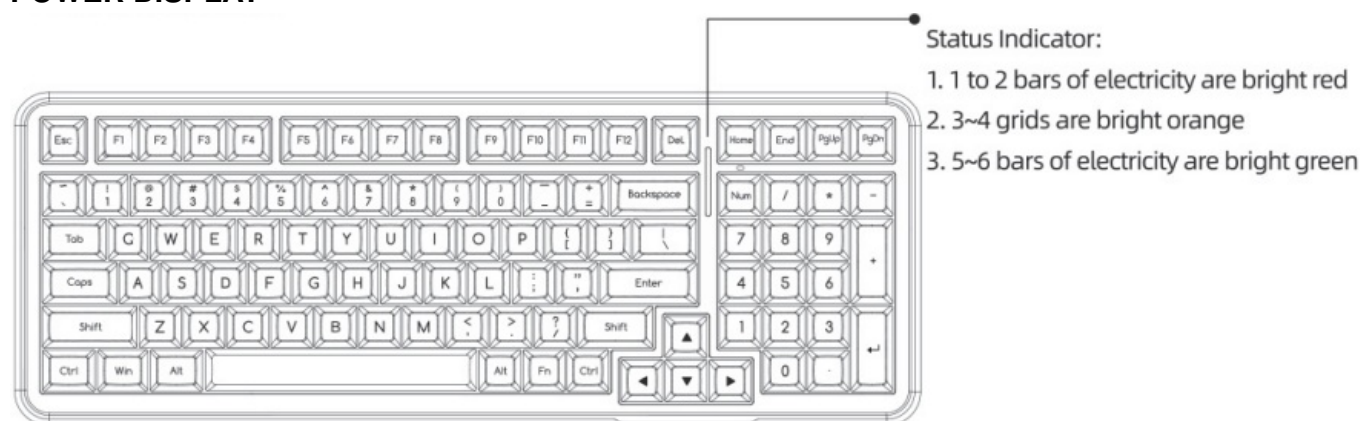

In the wireless mode (2.4G/BT) and the device is connected, the [Status Indicator] switches to the constant light mode, and the keyboard will display the battery percentage. There are 6 grids in total, the 1-2 grids are bright red, the 3-4 grids are orange, and the 5-6 grids are green. (Note: The power cannot be detected when the USB cable is connected)

## CHARGE

- Connect the keyboard to the computer through the equipped USB cable to charge the keyboard. During the charging process, the [status indicator] flows rapidly from bottom to top, After fully charged, the [Status Indicator] will return to normal lighting effect, and the charging lighting effect will only be displayed when the [Status Indicator] is always on.
- When the [Status Indicator] flashes red, please charge the keyboard in time.

## SPECIFICATIONS

- Product model: K99
- Transmission method: BT/2.4G/wired
- Charging cable length: about 2.1m
- Battery capacity: 6000mAh rechargeable lithium battery
- Charging voltage/current: DC 5V  $\approx$  1000mA

## INSTRUCTIONS FOR CHARGING

1. It is recommended to charge the keyboard only using the USB interface of the computer;
2. Do not use the fast charger to charge the keyboard;
3. Do not use poor quality non-standard power adapter to charge the keyboard;
4. Do not use the overvoltage and overcurrent power adapter to charge the keyboard;
5. Keep away from high-temperature devices when charging;
6. Turn off the power switch when not in use for a long time.

The above charging instructions also apply to other devices with a charging function (keyboard/mouse/headset/speaker, etc.)

**NOTE:** This equipment has been tested and found to comply with the limits for a Class B digital device, pursuant to part 15 of the FCC Rules.

These limits are designed to provide reasonable protection against harmful interference in a residential installation. This equipment generates, uses and can radiate radio frequency energy and, if not installed and used in accordance with the instructions, may cause harmful interference to radio communications. However, there is no guarantee that interference will not occur in a particular installation. If this equipment does cause harmful interference to radio or television reception, which can be determined by turning the equipment off and on, the user is encouraged to try to correct the interference by one or more of the following measures:

- Reorient or relocate the receiving antenna.
- Increase the separation between the equipment and the receiver.
- Connect the equipment to an outlet on a circuit different from that to which the receiver is connected.
- Consult the dealer or an experienced radio/TV technician for help.

Changes or modifications not expressly approved by the party responsible for compliance could void the user's authority to operate the equipment.

This device complies with Part 15 of the FCC Rules. Operation is subject to the following two conditions:

1. this device may not cause harmful interference, and
2. this device must accept any interference received, including interference that may cause undesired operation.

## WARRANTY CARD

Thank you for purchasing our products. If there are any quality problems during the warrant period, please contact us. Please provide this warranty card when contacting, so that we can provide you with perfect after-sales service.

- Product Model:
- Factory No.:
- Purchase Date:
- Purchase Address:
- Sales clerk:
- User Name:
- Warranty address:

- Warranty Contact:
- Contact Number:..
- Mail editor:



**Documents / Resources**

	<a href="#">MCHOSE K99 Mechanical Keyboard</a> [pdf] User Guide 2BERM-K99, 2BERMK99, K99, K99 Mechanical Keyboard, Mechanical Keyboard, Keyboard
-----------------------------------------------------------------------------------	-----------------------------------------------------------------------------------------------------------------------------------------------------

**References**

- [User Manual](#)

[Manuals+](#), [Privacy Policy](#)

This website is an independent publication and is neither affiliated with nor endorsed by any of the trademark owners. The "Bluetooth®" word mark and logos are registered trademarks owned by Bluetooth SIG, Inc. The "Wi-Fi®" word mark and logos are registered trademarks owned by the Wi-Fi Alliance. Any use of these marks on this website does not imply any affiliation with or endorsement.