

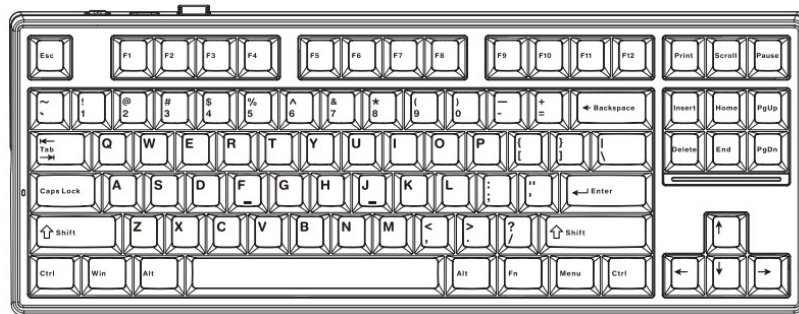

MCHOSE K87 Mechanical Keyboard User Guide

[Home](#) » [MCHOSE](#) » MCHOSE K87 Mechanical Keyboard User Guide 

MCHOSE – K87 User Guide – MECHANICAL KEYBOARD



Contents

- [1 K87 Mechanical Keyboard](#)
- [2 2.4G CONNECTION](#)
- [3 WIRELESS CONNECTION](#)
- [4 WIRED CONNECTION](#)
- [5 POWER SAVING MODE](#)
- [6 BACKLIGHT EFFECT](#)
- [7 FN KEY COMBINATION](#)
- [DESCRIPTION](#)
- [8 POWER DISPLAY](#)
- [9 CHARGING](#)
- [10 SPECIFICATION](#)
- [11 INSTRUCTIONS FOR CHARGING](#)
- [12 WARRANTY CARD](#)
- [13 Documents / Resources](#)
 - [13.1 References](#)

K87 Mechanical Keyboard

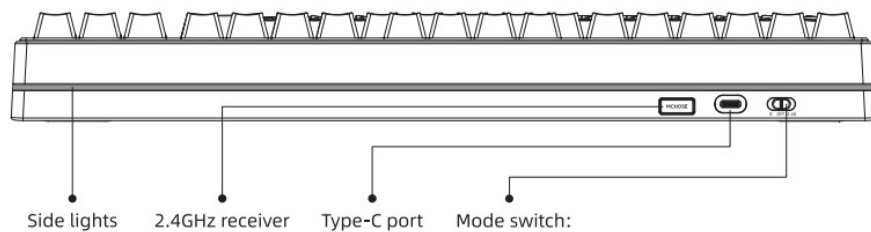

- 1.The left position [B] indicates wireless mode
- 2.The middle position [OFF] indicates USB wired mode
- 3.The right position [2.4G] 2.4GHz mode



Keyboard turning off: Switch the toggle to OFF and unplug the cable to disconnect.

Keyboard return rate: Wired mode 1000Hz, 2.4GHz mode 1000Hz, wireless mode 125Hz.

Attention: The images in this manual are all schematic diagrams and may deviate from the actual product. Please refer to the actual product for accuracy.

2.4G CONNECTION

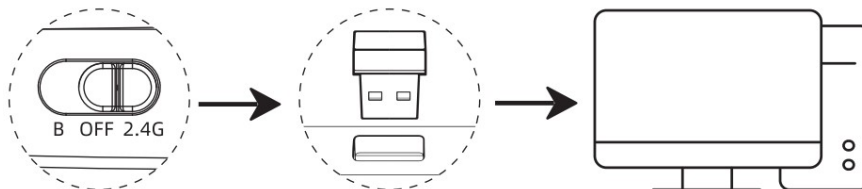

1. Switch the toggle to 2.4G to enter the 2.4GHz mode.
2. Open the cover from the upper right corner of the keyboard and take out the USB receiver from the slot.
3. Insert the USB receiver into the USB port on your computer. The keyboard is now ready for use.

• Manual pairing dongle: Switch the toggle to the position 2.4G to enter 2.4GHz mode. Press FN+`~ and hold for 3 seconds. The indicator will quickly flash GREEN to enter the pairing mode. Plug the included dongle into the desired device. [Indicator light] will become normal when the 2.4GHz wireless mode connect successful.

Note: The dongle is default paired.

WIRELESS CONNECTION

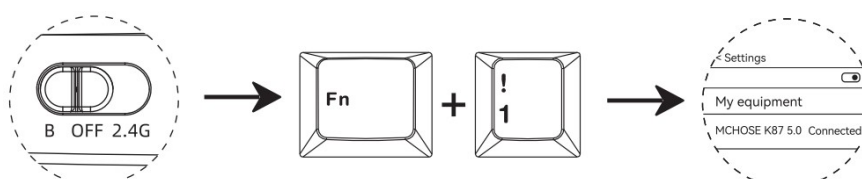

1. Switch the toggle to B to enter the wireless mode.

2. Press the combination key to switch to wireless1 and hold for about 3s until the blue light flashes quickly to activate wireless pairing.
3. Search for the wireless device name MCHOSE K87 3.0 or MCHOSE K87 5.0 on your device, and click to connect, the BT indicator light will go back to normal after successful pairing.

The wireless device names for channels 1, 2, and 3 are MCHOSE K87 3.0 or [MCHOSE K87 5.0 .

- The combination key of wireless channel 2 is [FN+2@ , and the [indicator light is purple;
- The combination key of wireless channel 3 is [FN+3# , and the indicator light is blue;

Press the combination key and hold for about 3s until the corresponding wireless channel indicator light flashes quickly, indicating that the keyboard has entered detect pairing or search mode, and can be paired and connected to the device;

- Press the combination key “Fn” + number keys “1”, “2”, or “3” to switch devices.

WIRED CONNECTION

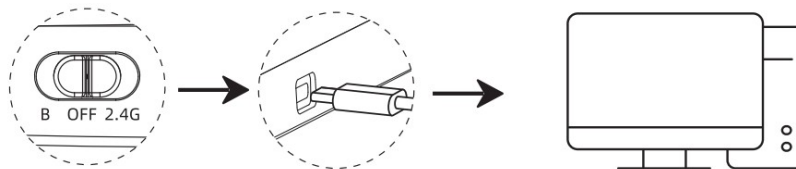

1. Switch the toggle to OFF to enter the wired mode.
2. Connect the cable to Type-C port of the keyboard.
3. Connect the cable to the USB port of the computer. The keyboard is ready to use.

POWER SAVING MODE

In wireless mode, the keyboard backlight will turn off after 3 minutes of sitting idle. And the keyboard will disconnect with the device after 30 minutes of sitting idle. Press any button to wake it up.

BACKLIGHT EFFECT

Press the FN+DEL key combination to switch 16 RGB backlights and light off:

1. Constant light mode
2. Breathing pattern
3. Dream Rainbow
4. Immediate trigger
5. Taking a walk in the rain
6. Ripple diffusion
7. Starry dots
8. Flowing endlessly
9. Go with the flow (default)
10. Accompanied like a shadow

11. Positive dazzling light wave
12. Rotating Windmill
13. Rainbow Waterfall
14. Flowers bloom for wealth and prosperity
15. Game mode default (four directional keys and a total of 9 keys for W/A/S/D and ESC to light up blue light)
(Combined with the driver, button light color customization can be achieved)
16. Turn off the lights

FN KEY COMBINATION DESCRIPTION

	Combination key	function
1	FN + ESC	Press and hold FN+ESC for 3 seconds to restore factory settings
2	FN + Left WIN	Lock/Unlock Win Key
3	FN + A	switches to Windows system
4	FN + 5	switches to Mac system
5	FN +- Long press 35	2.4G pairing
6	FN + 1!	wireless Channel 1 Switch (Short press to switch, long press for 3 seconds to pair)
7	FN + 2@	wireless Channel 2 Switch [Short press to switch, long press for 3 seconds to pair)
8	EN + 3#	wireless Channel 3 Switch (Short press to switch, long press for 3 seconds to pair)
9	FN + Right Shift	to turn keyboard backlight on/off
10	FN + DEL	keyboard lighting mode switching
11	EN + ↑	Backlight brightness increase
12	EN + ↓	Backlight brightness decrease
13	EN + →	Backlight speed increase
14	EN + ←	Backlight speed reduction
15	EN + - _	Backlight color switching
16	FN + END	side light mode switching
17	EN + [{	Side light brightness adjustment [5-level adjustable: off -25% -50% -75% -100% (default 100%)]
18	EN +] }	Side light speed adjustment [3 levels adjustable: default second level]
19	EN + \	side light breathing and constant light mode, switch colors: red green blue orange purple blue white
20	FN + HOME	LOGO light mode change
21	EN + =+	LOGO light color switching
22	FN + ;:	LOGO light speed reduction (3rd gear adjustable: default second gear]
23	FN + ‘”	LOGO light speed increase 13rd gear adjustable: default second gearl
24	FN + Page Dn	LOGO light brightness reduction (5-level adjustable: off -25% (default) -50% -75% -100%1
25	FN + Page up	LOGO light brightness increase (5-level adjustable: off -25% (default) -50% -75% -100%1

• **WINDOWS SYSTEM: FN KEY COMBINATION INSTRUCTIONS (MULTIMEDIA FUNCTIONS)**

Key position	F1	F2	F3	F4	F5	F6
single press	Screen brightness –	Screen brightness +	Convert Window	Resource manager	/	/
Fn combination	F1	F2	F3	F4	F5	F6
Key position	F7	F8	F9	F10	F11	F12
single press	Previous song	play / Pause	Next song	Mute	volume-	volume+
Fn combination	F7	F8	F9	F10	F11	F12

• MAC SYSTEM: FN KEY COMBINATION INSTRUCTIONS (MULTIMEDIA FUNCTIONS)

Key position	F1	F2	F3	F4	F5	F6
single press	Screen brightness –	Screen brightness +	Convert Window	Resource manager	/	/
Fn combination	F1	F2	F3	F4	F5	F6
Key position	F7	F8	F9	F10	F11	F12
single press	Previous song	play / Pause	Next song	Mute	volume-	volume+
Fn combination	F7	F8	F9	F10	F11	F12

*In the Windows system, after switching to the Mac system, the Win and Left Alt keys will be swapped.

POWER DISPLAY

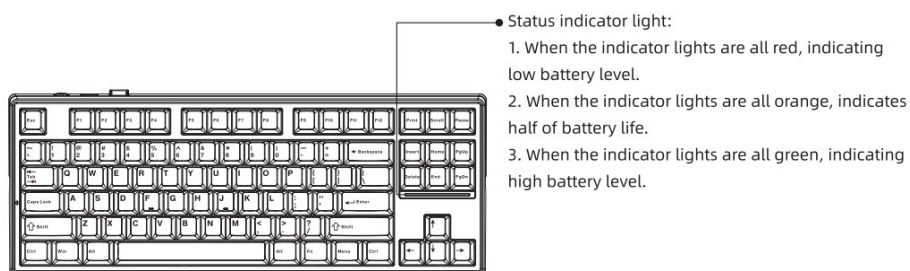

When in wireless mode (2.4GHz/wireless) and the device is connected, the status indicator light switches to the normally light on mode, and the keyboard will display the battery life. (Note: The battery life cannot be detected when connecting the USB cable)

CHARGING

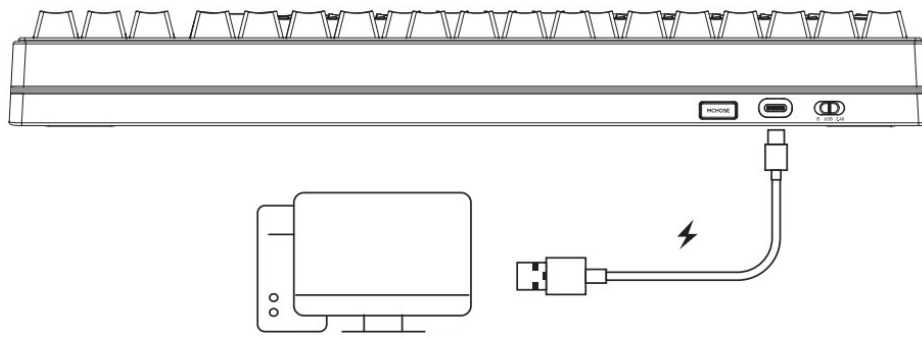

By connecting the keyboard to the computer through the equipped USB cable, the keyboard can be charged. During the charging process, the status indicator light quickly flows from left to right. After being fully charged, the status indicator light returns to normal light effect, and the charging light effect is only displayed when the status indicator light is in a constant light mode.

When the ambient light bar is fully red, please charge the keyboard on time.

SPECIFICATION

Product model: K87

Connectivity: wireless/2.4GHz/Wired

Charging interface: Type-C

Battery capacity: 6000mAh rechargeable lithium battery

Charging voltage/current: DC 5V 1.5A

NOTE: This equipment has been tested and found to comply with the limits for a Class B digital device, pursuant to part 15 of the FCC Rules. These limits are designed to provide reasonable protection against harmful interference in a residential installation. This equipment generates, uses and can radiate radio frequency energy and, if not installed and used in accordance with the instructions, may cause harmful interference to radio communications. However, there is no guarantee that interference will not occur in a particular installation. If this equipment does cause harmful interference to radio or television reception, which can be determined by turning the equipment off and on, the user is encouraged to try to correct the interference by one or more of the following measures:

- Reorient or relocate the receiving antenna.
- Increase the separation between the equipment and receiver.
- Connect the equipment into an outlet on a circuit different from that to which the receiver is connected.
- Consult the dealer or an experienced radio/TV – technician for help.

Changes or modifications not expressly approved by the party responsible for compliance could void the user's authority to operate the equipment.

This device complies with Part 15 of the FCC Rules. Operation is subject to the following two conditions: (1) this device may not cause harmful interference, and (2) this device must accept any interference received, including interference that may cause undesired operation.

INSTRUCTIONS FOR CHARGING

1. It is recommended to charge the keyboard only using the USB interface of the computer;
2. Do not use the fast charger to charge the keyboard;
3. Do not use poor quality non-standard power adapter to charge the keyboard;
4. Do not use the overvoltage and overcurrent power adapter to charge the keyboard;
5. Keep away from high temperature devices when charging;
6. Turn off the power switch when not in use for a long time

The above charging instructions also apply to other devices with charging function (keyboard/mouse/headset/speaker, etc.)

WARRANTY CARD

Thank you for purchasing our products. If there are any quality problems during the warranty period, please contact us. Please provide this warranty card when contacting, so that we can provide you with perfect after-sales service.

Product Model: _____ User Name: _____
Factory No.: _____ Warranty address: _____
Purchase Date: _____ Warranty Contact: _____
Purchase Address: _____ Contact Number: _____
Sales clerk: _____ Mail editor: _____



Documents / Resources

	MCHOSE K87 Mechanical Keyboard [pdf] User Guide 2BERM-K87, 2BERMK87, k87, K87 Mechanical Keyboard, K87 Keyboard, Mechanical Keyboard, Keyboard
--	---

References

- [User Manual](#)

[Manuals+](#), [Privacy Policy](#)

This website is an independent publication and is neither affiliated with nor endorsed by any of the trademark owners. The "Bluetooth®" word mark and logos are registered trademarks owned by Bluetooth SIG, Inc. The "Wi-Fi®" word mark and logos are registered trademarks owned by the Wi-Fi Alliance. Any use of these marks on this website does not imply any affiliation with or endorsement.