

MCHOSE G98 Mechanical Keyboard



MCHOSE G98 Mechanical Keyboard User Guide

[Home](#) » [MCHOSE](#) » MCHOSE G98 Mechanical Keyboard User Guide 

Contents

1 MCHOSE G98 Mechanical Keyboard

2 2.4GHZ CONNECTION

3 SPECIFICATIONS

4 Documents / Resources

4.1 References

5 Related Posts

MCHOSE

MCHOSE G98 Mechanical Keyboard



Mode switch:

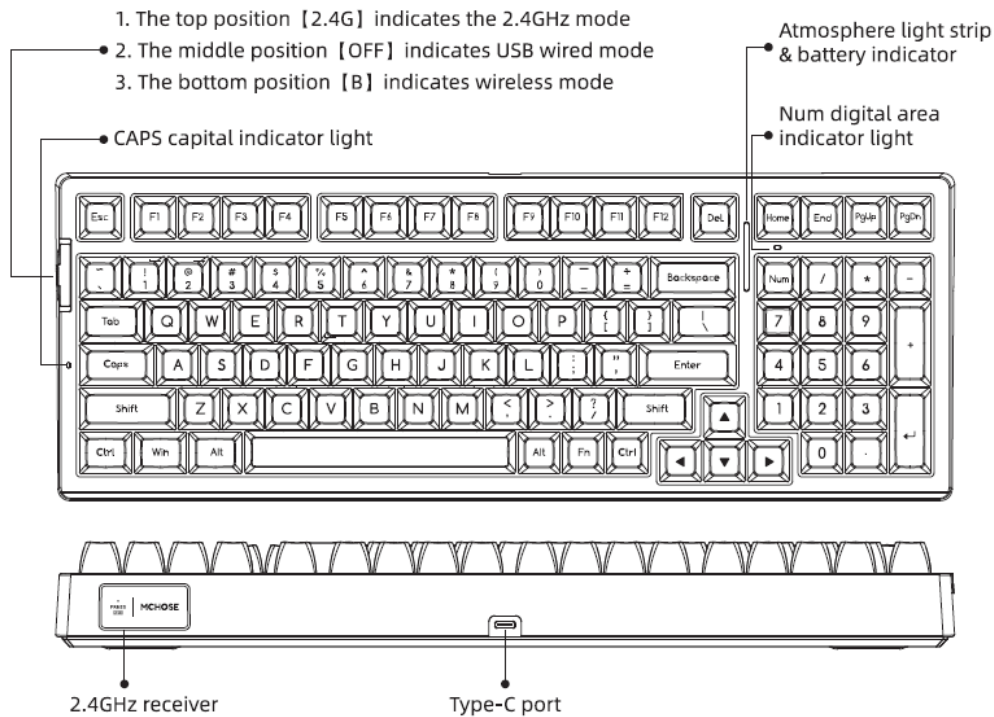

- **Keyboard turning off:** Switch the toggle to (OFF) and unplug the cable to disconnect.
- **Keyboard return rate:** Wired mode 1000Hz, 2.4GHz mode 1000Hz, wireless mode 125Hz.
- **Attention:** The images in this manual are all schematic diagrams and may deviate from the actual product. Please refer to the actual product for accuracy.

2.4GHZ CONNECTION

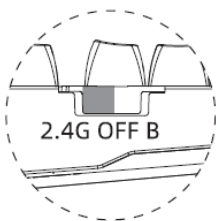

- ① Switch the toggle to [2.4G] to enter the 2.4GHz mode.

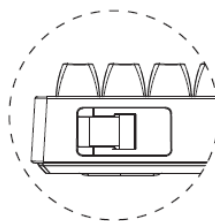

- ② Open the cover from the upper right corner of the keyboard and take out the USB receiver from the slot.

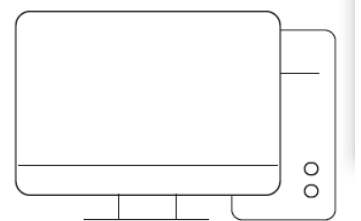

- ③ Insert the USB receiver into the USB port on your computer. The keyboard is now ready for use.

- **Manual pairing dangle:** Switch the toggle to the position (2.4G) to enter 2.4GHz mode. Press (FN+~) and hold for 3 seconds.
- The indicator will quickly flash GREEN to enter the pairing mode. Plug the included dangle into the desired device. The indicator stays GREEN for 2 seconds and completes the 2.4GHz pairing.
- **Note:** When connecting to 2.4GHz, search first and then plug the receiver. The dangle is default paired.

WIRELESS CONNECTION

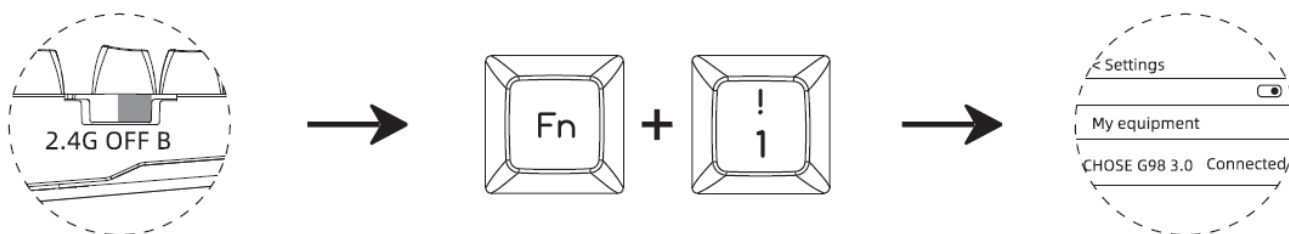

- G98 version: The wireless device names for channels 1, 2, and 3 are [MCHOSE G98 3.0] or [MCHOSE G98 5.0] •
- G98 PRO version: The wireless device names for channels 1, 2, and 3 are [MCHOSE G98 PRO 3.01] or [MCHOSE G98 PRO 5.01] .
- The combination key of wireless channel 2 is [FN+2@], and the [indicator light] is blue;
- The combination key of wireless channel 3 is [FN+3#], and the [indicator light] is blue;
- Press the combination key and hold for about 3 seconds until the corresponding wireless channel indicator light flashes quickly, indicating that the keyboard has entered detect pairing or search mode, and can be paired and connected to the device;
- Press the combination key “Fn” + number keys “1!”, “2@”, or “3#” to switch devices.

Wired Connection

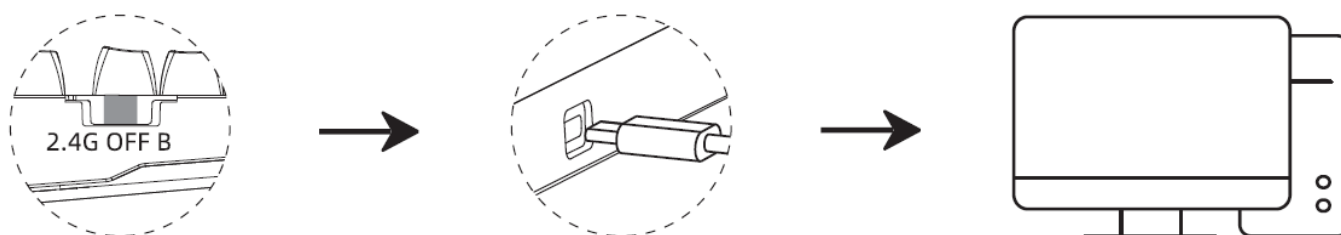

1. Switch the toggle to [OFF] to enter the wired mode.
2. Connect the cable to Type-C port of the keyboard.
3. Connect the cable to the USB port of the computer. The keyboard is ready to use.

POWER SAVING MODE

In wireless/2.4GHz mode, the mouse will go to Auto-sleep mode after 1 minute of sitting idle. Press any button to wake it up.

BACKLIGHT EFFECT

Press the “FN” + “\|” key combination to switch 15 RGB backlights and light off, a total of 16 lighting effects:

Following the flow (restoring default rear light effects), following the shadows, sinusoidal light waves, spinning windmills, colorful waterfalls, blooming flowers and wealth, game mode, off, Constant light mode, breathing mode, dreamy rainbow, ready to explode, strolling in the rain, button ripples, starry dots, an endless stream. In conjunction with the driver’s RGB lighting effect with music rhythm, there are 10 lighting modes to choose from under this lighting effect.

FN KEY COMBINATION DESCRIPTION (LIGHTING FUNCTION)

Fn +	ESC	~`	1!	2@	3#
	Restore default	2.4GHz pairing	wireless device 1	wireless device 2	wireless device 3
	Q	W	E	R	\
	Android system	Win system	Mac system	IOS system	Light mode switching
	TAB	↑	↓	←	→
	Light effect color switching	Light brightness+	Light brightness-	Light speed-	Light speed+
	Right Shift	/?	B	Right Alt	Right Ctrl
	Switching Atmosphere Light Bar Mode	Change the color of the light bar	Switch the light bar to power	Atmosphere light bar brightness cycle	Atmosphere light bar speed cycle
	WIN	DEL	U	I	O
	Lock/Unlock WIN	INS	PRTSC	SCRLK	PAUSE

- Fn+Win=Lock/Unlock Win Key (In Windows systems, the indicator light remains on when the Win key is locked, and the Win key cannot be used).
- In the Windows system, if switching to Mac/iOS system mode, the Win and Left Alt keys will be swapped, and F1-F12 is the multimedia button function.
- Fn+1!=wireless device 1, short press to switch, long press for 3 seconds to pair.
- Fn+2@=wireless device 2, short press to switch, long press for 3 seconds to pair.
- Fn+3#=wireless device 3, short press to switch, long press for 3 seconds to pair.

WINDOWS SYSTEM: FN KEY COMBINATION INSTRUCTIONS (MULTIMEDIA FUNCTIONS)

Key position	F1	F2	F3	F4	F5	F6
single press	F1	F2	F3	F4	F5	F6
Fn combination	home page	mail	Convert Window	Resource Manager	Light brightness-	Light brightness+

Key position	F7	F8	F9	F10	F11	F12
single press	F7	F8	F9	F10	F11	F12
Fn combination	Previous song	play / Pause	Next song	Mute	volume-	volume+

• MAC SYSTEM: FN KEY COMBINATION INSTRUCTIONS (MULTIMEDIA FUNCTIONS)

Key position	F1	F2	F3	F4	F5	F6
single press	Screen brightness -	Screen brightness +	Convert Window	Return to desktop	Light brightness-	Light brightness+
Fn combination	F1	F2	F3	F4	F5	F6

Key position	F7	F8	F9	F10	F11	F12
single press	Previous song	play / Pause	Next song	Mute	volume-	volume+
Fn combination	F7	F8	F9	F10	F11	F12

In the Windows system. after switching to the Mac system. the Win and Left Alt kevs will be swapped.

ANDROID SYSTEM: FN KEY COMBINATION INSTRUCTIONS (MULTIMEDIA FUNCTIONS)

Key position	F1	F2	F3	F4	F5	F6
single press	Screen brightness -	Screen brightness +	Convert Window	Return to desktop	Light brightness-	Light brightness+
Fn combination	F1	F2	F3	F4	F5	F6

Key position	F7	F8	F9	F10	F11	F12
single press	Previous song	play / Pause	Next song	Mute	volume-	volume+
Fn combination	F7	F8	F9	F10	F11	F12

• IOS SYSTEM: FN KEY COMBINATION INSTRUCTIONS (MULTIMEDIA FUNCTION)

Key position	F1	F2	F3	F4	F5	F6
single press	Screen brightness -	Screen brightness +	Convert Window	Return to desktop	Light brightness-	Light brightness+
Fn combination	F1	F2	F3	F4	F5	F6

Key position	F7	F8	F9	F10	F11	F12
single press	Previous song	play / Pause	Next song	Mute	volume-	volume+
Fn combination	F7	F8	F9	F10	F11	F12

In the Windows system, after switching to the IOS system, the Win and Left Alt keys will be swapped.

POWER DISPLAY

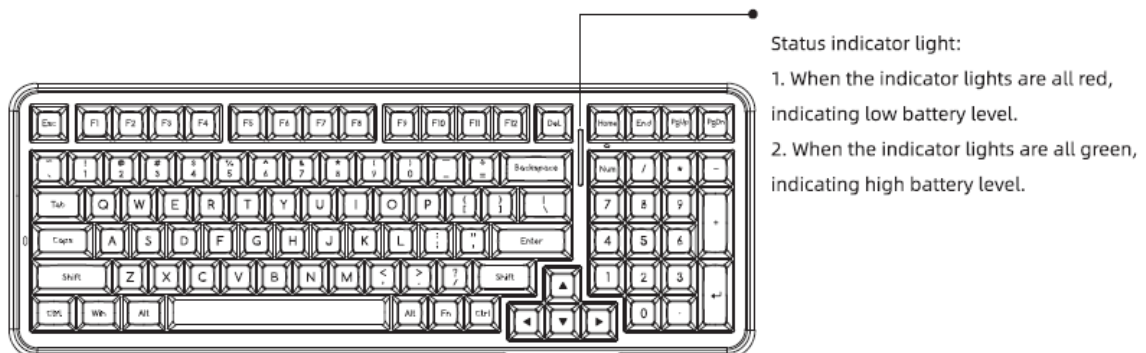

In 2.4GHz/wireless mode (without USB inserted), the RGB ambient light bar can display the keyboard battery level by pressing FN+B. When fully charged, it will be displayed in green. As the battery level decreases, the green color will gradually decrease, and when low, it will be displayed in red.

CHARGING

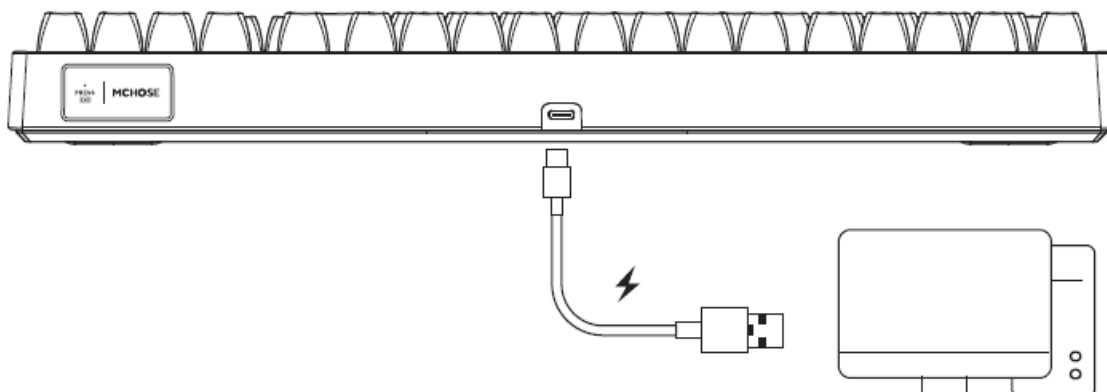

Connect the keyboard to the computer through the equipped USB cable to charge the keyboard. During charging,

the RGB ambient light strip flash flowing. When the keyboard is fully charged, the light will stay GREEN. When the ambient light bar stays RED, please charge the keyboard on time.

SPECIFICATIONS

- Product model: G98 / G98 PRO
- Connectivity: wireless/2.4GHz/Wired
- Charging interface: Type-C
- Charging voltage/current: DC 5V == 1.5A

NOTE: This equipment has been tested and found to comply with the limits for a Class B digital device, pursuant to part 15 of the FCC Rules. These limits are designed to provide reasonable protection against harmful interference in a residential installation. This equipment generates, uses and can radiate radio frequency energy and, if not installed and used in accordance with the instructions, may cause harmful interference to radio communications. However, there is no guarantee that interference will not occur in a particular installation. If this equipment does cause harmful interference to radio or television reception, which can be determined by turning the equipment off and on, the user is encouraged to try to correct the interference by one or more of the following measures:

- Reorient or relocate the receiving antenna.
- Increase the separation between the equipment and receiver.
- Connect the equipment into an outlet on a circuit different from that to which the receiver is connected.
- Consult the dealer or an experienced radio/TV technician for help.
- Changes or modifications not expressly approved by the party responsible for compliance could void the user's authority to operate the equipment.
- This device complies with Part 15 of the FCC Rules. Operation is subject to the following two conditions:
 1. this device may not cause harmful interference, and
 2. this device must accept any interference received, including interference that may cause undesired operation.

CHARGING INSTRUCTIONS

1. It is recommended to only use the computer USB interface to charge the keyboard;
2. Do not use a fast charging mobile phone charger to charge the keyboard;
3. Do not use inferior non-standard power adapters to charge the keyboard;
4. Do not use an overvoltage and overcurrent power adapter to charge the keyboard;
5. Please stay away from high-temperature equipment when charging;
6. Please turn off the power switch when not in use for a long time. The above charging instructions also apply to other devices with charging functions (keyboard/mouse/headphones/speakers, etc.)

WARRANTY CARD

Thank you for purchasing our company's products. If there are any quality issues with the products during the warranty period, please contact us. Please provide this warranty card when contacting us so that we can provide you with comprehensive after-sales service.

- Product model:
- User Name:

- Factory number:
- Warranty address:
- Purchase date:
- Warranty contact person:
- Purchase address:
- Salesperson:
- Contact phone number:
- Postal Code.

Documents / Resources

	MCHOSE G98 Mechanical Keyboard [pdf] User Guide G98, G98 Mechanical Keyboard, Mechanical Keyboard, Keyboard
---	--

References

- [User Manual](#)

Manuals+, Privacy Policy

This website is an independent publication and is neither affiliated with nor endorsed by any of the trademark owners. The "Bluetooth®" word mark and logos are registered trademarks owned by Bluetooth SIG, Inc. The "Wi-Fi®" word mark and logos are registered trademarks owned by the Wi-Fi Alliance. Any use of these marks on this website does not imply any affiliation with or endorsement.