

MCHOSE
A7 Wireless Mouse



MCHOSE A7 Wireless Mouse User Manual

[Home](#) » [MCHOSE](#) » MCHOSE A7 Wireless Mouse User Manual 

Contents

- [1 MCHOSE A7 Wireless Mouse](#)
- [2 PRODUCT OVERVIEW](#)
- [3 CONNECTION MODE](#)
- [4 indicator Status](#)
- [5 FCC NOTE](#)
- [6 WARRANTY CARD](#)
- [7 Documents / Resources](#)
 - [7.1 References](#)
- [8 Related Posts](#)

MCHOSE

MCHOSE A7 Wireless Mouse



PRODUCT OVERVIEW

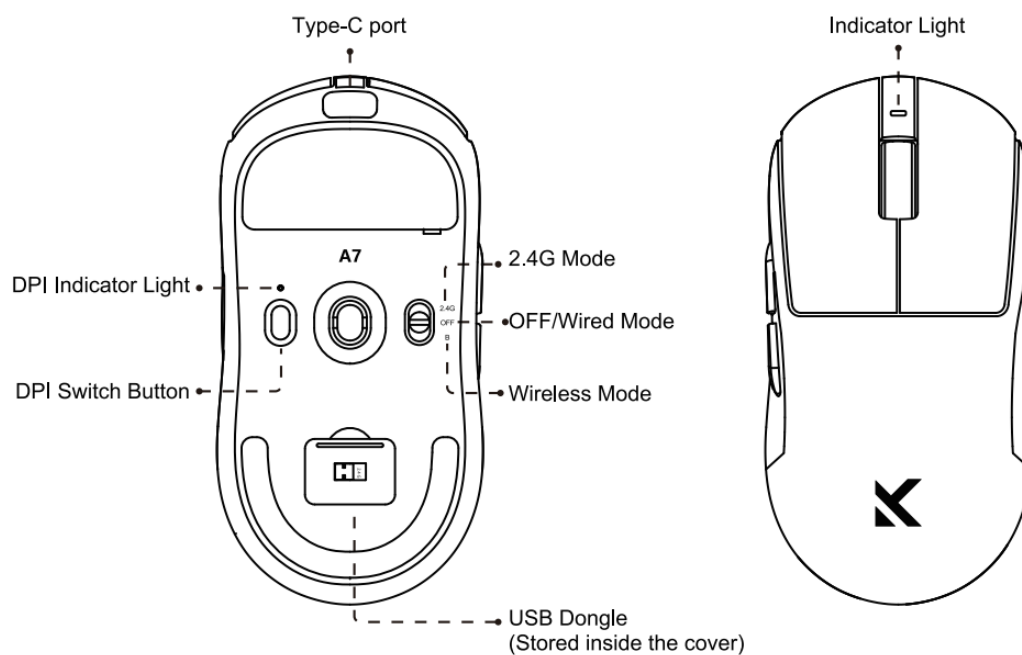

Tips: The pictures in this manual are schematic diagrams and may differ from the actual product. Please refer to the actual product.

CONNECTION MODE

1. Charging/Wired Connection

- Connect the cable to the Type-C port of the mouse, and connect the cable to the USB port of the computer. The mouse is ready to use.
- In 2.4G/wireless mode, plugging in the USB cable automatically switches the mouse to wired mode and simultaneously charges the mouse.

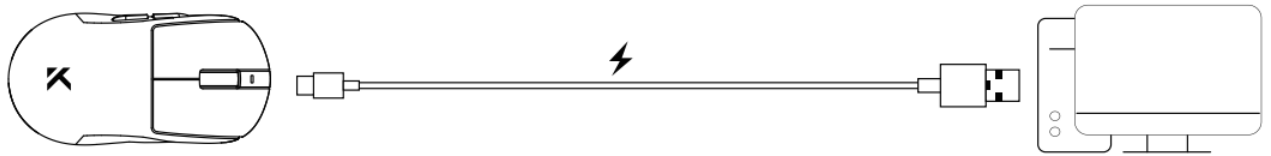

2. 2.4G Connection

- Switch the toggle to [2.4G]. Take out the USB dongle at the bottom of the mouse and insert it into the USB port of the computer. The mouse is now ready for use.
- Manual pairing dongle {The dongle is default paired}: Press the [Left], [Middle], and [Right] buttons of the mouse simultaneously for about 3 seconds. The indicator light flashes to enter the pairing status. Insert the USB dongle into the USB port of the computer. The mouse is close to the USB dongle (within 20cm), and the [Indicator light] will be off after a successful connection.

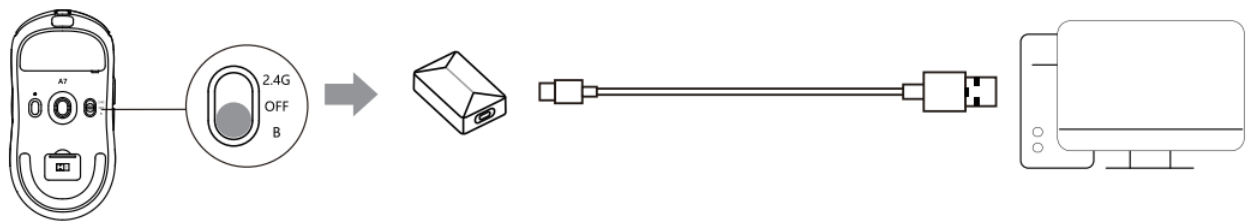

3. Wireless Connection

Switch the toggle to [B]. Press the [Left], [Middle], and [Right] buttons of the mouse simultaneously for about 3 seconds. The indicator light flashes to enter the search status. Search for the computer device with the pairing name [MCHOSEA7]/ [MCHOSEA7PTO]/ [MCHOSEA7Max]. The indicator light will be off after the connection is successful.

③ Wireless Connection

Press at the same time for about 3 seconds

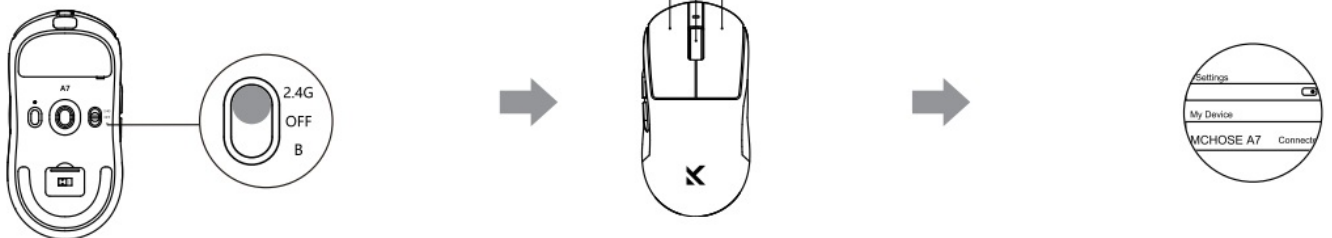

indicator Status

DPI Switch

Click the bottom of the mouse [DPI Switch] to cycle through the six DPI levels. DPI supports driver adjustment.

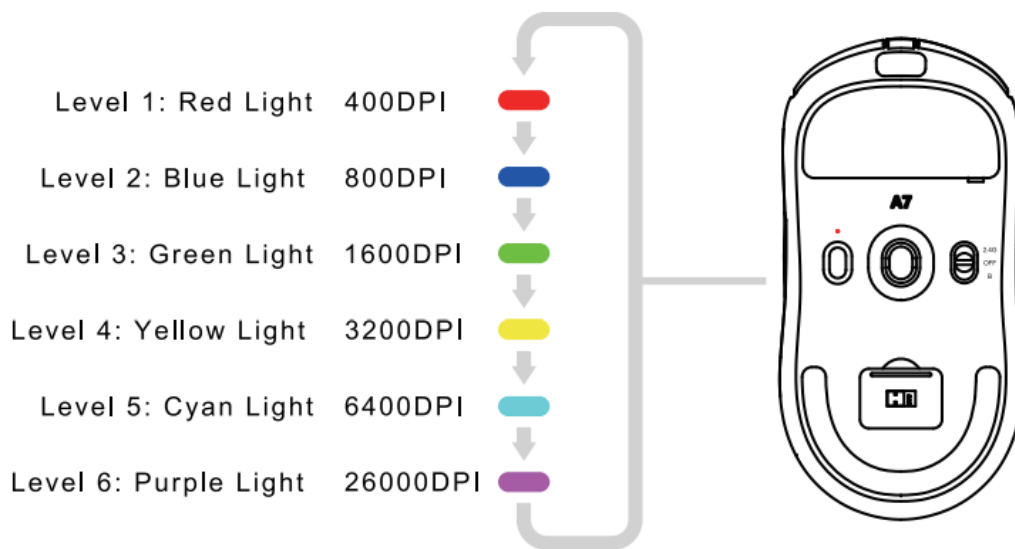

Note: A7 Ultra is a 3950 sensor with 42000 DPI in purple light.

Battery Status Indicator

When the [Indicator Light] flashes red please charge the mouse promptly.

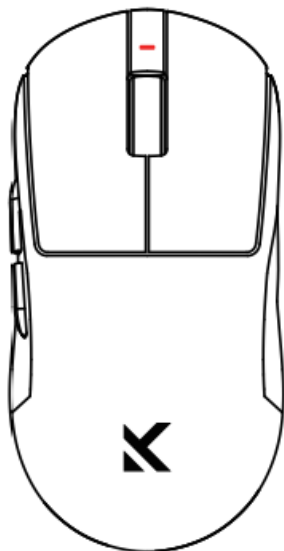

- The red indicator light is flashing: Please charge immediately.
- The red indicator light is on: Charging in progress.
- The green indicator light is on: Charging completed.

FCC NOTE

Note: This device has been tested and complies with the limits for Class B digital devices under Part 15 of the FCC Rules. These limits are designed to provide reasonable protection against harmful interference in residential installations.

This device generates, uses, and can radiate radio frequency energy, and if not installed and used by the instructions, may cause harmful interference to radio communications. However, there is no guarantee that interference will not occur in a particular installation. If this device does cause harmful interference to radio or television reception (which can be determined by turning the device off and on), we encourage the user to try one or more of the following measures to correct the interference:

- Reorient or relocate the receiving antenna.
- Increase the separation between the equipment and the receiver.
- Connect the equipment to an outlet on a circuit different from that to which the receiver is connected.
- Consult the dealer or an experienced radio/TV technician for help.

Changes or modifications not expressly approved by the responsible party could void the user's authority to operate the equipment.

This device complies with Part 15 of the FCC Rules. Operation is subject to the following two conditions:

1. This device may not cause harmful interference.
2. This device must accept any interference received, including interference that may cause undesired operation.

CHARGING INSTRUCTIONS

1. It is recommended to charge the keyboard only via a computer USB port.
2. Avoid using substandard or non-compliant power adapters to charge the keyboard.
3. Avoid using over-voltage or over-current power adapters for charging.
4. Keep the keyboard away from high-temperature devices while charging.
5. Please turn off the power switch if the device will not be used for an extended period.

These charging instructions also apply to other rechargeable devices {keyboard/mouse/headphones/ speakers, etc.)

WARRANTY CARD

Thank you for purchasing our product. Please contact us If there are any quality issues within the warranty period. Please provide this warranty card so we can provide comprehensive after-sales service.

Product Items: _____

Customer Name: _____

Serial No. : _____

Contact Address: _____

Purchase Date: _____

TEL / E-mail: _____

Purchase Channel: _____

Postcode: _____

Documents / Resources



[MCHOSE A7 Wireless Mouse](#) [pdf] User Manual
A7 Wireless Mouse, A7, Wireless Mouse, Mouse

References

- [User Manual](#)

This website is an independent publication and is neither affiliated with nor endorsed by any of the trademark owners. The "Bluetooth®" word mark and logos are registered trademarks owned by Bluetooth SIG, Inc. The "Wi-Fi®" word mark and logos are registered trademarks owned by the Wi-Fi Alliance. Any use of these marks on this website does not imply any affiliation with or endorsement.