

 **MCGREY**
6170 61 Key
Battery Keyboard



MCGREY 6170 61 Key Battery Keyboard User Manual

[Home](#) » [MCGREY](#) » MCGREY 6170 61 Key Battery Keyboard User Manual 

Contents

- [1 MCGREY 6170 61 Key Battery Keyboard](#)
- [2 Product Usage Instructions](#)
- [3 Assembly Instructions](#)
- [4 Rear connection panel](#)
- [5 Troubleshooting](#)
- [6 Product specifications](#)
- [7 WEEE Declaration \(Waste of Electrical and Electronic Equipment\)](#)
- [8 Documents / Resources](#)
 - [8.1 References](#)



MCGREY 6170 61 Key Battery Keyboard



Specifications

- Model: 6170 Keyboard
- Version: 08/2022
- Dimensions (W x D x H): As per specifications
- Power Supply: Power adapter included

Product Usage Instructions

Preparation

Before using the keyboard for the first time, ensure it is fully charged. The power button will indicate the charging status with a red light. When fully charged, the light will go out.

Operating Elements

- **POWER:** Press this button to turn on the keyboard. Remember to turn it off when not in use to save power.
- **VOLUME:** Adjust the volume using this knob.

Assembly Instructions

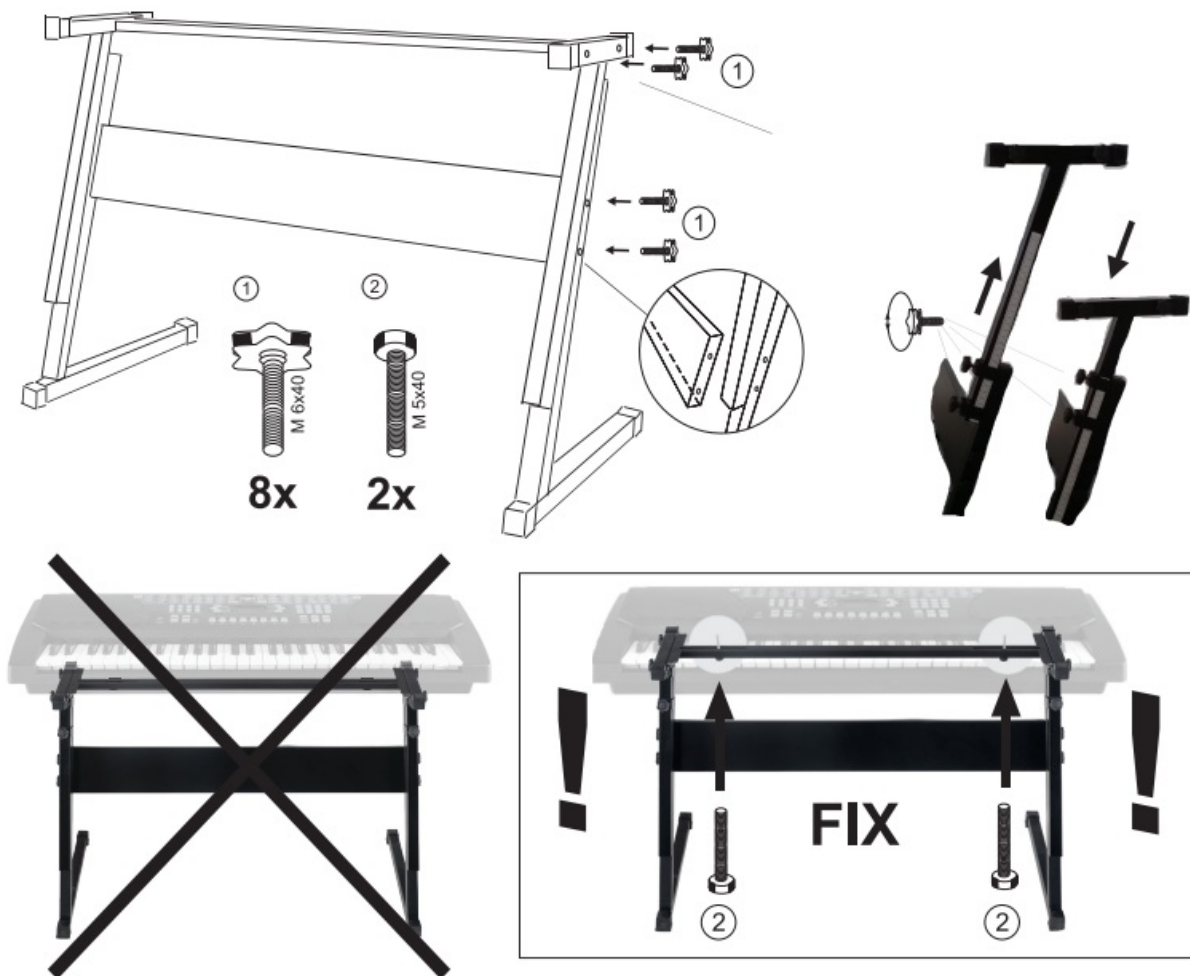

Thank you for choosing this product.

To ensure that you are fully satisfied with this product, carefully read and understand this manual before using this instrument. Keep this manual in a safe place. The operating instructions must be passed on to all subsequent users.



Observe operating instructions!

⚠ WARNING

The WARNING signal word identifies hazards that, without precautions, could result in serious injury.

⚠ NOTE

The signal word NOTE indicates general precautions that should be observed when handling the product.

⚠ NOTE

Images and screen images in this manual may differ slightly from the actual product's appearance, as long as it does not adversely affect the technical characteristics and safety of the product.

⚠ NOTE

All personal phrasing in this manual should be considered gender-neutral.

These operating instructions apply to responsible persons and users who have been supervised by a person responsible for their safety or instructed in the operation of the device and who have proven to be able to handle the device.

⚠ WARNING

- Children should be supervised to ensure that they do not use this device as a toy.

- Never allow children to play unattended with the packaging material.



- Danger of property damage! We are not liable for accidents that occur as a result of non-observance of the safety instructions or due to incorrect handling.

All information in this manual has been checked to the best of our knowledge and belief. However, neither the author nor the publisher can be held liable for any damage related to the use of this manual. Other product, brand, and company names mentioned herein may be the trademarks of their respective owners. Compliance with all applicable copyright laws is the responsibility of the user of this document.



Caution

Please observe the following basic information in order not to endanger yourself or others and to avoid damage to external devices.

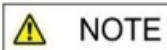

Warning

- Do not disassemble the instrument and do not modify it. This could result in electric shock. Entrust a specialist workshop with any necessary service and maintenance or contact your dealer.
- If you notice that the power cord is showing signs of wear, the unit shows malfunctions, burns, smells, or smokes, unplug the power cord immediately and have a technician repair it. Before you clean the instrument, you should disconnect it from the main power.
- Always place the instrument on a level, stable surface to ensure a secure footing.
- Do not use the instrument in a damp environment.
- Do not place vessels that are filled with liquids on the instrument, such as vases, glasses, or bottles.
- Do not place small objects on it that could slip in, such as hairpins, sewing needles, or coins. Do not place burning candles on the instrument.

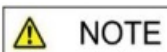

Precautions

- To avoid damage to the instrument, do not place it in places with high temperatures or dust, do not place it next to an air conditioner and avoid direct sunlight.
- Do not place the instrument near other electrical equipment to avoid interference.
- Do not use force when handling the instrument or place heavy objects on it.
- Disconnect the instrument from the power if you are not going to use it for a long time. To disconnect the device from the mains, pull the plug, not the cable. Please handle the power cable with care. It should not be near radiators, you should not place heavy objects on it and move it so that people can not step on it or fall over it.
- Please note that continuous high volume can permanently damage your hearing. Adjust the volume carefully.



Power adapter

Please connect the supplied power adapter to a power outlet with the correct voltage. Do not connect it to mains voltages other than those for which the instrument is intended. Unplug the power cord if you are not going to use the product for a long time or if there is a coming thunderstorm.

© 2022

These operating instructions are protected by copyright. The reproduction of these operating instructions, even in part, is only permitted with the approval of Musikhaus Kirstein GmbH. The same applies to the reproduction or copying of images, even in modified form.

Preparation

Please charge the instrument completely before using it for the first time. The power button lights up red as a charge control indicator when the battery is charged. When the battery is fully charged, the charge indicator goes out.

Operating elements

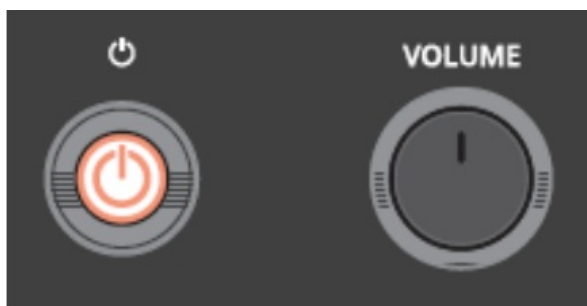

POWER

Press the POWER button to turn on the instrument. Please turn off your instrument when not in use to save power.

VOLUME

This knob allows you to adjust the volume of your keyboard.



TONE

Press TONE to enter the tone selection menu. Press the number buttons or + – to select the desired tone.

RHYTHM

Press RHYTHM to enter the rhythm accompaniment selection menu. Use the number buttons or + – to select the rhythm you want.



START / STOP.

Press START/STOP to start or stop the rhythm accompaniment.

TEMPO

Pressing the TEMPO + or TEMPO – button changes the tempo of the demo songs, metronome, and rhythm accompaniment.

TRANS

Press the TRANS + or TRANS – button to change the tuning of the instrument up or down in semitone steps.

CHORD (SINGLE / FINGER)

- Pressing the SINGLE or FINGER button activates chord recognition for the rhythm function. The left keyboard range up to and including f# now becomes the chord recognition range. Any rhythm accompaniment that was started can now be combined with a chord accompaniment.
- In the SINGLE mode of chord recognition, you can use any single key to specify the chord for the corresponding chord accompaniment. Here, the key you press specifies the root of the accompaniment chord in the major key. The nearest left black key can be pressed to change the chord gender to a minor. Press the nearest left white key for a dominant seventh chord, and the nearest left white and black keys for a minor seventh chord.
- Select the Finger mode to specify the chord for the corresponding chord accompaniment using three keys that define a whole chord. Unless you specify a three-part chord in this mode, only the drum rhythm will sound.
- Deactivate the chord recognition by pressing the SINGLE or FINGER button again to be able to use the whole keyboard range for your piano playing again.

FILL IN

Press the FILL IN button to add a short drum fill-in to the rhythm accompaniment.

SYNC

Pressing the SYNC key activates the sync start standby of the rhythm function. Rhythm playback will now start the first time you press a key in the chord recognition area. Press the SYNC key again to deactivate this function.



METRONOME

Press the METRONOME button to start/stop the metronome. Press the METRONOME button repeatedly to change the time signature of the metronome function.

SPLIT

Select a tone as described under "TONE". Press SPLIT to split the instrument's keyboard into two halves. Now you can use the number buttons or + – to change the tone of the right half of the keyboard. Press SPLIT again to exit the mode.

DRUM

Press the DRUM button to turn your keyboard into a rhythm instrument. Individual drum sounds are now assigned to the keyboard. Exit this mode by pressing DRUM again.

REC

The instrument is capable of recording monophonic melodies. Press the REC button to enter the melody recording mode. Recording will start automatically when the first key is pressed. (Max. 85 tones / when the instrument is turned off, the stored data will be lost).

PLAY

Immediately after recording, press the PLAY button to play back the recorded melody.

SUSTAIN

Press the SUSTAIN button to activate or deactivate the sustain effect (This creates an effect similar to the right pedal of a real piano).

VIBRATO

Press the VIBRATO button to activate or deactivate the vibrato effect.

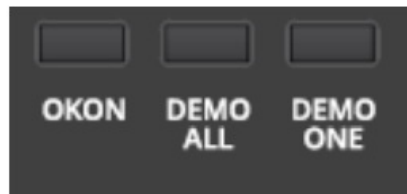

DEMO

- Press one of the DEMO buttons to start demo playback. Press the respective DEMO button again to stop demo playback.
- Select DEMO-ALL to play all demos in sequence. Press the DEMO ONE button repeatedly to scroll through each demo song.

OKON

- Press the OKON button to enter the practice mode for each demo song. First, select the desired demo song as described under "DEMO". Then press the OKON button. The song will now play without the melody part. The instrument plays the appropriate melody part of the selected song independently as soon as you press any key on the keyboard in the correct rhythm of the melody sequence. As long as no keyboard key is pressed, the accompaniment "waits" for you. For orientation, the display shows the note name of the next melody tone.
- Exit this mode by pressing the OKON button again. (It is recommended to set the tempo to a low value at the beginning as described under "TEMPO".)

MP3 player

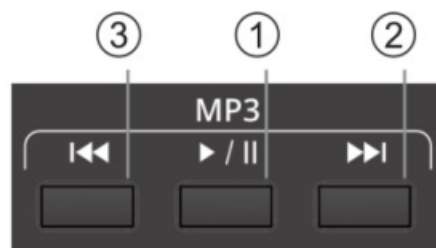

1. Play/Pause button
2. Next button
3. Previous button

Insert a USB stick into the USB socket on the rear panel.

- Start or stop playback by pressing the Play/Pause button.
- Press the Next or Previous button briefly to go to the next or previous title.
- Press and hold the Next or Previous button to fast forward or rewind.
- (When a USB memory stick is inserted into the instrument's rear USB jack, the MP3 player will be activated automatically. If there are compatible MP3 data on the stick, playback will start automatically.)

ATTENTION:

We recommend the use of USB sticks with the smallest possible storage capacity.

Rear connection panel

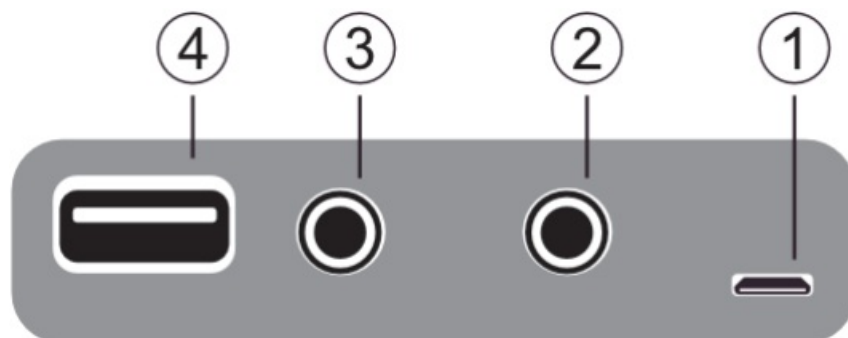

1. AC adapter jack
 - Use the instrument only with the supplied AC adapter.
 - First, connect the micro USB of the charging cable to the power supply socket on the instrument. Then connect the power adapter to the power outlet.
2. Phones
 - Connecting headphones to this 3.5mm jack will disable the instrument's speakers.
 - Make sure that the volume is set appropriately. Excessive volume or prolonged use of headphones can cause hearing damage.
3. Microphone
 - A dynamic microphone with a 3.5mm mono jack can be connected to the Mic input of the keyboard.
 - Make sure that the volume setting is appropriate. If the volume is too high or the distance between the

microphone and the speaker is too short, feedback may occur. Remove the microphone from the microphone jack when not in use to avoid unwanted background noise.

4. USB/MP3

- USB socket of the integrated MP3 player.

Troubleshooting

If a malfunction occurs, please check the following sources of error.

Error	Cause	Solution
The piano will not turn on	1. The battery is completely discharged	1. Charge the battery 2. Establish the power supply via the external power supply unit.
The piano does not emit sound from the speakers	1. The volume is set to the lowest value 2. A headphone (adapter) is plugged into the headphone jack	1. Increase the volume setting 2. Remove the headphone (adapter) from the headphone jack.
The left keyboard area does not respond.	The chord recognition is activated.	Deactivate the chord recognition.
The instrument emits noise	1. There are appliances with interference properties (freezer, washing machine, or similar) in the immediate vicinity 2. Objects on or near the instrument resonate with 3. The noise only occurs when using headphones	1. Remove the piano from the vicinity of other electrical appliances (especially those with motors). Remove resonating objects from the piano's environment. 3. Clean the headphone plug or replace the headphone.

- This instrument has an auto-sleep function. To save power, it will automatically enter a power-saving mode if it is not used for a long period. Reactivate the instrument by pressing any button.
- Sleep mode is indicated by the deactivated display. Only the blue power indicator will be lit. Please switch off the instrument completely if you do not intend to use it for a longer period.

Product specifications

Keyboard	61 keys
Sounds	200
Rhythms	200
Demo	70
Battery	3.7V 1200mAh, Li-Ion
Connections	Headphones (3.5mm jack), Microphone (3.5mm jack), USB 2.0 port for MP3 playback, Micro-USB charging port
Dimensions (WxDxH in mm)	950x300x90
Power supply unit	DC 5V, min. 1000mA

WEEE Declaration (Waste of Electrical and Electronic Equipment)

- Your product has been designed and manufactured using high-quality materials and components that are recyclable and reusable. This symbol means that electrical and electronic equipment must be disposed of separately from household waste at the end of their service life.
- Please dispose of this device at your local municipal collection point or the recycling center.
- Please help protect the environment in which we all live.
- All specifications and appearance are subject to change without notice. All information was correct at the time of printing. Musikhaus Kirstein GmbH assumes no responsibility for the accuracy or completeness of the descriptions, photos, or statements contained in this manual. Printed colors and specifications may vary slightly from the product. Products of Musikhaus Kirstein GmbH are distributed only through authorized dealers. Distributors and dealers are not representatives of Musikhaus Kirstein GmbH and are not authorized to legally bind Musikhaus Kirstein GmbH in any way, whether expressly or through conclusive action.



- Musikhaus Kirstein GmbH Bernbeurener Str. 11 86956 Schongau – Germany
- Phone: 0049-8861-909494-0
- Fax: 0049-8861-909494-19



Documents / Resources

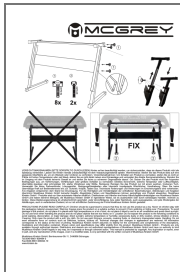

[MCGREY 6170 61 Key Battery Keyboard](#) [pdf] User Manual
6170, 6170 61 Key Battery Keyboard, 61 Key Battery Keyboard, Battery Keyboard, Keyboard

References

- [User Manual](#)

Manuals+, Privacy Policy

This website is an independent publication and is neither affiliated with nor endorsed by any of the trademark owners. The "Bluetooth®" word mark and logos are registered trademarks owned by Bluetooth SIG, Inc. The "Wi-Fi®" word mark and logos are registered trademarks owned by the Wi-Fi Alliance. Any use of these marks on this website does not imply any affiliation with or endorsement.