



# MAXXMEE Variable Transporthilfe User Manual

[Home](#) » [MAXXMEE](#) » MAXXMEE Variable Transporthilfe User Manual 

## MAXXMEE Variable Transporthilfe User Manual

### Contents

- 1 Transport Trolley
- 2 Sack Truck
- 3 Folding Up
- 4 Before Initial Use
- 5 Operating Instructions
- 6 ITEMS SUPPLIED
- 7 INTENDED USE
- 8 SAFETY NOTICES
- 9 BEFORE INITIAL USE
- 10 USE
- 11 CLEANING AND STORAGE
- 12 DISPOSAL
- 13 TECHNICAL DATA
- 14 Customer Service  
Importer
- 15 Documents / Resources
  - 15.1 References
- 16 Related Posts



Transport Trolley

A

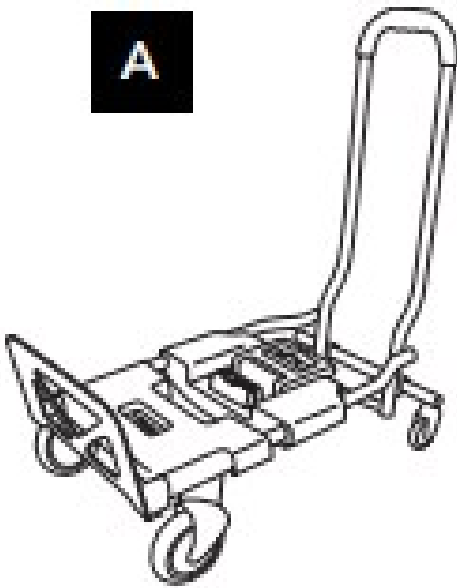

1

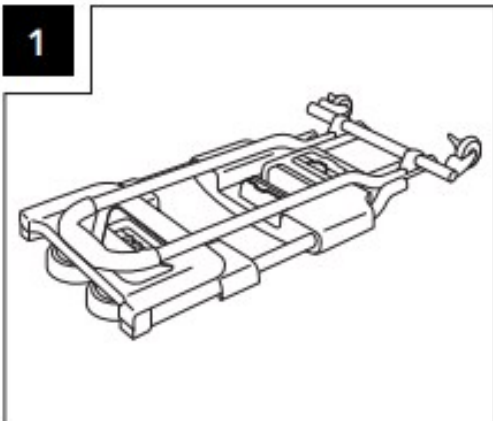

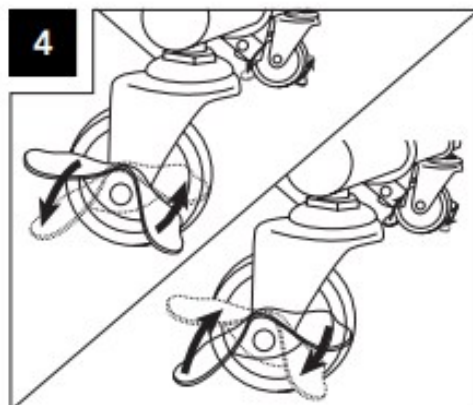
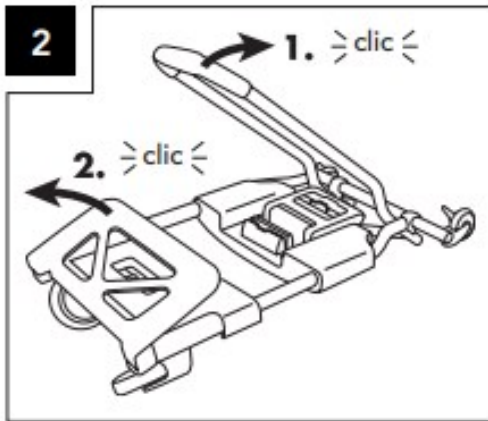

**A4: Turn the wings of the brake to apply or release it.**

**Sack Truck**

**B**

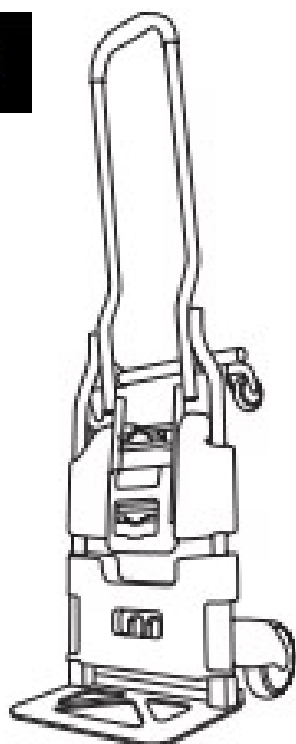

**1**



**2**

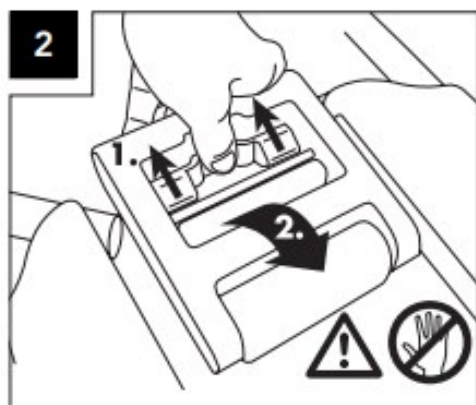

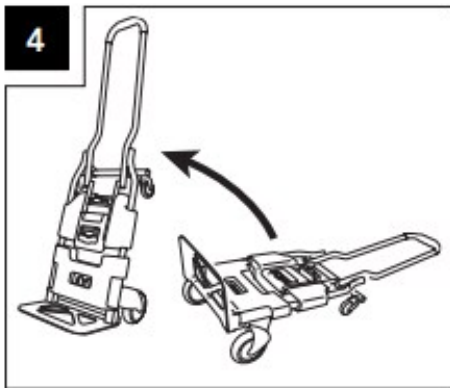
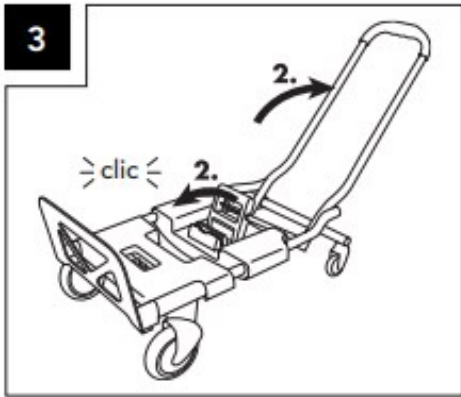

## Folding Up

**C**

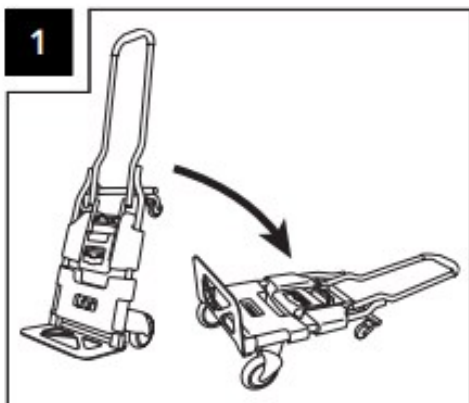
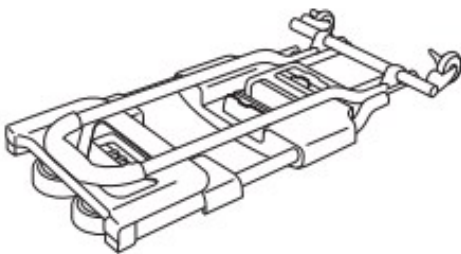

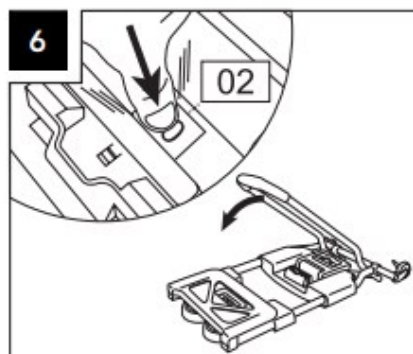
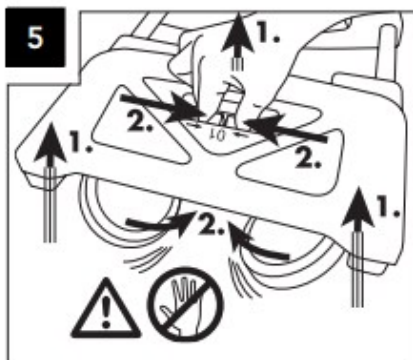
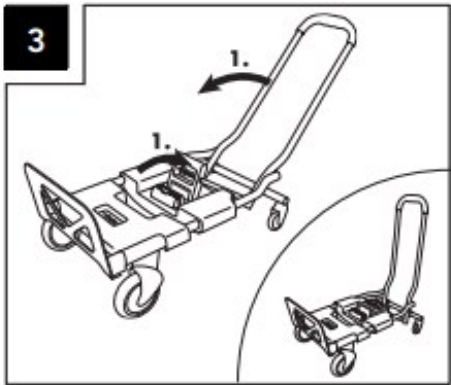
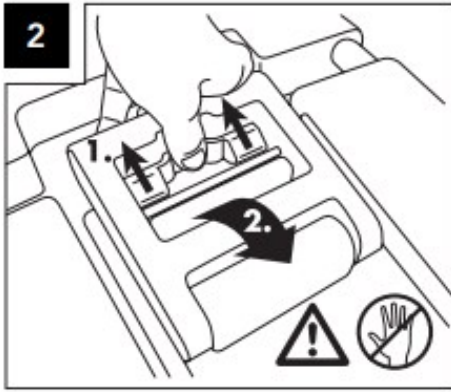

## Before Initial Use

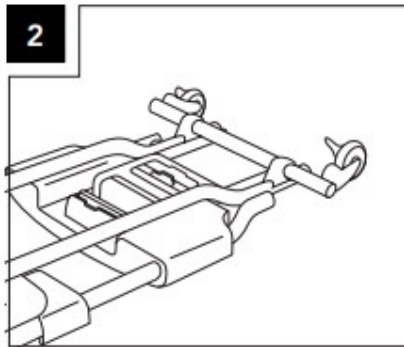
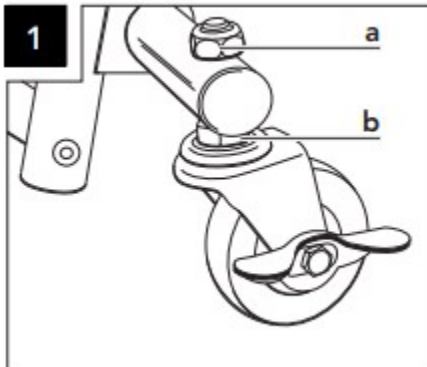

## Operating Instructions

### Dear Customer,

We are delighted that you have chosen the MAXXMEE variable transport aid. This product is a great help when performing heavy tasks such as large shopping expeditions or moving house. When folded up compact, it takes up hardly any space in the boot of a car, but in just seconds it can be folded out optionally as a sack truck or transport trolley without any tools or other equipment. If you have any questions about the product and about spare parts/accessories, contact the customer service department via our website: [www.dspro.de/kundenservice](http://www.dspro.de/kundenservice). We hope you have a lot of fun with your MAXXMEE variable transport aid.

### Information About the Operating Instructions

Before using the product for the first time, please read through these operating instructions carefully and keep them for future reference and other users. They form an integral part of the product. The manufacturer and importer do not accept any liability if the information in these operating instructions is not complied with.

## ITEMS SUPPLIED

- 1 x transport aid
- 2 x wheel
- 2 x nut
- 2 x sleeve
- 2 x spanner
- 1 x operating instructions

Check the items supplied for completeness and the components for transport damage. If you find any damage, do not use the product but contact our customer service department. Remove any possible films, stickers or transport

protection from the product.

## INTENDED USE

- This product is intended to be used to transport objects up to a total weight of 120 kg.
- Do not transport people or animals in the product!
- The product is not a trailer. Do not attach it to vehicles.
- Do not use in road traffic!
- The product is not a toy!
- The product is designed for personal use only and is not intended for commercial applications.
- The product should only be used as described in the operating instructions. Any other use is deemed to be improper.
- The warranty does not cover faults caused by incorrect handling, damage or attempted repairs. The same applies to normal wear and tear.

## SAFETY NOTICES

- Keep children and animals away from the packaging material. There is a danger of suffocation.
- The product is not a toy! Do not leave children unsupervised with the product. There is a danger of injury from incorrect use.
- Do not use on slopes when the product is heavily loaded. The load must be appropriate for the user's physical strength so that the user does not lose control of the product.
- When setting up and folding up the product, ensure that no fingers or other body parts become trapped. Ensure that the product is correctly set up before using it.
- Do not overload the product. Spread the objects around as evenly as possible and do not exceed the maximum load capacity.
- Keep the product away from naked flames or hot surfaces.  
Do not unnecessarily expose it to dust, rain, snow or extreme weather conditions to prevent rust formation and other problems. Do not expose it to moisture or wet conditions for a long period.
- Do not make any additions or changes to the product and do not attempt to repair it. If you find any damage, contact our customer service department.

## BEFORE INITIAL USE

Before the product is first used, the two wheels which are supplied must be mounted on the front axle (see Picture **D1 and 2**). To do this, two spanners are required.

1. The wheel mount has a thread. Plug one of the sleeves that is supplied onto the thread.
2. Plug the thread with the sleeve through the hole in the axle of the transport aid.
3. Use a spanner to screw the nut which is supplied (a) onto the thread and tighten it. When you do this, use another spanner to fix the nut (b) which is already present on the wheel mount.
4. Attach the second wheel in this way as well.

## USE



- For use as a transport trolley, carry out the steps which are shown in illustrations **A1 to 3**. The small wheels each have a brake. Turn the wings of the brake to apply or release it (see picture **A4**).
- The steps for setting up the product as a sack truck are shown in illustrations **B1 to 4**.
- The folding up is shown in illustrations **C1 to 6**.

## CLEANING AND STORAGE

- Lubricate the wheels with a conventional commercial lubricant if necessary. Otherwise all moving parts are maintenance-free.
- Do not use any caustic or abrasive cleaning agents! Wipe down with a damp cloth if necessary. Allow the product to dry completely before folding it up and storing it away.
- Store it in a clean and dry place.

## DISPOSAL



Dispose of the packaging material in an environmentally friendly manner so that it can be recycled.

## TECHNICAL DATA

Article Number	06908
Model Number	JHK-15617
Transport surface area as Trolley	62.5 x 37.5 cm
Transport surface area as Sack Truck	37.5 x 18 cm
Max. Load Capacity	120 KG
Weight	7 KG

## Customer Service Importer

DS Produkte GmbH  
 Am Heisterbusch 1 19258 Gallin Germany  
 ☎ +49 38851 314650  
 Calls to German landlines are subject to your provider's charges.

## Documents / Resources

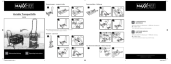

[MAXXMEE Variable Transporthilfe](#) [pdf] User Manual  
Variable Transporthilfe, 06908

## References

- [dS DS Group - Kundenservice, Kontakt, Produktinformationen](#)

Manuals+.