

# Maxxima MEW-DM310DW Smart WiFi Digital Dimmer Switch Instruction Manual

[Home](#) » [Maxxima](#) » Maxxima MEW-DM310DW Smart WiFi Digital Dimmer Switch Instruction Manual 

## Contents

- 1 Maxxima MEW-DM310DW Smart WiFi Digital Dimmer Switch
- 2 SPECIFICATION
- 3 FCC Information
- 4 Product Outline
- 5 Status Indicator
- 6 Using the On/Off Switch on Dimmer
- 7 Brightness adjustment button
- 8 Parts Supplied
- 9 Tools needed to install your Dimmer
- 10 Installation and testing
- 11 CONTROLL THROUGH APP
- 12 Troubleshooting
- 13 Documents / Resources
  - 13.1 References



**Maxxima MEW-DM310DW Smart WiFi Digital Dimmer Switch**

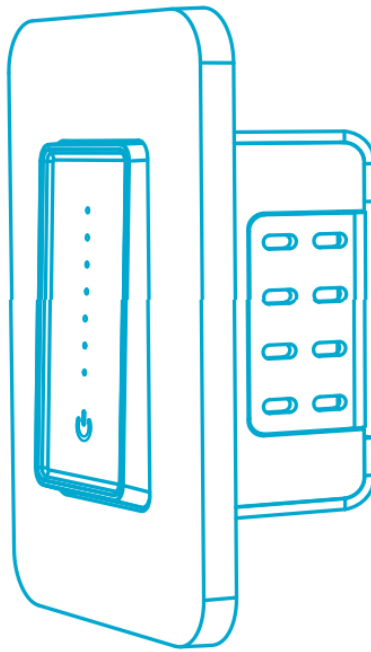

## SPECIFICATION

- **Input Power:** 100 ~ 120V AC 60Hz
- **Dimming Control:** Trailing edge cut
- **Communication:** WiFi 802.11 b/g/n 2.4GHz
- **Available for selected model** < 300W Incandescent/Halogen
- **Load:** < 250W LED
- **Standby Power:**  $\leq 1.5W$
- **Button Life:** 500K times
- **Dimension:** 105\*45\*45 mm

## WARNINGS AND CAUTIONS

- Risk of fire and electrical shock, products should be installed in accordance with appropriate electrical codes and regulations.
- Turn power off at circuit breaker or fuse and test that power is off before installing.
- If you are unsure about any part of these instructions, consult a licensed electrician.
- To reduce the risk of overheating and possible damage to other equipment, do not install to control a receptacle, a motor-operated appliance or a transformer-supplied appliance.
- Use with compatible dimmable LED, Incandescent or halogen bulbs only.
- When multiple bulbs are used with one dimmer, DO NOT mix bulb types. All bulbs shall be either LED, halogen or incandescent. Using the same model of each bulb will enhance dimmer performance.

## FCC Information

This device complies with Part 15 of the FCC Rules. Operation is subject to the following two conditions:

1. This device may not cause harmful interference
2. This device must accept any interference received, including interference that may cause undesired operation.

This equipment has been tested and found to comply with the limits for a Class B digital device, pursuant to part 15 of the FCC Rules. These limits are designed to provide reasonable protection against harmful interference in a residential installation. This equipment generates, uses and can radiate radio frequency energy and, if not installed and used in accordance with the instructions, may cause harmful interference to radio communications. However, there is no guarantee that interference will not occur in a particular installation. If this equipment does cause harmful interference to radio or television reception, which can be determined by turning the equipment off and on, the user is encouraged to try to correct the interference by one or more of the following measures:

- Reorient or relocate the receiving antenna.
- Increase the separation between the equipment and receiver.
- Connect the equipment into an outlet on a circuit different from that to which the receiver is connected.
- Consult the dealer or an experienced radio/TV technician for help.

### FCC CAUTION

Any changes or modifications to this unit not expressly approved by the manufacturer could void the user's authority to operate the equipment.

### Product Outline

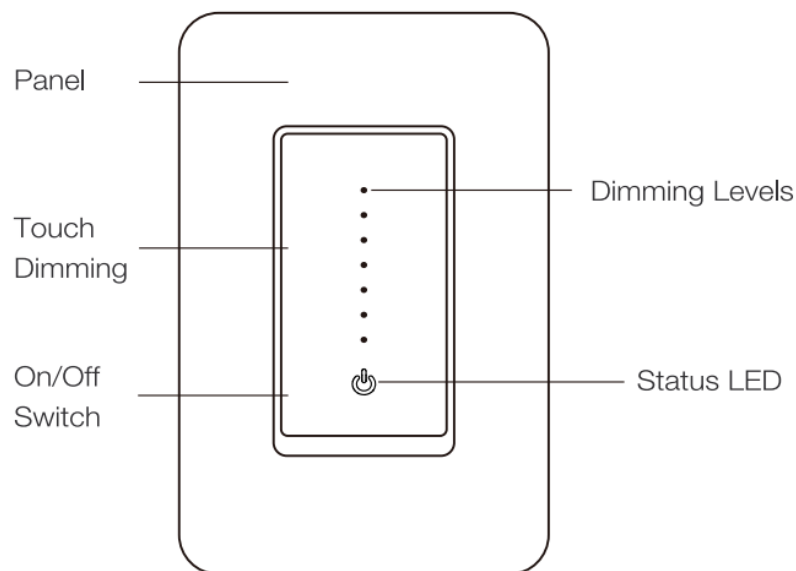

### Status Indicator

Light Color	Light Status	Switch Status	Remarks
Green	ON	Power OFF(Default)	Support Self-definition on APP
	OFF	Power ON	
White	ON	Connected to router and connected to cloud	The white light is enabled only when the switch status is on.
	OFF	Not Connected to the cloud	
	Blink Quickly (0.5s interval)	Ready for default configuration mode	
	Blink Slowly (1s interval)	Ready for AP (Access Point) configuration mode	

### Using the On/Off Switch on Dimmer

- **To turn on the light:** Press the On/Off switch once when the lights are off
- **To turn off the light:** Press the On/Off switch once when the lights are on
- **Factory Reset:** Hold the switch for 5s until the indicator light is flashing to reset the switch and go into quick configure mode.

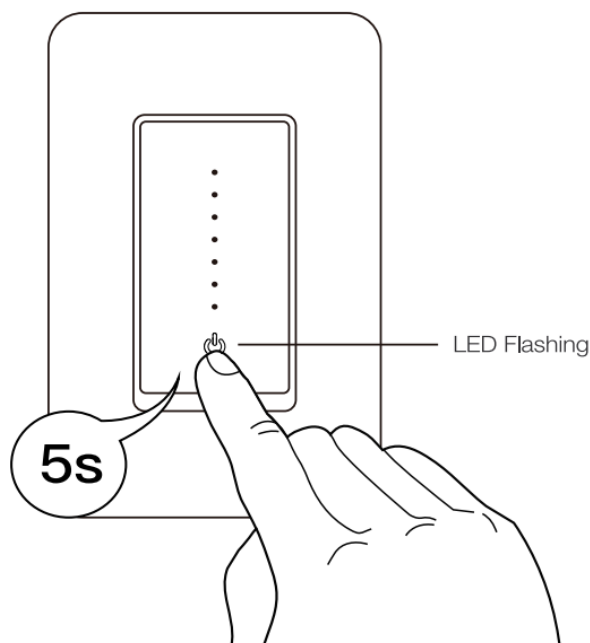

### Brightness adjustment button

- **Brightness control:** When lights are on, tap the LED dimming indicator to your desired brightness level. You can also slide your finger along the dimmer to the desired brightness.

- When you press the On/Off switch, your last brightness setting is saved and the next time you turn on the lights, it will automatically go to that brightness level. The Dimming Levels indicator will also glow at the saved brightness level when the lights are off.

## Parts Supplied

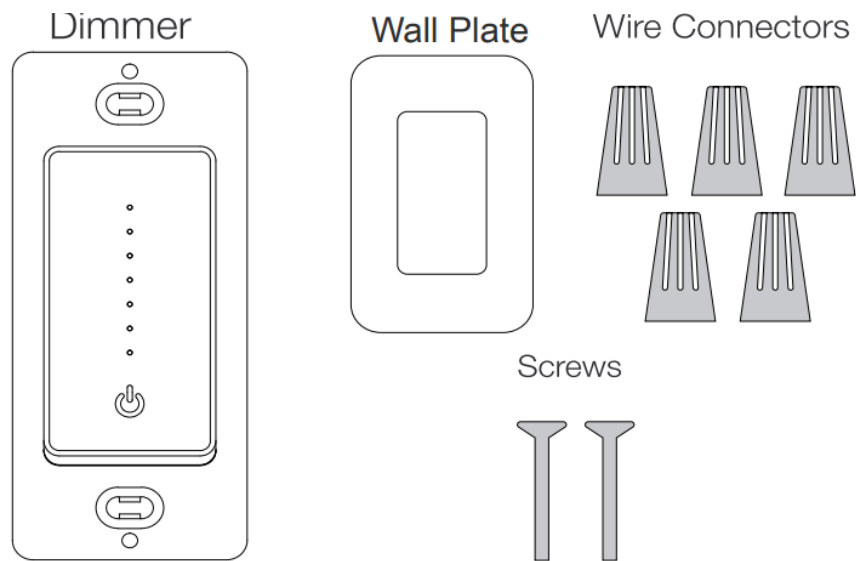

## Tools needed to install your Dimmer

Phillips-head Screwdriver



Flat-head Screwdriver



Pliers

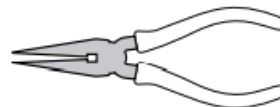

Voltage Tester

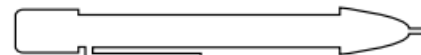

## Installation and testing

- **Step 1** **WARNING:** To avoid fire and electrical shock, TURN OFF POWER at circuit breaker or fuse and test that power is off before wiring.

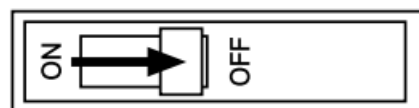

Circuit breaker panel

- **Step 2** **Removing existing switch:** Remove existing wall plate and switch mounting screws. Carefully pull switch from wall box, identify and take out the wires attached to the switch, then remove the switch. **DO NOT** remove the wires which are taken out from the switch at this time.

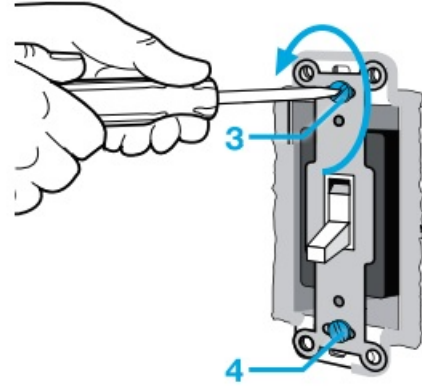
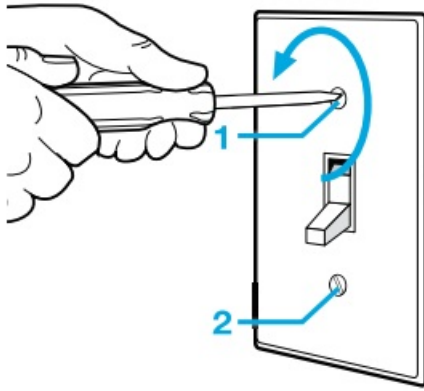

• **Step 3** Identify the Dimmer's Wiring application

◦ **SINGLE POLE**

Only one switch controls one light or bundle of lights

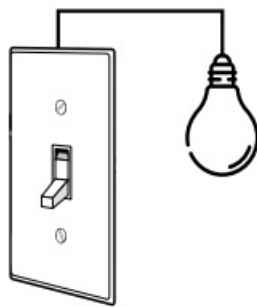

Single Pole

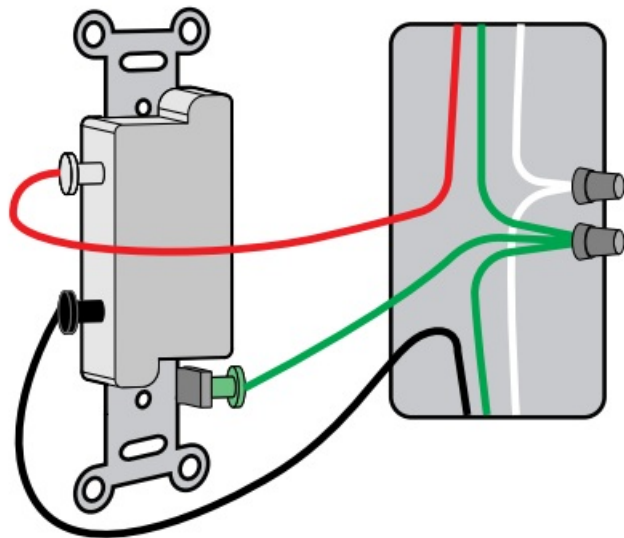

◦ **3-WAY**

Two switches control the same light or the same bundle of lights.

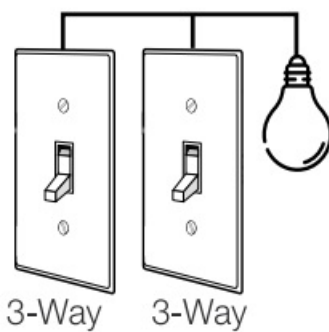

3-Way 3-Way

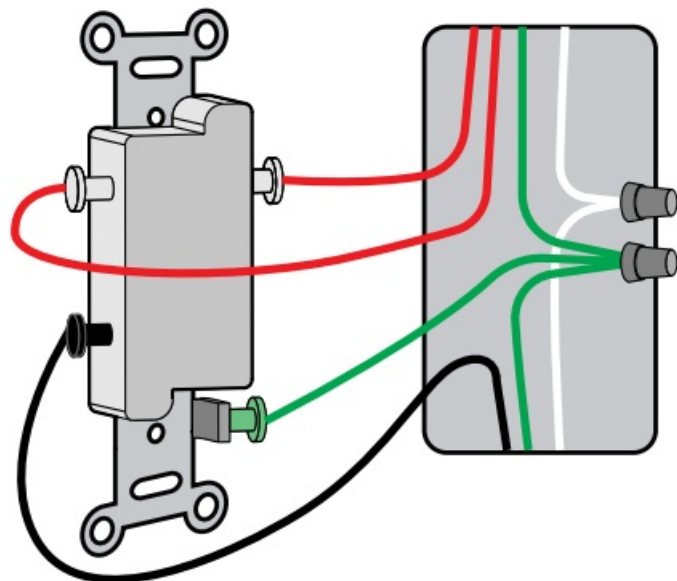

• **Step 4** Identify Line, Load, and Neutral Wires

**Note:** The color of your wire may be different from the color shown on the manual.

LINE/LOAD wire (usually BLACK, attached with a black screw, and may be Remarked “common”.)

- **Single Pole**

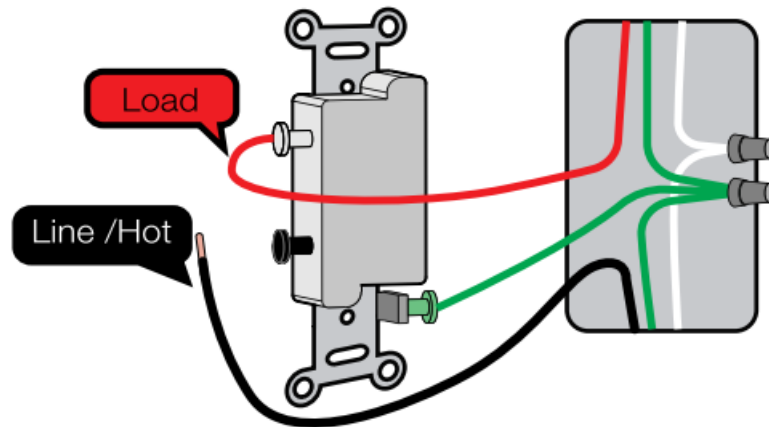

- **3-WAY**

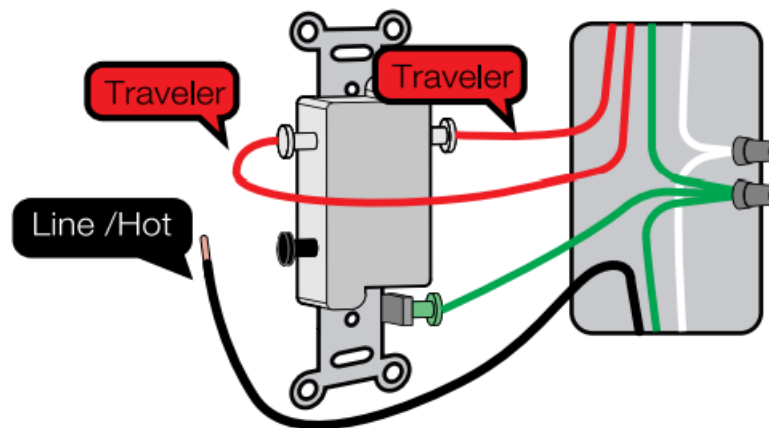

- Neutral wire is required to install the smart dimmer. Most likely a bundle of one or more white wires in the wall.
- GROUND wires are usually BARE COPPER or GREEN.

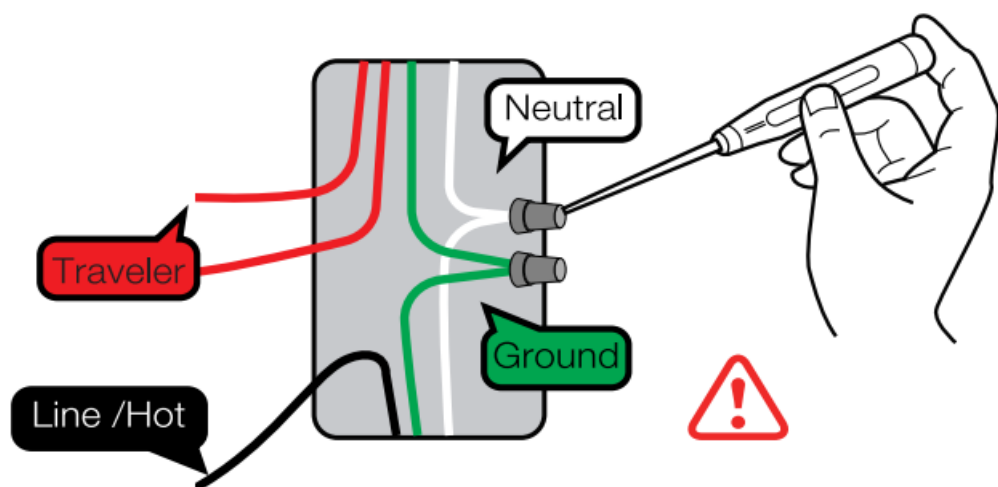

**Note:** If there is no neutral, please try another location or call an electrician for help.

- Take Pictures of the Wiring

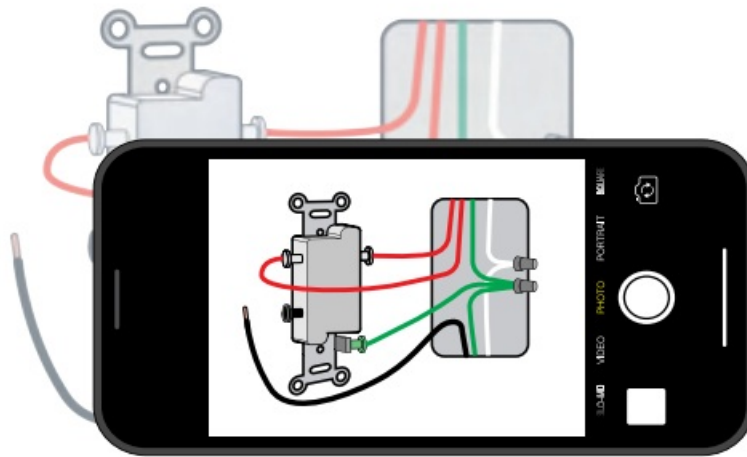

- Loosen the screw terminals and remove the old dimmer.

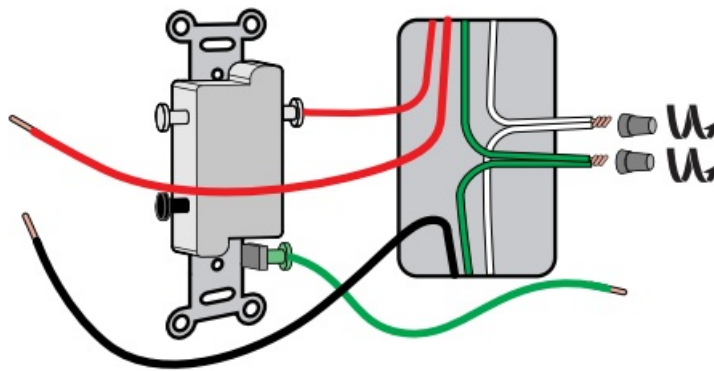

- **Step 5a** Wire the Smart Dimmer – Single Pole

Cap off the remaining L1 wire (RED) from the Switch with a wire nut.

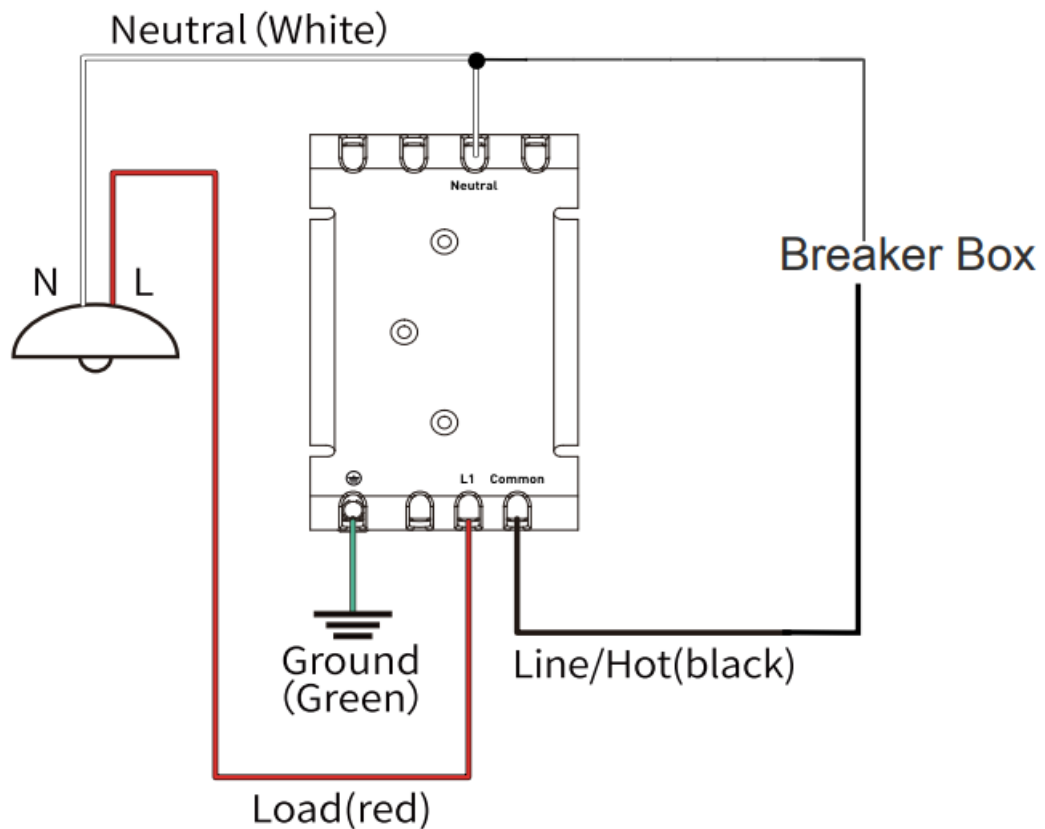

- **Step 5b** Wire the Smart Dimmer – 3-Way



Replace ONE of your REGULAR 3-WAY SWITCHES with SMART SWITCH

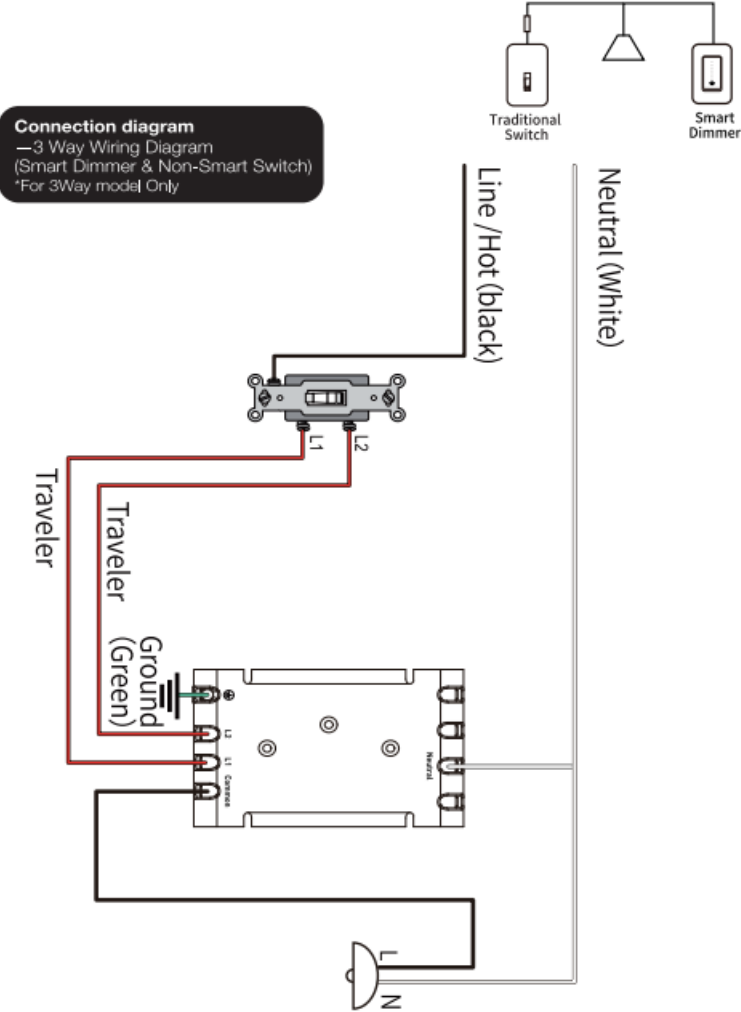

**Connection diagram**  
 — 3 Way Wiring Diagram  
 (Smart Dimmer & Traditional Switch)  
 \*For 3Way model Only

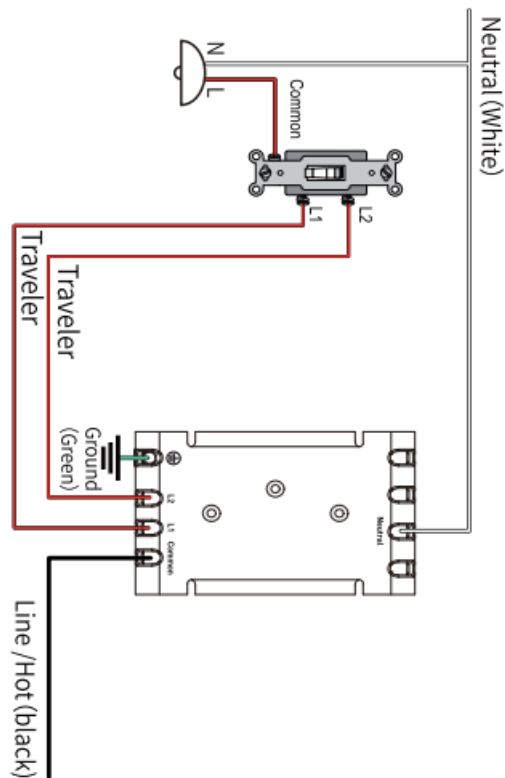
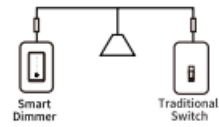

- **Step 6** Mount the Dimmer and turn on power

- **Mount The Dimmer**

Use the screws provided.

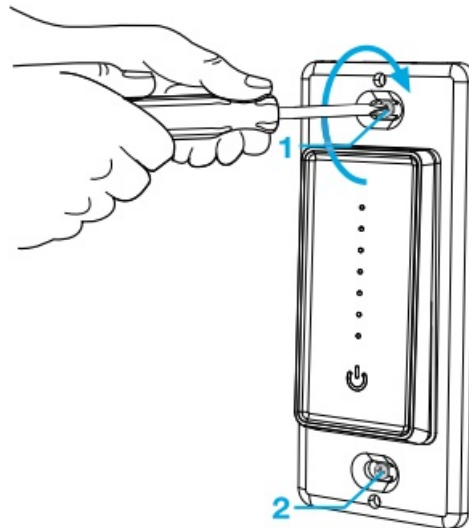

- **Attach The Wallplate**

Snap the wallplate onto the dimmer after it is screwed in.

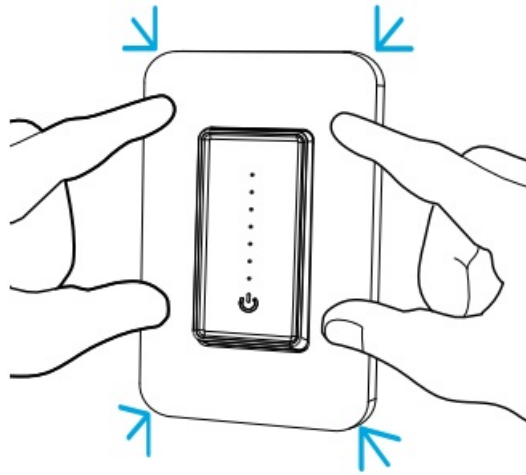

- **Turn on the power**

The lights) may flash once during smart dimmer first time power up

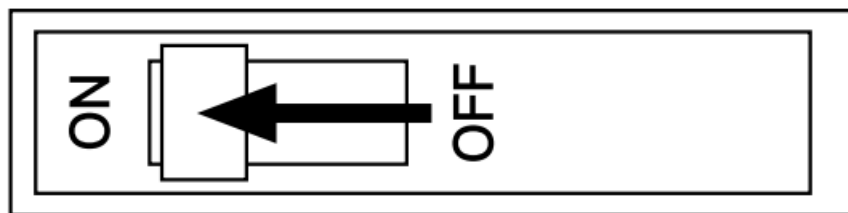

## CONTROLL THROUGH APP

- **Step 1** Download the 'Smart Life' or Tuya App

- Scan the QR code below to download the 'Smart Life' App.
- You can also download this app in the app store/Android app store by searching "Smart Life" or "Tuya"



- **Step 2** Register an account and Login

Enter the Register/Login interface; tap "Register" to create an account by entering your phone number to get a verification code and setting your password. Choose "Log In" if you already have a Smart Life Account

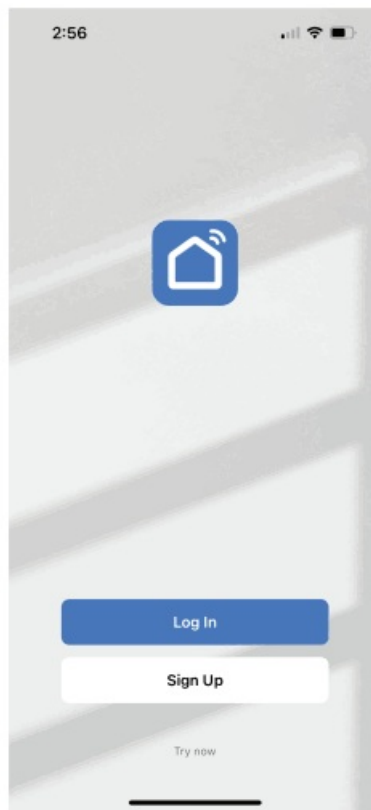

- **Step 3** Connect with the dimmer

- Click 'Add Device' or the '+' in the top right-hand corner.
- Click 'Electrical' then Dimmer Switch (Wi-Fi) to enter the device connection interface.

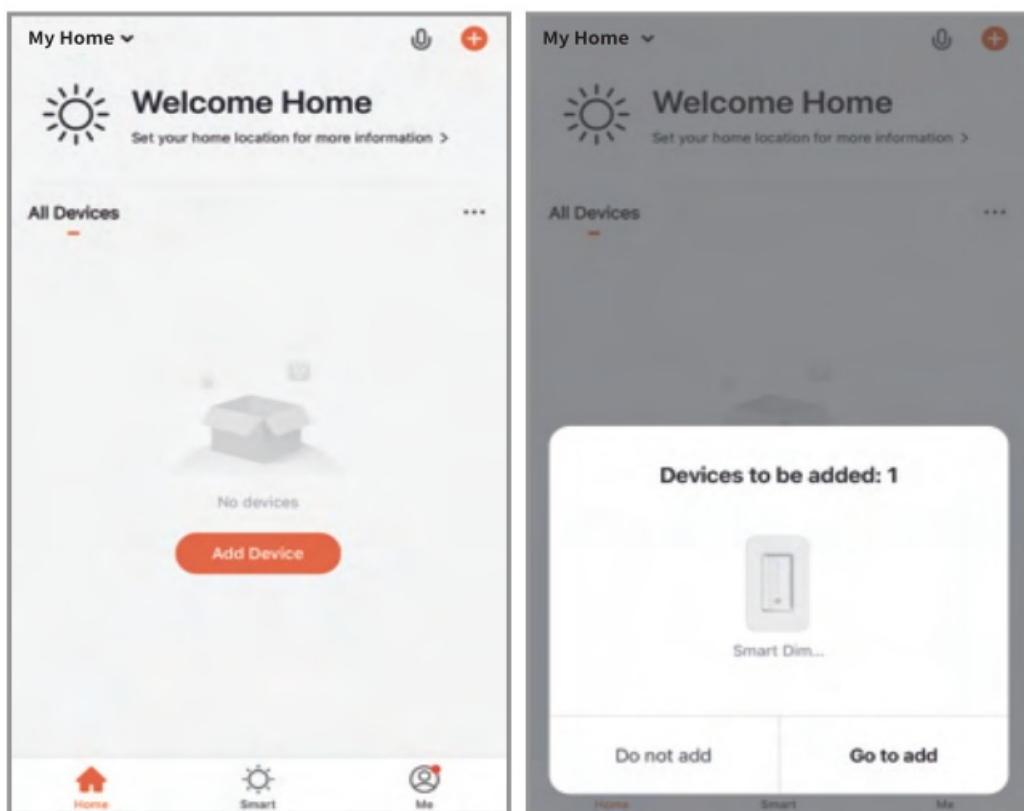

- **Step 3a** Quick Configuration Mode

- Press and hold the Switch button for 8s to reset the Dimmer & go into quick config. mode
- Select you home Wi-Fi and enter the password. Then click confirm to go to the next screen.

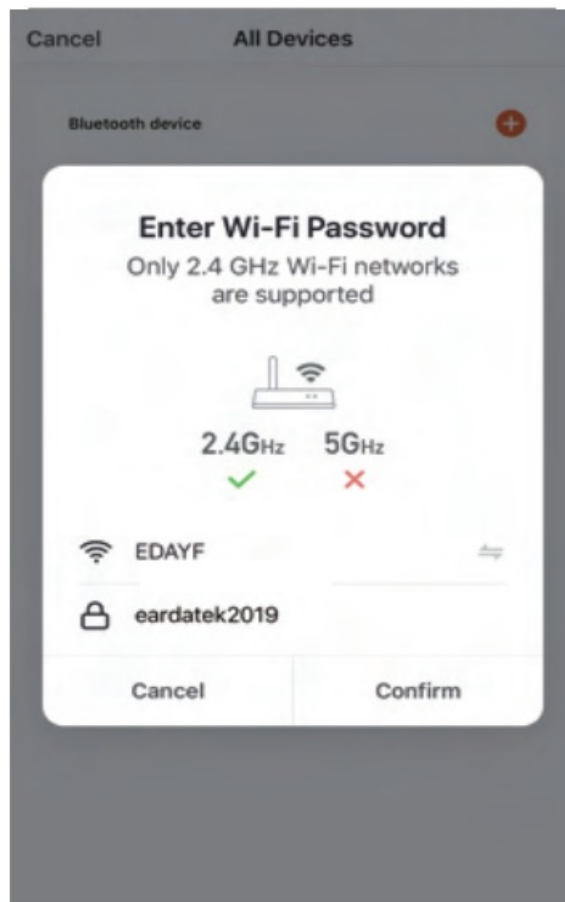

- Wait for the system to search for the device, connect, and configure the dimmer. It may take up to 3 min. to connect
- Once the device configures successfully, please input your preferred name and select a location for the dimmer.

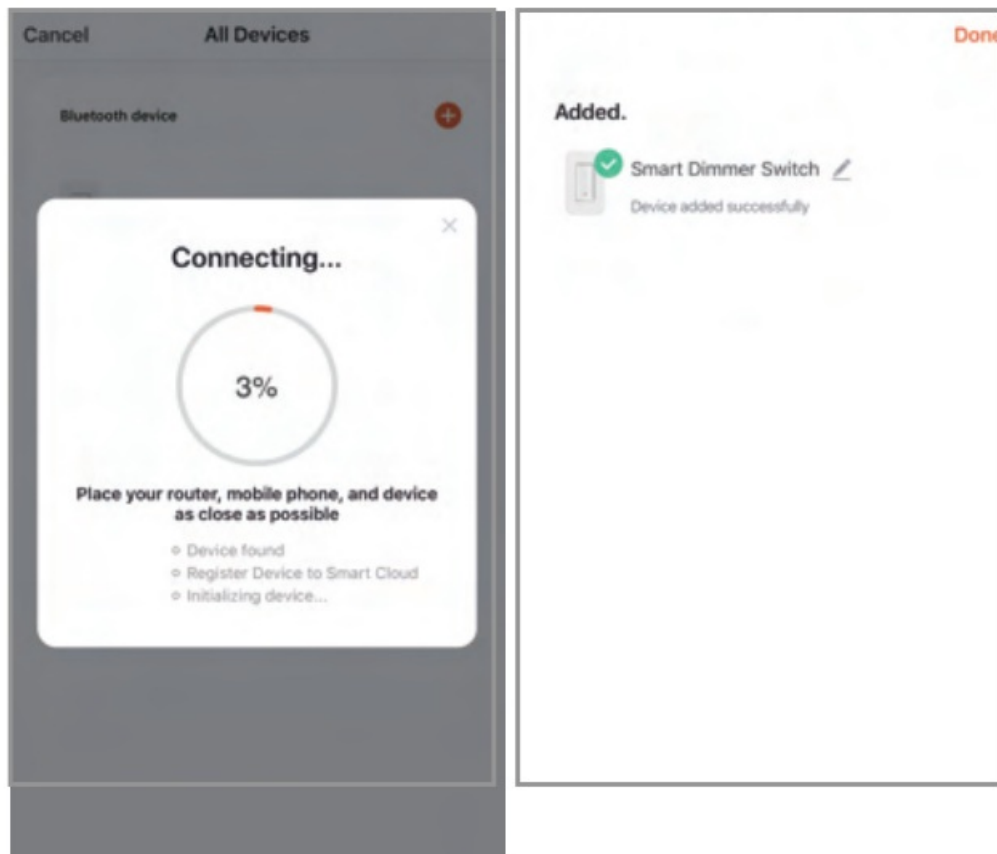

- **Step 4** The dimmer can be viewed in the Main Menu

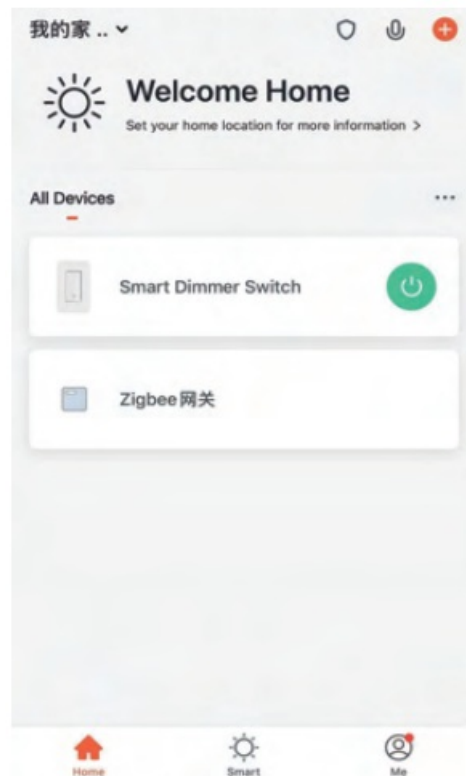

- **Step 5** Control the Dimmer through the App
  - The app allows you to turn on and off the switch as well as control the brightness of the light.
  - You can also choose the brightness range of the dimmer
  - The app allows you to select the light type that the dimmer is connected to, to ensure maximum performance.

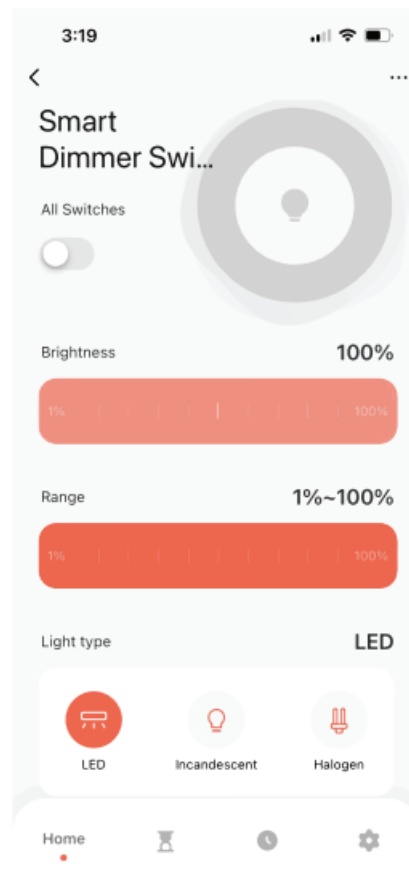

- **Step 6 Smart Life Skills (Alexa)**

- **STEP 1**

Log in your Alexa account on a smart phone or a computer, then tap Home>Skills & Games

- **STEP 2**

Search “Smart Life” and select the right one according to the blue logo (same with App)

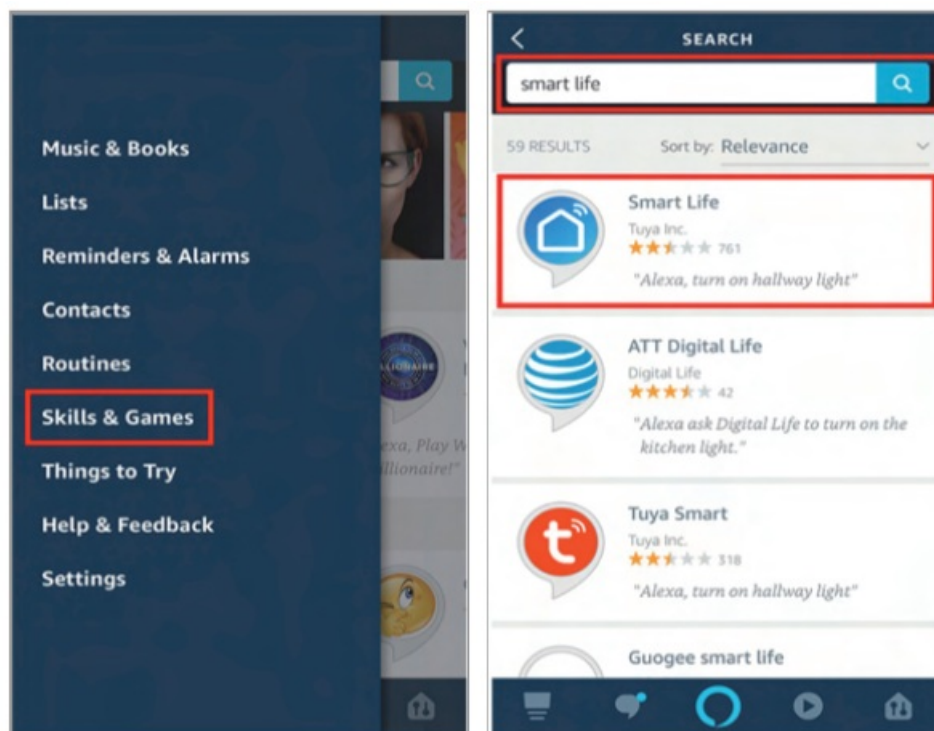

- **STEP 3**

Enable the skill

- **STEP 4**

Login the account you registered on the App in Part 2, then click “Link Now”

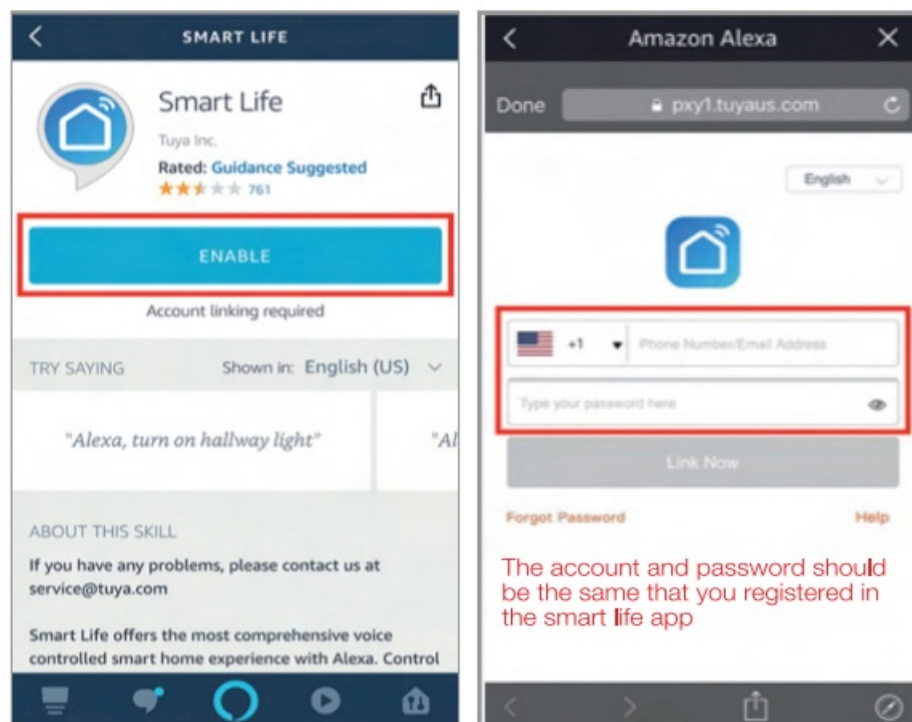

The Account is linked successfully, and then tap Authorize to Complete.

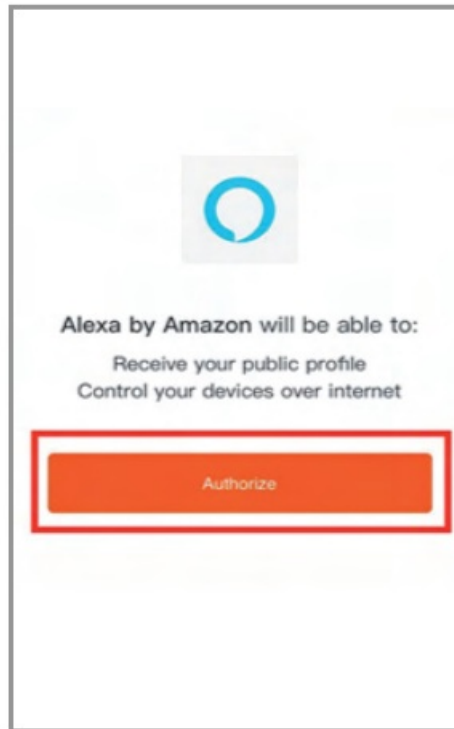

- **Step 7 Smart Life Skills (Google)**

- **STEP 1**

Find “Home Control” in the hamburger menu on the Google Home app’s home page > Home Control > tap “+”.

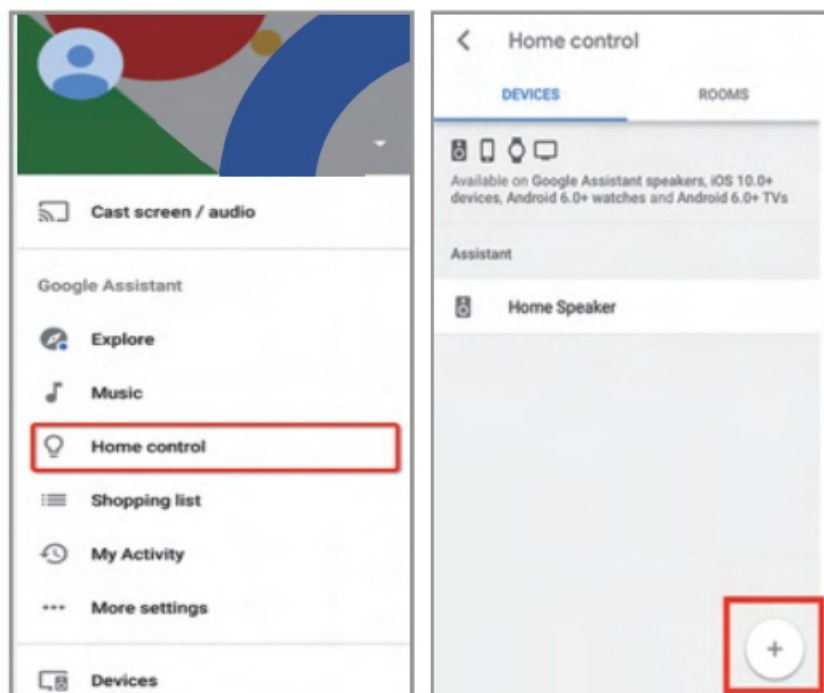

- **STEP 2**

Find “Smart Life” in the list

- **STEP 3**

Input your Smart Life account and password you registered in Part 2, then tap “Link Now”.



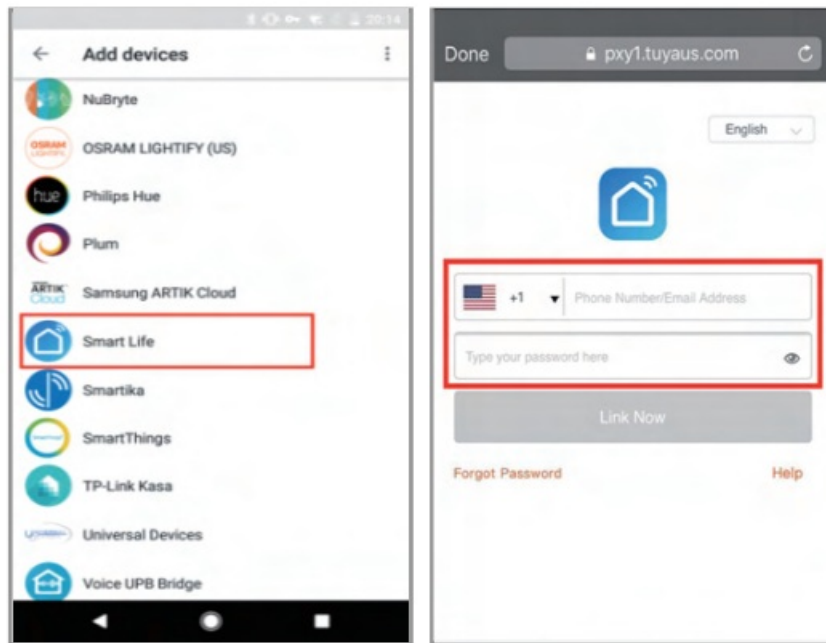

#### ◦ STEP 4

After you assign rooms for the Switch,your Switch will be listed in the Home Control page.

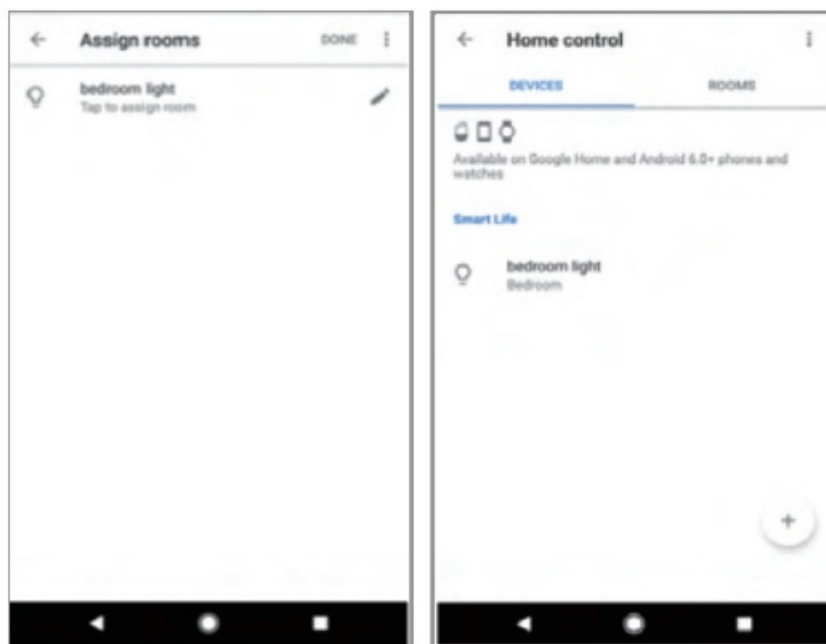

#### ◦ STEP 5

Control your smart switch through Google Home Now you can control your smart switch through Google Home.

- If you set the name as “bedroom light”, the supported voice commands are as below:
- Ok Google, turn on bedroom light.
- Ok Google, set bedroom light to 50%.

## Troubleshooting

- Make sure you have good Wi-Fi signal strength at the location of the switch
- Metal box and MATEL Surface-wall board may block Wi-Fi signal
- Make sure input correct Wi-Fi password.

---

## Documents / Resources

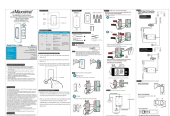

[Maxxima MEW-DM310DW Smart WiFi Digital Dimmer Switch](#) [pdf] Instruction Manual  
MEW-DM310DW Smart WiFi Digital Dimmer Switch, MEW-DM310DW, Smart WiFi Digital Dim  
mer Switch, WiFi Digital Dimmer Switch, Digital Dimmer Switch, Dimmer Switch, Switch

## References

- [User Manual](#)