



Maxxima MCL-710600D Motion Sensor LED Ceiling Light Installation Guide

[Home](#) » [Maxxima](#) » Maxxima MCL-710600D Motion Sensor LED Ceiling Light Installation Guide 



Contents

- [1 MCL-710600D Motion Sensor LED Ceiling Light](#)
- [2 INSTALLATION INSTRUCTIONS](#)
- [3 3 YEAR WARRANTY](#)
- [4 Documents / Resources](#)
- [5 Related Posts](#)

MCL-710600D Motion Sensor LED Ceiling Light

WARNINGS

- Risk of electric shock – Disconnect power at the source before installation.
- If you are unsure about the installation or the maintenance of the wall light, please consult an electrician.
- Do not make or alter any holes in the wiring enclosure or modify any electrical componentry.

CAUTIONS

- To insure personal safety, proper grounding of the electrical fixture is required.
- The fixture must be wired in accordance with the National Electric Code and applicable local codes or ordinances.

INSTALLATION INSTRUCTIONS

Tools Needed: Screwdriver, wire nuts, electrical tape

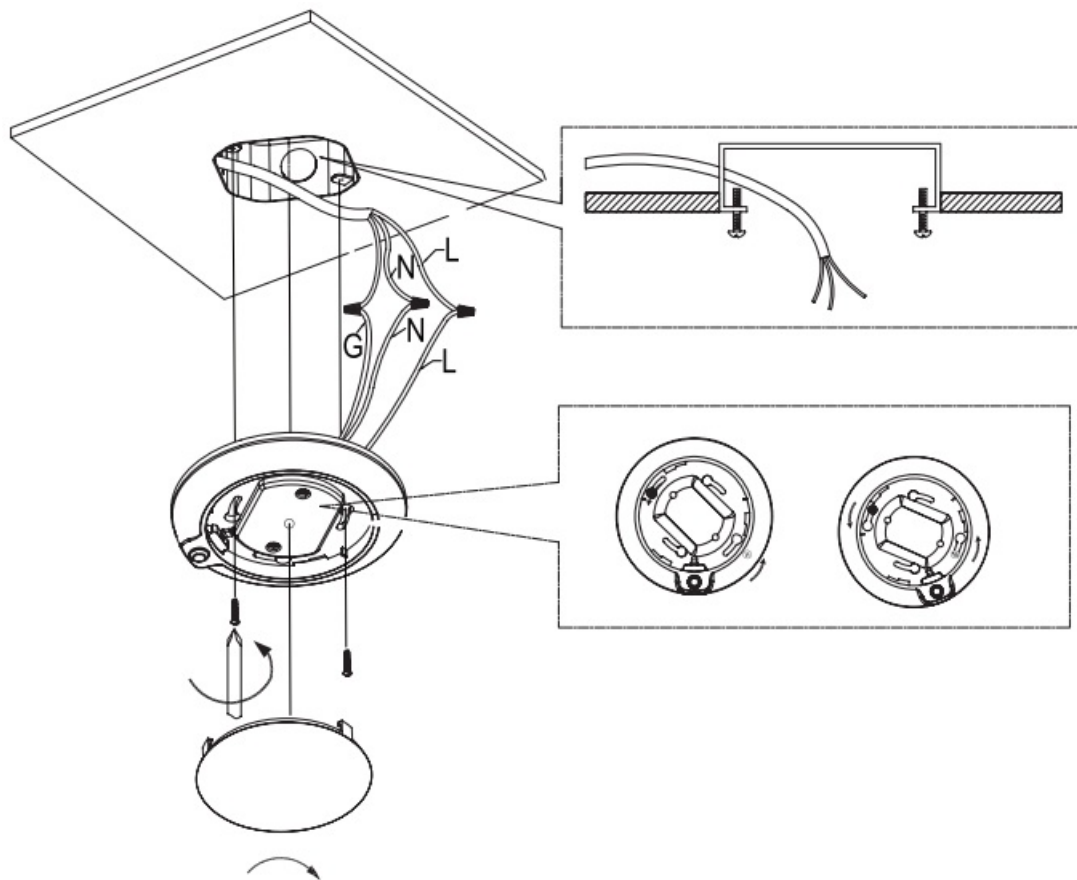

1. Shut off power at the circuit breaker or fuse before installation.
2. If you are replacing an existing fixture, remove and disconnect the old fixture first.
3. Expose the power supply wires from the junction box.
4. Remove the diffuser from the fixture base by twisting it counterclockwise and pulling away from the base.
5. Connect the white fixture neutral wire to the junction box neutral wire (typically white) using a wire nut.
6. Connect the black fixture hot wire to the junction box hot wire using a wire nut.
7. Connect the green fixture ground wire to the junction box ground wire using a wire nut.
8. Align the fixture mounting holes over the mounting screw holes on the junction box.
9. Thread the mounting screws through the slots in the fixture base and twist the base so that the screws are at the small end of the keyhole slots.
10. Ensure the wires are placed properly within the junction box. Tighten the mounting screws until the fixture base is snugly seated against the ceiling.
11. Place the diffuser on the fixture base and twist it clockwise to lock in place.
12. The installation is complete. Restore power to the fixture and verify the fixture operates properly.

3 YEAR WARRANTY

Maxxima extends a 3 year limited warranty to the original purchase that the products listed are free from defects in material and/or workmanship only. Maxxima will replace any warranted product to the original consumer/purchaser if the product fails because of defects due to workmanship and/or materials within the limited warranty period. Limited warranty is not transferable and applies to the original installation of the Maxxima product. This offer does not constitute in any way a product guarantee and Maxxima does not hereby assume any

obligation whatsoever beyond sending a free replacement product.



 info@maxximastyle.com

 866-MAXXIMA (629-9462)

 www.maxximastyle.com

 125 Cabot Court Hauppauge, NY 11788

Documents / Resources

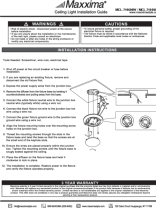
	<p>Maxxima MCL-710600D Motion Sensor LED Ceiling Light [pdf] Installation Guide MCL-710600W, MCL-710600D, MCL-710600D Motion Sensor LED Ceiling Light, Motion Sensor LED Ceiling Light, Sensor LED Ceiling Light, LED Ceiling Light, Ceiling Light, Light</p>
---	---

[Manuals+](#)