

MAXVIEW MXL050-KIT1 Roam Bracket Fixing Kit



MAXVIEW MXL050-KIT1 Roam Bracket Fixing Kit Instruction Manual

[Home](#) » [MAXVIEW](#) » MAXVIEW MXL050-KIT1 Roam Bracket Fixing Kit Instruction Manual 

Contents

- 1 MAXVIEW MXL050-KIT1 Roam Bracket Fixing Kit
- 2 Product Usage Instructions
- 3 Introduction
- 4 Product Contents
- 5 Tools required
- 6 Specifications
- 7 Accessories – Sold separately
- 8 Positioning your Antenna
- 9 Important Antenna Installation Information
- 10 Fitting the Antenna
- 11 General Safety Warnings
- 12 Installation
- 13 Operation
- 14 Maintenance
- 15 2-year guarantee
- 16 FAQ
- 17 Documents / Resources
 - 17.1 References

MAXVIEW

MAXVIEW MXL050-KIT1 Roam Bracket Fixing Kit



Specifications

- **Antenna Type:** 5G/4G 2X2 MIMO Antenna
- **Connector Type:** SMA connectors
- **Cable Lengths:** 0.8m

Product Usage Instructions

Positioning your Antenna

- For best performance, it is recommended to mount the router in close proximity to the roof-mounted antenna. Use the standard 0.8m coaxial cables for optimal performance.
- Ensure there is a suitable space on the roof to position the antenna in close proximity to the router. For example, if the router is placed in an overhead cupboard, mount the antenna directly above the cupboard space.

Roof Antenna Position: Leave a 30cm gap from obstacles around the antenna to avoid interference issues. Mount the antenna on a horizontal flat roof.

Introduction

Thank you for purchasing this product, should you have any difficulty using your Antenna please contact our friendly Customer Helpline on +44 (0)1553 811000 or email support@maxview.co.uk.

Product Contents

A. Omni-directional Roof Mount Antenna and 0.8m cables with SMA connectors
B. Roof Clamp

C. No. 6 Screws (spares included)
D. Fixing Template
E. SMA to TS9 Adaptor X 2

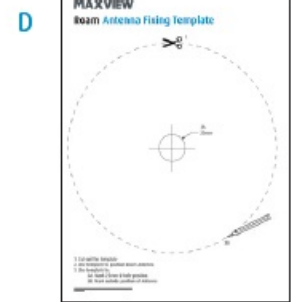

1. A. Omni-directional Roof Mount Antenna and 0.8m cables with SMA connectors
2. B. Roof Clamp
3. C. No. 6 Screws (spares included)
4. D. Fixing Template
5. E. SMA to TS9 Adaptor X 2

Tools required

- Power Drill
- 2.5mm Drill Bit
- Hack Saw
- File/Emery Paper
- 25mm Hole Saw – Surface Cleaner
- Cross Head Screwdriver

Specifications

Antenna

- **Type:** Omni-directional 2x2 MIMO (multiple in multiple out)
- **Frequency/Gain:** 698-6000 MHz/5.9dBi-8.8dBi. Includes all 3G, 4G and 5G frequencies
- **Connector Type:** 2 x SMA
- **Impedance:** 50 Ohm
- **Power:** Passive
- **Cable Lengths:** 0.8m as standard
- **Housing: Aluminium Base**. UV Stable ASA Cover
- **Dimensions:** \varnothing : 196mm x H: 65mm
- **Weight:** 500g

Accessories – Sold separately

Bracket Fixing Kit – For roof mounting



Bracket Fixing Kit - For roof mounting

The raiser bracket allows you the flexibility to mount your antenna anywhere on your roof and enter the cable at your preferred point using the supplied cable entry cover. Alternatively you may have an existing cable entry point you may like to utilise instead.

Designed and manufactured specifically for the Antenna, the aluminium bracket is lightweight, strong and finished with a durable white powder coating. Suitable for any flat roof the kit also includes 3m extension cables for flexible mounting position.

- MXL050/KIT1 White
- MXL050/GKIT Grey

Roam Extension Cables



Extension cables can be purchased separately to allow a flexible mounting position to the router.

- 1 metre MXL050/EXT1
- 2 metres MXL050/EXT2
- 3 metres MXL050/EXT3
- 5 metres MXL050/EXT5

Weatherproof Socket with SMA Connectors



Weatherproof Socket with SMA Connectors

The Weatherproof Socket provides an external entry point into the side of any vehicle. Available with 2 SMA connections, making it ideal when using the Roam Antenna with the Roam Bracket Fixing Kit (See left) to allow for a temporary connection or where entry into the roof is not possible. It can also be used for other applications where an external SMA connection is required.

B2016

Thread Extender



Can be used to fit all Roam Antennas to thicker vehicle roofs. For example American RV's, Winterised Motorhomes and Over Landing vehicles. Thread Extender is ideal for roofs 50 – 90mm thick.

MXL050/TE

Positioning your Antenna

Distance between Router and Antenna For best performance, we recommend mounting the router in close proximity to the roof mounted antenna. For best performance, only use the antennas standard 0.8m coaxial cables. This means, once you have a suitable location for the router inside the vehicle, you must also ensure there is a suitable space on the roof to position the antenna in close proximity to the router. For example, if you would like to position your router in an overhead cupboard, we recommend mounting the antenna directly above the cupboard space.

Roof Antenna Position

We recommend leaving 30cm gap from obstacles around the antenna to avoid interference issues and mounting on a horizontal flat roof.

Important Antenna Installation Information

1. The 3M seal provides a permanent installation. The adhesive is extremely strong and the antenna is not designed to be removed. Please ensure you are completely happy with your antenna's position and orientation before installation.
2. The Roam 5G antenna is designed to be mounted directly to a horizontal, flat and smooth surface such as GRP (Glass Reinforced Plastic) with the coaxial cables passing directly through the roof underneath the centre of the antenna. The standard installation is designed for roof thicknesses from 10mm up to 50mm.

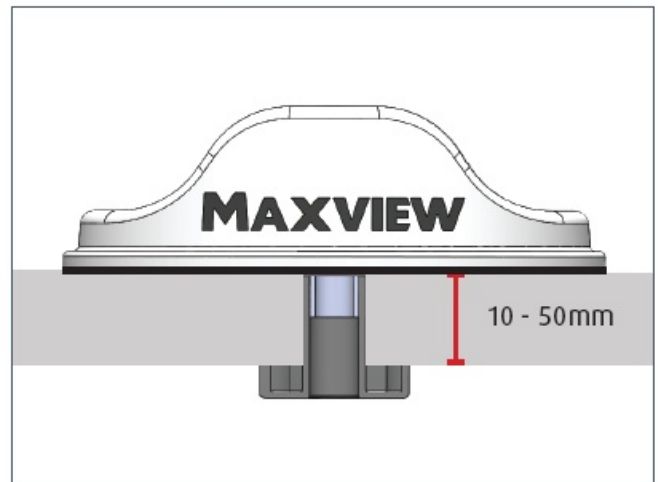

If this does not suit your installation, please see our mounting accessories (page 3) for a more suitable mounting option.

Fitting the Antenna

These instructions are for the standard through-the-roof installation as supplied.

1. Once you have a suitable position for the antenna, cut out the supplied template. Use to mark the 25mm centre hole position and mark the outside of the antenna.
2. At the marked centre position, drill a 2.5mm pilot hole through the roof. Use a 25mm hole saw to drill out the centre hole through the roof. Tidy up the hole to remove swarf and sharp edges.

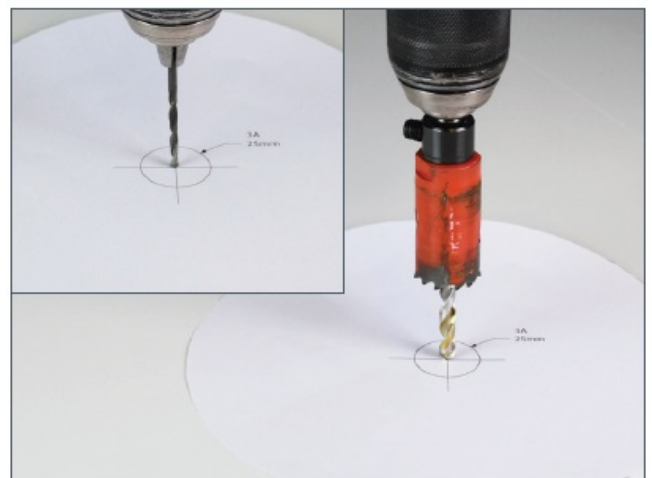

3. Use the Antenna clamp to gauge the depth of the roof. The best way to do this is to sit the Antenna clamp upside down through the hole. Then, from the inside, mark on the clamp where the clamp passes through the ceiling and into the vehicle.
4. Remove the clamp and cut the clamp shaft to the correct length. The correct length for your installation will be

the roof depth minus 3mm. This will ensure the clamp does not bottom out on the antenna when tightened. If roof depth is 30mm. The clamp shaft should be cut 27mm along the shaft.

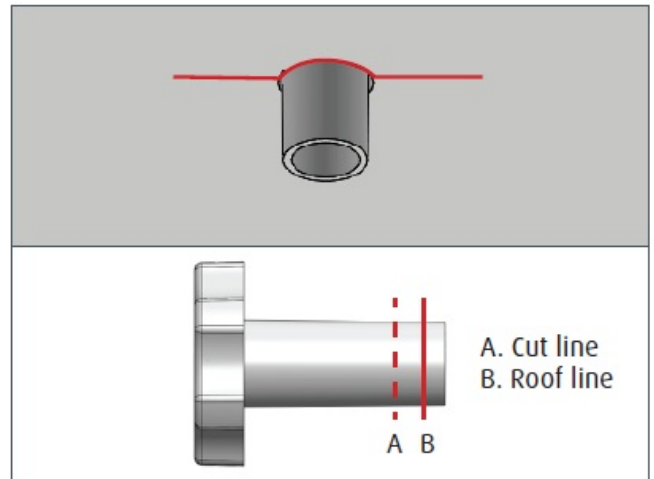

5. Clean the surface where the antenna will be installed, ensuring it is free from debris and grease.
6. Pass the cables through the hole and remove the self-adhesive backing from the 3M seal. Pass the cables through the roof and position the antenna with the embossed arrow facing the front of the vehicle and the outside edge of the antenna aligning with the marks added earlier.

IMPORTANT – Ensure the position of the antenna is central to your markings, as once stuck down, the antenna is not designed to be removed.

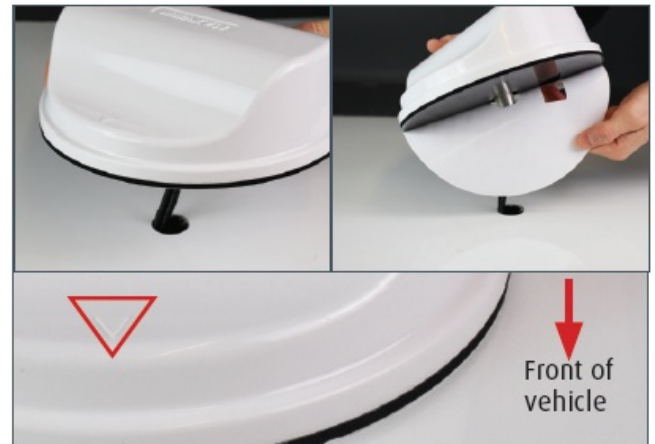

7. Press firmly around the edges of the antenna to ensure a watertight seal has been achieved.
8. From the inside of the vehicle, attach the clamp and turn clockwise onto the thread protruding from the bottom of the antenna. Continue to turn until the clamp is compressing the seal underneath the antenna.



9. Once in position, use 1 x No.6 Screw to secure the clamp in position.
10. The Antenna is now installed and ready to be connected to a suitable 4G/5G Router.

Please note: SMA to TS9 Adaptors (included) may need fitting depending on your chosen Router Model.



General Safety Warnings

Read these instructions carefully and become familiar with your Maxview product. Understand the application, limitations and any hazards involved with the installation and operation. Failure to follow all instructions may result in damage to your vehicle and/or serious injury. Maxview declines all responsibility in the event of an incident or accident if they are due to a non-observation of the installation instructions or the way the product is used. No modifications to the product are permissible.

Installation

- Always consider the additional height the product you install adds to the vehicle
- Always follow manufacturer's operating instructions before using tools and equipment.
- Take care when working at heights. Keep work area clean and tidy to avoid trip hazards
- Use creeper boards where necessary to ensure roof construction can support your weight
- All electrical work should be carried out by a competent person

Operation

The maximum speed of vehicle with product mounted on roof is 81mph (130km/h)

Servicing & Support

- Any inspection or repair must be carried out by Maxview or an appointed representative of the manufacturer
- No regular maintenance required on the product
- Do not dismantle product
- Do not use solvent or abrasive cleaning agents on the product
- Only use a suitable mild detergent to clean the product
- Do not pressure wash the product
- We recommend you check the mechanical integrity of a roof mounted product at least once a year
- If in the event that you do experience a problem with the product, call Maxview Customer Service +44 (0)1553 811000

Maintenance

The antenna has been designed to be maintenance and trouble free. For optimum signal strength, keep the cover clean from dirt, bugs, and other debris. Periodic washing of the top cover with mild soap and water is recommended.

1. Do not remove the cover of the antenna as it will void the limited guarantee.
2. Never power wash the antenna. Keep the enclosure clean from dirt, bugs, and other debris by hand washing

with mild soap and water.

DO NOT USE SOLVENTS TO CLEAN THE ROAM. DO NOT DROP OR EXPOSE TO JARRING MOVEMENTS.

Terms and conditions

In no event shall Maxview be liable for any indirect, incidental or consequential damages from the sale or use of the product. This disclaimer applies both during and after terms of the guarantee. This does not affect your statutory rights. The antenna is designed for permanent installation and is not designed to be removed or serviced. Whether the antenna is in warranty or not and whether the cause for removal is our fault or not, we are not responsible for the safe removal of the antenna. We will not be held responsible or liable for any damage done to the antenna or other property whilst removing the antenna, regardless of the reason for removal.

2-year guarantee

Every Maxview Antenna is covered by the following 2 year parts limited guarantee from the date of original purchase.

How do I claim on my guarantee?

In the unlikely event that you have an issue with your product please contact our Customer Services Team on +44 (0) 1553 811000 or email support@maxview.co.uk. You will need to retain your proof of purchase. In no event shall Maxview be liable for any indirect, incidental or consequential damages from the sale or use of the product. This disclaimer applies both during and after terms of the guarantee. This does not affect your statutory rights. Due to expanding and changing telecommunications market, Maxview cannot be held responsible for changes made to communication services. Software updates to address such issues are not covered under guarantee.

Terms and Conditions of the Guarantee

1. Your guarantee starts from the date you purchased your item. Your guarantee will be valid from date of manufacture if you are unable to provide a proof of purchase.
2. A guarantee authorisation must be obtained from Maxview prior to work commencing.
3. Maxview is responsible for the cost of a replacement part if the original part is determined to be defective under the terms of the guarantee.
4. Any replacement parts required will be supplied, by return, on receipt of the faulty part.
5. Any work requiring replacement parts will only be sanctioned on receipt of proof of the broken part. The customer is responsible for the cost of replacement parts after the guarantee period has expired.
6. Our guarantee is "Back To Base." No travelling costs will be paid.
7. Parts that suffer breakdown and/or failure due to flooding/water ingress or abrasive cleaning caused by solutions and/or Pressure Washers are not covered under our guarantee.
8. Our guarantee does not cover installation or external wiring.

This guarantee also does not apply where:

- The product has been abused, misused, improperly installed or improperly maintained.
- The product has been installed without the use of a Maxview mounting bracket designed for the product.
- Repairs have been made or attempted by others that are not certified by Maxview to do such repairs.
- Repairs are required because of normal wear and tear.
- Alterations have been made to the product.
- The antenna unit has been opened without authorisation.

- Damage has been caused by power washing.
- Circumstances beyond the control of Maxview cause the product to no longer operate correctly.
- The customer is not the original owner.

Certification and Environment

- The Antenna has been designed, constructed and marketed in compliance with the safety and product requirements of the relevant EEC Directives.
- Products marked with the crossed-out wheely bin must not be disposed of with normal household waste but made available for separate household collection. A separate collection of used products and their packaging allows materials to be recycled and used again. Reuse of recycled materials helps prevent environmental pollution and reduces the demand for raw materials.
- UK Conformity Assessed (UKCA) marking is a certification mark that indicates conformity with the applicable requirements for products sold within Great Britain.

FAQ

Q: Can I use extension cables with the antenna?

A: Yes, extension cables can be purchased separately to allow flexible mounting positions for the router. Available lengths are 1m, 2m, 3m, and 5m.

Q: What tools are required for installation?

A: The tools required for installation include a power drill, 2.5mm drill bit, 25mm hole saw, cross head screwdriver, hack saw, file/emery paper, and surface cleaner.

Q: How can I contact customer support?

A: You can contact the UK helpline at +44 (0)1553 811000 or email support@maxview.co.uk for assistance with the product.

Documents / Resources

 <p>MAXVIEW MXL050-KIT1 Roam Bracket Fixing Kit</p>	<p>MAXVIEW MAXVIEW MXL050-KIT1 Roam Bracket Fixing Kit [pdf] Instruction Manual MXL050-KIT1, MXL050-GKIT, MAXVIEW MXL050-KIT1 Roam Bracket Fixing Kit, Roam Bracket Fixing Kit, Bracket Fixing Kit, Fixing Kit, Kit</p>
--	---

References

- [M Satellite TV, Terrestrial TV and WiFi for Motorhomes, Caravans and More!](#)
- [User Manual](#)

[Manuals+](#), [Privacy Policy](#)

This website is an independent publication and is neither affiliated with nor endorsed by any of the trademark owners. The "Bluetooth®" word mark and logos are registered trademarks owned by Bluetooth SIG, Inc. The "Wi-Fi®" word mark and logos are registered trademarks owned by the Wi-Fi Alliance. Any use of these marks on this website does not imply any affiliation with or endorsement.