



MAXLED B0957DB3W5 Ceiling Luminaire Instruction Manual

[Home](#) » [MAXLED](#) » MAXLED B0957DB3W5 Ceiling Luminaire Instruction Manual 

Contents

- [1 MAXLED B0957DB3W5 Ceiling Luminaire](#)
- [2 OPERATION INSTRUCTIONS](#)
- [3 Documents / Resources](#)
- [4 Related Posts](#)

MAXLED

MAXLED B0957DB3W5 Ceiling Luminaire



OPERATION INSTRUCTIONS

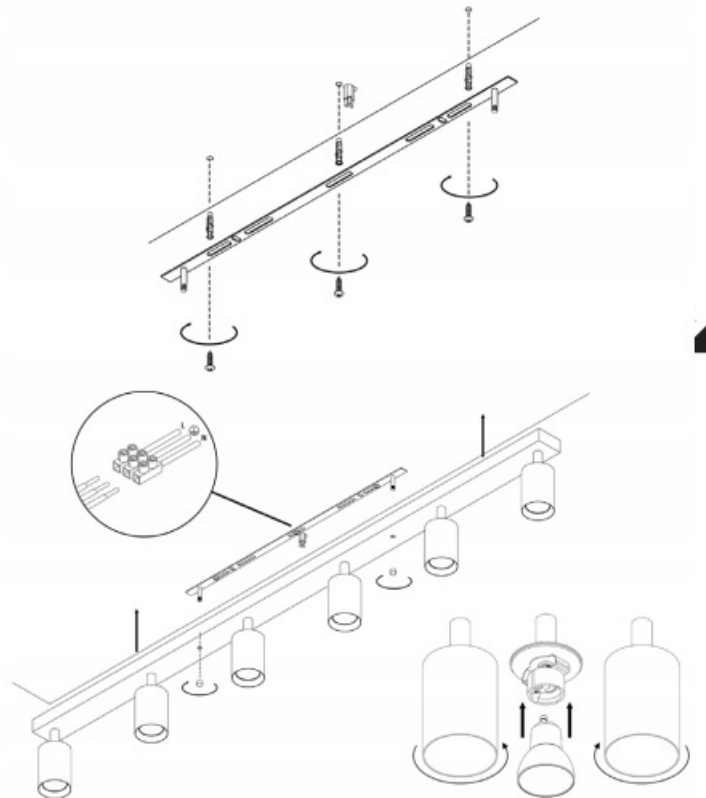

TURN OFF THE POWER!



This product complies with EU Directive 2002/96/EC. The crossed bin symbol on the appliance indicates that after use, the product must be disposed of separately from domestic waste, either by taking it to a separate waste disposal site for electric and electronic appliances or by returning it to the dealer. If the disused appliance is collected correctly as separate waste, it can be recycled, treated and disposed of ecologically; this avoids a negative impact on both the environment and health, and contributes to recycling of the products materials. For detailed information regarding waste disposal services please contact your local waste disposal agency or the shop where the product was purchased

Documents / Resources



[MAXLED B0957DB3W5 Ceiling Luminaire](#) [pdf] Instruction Manual
B0957DB3W5, Ceiling Luminaire, B0957DB3W5 Ceiling Luminaire, Luminaire