



Maximum Controls 04-18-24 Max App Based Keypad



# Maximum Controls 04-18-24 Max App Based Keypad Installation Guide

[Home](#) » [Maximum Controls](#) » Maximum Controls 04-18-24 Max App Based Keypad Installation Guide 

## Contents

- [1 Maximum Controls 04-18-24 Max App Based Keypad](#)
- [2 Product Information](#)
- [3 Product Usage Instructions](#)
- [4 Key Features](#)
- [5 MAX APP BASED KEYPAD OVERVIEW](#)
- [6 ENTRY GATE APPLICATION USING APP BASED KEYPAD](#)
- [7 PEDESTRIAN DOOR APPLICATION](#)
- [8 SETTING UP MAX CLOUD APP](#)
- [9 PROGRAM KEYPAD GREETING & CALL BUTTON](#)
- [10 PROGRAM TIMERS](#)
- [11 CELL DATA ACTIVATION SETUP](#)
- [12 Documents / Resources](#)
  - [12.1 References](#)
- [13 Related Posts](#)



**Maximum Controls 04-18-24 Max App Based Keypad**



## Product Information

### Specifications:

- Enclosure: Tamper resistant zinc die-cast front door
- LCD Display: Sunlight readable display for greeting and messages
- LEDs: Side LEDs for nighttime visibility
- Buttons: Help button for displaying messages, call button for visitors
- Power Input: 12VDC / VAC
- Antenna: Dome antenna for improved signal reception
- Keypad: Backlit and vandal-proof with call button and phone number display

## Product Usage Instructions

### Entry Gate Application:

1. Connect a 12VDC, 1A power transformer to the Power Input port of the Max Keypad.
2. Install the transponder device as shown in the diagram.
3. Select the desired RELAY STRIKE option using the rotary switch for gate access.

### Pedestrian Door Application:

1. Install the solenoid lock and connect it as indicated in the wiring diagram.
2. Add an Exit Push Button as shown in the instructions.

3. Select the appropriate Relay Strike Time using the rotary switch for door opening.

### **Setting up Max Cloud App:**

1. Download the Max Cloud App from the Google Play Store on your Android phone.
2. Follow the on-screen instructions to install the app and set up a new gate site.

### **FAQ**







**1. Q: How do I add a new user on the app?**

A: To add a new user, open the Max Cloud App, navigate to the user settings, and follow the prompts to input the necessary information for the new user.

**2. Q: Can I program keycodes with restrictive times?**

A: Yes, you can program keycodes with specific time restrictions by accessing the keypad programming options in the app and setting up the desired schedule for each user.

### **Key Features**

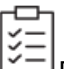
-  App Based Trackable Keypad
-  Affordable cell data plans (AT&T or Verizon)
-  16 Zone Control using Wiegand Converters
-  15 Wireless zone control (1 mile range / 900 MHz)(with wireless Wiegand Converters)
-  Push Notification for “Call” button pressed or Visitor Motion Detected COMING SOON
-  Guest Pass with date and time restriction
-  Event Log of all transactions

### **MAX APP BASED KEYPAD OVERVIEW**

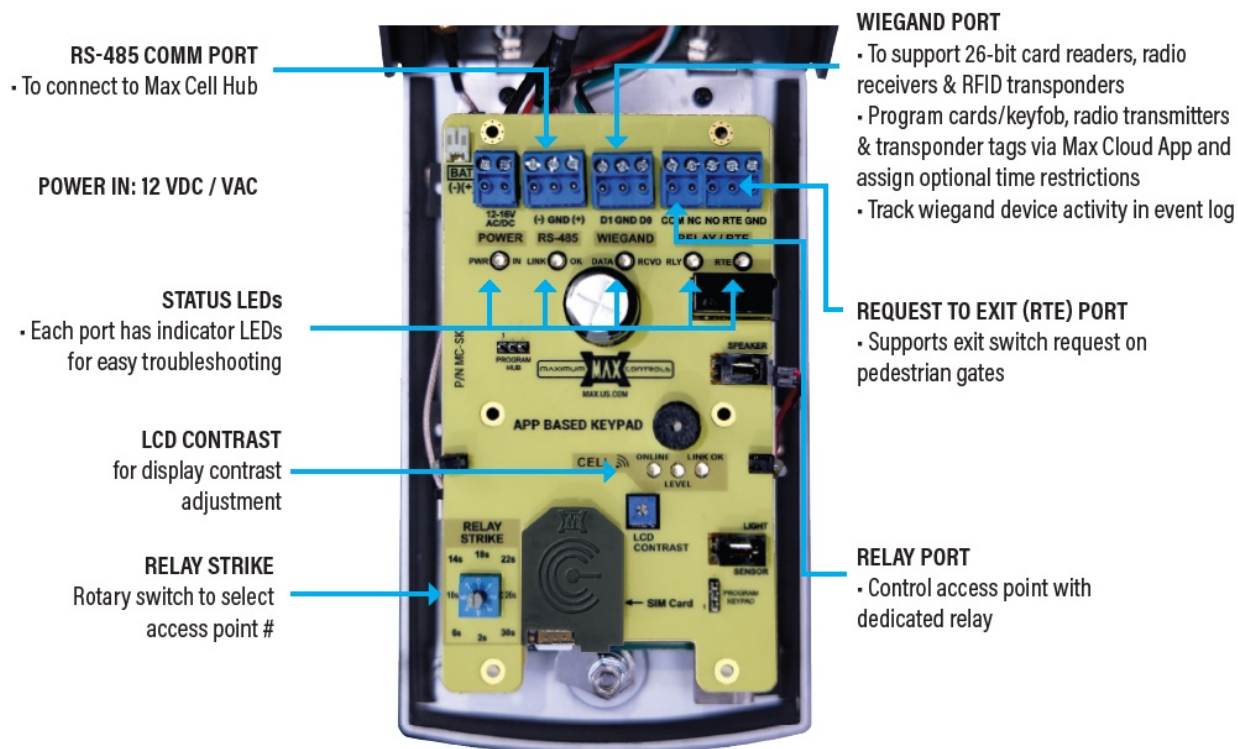

## ENTRY GATE APPLICATION USING APP BASED KEYPAD

APP  
BASED  
KEYPAD

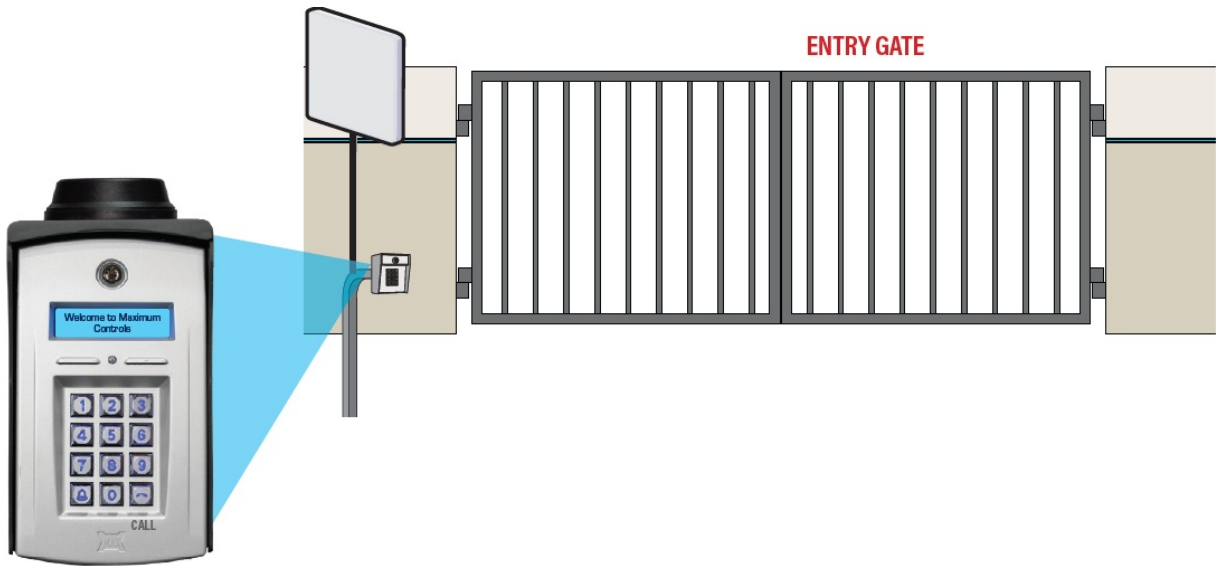

4

#### Wiring Transponder Device

Install transponder device as shown

1

#### Wiring Power Input

Connect 12VDC, 1A power transformer to *Power Input* port of Max Keypad (polarity does NOT matter)

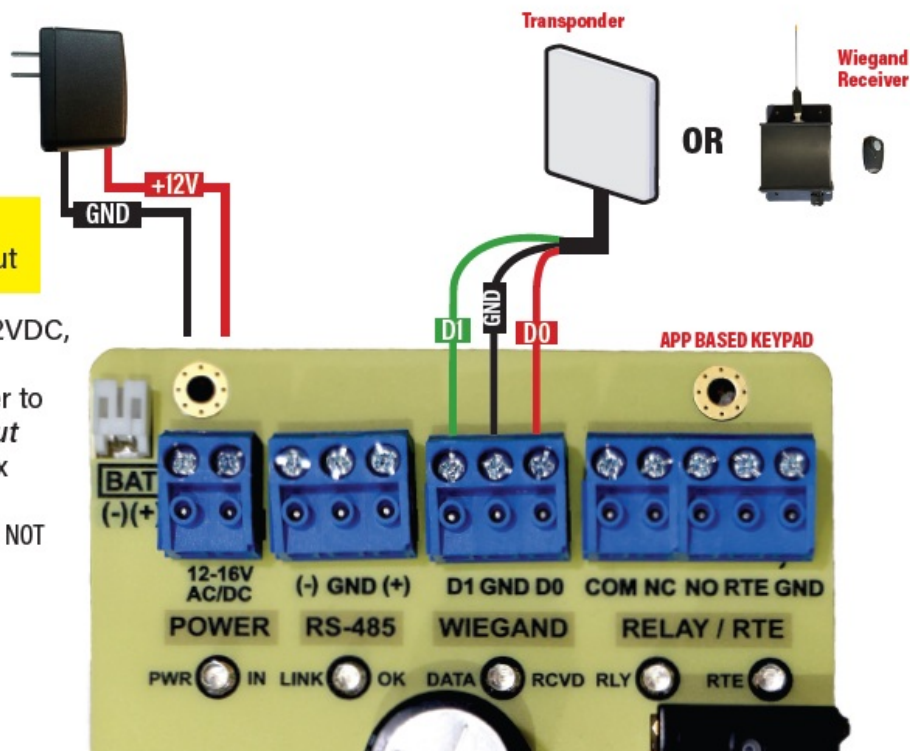

#### Select "RELAY STRIKE" using rotary switch

Select #0: to open gate via Cell Hub (note: keypad relay NOT activated)

Select #15: to open gate via Cell Hub (note: keypad relay is also activated)

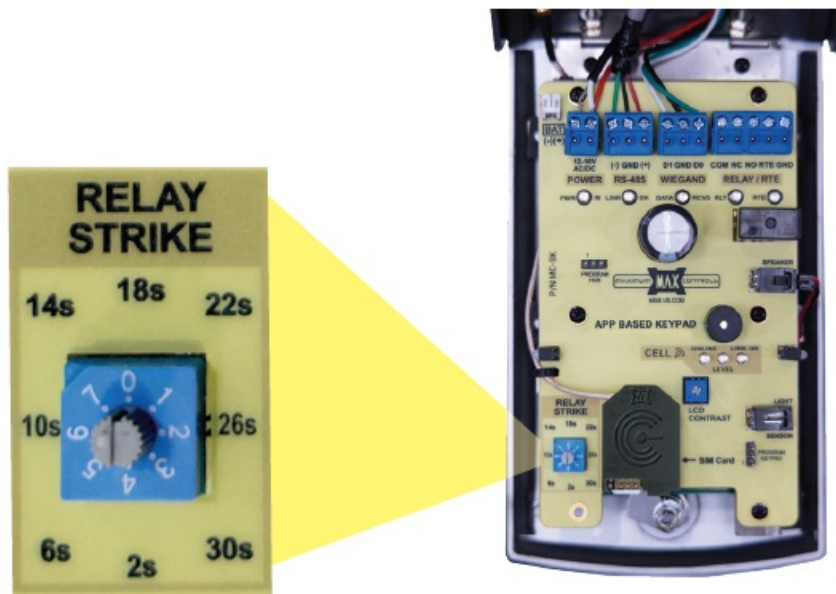

## PEDESTRIAN DOOR APPLICATION

### 2 Wiring Solenoid Lock

Install Solenoid Lock as shown below

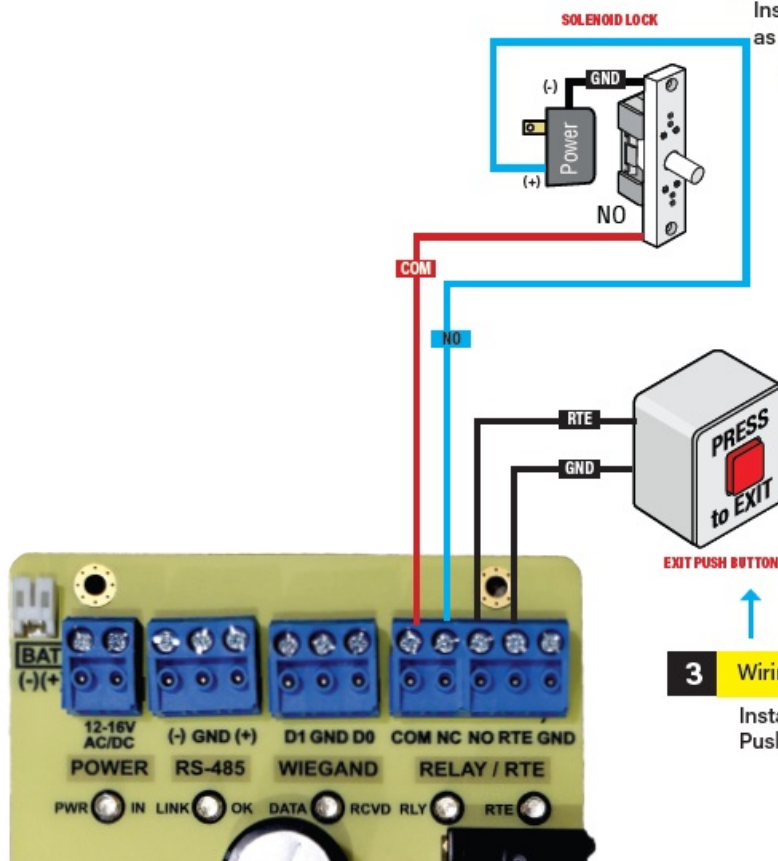

### 3 Wiring Exit Push Button

Install request to Exit Push Button as shown

Select "Relay Strike Time" using rotary switch

Select #2s-30s: to open gate using Relay Strike



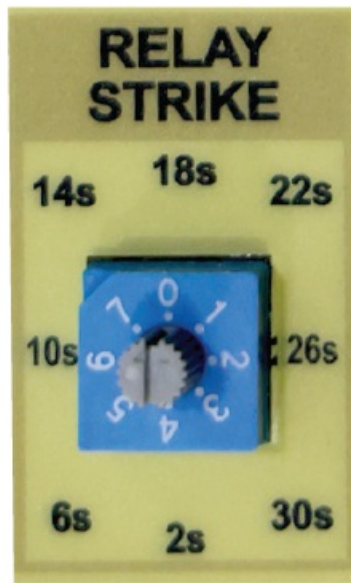

## PEDESTRIAN DOOR APPLICATION

### PEDESTRIAN DOOR

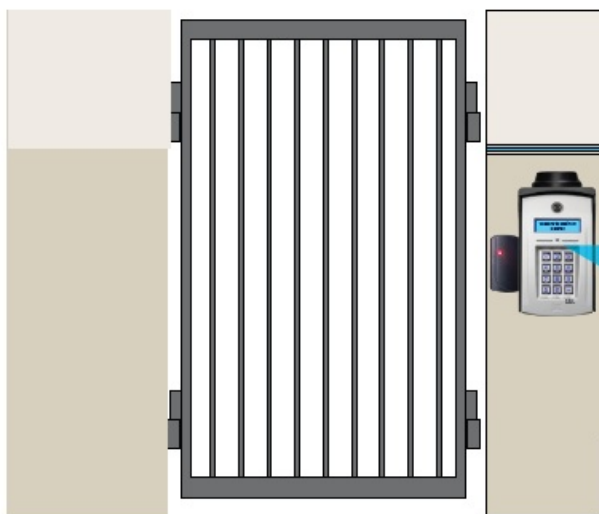

### App Based Keypad

Wiring Power Input

Connect 12VDC, 1A power transformer to *Power Input* port of Max Keypad (polarity does NOT matter)

Verify POWER LED is ON

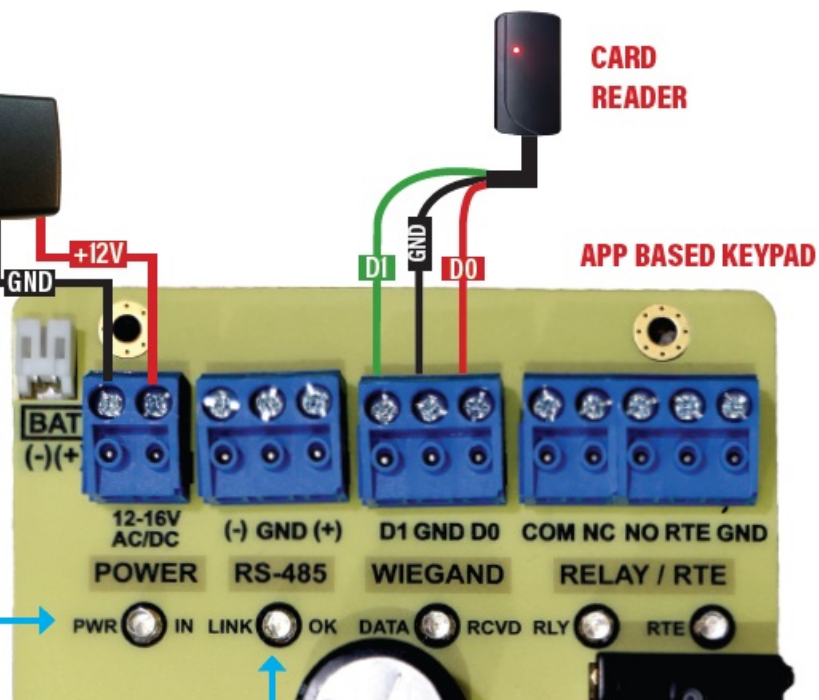

Verify RS-485 LED turns ON otherwise revise your wiring

## SETTING UP MAX CLOUD APP



**SCAN** QR CODES  
TO DOWNLOAD "MAX Cloud App"



### Getting Max Cloud App

Max Cloud App is available for download on:



How to install Max Cloud App on android phones



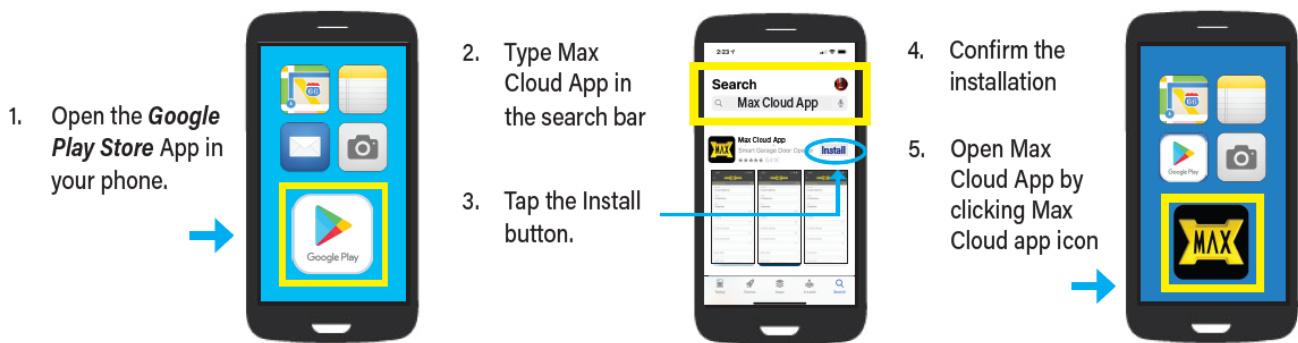

### How to install Max Cloud App on Iphone



### Max Cloud Login for the first time

1. Open the **Max Cloud app** in your phone.
2. Add a phone number then press **Login**. Android phone does automatic verification
- 3.

MAXIMUM **MAX** CONTROLS

Phone Number

Login

On Iphone phone Max Cloud app will send you a code to verify your account. Enter the code and press verify, now you Max Cloud app is now ready.

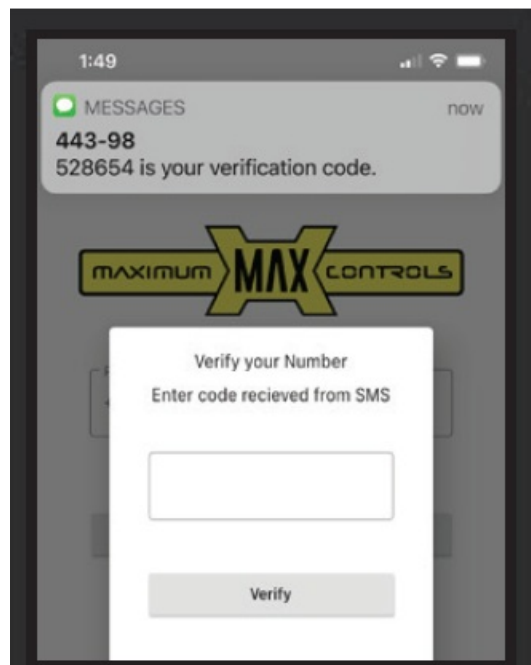

## SET UP A NEW GATE SITE ON APP

### 1 Add a New Gate Site on App

Click on + **Add a Gate** icon in app

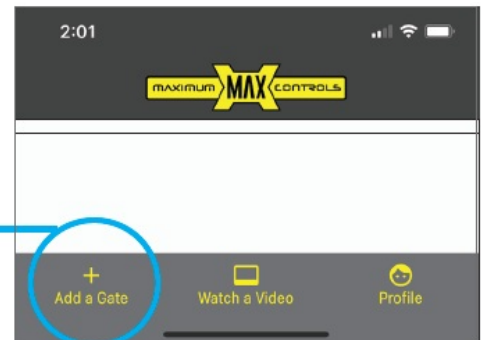

### 2 Setup gate site info

a.- Enter a site name

b.- Enter the IMEI# of the App Based Keypad



IMEI# is located on the inside of Max App Based Keypad



Please double check your entry to ensure cell connectivity

### 3 Set up ADMIN for the gate site

Add the name and cell # of the person who will manage the gate site

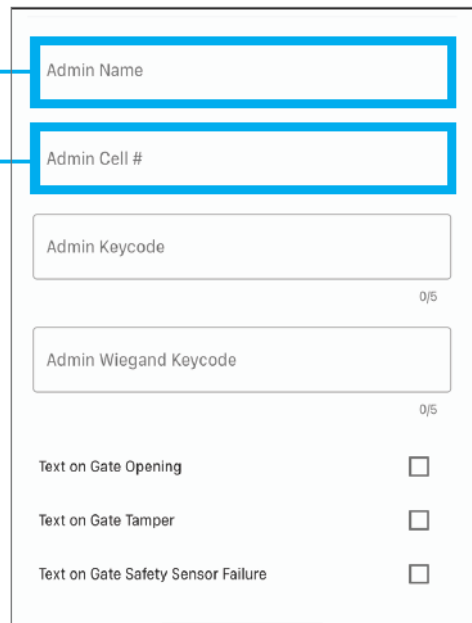

Admin Name

Admin Cell #

Admin Keycode 0/5

Admin Wiegand Keycode 0/5

Text on Gate Opening ☐

Text on Gate Tamper ☐

Text on Gate Safety Sensor Failure ☐

### 4 OPTIONAL Choose alert notifications

For manager to receive text alert for real time events

#### EXIT & SAVE changes

Press the back button [<] on the top left of the screen to confirm changes

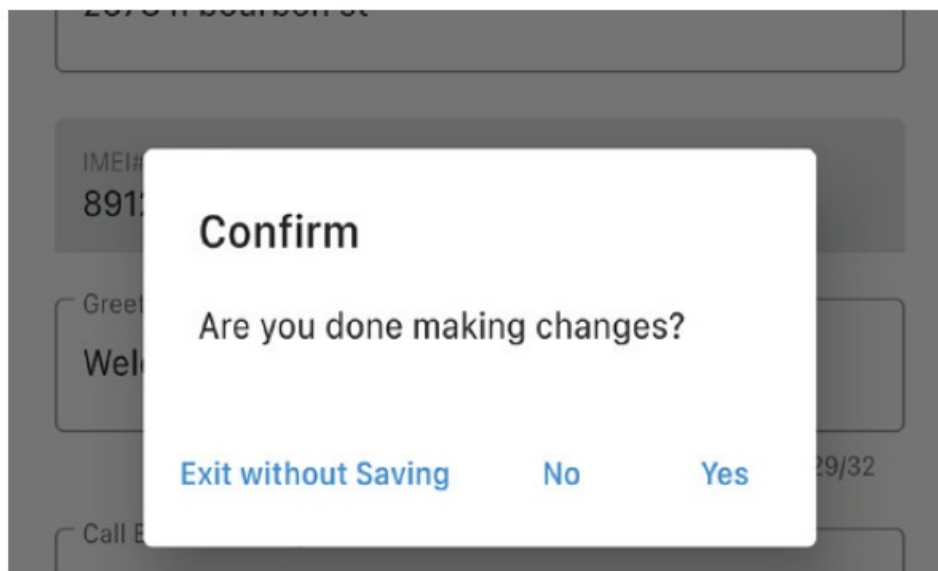

Choose the new site from the list

#### PROGRAM KEYPAD GREETING & CALL BUTTON

1

Press **Settings** icon in the main menu

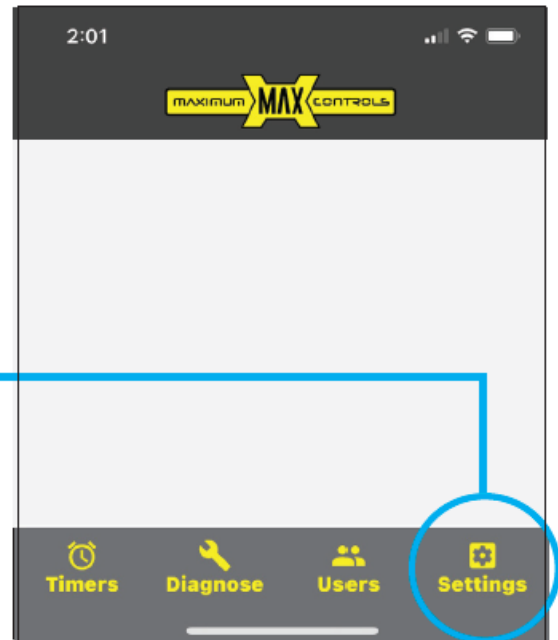

### Setup greeting message

Go to the GREETING area and type the message you want to display for your visitors. Limited to 32 characters.

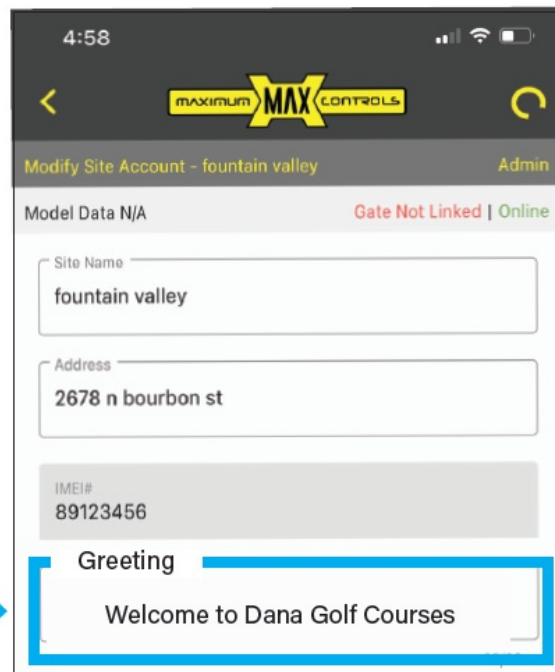

### PROGRAM CALL BUTTON MESSAGE

#### 1 Setup Call Button

Go to the Call Button area and type the message that may instruct the visitor to call a specific phone number (i.e. facility manager or home owner) using their personal cell phone. Example CALL button message: "CALL (949) 000-0000 on your phone".



CALL  
Button



4:58

MAX CONTROLS

Modify Site Account - fountain valley Admin

Model Data N/A Gate Not Linked | Online

Site Name  
fountain valley

Address  
2678 n bourbon st

IMEI#  
89123456

Greeting  
Welcome to Fountain Apartment

29/32

Call Button

CALL 949-000-0000 ON YOUR PHONE

30/32

When CALL button is pressed, display shows programmed message

**2 Press the back button [ < ] on the top left of the screen to confirm changes**



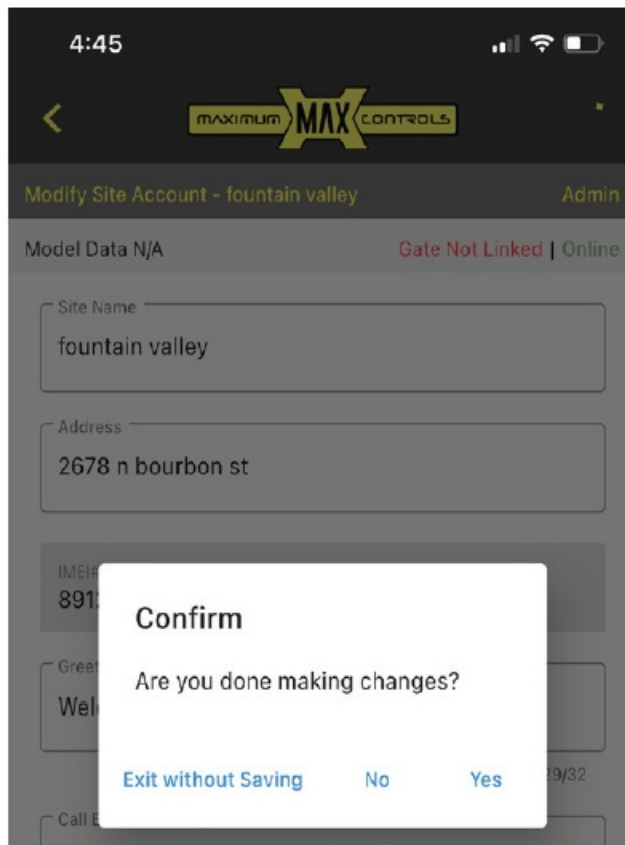

## ADD A USER ON APP

- 1 Press **Users** icon in the main menu

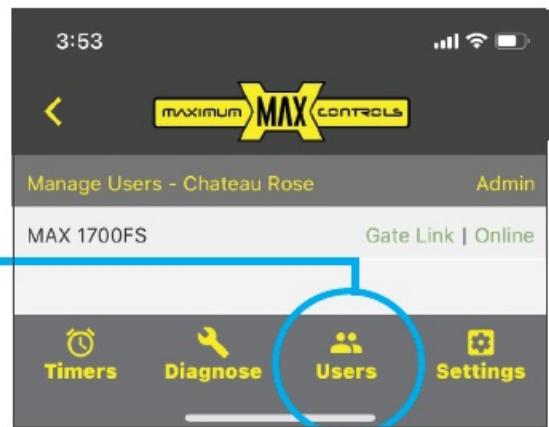

- 2 Then Press **Add a User** in the following menu

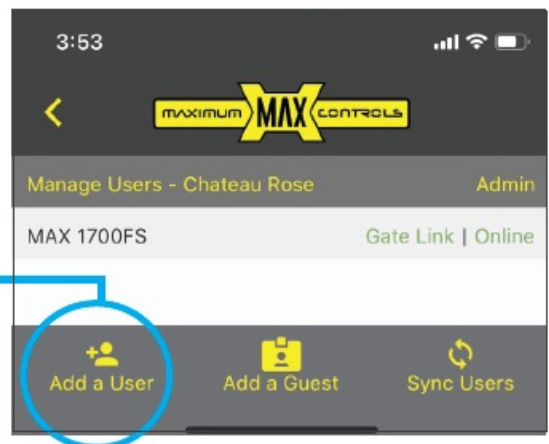

3

Enter **Name** of your visitor, then assign a **5 digit keycode**

4

Program Wiegand Keycode

If a Wiegand device is wired to keypad wiegand port then enter **Facility and Wiegand Keycode for the transmitter, keyfob or tag**

4:14

maximum MAX CONTROLS

Add a User - Chateau Rose Admin

MAX 1700FS Gate Link | Online

Admin ☐

User Name  
Rose

Keycode  
26709

Facility  
123

Wiegand Keycode  
12345

TIMER  
No Timer

PROGRAM KEYCODES WITH RESTRICTIVE TIME ZONES

**5 Assign a timer (OPTIONAL)**

Choose one of six timer schedules

These time restrictions apply to both keycode and Wiegand keycode

If you choose No Timer  
Keycode has no time restriction

4:14

MAX CONTROLS

Add a User - Chateau Rose Admin

MAX 1700FS Gate Link | Online

Admin

USER NAME

CELL PHONE #

KEYCODE

FACILITY ... WIEGAND KEYCODE

Timer

No Timer

Timer 1

Timer 2

Timer 3

Timer 4

Timer 5

Timer 6

Press the back button [<] on the top left of the screen to confirm create a user

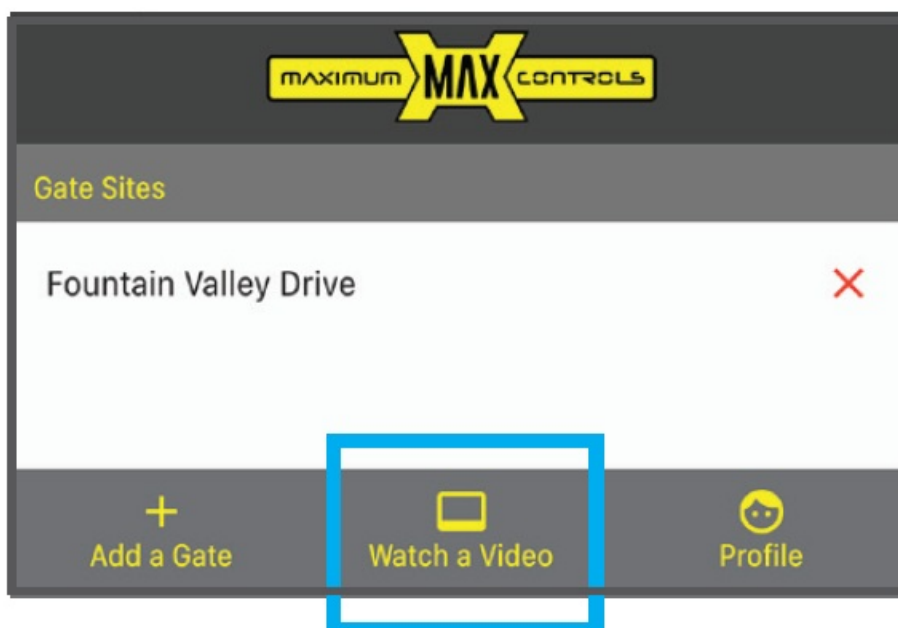

Watch video tutorials from Max Cloud App, just go to the home screen  
OR

**SCAN CODE**  
to watch tutorial



Applying restrictive time period to keycodes improves the security to your gate site

## PROGRAM TIMERS

**1**

Press *Timers* icon in the main menu

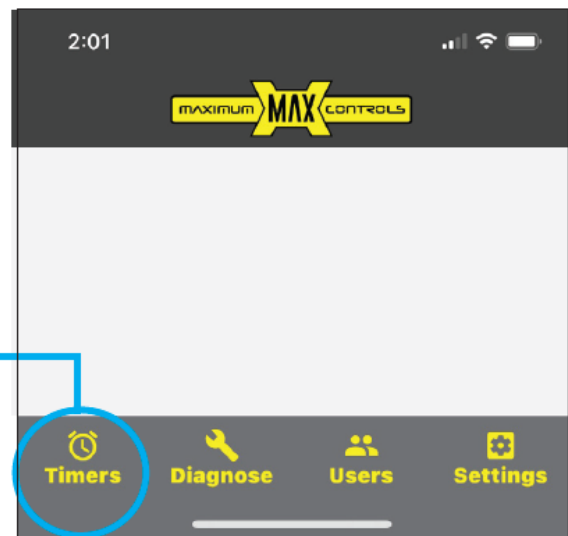

Choose the Timer option you want to setup from the list of timers

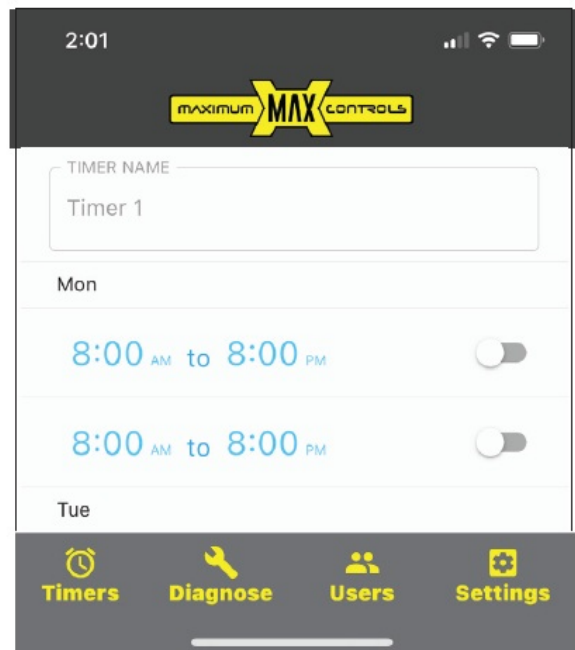
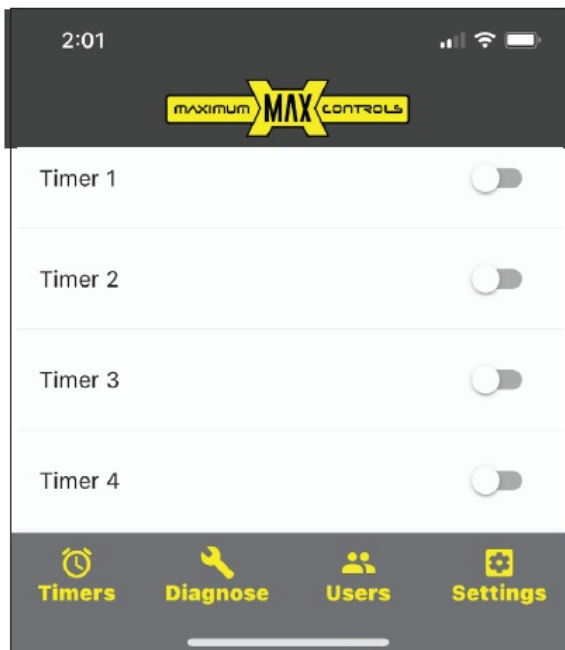

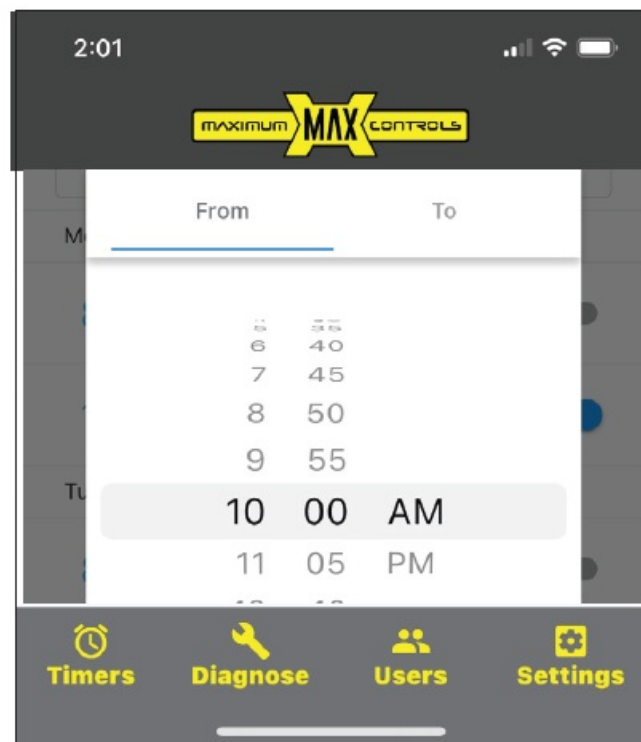

## CELL DATA ACTIVATION SETUP

SCAN QR CODE TO: Activate HUB's SIM card at [www.Max.us.com/products-cell-data-activation](http://www.Max.us.com/products-cell-data-activation)



**1** Go to <https://max.us.com>

**2** Press Max App on the main menu

Select **Max App Overview**  
then select and click on  
**Cell Data Activation**

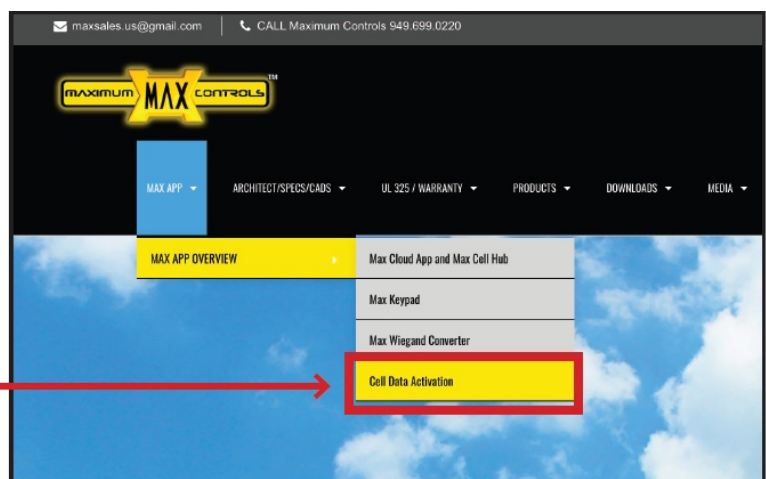



### 3 Start watching the video tutorial

### 4 Go to **Cell Data Activation** Button

Will take you to our secure portal <https://www.iotactivate.com/> to fill important information to register your account



Please have in hand the SIM Card (AT&T or Verizon) provided with Max App Based Keypad and IMEI#



Please double check your entry to ensure cell connectivity



IMEI# is located on the inside of Max App Based Keypad

### Setting up account information

a.- Under Marketplace subscription plans choose as a provider

**Maximum Controls**

b.- Choose a subscription Plan

c.- Follow instructions on the site to complete set up your account information and submit

### Enter your login info

Will take you to our secure portal <https://www.iotactivate.com/>, enter username and password then press login



iotactivate Wireless Data Plans

A RevX Systems Provided Service



## LOGIN

Keep your username secure, do not write it down, and if you're ever prompted for any security details from our rep or through e-mail exchange, do not share your login information.

If you need assistance at anytime, please feel free contact our support desk through the following link

[support@iotactivate.com](mailto:support@iotactivate.com)

Your Email Address

Password

[Forgot your password?](#)

LOGIN

7

## Review SUBSCRIPTIONS

Review your data plan shown in the your Active Subscription Plans section

Welcome back jake.mex@gmail.com [LOGOUT](#)  
Your Account Number is A1128

Subscription Status: ACTIVE

### ACTIVE SUBSCRIPTIONS

Your Current Subscription Plans

Product	Purchase	Next Billing	Expires	Qty	Price
<b>MAX Commercial Connect Plan (100MB plans)</b> The MAX Commercial Connect Plan is designed for heavy traffic commercial sector community gate security and provides for AT&T and/or VERIZON service - whichever carrier your equipment is built for. The monthly fee is \$15 per active gate and will be added on the monthly anniversary of your first gate activation.	09-29-2021	11-29-2021	never	1	per gate
<b>MAX Residential Connect Plan (10MB plans)</b> The MAX Residential Connect Plan is designed for vacation and primary residence gate security and provides for either gate activity for the monthly fee of \$7.95 per active gate. Your gate can be activated on AT&T or VERIZON - whichever carrier your equipment is built for.	07-30-2021	11-30-2021	never	3	per gate

## Activate SIM card

a.- Go to **My Services and Equipment** and **click over the plan and provider** you want to connect

b.- Go to **Activate a new subscription**

► MAX COMMERCIAL (VERIZON) \$15.00 MONTHLY - 1 LINE(s)

### MAX RESIDENTIAL CONNECT PLAN (10MB PLANS)

The MAX Residential Connect Plan is designed for vacation and primary residence gate security and provides for ample gate activity for the monthly fee of \$7.95 per active gate. Your gate can be activated on AT&T or VERIZON - whichever carrier your equipment is built for.

▼ MAX RESIDENTIAL (AT&T) \$7.95 MONTHLY - 2 LINE(s)

ICCID (AT&T)	IMEI (AT&T)	START DATE	STATUS	NICKNAME
--------------	-------------	------------	--------	----------

ACTIVATE A NEW MAX RESIDENTIAL (AT&T) \$7.95 MONTHLY SUBSCRIPTION HERE

ICCID (at&t) IMEI (at&t) [ACTIVATE](#)

\* NOTE: Your activation is usually complete within 2-5 minutes.

c.- Enter the **ICCID** information located on the back of the SIM Card provided



d.- Enter the **IMEI#** that is ocated on the inside of Max App Based



Please double check your entry to ensure cell connectivity

d.- Press **ACTIVATE** button

► MAX COMMERCIAL (VERIZON) \$15.00 MONTHLY - 1 LINE(s)

**MAX RESIDENTIAL CONNECT PLAN (10MB PLANS)**

The MAX Residential Connect Plan is designed for vacation and primary residence gate security and provides for ample gate activity for the monthly fee of \$7.95 per active gate. Your gate can be activated on AT&T or VERIZON - whichever carrier your equipment is built for.

▼ MAX RESIDENTIAL (AT&T) \$7.95 MONTHLY - 2 LINE(s)

ICCID (AT&T)	IMEI (AT&T)	START DATE	STATUS	NICKNAME

ACTIVATE A NEW **MAX RESIDENTIAL (AT&T) \$7.95 MONTHLY** SUBSCRIPTION HERE

678U99563 352753093240685 **ACTIVATE**

\* NOTE: Your activation is usually complete within 2-5 minutes.

e.- Review the status of your device; should show **ACTIVE**. In the event that shows **PENDING**, refresh your browser

► MAX COMMERCIAL (VERIZON) \$15.00 MONTHLY - 1 LINE(s)

**MAX RESIDENTIAL CONNECT PLAN (10MB PLANS)**

The MAX Residential Connect Plan is designed for vacation and primary residence gate security and provides for ample gate activity for the monthly fee of \$7.95 per active gate. Your gate can be activated on AT&T or VERIZON - whichever carrier your equipment is built for.

▼ MAX RESIDENTIAL (AT&T) \$7.95 MONTHLY - 2 LINE(s)





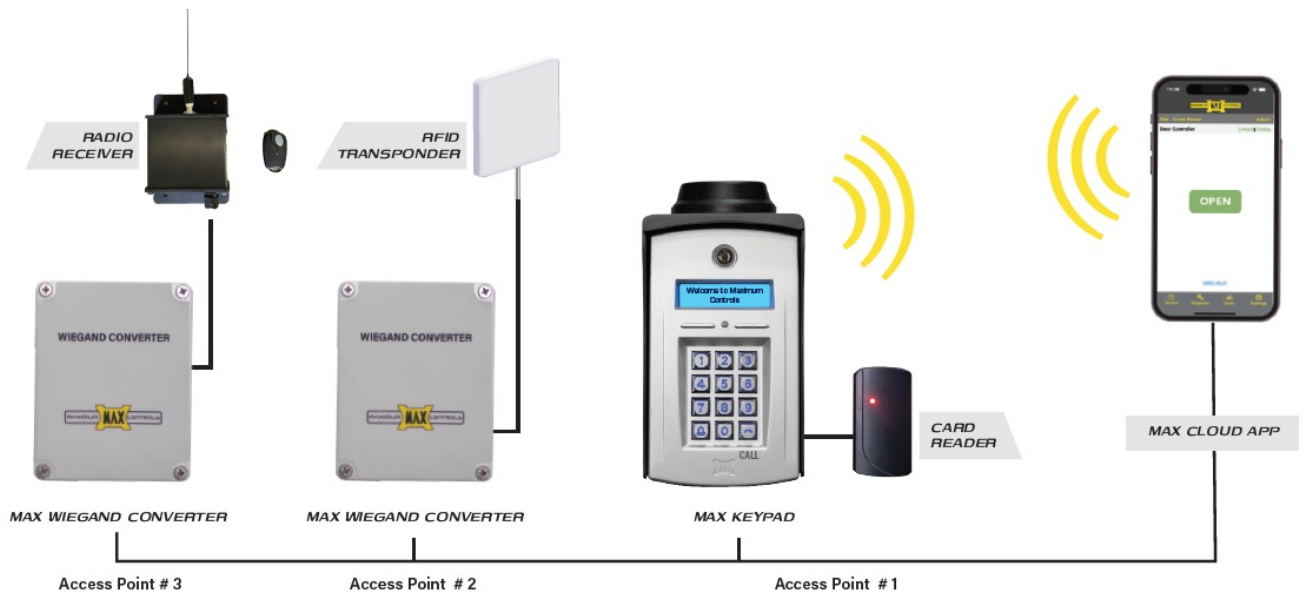

ICCID (AT&T)	IMEI (AT&T)	START DATE	STATUS	NICKNAME
89011703278374704081	355215100545533	07/30/2020	<b>ACTIVE</b>	JAKE ATT #1

f.- Now your device is ready. Please **LOGOUT** on the top of the website

**APP BASED KEYPAD**

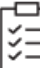

## Key Features

-  App Based Trackable Keypad
-  Affordable cell data plans (AT&T or Verizon)
-  16 Zone Control using Wiegand Converters
-  15 Wireless zone control (1 mile range / 900 MHz)(with wireless Wiegand Converters)
-  Push Notification for "Call" button pressed or Visitor Motion Detected COMING SOON
-  Guest Pass with date and time restriction
-  Event Log of all transactions







10530 Lawson River Ave., Fountain Valley, CA 92708

- Ave., Fountain Valley, CA 92708
- [949-699-0220](tel:949-699-0220)
- [maxsales.us@gmail.com](mailto:maxsales.us@gmail.com) | [MAX.US.COM](http://MAX.US.COM)

## Documents / Resources

	<p><b>Maximum Controls 04-18-24 Max App Based Keypad</b> [pdf] Installation Guide</p> <p>04-18-24 Max App Based Keypad, 04-18-24, Max App Based Keypad, App Based Keypad, Based Keypad, Keypad</p>
---	--

## References

-  [Maximum Controls MANUFACTURER OF BRUSHLESS DC SLIDE GATE OPERATORS, SWING GATE OPERATORS AND LONG-RANGE WIRELESS INTERCOMS](#)
-  [Maximum Controls Maximum Controls Max 1200 FS PRO sliding gate operator](#)
-  [The Kupfer Group](#)
-  [Maximum Controls MANUFACTURER OF BRUSHLESS DC SLIDE GATE OPERATORS, SWING GATE OPERATORS AND LONG-RANGE WIRELESS INTERCOMS](#)
-  [IoTactivate Wireless Data PlansA RevX Systems Provided Service](#)
-  [IoTactivate Wireless Data PlansA RevX Systems Provided Service](#)
- [User Manual](#)

[Manuals+](#), [Privacy Policy](#)

This website is an independent publication and is neither affiliated with nor endorsed by any of the trademark owners. The "Bluetooth®" word mark and logos are registered trademarks owned by Bluetooth SIG, Inc. The "Wi-Fi®" word mark and logos are registered trademarks owned by the Wi-Fi Alliance. Any use of these marks on this website does not imply any affiliation with or endorsement.